

LEGEND

- 840 — EXISTING CONTOURS
- 840 — NEW CONTOUR
- - - EXISTING DITCH
- - - NEW PAVED DITCH
- SS — EXISTING STORM SEWER
- (300) STRUCTURE NUMBER

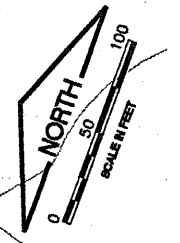

K:\Bloomington\0708502\Draw\EGPT
 FILE: RCP01004.dwg
 UPDATE BY: Kristy Brod
 PLOT DATE: 4/14/2008 9:43 AM
 BASE_EXISTGEO
 BASE_EXISTTOPD
 BASE_PROPCON
 BASE_CONTOURS30SCALE
 rcp01004
 CL_STA

REVISIONS

NUMBER	BY	DATE

0 1 2
 THIS BAR IS EQUAL TO 2"
 AT FULL SCALE (34X22).

**BLOOMINGTON-NORMAL AIRPORT AUTHORITY
 CENTRAL ILLINOIS REGIONAL AIRPORT
 BLOOMINGTON, ILLINOIS**

**CONSTRUCT DRAINAGE IMPROVEMENTS
 DITCH 1 GRADING
 PLAN & PROFILE
 STA. 0+00 TO STA. 12+00**

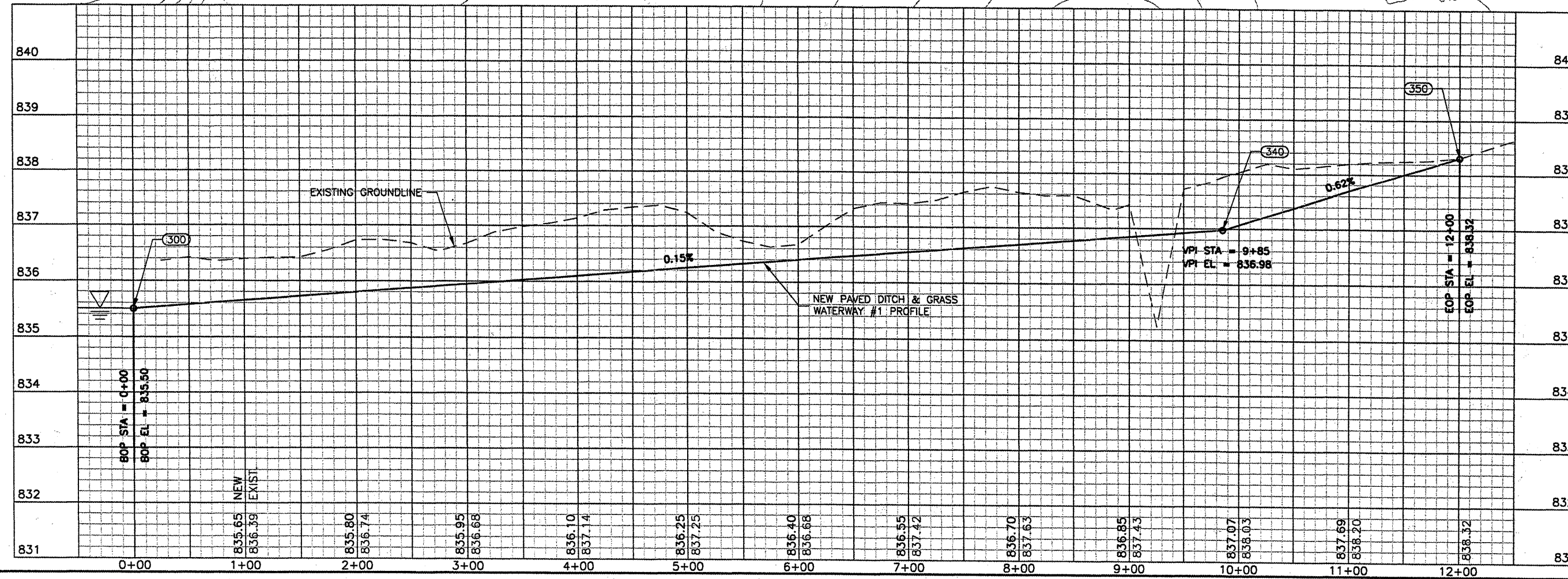

© Copyright CMT, Inc.
CMT
 CRAWFORD, MARRRY & TILLY, INC.
 CONSULTING ENGINEERS
 License No. 184-000613

DESIGN BY:	KLB
DRAWN BY:	DPA
CHECKED BY:	RLV
APPROVED BY:	RLV
DATE:	04/01/2008
JOB No:	0708502
IL PROJ NO.	BMI-3793
AIP PROJ NO.	3-17-0006-45
SHEET	14 OF 46 SHEETS