

IL 171 AT FOREST AVENUE / RIDGEWOOD ROAD
(NORTHWEST CORNER)

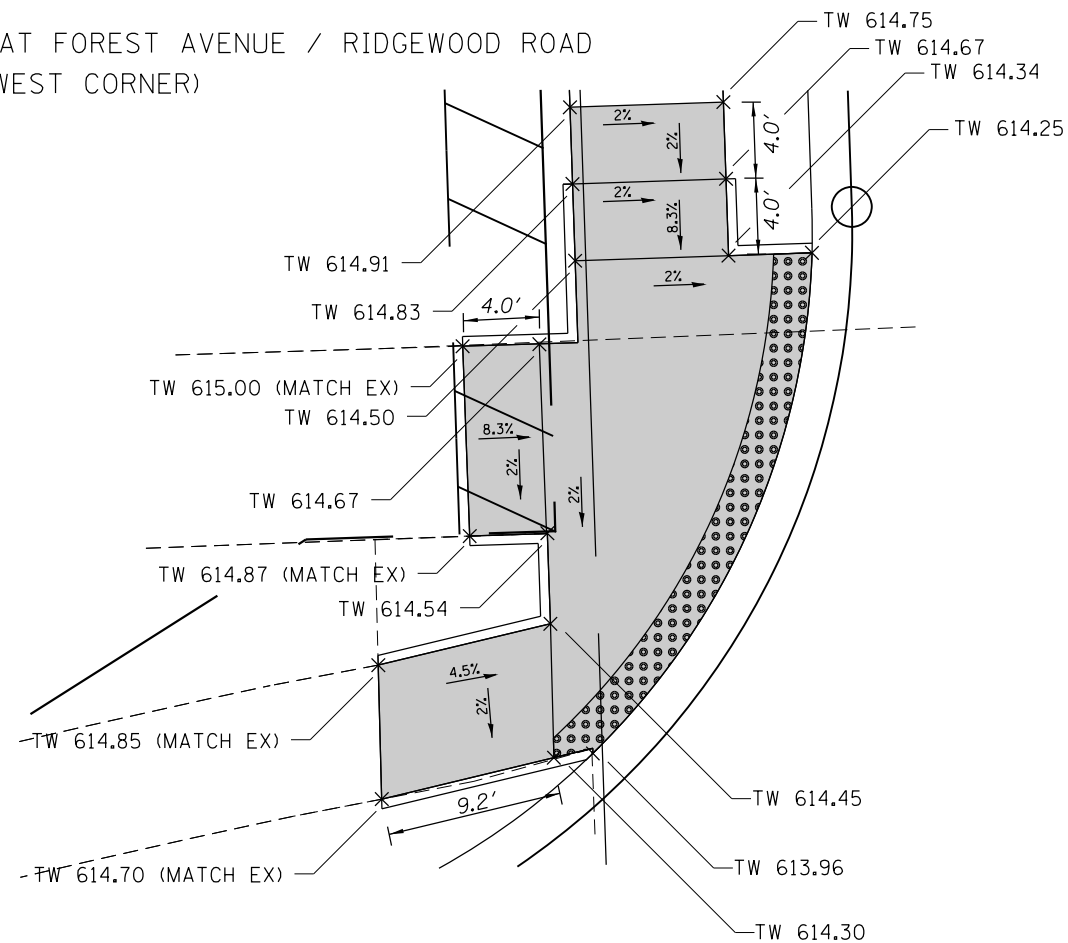

IL 171 AT FOREST AVENUE / RIDGEWOOD ROAD
(NORTHEAST CORNER)

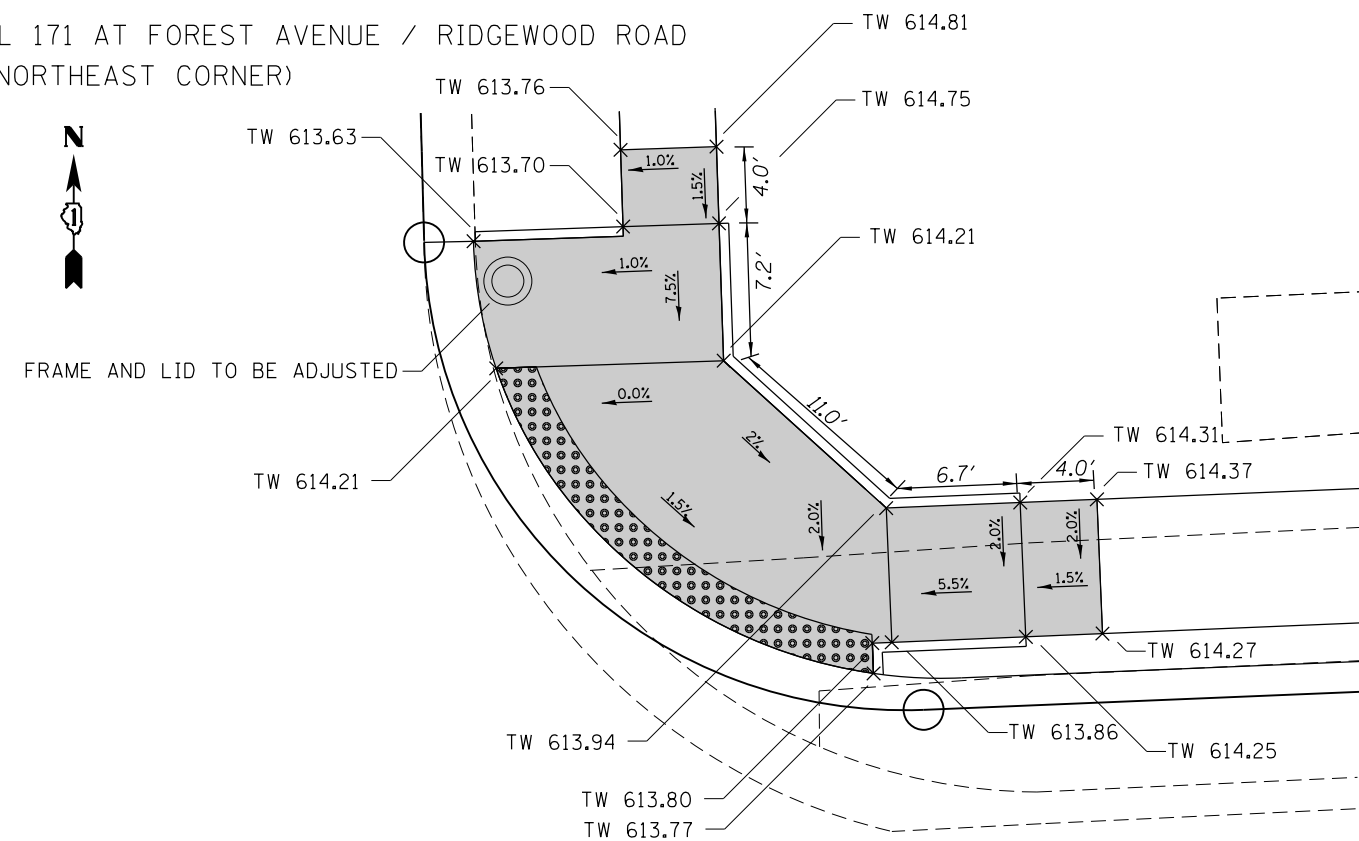

BUS PAD
STA 43+16, 39' RT

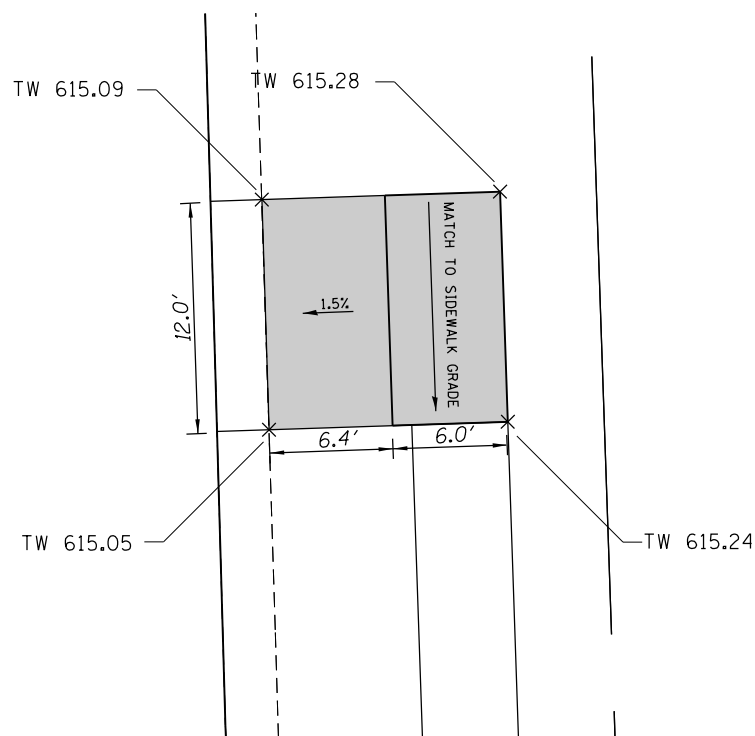

LEGEND



DETECTABLE WARNINGS

TW TOP OF WALK
PROPOSED ELEVATION

GENERAL NOTES:

1. PROPOSED ELEVATIONS ARE APPROXIMATE.
2. REF: BM ELEV 619.69, LOCATED ON THE NORTH-NORTHWEST BONNET BOLT ON THE FIRE HYDRANT AT THE SW CORNER OF WASHINGTON AVENUE AND WOODSIDE AVENUE.

FILE NAME =	USER NAME = Tariqfm	DESIGNED -	REVISED -
ci:\pw\work\p\idot\tariqfm\d0315748\PI144	2-sht-details.dgn	DRAWN -	REVISED -
Default	PLOT SCALE = 10.0000' / in.	CHECKED -	REVISED -
	PLOT DATE = 3/31/2014	DATE -	REVISED -

STATE OF ILLINOIS
DEPARTMENT OF TRANSPORTATION

IL ROUTE 171 AT FOREST AVE./RIDGEWOOD RD.
SIDEWALK DETAIL

SCALE: 1:5 SHEET OF SHEETS STA. TO STA.

F.A.P. RTE.	SECTION	COUNTY	TOTAL SHEETS	SHEET NO.
372	03035-TS	COOK	87	67
CONTRACT NO. 60X08				
ILLINOIS FED. AID PROJECT				