



F.A. RTE.	SECTION	COUNTY	TOTAL SHEETS	SHEET NO.
	2014-007TS	COOK	88	1
ILLINOIS CONTRACT NO. 60X82				

*88-2=86

D-91-222-14



STATE OF ILLINOIS
DEPARTMENT OF TRANSPORTATION
DIVISION OF HIGHWAYS

**PROPOSED
HIGHWAY PLANS**

**VARIOUS LOCATIONS IN NORTH COOK COUNTY #8
LIGHT EMITTING DIODE (LED) INSTALLATION
SECTION 2014-007TS
COOK COUNTY**

C-91-222-14

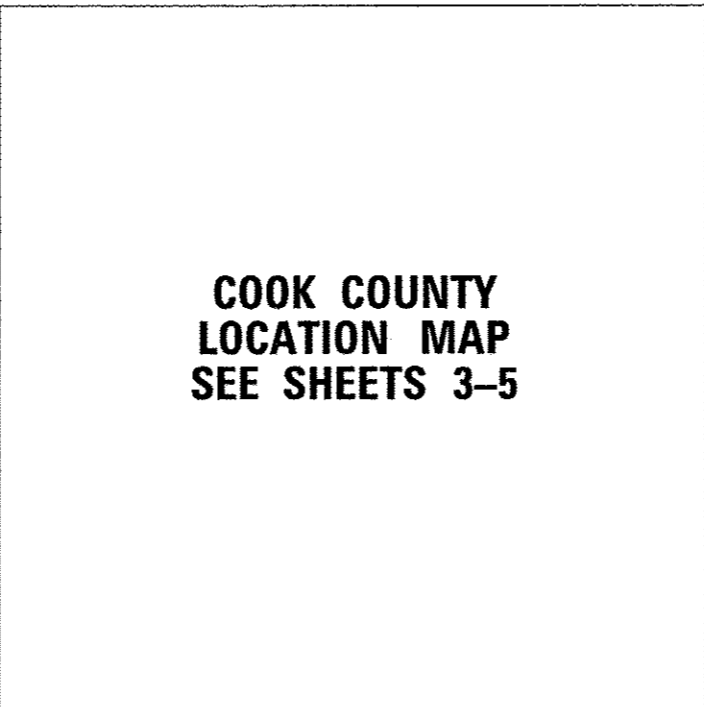

**COOK COUNTY
LOCATION MAP
SEE SHEETS 3-5**

FOR INDEX OF SHEETS, SEE SHEET NO. 2

	BRIAN K. SOIFERS REGISTRATION NO. 062-054567 DATE: 3/24/2014 EXPIRES: 11-30-2015

STANDARDS

- 701006-05 OFF-ROAD OPERATIONS 2L, 2W, 15' (4.5 m) TO 24" (600 mm) FROM PAVEMENT EDGE
- 701101-04 OFF-ROAD OPERATIONS MULTILANE, 15' (4.5 m) TO 24" (600 mm) FROM PAVEMENT EDGE
- 701701-09 URBAN LANE CLOSURE MULTILANE INTERSECTION
- 701901-03 TRAFFIC CONTROL DEVICES
- 720001-01 SIGN PANEL MOUNTING DETAIL
- 720006-04 SIGN PANEL ERECTION DETAILS
- 857001-01 STANDARD PHASE DESIGNATION DIAGRAMS AND PHASE SEQUENCES
- 862001-01 UNINTERRUPTABLE POWER SUPPLY (UPS)
- 880006-01 TRAFFIC SIGNAL MOUNTING DETAILS

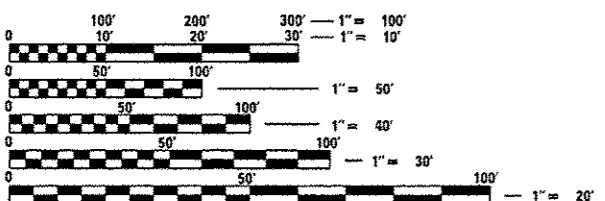

FULL SIZE PLANS HAVE BEEN PREPARED USING STANDARD ENGINEERING SCALES. REDUCED SIZED PLANS WILL NOT CONFORM TO STANDARD SCALES. IN MAKING MEASUREMENTS ON REDUCED PLANS, THE ABOVE SCALES MAY BE USED.

J.U.L.I.E.
JOINT UTILITY LOCATION INFORMATION FOR EXCAVATION
1-800-892-0123
OR 811

PROJECT ENGINEER: SUDUD MAHMOUD
PROJECT MANAGER: DARYLE DREW

CONTRACT NO. 60X82

STATE OF ILLINOIS
DEPARTMENT OF TRANSPORTATION
DIVISION OF HIGHWAYS

SUBMITTED March 29, 2014

John Fortin
DEPUTY DIRECTOR OF HIGHWAYS, REGION ENGINEER

May 9, 2014
John D. Baranzolo, P.E.
ENGINEER OF DESIGN AND ENVIRONMENT

May 9, 2014
Omer Osman, P.E.
DIRECTOR OF HIGHWAYS, CHIEF ENGINEER

**PRINTED BY THE AUTHORITY
OF THE STATE OF ILLINOIS**

Rev. 6-4-14



INDEX OF SHEETS

PAGE #	DESCRIPTION
1	COVER PAGE
2	INDEX OF SHEETS & GENERAL NOTES
3-5	LOCATION MAP
6	S&O HEADINGS
7-11	S&O SHEETS
12-18	IDOT TS DETAILS

PAGE #	TS#	INTERSECTION NAME	PAGE #	TS#	INTERSECTION NAME
19	65	IL 94/EDENS EXPY/ESTES @ IL 50/CICERO AVE	53	9190	IL 171/CUMBERLAND AVE @ TOUHY AVF
20	5835	TOUHY AVE @ KOSTNER AVE	54	9185	CUMBERLAND AVE @ TALCOTT AVE
21	5825	TOUHY AVE @ CRAWFORD AVE	55	9180	CUMBERLAND AVE @ GRANVILLE
22	5477	MCCORMICK BLVD @ NORTHEAST PKWY	56	5830	TOUHY AVE @ DEE RD
23	5047	US 41/LINCOLN @ FIRE STATION EXIT	57	5815	TALCOTT AVE @ TOUHY AVE
24	4916	CRAWFORD AVE @ DEVON AVE REMOVED	58	5810	DEE RD @ TALCOTT AVE
25	2625	IL 50/CICERO AVE @ TOUHY AVE	59	5535	OAKTON ST @ FLORENCE
26	2605	IL 50/CICERO AVE @ PRAIRI AVE	60	5510	NORTHWEST HWY @ POTTER RD
27	2590	IL 50/CICERO AVE @ DEVON AVE	61	5505	NORTHWEST HWY @ OAKTON ST
28	20395	MCCORMICK BLVD @ LINCOLNWOOD TOWN CENTER	62	4955	CUMBERLAND AVE @ DEVON AVE
29	20345	TOUHY AVE @ LINCOLNWOOD TOWN CENTER	63	4260	CANFIELD @ TALCOTT AVE
30	1617	IL 72/TOUHY AVE @ KILBOURNE AVE	64	4255	CANFIELD @ DEVON AVE
31	1610	US 41/LINCOLN @ PRATT	65	4245	BUSSE RD @ POTTER RD
32	1545	US 41/LINCOLN @ KOSTNER	66	4146	BALLARD RD @ NESSET RD
33	1505	US 41/LINCOLN @ DEVON AVE	67	4145	BALLARD RD @ DEE RD
34	1500	US 41/LINCOLN HWY @ CRAWFORD AVE REMOVED	68	4125	ALGONQUIN RD @ OAKTON ST
35	12090	TOUHY AVE @ BARCLAY PL/HYATT DR	69	3300	IL 72/HIGGINS RD @ CANFIELD RD
36	11185	DEVON AVE @ KENTON AVE/LEMOHT	70-72	3280	BUSSE HWY @ OAKTON ST
37	2435	IL 43/WAUKEGAN RD @ WINNETKA RD	73	22150	DEVON AVE @ GREENWOOD AVE
38	2406	IL 43/WAUKEGAN RD @ TECHN RD/FOUNDERS DR	74	1305	US 14/CALDWELL AVE @ TOUHY AVE
39	14485	WINNETKA RD @ HIBBARD	75	1275	US 14/DEMPSTER ST @ POTTER RD
40	14467	WILLOW RD @ LAGOON DR	76	1240	US 14/DEMPSTER ST @ LUTHER LN
41	9255	TOUHY AVE @ WASHINGTON ST	77	1213	US 14/DEMPSTER ST @ WESTERN AVE
42	9250	US 14/NORTHWEST HWY @ PROSPECT AVE	78	1210	US 14/DEMPSTER ST @ GREENWOOD AVE
43	9247	US 14/NORTHWEST HWY @ SUMMIT	79	1205	US 14/DEMPSTER ST @ DEE RD
44	9245	COURTLAND/TALCOTT AVE @ DEVON AVE	80	11695	US 14/NORTHWEST HWY @ ELM ST
45	9240	BUSSE HWY @ MEACHAM TOUHY AVE	81	5950	WOLF RD @ WILLOW/OLD WILLOW RD
46	9235	BUSSE HWY @ GREENWOOD AVE	82	5944	WOLF RD @ EDWARD RD
47	9230	TOUHY AVE @ WESTERN AVE	83	419	US 12/RAND RD @ OLIVE
48	9222	TOUHY AVE @ SUMMIT	84	3540	IL 83/ELMHURST RD @ WILLOW RD
49	9220	NORTHWEST HWY @ WASHINGTON ST	85-86	3485	IL 83/ELMHURST RD @ PALATINE RD
50	9215	NORTHWEST HWY @ MEACHAM AVE	87	1745	US 45-IL 21/MILWAUKEE AVE @ PALATINE SOUTH RAMP
51	9210	GREENWOOD AVE @ TOUHY AVE	88	1740	US 45-IL 21/MILWAUKEE AVE @ PALATINE NORTH RAMP
52	9205	GREENWOOD AVE @ TALCOTT AVE			

FOR TS 5505 LOCATION, DUE TO THE PRESENCE OF A RED LIGHT RUNNING (RLR) CAMERA WITHIN THE PROJECT LIMITS, CONTRACTOR SHALL NOTIFY THE CITY OF PARK RIDGE AND RED SPEED, LLC PRIOR TO THE START OF CONSTRUCTION. THE CITY OF PARK RIDGE AND RED SPEED, LLC SHALL MAKE THE RLR CAMERA INOPERATIVE FOR THE TIME OF CONSTRUCTION. ANY RLR CAMERA EQUIPMENT THAT IS IN CONFLICT WITH THE PROPOSED CONSTRUCTION SHALL BE REMOVED BY ITS RESPECTIVE OWNERS PRIOR TO THE START OF CONSTRUCTION.

CITY OF PARK RIDGE 505 BUTLER PLACE PARK RIDGE, IL 60068-4182 (847) 318-5200	RED SPEED, LLC. 400 EISENHOWER LANE LOMBARD, ILLINOIS 60148
---	---

FOR TS 1745 LOCATION, DUE TO THE PRESENCE OF A RED LIGHT RUNNING (RLR) CAMERA WITHIN THE PROJECT LIMITS, CONTRACTOR SHALL NOTIFY THE CITY OF PROSPECT HEIGHTS PRIOR TO THE START OF CONSTRUCTION. THE CITY OF PROSPECT HEIGHTS SHALL MAKE THE RLR CAMERA INOPERATIVE FOR THE TIME OF CONSTRUCTION. ANY RLR CAMERA EQUIPMENT THAT IS IN CONFLICT WITH THE PROPOSED CONSTRUCTION SHALL BE REMOVED BY ITS RESPECTIVE OWNERS PRIOR TO THE START OF CONSTRUCTION.

CITY OF PROSPECT HEIGHTS
8 N. ELMHURST ROAD
PROSPECT HEIGHTS, IL 60070
(847) 398-6070

GENERAL NOTES

ALL CONSTRUCTION SHALL CONFORM TO THE STANDARD SPECIFICATIONS FOR ROAD AND BRIDGE CONSTRUCTION (SSRBC), AND SUPPLEMENTAL SPECIFICATIONS AND RECURRING SPECIAL PROVISIONS, ADOPTED JANUARY 1, 2014 BY THE ILLINOIS DEPARTMENT OF TRANSPORTATION AND ALL AMENDMENTS THERETO; IN CASE OF CONFLICT, THE MORE RESTRICTIVE PROVISIONS SHALL APPLY. ANY REFERENCE TO STANDARDS IN THE PLANS OR SPECIAL PROVISIONS SHALL BE INTERPRETED TO BE THE LATEST STANDARDS OF THE DEPARTMENT.

THE CONTRACTOR SHALL CHECK THE PROPOSED TRAFFIC SIGNAL EQUIPMENT LOCATIONS FOR OVERHEAD UTILITY CONFLICTS. THE CONTRACTOR SHALL COORDINATE ANY CONFLICTS WITH THE UTILITY COMPANIES AND THE RESIDENT ENGINEER BEFORE ORDERING MATERIALS.

THE CONTRACTOR SHALL COORDINATE CONSTRUCTION ACTIVITIES WITH UTILITY COMPANIES, LOCAL GOVERNMENT AGENCIES, AND IDOT.

THE CONTRACTOR WILL NOT BE ALLOWED TO SET UP A YARD OR FIELD OFFICE ON STATE PROPERTY WITHOUT WRITTEN PERMISSION FROM THE DEPARTMENT.

WHENEVER, DURING CONSTRUCTION OPERATIONS, ANY LOOSE MATERIAL IS DEPOSITED IN THE FLOW LINE OF CUTTERS, DRAINAGE STRUCTURES, DITCHES, ETC. SUCH THAT THE NATURAL FLOW LINE OF WATER IS OBSTRUCTED, THE LOOSE MATERIAL WILL BE REMOVED AT THE CLOSE OF EACH WORKING DAY, AT THE CONCLUSION OF CONSTRUCTION OPERATIONS. ALL DRAINAGE STRUCTURES AND FLOW LINES SHALL BE FREE FROM DIRT AND DEBRIS. THIS WORK SHALL BE CONSIDERED INCIDENTAL TO THE CONTRACT. THE CONTRACTOR'S FAILURE TO PROVIDE THE ABOVE WILL PRECLUDE ANY POSSIBLE ADDED COMPENSATION REQUESTED DUE TO DELAYS OF UNSUITABLE MATERIALS CREATED AS A RESULT THEREOF.

THE CONTRACTOR SHALL NOTIFY THE IDOT ARTERIAL TRAFFIC CONTROL SUPERVISOR AT (847) 705-4470 A MINIMUM OF 72 HOURS IN ADVANCE OF BEGINNING WORK.

THE CONTRACTOR SHALL SOLELY BE RESPONSIBLE FOR THE INSTALLATION AND MAINTENANCE OF ADEQUATE SIGNS, TRAFFIC CONTROL DEVICES, AND WARNING DEVICES TO INFORM AND PROTECT THE PUBLIC DURING ALL PHASES OF CONSTRUCTION.

THE CONTRACTOR SHALL BE REQUIRED TO PROVIDE ACCESS TO ADJUTING PROPERTY AT ALL TIMES DURING THE CONSTRUCTION OF THIS PROJECT OR THE DIRECTION OF THE ENGINEER.

THE CONTRACTOR IS RESPONSIBLE FOR RETURNING ALL AREAS AFFECTED BY EQUIPMENT OR LABORERS TO EXISTING CONDITIONS. THE CONTRACTOR IS ALSO RESPONSIBLE FOR PROTECTING ALL NEW WORK UNTIL COMPLETION OF THIS CONTRACT.

RESTORATION OF WORK AREA: RESTORATION OF THE TRAFFIC SIGNAL WORK AREA SHALL BE INCIDENTAL TO THE RELATED PAY ITEM SUCH AS SIGNAL POST, UNINTERRUPTIBLE POWER SUPPLY ETC. AND NO EXTRA COMPENSATION SHALL BE ALLOWED. ALL ROADWAY SURFACES SUCH AS SHOULDERS, MEDIANS, SIDEWALKS, PAVEMENT, ETC. SHALL BE REPLACED IN KIND. ALL DAMAGE TO MOWED LAWNS SHALL BE REPLACED WITH AN APPROVED SOD IN ACCORDANCE TO STANDARD SPECIFICATIONS ARTICLE 252 WHICH SHALL INCLUDE THE REQUIRED WATERING PER ARTICLE 252.08. ALL DAMAGE TO UNMOWED FIELDS SHALL BE SEEDED IN ACCORDANCE WITH STANDARD SPECIFICATIONS ARTICLE 250 AND 251, RESPECTIVELY.

IT SHALL BE THE CONTRACTOR'S RESPONSIBILITY TO VERIFY ALL DIMENSIONS AND CONDITIONS EXISTING IN THE FIELD PRIOR TO ORDERING MATERIALS AND BEGINNING CONSTRUCTION.

THE EXACT LOCATION OF ALL UTILITIES SHALL BE FIELD VERIFIED BY THE CONTRACTOR BEFORE ORDERING ANY MATERIALS AND STARTING ANY WORK. FOR LOCATIONS OF UTILITIES, LOCALLY OWNED EQUIPMENT, LEASED ENFORCEMENT CAMERA SYSTEM FACILITIES, AND IDOT UNDERGROUND FACILITIES, CONTACT THE LOCAL COUNTIES, MUNICIPALITIES, AND IDOT FOR LOCATES. THE CONTRACTOR SHALL CALL 'JULIE' AT (800)892-0123 OR 811. IN THE CITY OF CHICAGO CONTACT DIGGER AT (312)744-7000 FOR FIELD LOCATIONS OF BURIED UTILITIES (48 HOURS NOTIFICATION REQUIRED).

AT LOCATIONS ON THE PLANS WHERE TRAFFIC SIGNAL POST REMOVAL AND NEW TRAFFIC SIGNAL POST INSTALLATIONS ARE SPECIFIED, THE CONTRACTOR SHALL INSPECT THE EXISTING POST FOUNDATIONS. PRIOR TO REMOVING THE EXISTING TRAFFIC SIGNAL POST TO BE REPLACED, THE CONTRACTOR SHALL VERIFY THAT THE PATTERN, SPACING, AND CONDITION OF THE EXISTING ANCHOR BOLT IS ACCEPTABLE FOR REUSE WITH A NEW POST. IF THE EXISTING ANCHOR BOLT CONDITION IS NOT ACCEPTABLE, THE CONTRACTOR SHALL REPLACE ANCHOR BOLT AS DIRECTED BY THE ENGINEER. ANCHOR BOLT REPLACEMENT WILL BE PAID FOR AS "REMOVE AND REPLACE ANCHOR BOLTS". "REMOVE AND REPLACE ANCHOR BOLTS" PAY ITEM QUANTITIES SHOWN ARE NOMINAL AND ONLY TO BE UTILIZED AS APPROVED BY THE ENGINEER.

THE CONTRACTOR SHALL RELOCATE ANY EXISTING SIGN PANELS, INCLUDING BLANK OUT SIGNS, FROM PAINTED POSTS THAT ARE INDICATED FOR REPLACEMENT TO A NEW POST AS SHOWN ON THE PLANS OR AS DIRECTED BY THE ENGINEER. THE COST OF REMOVAL, RELOCATION, AND ANY NEW MOUNTING HARDWARE NECESSARY TO COMPLETE THIS WORK SHALL BE INCLUDED IN THE PAY ITEM OF THE LENGTH AS SPECIFIED IN THE PLANS.

CONTRACTOR SHALL REPLACE METAL MOUNTING BRACKETS AT ALL RETROFIT SIGNAL HEADS WITH NEW POLYCARBONATE BRACKETS OR AS DIRECTED BY THE ENGINEER. THE COST OF THIS WORK SHALL BE INCLUDED IN THE CORRESPONDING SIGNAL HEAD, LED, RETROFIT PAY ITEM OF THE TYPE AND NUMBER OF SIGNAL HEADS, FACES, AND SECTIONS AS SPECIFIED IN THE PLANS.

PARTIAL PAYMENT AS DESCRIBED IN ARTICLE 109.07(b) OF THE STANDARD SPECIFICATIONS WILL NOT BE ALLOWED FOR ITEMS INCLUDED IN THIS CONTRACT.

A CONCRETE APRON SHALL NOT BE REQUIRED FOR NEW UPS INSTALLATIONS ADJACENT TO EXISTING IMPERVIOUS SURFACES THAT SATISFY THE NEED OF THE CONCRETE APRON, AS DIRECTED BY THE ENGINEER.

FILE NAME: C:\G082-shr-gennote.dgn	USER NAME: SJohnson	DESIGNED - BKS	REVISED - BKS 5-12-2014 1	STATE OF ILLINOIS DEPARTMENT OF TRANSPORTATION	INDEX OF SHEETS AND GENERAL NOTES				F.A. RTE.	SECTION	COUNTY	TOTAL SHEETS	SHEET NO.
Default	PL01 SCALE: 1/4" = 1'-0"	DRAWN - SVJ	REVISED -		SCALE:	SHEET	OF	SHEETS	STA.	TO	STA.	88	2
	PL01 DATE: 5/14/2014	CHECKED - BKS	REVISED -		CONTRACT NO. 60X82								
		DATE -	REVISED -		ILLINOIS FED. AID PROJECT								

LOC # TS # INTERSECTION

1	TS 65	I 94/EDENS EXPY/ESTES @ IL 50/CICERO AVE
2	TS 5835	TOUHY AVE @ KOSTNER AVE
3	TS 5825	TOUHY AVE @ CRAWFORD AVE
4	TS 5477	MCCORMICK BLVD @ NORTHEAST PKWY
5	-	NOT USED
6	TS 5047	US 41/LINCOLN @ FIRE STATION EXIT
7	TS 1010	CRAWFORD AVE @ DEVON AVE REMOVED
8	TS 2625	IL 50/CICERO AVE @ TOUHY AVE
9	TS 2605	IL 50/CICERO AVE @ PRATT AVE
10	TS 2590	IL 50/CICERO AVE @ DEVON AVE
11	TS 20395	MCCORMICK BLVD @ LINCOLNWOOD TOWN CENTER
12	TS 20345	TOUHY AVE @ LINCOLNWOOD TOWN CENTER
13	TS 20341	TOUHY AVE @ LAWNSDALE AVE
14	TS 1617	IL 72/TOUHY AVE @ KILBOURNE AVE
15	TS 1610	US 41/LINCOLN @ PRATT
16	TS 1545	US 41/LINCOLN @ KOSTNER
17	TS 1505	US 41/LINCOLN @ DEVON AVE
18	TS 1500	US 41/LINCOLN HWY @ CRAWFORD AVE REMOVED
19	TS 12090	TOUHY AVE @ BARCLAY PL/HYATT DR
20	TS 11185	DEVON AVE @ KENTON AVE/LEMONT
21	TS 2435	IL 43/WAUKEGAN RD @ WINNETKA RD
22	TS 2406	IL 43/WAUKEGAN RD @ TECHN Y RD/FOUNDERS DR
23	TS 14485	WINNETKA RD @ HIBBARD
24	TS 14467	WILLOW RD @ LAGOON DR
25	TS 9255	TOUHY AVE @ WASHINGTON ST
26	TS 9250	US 14/NORTHWEST HWY @ PROSPECT AVE
27	TS 9247	US 14/NORTHWEST HWY @ SUMMIT
28	TS 9245	COURTLAND/TALCOTT AVE @ DEVON AVE
29	TS 9240	BUSSE HWY @ TOUHY AVE
30	TS 9235	BUSSE HWY @ GREENWOOD AVE
31	TS 9230	TOUHY AVE @ WESTERN AVE
32	TS 9222	TOUHY AVE @ SUMMIT
33	TS 9220	NORTHWEST HWY @ WASHINGTON ST
34	TS 9215	NORTHWEST HWY @ MEACHAM AVE
35	TS 9210	GREENWOOD @ TOUHY
36	TS 9205	GREENWOOD AVE @ TALCOTT AVE
37	TS 9190	IL 171/CUMBERLAND AVE @ TOUHY AVE
38	TS 9185	CUMBERLAND AVE @ TALCOTT AVE
39	TS 9180	CUMBERLAND AVE @ GRANVILLE
40	TS 5830	TOUHY AVE @ DEE RD
41	TS 5815	TALCOTT AVE @ TOUHY AVE
42	TS 5810	DEE RD @ TALCOTT AVE
43	TS 5535	OAKTON ST @ FLORENCE
44	TS 5510	NORTHWEST HWY @ POTTER RD
45	TS 5505	NORTHWEST HWY @ OAKTON ST
46	TS 4955	CUMBERLAND AVE @ DEVON AVE
47	TS 4260	CANFIELD @ TALCOTT AVE
48	TS 4255	CANFIELD @ DEVON AVE
49	TS 4245	BUSSE RD @ POTTER RD
50	TS 4146	BALLARD RD @ NESSET RD
51	TS 4145	BALLARD RD @ DEE RD
52	TS 4125	ALGONQUIN RD @ OAKTON ST
53	TS 3300	IL 72/HIGGINS RD @ CANFIELD RD
54	TS 3280	BUSSE HWY @ OAKTON ST
55	TS 22150	DEVON AVE @ GREENWOOD AVE
56	TS 1305	US 14/CALDWELL AVE @ TOUHY AVE
57	TS 1275	US 14/DEMPSTER ST @ POTTER RD
58	TS 1240	US 14/DEMPSTER ST @ LUTHER LN
59	TS 1210	US 14/DEMPSTER ST @ GREENWOOD AVE
60	TS 1205	US 14/DEMPSTER ST @ DEE RD
61	TS 11695	US 14/ NORTHWEST HWY @ ELM ST
62	TS 5950	WOLF RD @ WILLOW/OLD WILLOW RD
63	TS 5944	WOLF RD @ EDWARD RD
64	TS 419	US 12/RAND RD @ OLIVE
65	TS 3540	IL 83/ELMHURST RD @ WILLOW RD
66	TS 3485	IL 83/ELMHURST RD @ PALATINE RD
67	TS 1745	US 45-IL 21/MILWAUKEE AVE @ PALATINE SOUTH RAMP
68	TS 1740	US 45-IL 21/MILWAUKEE AVE @ PALATINE NORTH RAMP

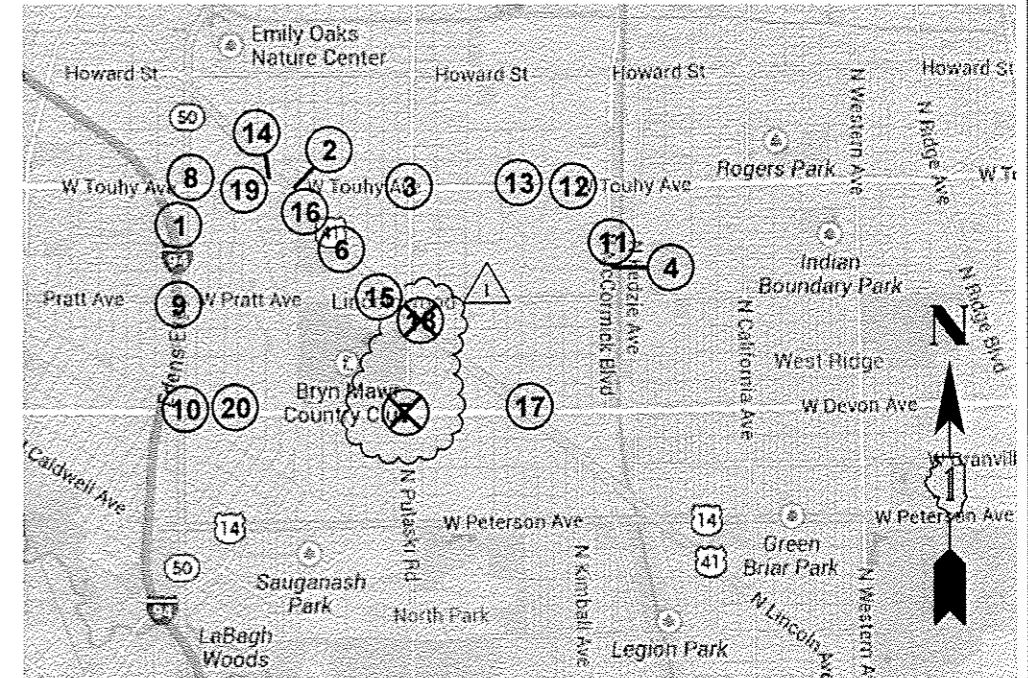
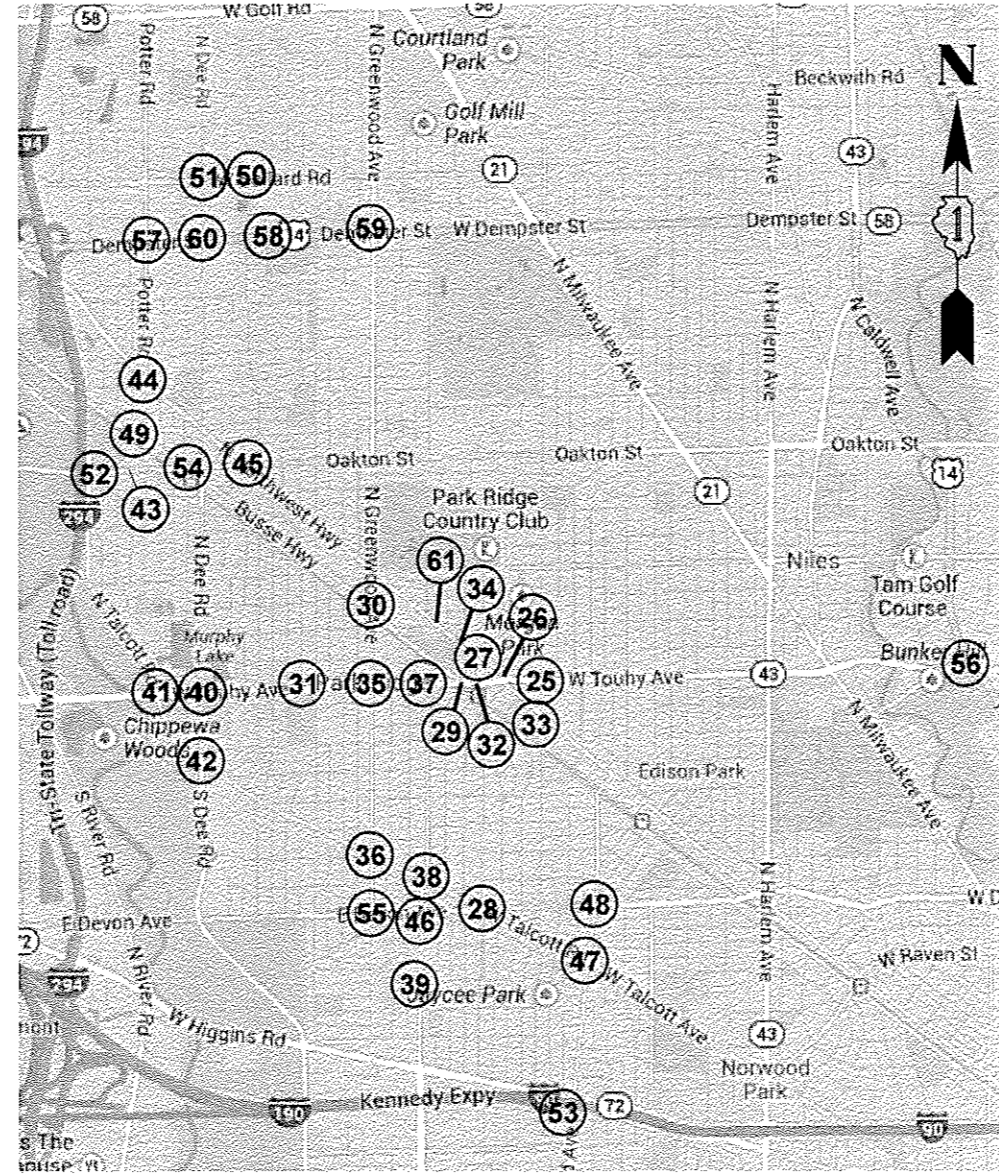

FILE NAME G:\68\82-111-100\mopl.dgn	USER NAME S.Johnson	DESIGNED - WBL	REVISED - BKS 5-12-2014
Default	PLOT SCALE 40,000.00 / 1 in.	CHECKED - BKS	REVISED -
	PLOT DATE 5/14/2014	DATE	REVISED -

STATE OF ILLINOIS
DEPARTMENT OF TRANSPORTATION

LOCATION MAP

SCALE: SHEET OF SHEETS STA. TO STA.

F.A. RTE.	SECTION	COUNTY	TOTAL SHEETS	SHEET NO.
	2014-007TS	COOK	88	3
CONTRACT NO. 60X82				
ILLINOIS FED. AID PROJECT				

LOC # IS # INTERSECTION

1	TS 65	I 94/EDENS EXPY/ESTES @ IL 50/CICERO AVE
2	TS 5835	TOUHY AVE @ KOSTNER AVE
3	TS 5825	TOUHY AVE @ CRAWFORD AVE
4	TS 5477	MCCORMICK BLVD @ NORTHEAST PKWY
5	-	NOT USED
6	TS 5047	US 41/LINCOLN @ FIRE STATION EXIT
7	TS 4010	CRAWFORD AVE @ DEVON AVE REMOVED
8	TS 2625	IL 50/CICERO AVE @ TOUHY AVE
9	TS 2605	IL 50/CICERO AVE @ PRATT AVE
10	TS 2590	IL 50/CICERO AVE @ DEVON AVE
11	TS 20395	MCCORMICK BLVD @ LINCOLNWOOD TOWN CENTER
12	TS 20345	TOUHY AVE @ LINCOLNWOOD TOWN CENTER
13	TS 20341	TOUHY AVE @ LAWNSDALE AVE
14	TS 1617	IL 72/TOUHY AVE @ KILBOURNE AVE
15	TS 1610	US 41/LINCOLN @ PRATT
16	TS 1545	US 41/LINCOLN @ KOSTNER
17	TS 1505	US 41/LINCOLN @ DEVON AVE
18	TS 1690	US 41/LINCOLN HWY @ CRAWFORD AVE REMOVED
19	TS 12090	TOUHY AVE @ BARCLAY PL/HYATT DR
20	TS 11185	DEVON AVE @ KENTON AVE/LEMONT
21	TS 2435	IL 43/WAUKEGAN RD @ WINNETKA RD
22	TS 2406	IL 43/WAUKEGAN RD @ TECHN Y RD/FOUNDERS DR
23	TS 14485	WINNETKA RD @ HIBBARD
24	TS 14467	WILLOW RD @ LAGOON DR
25	TS 9255	TOUHY AVE @ WASHINGTON ST
26	TS 9250	US 14/NORTHWEST HWY @ PROSPECT AVE
27	TS 9247	US 14/NORTHWEST HWY @ SUMMIT
28	TS 9245	COURTLAND/TALCOTT AVE @ DEVON AVE
29	TS 9240	BUSSE HWY @ TOUHY AVE
30	TS 9235	BUSSE HWY @ GREENWOOD AVE
31	TS 9230	TOUHY AVE @ WESTERN AVE
32	TS 9222	TOUHY AVE @ SUMMIT
33	TS 9220	NORTHWEST HWY @ WASHINGTON ST
34	TS 9215	NORTHWEST HWY @ MEACHAM AVE
35	TS 9210	GREENWOOD @ TOUHY
36	TS 9205	GREENWOOD AVE @ TALCOTT AVE
37	TS 9190	IL 171/CUMBERLAND AVE @ TOUHY AVE
38	TS 9185	CUMBERLAND AVE @ TALCOTT AVE
39	TS 9180	CUMBERLAND AVE @ GRANVILLE
40	TS 5830	TOUHY AVE @ DEE RD
41	TS 5815	TALCOTT AVE @ TOUHY AVE
42	TS 5810	DEE RD @ TALCOTT AVE
43	TS 5535	OAKTON ST @ FLORENCE
44	TS 5510	NORTHWEST HWY @ POTTER RD
45	TS 5505	NORTHWEST HWY @ OAKTON ST
46	TS 4955	CUMBERLAND AVE @ DEVON AVE
47	TS 4260	CANFIELD @ TALCOTT AVE
48	TS 4255	CANFIELD @ DEVON AVE
49	TS 4245	BUSSE RD @ POTTER RD
50	TS 4146	BALLARD RD @ NESSET RD
51	TS 4145	BALLARD RD @ DEE RD
52	TS 4125	ALGONQUIN RD @ OAKTON ST
53	TS 3300	IL 72/HIGGINS RD @ CANFIELD RD
54	TS 3280	BUSSE HWY @ OAKTON ST
55	TS 22150	DEVON AVE @ GREENWOOD AVE
56	TS 1305	US 14/CALDWELL AVE @ TOUHY AVE
57	TS 1275	US 14/DEMPSTER ST @ POTTER RD
58	TS 1240	US 14/DEMPSTER ST @ LUTHER LN
59	TS 1210	US 14/DEMPSTER ST @ GREENWOOD AVE
60	TS 1205	US 14/DEMPSTER ST @ DEE RD
61	TS 11695	US 14/ NORTHWEST HWY @ ELM ST
62	TS 5950	WOLF RD @ WILLOW/OLD WILLOW RD
63	TS 5944	WOLF RD @ EDWARD RD
64	TS 419	US 12/RAND RD @ OLIVE
65	TS 3540	IL 83/ELMHURST RD @ WILLOW RD
66	TS 3485	IL 83/ELMHURST RD @ PALATINE RD
67	TS 1745	US 45-IL 21/MILWAUKEE AVE @ PALATINE SOUTH RAMP
68	TS 1740	US 45-IL 21/MILWAUKEE AVE @ PALATINE NORTH RAMP

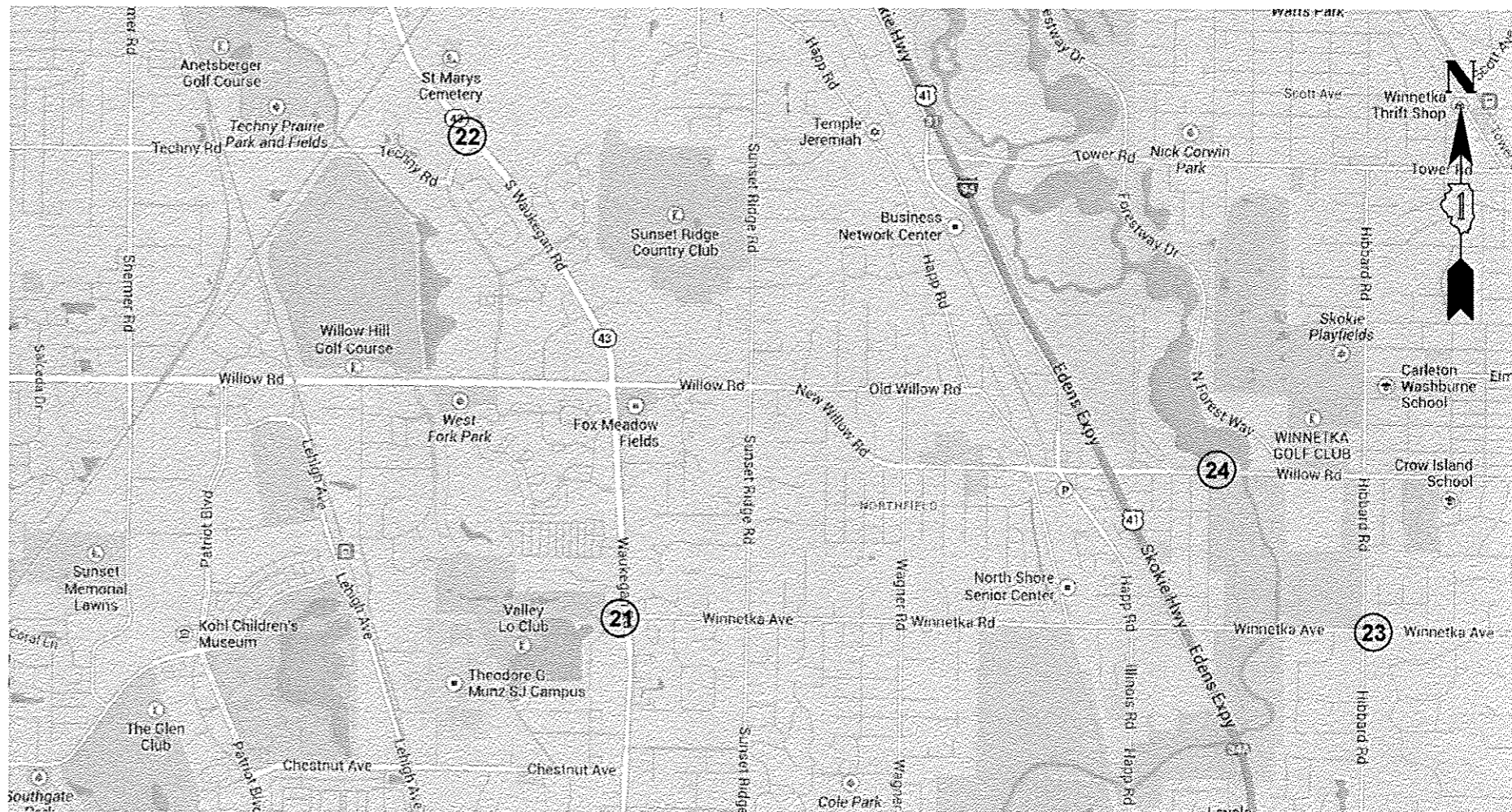

FILE NAME : C:\60x82-sh-1-locmap2.dgn
 Default

USER NAME : SJohnson
 PLOT SCALE : 40.0000 / 1 in.
 PLOT DATE : 5/14/2014

DESIGNED	-	WBL
DRAWN	-	WBL
CHECKED	-	BKS
DATE	-	
REVISED	-	BKS 5-12-2014
REVISED	-	
REVISED	-	
REVISED	-	

STATE OF ILLINOIS
 DEPARTMENT OF TRANSPORTATION

LOCATION MAP

SCALE: SHEET OF SHEETS STA. TO STA.

F.A. RTE.	SECTION	COUNTY	TOTAL SHEETS	SHEET NO.
	2014-007TS	COOK	88	4
CONTRACT NO. 60X82				
ILLINOIS FED. AID PROJECT				

LOC # TS # INTERSECTION

1	TS 65	I 94/EDENS EXPY/ESTES @ IL 50/CICERO AVE
2	TS 5835	TOUHY AVE @ KOSTNER AVE
3	TS 5825	TOUHY AVE @ CRAWFORD AVE
4	TS 5477	MCCORMICK BLVD @ NORTHEAST PKWY
5	-	NOT USED
6	TS 5047	US 41/LINCOLN @ FIRE STATION EXIT
7	TS 1010	CRAWFORD AVE @ DEVON AVE REMOVED
8	TS 2625	IL 50/CICERO AVE @ TOUHY AVE
9	TS 2605	IL 50/CICERO AVE @ PRATT AVE
10	TS 2590	IL 50/CICERO AVE @ DEVON AVE
11	TS 20395	MCCORMICK BLVD @ LINCOLNWOOD TOWN CENTER
12	TS 20345	TOUHY AVE @ LINCOLNWOOD TOWN CENTER
13	TS 20341	TOUHY AVE @ LAWDALE AVE
14	TS 1617	IL 72/TOUHY AVE @ KILBOURNE AVE
15	TS 1610	US 41/LINCOLN @ PRATT
16	TS 1545	US 41/LINCOLN @ KOSTNER
17	TS 1505	US 41/LINCOLN @ DEVON AVE
18	TS 1600	US 41/LINCOLN HWY @ CRAWFORD AVE REMOVED
19	TS 12090	TOUHY AVE @ BARCLAY PL/HYATT DR
20	TS 11185	DEVON AVE @ KENTON AVE/LEMONT
21	TS 2435	IL 43/WAUKEGAN RD @ WINNETKA RD
22	TS 2406	IL 43/WAUKEGAN RD @ TECHN Y RD/FOUNDERS DR
23	TS 14485	WINNETKA RD @ HIBBARD
24	TS 14467	WILLOW RD @ LAGOON DR
25	TS 9255	TOUHY AVE @ WASHINGTON ST
26	TS 9250	US 14/NORTHWEST HWY @ PROSPECT AVE
27	TS 9247	US 14/NORTHWEST HWY @ SUMMIT
28	TS 9245	COURTLAND/TALCOTT AVE @ DEVON AVE
29	TS 9240	BUSSE HWY @ TOUHY AVE
30	TS 9235	BUSSE HWY @ GREENWOOD AVE
31	TS 9230	TOUHY AVE @ WESTERN AVE
32	TS 9222	TOUHY AVE @ SUMMIT
33	TS 9220	NORTHWEST HWY @ WASHINGTON ST
34	TS 9215	NORTHWEST HWY @ MEACHAM AVE
35	TS 9210	GREENWOOD @ TOUHY
36	TS 9205	GREENWOOD AVE @ TALCOTT AVE
37	TS 9190	IL 171/CUMBERLAND AVE @ TOUHY AVE
38	TS 9185	CUMBERLAND AVE @ TALCOTT AVE
39	TS 9180	CUMBERLAND AVE @ GRANVILLE
40	TS 5830	TOUHY AVE @ DEE RD
41	TS 5815	TALCOTT AVE @ TOUHY AVE
42	TS 5810	DEE RD @ TALCOTT AVE
43	TS 5535	OAKTON ST @ FLORENCE
44	TS 5510	NORTHWEST HWY @ POTTER RD
45	TS 5505	NORTHWEST HWY @ OAKTON ST
46	TS 4955	CUMBERLAND AVE @ DEVON AVE
47	TS 4260	CANFIELD @ TALCOTT AVE
48	TS 4255	CANFIELD @ DEVON AVE
49	TS 4245	BUSSE RD @ POTTER RD
50	TS 4146	BALLARD RD @ NESSET RD
51	TS 4145	BALLARD RD @ DEE RD
52	TS 4125	ALGONQUIN RD @ OAKTON ST
53	TS 3300	IL 72/HIGGINS RD @ CANFIELD RD
54	TS 3280	BUSSE HWY @ OAKTON ST
55	TS 22150	DEVON AVE @ GREENWOOD AVE
56	TS 1305	US 14/CALDWELL AVE @ TOUHY AVE
57	TS 1275	US 14/DEMPSTER ST @ POTTER RD
58	TS 1240	US 14/DEMPSTER ST @ LUTHER LN
59	TS 1210	US 14/DEMPSTER ST @ GREENWOOD AVE
60	TS 1205	US 14/DEMPSTER ST @ DEE RD
61	TS 11695	US 14/ NORTHWEST HWY @ ELM ST
62	TS 5950	WOLF RD @ WILLOW/OLD WILLOW RD
63	TS 5944	WOLF RD @ EDWARD RD
64	TS 419	US 12/RAND RD @ OLIVE
65	TS 3540	IL 83/ELMHURST RD @ WILLOW RD
66	TS 3485	IL 83/ELMHURST RD @ PALATINE RD
67	TS 1745	US 45-IL 21/MILWAUKEE AVE @ PALATINE SOUTH RAMP
68	TS 1740	US 45-IL 21/MILWAUKEE AVE @ PALATINE NORTH RAMP

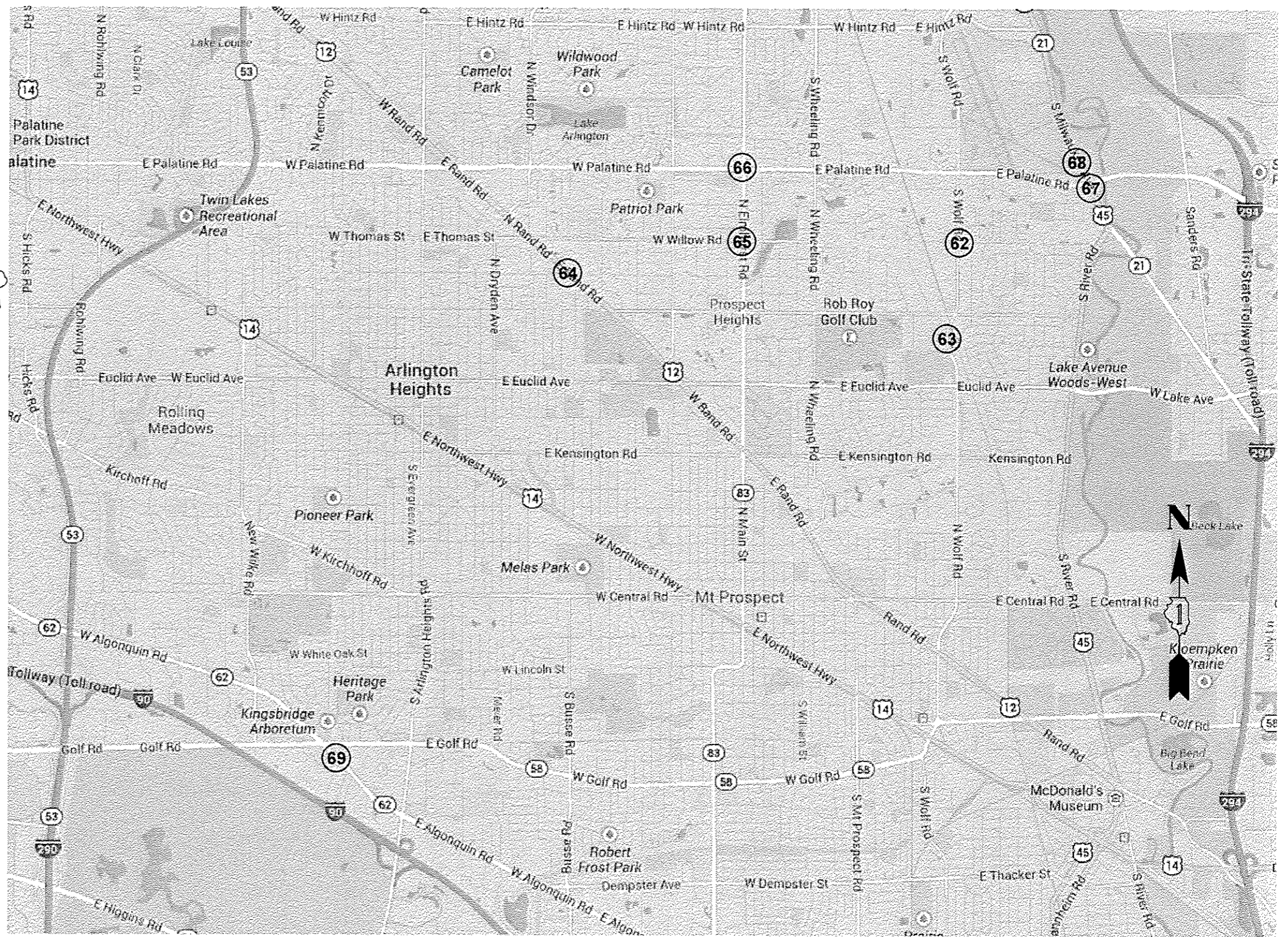

FILE NAME :
D:\60X82-sh1-lacmep3.dgn
Default

USER NAME : SJohnson
DESIGNED - WBL
DRAWN - WBL
CHECKED - BKS
DATE -

REVISIONS:
REVISED - BKS 5-12-2014
REVISED -
REVISED -
REVISED -

STATE OF ILLINOIS
DEPARTMENT OF TRANSPORTATION

LOCATION MAP

SCALE: SHEET OF SHEETS STA. TO STA.

F.A. RTE.	SECTION	COUNTY	TOTAL SHEETS	SHEET NO.
	2014-007TS	COOK	88	5
CONTRACT NO. 60X82				
ILLINOIS FED. AID PROJECT				

SUMMARY OF QUANTITIES HEADING LEGEND

COLUMN NUMBER	TS#	INTERSECTION	FUNDING PARTICIPATION							
			STATE	LINCOLNWOOD	NORTHFIELD	CLENVIEW	NORTHBROOK	WINNETKA	PROSPECT HEIGHTS	
1	65	I 94/EDENS EXPY/ESTES @ IL 50/CICERO AVE	100.0%							
2	5835	TOUHY AVE @ KOSTNER AVE	95.0%	5.0%						
1	5825	TOUHY AVE @ CRAWFORD AVE	100.0%							
3	5477	MCCORMICK BLVD @ NORTHEAST PKWY	96.7%	3.3%						
3	5047	US 41/LINCOLN @ FIRE STATION EXIT	96.7%	3.3%						
1	4910	CRAWFORD AVE @ DEVON AVE	100.0%							
1	2625	IL 50/CICERO AVE @ TOUHY AVE	100.0%							
2	2605	IL 50/CICERO AVE @ PRATT AVE	95.0%	5.0%						
1	2590	IL 50/CICERO AVE @ DEVON AVE	100.0%							
4	20395	MCCORMICK BLVD @ LINCOLNWOOD TOWN CENTER	96.7%						3.3%	
4	20345	TOUHY AVE @ LINCOLNWOOD TOWN CENTER	96.7%						3.3%	
2	1617	IL 72/TOUHY AVE @ KILBOURNE AVE	95.0%	5.0%						
2	1610	US 41/LINCOLN @ PRATT	95.0%	5.0%						
2	1545	US 41/LINCOLN @ KOSTNER	95.0%	5.0%						
1	1505	US 41/LINCOLN @ DEVON AVE	100.0%							
1	1500	US 41/LINCOLN HWY @ CRAWFORD AVE	100.0%							
2	12090	TOUHY AVE @ BARCLAY PL/HYATT DR	95.0%	5.0%						
5	11185	DEVON AVE @ KENTON AVE/LEMDNT	97.5%	2.5%						
6	2435	IL 43/WAUKEGAN RD @ WINNETKA RD	97.5%			2.5%				
7	2406	IL 43/WAUKEGAN RD @ TECHNY RD/FOUNDERS DR	95.0%				5.0%			
8	14485	WINNETKA RD @ HIBBARD	95.0%					5.0%		
9	14467	WILLOW RD @ LAGOON DR	96.7%		3.3%					
10	5950	WOLF RD @ WILLOW/OLD WILLOW RD	95.0%					5.0%		
10	5944	WOLF RD @ EDWARD RD	95.0%					5.0%		
10	419	US 12/RAND RD @ OLIVE	95.0%					5.0%		
1	3540	IL 83/ ELMHURST RD @ WILLOW RD	100.0%							
1	3485	IL 83/ELMHURST RD @ PALATINE RD	100.0%							
1	1745	US 45-IL 21 MILWAUKEE AVE @ PALATINE SOUTH RAMP	100.0%							
1	1740	US 45-IL 21/MILWAUKEE AVE @ PALATINE NORTH RAMP	100.0%							
1	5505	NORTHWEST HWY @ OAKTON ST	100.0%							
1	4955	CUMBERLAND AVE @ DEVON AVE	100.0%							
1	4260	CANFIELD @ TALCOTT AVE	100.0%							
1	4255	CANFIELD @ DEVON AVE	100.0%							

LINCOLNWOOD TOWN CENTER LLC

SUMMARY OF QUANTITIES HEADING LEGEND

COLUMN NUMBER	TS#	INTERSECTION	FUNDING PARTICIPATION			
			STATE	PARK RIDGE	LUTHERAN GENERAL HOSPITAL	MAIN TOWNSHIP
11	9255	TOUHY AVE @ WASHINGTON ST	95.0%	5.0%		
12	9250	US 14/ NORTHWEST HWY @ PROSPECT AVE	96.0%	4.0%		
13	9247	US 14/ NORTHWEST HWY @ SUMMIT	96.7%	3.3%		
12	9245	COURTLAND/TALCOTT AVE @ DEVON AVE	96.0%	4.0%		
1	9240	BUSSE HWY @ TOUHY AVE	100.0%			
11	9235	BUSSE HWY @ GREENWOOD AVE	95.0%	5.0%		
11	9230	TOUHY AVE @ WESTERN AVE	95.0%	5.0%		
11	9222	TOUHY AVE @ SUMMIT	95.0%	5.0%		
14	9220	NORTHWEST HWY @ WASHINGTON ST	94.0%	6.0%		
14	9215	NORTHWEST HWY @ MEACHAM AVE	94.0%	6.0%		
11	9210	GREENWOOD @ TOUHY	95.0%	5.0%		
11	9205	GREENWOOD AVE @ TALCOTT AVE	95.0%	5.0%		
11	9190	IL 171 CUMBERLAND AVE @ TOUHY AVE	95.0%	5.0%		
1	9185	CUMBERLAND AVE @ TALCOTT AVE	100.0%			
11	9180	CUMBERLAND AVE @ GRANVILLE	95.0%	5.0%		
11	5830	TOUHY AVE @ DEE RD	95.0%	5.0%		
1	5815	TALCOTT AVE @ TOUHY AVE	100.0%			
11	5810	DEE RD @ TALCOTT AVE	95.0%	5.0%		
13	5535	OAKTON ST @ FLORENCE	96.7%	3.3%		
11	5510	NORTHWEST HWY @ POTTER RD	95.0%	5.0%		
13	4245	BUSSE RD @ POTTER RD	96.7%	3.3%		
13	4146	BALLARD RD @ NESSET RD	96.7%	3.3%		
15	4145	BALLARD RD @ DEE RD	95.0%			5.0%
1	4125	ALCONQUIN RD @ OAKTON ST	100.0%			
1	3300	IL 72/HIGGINS RD @ CANFIELD RD	100.0%			
1	3280	BUSSE HWY @ OAKTON ST	100.0%			
11	22150	DEVON AVE @ GREENWOOD AVE	95.0%	5.0%		
1	1305	US 14/CALDWELL AVE @ TOUHY AVE	100.0%			
16	1275	US 14/DEMPSTER ST @ POTTER RD	97.5%	2.5%		
17	1240	US 14/ DEMPSTER ST @ LUTHER LN	95.0%	2.5%	2.5%	
1	1210	US 14/DEMPSTER ST @ GREENWOOD AVE	100.0%			
18	1205	US 14/DEMPSTER ST @ DEE RD	95.0%	2.5%		2.5%
11	11695	US 14/ NORTHWEST HWY @ ELM ST	95.0%	5.0%		
11	1213	US 14/ DEMPSTER ST @ WESTERN AVE	95.0%	5.0%		

Rev. 6-4-14

100%
STATE

CONSTRUCTION CODE							C11	C12	C02	C13	C14	C15		
A01	C01	C02	C03	C04	C05	C06	11	12	13	14	15	16	17	18

TRAFFIC SIGNAL
0021
URBAN

CODE NO.	ITEM	UNIT	TOTAL QUANTITY	A01	C01	C02	C03	C04	C05	C06	C07	C08	C09	C10	C11	C12	C13	C14	C15		
67000400	ENGINEER'S FIELD OFFICE, TYPE A	CAL MO	6	6																	
67100100	MOBILIZATION	L SUM	1	1																	
70102635	TRAFFIC CONTROL AND PROTECTION, STANDARD 701701	L SUM	1	1																	
* 72000100	SIGN PANEL - TYPE 1	SD FT	1	1																	
* 72400310	REMOVE SIGN PANEL - TYPE 1	SD FT	1	1																	
85000200	MAINTENANCE OF EXISTING TRAFFIC SIGNAL INSTALLATION	EACH	65	21	6	2	2	1	1	1	1	1	1	3	14	2	4	2	1	1	1
△ 85700200	FULL-ACTUATED CONTROLLER AND TYPE IV CABINET	EACH	1	1																	
87502440	TRAFFIC SIGNAL POST, GALVANIZED STEEL 10 FT.	EACH	11	10											1						
87502480	TRAFFIC SIGNAL POST, GALVANIZED STEEL 14 FT.	EACH	56	16	6		1	4	1			6	4		5	2	4		2		5
87502490	TRAFFIC SIGNAL POST, GALVANIZED STEEL 15 FT.	EACH	3	1													2				
87502500	TRAFFIC SIGNAL POST, GALVANIZED STEEL 16 FT.	EACH	33	15	4			2	2						5	2			2		1
87502520	TRAFFIC SIGNAL POST, GALVANIZED STEEL 18 FT.	EACH	8	5											1	2					
88001640	SIGNAL HEAD, LED, 3-FACE, 2-3 SECTION, 1-4 SECTION, BRACKET MOUNTED	EACH	1														1				
88030020	SIGNAL HEAD, LED, 1-FACE, 3-SECTION, MAST-ARM MOUNTED	EACH	56	11	23			2	3			2			8		4		2		1
88030050	SIGNAL HEAD, LED, 1-FACE, 3-SECTION, BRACKET MOUNTED	EACH	57	18	5			4				4	4		9	2	7				4

*Specialty Items

Rev. 6-4-14



100%
STATE

CODE NO.	ITEM	UNIT	TOTAL QUANTITY	CONSTRUCTION CODE																	
				1	2	3	4	5	6	7	8	9	10	11	12	13	14	15	16	17	18
				TRAFFIC SIGNAL																	
				0021																	
URBAN																					
88030080	SIGNAL HEAD, LED, 1-FACE, 4-SECTION, MAST ARM MOUNTED	EACH	1																1		
88030100	SIGNAL HEAD, LED, 1-FACE, 5-SECTION, BRACKET MOUNTED	EACH	11	4				2	2						3						
88030110	SIGNAL HEAD, LED, 1-FACE, 5-SECTION, MAST-ARM MOUNTED	EACH	29	13	2			2	3					6				2	1		
88030210	SIGNAL HEAD, LED, 2-FACE, 3-SECTION, BRACKET MOUNTED	EACH	32	10	4				1		4			3	2	3		2	3		
88030220	SIGNAL HEAD, LED, 2-FACE, 5-SECTION, BRACKET MOUNTED	EACH	2	2																	
88030230	SIGNAL HEAD, LED, 2-FACE, 1-3 SECTION, 1-4 SECTION, BRACKET MOUNTED	EACH	2	1											1						
88030240	SIGNAL HEAD, LED, 2-FACE, 1-3 SECTION, 1-5 SECTION, BRACKET MOUNTED	EACH	20	9	2				1					5				2	1		
88030310	SIGNAL HEAD, LED, 3-FACE, 3-SECTION, BRACKET MOUNTED	EACH	1	1																	
88055150	OPTICALLY PROGRAMMED SIGNAL HEAD, LED, 1-FACE, 3-SECTION, BRACKET MOUNTED	EACH	9	2	3										4						
88055160	OPTICALLY PROGRAMMED SIGNAL HEAD, LED, 1-FACE, 3-SECTION, MAST ARM MOUNTED	EACH	13		9										2	2					
88055170	OPTICALLY PROGRAMMED SIGNAL HEAD, LED, 1-FACE, 4-SECTION, MAST ARM MOUNTED	EACH	2												2						
88055190	OPTICALLY PROGRAMMED SIGNAL HEAD, LED, 1-FACE, 5-SECTION, BRACKET MOUNTED	EACH	3	1											2						
88055200	OPTICALLY PROGRAMMED SIGNAL HEAD, LED, 1-FACE, 5-SECTION, MAST ARM MOUNTED	EACH	2	2																	
88060110	COMBINATION SIGNAL HEAD, LED, 2-FACE, 1-3 SECTION OPTICALLY PROGRAMMED, 1-3 SECTION, BRACKET MOUNTED	EACH	14		12										2						

FILE NAME =
D:\60X82-wht-SQ02.dgn
Default

USER NAME = SJohnson
PLOT SCALE = 40.0000' / 1" =
PLOT DATE = 3/21/2014

DESIGNED - PHL
DRAWN - PHL
CHECKED - BKS
DATE -

REVISED -
REVISED -
REVISED -
REVISED -

STATE OF ILLINOIS
DEPARTMENT OF TRANSPORTATION

SUMMARY OF QUANTITIES
(SHEET 3 OF 6)

SCALE: SHEET OF SHEETS STA. TO STA.

F.A. RTE. SECTION COUNTY TOTAL SHEETS SHEET NO.
2014-007TS COOK 88 8
CONTRACT NO. 60X82
ILLINOIS FED. AID PROJECT

Rev 6-4-14



100%
STATE

CONSTRUCTION CODE

CODE NO.	ITEM	UNIT	TOTAL QUANTITY	CONSTRUCTION CODE																							
				1	2	3	4	5	6	7	8	9	10	11	12	13	14	15	16	17	18						
				TRAFFIC SIGNAL																							
				0021																							
URBAN																											
88060150	COMBINATION SIGNAL HEAD, LED, 2-FACE, 1-4 SECTION OPTICALLY PROGRAMMED, 1-3 SECTION, BRACKET MOUNTED	EACH	2																2								
88060180	COMBINATION SIGNAL HEAD, LED, 2-FACE, 1-5 SECTION OPTICALLY PROGRAMMED, 1-3 SECTION, BRACKET MOUNTED	EACH	3	1															2								
88060460	COMBINATION SIGNAL HEAD, LED, 3-FACE, 2-5 SECTION OPTICALLY PROGRAMMED, 1-3 SECTION, BRACKET MOUNTED	EACH	1	1																							
88102710	PEDESTRIAN SIGNAL HEAD, LED, 1-FACE, BRACKET MOUNTED	EACH	5																5								
88102717	PEDESTRIAN SIGNAL HEAD, LED, 1-FACE, BRACKET MOUNTED WITH COUNTDOWN TIMER	EACH	130	27	30					2	4						2	4	27	10	4	6	8				6
88102740	PEDESTRIAN SIGNAL HEAD, LED, 2-FACE, BRACKET MOUNTED	EACH	1																	1							
88102747	PEDESTRIAN SIGNAL HEAD, LED, 2-FACE, BRACKET MOUNTED WITH COUNTDOWN TIMER	EACH	54	28	2						1								17	1	1					4	
88102757	PEDESTRIAN SIGNAL HEAD, LED, 3-FACE, BRACKET MOUNTED WITH COUNTDOWN TIMER	EACH	2	1																1							
88200210	TRAFFIC SIGNAL BACKPLATE, LOUVERED, ALUMINUM	EACH	151	52	36					4	4	6	2				2	6	22	4	7				4		2
88500100	INDUCTIVE LOOP DETECTOR	EACH	8	8																							
88800100	PEDESTRIAN PUSH-BUTTON	EACH	122	18	26						2							2	4	36	12	2	6	8			6
89500100	RELOCATE EXISTING SIGNAL HEAD	EACH	26	25						1																	
89500200	RELOCATE EXISTING PEDESTRIAN SIGNAL HEAD	EACH	23	23																							
89500400	RELOCATE EXISTING PEDESTRIAN PUSH-BUTTON	EACH	1	1																							
89502210	MODIFY EXISTING CONTROLLER CABINET	EACH	60	19	5	2	2	1	1	1	1	1	1	1	3	13	2	4	2	1				1	1		



Rev. 6-4-14



CODE NO.	ITEM	UNIT	TOTAL QUANTITY	CONSTRUCTION CODE																			
				1	2	3	4	5	6	7	8	9	10	11	12	13	14	15	16	17	18		
				TRAFFIC SIGNAL																			
				0021																			
URBAN																							
89502375	REMOVE EXISTING TRAFFIC SIGNAL EQUIPMENT	EACH	54 17	6			1	1	1			1	1	1	14	2	4	2	1	1			1
X8620050	UNINTERRUPTABLE POWER SUPPLY, GROUND MOUNTED	EACH	7	2	2							1				1		1					
X8620200	UNINTERRUPTABLE POWER SUPPLY, SPECIAL	EACH	54 18 3	2	2	1	1	1				1	3	13	1	4	1	1			1	1	
X8803038	SIGNAL HEAD, LED, 2-FACE, 1-3 SECTION, 1-4 SECTION, BRACKET MOUNTED, RETROFIT	EACH	2	2																			
X8803040	SIGNAL HEAD, LED, 2-FACE, 1-3 SECTION, 1-5 SECTION, BRACKET MOUNTED, RETROFIT	EACH	12	5						2			1	3		1							
X8803051	SIGNAL HEAD, LED, 3-FACE, 2-3 SECTION, 1-5 SECTION, BRACKET MOUNTED, RETROFIT	EACH	1			1																	
X8803060	SIGNAL HEAD, LED, 3-FACE, 3-SECTION, BRACKET MOUNTED, RETROFIT	EACH	1			1																	
X8803082	SIGNAL HEAD, LED, 1-FACE, 3-SECTION, BRACKET MOUNTED, RETROFIT	EACH	26	4	2	4							2	12		2							
X8803084	SIGNAL HEAD, LED, 1-FACE, 3-SECTION, MAST ARM MOUNTED, RETROFIT	EACH	77	33	6	4				6			14	11		3							
X8803088	SIGNAL HEAD, LED, 1-FACE, 5-SECTION, MAST ARM MOUNTED, RETROFIT	EACH	56	28	2	4				4			10	7		1							
X8803090	SIGNAL HEAD, LED, 2-FACE, 3-SECTION, BRACKET MOUNTED, RETROFIT	EACH	9	4						1				4									
X8803110	SIGNAL HEAD, LED, 1-FACE, 4-SECTION, BRACKET MOUNTED, RETROFIT	EACH	1	1																			
X8803120	SIGNAL HEAD, LED, 1-FACE, 4-SECTION, MAST ARM MOUNTED, RETROFIT	EACH	1	1																			
X8803210	SIGNAL HEAD, LED, 1-FACE, 5-SECTION, BRACKET MOUNTED, RETROFIT	EACH	28	13	2								9	2		2							

100% STATE

FILE NAME = D:\60X82-wht-5004.dgn	USER NAME = SJohnson	DESIGNED - PHL	REVISIONS -
Default	PLOT SCALE = 40,0000 1/ in.	DRAWN - PHL	REVISIONS -
	PLOT DATE = 3/21/2014	CHECKED - BKS	REVISIONS -
		DATE -	REVISIONS -

STATE OF ILLINOIS
DEPARTMENT OF TRANSPORTATION

SUMMARY OF QUANTITIES
(SHEET 5 OF 6)

SCALE: SHEET OF SHEETS STA. TO STA.

F.A. RTE.	SECTION	COUNTY	TOTAL SHEETS	SHEET NO.
	2014-007TS	COOK	88	10
CONTRACT NO. 60X82				
ILLINOIS FED. AID PROJECT				

A Rev.



100%
STATE

CONSTRUCTION CODE

1	2	3	4	5	6	7	8	9	10	11	12	13	14	15	16	17	18
TRAFFIC SIGNAL																	
0021																	
URBAN																	

CODE NO.	ITEM	UNIT	TOTAL QUANTITY	1	2	3	4	5	6	7	8	9	10	11	12	13	14	15	16	17	18
X8803910	SIGNAL HEAD, LED, 2-FACE, 5-SECTION, BRACKET MOUNTED RETROFIT	EACH	8	5			1			1				1							
X8880015	PEDESTRIAN PUSH-BUTTON, NON-LATCHING	EACH	^Δ 122	59	6				5					29	7	7	5		4		
Z0050400	REMOVE AND REPLACE ANCHOR BOLTS	EACH	58	25	5		1	3	2		3	2		6	3	3		2			3
X8808755	COMBINATION SIGNAL HEAD, LED, 3-FACE, 1-3 SECTION OPTICALLY PROGRAMMED, 1-4 SECTION OPTICALLY PROGRAMMED, 1-3 SECTION, BRACKET MOUNTED	EACH	1													1					
∅ Z0076604	TRAINEES TRAINING PROGRAM GRADUATE	HOUR	500	500																	

∅ 0042

Δ Rev. 6-4-14

FILE NAME = D:\62432\hlt-5005.dgn	USER NAME = SJohnson	DESIGNED - PHL	REVISED -
		DRAWN - PHL	REVISED -
		CHECKED - BKS	REVISED -
		DATE -	REVISED -

STATE OF ILLINOIS
DEPARTMENT OF TRANSPORTATION

SUMMARY OF QUANTITIES
(SHEET 6 OF 6)

SCALE: SHEET OF SHEETS STA. TO STA.

F.A. RTE.	SECTION	COUNTY	TOTAL SHEETS	SHEET NO.
	2014-007TS	COOK	88	11
CONTRACT NO. 60X82			ILLINOIS FED. AID PROJECT	

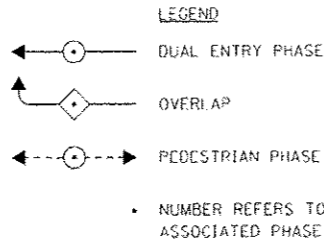
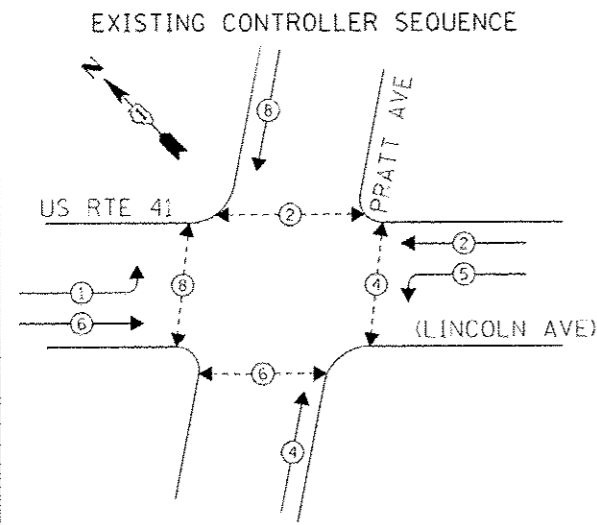

UPS SHALL BE INSTALLED ON LEFT SIDE OF CONTROLLER CABINET DUE TO PHYSICAL CONSTRAINT, OR AS DIRECTED BY THE ENGINEER.

PHASE DESIGNATION DIAGRAM

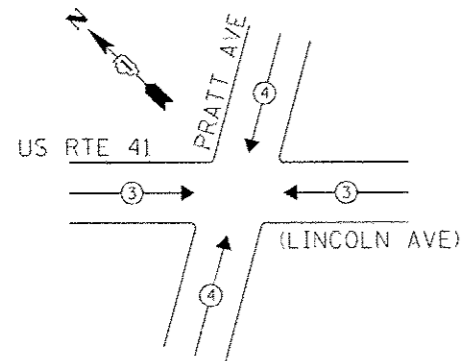

EXISTING EMERGENCY VEHICLE PREEMPTION SEQUENCE

EMERGENCY VEHICLE PREEMPTORS		
EMERGENCY VEHICLE PREEMPTOR	3	4
MOVEMENT	←→	↖↗

THE TRAFFIC SIGNAL CONTROL EQUIPMENT FOR THIS PROJECT SHALL BE "ECONOLITE" TO MATCH THE EXISTING ADJACENT SYSTEM.

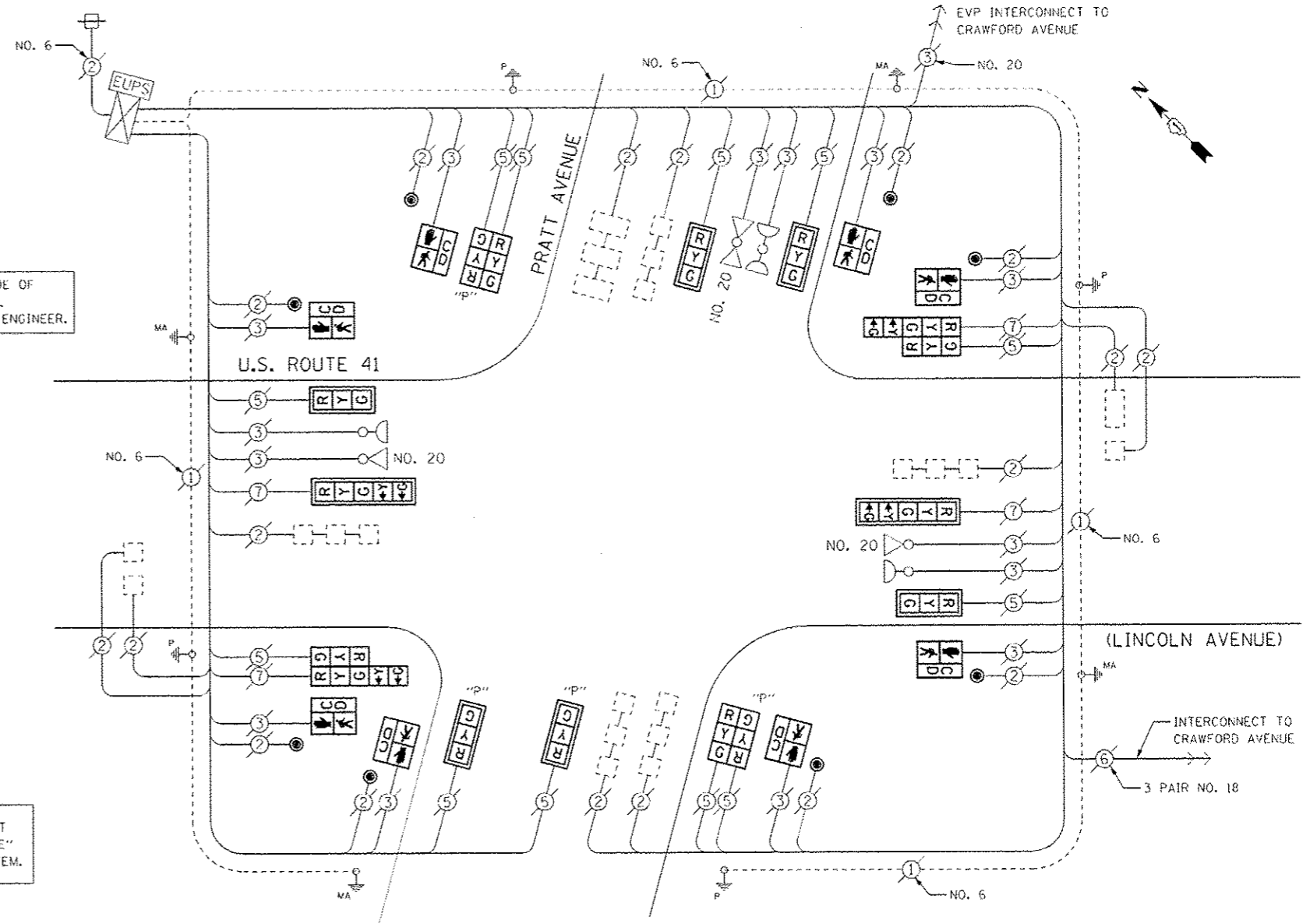

CABLE PLAN

I. D. O. T. TRAFFIC SIGNAL INSTALLATION ELECTRICAL SERVICE REQUIREMENTS

TYPE	NO. LAMPS	WATTAGE INCAND.	WATTAGE LED	%OPERATION	TOTAL WATTAGE
SIGNAL (RED)	16	-	17	0.50	136.0
(YELLOW)	16	-	25	0.25	100.0
(GREEN)	16	-	15	0.25	60.0
ARROW	8	-	12	0.10	9.6
PED. SIGNAL	8	-	25	1.00	200.0
CONTROLLER	1	100	-	1.00	100.0
ILLUM. SIGN	-	-	-	0.50	-
VIDEO SYSTEM	-	150	-	1.00	-
BATTERY BACKUP	1	25	-	1.00	25.0
LUMINAIRE	-	-	-	0.50	-
FLASHER	-	-	-	0.50	-
TOTAL =					630.6

ENERGY COSTS- BILLED TO: IDOT DISTRICT 1
 201 WEST CENTER COURT
 SCHAUMBURG, IL 60196-1096

ENERGY SUPPLY- CONTACT: TERRI BLECK
 PHONE: 847-816-5239
 COMMONWEALTH EDISON

SCHEDULE OF QUANTITIES

ITEMS	UNIT	QUANTITY
MAINTENANCE OF EXISTING TRAFFIC SIGNAL INSTALLATION	EACH	1
SIGNAL HEAD, LED, 1-FACE, 3-SECTION, MAST-ARM MOUNTED	EACH	4
SIGNAL HEAD, LED, 1-FACE, 5-SECTION, MAST-ARM MOUNTED	EACH	2
SIGNAL HEAD, LED, 2-FACE, 1-3 SECTION, 1-5 SECTION, BRACKET MOUNTED	EACH	2
OPTICALLY PROGRAMMED SIGNAL HEAD, LED, 1-FACE, 3-SECTION, MAST ARM MOUNTED	EACH	2
COMBINATION SIGNAL HEAD, LED, 2-FACE, 1-3 SECTION OPTICALLY PROGRAMMED, 1-3 SECTION, BRACKET MOUNTED	EACH	2
PEDESTRIAN SIGNAL HEAD, LED, 1-FACE, BRACKET MOUNTED WITH COUNTDOWN TIMER	EACH	8
TRAFFIC SIGNAL BACKPLATE, LOUVERED, ALUMINUM	EACH	8
PEDESTRIAN PUSH-BUTTON	EACH	8
REMOVE EXISTING CONTROLLER CABINET	EACH	1
REMOVE EXISTING TRAFFIC SIGNAL EQUIPMENT	EACH	1
UNINTERRUPTIBLE POWER SUPPLY, SPECIAL	EACH	1

REMOVAL OF EXISTING TRAFFIC SIGNAL EQUIPMENT

THE FOLLOWING ITEMS SHALL BE REMOVED BY THE CONTRACTOR AND SHALL BE DISPOSED OF BY THEM OUTSIDE THE RIGHT-OF-WAY AT THEIR EXPENSE. THE SALVAGE VALUE OF THE REMOVED EQUIPMENT SHALL BE REFLECTED IN THE CONTRACT BID PRICE.

- 6 EACH SIGNAL HEAD, 1-FACE, 3-SECTION
- 2 EACH SIGNAL HEAD, 1-FACE, 5-SECTION
- 2 EACH SIGNAL HEAD, 2-FACE, 3-SECTION
- 2 EACH SIGNAL HEAD, 2-FACE, 1-3 SECTION, 1-5 SECTION
- 8 EACH PEDESTRIAN SIGNAL HEAD, 1-FACE
- 8 EACH PEDESTRIAN PUSH-BUTTON

FILE NAME - DIG082-ehc-TS1610.dgn	USER NAME - SJohnson	DESIGNED - PHL	REVISED - BKS 5-12-2014 / 1
		DRAWN - PHL	REVISED -
	PLT: SCALE: 1/4"=1'-0"	CHECKED - BKS	REVISED -
	PLT: DATE: 5/14/2014	DATE - 03/09/2014	REVISED -

STATE OF ILLINOIS DEPARTMENT OF TRANSPORTATION

U.S. ROUTE 41 (LINCOLN AVE) AT PRATT AVENUE - CABLE PLAN
SCHEDULE OF QUANTITIES, PHASE DESIG. DIAGRAM & EVP SEQUENCE

F.A. RTE.	SECTION	COUNTY	TOTAL SHEETS	SHEET NO.
	2014-007T5	COOK	88	31
CONTRACT NO. 60X82			ILLINOIS FED. AID PROJECT	

TS 1610
LINCOLNWOOD

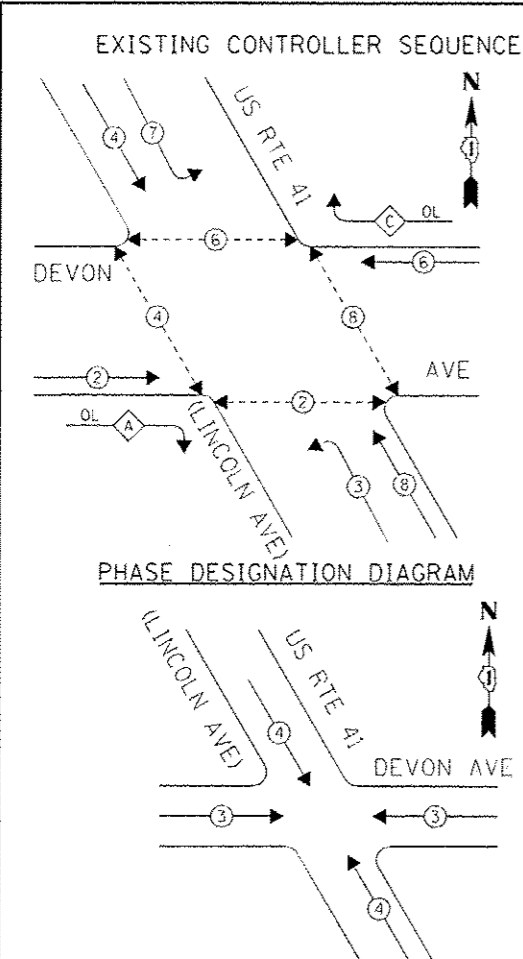

LEGEND

- DUAL ENTRY PHASE
- OVERLAP
- PEDESTRIAN PHASE
- NUMBER REFERS TO ASSOCIATED PHASE

OVERLAP LETTER	PERMISSIVE PHASE	PROTECTED PHASE
A	= 2	+ 3
C	= 6	+ 7

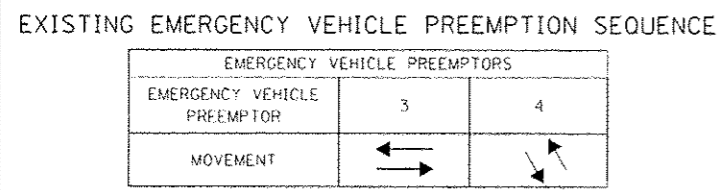

I. D. O. T. TRAFFIC SIGNAL INSTALLATION ELECTRICAL SERVICE REQUIREMENTS

TYPE	NO. LAMPS	WATTAGE INCAND.	LED	%OPERATION	TOTAL WATTAGE
SIGNAL (RED)	16	-	17	0.50	136.0
(YELLOW)	16	-	25	0.25	100.0
(GREEN)	16	-	15	0.25	60.0
ARROW	16	-	12	0.10	19.2
PED. SIGNAL	8	-	25	1.00	200.0
CONTROLLER	1	100	-	1.00	100.0
ILLUM. SIGN	-	-	25	0.50	-
VIDEO SYSTEM	-	-	-	1.00	-
BATTERY BACKUP	1	25	-	1.00	25.0
LUMINAIRE	-	-	-	0.50	-
FLASHER	-	-	25	0.50	-
TOTAL =					640.2

ENERGY COSTS- BILLED TO: IDOT DISTRICT 1
 201 WEST CENTER COURT
 SCHAUMBURG, IL 60196-1096

ENERGY SUPPLY- CONTACT: TERRI BLECK
 PHONE: 847-816-5239
 COMMONWEALTH EDISON

REMOVAL OF EXISTING TRAFFIC SIGNAL EQUIPMENT
 THE FOLLOWING ITEMS SHALL BE REMOVED BY THE CONTRACTOR AND SHALL BE DISPOSED OF BY THEM OUTSIDE THE RIGHT-OF-WAY AT THEIR EXPENSE. THE SALVAGE VALUE OF THE REMOVED EQUIPMENT SHALL BE REFLECTED IN THE CONTRACT BID PRICE.

- 2 EACH TRAFFIC SIGNAL POST
- 4 EACH SIGNAL HEAD, 1-FACE, 3-SECTION
- 3 EACH SIGNAL HEAD, 1-FACE, 5-SECTION
- 3 EACH SIGNAL HEAD, 2-FACE, 1-3 SECTION, 1-5 SECTION
- 1 EACH SIGNAL HEAD, 3-FACE, 2-5 SECTION, 1-3 SECTION
- 6 EACH PEDESTRIAN SIGNAL HEAD, 1-FACE
- 1 EACH PEDESTRIAN SIGNAL HEAD, 2-FACE
- 8 EACH PEDESTRIAN PUSH-BUTTON
- 1 EACH CONTROLLER AND CABINET

SCHEDULE OF QUANTITIES

ITEMS	UNIT	QUANTITY
MAINTENANCE OF EXISTING TRAFFIC SIGNAL INSTALLATION	EACH	1
TRAFFIC SIGNAL POST, GALVANIZED STEEL 16 FT.	EACH	1
TRAFFIC SIGNAL POST, GALVANIZED STEEL 18 FT.	EACH	1
SIGNAL HEAD, LED, 1-FACE, 3-SECTION, MAST-ARM MOUNTED	EACH	2
SIGNAL HEAD, LED, 2-FACE, 1-3 SECTION, 1-5 SECTION, BRACKET MOUNTED	EACH	2
OPTICALLY PROGRAMMED SIGNAL HEAD, LED, 1-FACE, 3-SECTION, BRACKET MOUNTED	EACH	2
OPTICALLY PROGRAMMED SIGNAL HEAD, LED, 1-FACE, 5-SECTION, BRACKET MOUNTED	EACH	1
OPTICALLY PROGRAMMED SIGNAL HEAD, LED, 1-FACE, 5-SECTION, MAST ARM MOUNTED	EACH	2
COMBINATION SIGNAL HEAD, LED, 2-FACE, 1-5 SECTION OPTICALLY PROGRAMMED, 1-3 SECTION, BRACKET MOUNTED	EACH	1
COMBINATION SIGNAL HEAD, LED, 3-FACE, 2-5 SECTION OPTICALLY PROGRAMMED, 1-3 SECTION, BRACKET MOUNTED	EACH	1
PEDESTRIAN SIGNAL HEAD, LED, 1-FACE, BRACKET MOUNTED WITH COUNTDOWN TIMER	EACH	6
PEDESTRIAN SIGNAL HEAD, LED, 2-FACE, BRACKET MOUNTED WITH COUNTDOWN TIMER	EACH	1
TRAFFIC SIGNAL BACKPLATE, LOUVERED, ALUMINUM	EACH	4
PEDESTRIAN PUSH-BUTTON	EACH	8
MODIFY EXISTING CONTROLLER CABINET	EACH	1
REMOVE EXISTING TRAFFIC SIGNAL EQUIPMENT	EACH	1
UNINTERRUPTIBLE POWER SUPPLY, SPECIAL	EACH	1
FULL-ACTUATED CONTROLLER AND TYPE IV CABINET	EACH	1
INDUCTIVE LOOP DETECTOR	EACH	8

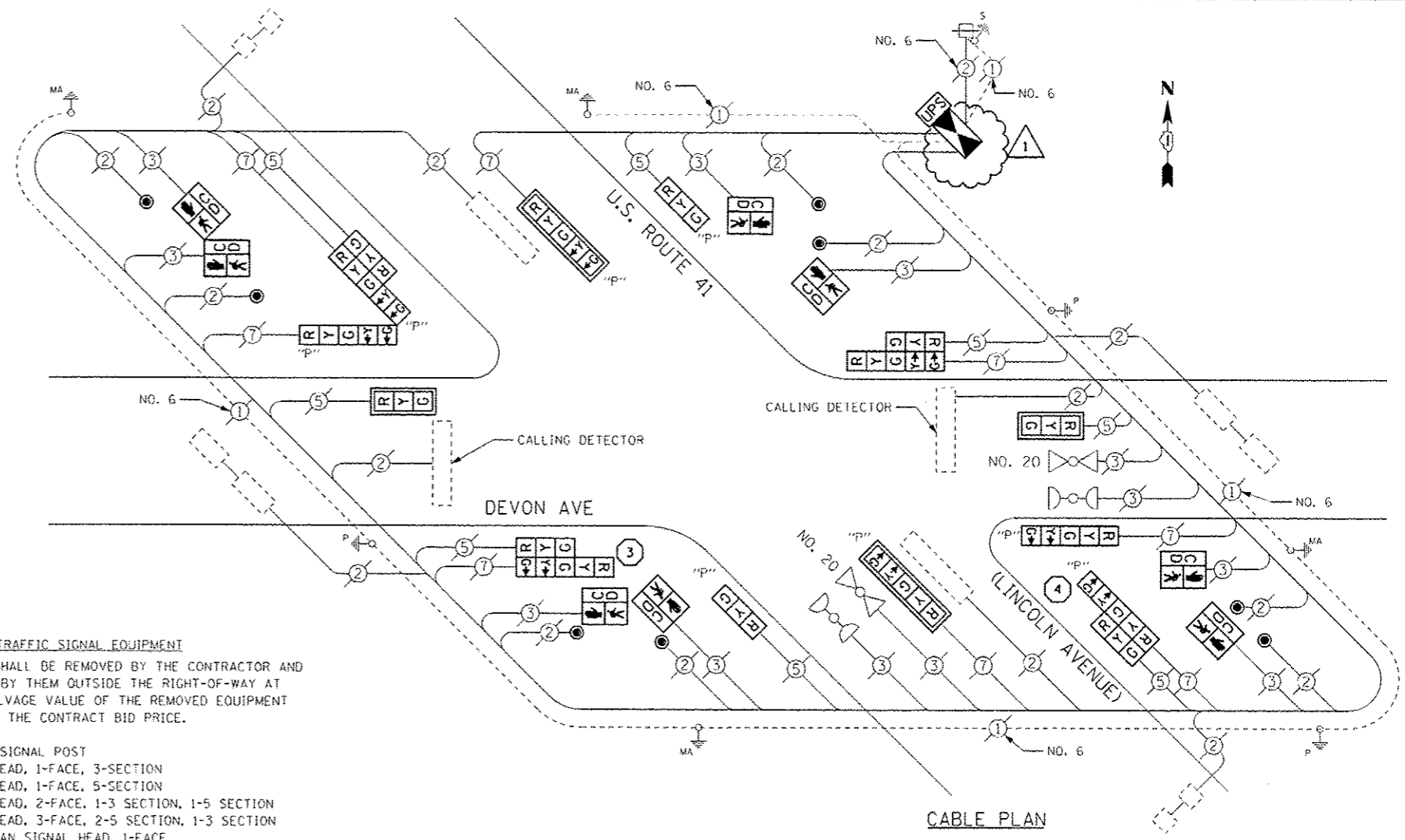

NOTE
 CONTRACTOR SHALL RELOCATE PREEMPTION PHASE SELECTOR AND "SMART MICRO" RADAR DETECTION SYSTEMS FROM EXISTING CONTROLLER CABINET TO PROPOSED CONTROLLER CABINET OR AS DIRECTED BY ENGINEER. RELOCATION OF THESE SYSTEMS, INCLUDING ALL NECESSARY HARDWARE, CABLES, AND CONNECTIONS, SHALL BE INCLUDED IN THE COST OF FULL-ACTUATED CONTROLLER AND TYPE IV CABINET.

CONSTRUCTION NOTES

- 3 THE CONTRACTOR SHALL REPLACE THE EXISTING TRAFFIC SIGNAL POST WITH THE PROPOSED TRAFFIC SIGNAL POST, 16 FT. AND ATTACH THE PROPOSED POST TO THE EXISTING FOUNDATION.
- 4 THE CONTRACTOR SHALL REPLACE THE EXISTING TRAFFIC SIGNAL POST WITH THE PROPOSED TRAFFIC SIGNAL POST, 18 FT. AND ATTACH THE PROPOSED POST TO THE EXISTING FOUNDATION.

TS 1505
 LINCOLNWOOD