

109

STATE OF ILLINOIS
DEPARTMENT OF TRANSPORTATION
DIVISION OF HIGHWAYS

**PROPOSED
CONTRACT MAINTENANCE**

F.A.I 155 (I-155)
SECTION (54-10) BRR-1
BRIDGE REPAIRS
LOGAN COUNTY

FOR INDEX OF SHEETS, SEE SHEET NO. 2

F.A.I. RTE.	SECTION	COUNTY	TOTAL SHEETS	SHEET NO.
I-155	(54-10) BRR-1	LOGAN	4	1
		ILLINOIS	CONTRACT NO. 72L18	

D-95-040-19

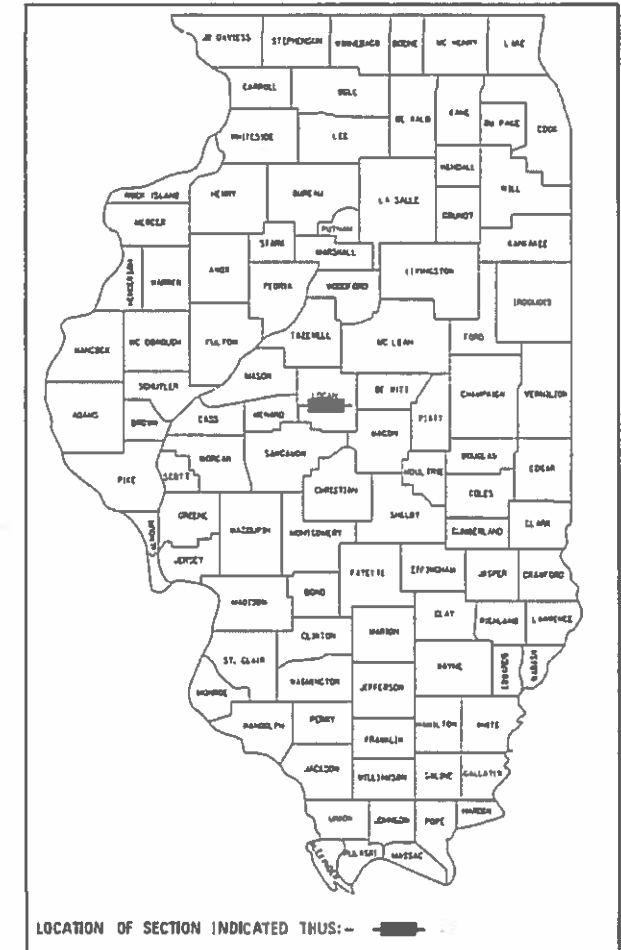

C-96-054-19

STRUCTURAL REPAIR OF STEEL BRIDGE SN 054-0075
TR 33 OVER I-155 AT THE HARTSBURG INTERCHANGE
40.2495°N 89.4614°W

WORK SHALL CONSIST OF SUBSTRUCTURE REPAIR AT BOTH
ABUTMENTS.

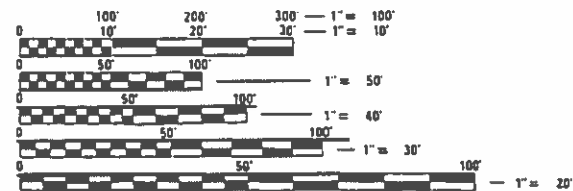

FULL SIZE PLANS HAVE BEEN PREPARED USING STANDARD
ENGINEERING SCALES. REDUCED SIZED PLANS WILL NOT
CONFORM TO STANDARD SCALES. IN MAKING MEASUREMENTS
ON REDUCED PLANS, THE ABOVE SCALES MAY BE USED.

J.U.L.I.E.
JOINT UTILITY LOCATION INFORMATION FOR EXCAVATION
1-800-892-0123
OR 811



LOGAN COUNTY

BRIDGE MAINTENANCE ENGINEER - BRANDON DUDLEY (217) 785-9290
DESIGNER - NKOSANE NOSAKHERE (217) 524-5010

GROSS LENGTH = 354 FT = 0.07 MI
NET LENGTH = 354 FT = 0.07 MI

CONTRACT NO. 72L18

STATE OF ILLINOIS
DEPARTMENT OF TRANSPORTATION
DIVISION OF HIGHWAYS

SUBMITTED 20 March 2019

Brandon Dudley
REGION FOUR ENGINEER

May 10 2019
Paul G. Chik
ENGINEER OF DESIGN AND ENVIRONMENT

Paul G. Chik
DIRECTOR OF HIGHWAYS PROJECT IMPLEMENTATION

PRINTED BY THE AUTHORITY
OF THE STATE OF ILLINOIS

INDEX OF SHEETS

- 1 COVER SHEET
- 2 INDEX, STANDARDS, GENERAL NOTES, SIGNATURES, & SUMMARY OF QUANTITIES
- 3-4 BRIDGE PLANS - SN 054-0075

HIGHWAY STANDARDS

- 000001-07
- 001006
- 701101-05
- 701106-02
- 701400-09
- 701406-12
- 701411-09
- 701901-08

GENERAL NOTES:

0-02174-6005
 SN 054-0075
 100% STATE
 BRIDGE

CODE NO.	ITEM	UNIT	TOTAL QUANTITY	LOGAN
67100100	MOBILIZATION	L SUM	1	1
70100700	TRAFFIC CONTROL AND PROTECTION, STANDARD 701406	L SUM	1	1
70100420	TRAFFIC CONTROL AND PROTECTION, STANDARD 701411	EACH	2	2
Z0012754	STRUCTURAL REPAIR OF CONCRETE (DEPTH EQUAL TO OR LESS THAN 5 INCHES)	SQ FT	138	138

STATE OF ILLINOIS
DEPARTMENT OF TRANSPORTATION
DIVISION OF HIGHWAYS
DISTRICT 6

EXAMINED 15 March 2019

 ENGINEER OF OPERATIONS

EXAMINED 15 March 2019

 ENGINEER OF PROJECT IMPLEMENTATION

EXAMINED March 5 2019

 ENGINEER OF PROGRAM DEVELOPMENT

FILE NAME = OPERATIONS\bridges\br-edges\br-opgplans_CAD\72118 - 0540075 substructure repair\vol\enhancement\PROGRAM	USER NAME = npsghbrank PLT SCALE = 1/8"=1'-0" PLOT DATE = 3/21/2019	DESIGNED - CHECKED - DATE -	REVISED - REVISIONS -
STATE OF ILLINOIS DEPARTMENT OF TRANSPORTATION		INDEX OF SHEETS, STANDARDS, GENERAL NOTES, SIGNATURES, & SUMMARY OF QUANTITIES	
SCALES: 50' _____ SHEET _____ OF _____ SHEETS		STA. 538+40.00 TO STA. 701+17.25	
F.A.I. RTE. 1-155	SECTION 54-101 BRR-1	COUNTY LOGAN	TOTAL SHEETS NO. 4 CONTRACT NO. 72118

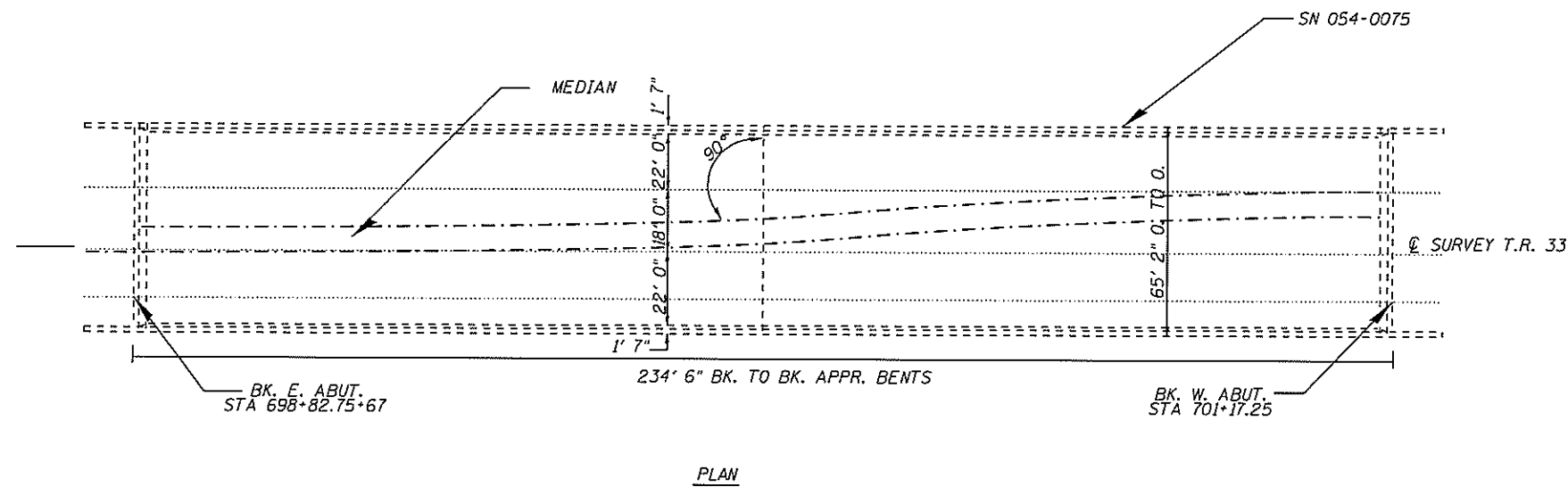
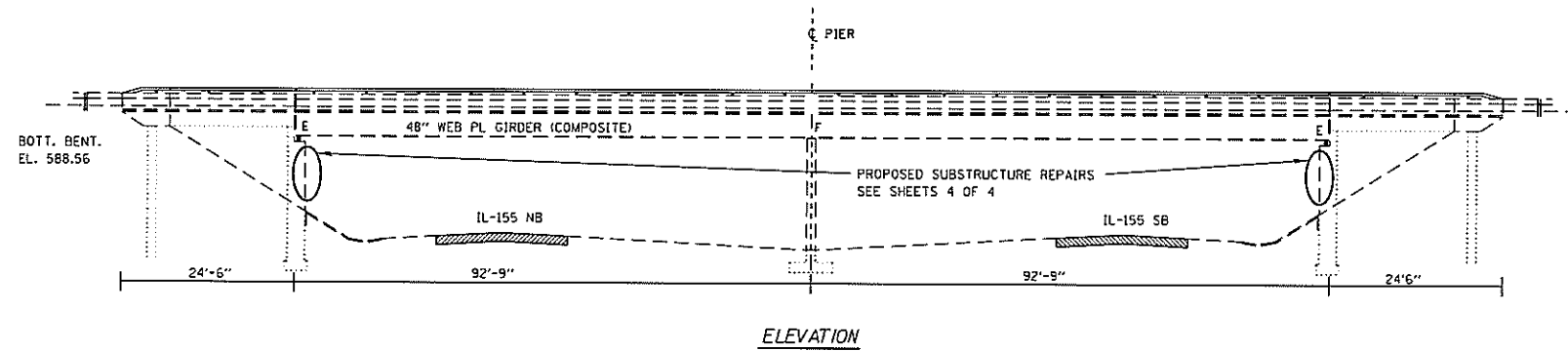
GENERAL NOTES:

PLAN DIMENSIONS AND DETAILS RELATIVE TO EXISTING PLANS ARE SUBJECT TO NOMINAL CONSTRUCTION VARIATIONS. THE CONTRACTOR SHALL FIELD VERIFY EXISTING DIMENSIONS AND DETAILS AFFECTING NEW CONSTRUCTION AND MAKE NECESSARY APPROVED ADJUSTMENTS PRIOR TO CONSTRUCTION OR ORDERING OF MATERIALS. SUCH VARIATIONS SHALL NOT BE CAUSE FOR ADDITIONAL COMPENSATION FOR A CHANGE IN THE SCOPE OF WORK. HOWEVER, THE CONTRACTOR WILL BE PAID FOR THE QUANTITY ACTUALLY FURNISHED AT THE UNIT PRICE BID FOR THE WORK.



TOTAL BILL OF MATERIAL		
ITEM	UNIT	QUANTITY
STRUCTURAL REPAIR OF CONCRETE (DEPTH EQUAL TO OR LESS THAN 5")	SQ. FT.	138

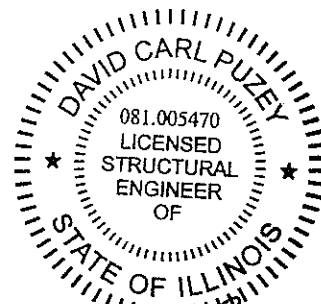

*David Carl Puzey 5/10/19
Expires 11/30/20*

FILE NAME =	USER NAME = noakhorenk	DESIGNED - <u>BMA</u>	REVISED -	STATE OF ILLINOIS DEPARTMENT OF TRANSPORTATION	BRIDGE PLAN & ELEVATION SN 054-0075			F.A.J. RTE.	SECTION	COUNTY	TOTAL SHEETS	SHEET NO.
Q:\OPERATIONS\Bridges\Bridgplans\CAD\72118 - 0540075 substructure repair\plansheet	DRAWN -	CHECKED - <u>JJB</u>	REVISED -		SCALE: 50	SHEET 3 OF 4 SHEETS	STA. 698+85.00 TO STA. 701+17.25	I-155	(54-10) BRR-1	LOGAN	4	3
Default	PLOT SCALE = 100.0001' / 1"	DATE -	REVISED -					CONTRACT NO. 72L18			ILLINOIS FED. AID PROJECT	

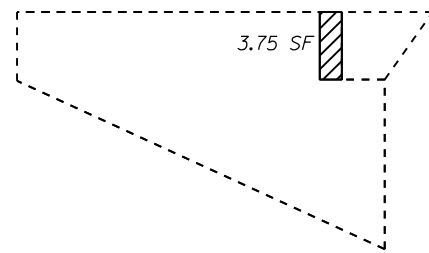

NORTH CURTAIN WALL ELEVATION
(LOOKING SOUTH)

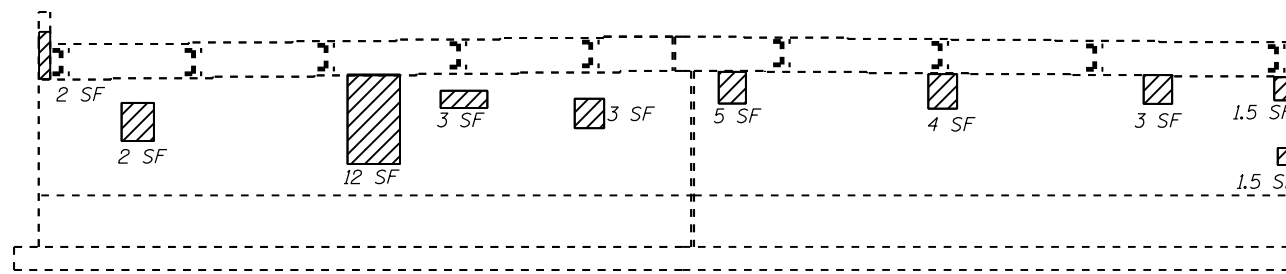

EAST ABUTMENT ELEVATION (LOOKING EAST)

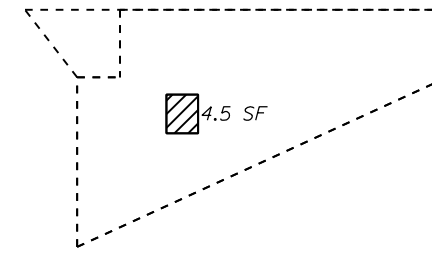

SOUTH CURTAIN WALL ELEVATION
(LOOKING NORTH)

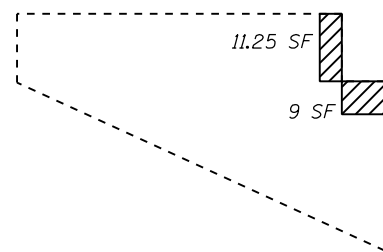

SOUTH CURTAIN WALL ELEVATION
(LOOKING NORTH)

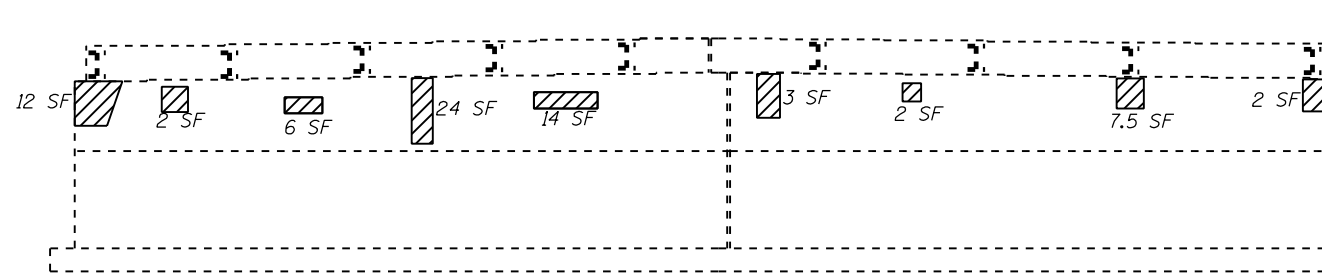

WEST ABUTMENT ELEVATION (LOOKING WEST)

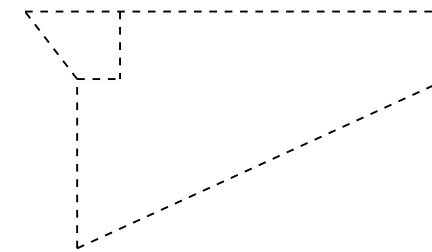

NORTH CURTAIN WALL ELEVATION
(LOOKING SOUTH)



PROPOSED STRUCTURAL REPAIR OF CONCRETE
(DEPTH EQUAL TO OR LESS THAN 5")

FILE NAME =	USER NAME = nosakherenk	DESIGNED - _____	REVISED - _____
Q:\OPERATIONS\Bridges\Bridgplans.CAD\72L18 - 0540075 substructure repair\plansheet.d		DRAWN - _____	REVISED - _____
Default	PLOT SCALE = 100.0000' / in.	CHECKED - _____	REVISED - _____
	PLOT DATE = 3/22/2019	DATE - _____	REVISED - _____

STATE OF ILLINOIS
DEPARTMENT OF TRANSPORTATION

SUBSTRUCTURE REPAIRS	
SN 054-0075	
SCALE: _____	SHEET 3 OF 4 SHEETS STA. _____ TO STA. _____

F.A.I. RTE.	SECTION	COUNTY	TOTAL SHEETS	SHEET NO.
I-155	(54-10)BR-1	LOGAN	4	4
CONTRACT NO. 72L18			ILLINOIS FED. AID PROJECT	