

174

06-14-2019 LETTING ITEM 174

F.A.P. RTE	SECTION	COUNTY	TOTAL SHEETS	SHEET NO.
694	D2 BDR 2019-4	LEE	26	1
		ILLINOIS	CONTRACT NO. 64N28	

STATE OF ILLINOIS
 DEPARTMENT OF TRANSPORTATION
**PROPOSED
 HIGHWAY PLANS**

FOR INDEX OF SHEETS, SEE SHEET NO. 2
 FOR STATE STANDARDS, SEE SHEET NO. 2

FAP ROUTE 694 (US 52)
 SECTION D2 BDR 2019-4
 PROJECT
 EXPANSION JOINT REPLACEMENT, DECK
 PATCHING & CONCRETE OVERLAY
 LEE COUNTY

C-92-005-19

R.10E

AMBOY TOWNSHIP - SECTION 22 & 23

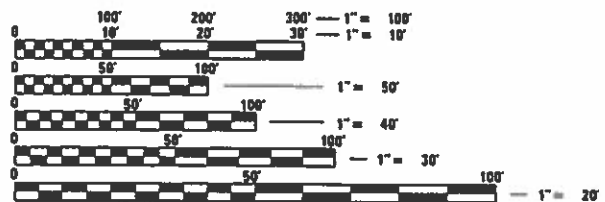

FULL SIZE PLANS HAVE BEEN PREPARED USING STANDARD ENGINEERING SCALES. REDUCED SIZED PLANS WILL NOT CONFORM TO STANDARD SCALES. IN MAKING MEASUREMENTS ON REDUCED PLANS, THE ABOVE SCALES MAY BE USED.

J.U.L.I.E.
 JOINT UTILITY LOCATION INFORMATION FOR EXCAVATION
 1-800-892-0123
 OR 811

PROJECT ENGINEER: MAHMOUD ETEMADI, Ext. 393
 PROJECT MANAGER: MAHMOUD ETEMADI, Ext. 393

CONTRACT NO. 64N28

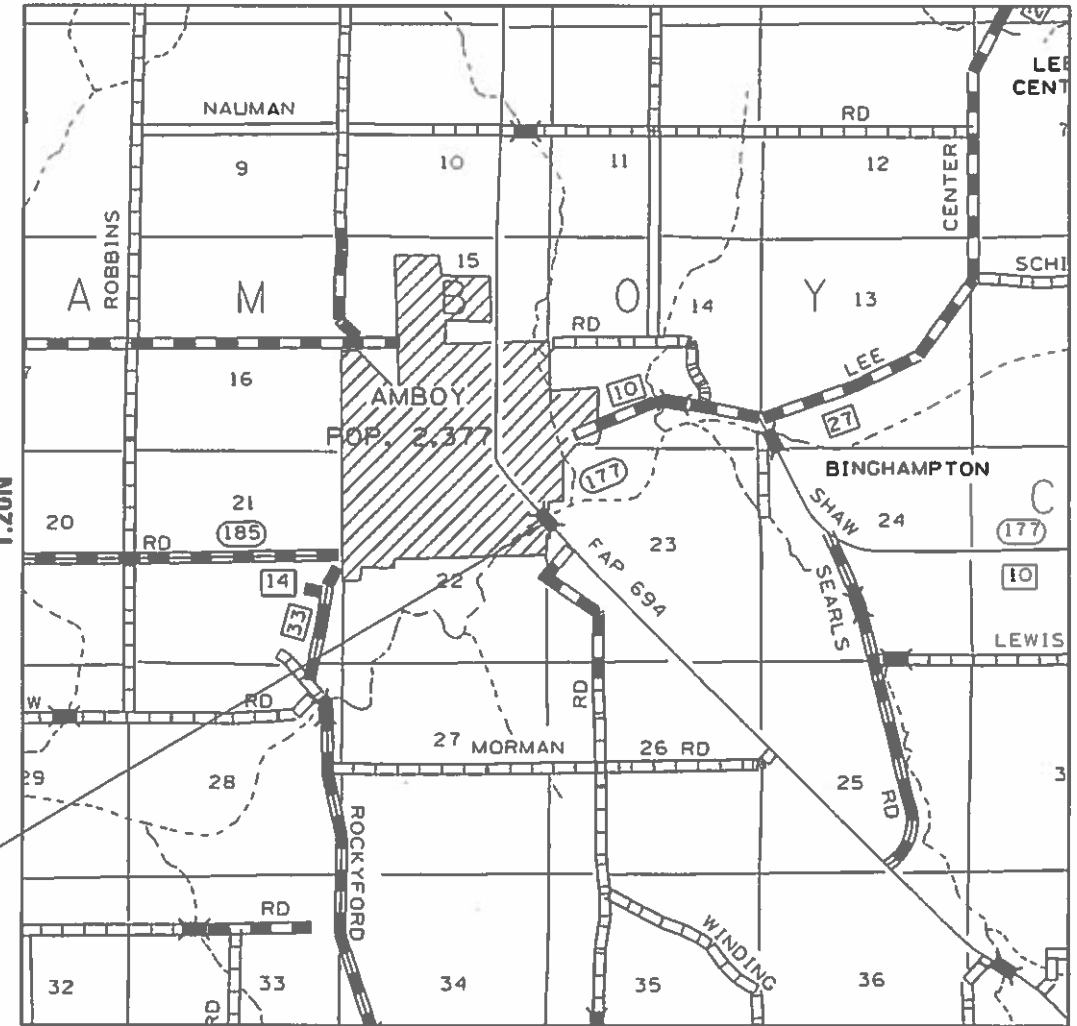

STATE OF ILLINOIS
 DEPARTMENT OF TRANSPORTATION

SUBMITTED Dec 21, 2018
Kerwin Marchek
 REGIONAL ENGINEER

May 10, 2019
Eric A. Elk
 ENGINEER OF DESIGN AND ENVIRONMENT

May 10, 2019
Paul J. [Signature]
 DIRECTOR OF HIGHWAYS PROJECT IMPLEMENTATION

PRINTED BY THE AUTHORITY
 OF THE STATE OF ILLINOIS

INDEX OF SHEETS

1	COVER SHEET
2	INDEX OF SHEETS
2	DISTRICT AND STATE STANDARDS
3	GENERAL NOTES
4 - 6	SUMMARY OF QUANTITIES
7	TYPICAL SECTIONS
8 - 9	SCHEDULE OF QUANTITIES
9 - 13	STAGING PLANS
14 - 19	STRUCTURE PLANS - BRIDGES (SN 052-0060)
20 - 23	WORK ZONE SIGN DETAILS 34.1
24 - 26	TYPICAL PAVEMENT MARKINGS (DS 41.1)

STATE STANDARDS

000001	-	07	STANDARD SYMBOLS, ABBREVIATIONS, AND PATTERNS
001001	-	02	AREAS OF REINFORCEMENT BARS
001006	-		DECIMAL OF AN INCH AND OF A FOOT
701006	-	05	OFF-ROAD OPERATIONS, 2L, 2W, 15' TO 24" FROM PAVEMENT EDGE
701011	-	04	OFF-ROAD MOVING OPERATIONS, 2L, 2W, DAY ONLY
701201	-	05	LANE CLOSURE, 2L, 2W, DAY ONLY, FOR SPEEDS > 45MPH
701301	-	04	LANE CLOSURE, 2L, 2W, SHORT TIME OPERATIONS
701306	-	04	LANE CLOSURE, 2L, 2W, SLOW MOVING OPERATIONS DAY ONLY, FOR SPEEDS ≥ 45MPH
701311	-	03	LANE CLOSURE, 2L, 2W, MOVING OPERATIONS DAY ONLY
701321	-	17	LANE CLOSURE, 2L, 2W, BRIDGE REPAIR WITH BARRIER
701901	-	08	TRAFFIC CONTROL DEVICES
704001	-	08	TEMPORARY CONCRETE BARRIER
720011	-	01	METAL POSTS FOR SIGNS, MARKERS AND DELINEATORS
728001	-	01	TELESCOPING STEEL SIGN SUPPORT
729001	-	01	APPLICATIONS FOR TYPES A AND B METAL POSTS (FOR SIGNS & MARKERS)
780001	-	05	TYPICAL PAVEMENT MARKINGS
782006	-		GUARDRAIL AND BARRIER WALL REFLECTOR MOUNTING DETAILS

MODEL: Default
 FILE NAME: p:\110848E8D\NTEG\Illinois.gov\PIW\DOT\Documents\DOT_Offices\District 2\Projects\64N28\Program_Development\Studies & Plans\Design\CADD\CAD\Sheet\02_64N28-shr-cover.dgn

USER NAME = vaceksk	DESIGNED -	REVISED -
	DRAWN - JDH	REVISED -
PLOT SCALE = 4800.0000' / in.	CHECKED -	REVISED -
PLOT DATE = Dec-21-2018 01:10:36 PM	DATE -	REVISED -

**STATE OF ILLINOIS
DEPARTMENT OF TRANSPORTATION**

**INDEX OF SHEETS &
STATE STANDARDS**

SCALE: [SHEET OF SHEETS] STA. TO STA.

F.A.P. RTE.	SECTION	COUNTY	TOTAL SHEETS	SHEET NO.
694	D2 BDR 2019-4	LEE	26	2
			CONTRACT NO. 64N28	
[ILLINOIS] [FED. AID PROJECT]				

GENERAL NOTES

The final top 4 inches of soil in any right-of-way area disturbed by the Contractor must be capable of supporting vegetation. The soil must be from the A horizon (zero to 2' deep) of soil profiles of local soils. The cost of this work shall be included in the unit prices bid and no additional compensation will be allowed.

All "Aggregate Subgrade Improvement" (Section 303), shall be completed in accordance with Articles 311.04, 311.05, 311.05(a), 311.06 and 311.07. All aggregate subgrade thicknesses equal to or less than 12 inches shall be constructed of aggregate of CA02 gradation. All aggregate subgrade thicknesses greater than 12 inches shall be constructed of CS02.

This structure will retain the same number 052-0060

Pavement Marking shall be done according to Standard 780001, except as follows:

1. All words, such as ONLY, shall be 8 feet high.
2. All non-freeway arrows shall be the large size.
3. The distance between yellow no-passing lines shall be 8 inches, not 7 inches, as shown in the detail of Typical Lane and Edge Lines.
4. Centerline Skip Dash Pavement Marking on multi-lane divided, multi-lane undivided, and one-way roadway shall be according to District Standard 41.1.

Hazards behind Temporary Concrete Barrier Wall

No materials, equipment, vehicles or other hazards shall be within 3' – 6" of the temporary concrete barrier wall measured from the closest point of the barrier wall perpendicular to the hazard. Equipment that is actively working with the 3' – 6" of the barrier wall may be allowed for a short duration, if approved by the engineer, required for the work activity, if there is not another method to complete the work.

The following Mixture Requirements are applicable for this project:

Location(s):	
Mixture Use(s):	Surface
PG:	PG 64-22
Design Air Voids:	4.0 @N50
Mixture Composition (Mixture Gradation):	IL 9.5
Friction Aggregate:	C
Mixture Weight:	112 lbs.
Quality Management Program:	QC/QA
Sublot Size:	N/A
Number of Roller Passes ¹⁾ :	N/A

- 1) When a number of roller passes is specified, the Contractor may opt to use intelligent compaction in lieu of density testing under the Quality Control for Performance (QCP) program.

FILE NAME = 64N28.GN.DOCX	USER NAME =	DESIGNED - Engineering Systems	REVISED -	STATE OF ILLINOIS DEPARTMENT OF TRANSPORTATION	GENERAL NOTES	ROUTE	SECTION	COUNTY	TOTAL SHEETS	SHEET NO.	
		DRAWN -	REVISED -			FAP Route 694 (US 52)	D2 BDR 2019-4	Lee	26	3	
	PLOT SCALE =	CHECKED -	REVISED -			CONTRACT NO. #64N28					
	PLOT DATE = 12/21/2018 2:01 PM	DATE - 12/3/2018 12:30 PM	REVISED -			ILLINOIS FED. AID PROJECT					
						SCALE:	SHEET NO.	OF	SHEETS	STA.	TO STA.

SUMMARY OF QUANTITIES

CONSTRUCTION CODE
S.N. 052-0060
100% STATE BRIDGE
0059
RURAL

CODE NO.	ITEM	UNIT	TOTAL	RURAL
20200500	EARTH EXCAVATION (WIDENING)	CU YD	100	100
40600982	HOT-MIX ASPHALT SURFACE REMOVAL - BUTT JOINT	SQ YD	144.4	144.4
40600990	TEMPORARY RAMP	SQ YD	58	58
40603310	HOT-MIX ASPHALT SURFACE COURSE, MIX "C", N50	TON	17	17
40800025	BITUMINOUS MATERIALS (PRIME COAT)	POUND	88	88
50102400	CONCRETE REMOVAL	CU YD	10.5	10.5
50300255	CONCRETE SUPERSTRUCTURE	CU YD	11.6	11.6
50300260	BRIDGE DECK GROOVING	SQ YD	633	633
50300300	PROTECTIVE COAT	SQ YD	688	688
50800205	REINFORCEMENT BARS, EPOXY COATED	POUND	1430	1430
50800515	BAR SPLICERS	EACH	28	28
52000110	PREFORMED JOINT STRIP SEAL	FOOT	67	67
67000400	ENGINEER'S FIELD OFFICE, TYPE A	CA MO	3	3
67100100	MOBILIZATION	L SUM	1	1
70100405	TRAFFIC CONTROL AND PROTECTION, STANDARD 701321	EACH	1	1

* SPECIALTY ITEM

MODEL: C:\p1\it FILE NAME: p:\1108\EBRD\NTEC\Illinois.gov\PWIDOT\Documents\DOT_Offices\District 2\Projects\64N28\program_Developments\Studies & Plans\Design\CADD\CAD\Sheet\02-64N28-sh-SQG.dgn

USER NAME = vaceksk	DESIGNED -	REVISED -
	DRAWN - JDH	REVISED -
PLOT SCALE = 100.0000' / in.	CHECKED -	REVISED -
PLOT DATE = Dec-21-2018 01:31:22 PM	DATE -	REVISED -

**STATE OF ILLINOIS
DEPARTMENT OF TRANSPORTATION**

SUMMARY OF QUANTITIES

SCALE: SHEET OF SHEETS STA. TO STA.

F.A.P. RTE.	SECTION	COUNTY	TOTAL SHEETS	SHEET NO.
694	D2 BDR 2019-4	LEE	26	4
CONTRACT NO. 64N28				
ILLINOIS FED. AID PROJECT				

SUMMARY OF QUANTITIES

CONSTRUCTION CODE
S.N. 052-0060
100% STATE BRIDGE
0059
RURAL

CODE NO.	ITEM	UNIT	TOTAL	RURAL
70100450	TRAFFIC CONTROL AND PROTECTION, STANDARD 701201	L SUM	1	1
70100500	TRAFFIC CONTROL AND PROTECTION, STANDARD 701326	L SUM	1	1
70106500	TEMPORARY BRIDGE TRAFFIC SIGNALS	EACH	2	2
70106700	TEMPORARY RUMBLE STRIPS	EACH	3	3
70107005	PAVEMENT MARKING BLACKOUT TAPE, 5"	FOOT	860	860
70300150	SHORT TERM PAVEMENT MARKING REMOVAL	SQ FT	1318	1318
70300904	PAVEMENT MARKING TAPE, TYPE IV 4"	FOOT	2078	2078
70300924	PAVEMENT MARKING TAPE, TYPE IV 24"	FOOT	26	26
70400100	TEMPORARY CONCRETE BARRIER	FOOT	425	425
70400200	RELOCATE TEMPORARY CONCRETE BARRIER	FOOT	438	438
70600242	IMPACT ATTENUATORS, TEMPORARY (NON- REDIRECTIVE, NARROW), TEST LEVEL 2	EACH	2	2
70600341	IMPACT ATTENUATORS, RELOCATE (NON- REDIRECTIVE, NARROW), TEST LEVEL 2	EACH	2	2
* 78001110	PAINT PAVEMENT MARKING - LINE 4"	FOOT	4820	4820

* SPECIALTY ITEM

MODEL: Default
FILE NAME: P:\1108\B&E\DOT\Illinois.gov\PIWDOT\Documents\DOT_Offices\District 2\Projects\616\N28\Program_Development\Studies & Plans\Design\CADD\Cadd\Sheets\02-64N28-sh-500.dgn

USER NAME = vaceksk	DESIGNED -	REVISED -
	DRAWN - JDH	REVISED -
PLOT SCALE = 100.0000' / in.	CHECKED -	REVISED -
PLOT DATE = Dec-21-2018 01:32:05 PM	DATE -	REVISED -

**STATE OF ILLINOIS
DEPARTMENT OF TRANSPORTATION**

SUMMARY OF QUANTITIES

SCALE: SHEET OF SHEETS STA. TO STA.

F.A.P. RTE.	SECTION	COUNTY	TOTAL SHEETS	SHEET NO.
694	D2 BDR 2019-4	LEE	26	5
CONTRACT NO. 64N28				
ILLINOIS FED. AID PROJECT				

SUMMARY OF QUANTITIES

CONSTRUCTION CODE
S.N. 052-0060
100% STATE
BRIDGE
0059
RURAL

CODE NO.	ITEM	UNIT		
Z0012130	BRIDGE DECK SCARIFICATION 3/4"	SQ YD	661.5	661.5
Z0016001	DECK SLAB REPAIR (FULL DEPTH, TYPE I)	SQ YD	35	35
Z0006012	BRIDGE DECK LATEX CONCRETE OVERLAY, 2 1/4 INCHES	SQ YD	661.5	661.5
Z0016002	DECK SLAB REPAIR (FULL DEPTH, TYPE II)	SQ YD	5	5
Z0062456	TEMPORARY PAVEMENT	SQ YD	286	286

* SPECIALTY ITEM

MODEL: Default
 FILE NAME: P:\1108\BIDD\NTEC\Illinois.gov\PWD\DOT\Documents\DOT Offices\District 2\Projects\64N28\Program Development\Studies & Plans\Design\CADD\Cadd\Sheet\02-64N28-sh-SQ.dgn

	USER NAME = vaceksk DESIGNED - DRAWN - JDH CHECKED - DATE -	REVISED - REVISED - REVISED - REVISED -	STATE OF ILLINOIS DEPARTMENT OF TRANSPORTATION	SUMMARY OF QUANTITIES	F.A.P. RTE. 694	SECTION D2 BDR 2019-4	COUNTY LEE	TOTAL SHEETS 26	SHEET NO. 6	
				SCALE:	SHEET	OF	SHEETS	STA.	TO STA.	ILLINOIS FED. AID PROJECT CONTRACT NO. 64N28

STAGING TYPICALS

PRE-STAGE SHOULDER WIDENING

STA 997+70 - 999+13 NB
 STA 1001+03 - 1002+45 NB
 STA 997+70 - 999+11 SB
 STA 1001+01 - 1002+45 SB

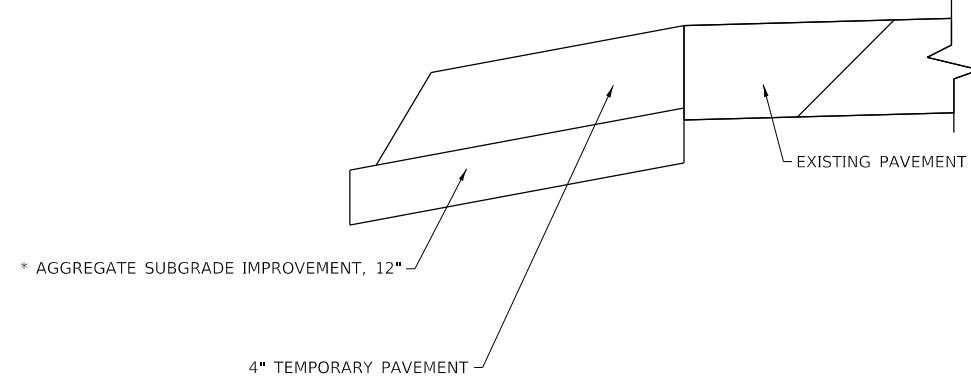

STAGE I (SN 052-0060 OVER GREEN RIVER)

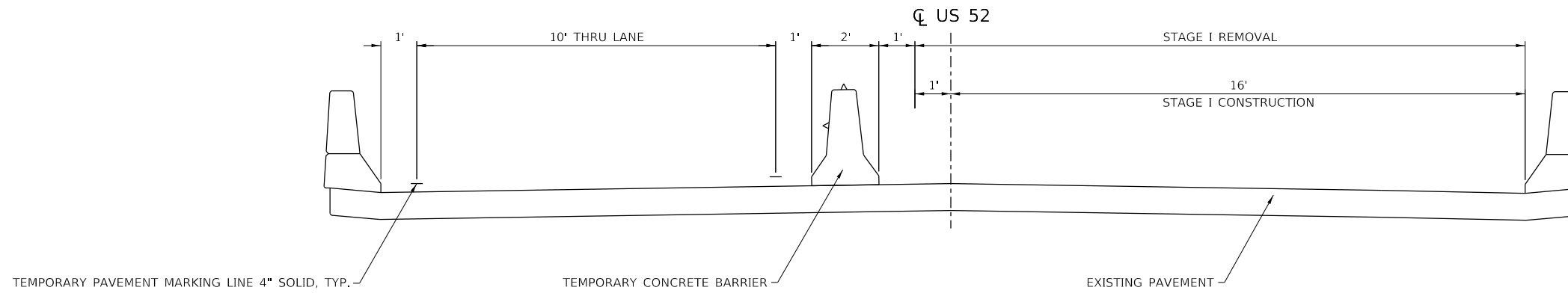

STAGE II (SN 052-0060 OVER GREEN RIVER)

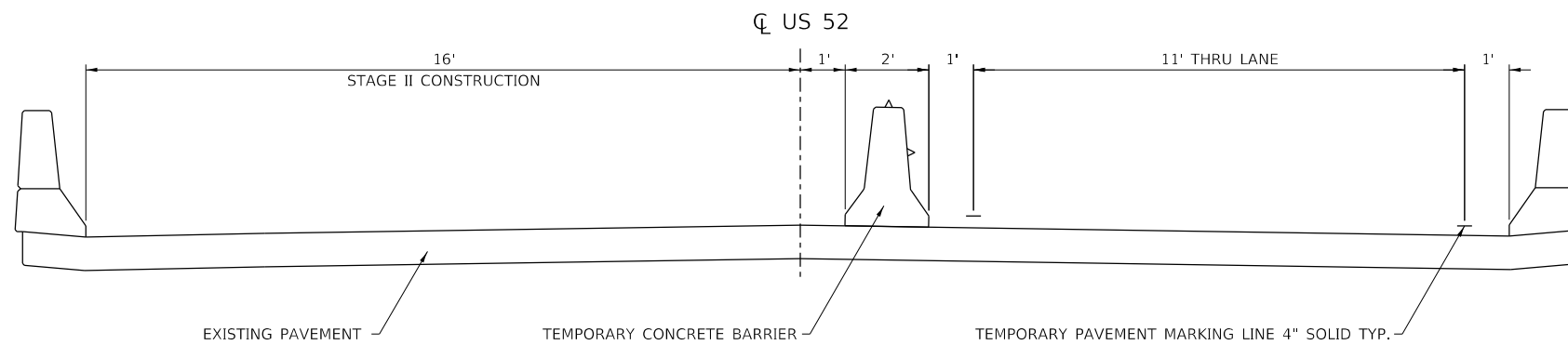

NOTE:

* INCLUDED IN THE COST OF TEMPORARY PAVEMENT

MODEL: Default
 FILE: \\nas0101\B&E\BID\NTEC\Illinois\gov\PIV\DOT\Documents\BID\Office\Director\Projects\16\128\Program_Development\Stufiles & Plans\Design\CADD\CADD\Sheet\02_64N28-sh-typ1.dgn

USER NAME = vacekss	DESIGNED -	REVISED -
	DRAWN - JDH	REVISED -
PLOT SCALE = 4.0000' / in.	CHECKED -	REVISED -
PLOT DATE = Dec-21-2018 01:37:47 PM	DATE -	REVISED -

**STATE OF ILLINOIS
 DEPARTMENT OF TRANSPORTATION**

STAGING TYPICALS

SCALE: 1"=40' SHEET OF SHEETS STA. TO STA.

F.A.P. RTE.	SECTION	COUNTY	TOTAL SHEETS	SHEET NO.
694	D2 BDR 2019-4	LEE	26	7
CONTRACT NO. 64N28			ILLINOIS FED. AID PROJECT	

TRAFFIC CONTROL PLAN FOR SN 052-0060 STAGE I

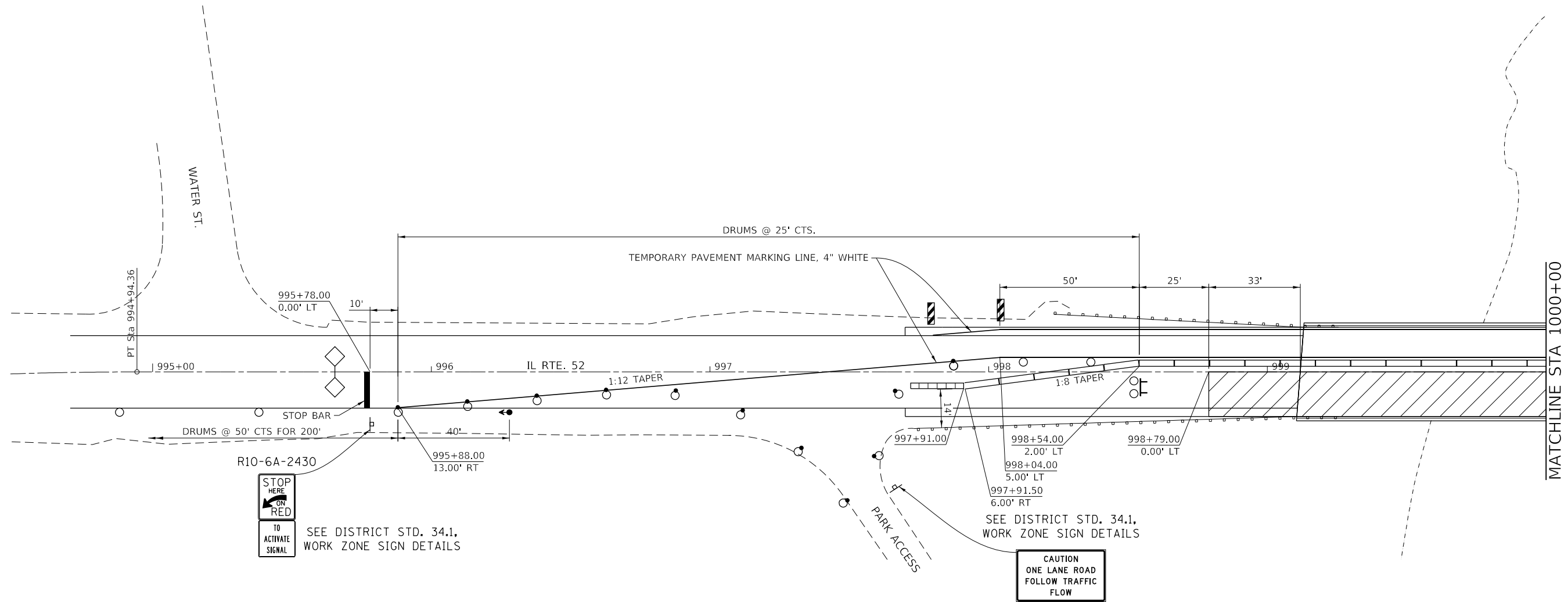
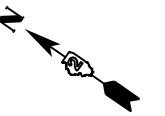

STOP HERE ON RED TO ACTIVATE SIGNAL
SEE DISTRICT STD. 34.1, WORK ZONE SIGN DETAILS

CAUTION ONE LANE ROAD FOLLOW TRAFFIC FLOW

GENERAL NOTES

See Traffic Control and Protection Standard 701321 for details not shown.

Traffic signals shall be operational only when all traffic controls are in place. When traffic signals are not in operation, flaggers shall be used and traffic control shall conform to Standard 701201 or 701206.

Temporary concrete barrier shall be according to Standard 704001.

Existing or temporary pavement markings shall be on both sides of open lane from stop bar to stop bar.

All dimensions are in inches (millimeters) unless otherwise shown.

SYMBOLS

- Work area
- Sign
- Type III barricade
- Traffic signal
- Detector loops
- Impact attenuator Absorb 350 - TL 2
- Drum with steady burning bi-directional light
- Temporary concrete barrier
- Temporary rumble strip (when specified)
- Double vertical panel (see detail on Std. 701316)
- Crystal, bidirectional barrier wall/guardrail marker
- Drum

MODEL: Default
FILE: \\nas01\B&E\BID\NTEC\Illinois\poc\p\W\DOT\Documents\DOT_Offices\District 2\Projects\616\N28\Program_Development\Snuffles & Plans\Drawn\CADD\CAD\Drawings\02_64N28-Substation.dgn

USER NAME = vaceksk	DESIGNED - _____	REVISED - _____
	DRAWN - JDH	REVISED - _____
PLOT SCALE = 40,0000' / in.	CHECKED - _____	REVISED - _____
PLOT DATE = Dec-21-2018 01:44:24 PM	DATE - _____	REVISED - _____

STATE OF ILLINOIS
DEPARTMENT OF TRANSPORTATION

TRAFFIC CONTROL PLAN FOR SN 052-0060
STAGE I

SCALE: 1"=40' SHEET ___ OF ___ SHEETS STA. _____ TO STA. _____

F.A.P. RTE.	SECTION	COUNTY	TOTAL SHEETS	SHEET NO.
694	D2_BDR_2019-4	LEE	26	10
CONTRACT NO. 64N28				
ILLINOIS FED. AID PROJECT				

TRAFFIC CONTROL PLAN FOR SN 052-0060 STAGE I

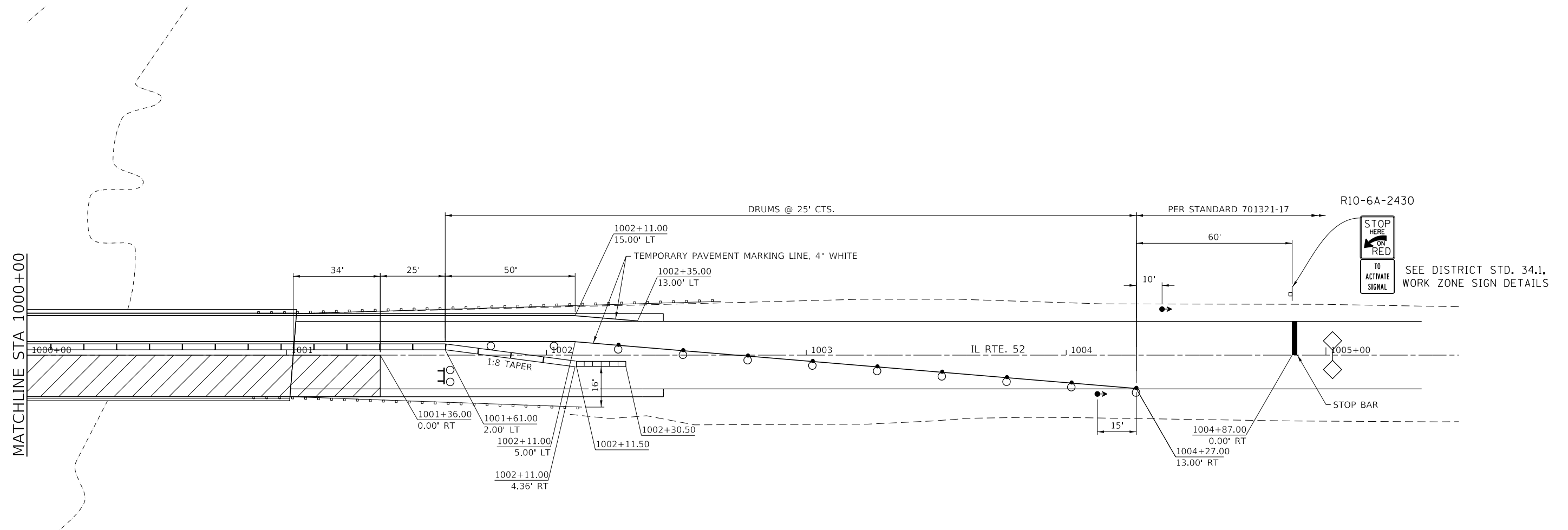
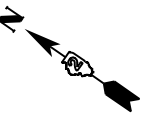

STOP
HERE
ON
RED
TO
ACTIVATE
SIGNAL

SEE DISTRICT STD. 34.1,
WORK ZONE SIGN DETAILS

GENERAL NOTES

See Traffic Control and Protection Standard 701321 for details not shown.

Traffic signals shall be operational only when all traffic controls are in place. When traffic signals are not in operation, flaggers shall be used and traffic control shall conform to Standard 701201 or 701206.

Temporary concrete barrier shall be according to Standard 704001.

Existing or temporary pavement markings shall be on both sides of open lane from stop bar to stop bar.

All dimensions are in inches (millimeters) unless otherwise shown.

SYMBOLS	
	Work area
	Sign
	Type III barricade
	Traffic signal
	Detector loops
	Impact attenuator Absorb 350 - TL 2
	Drum with steady burning bi-directional light
	Temporary concrete barrier
	Temporary rumble strip (when specified)
	Double vertical panel (see detail on Std. 701316)
	Crystal, bidirectional barrier wall/guardrail marker
	Drum

MODEL: Default
 FILE: \\nas01.cba.uillinois.edu\BID\NTEC\Illinois\gov\PIV\DOT\Documents\BID\Office\District 2\Projects\616\N28\Program_Development\Snuffles & Plans\Defm\CADD\Cadd\Sheet\02_64N28-1-11.ctb\snuff.dgn

USER NAME = vaceksk	DESIGNED - _____	REVISED - _____
	DRAWN - JDH	REVISED - _____
PLOT SCALE = 40.0000 ' / in.	CHECKED - _____	REVISED - _____
PLOT DATE = Dec-21-2018 01:45:13 PM	DATE - _____	REVISED - _____

STATE OF ILLINOIS
DEPARTMENT OF TRANSPORTATION

TRAFFIC CONTROL PLAN FOR SN 052-0060 STAGE I	
SCALE: 1"=40'	SHEET ___ OF ___ SHEETS
STA. _____	TO STA. _____

F.A.P. RTE.	SECTION	COUNTY	TOTAL SHEETS	SHEET NO.
694	D2_BDR_2019-4	LEE	26	11
CONTRACT NO. 64N28				
ILLINOIS FED. AID PROJECT				

TRAFFIC CONTROL PLAN FOR SN 052-0060 STAGE II

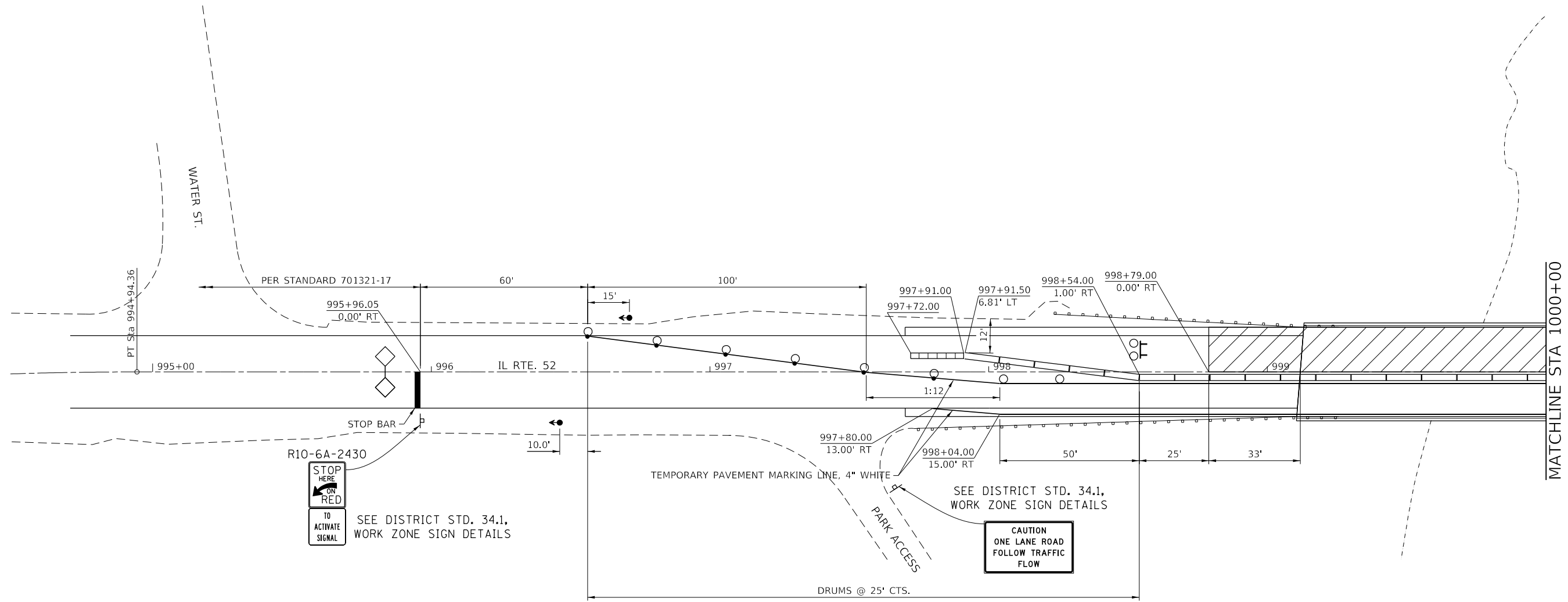
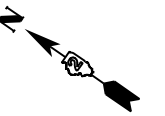

GENERAL NOTES

See Traffic Control and Protection Standard 701321 for details not shown.

Traffic signals shall be operational only when all traffic controls are in place. When traffic signals are not in operation, flaggers shall be used and traffic control shall conform to Standard 701201 or 701206.

Temporary concrete barrier shall be according to Standard 704001.

Existing or temporary pavement markings shall be on both sides of open lane from stop bar to stop bar.

All dimensions are in inches (millimeters) unless otherwise shown.

SYMBOLS

- Work area
- Sign
- Type III barricade
- Traffic signal
- Detector loops
- Impact attenuator Absorb 350 - TL 2
- Drum with steady burning bi-directional light
- Temporary concrete barrier
- Temporary rumble strip (when specified)
- Double vertical panel (see detail on Std. 701316)
- Crystal, bidirectional barrier wall/guardrail marker
- Drum

USER NAME = vacekss PLOT SCALE = 40,0000' / in. PLOT DATE = Dec-21-2018 01:45:51 PM	DESIGNED - _____ DRAWN - JDH CHECKED - _____ DATE - _____	REVISED - _____ REVISED - _____ REVISED - _____ REVISED - _____	STATE OF ILLINOIS DEPARTMENT OF TRANSPORTATION	TRAFFIC CONTROL PLAN FOR SN 052-0060 STAGE II	F.A.P. RTE. 694 SECTION D2_BDR_2019-4 COUNTY LEE TOTAL SHEETS 26 SHEET NO. 12 CONTRACT NO. 64N28 ILLINOIS FED. AID PROJECT
SCALE: 1"=40' SHEET ___ OF ___ SHEETS STA. _____ TO STA. _____					

TRAFFIC CONTROL PLAN FOR SN 052-0060 STAGE II

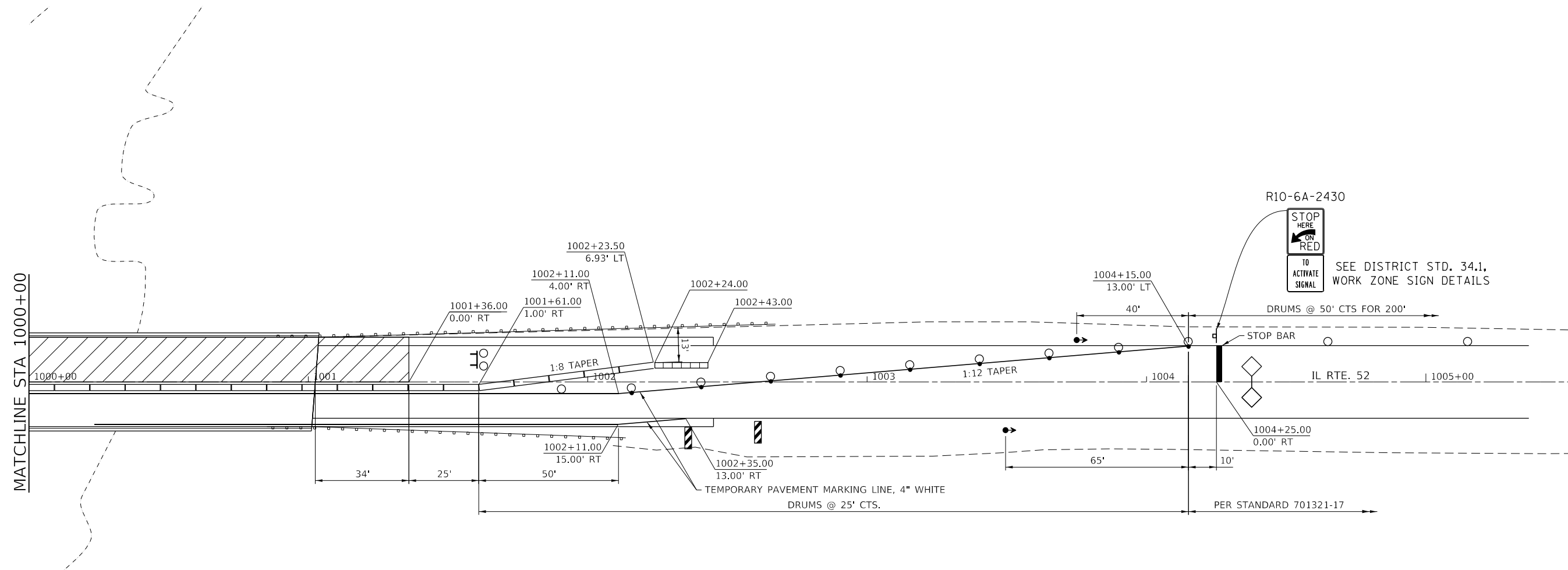
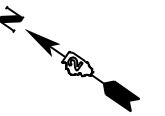

GENERAL NOTES

See Traffic Control and Protection Standard 701321 for details not shown.

Traffic signals shall be operational only when all traffic controls are in place. When traffic signals are not in operation, flaggers shall be used and traffic control shall conform to Standard 701201 or 701206.

Temporary concrete barrier shall be according to Standard 704001.

Existing or temporary pavement markings shall be on both sides of open lane from stop bar to stop bar.

All dimensions are in inches (millimeters) unless otherwise shown.

SYMBOLS

- Work area
- Sign
- Type III barricade
- Traffic signal
- Detector loops
- Impact attenuator
Absorb 350 - TL 2
- Drum with steady burning bi-directional light
- Temporary concrete barrier
- Temporary rumble strip (when specified)
- Double vertical panel (see detail on Std. 701316)
- Crystal, bidirectional barrier wall/guardrail marker
- Drum

MODEL: Default
 FILE NAME: P:\IL\B&E\BID\NTEC\Illinois\poc\RW\DOT\Documents\DOT_Offices\District 2\Projects\616\N28\Program_Development\Snuffles & Plans\Defm\CADD\CAD\Drawings\02_64N28-SubstaPlan.dgn

USER NAME = vaceksk	DESIGNED - _____	REVISED - _____
DRAWN - JDH	REVISIONS - _____	REVISIONS - _____
PLOT SCALE = 40,0000 ' / in.	CHECKED - _____	REVISIONS - _____
PLOT DATE = Dec-21-2018 01:46:27 PM	DATE - _____	REVISIONS - _____

**STATE OF ILLINOIS
DEPARTMENT OF TRANSPORTATION**

TRAFFIC CONTROL PLAN FOR SN 052-0060 STAGE II	
SCALE: 1"=40'	SHEET ___ OF ___ SHEETS STA. _____ TO STA. _____

F.A.P. RTE.	SECTION	COUNTY	TOTAL SHEETS	SHEET NO.
694	D2_BDR_2019-4	LEE	26	12
CONTRACT NO. 64N28			ILLINOIS FED. AID PROJECT	

GENERAL NOTES

Reinforcement bars designated (E) shall be epoxy coated.
 Prior to pouring the new concrete deck, all heavy or loose rust, loose mill scale, and other loose or potentially detrimental foreign material shall be removed from the surfaces in contact with concrete. Tightly adhered paint may remain unless otherwise noted. Removal shall be accomplished by methods that will not damage the steel and the cost will be included in the pay item covering removal of the existing concrete.
 Plan dimensions and details relative to existing plans are subject to nominal construction variations. The Contractor shall field verify existing dimensions and details affecting new construction and make necessary approved adjustments prior to construction or ordering of materials. Such variations shall not be cause for additional compensation for a change in scope of the work, however, the Contractor will be paid for the quantity actually furnished at the unit price bid for the work.
 Existing reinforcement bars extending into the removal area shall be cleaned, straightened and incorporated into the new construction. Any reinforcement bars that are damaged during concrete removal shall be replaced with an approved bar splicer or anchorage system. Cost included with Concrete Removal.
 Joint openings shall be adjusted according to Article 520.04 of the Std. Specs. when the deck is poured at an ambient temperature other than 50° F.
 Cost of removal and re-installation of all members necessary to complete the work as detailed on the plans and as specified in the Special Provisions shall be included with Concrete Removal.
 Synthetic fibers shall be added to the Bridge Deck Latex Concrete Overlay. See Special Provisions.
 Areas of deck repairs are estimated. The Engineer shall show actual locations of deck repairs on as-built plans.

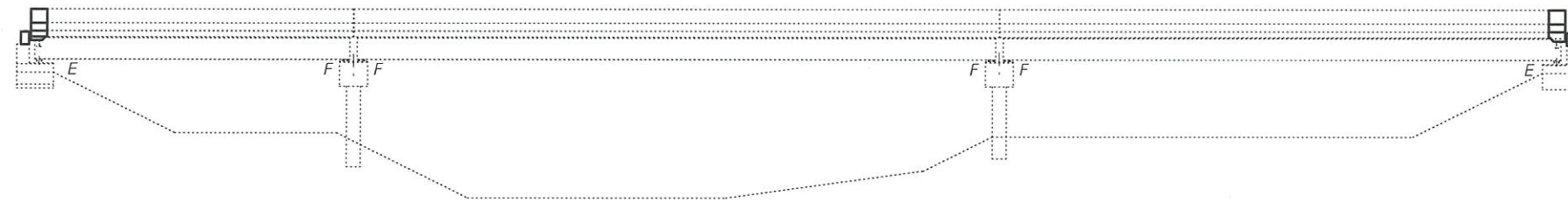

ELEVATION

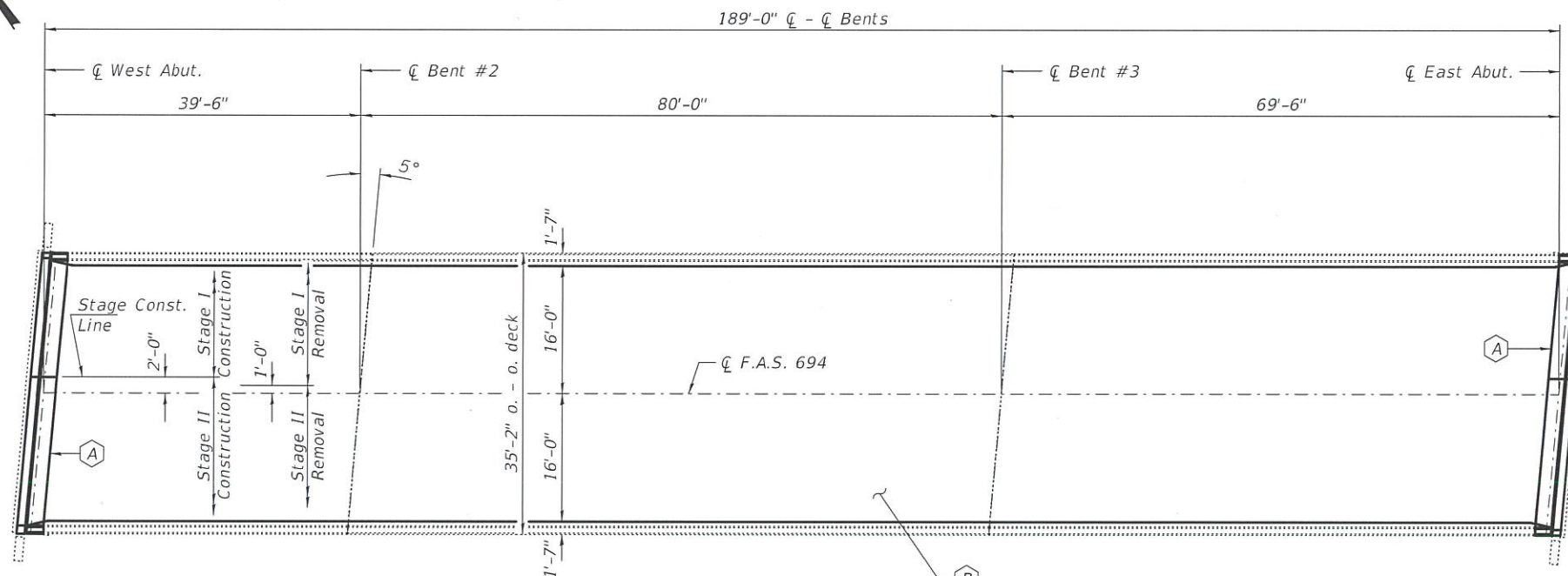

PLAN

- (A) - Remove and Replace Expansion Joints at Abutments.
- (B) - Install a new 2 1/4" Latex Overlay on the existing deck. (See sheet 2 & 3 of 6 for details.)



TOTAL BILL OF MATERIAL

ITEM	UNIT	QUANTITY
Concrete Removal	Cu. Yd.	10.5
Concrete Superstructure	Cu. Yd.	11.6
Preformed Joint Strip Seal	Foot	67
Reinforcement Bars, Epoxy Coated	Pound	1430
Bar Splicers	Each	28
Protective Coat	Sq. Yd.	688
Bridge Deck Scarification, 3/4"	Sq. Yd.	661.5
Bridge Deck Latex Concrete Overlay, 2 1/4"	Sq. Yd.	661.5
Bridge Deck Grooving	Sq. Yd.	633
Deck Slab Repair (Full Depth, Type I)	Sq. Yd.	35
Deck Slab Repair (Full Depth, Type II)	Sq. Yd.	5

* Apply to new concrete and concrete overlay surfaces only.

EXPIRES 11-30-2020

DESIGNED - *[Signature]*
 CHECKED - *[Signature]*
 DRAWN - *[Signature]*
 CHECKED - *[Signature]*

EXAMINED - *[Signature]*
 PASSED - *[Signature]*

DATE - JANUARY 29, 2019
 REVISED -
 REVISED -

STATE OF ILLINOIS
 DEPARTMENT OF TRANSPORTATION

GENERAL PLAN AND ELEVATION
 FAP 694 OVER GREEN RIVER
 SN 052-0060

SHEET NO. 1 OF 6 SHEETS

F.A.P. RTE.	SECTION	COUNTY	TOTAL SHEETS	SHEET NO.
694	D2 BDR 2019-4	LEE	26	14
CONTRACT NO. 64N28			ILLINOIS FED. AID PROJECT	

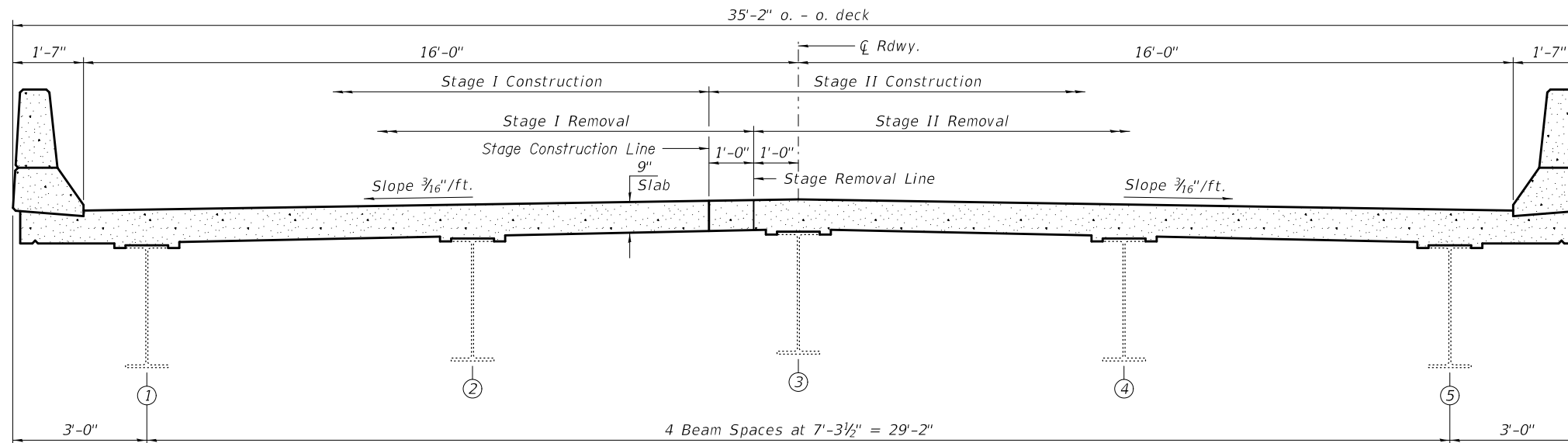

CROSS SECTION AT ABUTMENTS
(Looking East)

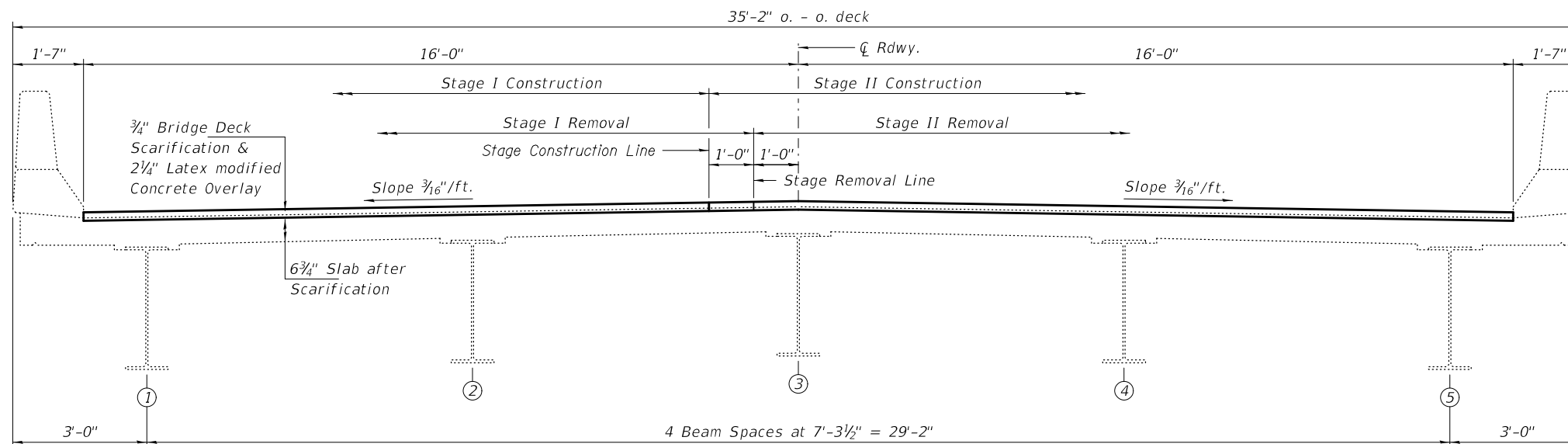

CROSS SECTION NEAR ABUTMENTS
(Looking East)

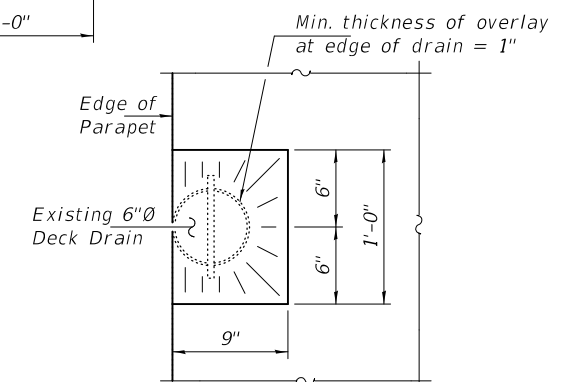

OVERLAY TREATMENT AT DRAINS

DESIGNED - JSB	EXAMINED	DATE - JANUARY 29, 2019
CHECKED - SMR	<i>Timothy A. Daburdell</i> ENGINEER OF STRUCTURAL SERVICES	
DRAWN - <i>daburdell</i>	PASSED	REVISED -
CHECKED - JSB SMR	<i>Carl Ringer</i> ENGINEER OF BRIDGES AND STRUCTURES	REVISED -

STATE OF ILLINOIS
DEPARTMENT OF TRANSPORTATION

CROSS SECTIONS & STAGING DETAILS
SN 052-0060

SHEET NO. 2 OF 6 SHEETS

F.A.P. RTE.	SECTION	COUNTY	TOTAL SHEETS	SHEET NO.
694	D2 BDR 2019-4	LEE	26	15
CONTRACT NO. 64N28				
ILLINOIS FED. AID PROJECT				

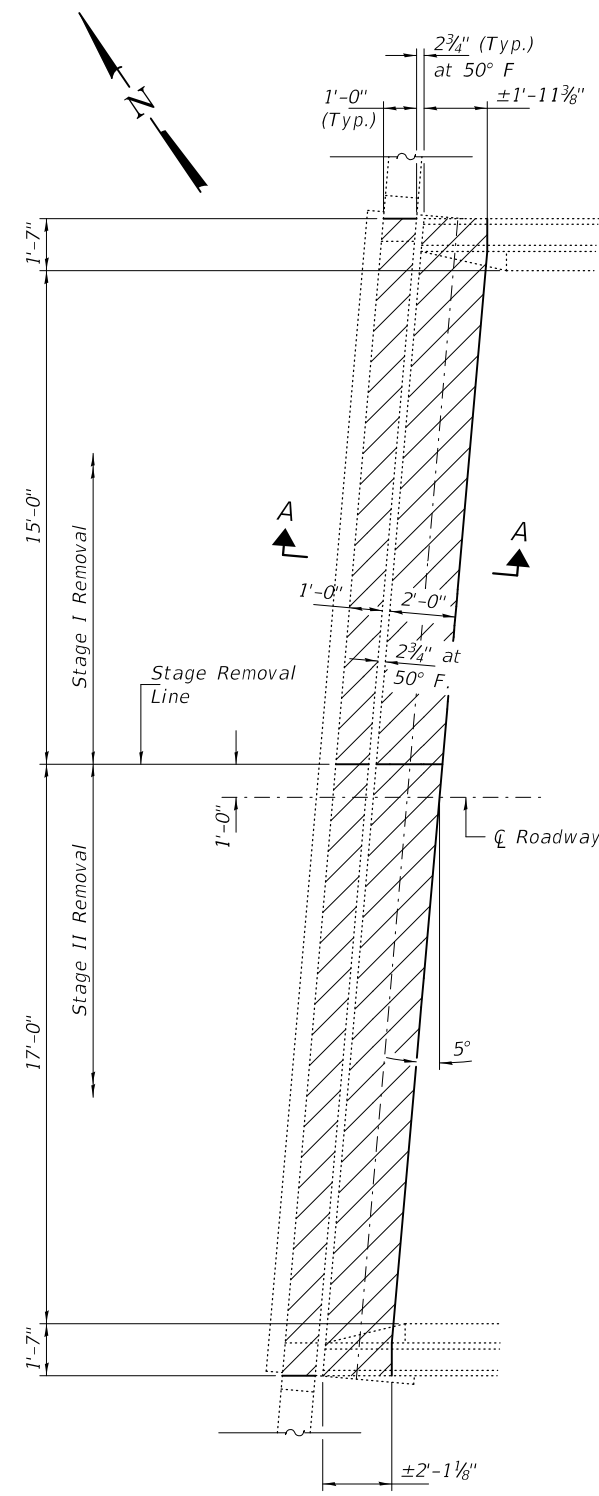

CONCRETE REMOVAL DETAILS

(West Abutment shown, East Abutment similar)

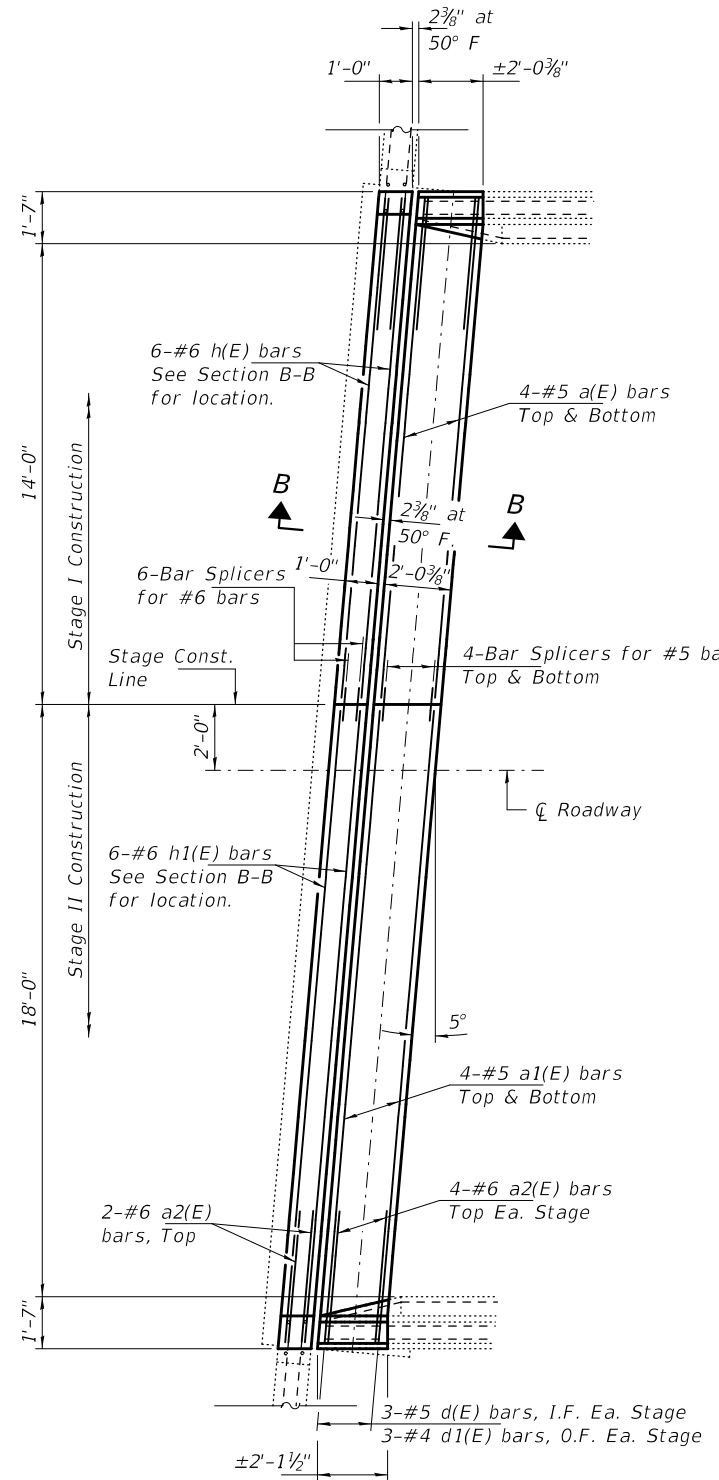

CONCRETE REPLACEMENT DETAILS

(West Abutment shown, East Abutment similar)

Note:
Hatched areas indicate
Concrete Removal.

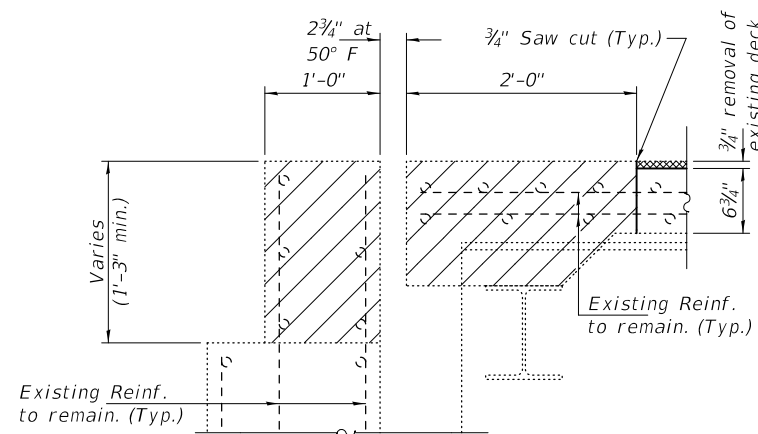

SECTION A-A

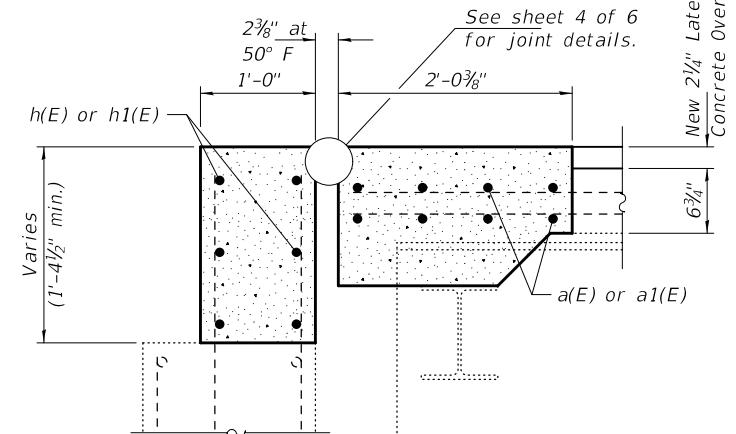

SECTION B-B

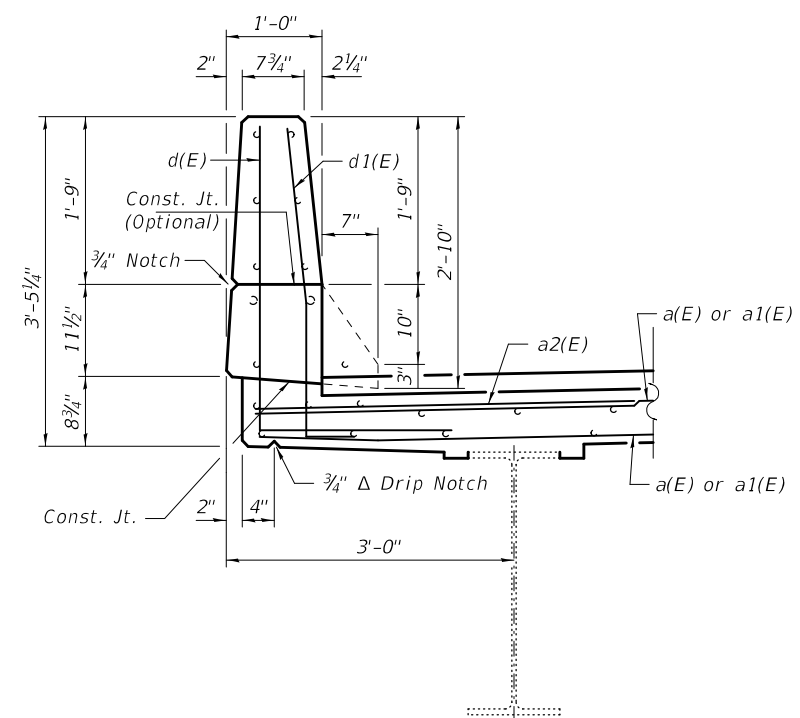

SECTION THRU BRIDGE PARAPET

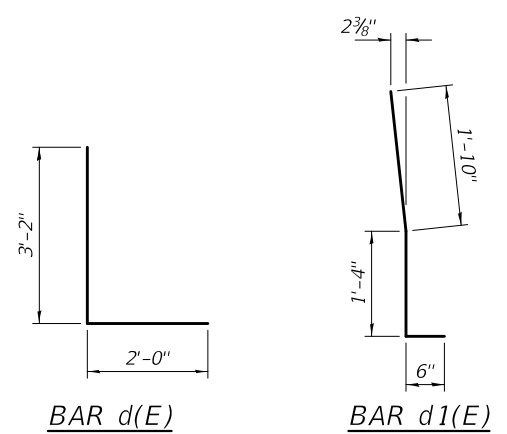

BILL OF MATERIAL (BOTH ABUTMENTS)

Bar	No.	Size	Length	Shape
a(E)	16	#5	15'-1"	—
a1(E)	16	#5	19'-1"	—
a2(E)	24	#6	4'-0"	—
h(E)	12	#6	15'-3"	—
h1(E)	12	#6	19'-4"	—
d(E)	12	#5	5'-2"	L
d1(E)	12	#4	3'-8"	L
Concrete Removal			Cu. Yd.	10.5
Concrete Superstructure			Cu. Yd.	11.6
Bar Splicers			Each	28
Reinforcement Bars, Epoxy Coated			Pound	1430

DESIGNED - JSB
CHECKED - SMR
DRAWN - daburdell
CHECKED - JSB SMR

EXAMINED
PASSED
Timothy A. Daburdell
ENGINEER OF STRUCTURAL SERVICES
Carl R. Meyer
ENGINEER OF BRIDGES AND STRUCTURES

DATE - JANUARY 29, 2019
REVISED -
REVISED -

STATE OF ILLINOIS
DEPARTMENT OF TRANSPORTATION

JOINT REPLACEMENT DETAILS - ABUTMENTS
SN 052-0060

SHEET NO. 3 OF 6 SHEETS

F.A.P. RTE. SECTION COUNTY TOTAL SHEETS SHEET NO.
694 D2 BDR 2019-4 LEE 26 16
CONTRACT NO. 64N28
ILLINOIS FED. AID PROJECT

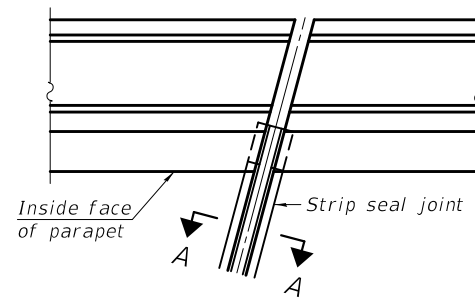

FOR SKEWS $\leq 30^\circ$
PLAN AT PARAPET

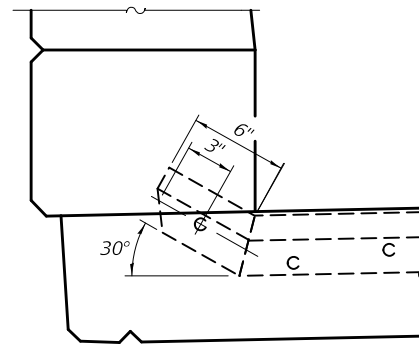

ELEVATION AT PARAPET
 (Skews $\leq 30^\circ$)

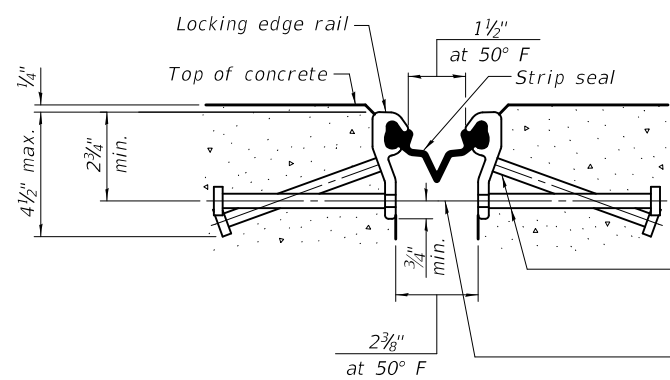

SHOWING ROLLED RAIL JOINT

* $\frac{5}{8}$ " ϕ x 6" studs @ 6" cts. (alternate angled/bent studs with horizontal studs)
 $\frac{3}{8}$ " ϕ threaded rods in $\frac{7}{16}$ " ϕ holes at ± 4 "-0" cts. for holding the proper joint opening based on the temperature during the deck pour. Place to miss studs. All rods shall be burned, or sawed off flush with the plates after concrete is set.

SECTION A-A

* Granular or solid flux filled headed studs conforming to Article 1006.32 of the Std. Specs., automatically end welded.

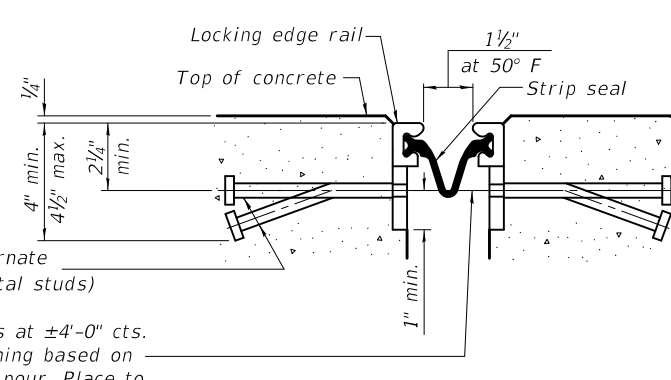

SHOWING WELDED RAIL JOINT

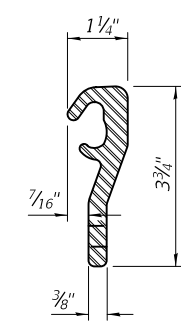

ROLLED (EXTRUDED) RAIL

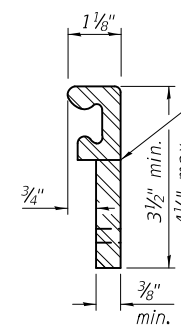

WELDED RAIL

LOCKING EDGE RAILS

** Back gouge not required if complete joint penetration is verified by mock-up.

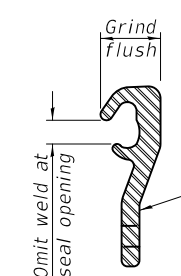

LOCKING EDGE RAIL SPLICE

The inside of the locking edge rail groove shall be free of weld residue. Rolled rail shown, welded rail similar.

BILL OF MATERIAL

Item	Unit	Total
Preformed Joint Strip Seal	Foot	67

EJ-SS1 LT30/REPS

6-22-18

DESIGNED - JSB
 CHECKED - SMR
 DRAWN - daburdell
 CHECKED - JSB SMR

EXAMINED
 PASSED
 Timothy A. Daulton
 ENGINEER OF STRUCTURAL SERVICES
 Carl R. Meyer
 ENGINEER OF BRIDGES AND STRUCTURES

DATE - JANUARY 29, 2019
 REVISED -
 REVISED -

STATE OF ILLINOIS
 DEPARTMENT OF TRANSPORTATION

PREFORMED JOINT STRIP SEAL
 SN 052-0060

SHEET NO. 4 OF 6 SHEETS

F.A.P. RTE.	SECTION	COUNTY	TOTAL SHEETS	SHEET NO.
694	D2 BDR 2019-4	LEE	26	17
ILLINOIS			CONTRACT NO. 64N28	
FED. AID PROJECT				

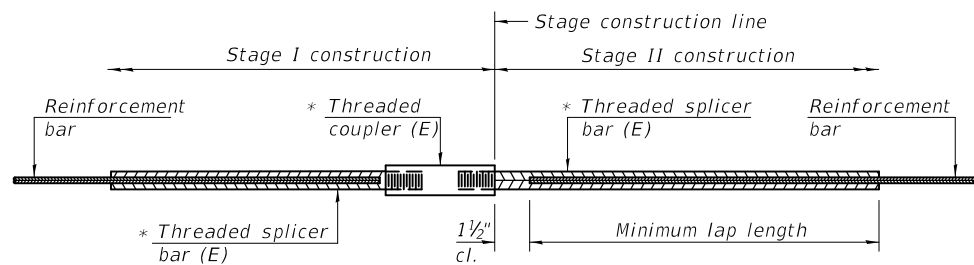

STANDARD BAR SPLICER ASSEMBLY

Threaded splicer bar length = min. lap length + 1 1/2" + thread length

* Epoxy not required on Bar Splicer Assembly components used in conjunction with black bars.

Location	Bar size	No. assemblies required	Minimum lap length
W. Abut.	#5	8	3'-6"
W. Abut.	#6	6	4'-0"
E. Abut.	#5	8	3'-6"
E. Abut.	#6	6	4'-0"

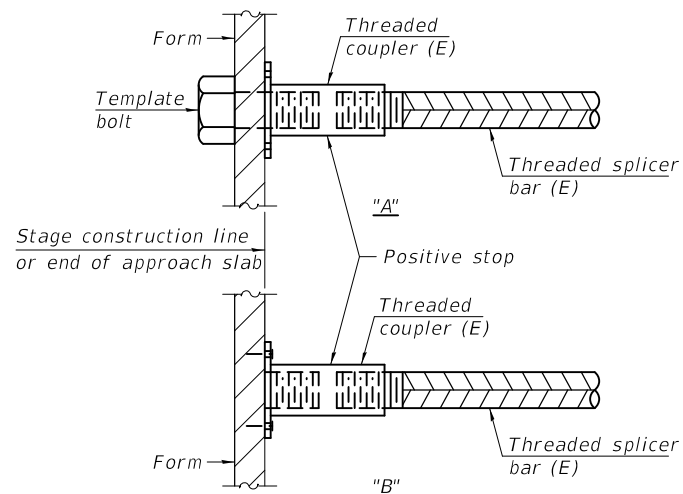

INSTALLATION AND SETTING METHODS

"A" : Set bar splicer assembly by means of a template bolt.
 "B" : Set bar splicer assembly by nailing to wood forms or cementing to steel forms.
 (E) : Indicates epoxy coating.

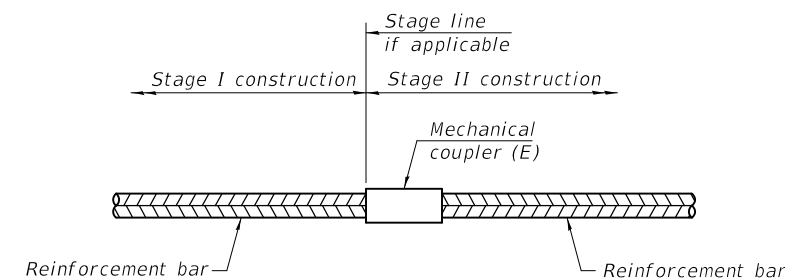

STANDARD MECHANICAL SPLICER

Location	Bar size	No. assemblies required

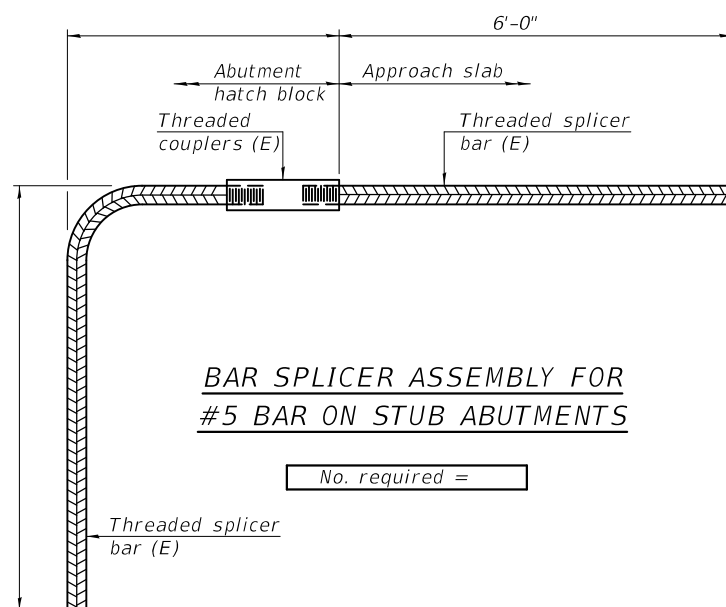

BAR SPLICER ASSEMBLY FOR #5 BAR ON STUB ABUTMENTS

No. required =

NOTES

Splicer bars shall be deformed with threaded ends and have a minimum 60 ksi yield strength.
 All reinforcement shall be lapped and tied to the splicer bars.
 Bar splicer assemblies shall be epoxy coated according to the requirements for reinforcement bars. See Section 508 of the Standard Specifications.
 See approved list of bar splicer assemblies and mechanical splicers for alternatives.

BSD-1 2-17-2017

DESIGNED - JSB
 CHECKED - SMR
 DRAWN - daburdell
 CHECKED - JSB SMR

EXAMINED
 PASSED

Timothy A. Daburdell
 ENGINEER OF STRUCTURAL SERVICES
 Carl R. Meyer
 ENGINEER OF BRIDGES AND STRUCTURES

DATE - JANUARY 29, 2019
 REVISED -
 REVISED -

STATE OF ILLINOIS
 DEPARTMENT OF TRANSPORTATION

BAR SPLICER ASSEMBLY AND MECHANICAL SPLICER DETAILS
 SN 052-0060

SHEET NO. 5 OF 6 SHEETS

F.A.P. RTE.	SECTION	COUNTY	TOTAL SHEETS	SHEET NO.
694	D2 BDR 2019-4	LEE	26	18
CONTRACT NO. 64N28				
ILLINOIS FED. AID PROJECT				

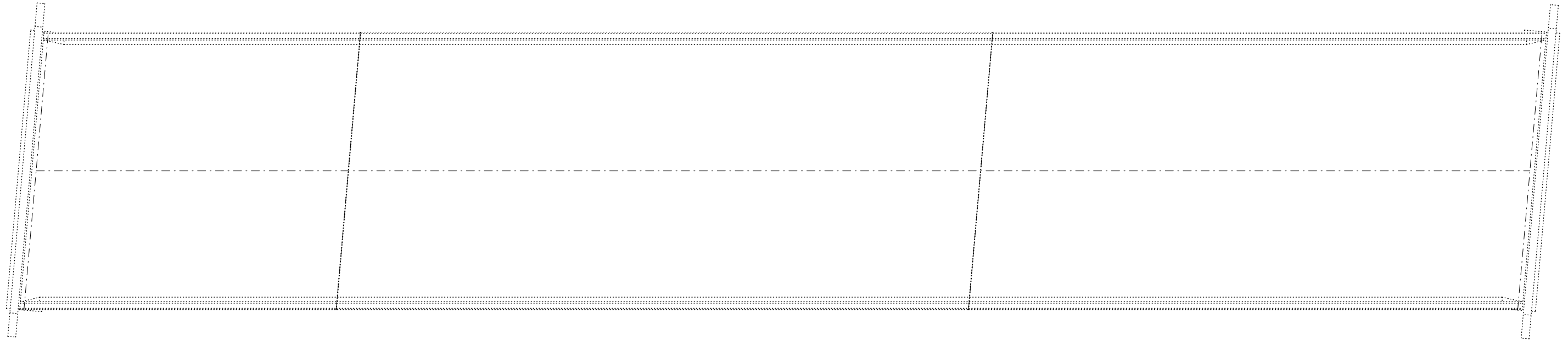

PLAN

DESIGNED - JSB
 CHECKED - SMR
 DRAWN - daburdell
 CHECKED - JSB SMR

EXAMINED
Timothy A. Daburdell
 ENGINEER OF STRUCTURAL SERVICES
 PASSED
Carl R. Meyer
 ENGINEER OF BRIDGES AND STRUCTURES

DATE - JANUARY 29, 2019
 REVISED -
 REVISED -

STATE OF ILLINOIS
DEPARTMENT OF TRANSPORTATION

AS - BUILT DECK SLAB REPAIRS
SN 052-0060
 SHEET NO. 6 OF 6 SHEETS

F.A.P. RTE.	SECTION	COUNTY	TOTAL SHEETS	SHEET NO.
694	D2 BDR 2019-4	LEE	26	19
ILLINOIS FED. AID PROJECT			CONTRACT NO. 64N28	

WORK ZONE SIGN DETAILS

ILLINOIS STANDARD G20-I100

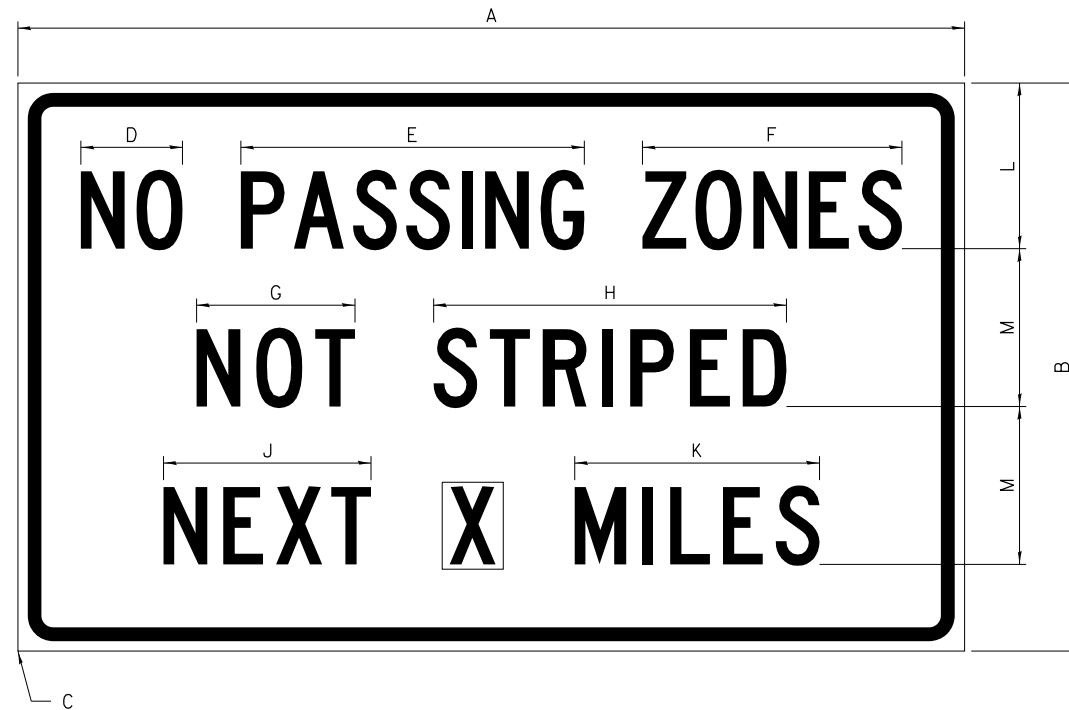

COLOR LEGEND AND BORDER BACKGROUND BLACK ORANGE NON-REFLECTORIZED REFLECTORIZED

SIGN SIZE	DIMENSIONS											
	A	B	C	D	E	F	G	H	J	K	L	M
60 x 36	60.00	36.00	2.25	6.4	21.80	16.40	10.00	22.40	13.20	15.50	10.50	10.00

SIGN SIZE	SERIES BY LINE			MARGIN	BORDER
	1	2	3		
60 x 36	5C	5C	5C	0.625	0.875

Sign not to scale

ILLINOIS STANDARD W8-I107

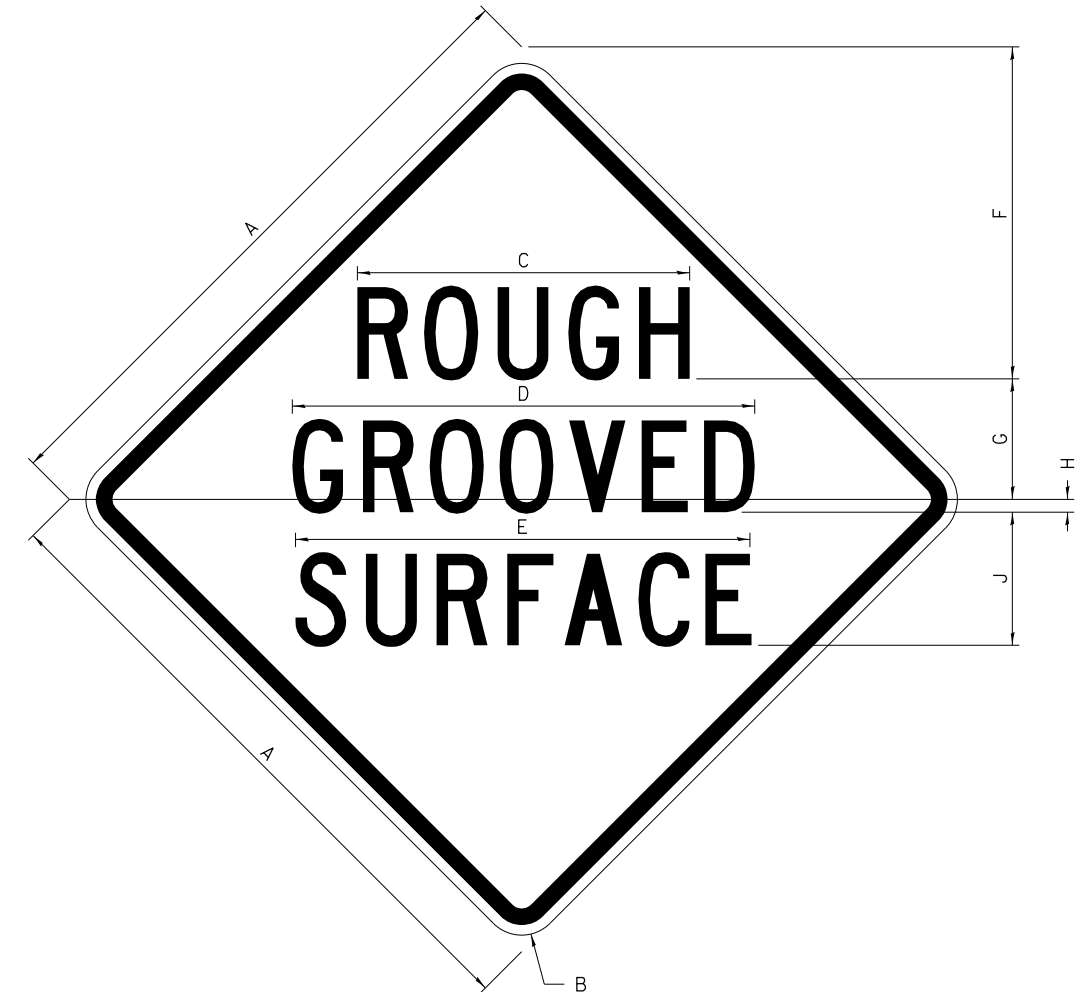

COLOR LEGEND AND BORDER BACKGROUND BLACK ORANGE NON-REFLECTORIZED REFLECTORIZED

SIGN SIZE	DIMENSIONS								
	A	B	C	D	E	F	G	H	J
48 x 48	48.00	3.00	25.00	34.80	34.20	24.94	9.00	1.00	10.00

SIGN SIZE	SERIES BY LINE			MARGIN	BORDER
	1	2	3		
48 x 48	7C	7C	7C	1.250	0.750

Sign not to scale

GENERAL NOTES

All work to furnish and install these signs shall be included in the cost of the specified traffic control standards and shall not be paid separately.

All Illinois Standard signs shall conform to the latest edition of the "Illinois Standard Highway Signs Book" in effect on the date of invitation for bids.

Signs shall meet the applicable portions of Sections 701 and 720 of the Standard Specifications.

All dimensions are in inches unless otherwise noted.

FILE NAME =	USER NAME = vaceksk	DESIGNED -	REVISED - 3-02-16
pw:\IL\084EBID\INTEG\illinois.gov\PI\DOT\Documents\DOT Offices\District 2\Projects\64N28\Drawings\Development\Studies & Plans\Development\Drawings\CAD\Sheets\02_64N28-sht-details.dgn		CHECKED -	REVISED -
		DATE -	REVISED -

**STATE OF ILLINOIS
DEPARTMENT OF TRANSPORTATION**

REGION 2 / DISTRICT 2 STANDARD

SCALE: SHEET NO. 1 OF 4 SHEETS STA. TO STA.

F.A.P. RTE.	SECTION	COUNTY	TOTAL SHEETS	SHEET NO.
694	D2 BDR 2019-4	LEE	26	20
FED. ROAD DIST. NO. ILLINOIS FED. AID PROJECT			64N28	

WORK ZONE SIGN DETAILS

ILLINOIS STANDARD W12-I102

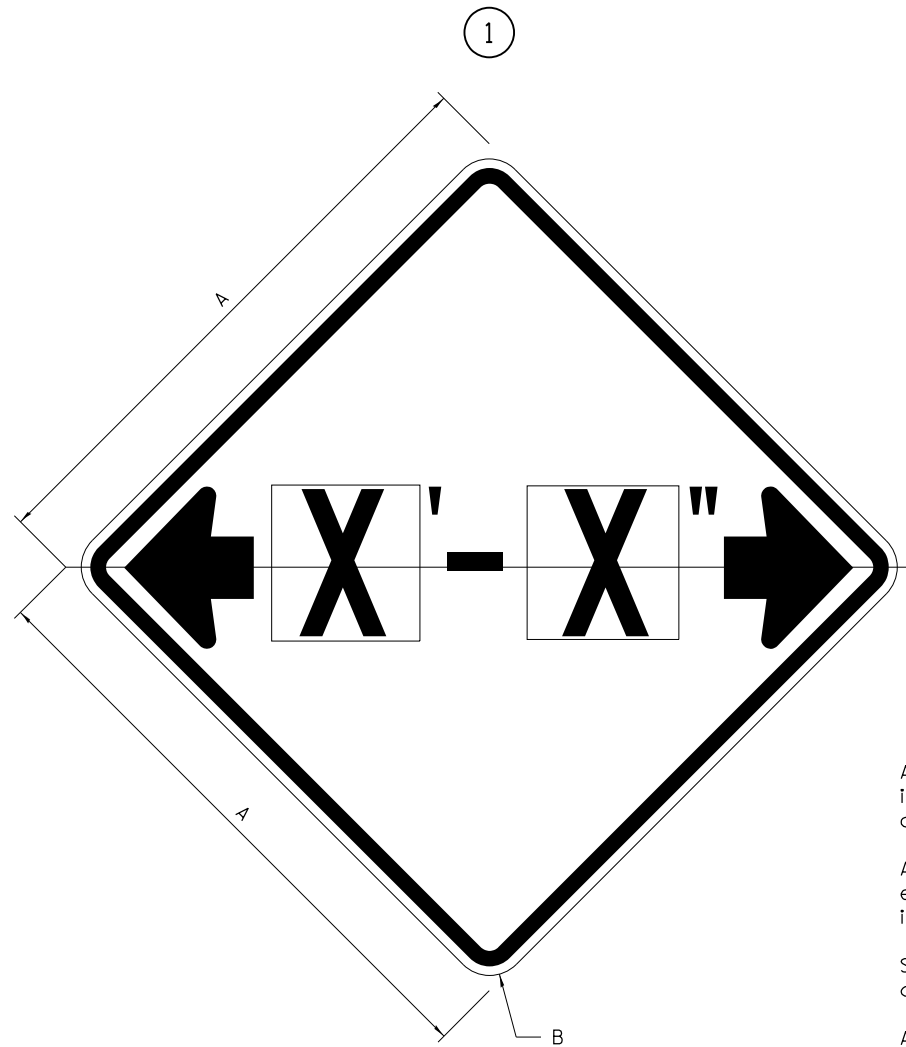

ILLINOIS STANDARD W12-I103

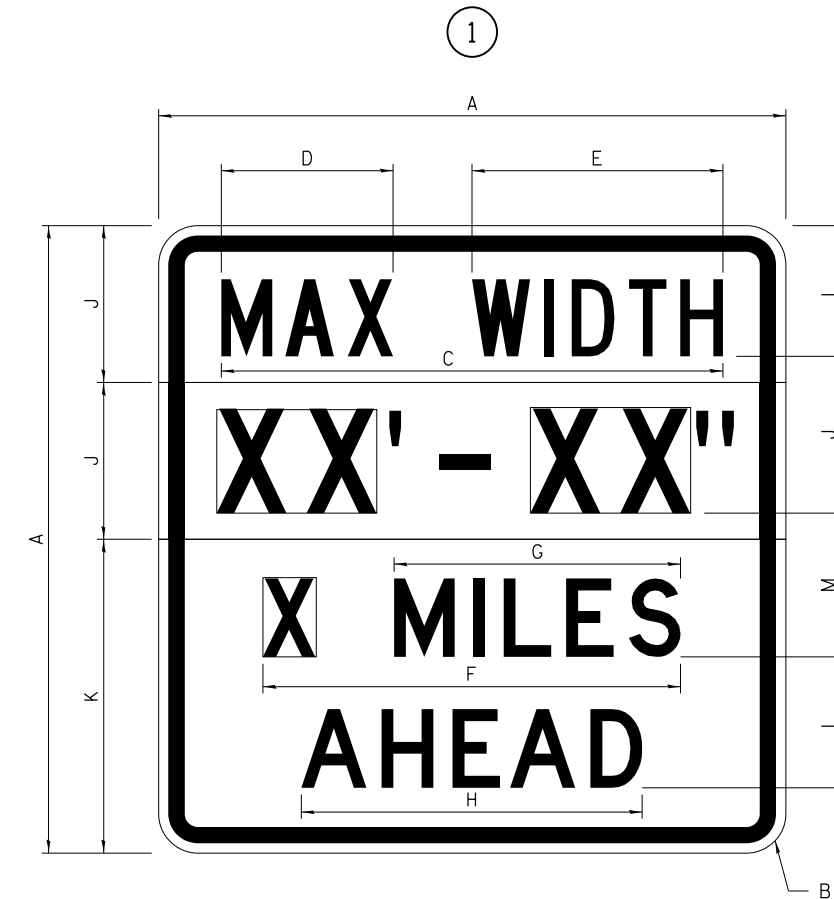

GENERAL NOTES

All work to furnish and install these signs shall be included in the cost of the specified traffic control standards and shall not be paid separately.

All Illinois Standard signs shall conform to the latest edition of the "Illinois Standard Highway Signs Book" in effect on the date of invitation for bids.

Signs shall meet the applicable portions of Sections 701 and 720 of the Standard Specifications.

All dimensions are in inches unless otherwise noted.

COLOR LEGEND AND BORDER BACKGROUND BLACK FL ORANGE NON-REFLECTORIZED REFLECTORIZED

SIGN SIZE	DIMENSIONS	
	A	B
48 x 48	48.00	3.00

① Illinois Standard signs W12-I102 and W12-I103 shall be used as described in the special provisions.

SIGN SIZE	SERIES BY LINE	MARGIN	BORDER
	1		
48 x 48	12C	0.750	1.250

Sign not to scale

COLOR LEGEND AND BORDER BACKGROUND (WIDTH) BLACK WHITE FL ORANGE NON-REFLECTORIZED REFLECTORIZED REFLECTORIZED

SIGN SIZE	DIMENSIONS											
	A	B	C	D	E	F	G	H	J	K	L	M
48 x 48	48.00	3.00	38.40	13.20	19.20	32.00	22.00	26.20	12.00	24.00	10.00	11.00

SIGN SIZE	SERIES BY LINE				MARGIN	BORDER
	1	2	3	4		
48 x 48	6C	8D	6D	6D	0.750	1.250

Sign not to scale

XX'-XX" WIDTH AND X MILES ARE VARIABLE TOP AND BOTTOM OF BACKGROUND WHITE

FILE NAME =	USER NAME = vaceksk	DESIGNED -	REVISED - 3-02-16
p:\11\084EBIDINTEG\illinois.gov\PIDOT\Documents\DOT Offices\District 2\Projects\64N28\Drawings\Development\Studies & Plans\Development\CADsheets\02-64N28-sht-details.dgn		DRAWN -	REVISED -
		CHECKED -	REVISED -
		DATE -	REVISED -
PLOT SCALE = 100.0000' / in.			
PLOT DATE = Dec-21-2018 01:53:54 PM			

STATE OF ILLINOIS
DEPARTMENT OF TRANSPORTATION

REGION 2 / DISTRICT 2 STANDARD

SCALE: SHEET NO. 2 OF 4 SHEETS STA. TO STA.

F.A.P. RTE.	SECTION	COUNTY	TOTAL SHEETS	SHEET NO.
694	D2 BDR 2019-4	LEE	26	21
				64N28

FED. ROAD DIST. NO. ILLINOIS FED. AID PROJECT

WORK ZONE SIGN DETAILS

ROAD CLOSED TO OVERSIZED LOADS

STOP LINE SIGN FOR TEMPORARY SIGNALS

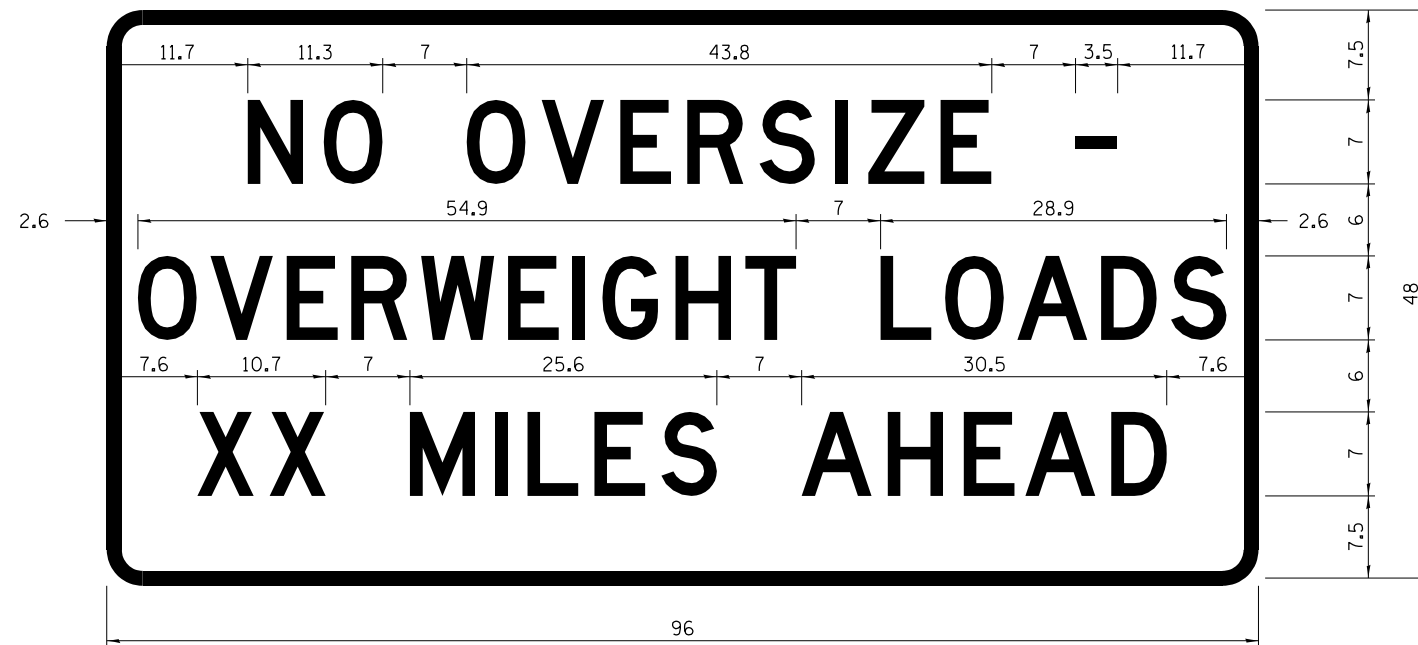

COLOR	LEGEND AND BORDER BACKGROUND	BLACK ORANGE	NON-REFLECTORIZED REFLECTORIZED
-------	------------------------------	--------------	---------------------------------

COLOR	LEGEND AND BORDER BACKGROUND	BLACK WHITE	NON-REFLECTORIZED REFLECTORIZED
-------	------------------------------	-------------	---------------------------------

Permit Loads - Loads Over 13 Feet; 3.0" Radius, 1.3" Border;
 [NO OVERSIZE -] D; [OVERWEIGHT LOADS] D 85% spacing; [XX MILES AHEAD] D;
 Table of letter and object lefts.

SIGN SIZE	SERIES BY LINE		
	1	2	3
24 x 24	4C	4C	4C

N	O	O	V	E	R	S	I	Z	E	-
11.7	18.1	30.0	36.2	42.8	48.4	54.4	60.7	63.5	69.5	80.8

O	V	E	R	W	E	I	G	H	T	L	O	A	D	S
2.6	8.6	15.0	20.4	26.2	33.4	38.8	41.3	47.4	53.2	64.5	69.9	75.9	82.9	88.7

X	X	M	I	L	E	S	A	H	E	A	D
7.6	13.6	25.3	32.3	35.1	40.6	46.2	57.9	65.1	71.4	76.6	83.7

Sign not to scale

Sign not to scale

GENERAL NOTES

All work to furnish and install these signs shall be included in the cost of the specified traffic control standards and shall not be paid separately.

All Illinois Standard signs shall conform to the latest edition of the "Illinois Standard Highway Signs Book" in effect on the date of invitation for bids.

Signs shall meet the applicable portions of Sections 701 and 720 of the Standard Specifications.

All dimensions are in inches unless otherwise noted.

FILE NAME =	USER NAME = vaceksk	DESIGNED -	REVISED - 3-02-16
PLOT SCALE = 100.0000' / in.		CHECKED -	REVISED -
PLOT DATE = Dec-21-2018 01:54:32 PM		DATE -	REVISED -

STATE OF ILLINOIS
DEPARTMENT OF TRANSPORTATION

REGION 2 / DISTRICT 2 STANDARD

SCALE: SHEET NO. 3 OF 4 SHEETS STA. TO STA.

F.A.P. RTE.	SECTION	COUNTY	TOTAL SHEETS	SHEET NO.
694	D2 BDR 2019-4	LEE	26	22
CONTRACT NO. 64N28				
FED. ROAD DIST. NO. ILLINOIS FED. AID PROJECT				

**ENTRANCE SIGN FOR USE
WITH TEMPORARY SIGNALS**

WORK ZONE SIGN DETAILS

②

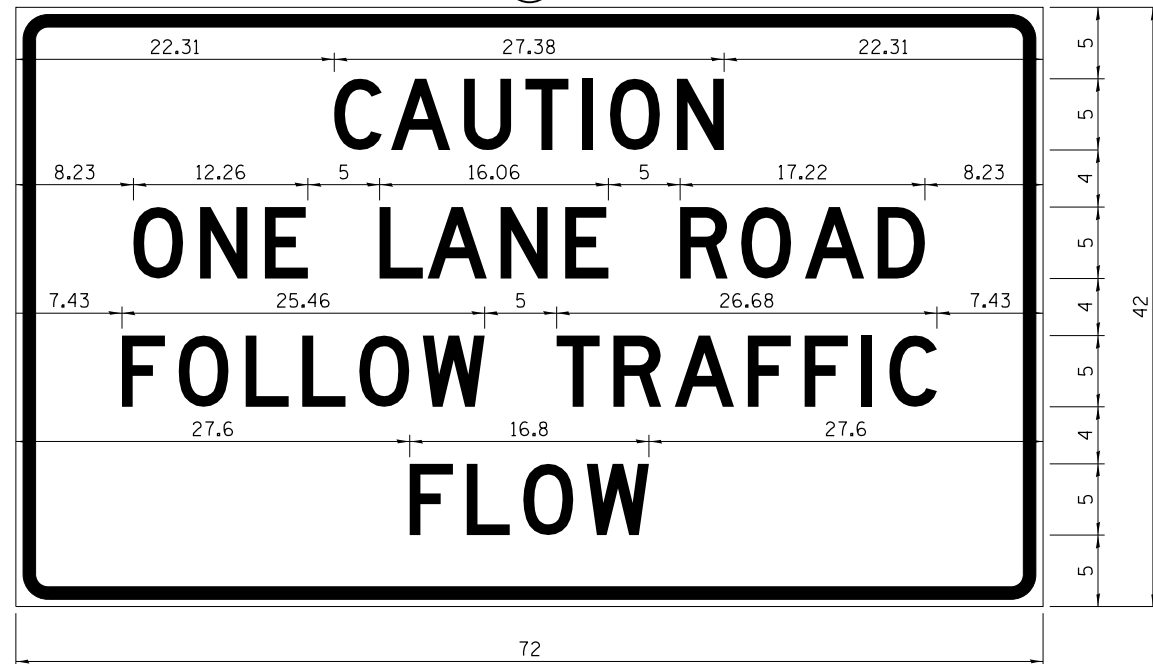

COLOR LEGEND AND BORDER BACKGROUND BLACK ORANGE NON-REFLECTORIZED REFLECTORIZED

2.25" Radius, 0.88" Border, 0.50" Indent;
[CAUTION] D; [ONE LANE ROAD] D;
[FOLLOW TRAFFIC] D; [FLOW] D

② This sign shall be installed at entrances located between the temporary signals as shown in the staging plans.

Table Of Widths And Spaces

22.31	C	0.62	A	0.94	U	0.94	T	0.94	I	1.17	O	1.17	N	3.36	22.31
	3.36		4.18		3.36		3.04		0.78		3.52		3.36		

8.23	O	1.17	N	1.18	E
	3.51		3.36		3.04

5.00	L	0.31	A	0.94	N	1.17	E
	3.05		4.18		3.36		3.05

5.00	R	0.93	O	0.94	A	0.93	D	8.23
	3.36		3.52		4.18		3.36	

7.43	F	0.94	O	1.17	L	0.94	L	0.94	O	0.94	W
	3.04		3.52		3.04		3.05		3.51		4.37

5.00	T	0.94	R	0.94	A	0.93	F	0.94	F	0.94	I	1.18	C	7.43
	3.05		3.36		4.18		3.05		3.04		0.78		3.35	

27.60	F	0.94	L	0.94	O	0.93	W	27.60
	3.05		3.04		3.52		4.38	

Sign not to scale

STAY IN YOUR LANE

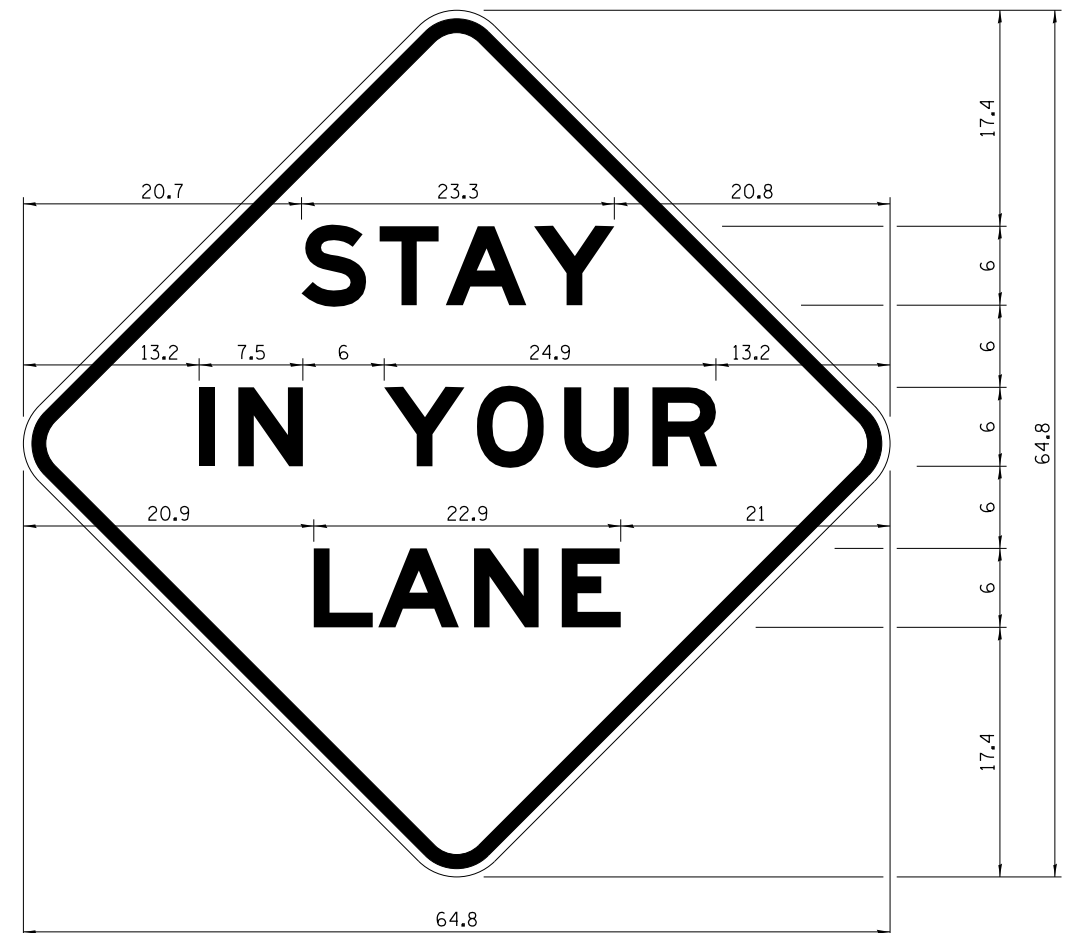

COLOR LEGEND AND BORDER BACKGROUND BLACK ORANGE NON-REFLECTORIZED REFLECTORIZED

48.0" across sides 3.8" Radius, 1.0" Border, 0.6" Indent;
"STAY" E Mod; "IN YOUR" E Mod; "LANE" E Mod;

Table of Letter and Object Lefts

S	T	A	Y
20.7	26.8	31.6	38.0

I	N	Y	O	U	R
13.2	15.9	26.7	33.9	40.5	46.8

L	A	N	E
20.9	25.8	33.1	39.4

Sign not to scale

GENERAL NOTES

All work to furnish and install these signs shall be included in the cost of the specified traffic control standards and shall not be paid separately.

All Illinois Standard signs shall conform to the latest edition of the "Illinois Standard Highway Signs Book" in effect on the date of invitation for bids.

Signs shall meet the applicable portions of Sections 701 and 720 of the Standard Specifications.

All dimensions are in inches unless otherwise noted.

FILE NAME =	USER NAME = vacesk	DESIGNED -	REVISED - 3-02-16
p:\11\084EBID\INTEG\illinois.gov\PIDOT\Documents\IDOT Offices\District 2\Projects\64N28\Drawings\Development\Studies & Plans\Development\CAD\Sheets\02_64N28-sht-details.dgn		CHECKED -	REVISED -
		DATE -	REVISED -

**STATE OF ILLINOIS
DEPARTMENT OF TRANSPORTATION**

REGION 2 / DISTRICT 2 STANDARD

SCALE: SHEET NO. 4 OF 4 SHEETS STA. TO STA.

F.A.P. RTE.	SECTION	COUNTY	TOTAL SHEETS	SHEET NO.
694	D2 BDR 2019-4	LEE	26	23
CONTRACT NO. 64N28				
FED. ROAD DIST. NO. ILLINOIS FED. AID PROJECT				

TYPICAL PAVEMENT MARKINGS

TYPICAL PAVEMENT MARKING FOR FLUSH MEDIAN AT LEFT TURN LANE

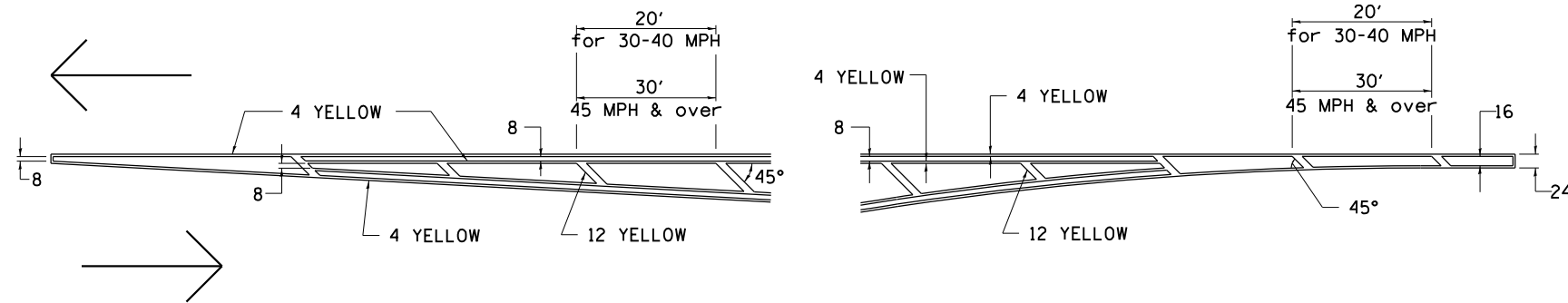

MEDIAN PAVEMENT MARKING

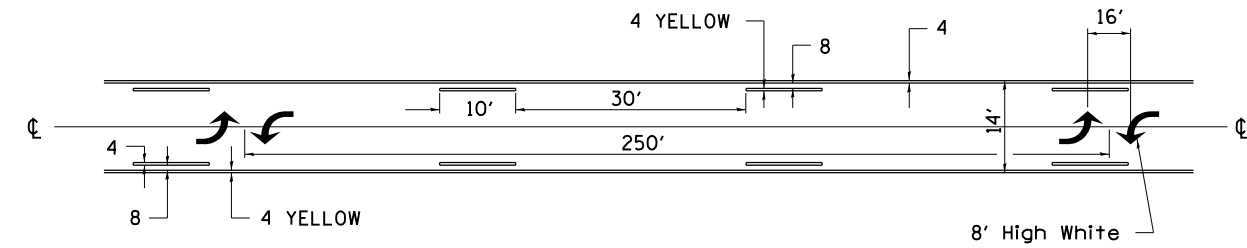

•• ALL DIMENSIONS ARE IN INCHES UNLESS OTHERWISE NOTED.

TYPICAL ISLAND OFFSET SHOULDER WIDTH

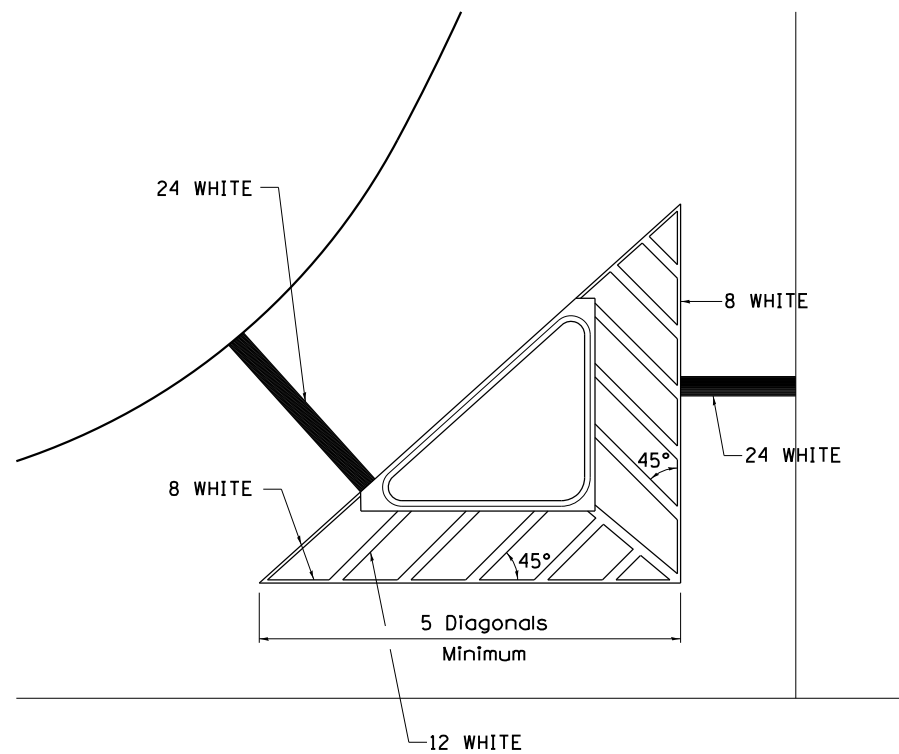

TYPICAL MARKING FOR PAINTED ISLANDS

NOTE:
* 45° TO LOCAL TAN.

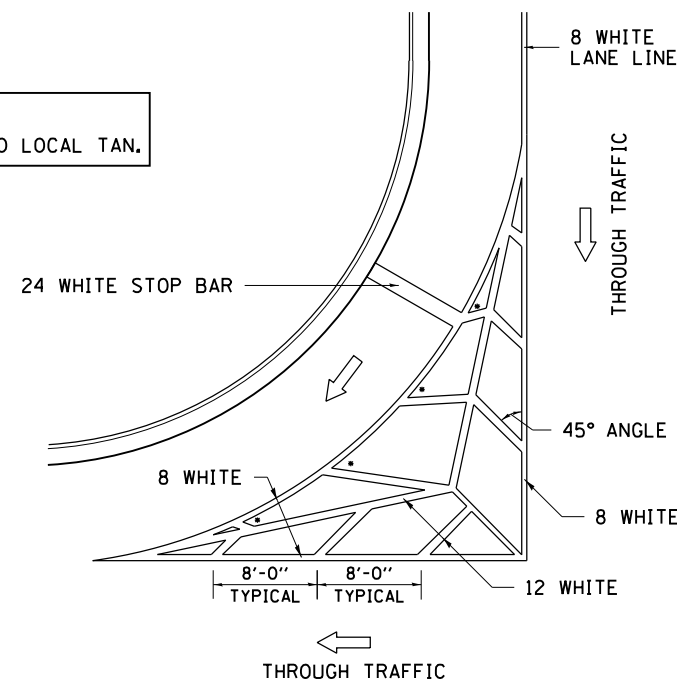

STANDARD CROSSWALK MARKING

See Schedules for Locations

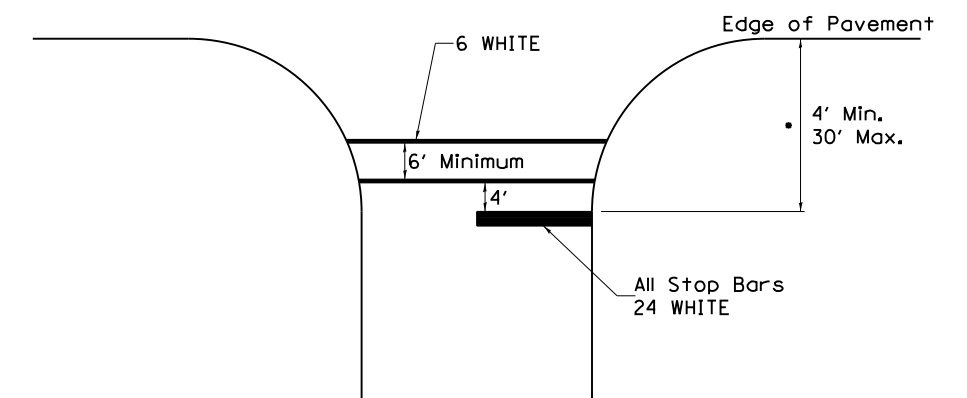

• Distance to the nearest edge of the intersecting roadway in the absence of a marked crosswalk.

FILE NAME =	USER NAME = vacek	DESIGNED -	REVISED - 6-27-14
p:\11\084EBIDINTEG\illinois.gov\PIWIDOT\Documents\IDOT Offices\District 2\Projects\64N28\Drawings\Development\Studies & Plans\Development\CA\Sheet\64N28-sht-details.dgn		CHECKED -	REVISED -
		DATE -	REVISED -

STATE OF ILLINOIS
DEPARTMENT OF TRANSPORTATION

REGION 2 / DISTRICT 2 STANDARD

SCALE: _____ SHEET NO. ____ OF ____ SHEETS STA. _____ TO STA. _____

F.A.P. RTE.	SECTION	COUNTY	TOTAL SHEETS	SHEET NO.
694	D2 DBD 2019-4	LEE	26	24
FED. ROAD DIST. NO. _____ ILLINOIS FED. AID PROJECT			CONTRACT NO. 64N28	

TYPICAL PAVEMENT MARKINGS

ARROW LAYOUT

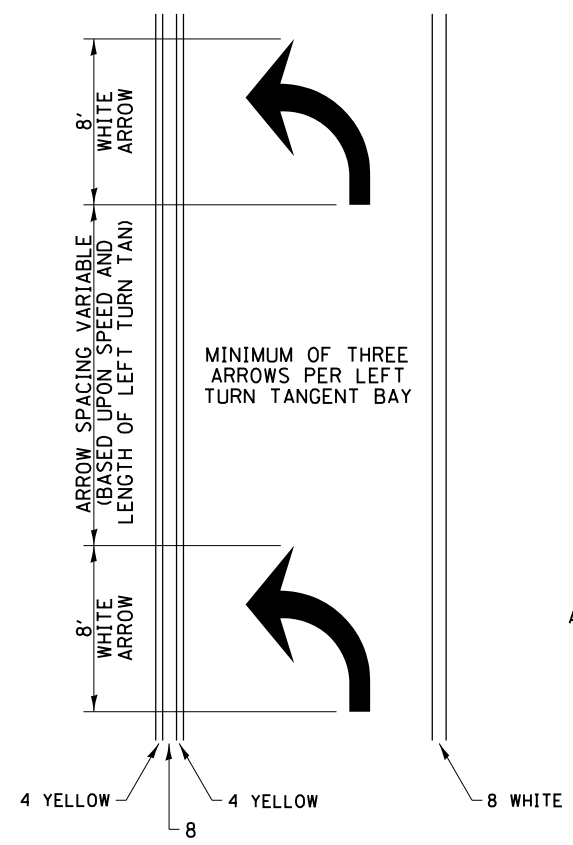

- ◀ ONE-WAY AMBER MARKER
- ◁ ONE-WAY CRYSTAL MARKER
- ◆ TWO-WAY AMBER MARKER

ALL DIMENSIONS ARE IN INCHES UNLESS OTHERWISE NOTED.

TYPICAL PAVEMENT MARKING FOR FLUSH MEDIAN

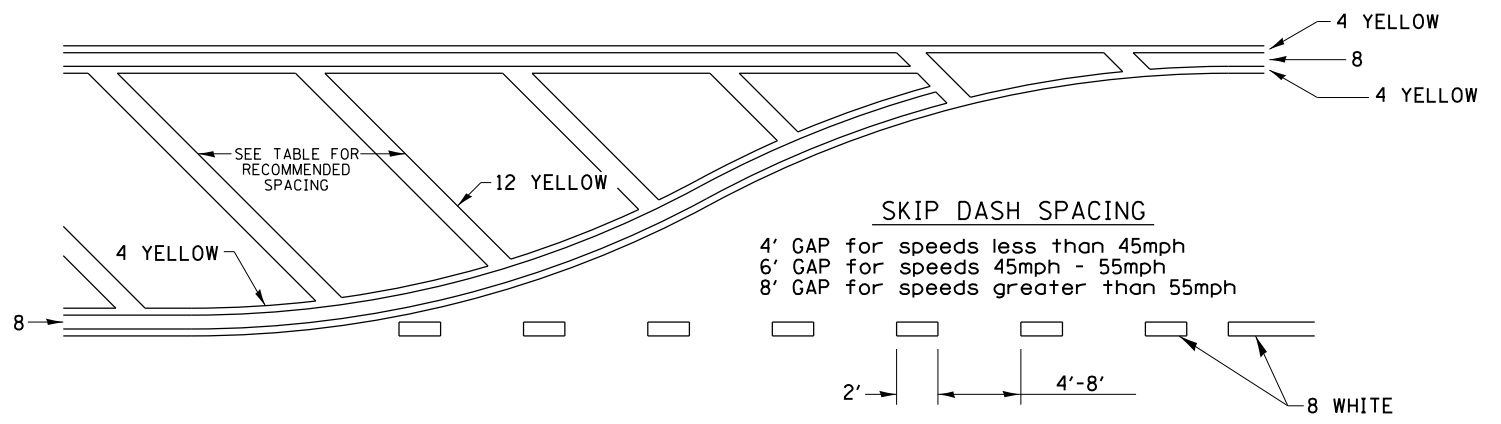

RECOMMENDED SPACING BETWEEN DIAGONALS (IN FEET)

Speed Limit Range	Continuous Median Area	Intersection Channelization	Objects (Islands)
less than 30MPH	50'	15'	10'
30-40MPH	75'	20'	15'
45MPH & over	75'	30'	20'

NOTE: if the spacing recommended in the Table does not permit at least five diagonal lines in the area being marked, the spacing from the next lowest speed range should be used. The recommended spacing is measured parallel to the pavement center line.

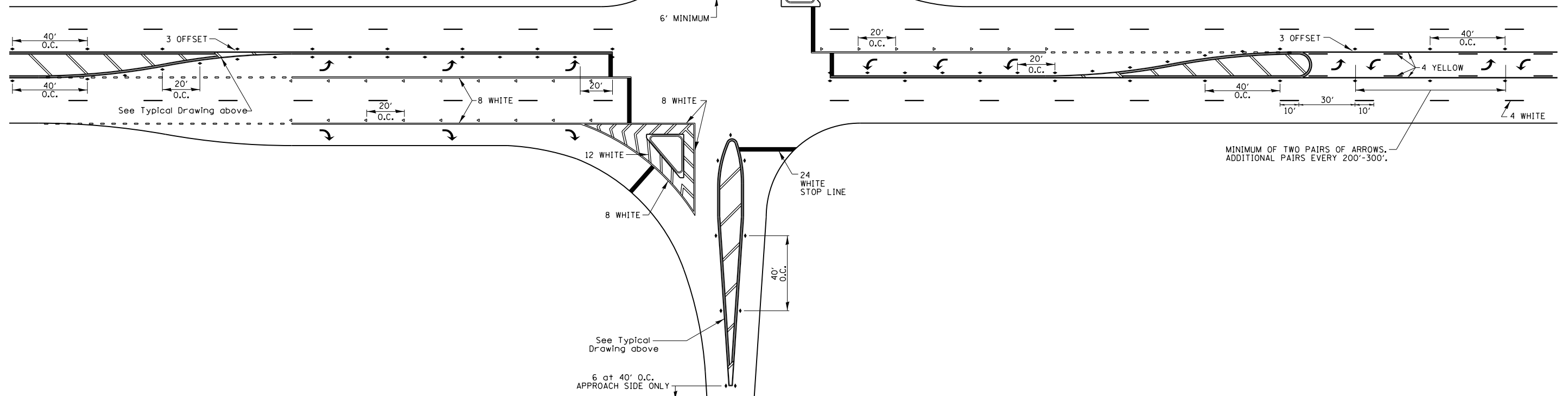

FILE NAME =	USER NAME = vaceksk	DESIGNED -	REVISED - 6-27-14
p:\11\084EBIDINTEG.illinois.gov\PI\DOT\Documents\DOT Offices\District 2\Projects\64N28\Drawings\Development\Studies & Plans\Development\CAD\Sheet\64N28-sht-details.dgn		DRAWN -	REVISED -
PLOT SCALE = 100.0000' / in.	CHECKED -	DATE -	REVISED -
PLOT DATE = Dec-21-2018 01:56:48 PM			

STATE OF ILLINOIS
DEPARTMENT OF TRANSPORTATION

REGION 2 / DISTRICT 2 STANDARD

SCALE: _____ SHEET NO. ____ OF ____ SHEETS STA. _____ TO STA. _____

F.A.P. RTE. 694	SECTION 02_BDB_2019-4	COUNTY LEE	TOTAL SHEETS 26	SHEET NO. 25
FED. ROAD DIST. NO. _____ ILLINOIS FED. AID PROJECT			CONTRACT NO. 64N28	

TYPICAL PAVEMENT MARKINGS

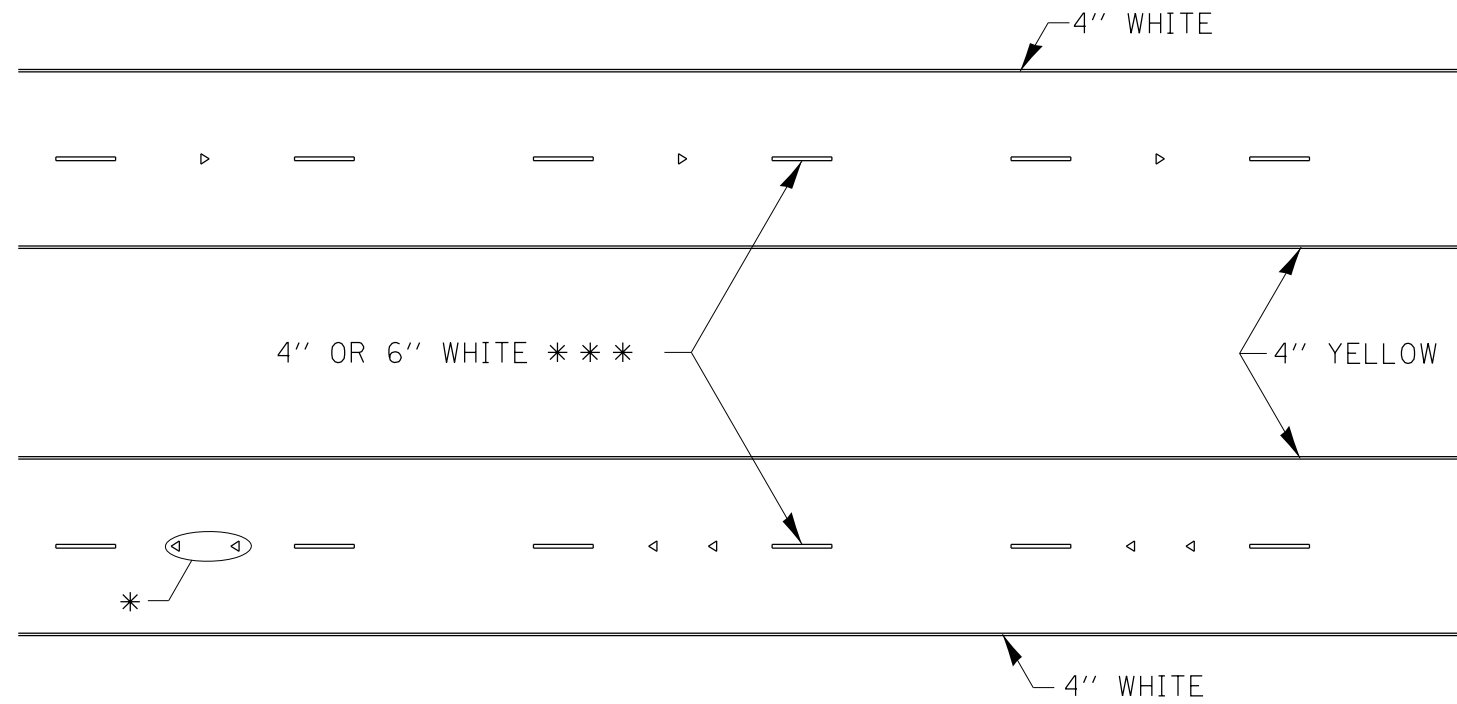

* SEE HIGHWAY STANDARD 781001 FOR SPACING DETAILS.
USE DOUBLE MARKERS WHEN ADT > 20,000.

MULTI-LANE / DIVIDED

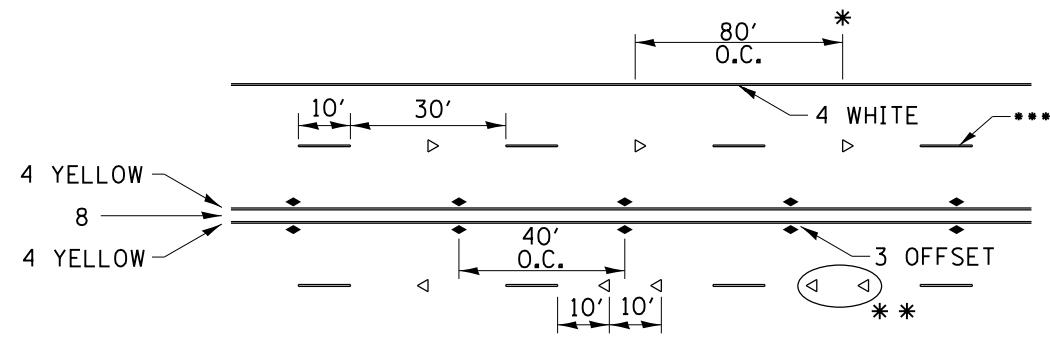

* REDUCE TO 40' O.C. ON CURVES WHERE ADVISORY SPEEDS ARE 10 MPH LOWER THAN POSTED SPEEDS.

** USE DOUBLE MARKERS WHEN ADT ≥ 20,000

*** CENTERLINE SKIP DASH PAVEMENT MARKING SPEED LIMIT LESS THAN 40 MPH USE 4" LINE. SPEED LIMIT 40 MPH AND OVER USE 6" LINE.

MULTI-LANE / UNDIVIDED & ONE WAY

(FOR MULTI-LANE UNDIVIDED HIGHWAYS USE THIS DETAIL NOT HIGHWAY STANDARD 781001)

TYPICAL PARKING SPACING

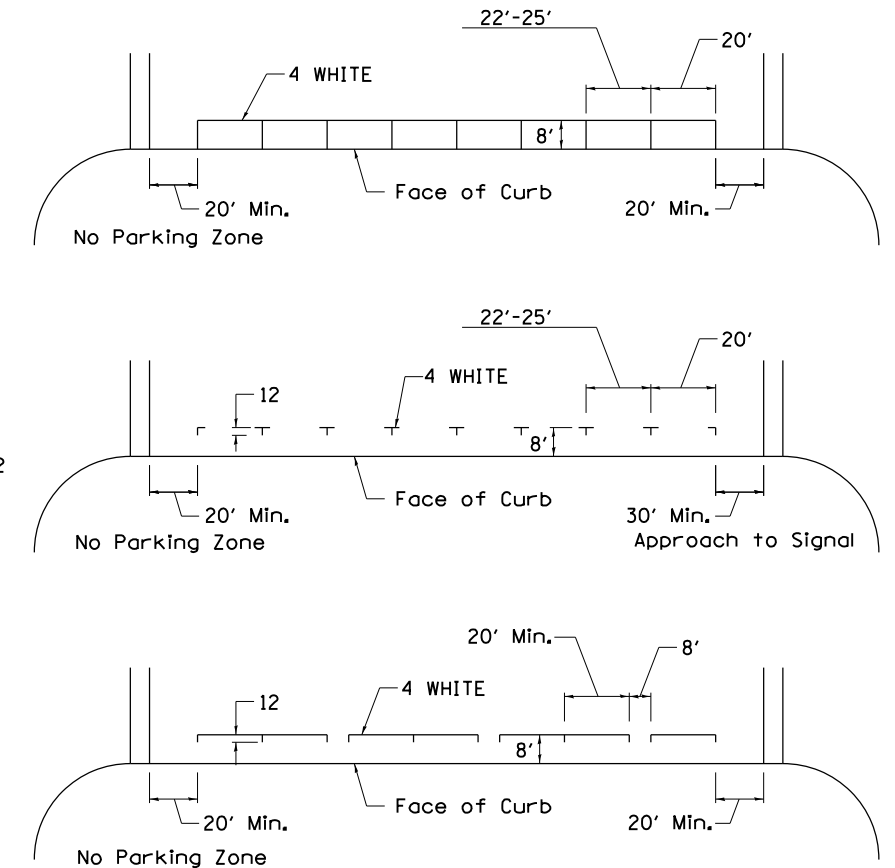

TYPICAL PAVEMENT MARKING FOR TWO LANE SECTION – NO PASSING ZONES

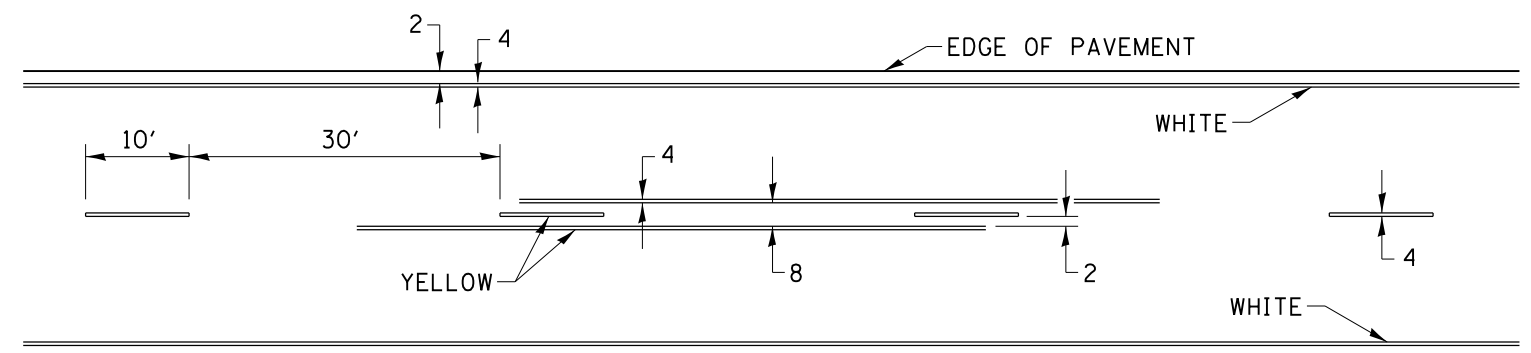

SYMBOLS

FILE NAME =	USER NAME = vaceksk	DESIGNED -	REVISED - 6-27-14
pw:\IL\084EBIDINTEG\illinois.gov\PIDOT\Documents\DOT Offices\District 2\Projects\64N28\Drawings\Development\Studies & Plans\Development\CA\Sheet\64N28-sht-details.dgn		CHECKED -	REVISED - 11-28-12
		DATE -	REVISED -

STATE OF ILLINOIS
DEPARTMENT OF TRANSPORTATION

REGION 2 / DISTRICT 2 STANDARD

SCALE: _____ SHEET NO. ____ OF ____ SHEETS STA. _____ TO STA. _____

F.A.P. RTE.	SECTION	COUNTY	TOTAL SHEETS	SHEET NO.
694	D2 DBD 2019-4	LEE	26	26
FED. ROAD DIST. NO. _____ ILLINOIS FED. AID PROJECT			CONTRACT NO. 64N28	