

**U.S. ROUTE 30 (LINCOLN HIGHWAY)**  
 STA 493+00 TO STA 500+00  
 PROPOSED IMPROVEMENT  
 STAGE 1

PROP. HMA SURFACE COURSE,  
 MIX "D", N50  
 PROP. SUB-BASE GRANULAR  
 MATERIAL, TYPE B, 4" (TYP.)

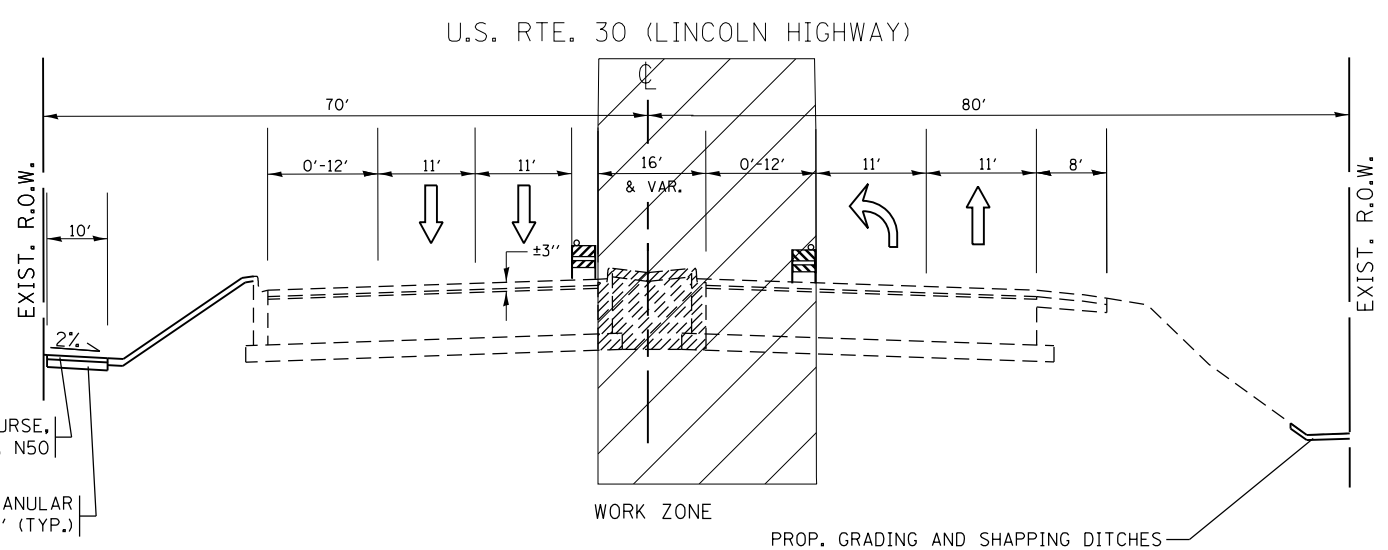

**U.S. ROUTE 30 (LINCOLN HIGHWAY)**  
 STA 493+00 TO STA 500+00  
 PROPOSED IMPROVEMENT  
 STAGE 3

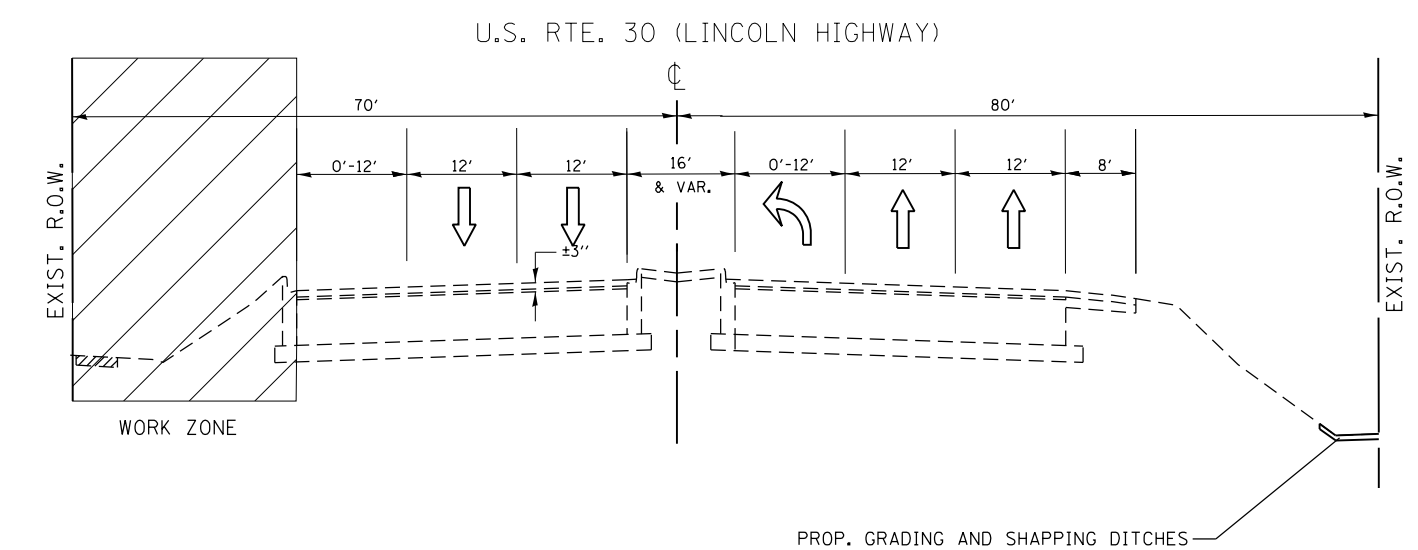

**U.S. ROUTE 30 (LINCOLN HIGHWAY)**  
 STA 493+00 TO STA 500+00  
 PROPOSED IMPROVEMENT  
 STAGE 2

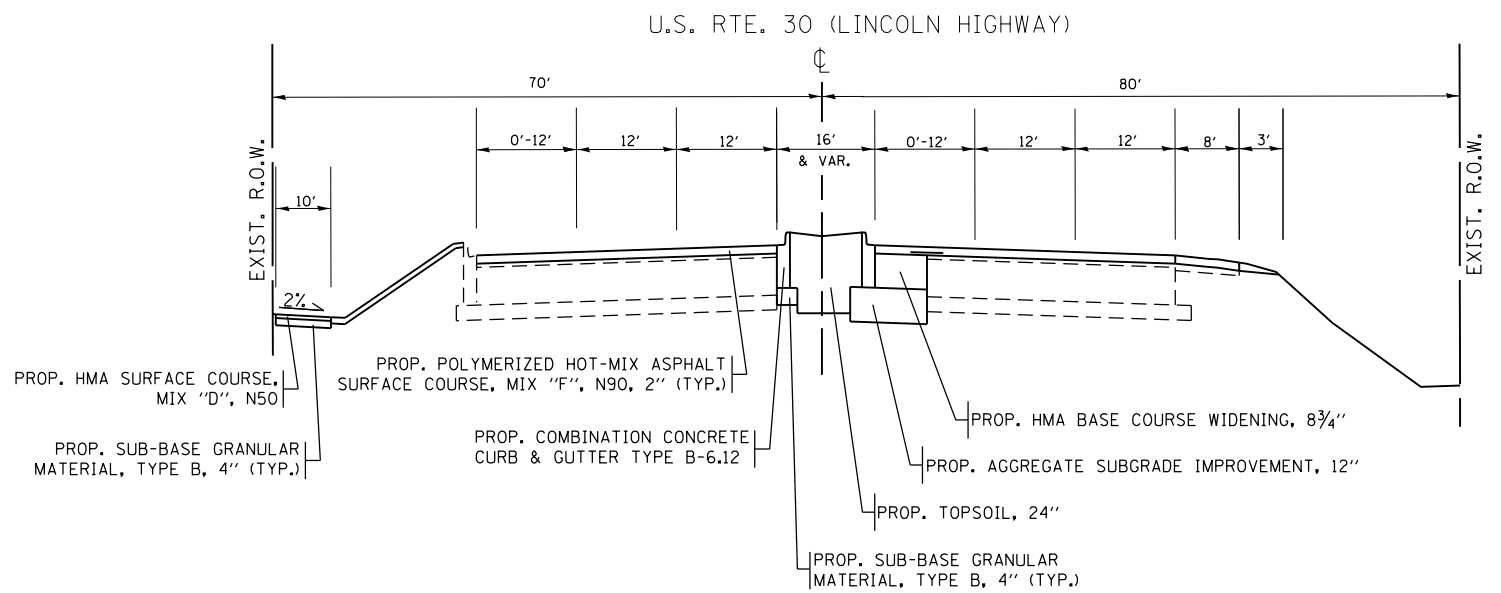

**U.S. ROUTE 30 (LINCOLN HIGHWAY)**  
 STA 493+00 TO STA 500+00  
 PROPOSED IMPROVEMENT  
 STAGE 4

FILE NAME =	USER NAME = midyja	DESIGNED -	REVISED -
c:\pwork\pwork\midyja\dms92836\p156808-staging-Design.dgn		DRAWN -	REVISED -
	PLOT SCALE = 100.0000' / 1" =	CHECKED -	REVISED -
	PLOT DATE = 3/28/2012	DATE -	REVISED -

**STATE OF ILLINOIS  
 DEPARTMENT OF TRANSPORTATION**

<b>SUGGESTED STAGING AND TRAFFIC CONTROL    TYPICAL SECTION    US 30 AT CENTRAL AVE.</b>			
SCALE:	SHEET NO.	OF SHEETS	STA. TO STA.

F.A.P. RTE.	SECTION	COUNTY	TOTAL SHEETS	SHEET NO.
353	23-N-4	COOK	68	19
CONTRACT NO. 60L21				
ILLINOIS FED. AID PROJECT				