

UTILITY OWNERS	
COMED	= ELECTRIC
AT&T	= TELEPHONE
COMCAST	= FIBER OPTIC
COMCAST	= CATV
NICOR	= GAS
VILLAGE OF MATTESON	= WATER

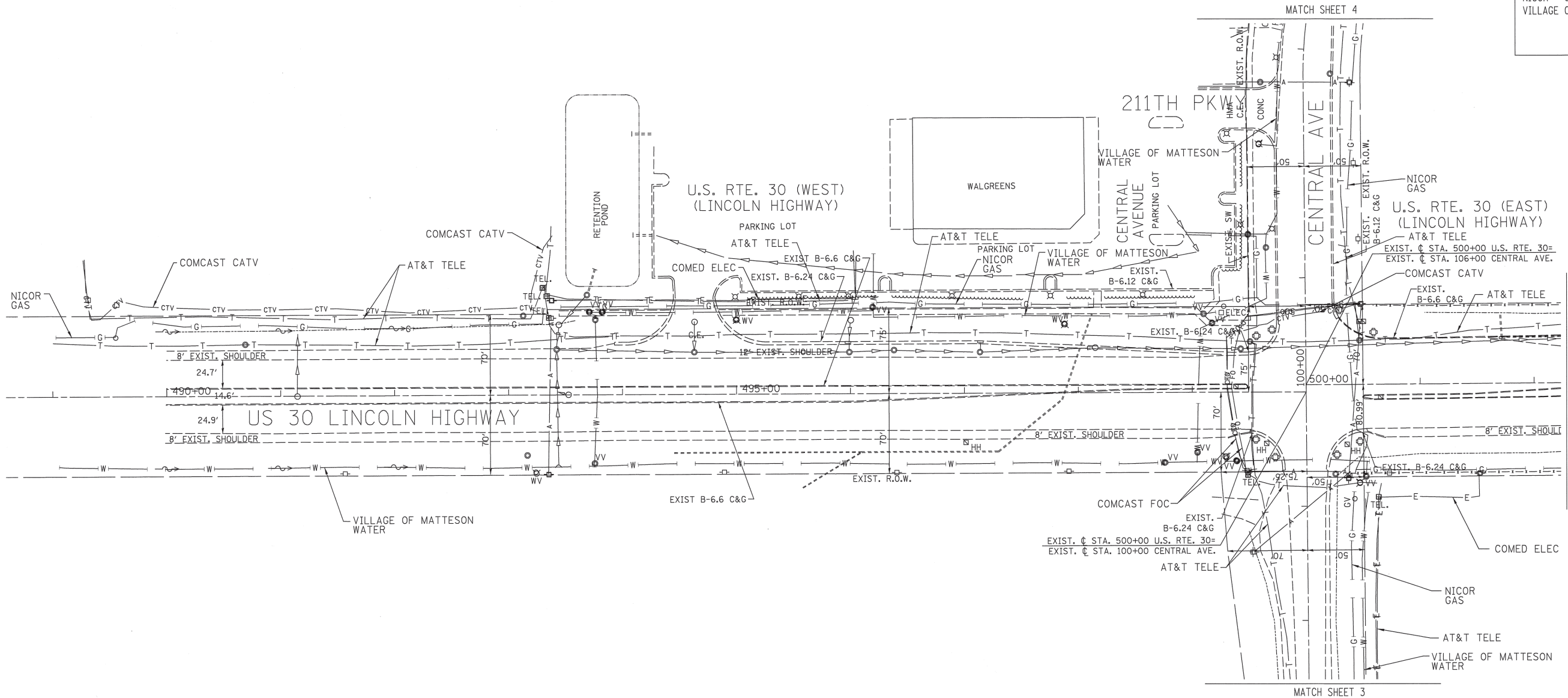

— A — A —	AERIAL UTILITY UNKNOWN
— CTV — CTV —	CABLE TV
— T — T —	TELEPHONE
— G — G —	GAS
— E — E —	ELECTRIC
— W — W —	WATER
— FO — FO —	FIBER OPTIC
— S — S —	SEWER
⊙	TBE TEST HOLE

Utilities shown on these plans as depicted in the legend have been investigated by Cardno TBE in accordance with SUE Industry Standards. All other information shown has been provided to Cardno TBE by others. Cardno TBE's SUE field investigation was performed 7/07/11 through 8/05/11. Changes to utilities after 8/05/11 may have been made and therefore may result in variances from this plan. Consideration should be given to updating this plan if deemed advisable prior to final design and construction.

ALL UTILITIES SHOWN QUALITY LEVEL "B" UNLESS NOTED OTHERWISE.

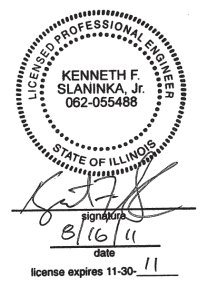
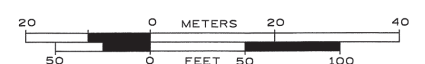

Utility Quality Level "A": Test Hole	DESIGNED <i>EG</i>	REVISED
Utility Quality Level "B": Designating	DRAWN <i>KLC</i>	REVISED
Utility Quality Level "C": Research with Survey	CHECKED <i>KFS</i>	REVISED
Utility Quality Level "D": Records Research	DATE <i>8/15/11</i>	REVISED

DESIGNED <i>EG</i>	REVISED
DRAWN <i>KLC</i>	REVISED
CHECKED <i>KFS</i>	REVISED
DATE <i>8/15/11</i>	REVISED

**STATE OF ILLINOIS
DEPARTMENT OF TRANSPORTATION**

**US RT. 30 at Central Avenue in
Matteson, IL**

F.A.R. RTE. <i>353</i>	SECTION <i>23-N-4</i>	COUNTY <i>Cook</i>	TOTAL SHEETS <i>68</i>	SHEET NO. <i>25</i>
Contract No. 60L21				
FED. ROAD DIST. NO. [ILLINOIS] IDOT Project No.				

TBE Job No. IL09510443
SUE Plan Page: 1 of 4