

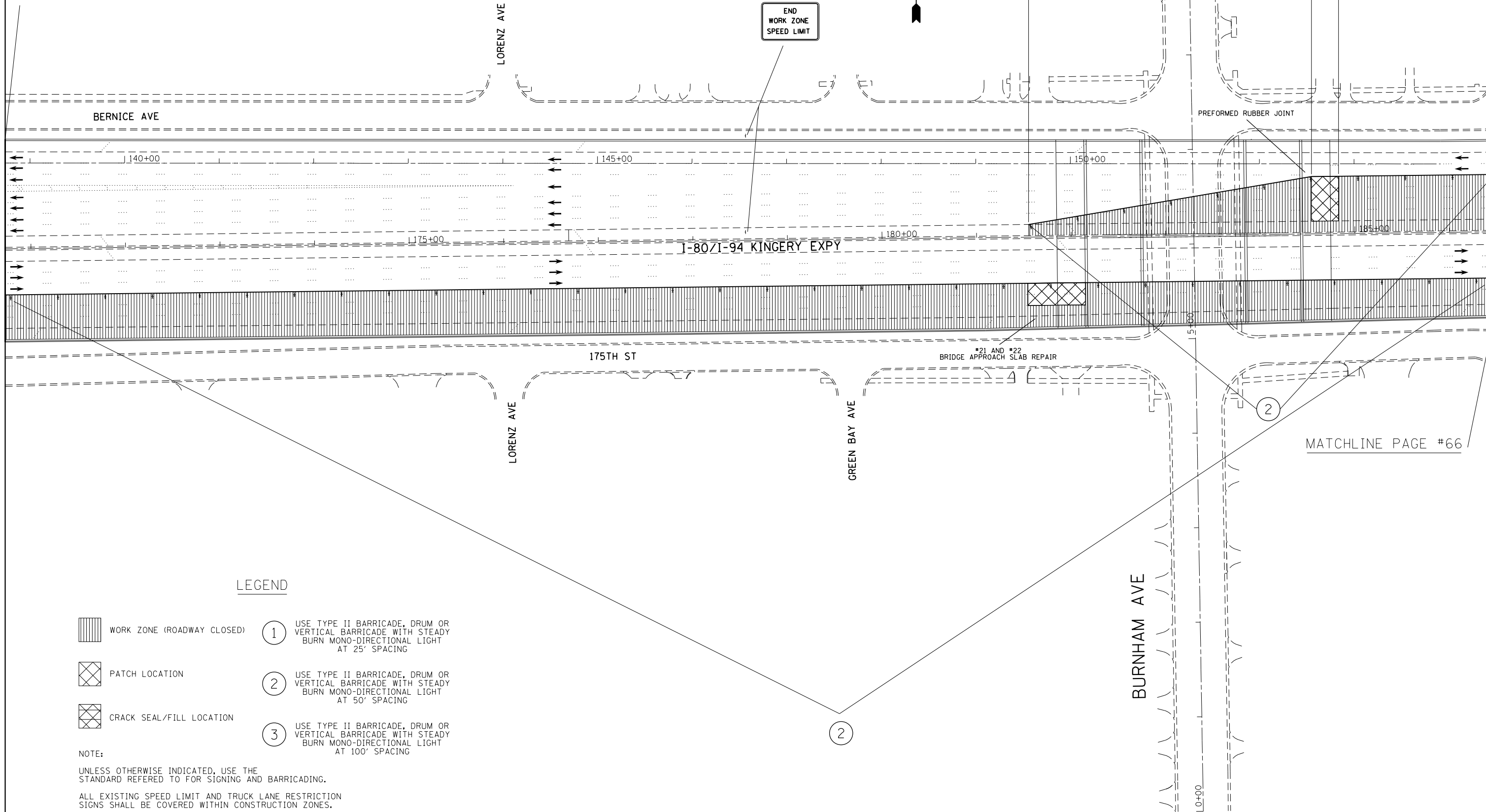



THE MOT STAGE 2 FOR WB I-80/I-94 WILL FOLLOW THE TRAFFIC CONTROL ACCORDING TO THE ALLOWABLE HOURS IN "KEEPING THE EXPRESSWAY OPEN TO TRAFFIC" SPECIAL PROVISION.

MATCHLINE PAGE #64



MATCHLINE PAGE #66

LEGEND

-  WORK ZONE (ROADWAY CLOSED) ① USE TYPE II BARRICADE, DRUM OR VERTICAL BARRICADE WITH STEADY BURN MONO-DIRECTIONAL LIGHT AT 25' SPACING
-  PATCH LOCATION ② USE TYPE II BARRICADE, DRUM OR VERTICAL BARRICADE WITH STEADY BURN MONO-DIRECTIONAL LIGHT AT 50' SPACING
-  CRACK SEAL/FILL LOCATION ③ USE TYPE II BARRICADE, DRUM OR VERTICAL BARRICADE WITH STEADY BURN MONO-DIRECTIONAL LIGHT AT 100' SPACING

NOTE:  
 UNLESS OTHERWISE INDICATED, USE THE STANDARD REFERED TO FOR SIGNING AND BARRICADING.  
 ALL EXISTING SPEED LIMIT AND TRUCK LANE RESTRICTION SIGNS SHALL BE COVERED WITHIN CONSTRUCTION ZONES.

|   |                              |            |           |
|---|------------------------------|------------|-----------|
| FILE NAME =   | USER NAME = llajdjm          | DESIGNED - | REVISED - |
| et:\pw\work\p1dot\llajdjm\d0298297\013302\2-sh-t-plan.dgn |                              | DRAWN -    | REVISED - |
|   | PLOT SCALE = 100.0000' / in. | CHECKED -  | REVISED - |
|   | PLOT DATE = 4/4/2012         | DATE -     | REVISED - |

STATE OF ILLINOIS  
 DEPARTMENT OF TRANSPORTATION

| ROADWAY AND SUGGESTED MAINTENANCE OF TRAFFIC |       |           |              |
|--|-------|-----------|--------------|
| STAGE 2                                      |       |           |              |
| SCALE:                                       | SHEET | OF SHEETS | STA. TO STA. |

| F.A.I. RTE.               | SECTION        | COUNTY | TOTAL SHEETS | SHEET NO. |
|---------------------------|----------------|--------|--------------|-----------|
| 80/94                     | 2012-002CRC-PP | COOK   | 91           | 65        |
| CONTRACT NO. 60T34        |                |        |              |           |
| ILLINOIS FED. AID PROJECT |                |        |              |           |