

*Restricted Construction Loads
See Sheet 7

STAGE I
(Looking North)

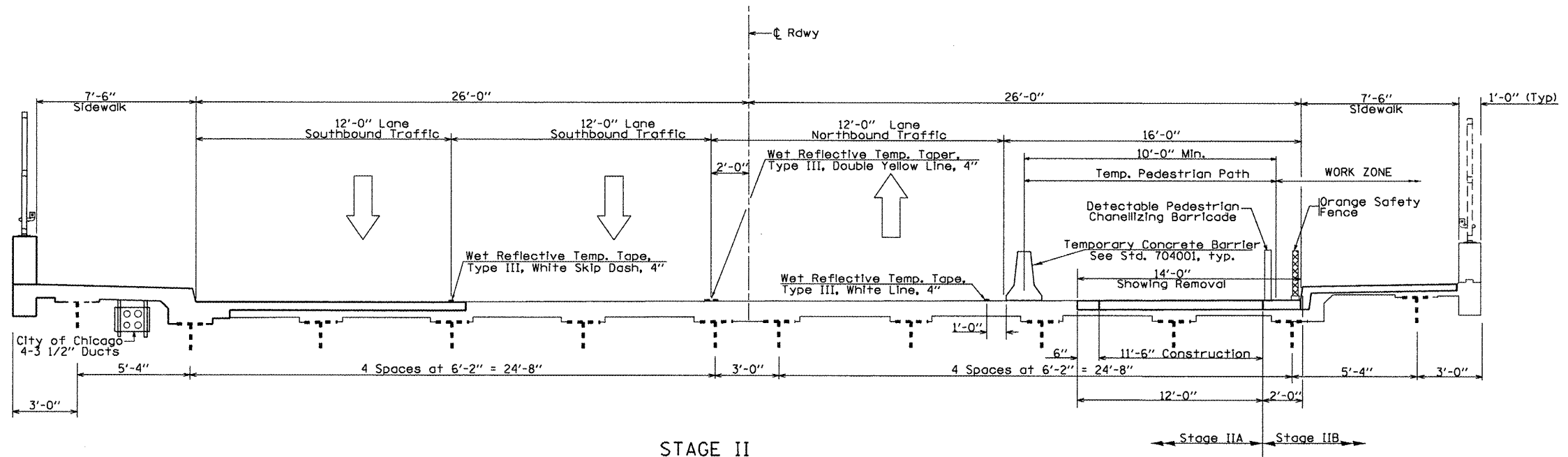

STAGE II
(Looking North)

FILE NAME =	USER NAME = handenah	DESIGNED -	REVISED -	STATE OF ILLINOIS DEPARTMENT OF TRANSPORTATION	I-290 (EISENHOWER EXPY) AT OGDEN AVE. TRAFFIC CONTROL PLAN STAGE I & II	F.A. RTE.	SECTION	COUNTY	TOTAL SHEETS	SHEET NO.
c:\pwwork\pwwork\handenah\0299703\013	1512-sh1-plan.dgn	DRAWN -	REVISED -			3-B-10BR(11)	COOK	26	4	
PLOT SCALE = 100.0000' / 1" =	CHECKED -	REVISED -	SCALE:			SHEET NO.	OF SHEETS	STA.	TO STA.	CONTRACT NO. 60T39
PLOT DATE = 4/3/2012	DATE -	REVISED -								ILLINOIS FED. AID PROJECT