

Plotted: February 20, 2012 @ 11:02 AM By: Kris Pung - Tab: 66 - Cross Section - 22x34  
 COPYRIGHT © 2012 ENGINEERING ENTERPRISES, INC.

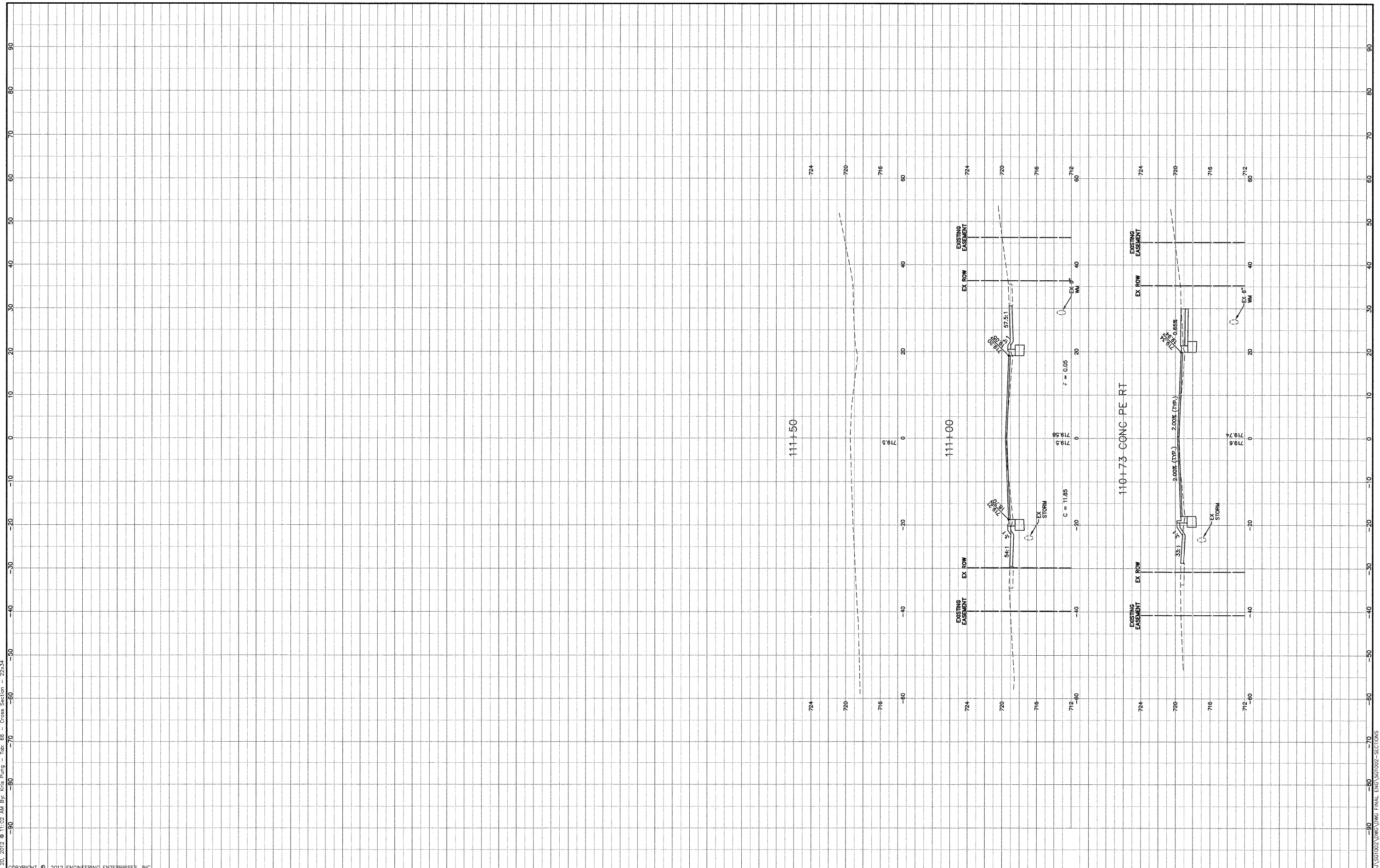

**Engineering Enterprises, Inc.**  
 CONSULTING ENGINEERS  
 52 Wheeler Road  
 Sugar Grove, Illinois 60554  
 630.466.6700 / www.eeiweb.com

USER NAME =	DESIGNED -
PLOT SCALE =	DRAWN -
PLOT DATE =	CHECKED -
	DATE -

REVISIED -	REVISIED -
REVISIED -	REVISIED -
REVISIED -	REVISIED -
REVISIED -	REVISIED -

**STATE OF ILLINOIS**  
**DEPARTMENT OF TRANSPORTATION**

**CROSS STREET - CROSS SECTIONS**  
 SCALE: HORIZ-10' - VERT-5' SHEET NO. 8 OF 12 SHEETS STA. 110+73 TO STA. 111+50

F.A.P. RTE.	SECTION	COUNTY	TOTAL SHEETS	SHEET NO.
326	10-00023-00-ES	KANE	70	66
FED. ROAD DIST. NO. 1 ILLINOIS			CONTRACT NO. 63700	
FED. AID PROJECT NO. M-9003(717)				

Path: H:\SDSKR001\SS1002\DWG\W06 FINAL ENG\SS1002-SECTIONS