

PLAN VIEW

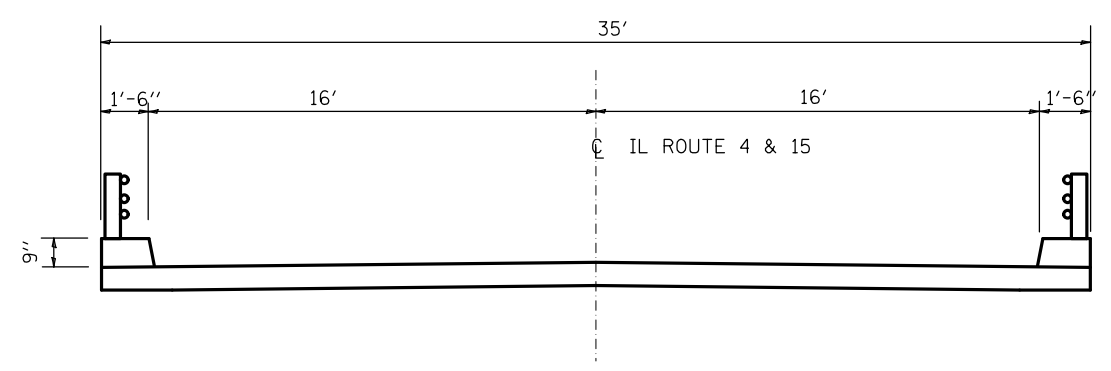

TYPICAL SECTION

TOTAL BILL OF MATERIALS

ITEM	UNIT	TOTAL
CONCRETE SEALER	SQ FT	21,007

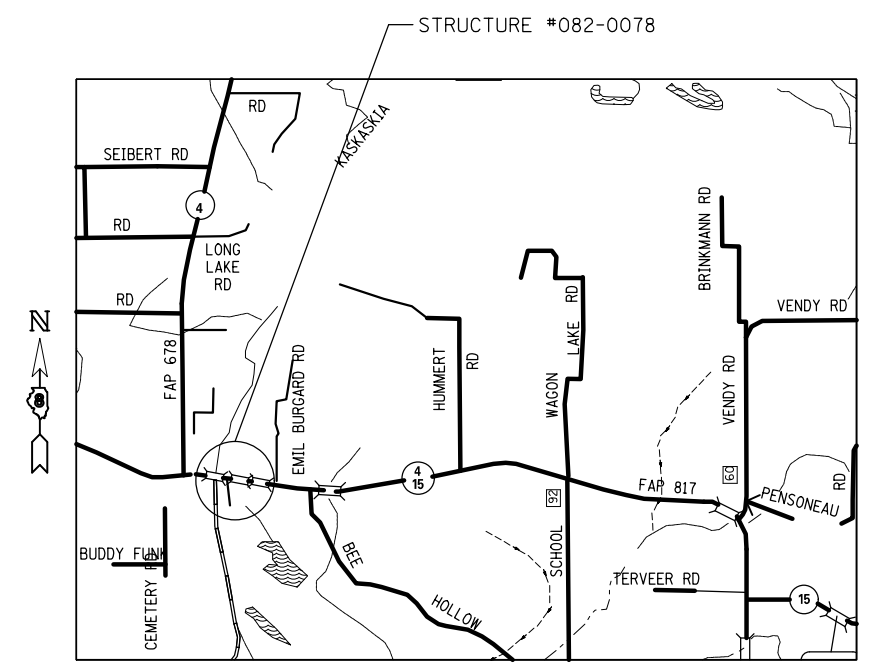

LOCATION MAP

FILE NAME =	USER NAME = burnsideem	DESIGNED -	REVISED -
et:\pw\work\p1dot\burnsideem\d0288219\d876f48-sht-plan1.dgn		DRAWN -	REVISED -
	PLOT SCALE = 100.0000' / 1in.	CHECKED -	REVISED -
	PLOT DATE = 3/23/2012	DATE -	REVISED -

STATE OF ILLINOIS
DEPARTMENT OF TRANSPORTATION

BRIDGE #082-0078 CARRYING IL 4 & 15 OVER KASKASKIA OVERFLOW
PLAN AND SECTION VIEWS

SCALE:	SHEET NO.	OF	SHEETS	STA.	TO	STA.
--------	-----------	----	--------	------	----	------

F.A. RTE.	SECTION	COUNTY	TOTAL SHEETS	SHEET NO.
VAR DIST 8	BRIDGE DECK 2012-1	ST. CLAIR	76	29
CONTRACT NO. 76F48				
FED. ROAD DIST. NO.	ILLINOIS	FED. AID PROJECT		