

TOTAL BILL OF MATERIALS

ITEM	UNIT	TOTAL
CONCRETE SEALER	SQ FT	8,433

PLAN VIEW

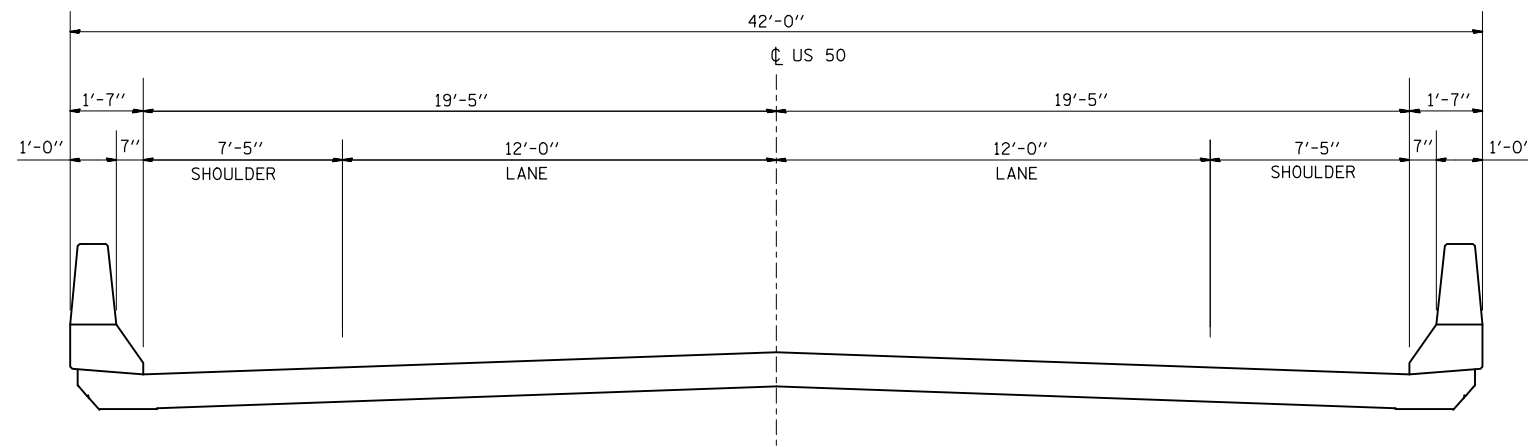

TYPICAL SECTION

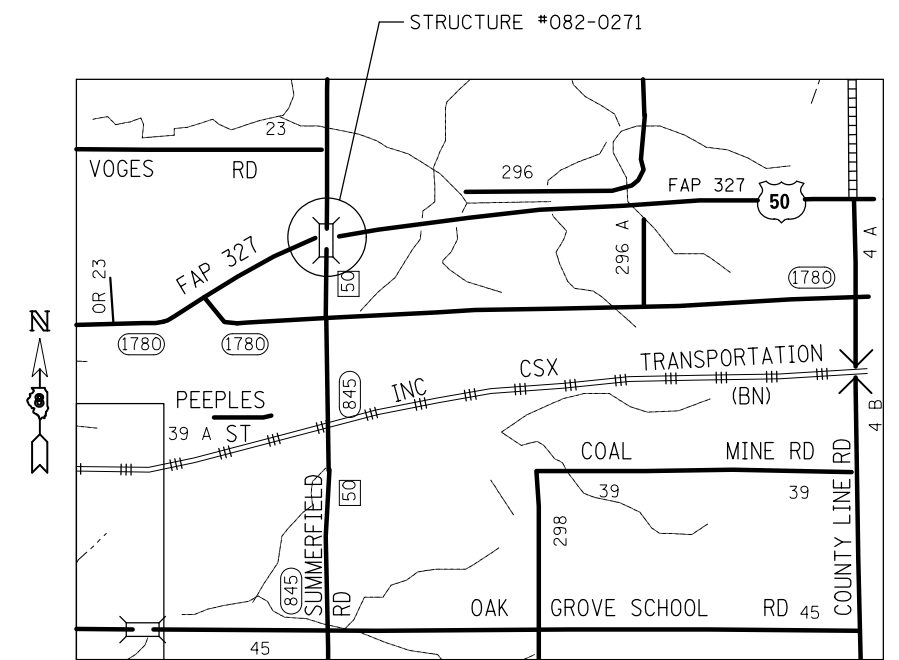

LOCATION MAP

FILE NAME =	USER NAME = Burnsideem	DESIGNED -	REVISED -	STATE OF ILLINOIS DEPARTMENT OF TRANSPORTATION	BRIDGE #082-0271 CARRYING US 50 OVER SUMMERFIELD ROAD PLAN AND SECTION VIEWS	F.A. RTE.	SECTION	COUNTY	TOTAL SHEETS	SHEET NO.	
et:\pw\work\p\dot\burnsideem\d0288219\d876f48-sh-t-plan1.dgn	PLOT SCALE = 100.0000' / 1in.	DRAWN -	REVISED -			VAR	VARIOUS	ST. CLAIR	76	51	
	PLOT DATE = 3/23/2012	CHECKED -	REVISED -			CONTRACT NO. 76F48					
		DATE -	REVISED -			SCALE: SHEET NO. OF SHEETS STA. TO STA. FED. ROAD DIST. NO. ILLINOIS FED. AID PROJECT					