

PROP. CURVE 145N
 PI STA. = 287+83.35
 Δ = 30° 00' 00" (LT)
 D = 2° 36' 00"
 R = 2,203.60'
 T = 590.45'
 L = 1,153.80'
 E = 77.73'
 e = 2.60%
 T.R. = 38.05'
 S.E. RUN = 65.95'
 P.C. STA. = 281+92.90
 P.T. STA. = 293+46.70

PROP. CURVE 145S
 PI STA. = 1014+71.51
 Δ = 12° 16' 00" (LT)
 D = 1° 00' 00"
 R = 5,729.70'
 T = 615.70'
 L = 1,226.69'
 E = 32.99'
 e = 1.00%
 T.R. = 57'
 S.E. RUN = 39'
 P.C. STA. = 1008+55.81
 P.T. STA. = 1020+82.50

ALIGNMENT COORDINATES			
IL-145	STATION	N	E
POT	276+00.00	263109.6025	884979.2773
PC	281+92.90	262619.2278	884646.0190
PT	293+46.70	261542.0107	884270.8924
POT	294+11.20	261477.6856	884266.1686
ST. EQ.	295+20.40/1020+82.50	261368.7788	884258.1710
PC	1008+55.81	260164.2853	884038.5535
POT	1002+00.00	259535.3735	883852.6593
IL-146	STATION	N	E
POT	697+28.19	261444.0778	884665.0648
POT	685+00.00	261538.2711	883440.4887

BENCHMARK "801"

ELEVATION 490.44

CHISELED "□" ON BACK SIDE OF A STANDARD INLET ALONG ROUTE 145 STA. 267+63.00, 18.00' RT OF CL

USGS 10 FWK

ELEVATION 456.28

DISK ON TOP OF SOUTHEAST WING WALL OF STRUCTURE NO. 076-0016 ALONG IL-145 OVER IL-146

NOTE: USGS 10 FWK TO BE RESET ON PROP. STRUCT. LOCATION TO BE DETERMINED IN THE FIELD BY THE ENGINEER.

M-39

ELEVATION 483.97

CUT "□" ON THE SOUTHWEST CORNER OF THE SOUTHWEST PARAPET WALL ON STRUCTURE NO. 076-0007 ALONG IL-146

BENCHMARK "800"

ELEVATION 387.99

RAILROAD SPIKE IN POWER POLE ALONG ROUTE 145 JUST NORTH OF DIXON SPRINGS MAINTENANCE YARD. SET BY OTHERS

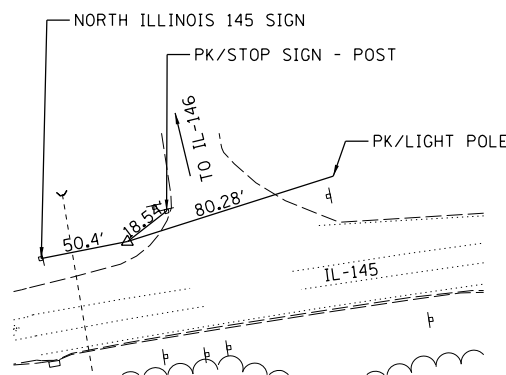

CONTROL POINT 07600161



IRON PIN WITH CAP

STA. 1015+87.48, 32.24' RT
 N 260872.0877
 E 884232.7630
 ELEV. 447.103'

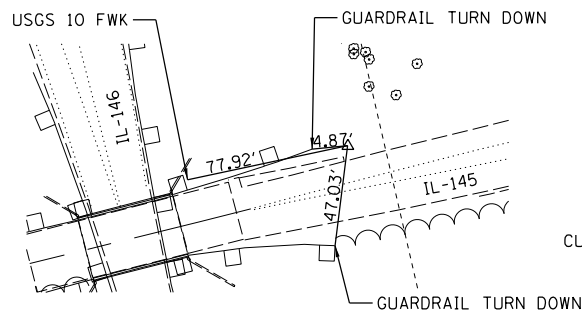

CONTROL POINT 07600162



IRON PIN WITH CAP

STA. 295+19.15, 16.43' LT
 N 261368.8266
 E 884274.6452
 ELEV. 455.189'

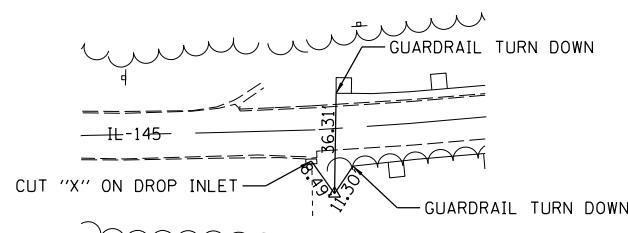

CONTROL POINT 07600163



IRON PIN WITH CAP

STA. 289+07.49, 16.79' RT
 N 261978.4700
 E 884330.1900
 ELEV. 462.457'

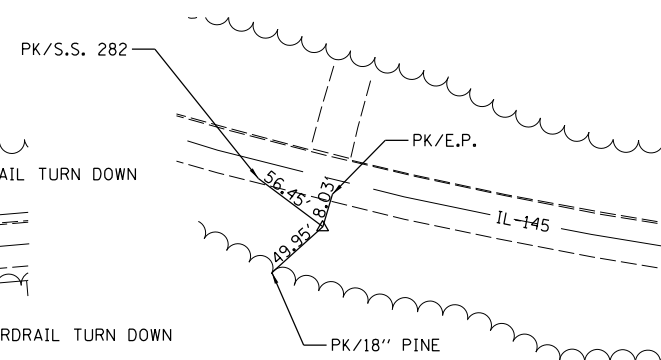

CONTROL POINT 07600164



IRON PIN WITH CAP

STA. 282+57.12, 18.88' RT
 N 262575.7500
 E 884594.7800
 ELEV. N/A

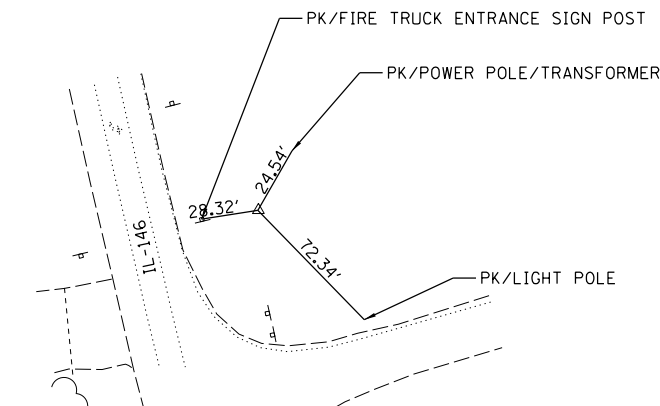

CONTROL POINT 2800



IRON PIN WITH CAP

STA. 697+28.19, 55.59' RT
 N 261385.4515
 E 884702.4031
 ELEV. 467.840'

FILE NAME =
 c:\working\dms23830\0978134-sht-A1B.dgn
 MODEL = 200 scale

USER NAME = brenn02248
 PLOT SCALE = 400.0000' / in.
 PLOT DATE = 02/22/2012

DESIGNED - BKC
 DRAWN - BKC
 CHECKED - MH
 DATE - 02/23/12

REVISED -
 REVISED -
 REVISED -
 REVISED -

**STATE OF ILLINOIS
 DEPARTMENT OF TRANSPORTATION**

IL-145 (OVER IL-146) ALIGNMENT, TIES, & BENCHMARKS

SCALE: SHEET NO. OF SHEETS STA. TO STA.

F.A.P. RTE.	SECTION	COUNTY	TOTAL SHEETS	SHEET NO.
132	103B-1	POPE	52	10
CONTRACT NO. 78134				
FED. ROAD DIST. NO. ILLINOIS FED. AID PROJECT				