

**LEGEND**

- STRUCTURE REMOVAL
- PAVEMENT REMOVAL
- GUTTER/SHOULDER REMOVAL

**STAGE 1 CONSTRUCTION**

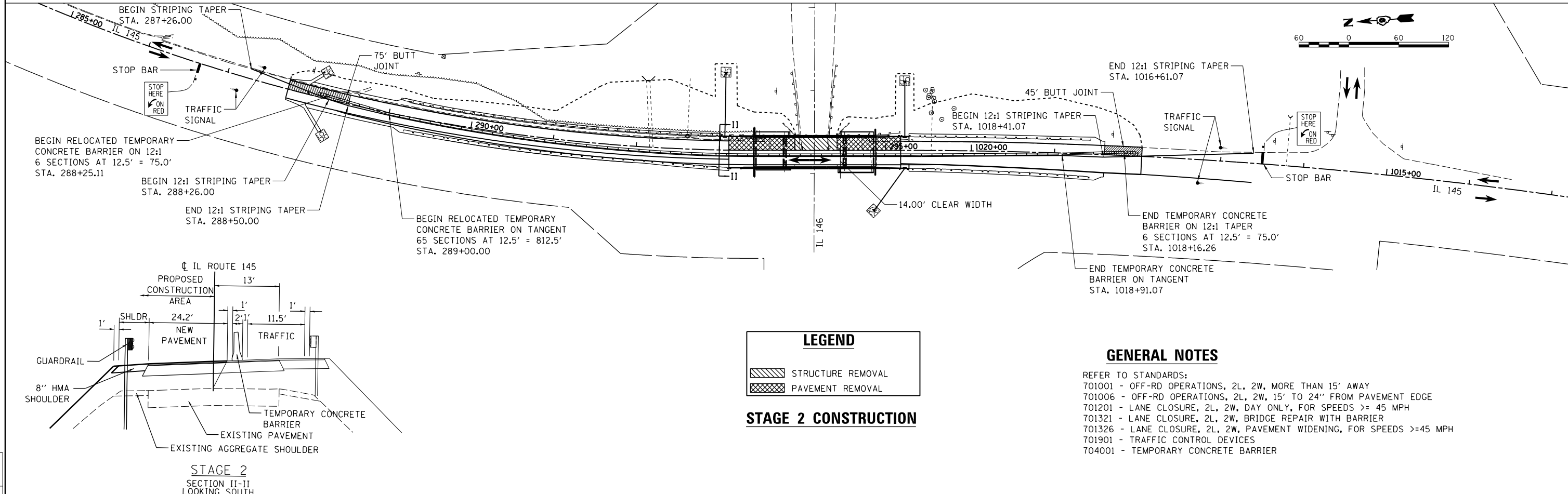

**LEGEND**

- STRUCTURE REMOVAL
- PAVEMENT REMOVAL

**STAGE 2 CONSTRUCTION**

**GENERAL NOTES**

- REFER TO STANDARDS:  
 701001 - OFF-RD OPERATIONS, 2L, 2W, MORE THAN 15' AWAY  
 701006 - OFF-RD OPERATIONS, 2L, 2W, 15' TO 24" FROM PAVEMENT EDGE  
 701201 - LANE CLOSURE, 2L, 2W, DAY ONLY, FOR SPEEDS >= 45 MPH  
 701321 - LANE CLOSURE, 2L, 2W, BRIDGE REPAIR WITH BARRIER  
 701326 - LANE CLOSURE, 2L, 2W, PAVEMENT WIDENING, FOR SPEEDS >= 45 MPH  
 701901 - TRAFFIC CONTROL DEVICES  
 704001 - TEMPORARY CONCRETE BARRIER

FILE NAME =	USER NAME = brenn00248	DESIGNED - BKC	REVISED -
et:\working\dms23830\0978134-sht-staging-new.dgn		DRAWN - BKC	REVISED -
MODEL = IL 145 STAGE CONSTRUCTION-stag	PLOT SCALE = 120.0000' / in.	CHECKED - MH	REVISED -
	PLOT DATE = 02/22/2012	DATE - 02/23/12	REVISED -

**STATE OF ILLINOIS  
 DEPARTMENT OF TRANSPORTATION**

**IL-145 (OVER IL-146) TRAFFIC CONTROL AND STAGING**

SCALE: SHEET NO. OF SHEETS STA. TO STA.

F.A.P. RTE.	SECTION	COUNTY	TOTAL SHEETS	SHEET NO.
132	103B-1	POPE	52	13
CONTRACT NO. 78134				
FED. ROAD DIST. NO. ILLINOIS FED. AID PROJECT				