

**STAGE I REMOVAL**  
LOOKING SOUTH

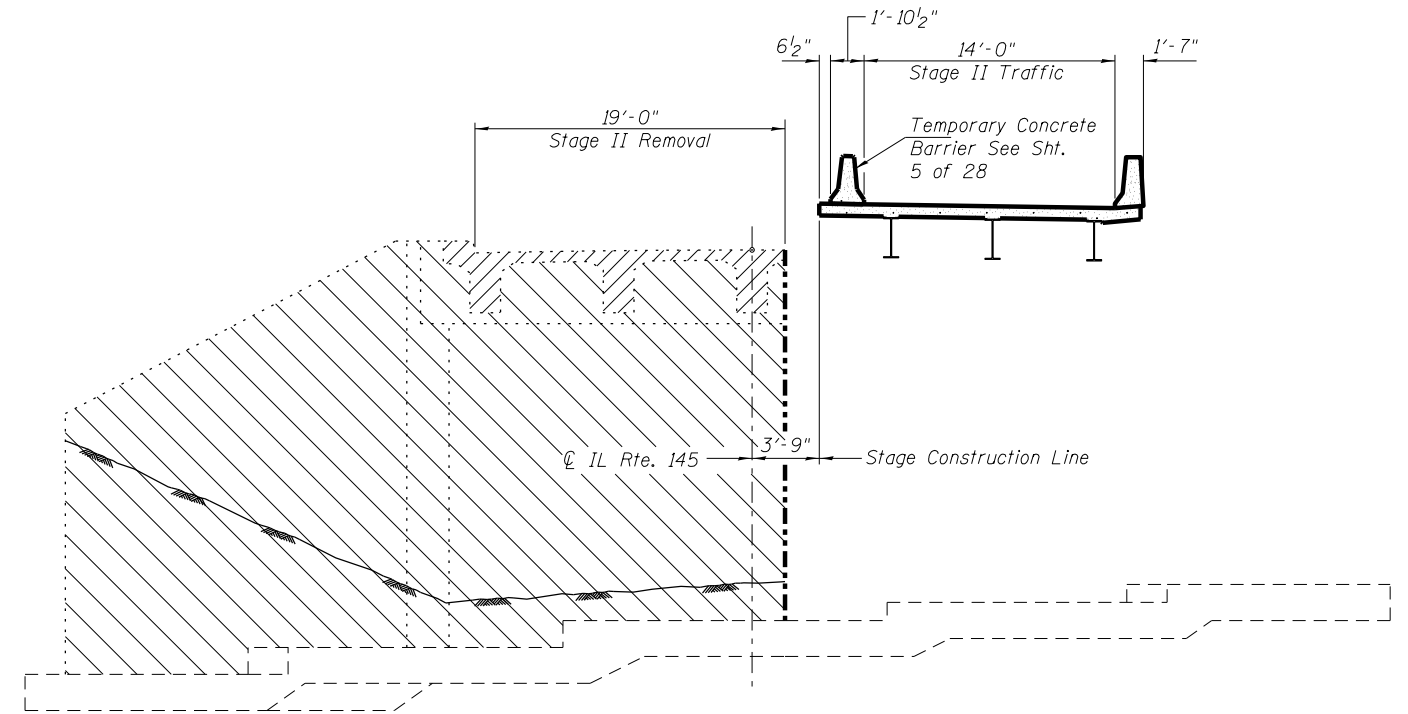

**STAGE II REMOVAL**  
LOOKING SOUTH

Indicates Areas to be removed as part of "Removal of Existing Structures".

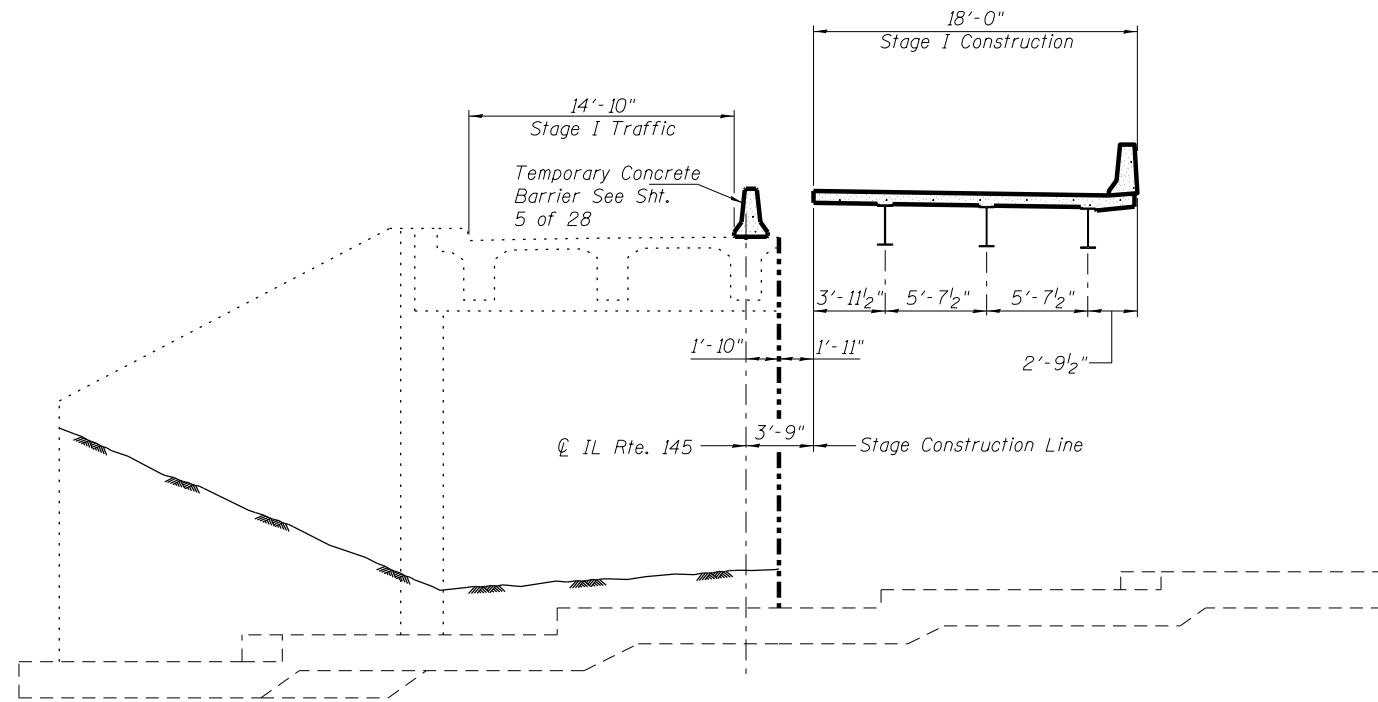

**STAGE I CONSTRUCTION**  
LOOKING SOUTH

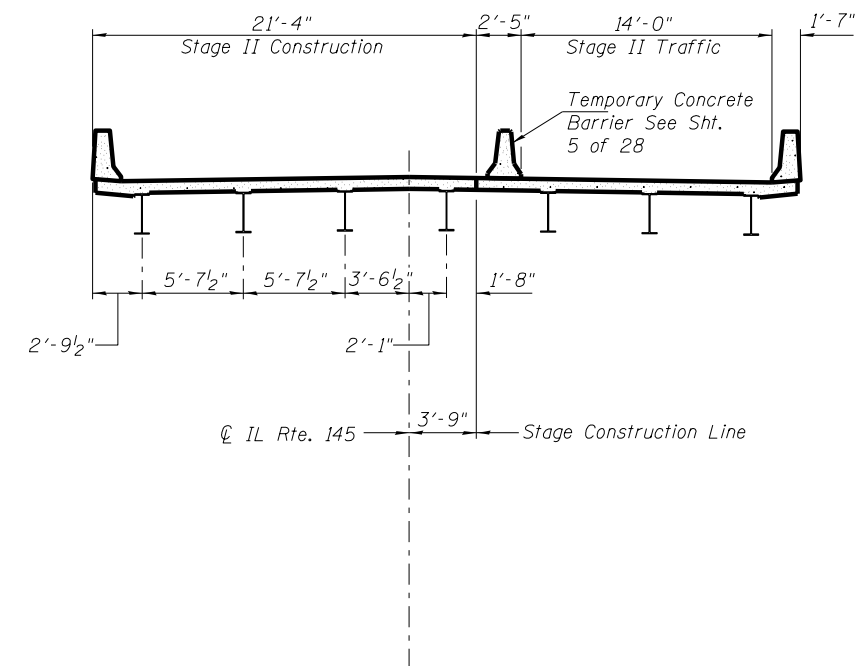

**STAGE II CONSTRUCTION**  
LOOKING SOUTH

Note: See Roadway Plans for Temporary Concrete Barrier quantities.

FILE NAME = 0760028-78134.dgn	USER NAME = hmf1m00028	DESIGNED - BDC	REVISED -	<b>STATE OF ILLINOIS DEPARTMENT OF TRANSPORTATION</b>	<b>STAGE CONSTRUCTION DETAILS STRUCTURE NO. 076-0028</b>	F.A.P. RTE.	SECTION	COUNTY	TOTAL SHEETS	SHEET NO.
PLOT SCALE =	DRAWN - Rod	REVISED -	132			103B-1	Pope	52	28	
PLOT DATE = 02/22/2012	CHECKED - TEH	REVISED -	<b>CONTRACT NO. 78134</b>							
						ILLINOIS FED. AID PROJECT				