

**HORIZONTAL CONTROL**

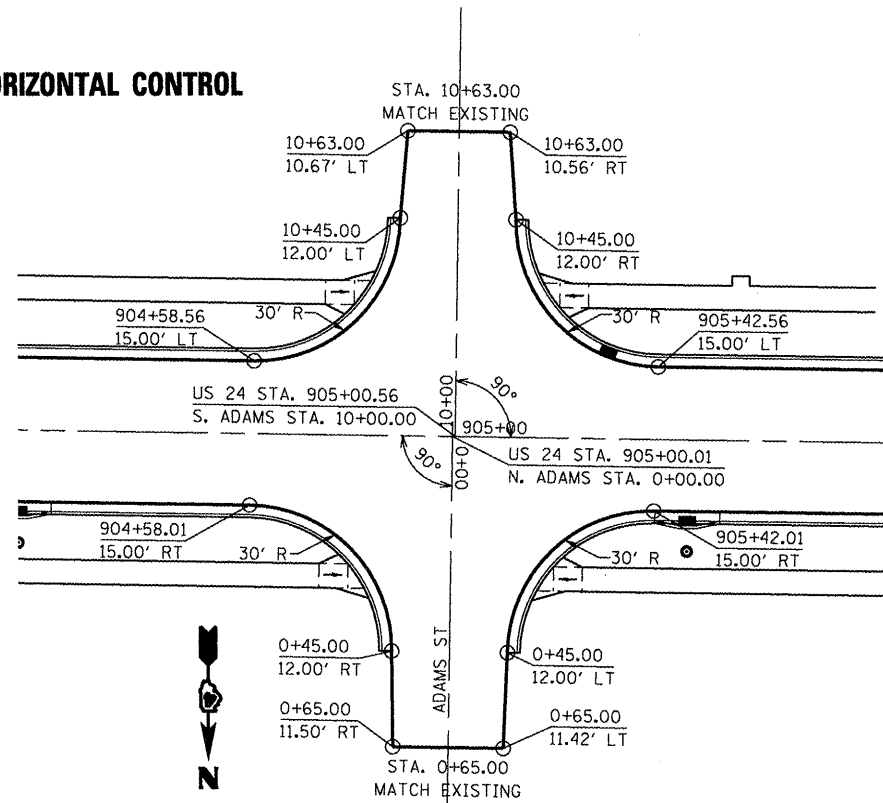

**VERTICAL CONTROL**

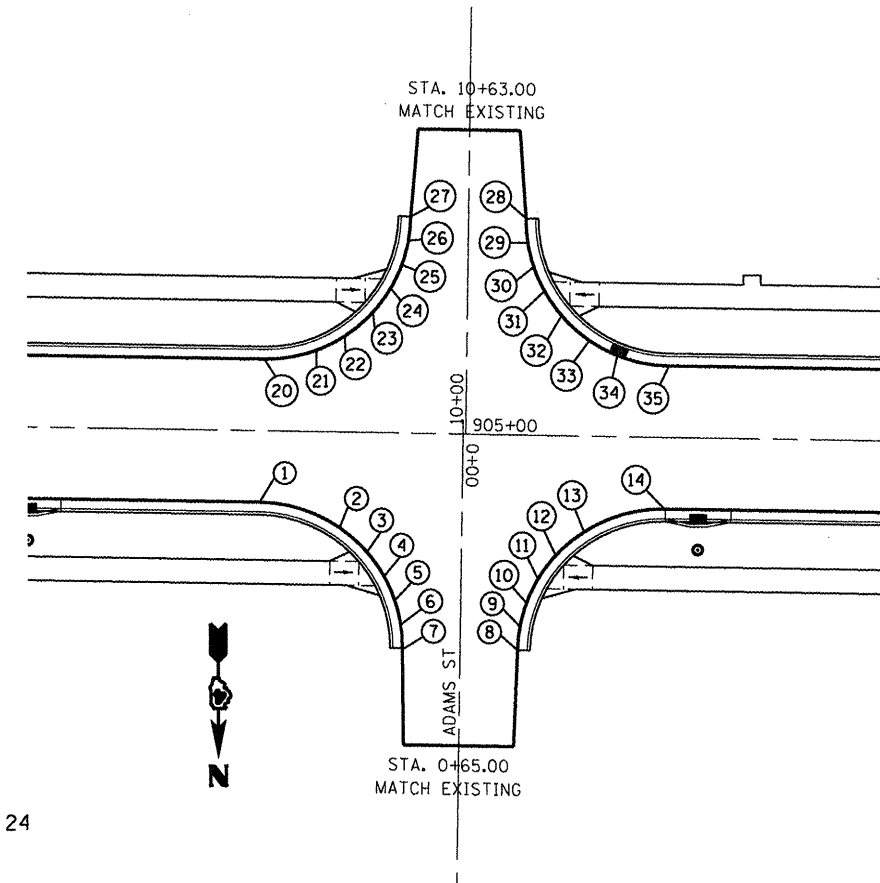

- NOTES:**
1. SEE SIDEROAD PROFILES.
  2. TYPICAL TRANSVERSE JOINT SPACING ON US 24 BETWEEN INTERSECTIONS SHALL BE 14'.

**PAVEMENT JOINTS**

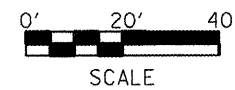
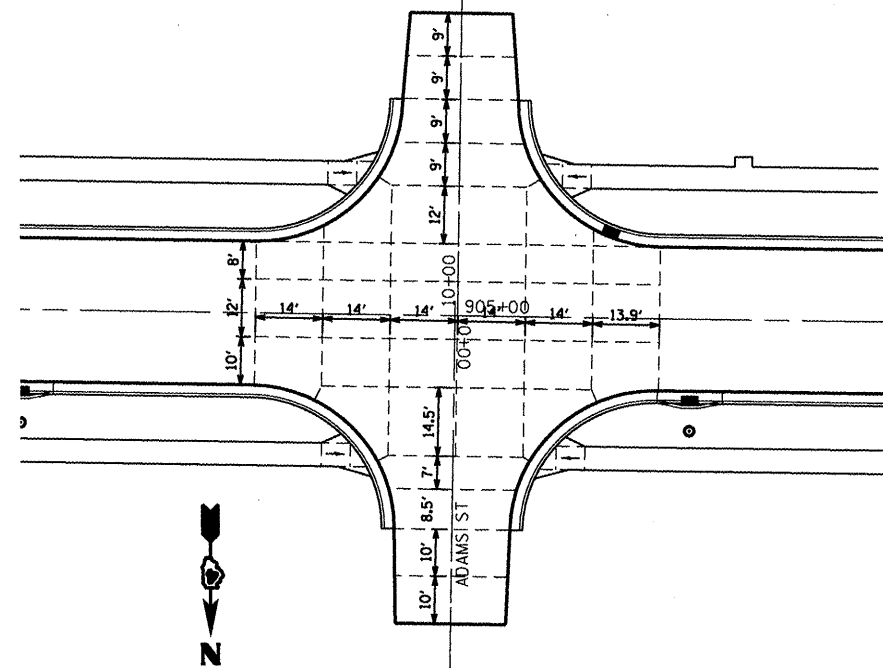

LOCATION	STATION	OFFSET	ELEVATION
N. ADAMS ST			
1	0+15.00	42.00	701.66
2	0+20.00	25.42	701.74
3	0+25.00	19.64	701.69
4	0+30.00	16.02	701.65
5	0+35.00	13.72	701.61
6	0+40.00	12.42	701.57
7	0+45.00	12.00	701.53
8	0+45.00	12.00	701.53
9	0+40.00	12.42	701.58
10	0+35.00	13.72	701.63
11	0+30.00	16.02	701.69
12	0+25.00	19.64	701.76
13	0+20.00	25.42	701.85
14	0+15.00	42.00	702.02

LOCATION	STATION	OFFSET	ELEVATION
S. ADAMS ST			
20	10+15.00	42.00	701.66
21	10+17.00	31.23	701.75
22	10+20.00	25.42	701.79
23	10+25.00	19.64	701.88
24	10+30.00	16.02	701.98
25	10+35.00	13.72	702.09
26	10+40.00	12.42	702.16
27	10+45.00	12.00	702.19
28	10+45.00	12.00	702.19
29	10+40.00	12.42	702.16
30	10+35.00	13.72	702.12
31	10+30.00	16.02	702.08
32	10+25.00	19.64	702.04
33	10+20.00	25.42	701.99
34	10+17.00	31.23	701.94
35	10+15.00	42.00	702.03