

SURVEY PLOTTED TEMPLATE
 NOTE BOOK NO. _____
 AREAS CHECKED _____
 SURVEY PLOTTED TEMPLATE
 NOTE BOOK NO. _____
 AREAS CHECKED _____

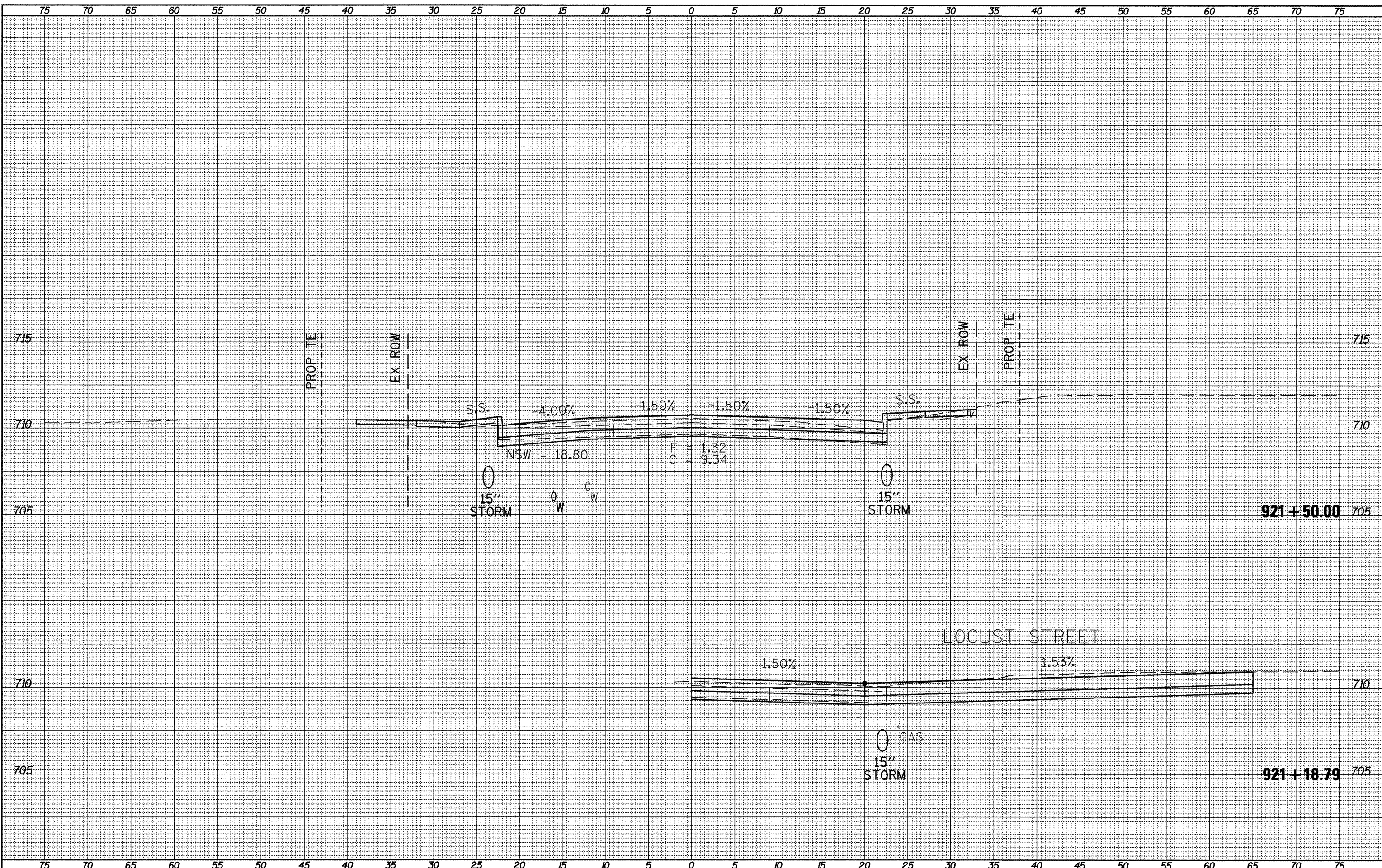

FILE NAME = xsect_sht.dgn	USER NAME = horstkj	DESIGNED -	REVISED -	STATE OF ILLINOIS DEPARTMENT OF TRANSPORTATION	CROSS SECTIONS	F.A.P. RTE. 317	SECTION 16W-1,RS-3	COUNTY FULTON	TOTAL SHEETS 341	SHEET NO. 284		
PLOT SCALE = 1/8" = 1' / 32"		DRAWN -	REVISED -			SCALE:	SHEET NO. OF SHEETS	STA. 921+18.79	TO STA. 921+50.00	ILLINOIS FED. AID PROJECT		
PLOT DATE = 3/21/2012		CHECKED -	REVISED -			CONTRACT NO. 88795						
DATE -		REVISED -	REVISED -									