

PLAN
 SURVEYED
 PLOTTED
 CHECKED
 RT. OF WAY CHECKED
 CAD FILE NAME
 NO.
 BY
 DATE

PROFILE
 SURVEYED
 PLOTTED
 CHECKED
 BRIDGE CHECKED
 STRUCTURE NOTATIONS CHK'D
 NO.
 BY
 DATE

Station	BACK EDGE OF SW		BOC		BOC		BACK EDGE OF SW		NOTES
	O.S.	ELEVATION	O.S.	ELEVATION	O.S.	ELEVATION	O.S.	ELEVATION	
27+00	33.00	588.74	20.58	588.49	20.58	588.65	33.00	588.90	BOC - WITHIN ENTRANCE USE DEPRESSED CURB, ELEV. SHOWN IS THEORETICAL TOP OF CURB
27+25	33.00	588.87	20.58	588.57	20.58	588.98	33.00	588.90	BOC - WITHIN ENTRANCE USE DEPRESSED CURB, ELEV. SHOWN IS THEORETICAL TOP OF CURB
27+50	33.00	588.90	20.58	588.65	20.58	589.30	33.00	589.30	BOC - WITHIN ENTRANCE USE DEPRESSED CURB, ELEV. SHOWN IS THEORETICAL TOP OF CURB
27+75	33.00	589.33	20.58	589.00	20.58	589.62	33.00	589.70	BOC - WITHIN ENTRANCE USE DEPRESSED CURB, ELEV. SHOWN IS THEORETICAL TOP OF CURB
28+00	33.00	589.58	20.58	589.34	20.58	589.94	33.00	590.20	BOC - WITHIN ENTRANCE USE DEPRESSED CURB, ELEV. SHOWN IS THEORETICAL TOP OF CURB
28+25	33.00	590.00	20.58	589.78	20.58	590.26	33.00	590.50	
28+50	33.00	590.38	20.58	590.18	20.58	590.57	33.00	590.80	BOC - WITHIN ENTRANCE USE DEPRESSED CURB, ELEV. SHOWN IS THEORETICAL TOP OF CURB

+. SIDEWALK ELEVATION AND O.S. SHALL MATCH EXISTING ELEVATIONS.

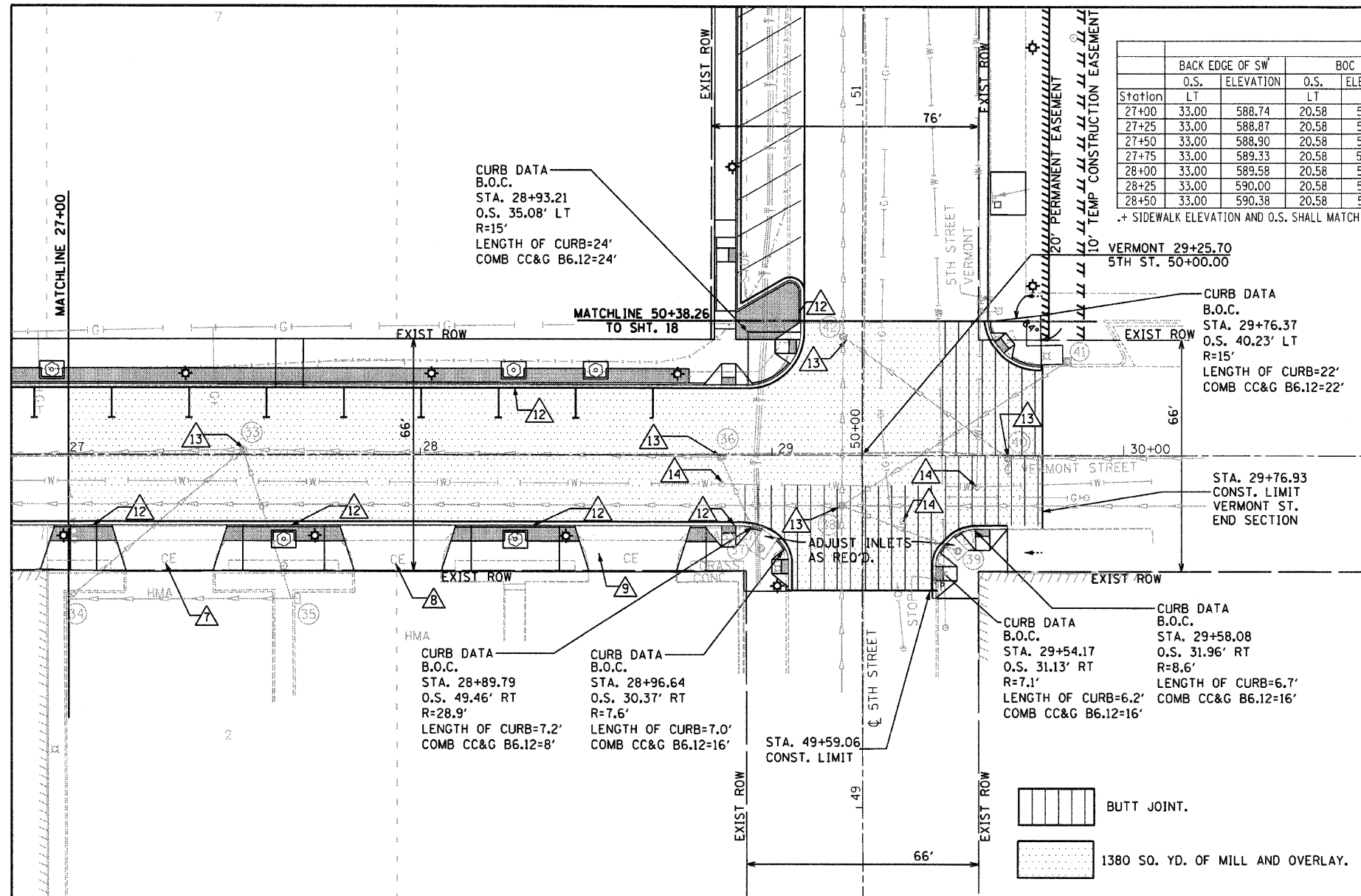

△7	STA 27+28.68 RT C/L 25' WIDE DRIVEWAY PCC DRIVEWAY PAVT. 6" = 41 S.Y.	△9	STA 28+60.44 RT C/L 25' WIDE DRIVEWAY PCC DRIVEWAY PAVT. 6" = 41 S.Y.	△12	CC&G B6.12 = 450 FT
△8	STA 27+93.59 RT C/L 25' WIDE DRIVEWAY PCC DRIVEWAY PAVT. 6" = 41 S.Y.	△13	MAN ADJUST = 5 EA	△14	VALVE BOX ADJ = 3 EA

▨ BUTT JOINT.
 ▨ 1380 SO. YD. OF MILL AND OVERLAY.

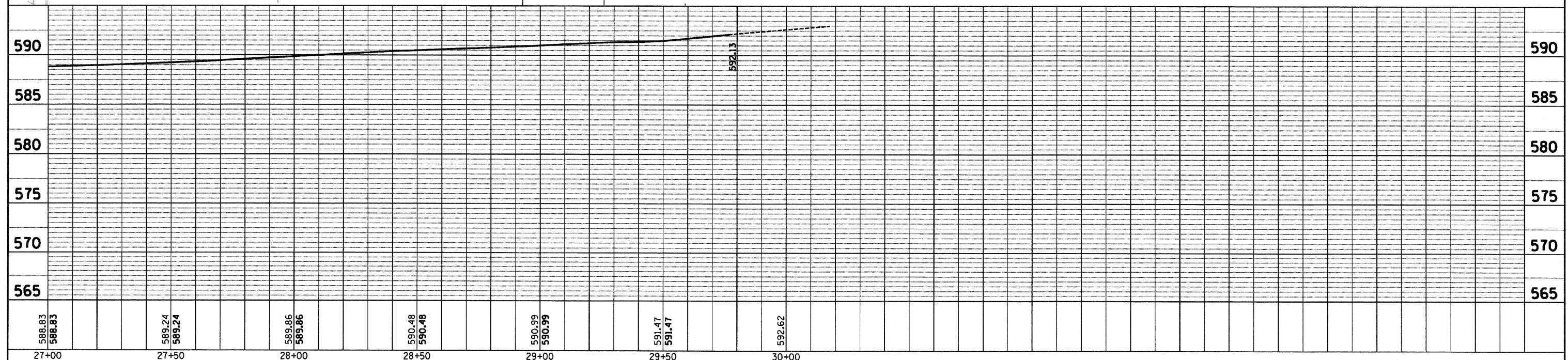
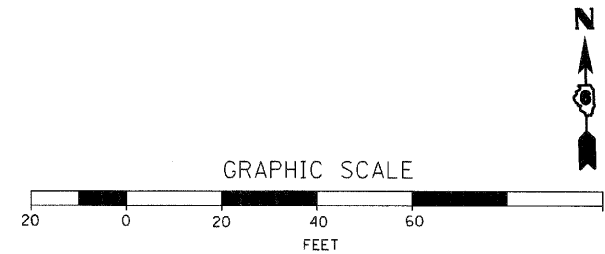

FILE NAME = DSXXXX-sht-17-PlnPrf-Vermont	USER NAME = MDL	DESIGNED -	REVISED -	STATE OF ILLINOIS DEPARTMENT OF TRANSPORTATION	VERMONT STREET PLAN & PROFILE	F.A.P. RTE. 63	SECTION 09-00309-00-LS	COUNTY ADAMS	TOTAL SHEETS 39	SHEET NO. 17	CONTRACT NO. 93578		
PLOT SCALE = 1" = 40'	CHECKED -	REVISED -	SCALE: 1" = 20'			SHEET NO. 2 OF 2 SHEETS	STA. 27+00.00 TO STA. 30+67.97	ILLINOIS FED. AID PROJECT					
PLOT DATE = #DATE#	DATE -	REVISED -											