

SHEET ITEM	STREET	PAY ITEM	MUTCD NO.	DISCRIPTION	UNIT	QUANTITY	STA	O.S.	LT/RT	NOTES	FACE
1	VERMONT	72400200 - REMOVE SIGN PANEL ASSEMBLY - TYPE B		STOP SIGN WITH ONE WAY SIGN	EA	1					N/A
2	VERMONT	72000100 - SIGN PANEL - TYPE 1	R1-1	30" X 30" STOP SIGN	SO. FT.	6.25	24+24	24	RT		W
3	VERMONT	72000100 - SIGN PANEL - TYPE 1	R6-2	30"X36" ONE WAY SIGN	SO. FT.	7.5	24+35	35	RT		E
4	VERMONT	72400200 - REMOVE SIGN PANEL ASSEMBLY - TYPE B		STOP SIGN WITH ONE WAY SIGN	EA	1					N/A
5	VERMONT	72000100 - SIGN PANEL - TYPE 1	R1-1	30" X 30" STOP SIGN	SO. FT.	6.25	24+98	24	LT		E
6	VERMONT	72000100 - SIGN PANEL - TYPE 1	R6-2	30"X36" ONE WAY SIGN	SO. FT.	7.5	24+45	38	RT		W
7	VERMONT	72000100 - SIGN PANEL - TYPE 1	D3-1	STREET SIGN - VERMONT	SO. FT.	3	24+45	38	RT	INSTALL ABOVE 1-WAY SIGN	N/S
		72000100 - SIGN PANEL - TYPE 1	D3-1	STREET SIGN - 4TH STREET	SO. FT.	3	24+45	38	RT		E/W
8	VERMONT	72400710 - RELOCATE SIGN PANEL - TYPE 1		EMERGENCY SNOW ROUTE	SO. FT.	3	26+08	23.1	RT	INSTALL ON NEW LIGHT POST	W

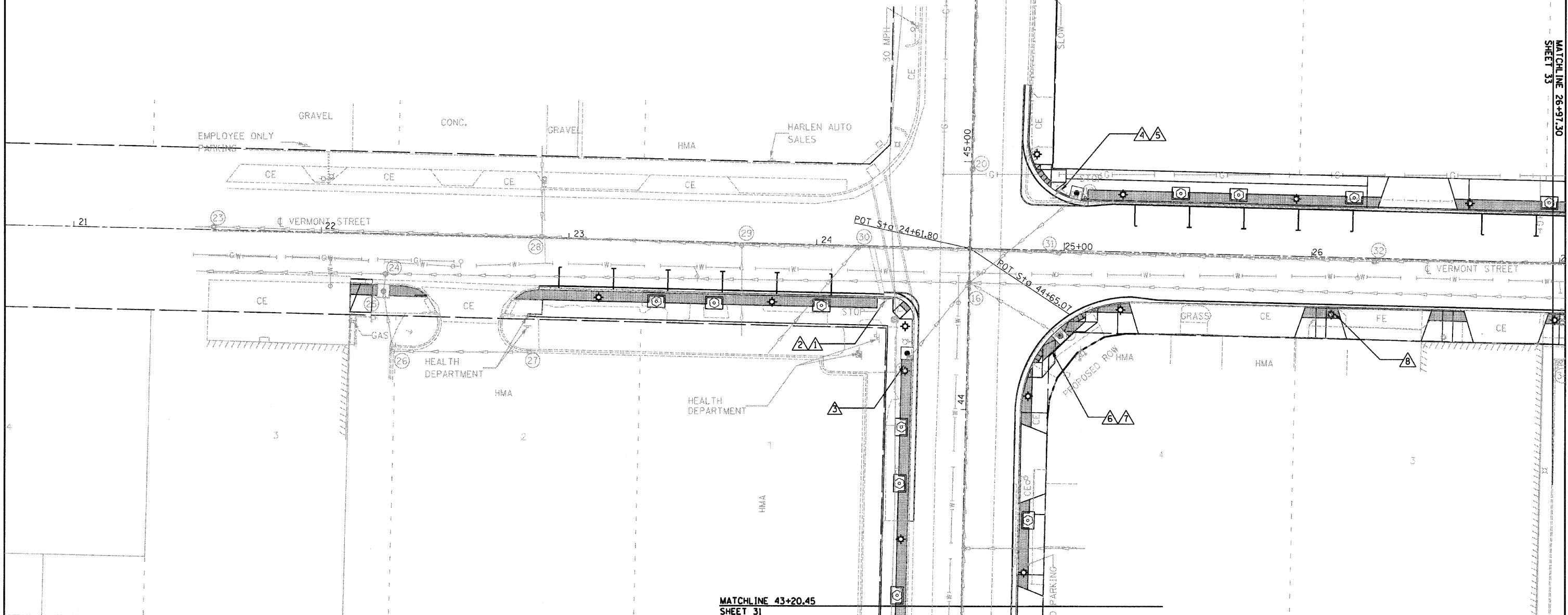

FILE NAME = D6XXXX-shr-32-Sign

USER NAME = MDL  
 DESIGNED -  
 DRAWN -  
 CHECKED -  
 DATE -  
 PLOT SCALE = 1" = 40'  
 PLOT DATE = #DATE#

DESIGNED -  
 REVISIONS:  
 REVISIONS:  
 REVISIONS:  
 REVISIONS:

**STATE OF ILLINOIS  
 DEPARTMENT OF TRANSPORTATION**

**SIGNING PLAN SHEETS**  
 SCALE: 1" = 20' SHEET NO. 2 OF 3 SHEETS STA. \_\_\_\_\_ TO STA. \_\_\_\_\_

F.A.P. RTE. 63	SECTION 09-00309-00-LS	COUNTY ADAMS	TOTAL SHEETS 39	SHEET NO. 32
CONTRACT NO. 93578				
ILLINOIS FED. AID PROJECT				