

SHEET NO.  
**23 of 55**

Job No. 086-09  
Scale: 1"=20'  
Drawn by: BEC  
Design by: BEC  
Approved by: CMB  
File Name: Shiloh Plans

ISSUE RECORD	
DATE	DESCRIPTION
4/20/12	FS&E 4/20/12

Corporate Engineering Certificate # 000361

CIVIL ENGINEER  
4/20/12

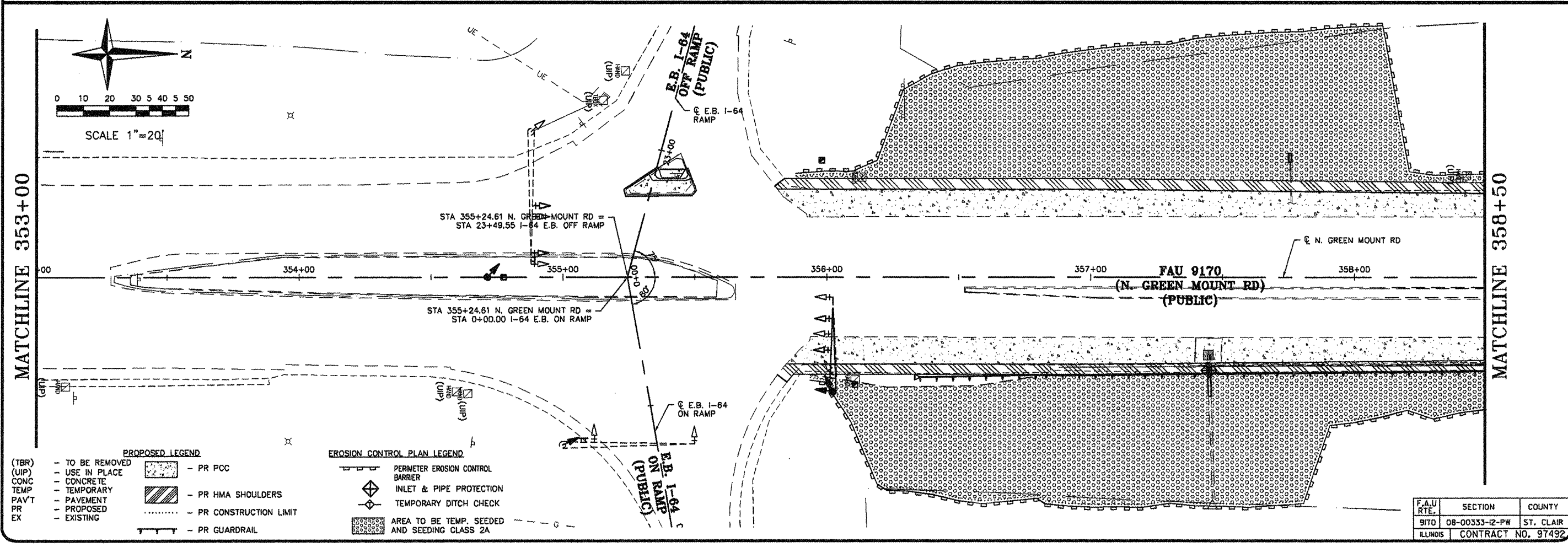

**CBB** Crawford, Bunte, Brammeier  
Traffic and Transportation Engineers

St. Louis, Missouri/Glen Carbon, Illinois  
314-878-6644 618-656-2612  
Fax: 314-878-5876 E-Mail: cbb@cbbtraffic.com

**EROSION CONTROL PLAN**

N. GREEN MOUNT ROAD & I-64  
E.B. RAMP, W.B. RAMP &  
REGENCY PARK/PIERCE BLVD  
SHILOH, ILLINOIS

F.A.U. RTE.	SECTION	COUNTY
917D	08-00333-12-PW	ST. CLAIR
ILLINOIS	CONTRACT NO. 97492	

- PROPOSED LEGEND**
- (TBR) TO BE REMOVED
  - (CIP) USE IN PLACE
  - CONC CONCRETE
  - TEMP TEMPORARY
  - PAV PAVEMENT
  - PROPOSED
  - EXISTING
- EROSION CONTROL PLAN LEGEND**
- PR PCC
  - PR HMA SHOULDERS
  - PR CONSTRUCTION LIMIT
  - PR GUARDRAIL
  - PERIMETER EROSION CONTROL BARRIER
  - INLET & PIPE PROTECTION
  - TEMPORARY DITCH CHECK
  - AREA TO BE TEMP. SEEDED AND SEEDING CLASS 2A