

F.A.U. ROUTE	SECTION	COUNTY	TOTAL SHEETS	SHEET NUMBER
9910	10-00050-00-RS	UNION	16	4
CITY OF ANNA		PROJECT NO. M-5080(006)		
CONTRACT NO. 99470		JOB NO. C99-542-10		

+50 1+00 +50 2+00 +50 3+00 +50 4+00 +50 5+00 +50

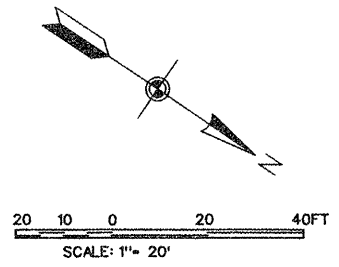

- LEGEND**
- ⊛ - PROPOSED STREET LIGHT
 - ⊙ - STREET SIGNAL
 - ⊕ - STREET LIGHT
 - ⊖ - ELECTRIC POLE
 - ⊗ - TELEPHONE POLE
 - ⊙ - SIGN
 - ⊖ - HYDRANT
 - ⊙ - WATER METER
 - ⊙ - PROPOSED LANDSCAPING

CURVE NO. 1		CURVE NO. 2		STA. EQUATION
Δ = 2°29'25"	PC = 0+00	PC = 0+99.985	PT = 1+99.97	1+99.97 BK=2+00 FWD
T = 50'	PI = 0+50	PI = 1+49.985		
L = 99.985	PT = 0+99.985	PT = 1+99.97		
R = 2300.67				

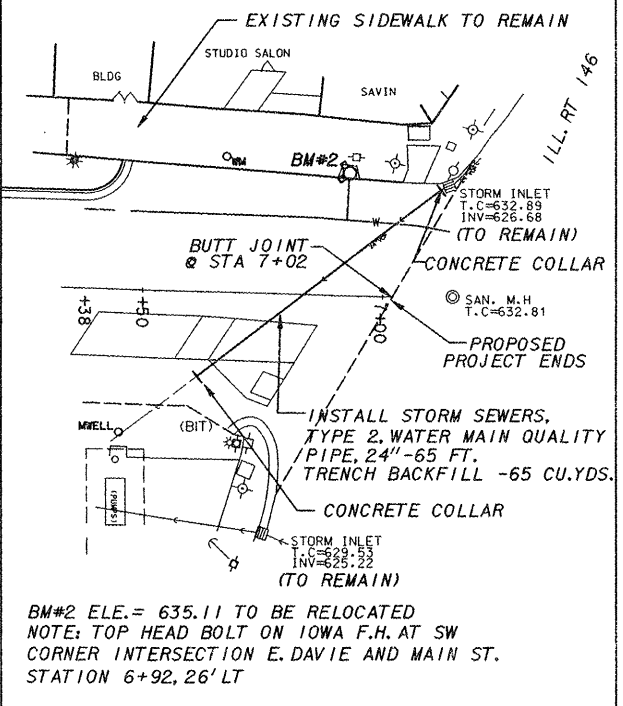
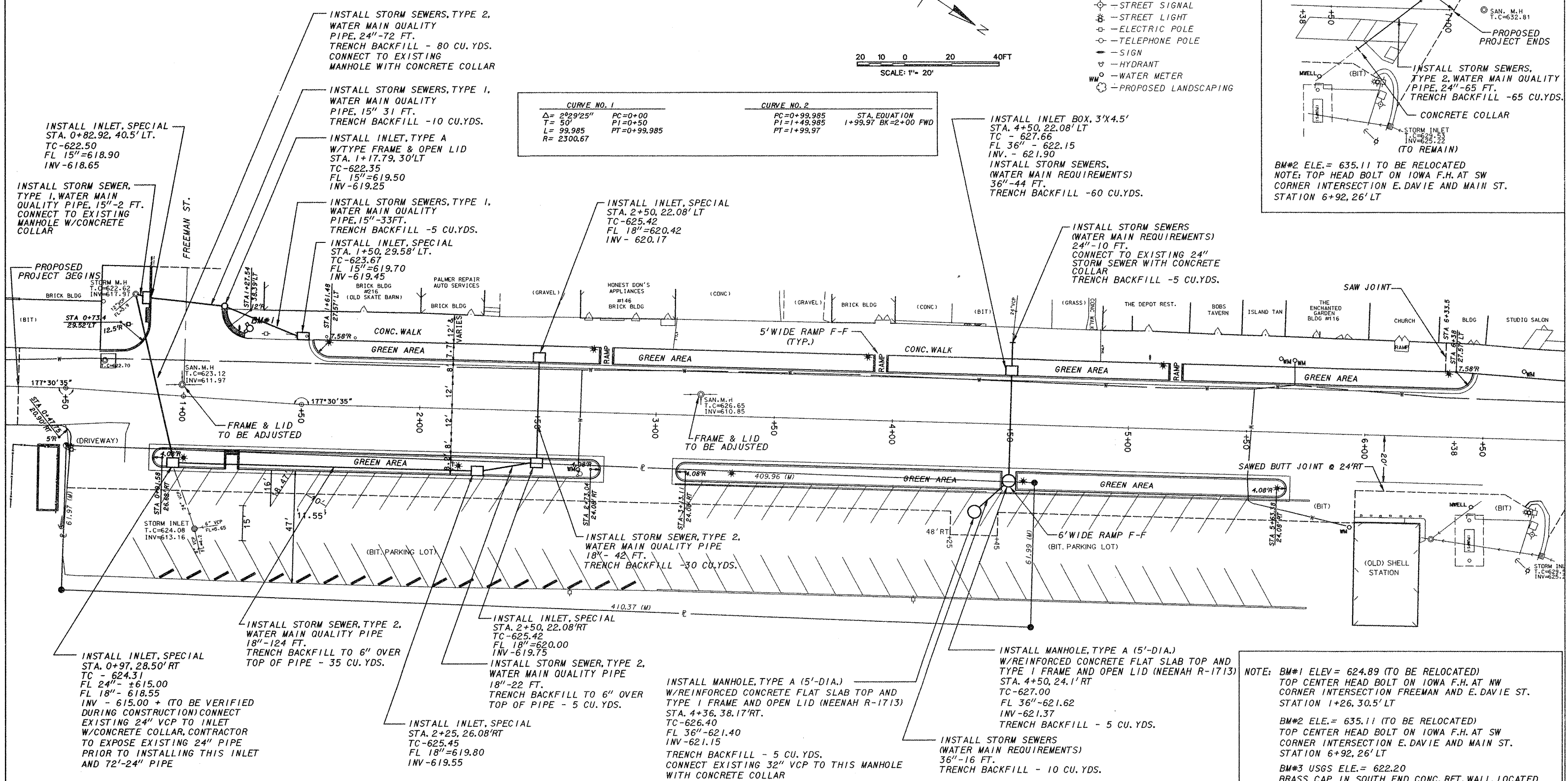

NOTE: BM#1 ELEV = 624.89 (TO BE RELOCATED)
TOP CENTER HEAD BOLT ON IOWA F.H. AT NW CORNER INTERSECTION FREEMAN AND E. DAVIE ST. STATION 1+26.30.5' LT

BM#2 ELEV = 635.11 (TO BE RELOCATED)
TOP CENTER HEAD BOLT ON IOWA F.H. AT SW CORNER INTERSECTION E. DAVIE AND MAIN ST. STATION 6+92.26' LT

BM#3 USGS ELEV = 622.20
BRASS CAP IN SOUTH END CONC. RET. WALL. LOCATED AT E. SIDE ANNA STATE BANK ± 31' SE CORNER OF BANK ± 43' S. CORNER OF BANK ± 34' N. OF E. VIENNA ST.

NOTE: CONTRACTOR TO EXCAVATE AND EXPOSE EXISTING 8" DI/C1 WATER MAINS AT ALL LOCATIONS WHERE NEW STORM SEWERS CROSS WATER MAIN PRIOR TO THE INSTALLATION OF ANY NEW INLETS/STORM SEWER/ MANHOLES.