

F.A.U. ROUTE	SECTION	COUNTY	TOTAL SHEETS	SHEET NUMBER
9910	10-00050-00-RS	UNION	16	9
CITY OF ANNA		PROJECT NO. M-5080(006)		
CONTRACT NO. 99470		JOB NO. C99-542-10		

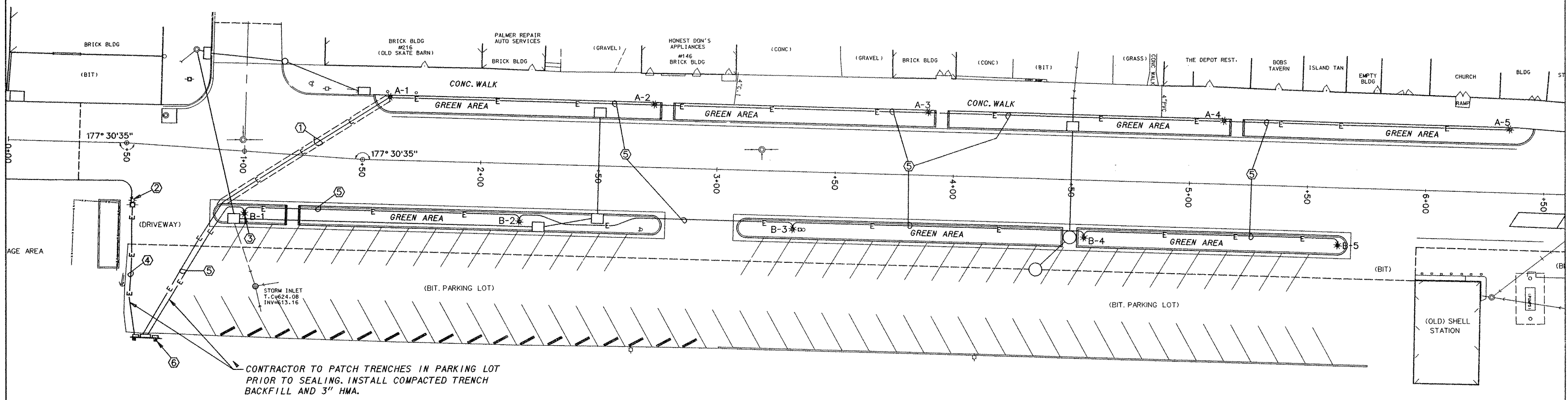
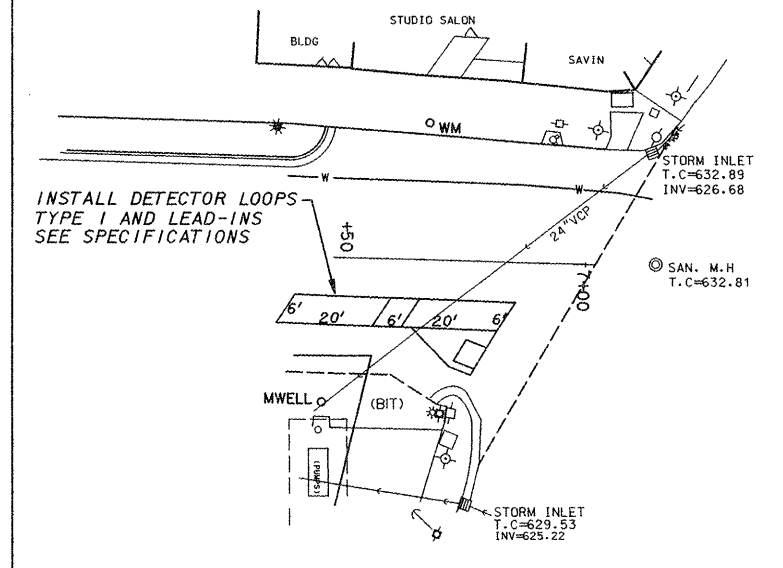

SITE PLAN NOTES:

- ① CONDUIT UNDER DAVIE STREET SHALL BE 3 FT. DEEP MINIMUM AND ENCASED 3" ON ALL SIDES WITH CONCRETE.
- ② EXISTING AMEREN ILLINOIS POWER POLE. INSTALL SERVICE RISER UP POLE TO HEIGHT REQUIRED BY AMEREN AND TERMINATE IN A WEATHERHEAD. VERIFY SERVICE REQUIREMENTS PRIOR TO INSTALLATION AND ADJUST PER AMEREN REGULATIONS.
- ③ TYPICAL FOR TEN LIGHTING ASSEMBLIES. SEE FOUNDATION DETAIL, SHEET 10.
- ④ SERVICE CONDUIT IN TRENCH SHALL BE 3 FT DEEP, MINIMUM.
- ⑤ LIGHTING SYSTEM CONDUIT IN TRENCH SHALL BE 2 FT DEEP, MINIMUM. SEE SYSTEM I- LINE DIAGRAM.
- ⑥ SERVICE EQUIPMENT STRUCTURE. SEE DETAIL, SHEET 10.

LEGEND

- A-3 — TYPE "A" ASSEMBLY
- B-3 — TYPE "B" ASSEMBLY
- ☀ — PROPOSED STREET LIGHT
- E— — PROPOSED UNDERGROUND ELECTRICAL
- ≡E≡ — PROPOSED UNDERGROUND ELECTRICAL CONCRETE ENCASED
- ⊕ — TRAFFIC SIGNAL
- ☼ — EXISTING STREET LIGHT
- ⊕ — ELECTRIC POLE
- ⊙ — TELEPHONE POLE
- — SIGN
- ⊕ — HYDRANT
- ⊙ — WATER METER

