

SCOPE OF WORK

RUNWAY 13-31 - THIS PORTION OF THE PROJECT INCLUDES BUT IS NOT LIMITED TO MILLING, CRACK CLEANING AND SEALING, PAVEMENT REPAIRS, PAVING, SHOULDER ADJUSTMENT, SEEDING, MULCHING AND PAVEMENT MARKING.

APRON - THE PORTION OF THE PROJECT INCLUDES BUT IS NOT LIMITED TO MILLING, EARTHWORK, DRAINAGE, PAVING, TIEDOWN PLACEMENT, AND PAVEMENT MARKING.

CONNECTING TAXIWAY A1 - THIS PORTION OF THE PROJECT INCLUDES BUT IS NOT LIMITED TO EARTHWORK, PAVING, AND PAVEMENT MARKING.

COORDINATION

CONSTRUCTION OF THIS PROJECT WILL LIKELY TAKE PLACE CONCURRENT WITH AN AIRFIELD LIGHTING AND ELECTRICAL PROJECT. CONTRACTORS MUST COORDINATE TO AVOID CONFLICT.

PROPOSED SAFETY PLAN

GENERAL - THE JOLIET REGIONAL AIRPORT IS COMPRISED OF TWO RUNWAYS. THE PROPOSED CONSTRUCTION WILL NECESSITATE CLOSING BOTH RUNWAYS. ANY TIME THE CONTRACTOR IS WORKING WITHIN 200' OF THE RUNWAY CENTERLINE THE RUNWAY WILL BE CLOSED. ALL WORK INCLUDED IN OPENING AND CLOSING THE RUNWAY WILL BE CONSIDERED INCIDENTAL TO THE PROJECT AND NO ADDITIONAL COMPENSATION WILL BE ALLOWED. ALL NOTAM'S WILL BE ISSUED BY AIRPORT PERSONNEL. THE CONTRACTOR WILL COORDINATE DEACTIVATION OF THE BEACON AND ALL LIGHTING AND NAVAIDS WITH THE AIRPORT.

IDENTIFICATION - WHEN THE CONTRACTORS VEHICLES AND EQUIPMENT ARE ON THE AIRPORT THEY SHALL BE PROPERLY MARKED WITH THREE (3') FOOT SQUARE CHECKERED FLAGS (INTERNATIONAL ORANGE AND WHITE). THE CONTRACTOR WILL ALSO PROVIDE WORKERS WITH SOME TYPE OF TAG OR GARMENT TO IDENTIFY THE PERSON AS BEING PART OF THE CONSTRUCTION CREW.

RADIO CONTROL - THE CONTRACTOR WILL BE REQUIRED TO BE IN TWO-WAY RADIO CONTACT (122.70 MHz.) WITH THE AIRPORT UNICOM. THIS WILL KEEP THE CONTRACTOR IN CONSTANT CONTACT WITH THE JOLIET REGIONAL AIRPORT AND ENABLE THE AIRPORT TO IMMEDIATELY CONTACT THE CONTRACTOR IN CASE OF AN AERONAUTIC EMERGENCY THAT WOULD REQUIRE ACTION BY THE CONTRACTOR AND/OR HIS PERSONNEL.

HAUL ROUTE AND VEHICLE PARKING

THE CONTRACTOR WILL USE THE DESIGNATED HAUL ROUTE AND PARKING AREA AS SHOWN ON THIS SHEET. THE CONTRACTOR WILL BE REQUIRED TO MAINTAIN THE PROPOSED HAUL ROUTE AND PARKING AREA THROUGHOUT THE COURSE OF THE PROJECT. ANY AREAS DAMAGED OUTSIDE OF THESE AREAS WILL BE REPAIRED BY THE CONTRACTOR AND AT THE CONTRACTOR'S OWN EXPENSE. AT THE CONCLUSION OF THE PROJECT THE CONTRACTOR WILL GRADE, FERTILIZE, SEED AND MULCH THE HAUL ROUTE AND PARKING AREA AS NEEDED TO RESTORE IT TO ITS ORIGINAL STATE. RESTORATION OF THE HAUL ROUTE AND PARKING AREA WILL BE CONSIDERED INCIDENTAL TO THE PROJECT AND NO ADDITIONAL COMPENSATION WILL BE ALLOWED.

CONTRACTOR RESPONSIBILITIES

THE CONTRACTOR'S EQUIPMENT PARKING AND STORAGE AREA WILL BE AS SHOWN ON THIS SHEET. THE CONTRACTOR'S EMPLOYEES WILL PARK THEIR VEHICLES IN THIS AREA. ONLY CONTRACTOR VEHICLES WILL BE ALLOWED OUTSIDE THIS AREA.

ALL WORK PERFORMED SHALL BE DONE IN AN ORDERLY AND EFFECTIVE MANNER TO MINIMIZE RUNWAY CLOSURE AND INTERRUPTIONS TO THE REFUELING AREA ON THE APRON.

BARRICADES AND TRAFFIC CONES

IT WILL BE THE CONTRACTOR'S RESPONSIBILITY TO PLACE AND MAINTAIN BARRICADES AND TRAFFIC CONES AS DIRECTED BY THE AIRPORT MANAGER. THE BARRICADES WILL BE EQUIPPED WITH RED FLASHING OR RED STEADY-BURN LIGHTS AND 20" SQUARE ORANGE FLAGS. THE BARRICADES, THEIR MAINTENANCE, PLACEMENT AND REMOVAL WILL BE CONSIDERED AS AN INCIDENTAL ITEM TO THE CONTRACT AND NO ADDITIONAL COMPENSATION WILL BE ALLOWED.

LEGEND

- EXISTING IMPROVEMENTS
- PROPOSED IMPROVEMENTS
- EXISTING BUILDINGS
- PROPOSED HAUL ROUTE AND EQUIPMENT PARKING AREA
- PROPOSED CONTROL POINT
- PROPOSED BARRICADES OR TRAFFIC CONES

AIRCRAFT OPERATION LINE

THE CONTRACTOR WILL LOCATE THIS LINE AT THE START OF CONSTRUCTION AND WILL PLACE FRANGIBLE MARKER EVERY 150' ALONG IT. THIS LINE WILL BE THE LIMITS THAT ALL CONTRACTOR PERSONNEL MAY VENTURE WHEN A RUNWAY IS NOT CLOSED. THE CONTRACTOR WILL MAINTAIN THE LINE FOR EACH RUNWAY FOR THE DURATION OF THE PROJECT.

EROSION CONTROL

THIS PROJECT WILL DISTURB MORE THAN 1 ACRE OF LAND, THEREFORE A N.P.D.E.S. PERMIT WILL BE REQUIRED.

HEIGHT OF CONSTRUCTION EQUIPMENT

THE MAXIMUM ANTICIPATED HEIGHT OF THE CONSTRUCTION EQUIPMENT WILL BE 20 FEET. THE TALLEST EQUIPMENT IS EXPECTED TO BE A DUMP TRUCK.

HORIZONTAL AND VERTICAL CONTROL DATA

NO.	DESCRIPTION	NORTHING	EASTING	ELEV.
1.	NGS BRASS MONUMENT "G142 1947" NAVD 88. LOCATED ON THE N.E. FACE OF THE AIRPORT TERMINAL.	***	***	583.15
2.	NGS BRASS MONUMENT "JOLIPOINT" NAD83 (2007) IL. E. ZONE.	1,767,814.89	1,026,441.63	579.87
3.	NGS BRASS MONUMENT "JOLIPOINT AZ MK" NAD83 (2007), IL. E. ZONE.	1,766,728.01	1,027,868.33	581.29

CERTIFIED PAYROLLS

THE RESIDENT ENGINEER CANNOT FORWARD CONSTRUCTION REPORTS TO THE ILLINOIS DIVISION OF AERONAUTICS FOR PROCESSING UNTIL ALL CERTIFIED PAYROLLS FOR THE PERIOD HAVE BEEN RECEIVED.

MATERIAL CERTIFICATION

COMPLETED WORK CANNOT BE PLACED ON A CONSTRUCTION REPORT UNTIL ALL MATERIAL CERTIFICATIONS FOR THAT PAY ITEM HAVE BEEN RECEIVED, REVIEWED AND ACCEPTED BY THE RESIDENT ENGINEER.

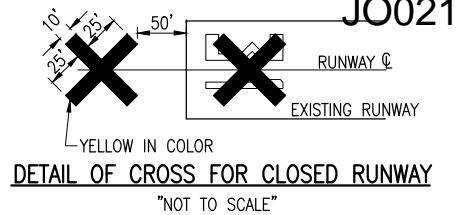

NOTE:

COST OF CONSTRUCTING, PLACING, MAINTAINING AND REMOVING CROSSES WILL BE CONSIDERED INCIDENTAL TO THE CONTRACT AND NO ADDITIONAL COMPENSATION WILL BE ALLOWED. THE CROSSES WILL BE YELLOW IN COLOR AND SHALL BE MADE OF A SUITABLE MATERIAL AS APPROVED BY THE AIRPORT MANAGER. THE CROSSES WILL BE PLACED OVER THE NUMERALS AND SECURED IN A MANNER APPROVED BY THE MANAGER. THE PROPOSED CROSSES WILL BE PLACED EACH DAY THE RUNWAY IS CLOSED AND REMOVED WHEN THE RUNWAY IS RE-OPENED. THE CONTRACTOR WILL BE RESPONSIBLE FOR THE PLACEMENT AND REMOVAL OF THE CROSSES. NO ADDITIONAL COMPENSATION WILL BE ALLOWED.

J.U.L.I.E. INFORMATION

COUNTY: WILL
 CITY: JOLIET
 TOWNSHIP: TROY
 SECTION NO.: 14 & 15
 ADDRESS: JOLIET REGIONAL AIRPORT
 3000 WEST JEFFERSON STREET
 JOLIET, ILLINOIS 60435

CRITICAL POINT DATA

LATITUDE: 41° 31' 04.21"
 LONGITUDE: 88° 10' 33.36"
 ELEVATION: 579.86 M.S.L.

UTILITY NOTE

THE LOCATION, SIZE, AND TYPE OF MATERIAL OF EXISTING UNDERGROUND AND/OR ABOVEGROUND UTILITIES INDICATED ON THE PLANS ARE NOT REPRESENTED AS BEING ACCURATE, SUFFICIENT OR COMPLETE. NEITHER THE OWNER NOR THE ENGINEER ASSUMES ANY RESPONSIBILITY WHATEVER IN RESPECT TO THE ACCURACY, COMPLETENESS, OR SUFFICIENCY OF THE INFORMATION. THERE IS NO GUARANTEE, EITHER EXPRESSED OR IMPLIED, THAT THE LOCATIONS, SIZE AND TYPE OF MATERIAL OF EXISTING UNDERGROUND UTILITIES INDICATED ARE REPRESENTATIVE OF THOSE TO BE ENCOUNTERED IN THE CONSTRUCTION. IT SHALL BE THE CONTRACTOR'S RESPONSIBILITY TO DETERMINE THE ACTUAL LOCATION OF ALL SUCH FACILITIES, INCLUDING SERVICE CONNECTIONS TO UNDERGROUND UTILITIES. PRIOR TO CONSTRUCTION, THE CONTRACTOR SHALL NOTIFY THE UTILITY COMPANIES OF HIS OPERATIONAL PLANS AND SHALL OBTAIN FROM THE RESPECTIVE UTILITY COMPANIES DETAILED INFORMATION AND ASSISTANCE RELATIVE TO THE LOCATION OF THEIR FACILITIES AND THE WORKING SCHEDULE OF THE COMPANIES FOR REMOVAL OR ADJUSTMENT WHERE REQUIRED. IN THE EVENT AN UNEXPECTED UTILITY INTERFERENCE IS ENCOUNTERED DURING CONSTRUCTION, THE CONTRACTOR SHALL IMMEDIATELY NOTIFY THE UTILITY COMPANY OF JURISDICTION. THE OWNER'S REPRESENTATIVE AND/OR THE RESIDENT ENGINEER SHALL ALSO BE IMMEDIATELY NOTIFIED. ANY DAMAGE TO SUCH MAINS AND SERVICES SHALL BE RESTORED TO SERVICE AT ONCE AND PAID FOR BY THE CONTRACTOR AT NO ADDITIONAL COST TO THE CONTRACT. ALL UTILITY CABLES AND LINES SHALL BE LOCATED BY THE RESPECTIVE UTILITY. CONTACT JULIE (JOINT UTILITY LOCATION INFORMATION FOR EXCAVATORS) FOR UTILITY INFORMATION, PHONE: 1-800-892-0123. CONTACT THE FAA (FEDERAL AVIATION ADMINISTRATION) FOR ASSISTANCE IN LOCATING FAA CABLES AND UTILITIES. LOCATION OF FAA POWER, CONTROL, AND COMMUNICATION CABLES SHALL BE COORDINATED WITH AND/OR LOCATED BY THE FAA. ALSO CONTACT AIRPORT DIRECTOR/MANAGER AND AIRPORT PERSONNEL FOR ASSISTANCE IN LOCATING UNDERGROUND AIRPORT CABLES AND/OR UTILITIES. ALSO COORDINATE WORK WITH ALL ABOVEGROUND UTILITIES.

150-ENGINEER'S FIELD OFFICE NOTES

THE PROPOSED ENGINEER'S FIELD OFFICE WILL BE FURNISHED, MAINTAINED, AND REMOVED IN ACCORDANCE WITH ITEM AR150510 "ENGINEER'S FIELD OFFICE" AS STATED ON PAGE 49 OF THE ILLINOIS STANDARD SPECIFICATIONS FO CONSTRUCTION OF AIRPORTS, ADOPTED NOVEMBER 2, 2009.

THE LOCATION OF THE PROPOSED ENGINEER'S FIELD OFFICE WILL BE DETERMINED AT THE PRE-CONSTRUCTION MEETING.

THE ENGINEERING FIRM WILL MAKE PAYMENT FOR ALL LONG DISTANCE TELEPHONE CALLS IN EXCESS OF ONE HUNDRED DOLLARS (\$100.00) PER MONTH.

ADDITIONALLY, THE CONTRACTOR WILL FURNISH A CELL PHONE TO THE RESIDENT ENGINEER FOR HIS EXCLUSIVE USE FOR THE DURATION OF THIS PROJECT. THE RESIDENT ENGINEER WILL USE THIS PHONE FOR PROJECT BUSINESS ONLY. THE CONTRACTOR WILL BE RESPONSIBLE FOR ALL CHARGES ASSOCIATED WITH THIS CELL PHONE.

THE PROPOSED ENGINEER'S FIELD OFFICE WILL BE PAID FOR UNDER ITEMS: AR150510 ENGINEER'S FIELD OFFICE ____ 1 L.S.

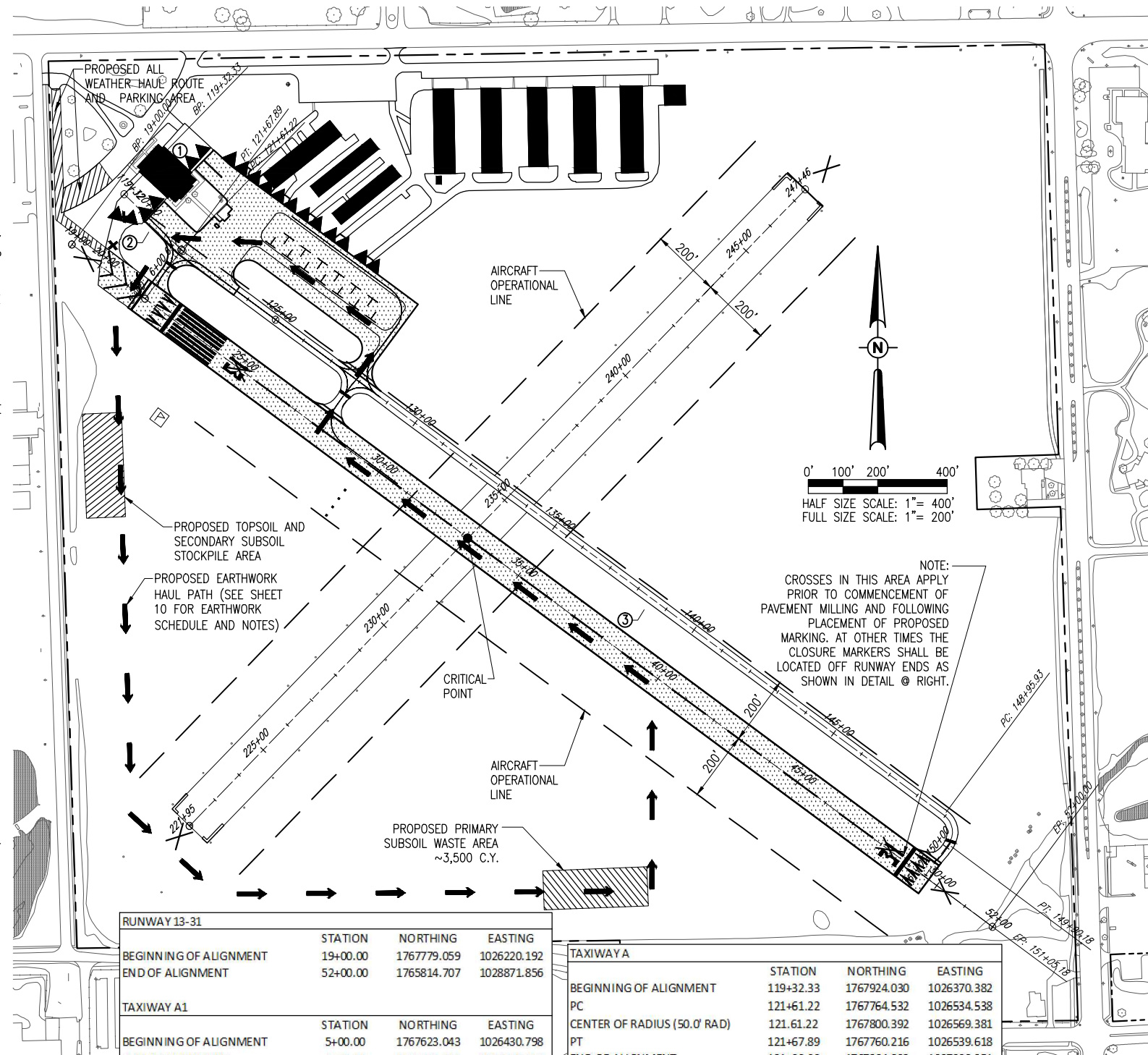

RUNWAY 13-31			
	STATION	NORTHING	EASTING
BEGINNING OF ALIGNMENT	19+00.00	1767779.059	1026220.192
END OF ALIGNMENT	52+00.00	1765814.707	1028871.856

TAXIWAY A			
	STATION	NORTHING	EASTING
BEGINNING OF ALIGNMENT	119+32.33	1767924.030	1026370.382
PC	121+61.22	1767764.532	1026534.538
CENTER OF RADIUS (50.0' RAD)	121.61.22	1767800.392	1026569.381
PT	121+67.89	1767760.216	1026539.618
END OF ALIGNMENT	131+00.00	1767264.893	1027208.251

**JOLIET REGIONAL AIRPORT
 JOLIET PARK DISTRICT
 JOLIET, ILLINOIS**

A.I.P. PROJ.: 3-17-0056-B6
 I.L. PROJ.: JOT-4043

Hanson Project No. 09A0152D_0001	Date: 5/14/12	LAYOUT: KES 04/19/12
File Name: R-003SEF.DWG	Scale: 1" = 200'	DRAWN: BAK 04/19/12
		REVIEWED: RAW 4/20/12

Hanson Professional Services Inc.
 1526 South Sixth Street
 Springfield, IL 62762-2886
 Offices Nationwide

REHAB RUNWAY 13-31, REPLACE APRON, CONSTRUCT TAXIWAY A1

PROJECT CONTROL, ALIGNMENT & SAFETY PLAN

3

3 of 44 sheets