

SUMMARY OF QUANTITIES					CONSTRUCTION CODE
CODE NO.	ITEM	UNIT	TOTAL QUANTITY	SAFETY 0021	
20200100	EARTH EXCAVATION	CU YD	160	160	
20400800	FURNISHED EXCAVATION	CU YD	50	50	
21101600	TOPSOIL FURNISH AND PLACE, VARIABLE DEPTH	SQ YD	1,685	1,685	
25000100	SEEDING, CLASS 1	ACRE	0.50	0.50	
25000110	SEEDING, CLASS 1A	ACRE	0.10	0.10	
25000400	NITROGEN FERTILIZER NUTRIENT	POUND	60	60	
25000600	POTASSIUM FERTILIZER NUTRIENT	POUND	60	60	
25100127	MULCH, METHOD 3A	ACRE	0.55	0.55	
28000400	PERIMETER EROSION BARRIER	FOOT	600	600	
35101600	AGGREGATE BASE COURSE, TYPE B 4"	SQ YD	800	800	
* 40603335	HOT-MIX ASPHALT SURFACE COURSE, MIX "D", N50	TON	75.0	75.0	
* 40800050	INCIDENTAL HOT-MIX ASPHALT SURFACING	TON	10.0	10.0	
42400300	PORTLAND CEMENT CONCRETE SIDEWALK 6 INCH	SQ FT	6,832	6,832	
42400800	DETECTABLE WARNINGS	SQ FT	60	60	
* 44000157	HOT-MIX ASPHALT SURFACE REMOVAL, 2"	SQ YD	335	335	
44000500	COMBINATION CURB AND GUTTER REMOVAL	FOOT	115	115	
44000600	SIDEWALK REMOVAL	SQ FT	4,380	4,380	
50800205	REINFORCEMENT BARS, EPOXY COATED	POUND	500	500	
60603800	COMBINATION CONCRETE CURB AND GUTTER, TYPE B-6.12	FOOT	115	115	
67100100	MOBILIZATION	LSUM	1	1	
70102620	TRAFFIC CONTROL AND PROTECTION, STANDARD 701501	LSUM	1	1	
70102635	TRAFFIC CONTROL AND PROTECTION, STANDARD 701701	LSUM	1	1	
70102640	TRAFFIC CONTROL AND PROTECTION, STANDARD 701801	LSUM	1	1	
* 72000100	SIGN PANEL - TYPE 1	SQ FT	60	60	
* 72400100	REMOVE SIGN PANEL ASSEMBLY - TYPE A	EACH	4	4	
* 72800100	TELESCOPING STEEL SIGN SUPPORT	FOOT	30	30	
* 78000100	THERMOPLASTIC PAVEMENT MARKING - LETTERS AND SYMBOL	SQ FT	24	24	
* 78000200	THERMOPLASTIC PAVEMENT MARKING - LINE 4"	FOOT	117	117	
* 78000600	THERMOPLASTIC PAVEMENT MARKING - LINE 12"	FOOT	240	240	
* 78000850	THERMOPLASTIC PAVEMENT MARKING - LINE 24"	FOOT	75	75	
SP	X0326899	SOLAR POWERED FLASHING BECON ASSEMBLY (COMPLETE)	EACH	2	2
	X0327979	PAVEMENT MARKING REMOVAL - GRINDING	SQ FT	165	165
SP	* XX008728	SOLAR POWERED LED FLASHING WARNING SIGN	EACH	2	2

SP - SPECIAL PROVISION * SPECIALTY ITEM

STATION	DISTANCE	EARTH EXCAVATION END AREAS (SQ FT)		EARTH EXCAVATION AVERAGE END AREA (SQ FT)		EARTH EXCAVATION SECTION VOLUMES (CU YD)		EARTH EXCAVATION CUMULATIVE VOLUMES (CU YD)		CUMULATIVE EARTHWORK BALANCE WASTE (+) OR SHORTAGE (-)
		CUT	FILL	CUT	FILL	CUT	FILL	CUT	FILL	
DEERPATH SW										
1+00.00		4.80	0.00							
1+25.00	25.00	9.60	0.00	7.20	0.00	6.67	0.00	6.67	0.00	6.67
1+50.00	25.00	5.10	0.70	7.35	0.35	6.81	0.32	13.47	0.32	13.15
1+75.00	25.00	5.30	1.80	5.20	1.25	4.81	1.16	18.29	1.48	16.81
2+00.00	25.00	2.10	14.00	3.70	7.90	3.43	7.31	21.71	8.80	12.92
2+25.00	25.00	2.10	15.40	2.10	14.70	1.94	13.61	23.66	22.41	1.25
2+50.00	25.00	2.70	8.00	2.40	11.70	2.22	10.83	25.88	33.24	-7.36
2+75.00	25.00	6.00	1.10	4.35	4.55	4.03	4.21	29.91	37.45	-7.55
3+00.00	25.00	6.00	1.00	6.00	1.05	5.56	0.97	35.46	38.43	-2.96
3+25.00	25.00	6.10	0.90	6.05	0.95	5.60	0.88	41.06	39.31	1.76
3+50.00	25.00	6.50	0.60	6.30	0.75	5.83	0.69	46.90	40.00	6.90
3+75.00	25.00	6.10	0.80	6.30	0.70	5.83	0.65	52.73	40.65	12.08
4+00.00	25.00	5.90	0.70	6.00	0.75	5.56	0.69	58.29	41.34	16.94
4+25.00	25.00	6.90	0.30	6.40	0.50	5.93	0.46	64.21	41.81	22.41
4+50.00	25.00	6.20	0.20	6.55	0.25	6.06	0.23	70.28	42.04	28.24
4+75.00	25.00	7.50	0.10	6.85	0.15	6.34	0.14	76.62	42.18	34.44
5+00.00	25.00	7.00	0.30	7.25	0.20	6.71	0.19	83.33	42.36	40.97
5+25.00	25.00	6.90	0.40	6.95	0.35	6.44	0.32	89.77	42.69	47.08
5+50.00	25.00	6.90	0.40	6.90	0.40	6.39	0.37	96.16	43.06	53.10
5+75.00	25.00	5.90	0.80	6.40	0.60	5.93	0.56	102.08	43.61	58.47
6+00.00	25.00	7.20	0.10	6.55	0.45	6.06	0.42	108.15	44.03	64.12
6+25.00	25.00	7.40	0.10	7.30	0.10	6.76	0.09	114.91	44.12	70.79
6+50.00	25.00	4.90	0.00	6.15	0.05	5.69	0.05	120.60	44.17	76.44
NORTH SW										
10+00.00		3.60	0.00							
10+25.00	25.00	3.10	0.30	3.35	0.15	3.10	0.14	3.10	0.14	2.96
10+50.00	25.00	3.60	1.00	3.35	0.65	3.10	0.60	6.20	0.74	5.46
10+75.00	25.00	3.80	0.80	3.70	0.90	3.43	0.83	9.63	1.57	8.06
11+00.00	25.00	4.90	0.00	4.35	0.40	4.03	0.37	13.66	1.94	11.71
11+25.00	25.00	2.20	0.60	3.55	0.30	3.29	0.28	16.94	2.22	14.72
11+50.00	25.00	5.50	0.20	3.85	0.40	3.56	0.37	20.51	2.59	17.92
11+75.00	25.00	1.90	1.40	3.70	0.80	3.43	0.74	23.94	3.33	20.60
12+00.00	25.00	3.00	0.00	2.45	0.70	2.27	0.65	26.20	3.98	22.22
12+25.00	25.00	2.40	0.00	2.70	0.00	2.50	0.00	28.70	3.98	24.72
12+50.00	25.00	2.60	0.00	2.50	0.00	2.31	0.00	31.02	3.98	27.04
12+75.00	25.00	0.00	0.00	1.30	0.00	1.20	0.00	32.22	3.98	28.24

FILE NAME = 4668-000-PR5.dwg

USER NAME = DANIEL BRINKMAN

DESIGNED -

REVISED - 4/3/18

DRAWN - FCL

REVISED - 5/23/18

CHECKED - EBJ

REVISED -

DATE - 3/5/18

REVISED -

PLOT SCALE = 1" = .0833'

PLOT DATE = 2/28/2018

STATE OF ILLINOIS
DEPARTMENT OF TRANSPORTATION

SUMMARY OF QUANTITIES

SCALE N.T.S. SHEET NO. 3 OF 21 SHEETS STA. TO STA.

FA RTE	SECTION	COUNTY	TOTAL SHEETS	SHEET NO.
-	11-00076-00-SW	LAKE	21	3
CONTRACT #			61E81	
ILLINOIS FED. AID PROJECT				

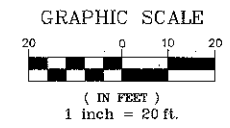
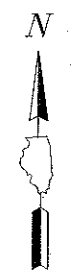



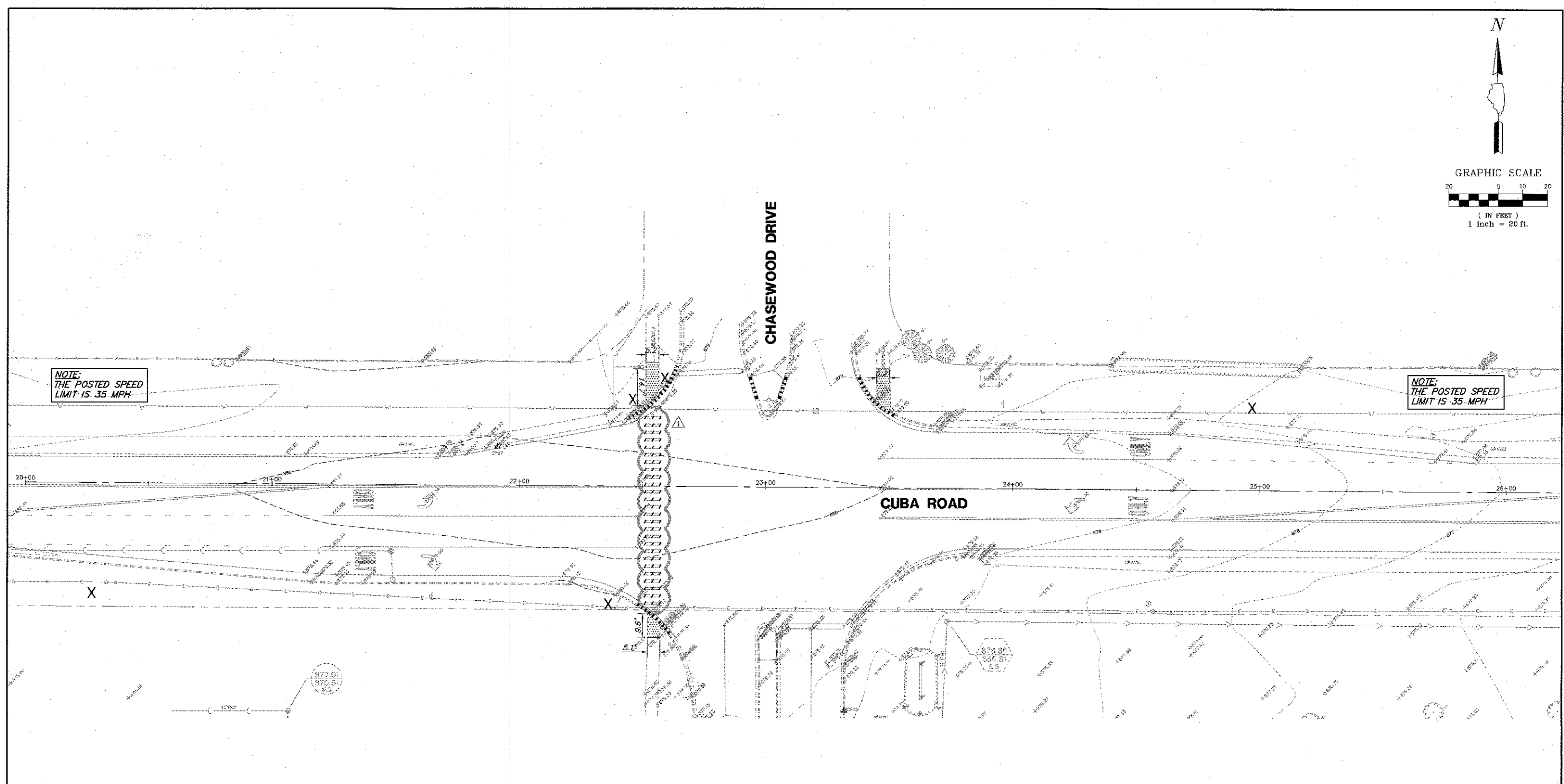

NOTE:
THE POSTED SPEED
LIMIT IS 35 MPH

NOTE:
THE POSTED SPEED
LIMIT IS 35 MPH



REMOVAL LEGEND

-  SIDEWALK REMOVAL
-  SIGN REMOVAL
-  COMBINATION CURB AND GUTTER REMOVAL
-  PAVEMENT SAWCUT
-  PAVEMENT MARKING REMOVAL - GRINDING

FILE NAME = 466B-000-PR5.dwg	USER NAME = PAUL SWIATEK	DESIGNED -	REVISED - 5/23/18
		DRAWN - PCL	REVISED -
		CHECKED - BJW	REVISED -
		DATE - 3/5/18	REVISED -

**STATE OF ILLINOIS
DEPARTMENT OF TRANSPORTATION**

**CUBA ROAD PEDESTRIAN CROSSING
DEMOLITION PLAN**

SCALE 1" = 20' SHEET NO. 8 OF 21 SHEETS STA. 20+00 TO STA. 25+22.92

FA. RTE.	SECTION	COUNTY	TOTAL SHEETS	SHEET NO.
-	11-00076-00-SW	LAKE	21	8
				CONTRACT # 61E81
ILLINOIS FED. AID PROJECT				

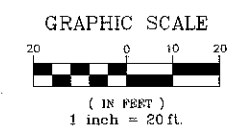
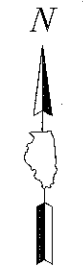

PEDESTRIANS TO CROSS WAIT FOR ADEQUATE GAPS IN TRAFFIC

SPECIAL 2 REQUIRED

PUSH BUTTON TO TURN ON WARNING LIGHTS

R10-25 2 REQUIRED (9"x12")

NOTE: THE POSTED SPEED LIMIT IS 35 MPH

NOTE: THE POSTED SPEED LIMIT IS 35 MPH

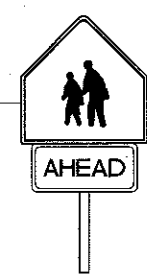
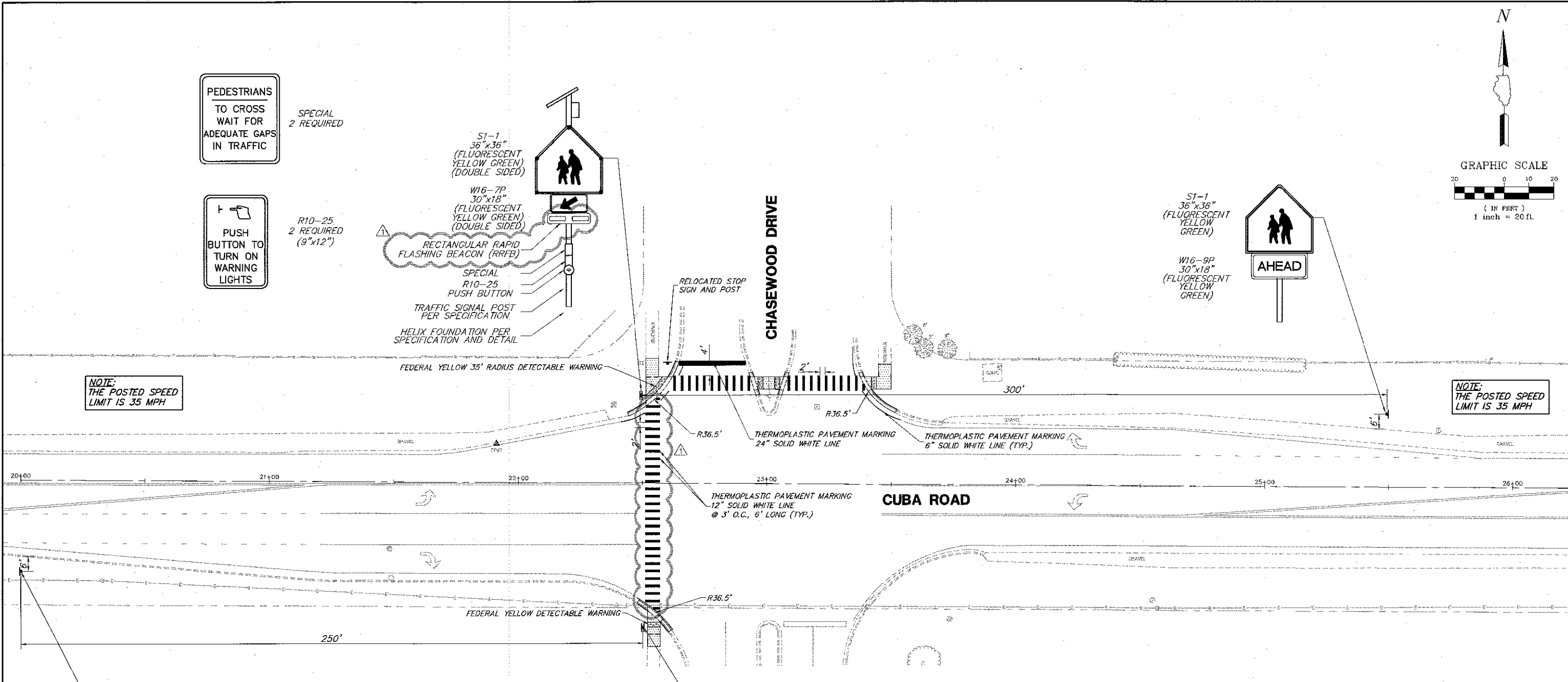

S1-1 36"x36" (FLUORESCENT YELLOW GREEN)

W16-9P 30"x18" (FLUORESCENT YELLOW GREEN)

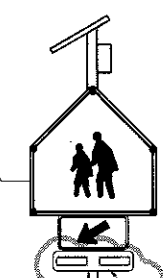

S1-1 36"x36" (FLUORESCENT YELLOW GREEN)

W16-7P 30"x18" (FLUORESCENT YELLOW GREEN)

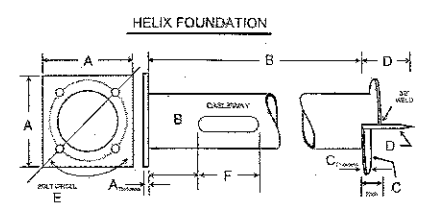

SLSF-10-S
 A BASEPLATE: 14" x 14" x 1" Thick With 2 Notches to Indicate Cableways
 B BODY: 10-3/4" OD Sch 20 250 Wall 8 Ft Long
 C HELIX PLATE: 3/8" x 15" OD with 3" Pitch
 D PILOT POINT: 1-1/4" OD x 9" Long
 E BOLT CIRCLE DESIGN: Bolt Circle 15" Four 1-1/8" Diameter Holes
 F CABLEWAY: 2-1/2" x 27" Starting 16" from top plate - Double Slided
 CONNECTING HARDWARE: 1 set of 4 each 1" x 4" Hex Bolts with LWFVWAW
 HELIX IS HOT DIP GALVANIZED PER ASTM A-123 & AASHTO M-111

PROPOSED LEGEND

- PCC SIDEWALK 6 INCH
- DETECTABLE WARNINGS
- B6.12 CURB & GUTTER (REGULAR)
- B6.12 CURB & GUTTER (DEPRESSED)

Component Products, Inc.

FILE NAME = 4668-000-PR5.dwg	USER NAME = PAUL SWATEK	DESIGNED -	REVISED - 4/3/18	STATE OF ILLINOIS DEPARTMENT OF TRANSPORTATION	CUBA ROAD PEDESTRIAN CROSSING GEOMETRIC PLAN			FA	SECTION	COUNTY	TOTAL	SHEET	
		DRAWN - PCL	REVISED - 5/23/18										
		CHECKED - BJW	REVISED -										
		DATE - 3/5/18	REVISED -		SCALE 1" = 20'	SHEET NO. 9 OF 21 SHEETS	STA. 20+00 TO STA. 25+22.92						
								CONTRACT # 61E81		ILLINOIS FED. AID PROJECT			