

F.A. RTE.	SECTION	COUNTY	TOTAL SHEETS	SHEET NO.
314	110-1VBR-1	MADISON	77	23
STA. TO STA.		FED. ROAD DIST. NO. ILLINOIS FED. AID PROJECT		

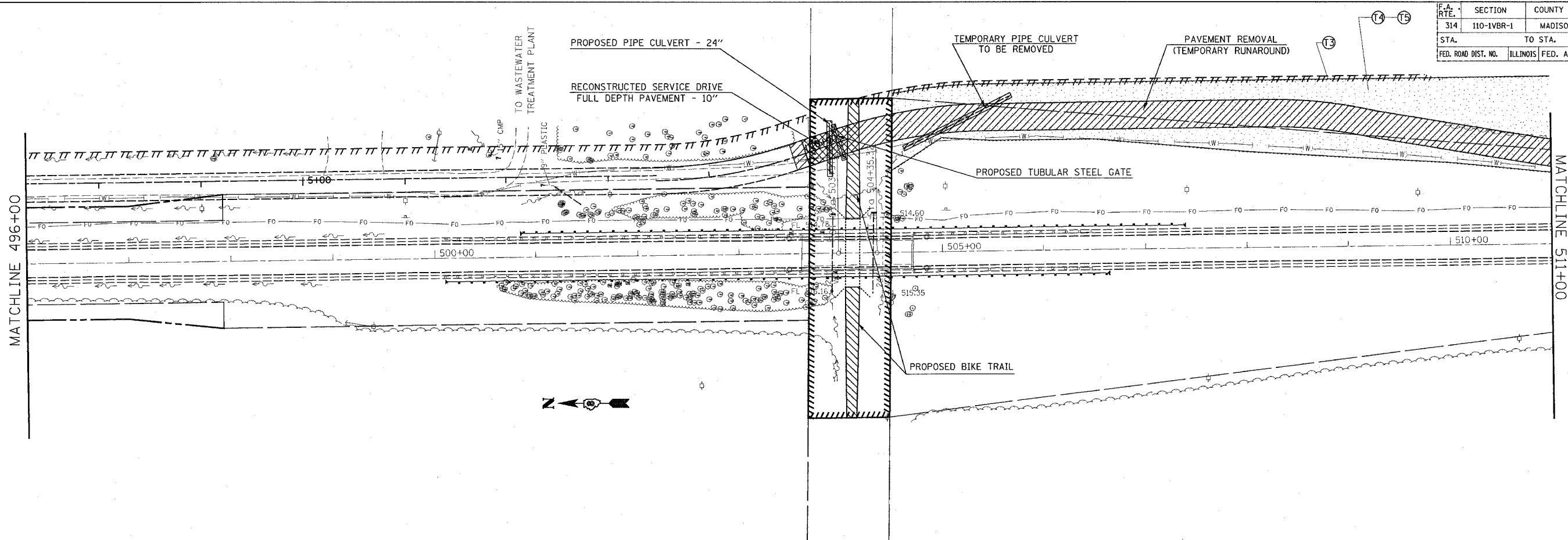

SUGGESTED STAGE CONSTRUCTION

STAGE 3:

1. STAGE 3 CONSTRUCTION SHALL CONSIST OF REMOVING THE TEMPORARY RUNAROUND TO THE LIMITS SHOWN IN THE PLANS, RECONSTRUCTING THE PROPOSED SERVICE DRIVE ENTRANCE, CONSTRUCTING THE BIKE TRAIL, REMOVAL OF TEMPORARY CULVERTS AND TEMPORARY CULVERT EXTENSIONS, REMOVAL OF THE TEMPORARY GUARDRAIL, MILLING AND RESURFACING OF THE MAINLINE PAVEMENT TO REESTABLISH CROSS SLOPES, INSTALLING THE TUBULAR STEEL GATE ON THE SERVICE DRIVE AS SHOWN IN THE PLANS, AND FINAL GRADING AND EARTHWORK.
2. THE PROPOSED BIKE TRAIL SHALL CONSIST OF 2" BITUMINOUS CONCRETE SURFACE COURSE, AND 4" AGGREGATE BASE COURSE. THE PROPOSED SERVICE DRIVE ENTRANCE SHALL CONSIST OF 1 3/4" SURFACE COURSE AND 8 1/4" BINDER COURSE.
3. TRAFFIC CONTROL FOR THIS WORK SHALL BE IN ACCORDANCE WITH THE APPLICABLE PORTIONS OF STANDARDS 701001, 701006, 701306, 701331.

NOTES:

1. THE CONTRACTOR SHALL MAINTAIN TEMPORARY ACCESS TO THE ELECTRIC SUBSTATION AND TO WASTE WATER TREATMENT PLANT LOCATED WITHIN THE LIMITS OF THE PROJECT.
2. TEMPORARY ACCESS SHALL BE MEASURED AND PAID FOR AT THE CONTRACT UNIT PRICE PER TON FOR AGGREGATE SURFACE COURSE TYPE B. WHEN USE OF THE AGGREGATE SURFACE COURSE TYPE B IS DISCONTINUED AS TEMPORARY ACCESS IT SHALL BE UTILIZED IN PERMANENT CONSTRUCTION. THE REUSE AND PLACEMENT SHALL BE AS DETERMINED BY THE ENGINEER.
3. REMOVAL AND REUSE OF TEMPORARY ACCESS MATERIALS SHALL BE CONSIDERED AS INCLUDED IN THE COST OF AGGREGATE SURFACE COURSE, TYPE B.
4. USE STANDARD TRAFFIC CONTROL AND PROTECTION EXCEPT WHERE NOTED.
5. THE PLACEMENT OF THE TUBULAR STEEL GATE WILL BE AS COORDINATED WITH MADISON COUNTY TRANSIT AND THE RESIDENT ENGINEER.

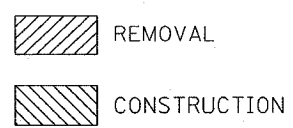

TEMPORARY EROSION CONTROL MEASURES

- ⊕ T1 INLET AND PIPE PROTECTION
- ⊕ T2 TEMPORARY DITCH CHECK
- T3 PERIMETER EROSION BARRIER
- ▭ T4 TEMPORARY SEEDING
- ▭ T5 TEMPORARY MULCH METHOD 1

NOTES:

FOR SCHEDULE AND QUANTITIES OF PERMANENT EROSION CONTROL PAY ITEMS SEE ROADWAY PLANS.
SEE STANDARD 280001 FOR TEMPORARY EROSION CONTROL SYSTEM DETAILS.

REVISIONS	
NAME	DATE

ILLINOIS DEPARTMENT OF TRANSPORTATION
STAGE III CONSTRUCTION & REMOVAL
 FAP ROUTE 314
 SECTION 110-1VBR-1
 MADISON COUNTY

SCALE: VERT. _____
 HORIZ. _____
 DATE _____

DRAWN BY _____
 CHECKED BY _____

PLT DATE = #DATE#
 FILE NAME = #FILE#
 PLOT SCALE = #SCALE#
 REFERENCE = #REF#