

CONTRACT NO.				
F.A. RTE.	SECTION	COUNTY	TOTAL SHEETS	SHEET NO.
314	110-1VBR-1	MADISON	77	26F
STA.		TO STA.		
FED. ROAD DIST. NO.		ILLINOIS	FED. AID PROJECT	

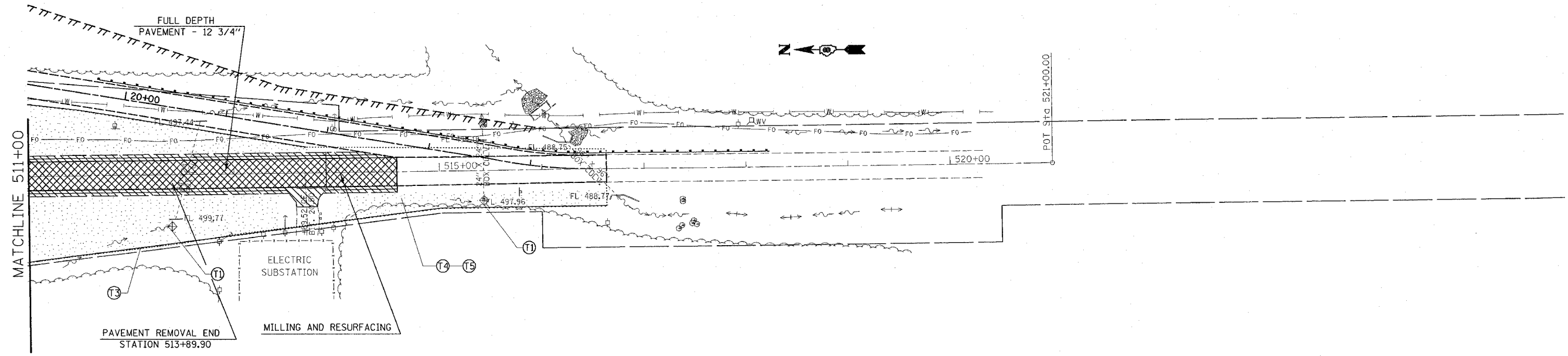

SUGGESTED STAGE CONSTRUCTION

STAGE 2:

1. STAGE 2 CONSTRUCTION SHALL CONSIST OF REMOVING THE EXISTING MAINLINE PAVEMENT TO THE LIMITS DETAILED IN THE PLANS, SURFACE REMOVAL OF EXISTING MAINLINE PAVEMENT TO ESTABLISH CROSS SLOPES FOR THE RUNAROUND, REMOVING THE EXISTING STRUCTURE, REMOVING INLETS AND DRAINS ON THE EXISTING BRIDGE APPROACH PAVEMENT, REMOVAL OF THE EXISTING BRIDGE APPROACH PAVEMENT, REMOVAL AND REPLACEMENT OF CULVERTS, CONSTRUCTING THE NEW PAVEMENT, INSTALLING GUARDRAIL, CONSTRUCTING THE AGGREGATE AND BITUMINOUS SHOULDERS, AND RESURFACING OF THE EXISTING PAVEMENT.
2. TRAFFIC CONTROL FOR THIS WORK SHALL BE IN ACCORDANCE WITH THE APPLICABLE PORTIONS OF STANDARDS 701001, 701006, 701331 AND B.L.R. 22-4.
3. THE PROPOSED MAINLINE PAVEMENT SHALL CONSIST OF 1 3/4" SURFACE COURSE AND A 11' BINDER COURSE.
4. TRAFFIC WILL BE ROUTED TO THE TEMPORARY RUNAROUND DURING STAGE 2 CONSTRUCTION.

NOTES:

1. THE CONTRACTOR SHALL MAINTAIN TEMPORARY ACCESS TO THE ELECTRIC SUBSTATION AND TO WASTE WATER TREATMENT PLANT LOCATED WITHIN THE LIMITS OF THE PROJECT.
2. TEMPORARY ACCESS SHALL BE MEASURED AND PAID FOR AT THE CONTRACT UNIT PRICE PER TON FOR AGGREGATE SURFACE COURSE TYPE B. WHEN USE OF THE AGGREGATE SURFACE COURSE TYPE B IS DISCONTINUED AS TEMPORARY ACCESS IT SHALL BE UTILIZED IN PERMANENT CONSTRUCTION. THE REUSE AND PLACEMENT SHALL BE AS DETERMINED BY THE ENGINEER.
3. REMOVAL AND REUSE OF TEMPORARY ACCESS MATERIALS SHALL BE CONSIDERED AS INCLUDED IN THE COST OF AGGREGATE SURFACE COURSE, TYPE B.
4. USE STANDARD TRAFFIC CONTROL AND PROTECTION EXCEPT WHERE NOTED.

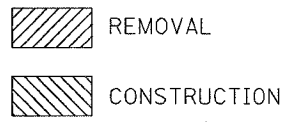

TEMPORARY EROSION CONTROL MEASURES

- ⊕ T1 INLET AND PIPE PROTECTION
- ⊕ T2 TEMPORARY DITCH CHECK
- T3 PERIMETER EROSION BARRIER
- ▭ T4 TEMPORARY SEEDING
- ⊕ T5 TEMPORARY MULCH METHOD 1

NOTES:

FOR SCHEDULE AND QUANTITIES OF PERMANENT EROSION CONTROL  
PAY ITEMS SEE ROADWAY PLANS.  
SEE STANDARD 280001 FOR TEMPORARY EROSION CONTROL SYSTEM DETAILS.

PLOT DATE = #DATE#  
FILE NAME = #FILE#  
SCALE = #SCALE#  
REFERENCE = #REF#

REVISIONS		ILLINOIS DEPARTMENT OF TRANSPORTATION STAGE II EROSION CONTROL FAP ROUTE 314 SECTION 110-1VBR-1 MADISON COUNTY
NAME	DATE	

SCALE: VERT. \_\_\_\_\_  
          HORIZ. \_\_\_\_\_  
DATE \_\_\_\_\_

DRAWN BY \_\_\_\_\_  
CHECKED BY \_\_\_\_\_