

F.A. RTE.	SECTION	COUNTY	TOTAL SHEETS	SHEET NO.
303	D3-00520-00-WR	WINNEBAGO	254	46
STA. 200+00 TO STA. 206+00				
FED. ROAD DIST. NO.	ILLINOIS FED. AID PROJECT			

PLAN	SURVEYED	DATE
	PLOTTED	
	CHECKED	
	BY	
	NO. OF WAY CHECKED	
	CADD FILE NAME	

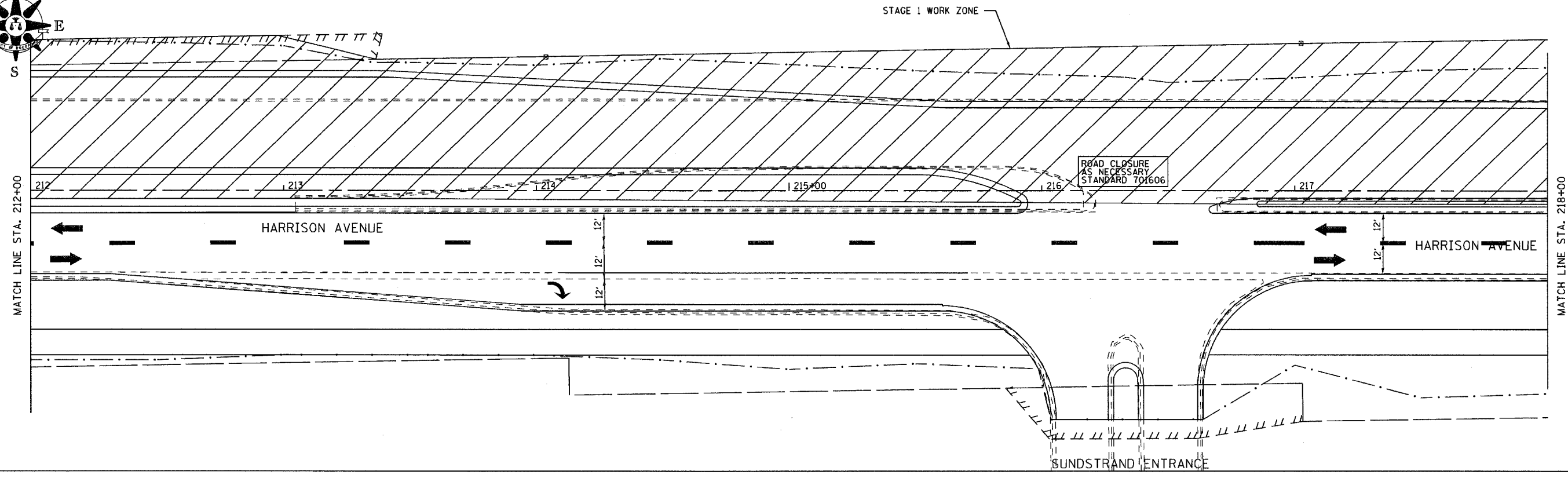

PROFILE	SURVEYED	DATE
	PLOTTED	
	CHECKED	
	BY	
	NO. OF WAY CHECKED	
	STRUCTURE NOTATIONS CORD	

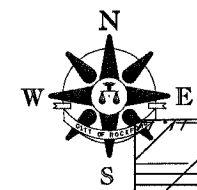
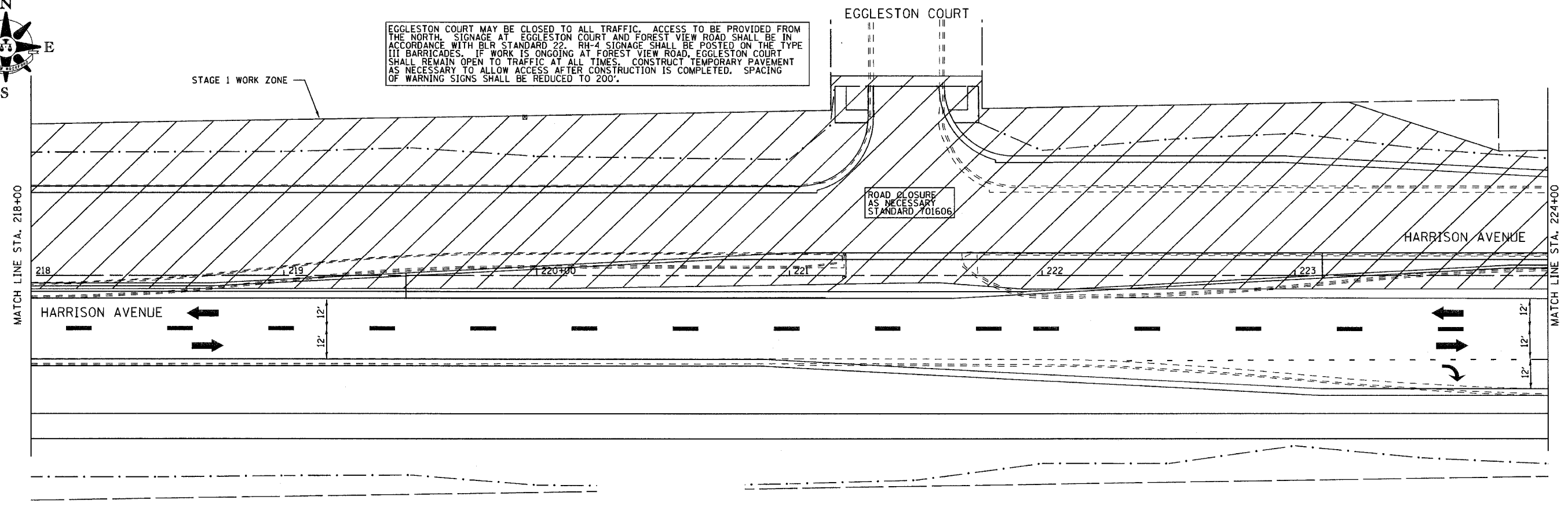
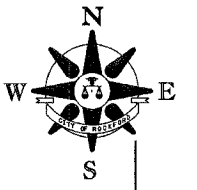

EGGLESTON COURT MAY BE CLOSED TO ALL TRAFFIC. ACCESS TO BE PROVIDED FROM THE NORTH. SIGNAGE AT EGLESTON COURT AND FOREST VIEW ROAD SHALL BE IN ACCORDANCE WITH BLR STANDARD 22. RH-4 SIGNAGE SHALL BE POSTED ON THE TYPE III BARRICADES. IF WORK IS ONGOING AT FOREST VIEW ROAD, EGLESTON COURT SHALL REMAIN OPEN TO TRAFFIC AT ALL TIMES. CONSTRUCT TEMPORARY PAVEMENT AS NECESSARY TO ALLOW ACCESS AFTER CONSTRUCTION IS COMPLETED. SPACING OF WARNING SIGNS SHALL BE REDUCED TO 200'.

STAGE 1 - STAGING PLAN HARRISON AVENUE