

F.A. RTE.	SECTION	COUNTY	TOTAL SHEETS	SHEET NO.
303	D3-00520-00-WR	WINNEBAGO	254	58
STA. 200+00		TO STA. 206+00		
FED. ROAD DIST. NO.	ILLINOIS	FED. AID PROJECT		

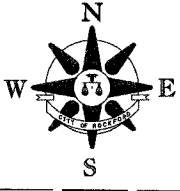

PROVIDE 3-WAY OR 4-WAY STOP CONTROLLED INTERSECTION AT OHIO PARKWAY. SET SIGNALS TO FLASHING RED. PROVIDE TEMPORARY R1-1 STOP SIGNS WITH 2 RED FLAGS.

MERGE EASTBOUND TRAFFIC TO SINGLE LANE AND SHIFT THROUGH CROSSOVER TO WESTBOUND LANES IN ACCORDANCE WITH STANDARD 701602.

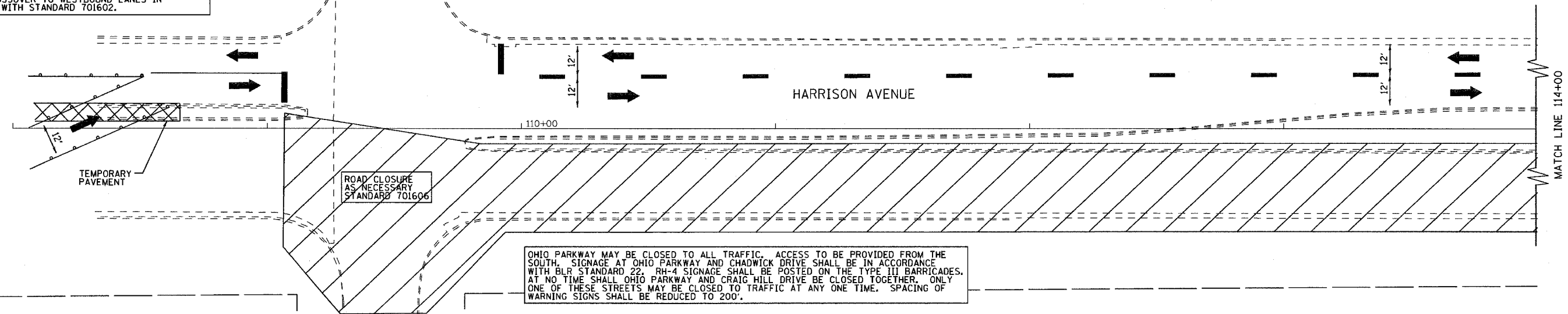

OHIO PARKWAY MAY BE CLOSED TO ALL TRAFFIC. ACCESS TO BE PROVIDED FROM THE SOUTH. SIGNAGE AT OHIO PARKWAY AND CHADWICK DRIVE SHALL BE IN ACCORDANCE WITH BLR STANDARD 22. R1-4 SIGNAGE SHALL BE POSTED ON THE TYPE III BARRICADES. AT NO TIME SHALL OHIO PARKWAY AND CRAIG HILL DRIVE BE CLOSED TOGETHER. ONLY ONE OF THESE STREETS MAY BE CLOSED TO TRAFFIC AT ANY ONE TIME. SPACING OF WARNING SIGNS SHALL BE REDUCED TO 200'.

PLAN

DATE	BY
REVISIONS	
NO.	
DATE	BY
REVISIONS	
NO.	

STRUCTURE NOTATION: DKRD

PROFILE

DATE	BY
REVISIONS	
NO.	
DATE	BY
REVISIONS	
NO.	

STRUCTURE NOTATION: DKRD

