

F.A. RY.	SECTION	COUNTY	TOTAL SHEETS	SHEET NO.
303	D3-00520-00-WR	WINNEBAGO	254	64
STA. 200+00		TO STA. 206+00		
FED. ROAD DIST. NO.		ILLINOIS FED. AID PROJECT		

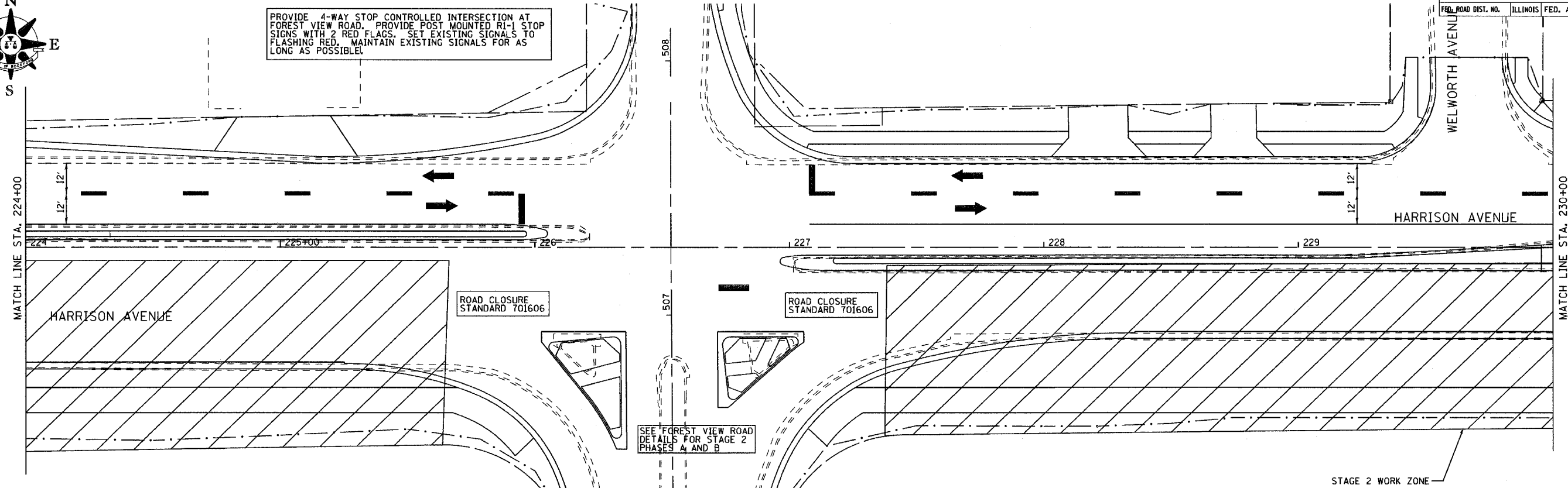

FOREST VIEW ROAD

PROVIDE 4-WAY STOP CONTROLLED INTERSECTION AT FOREST VIEW ROAD. PROVIDE POST MOUNTED R1-1 STOP SIGNS WITH 2 RED FLAGS. SET EXISTING SIGNALS TO FLASHING RED. MAINTAIN EXISTING SIGNALS FOR AS LONG AS POSSIBLE.



PLAN	DATE
BY	
REVISION	
NOTES	
NO.	

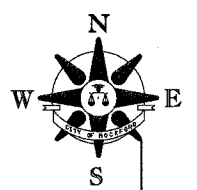

WENTWORTH AVENUE

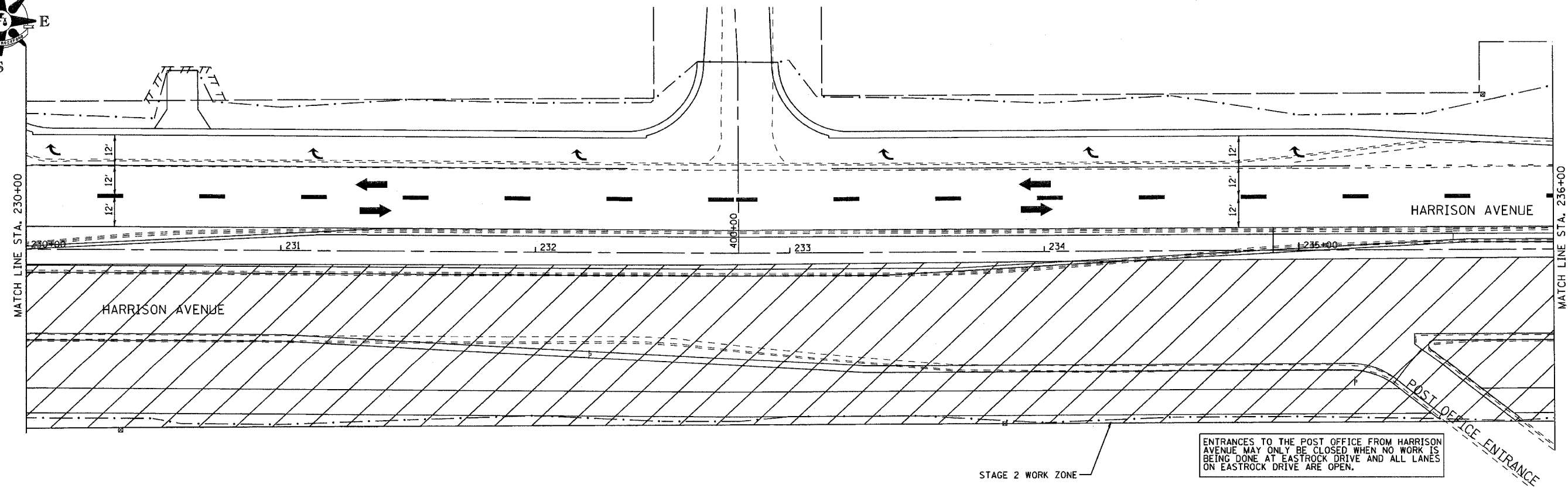

ENTRANCES TO THE POST OFFICE FROM HARRISON AVENUE MAY ONLY BE CLOSED WHEN NO WORK IS BEING DONE AT EASTROCK DRIVE AND ALL LANES ON EASTROCK DRIVE ARE OPEN.

PROFILE	DATE
BY	
REVISION	
NOTES	
NO.	