

F.A. RTE.	SECTION	COUNTY	TOTAL SHEETS	SHEET NO.
303	D3-00520-00-WR	WINNEBAGO	254	91
STA. 224+00		TO STA. 230+00		
FED. ROAD DIST. NO.		ILLINOIS FED. AID PROJECT		



DONALD G. PETERSON  
JOSEPHINE M. PETERSON

FOREST VIEW ROAD  
66' R.O.W.

FRANK SCHMERSE

74.99' LT  
229+53.58

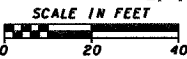
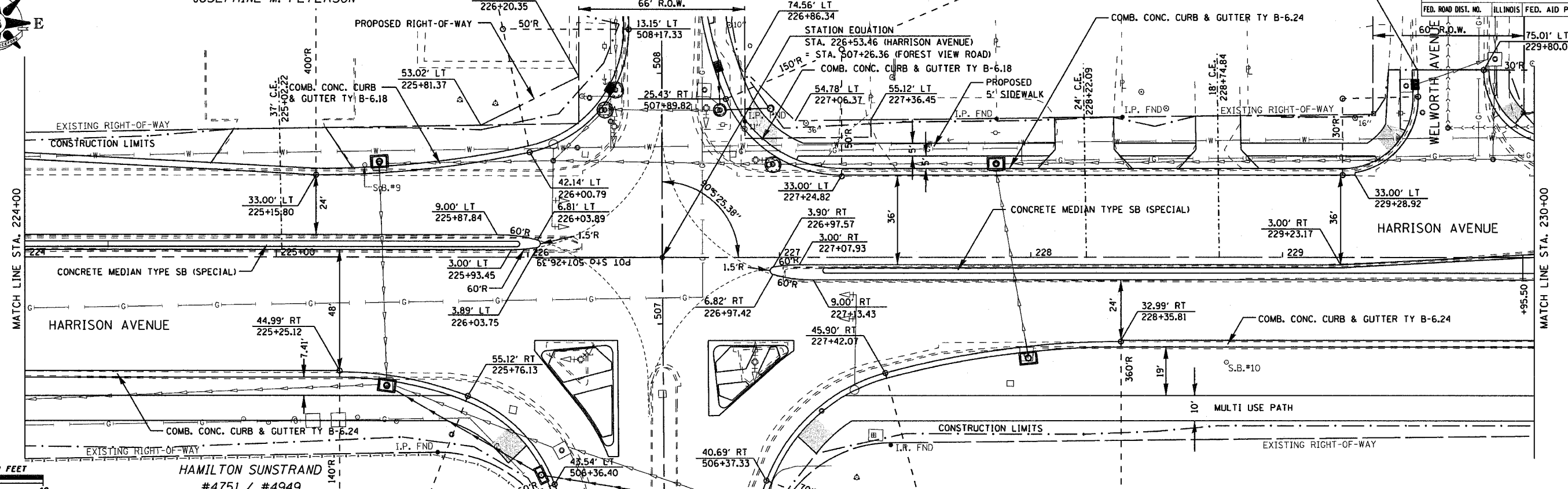

HAMILTON SUNSTRAND  
#4751 / #4949

FOREST VIEW ROAD

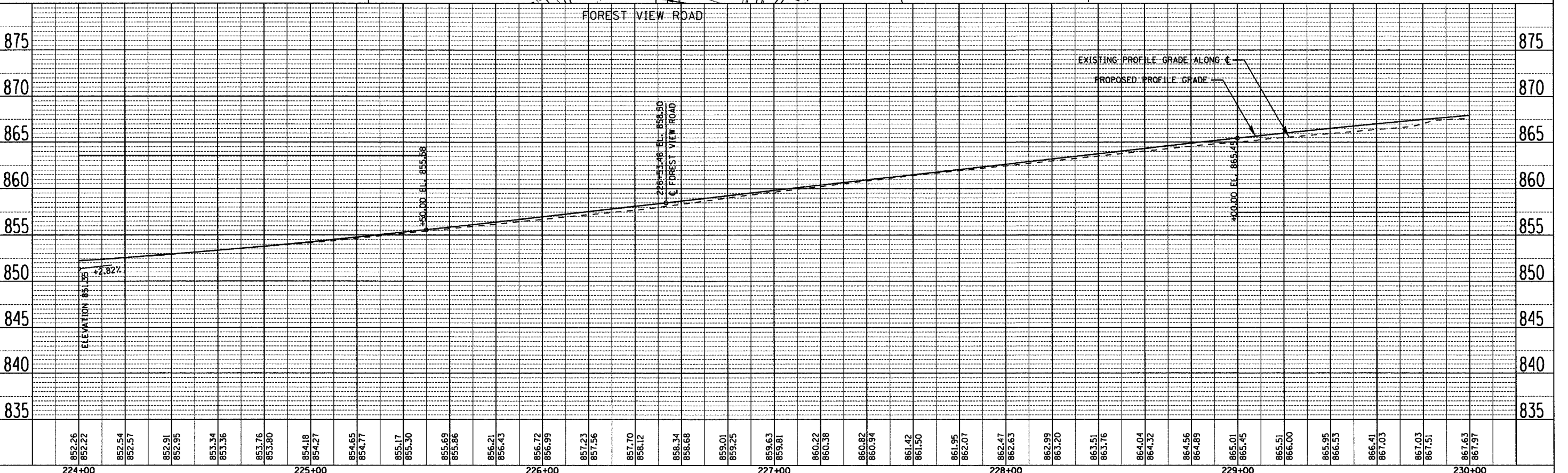

HARRISON AVENUE - STA. 224+00 TO 230+00

DATE: \_\_\_\_\_ BY: \_\_\_\_\_  
 CHECKED: \_\_\_\_\_  
 PLAN: \_\_\_\_\_  
 NOTE BOOK: \_\_\_\_\_  
 NO.: \_\_\_\_\_

DATE: \_\_\_\_\_ BY: \_\_\_\_\_  
 CHECKED: \_\_\_\_\_  
 PROFILE: \_\_\_\_\_  
 NOTE BOOK: \_\_\_\_\_  
 NO.: \_\_\_\_\_