

**LEGEND**

	PROPOSED PAVEMENT
	EXISTING PAVEMENT
	PROPOSED MARKING
	EXISTING MARKING

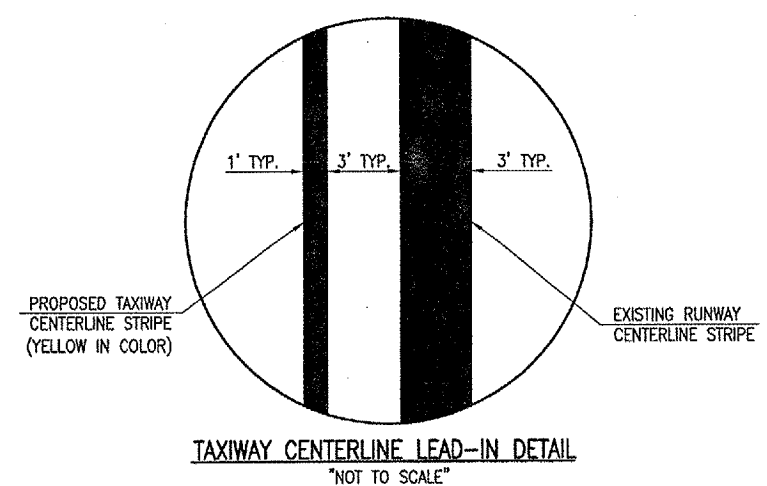
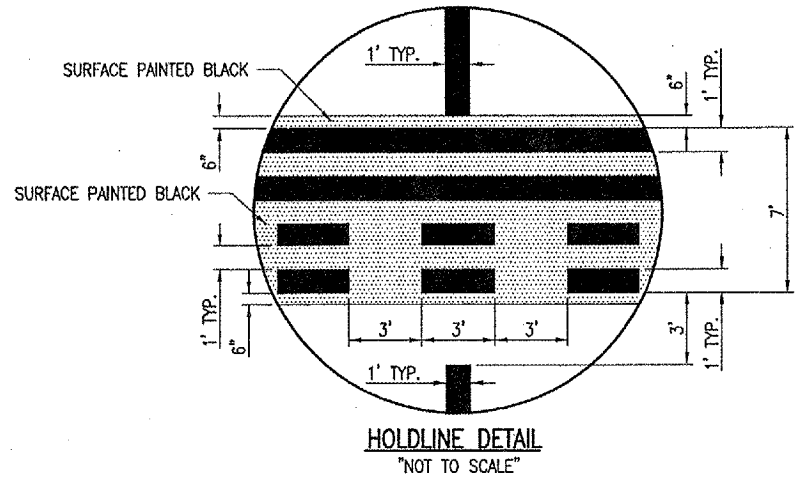
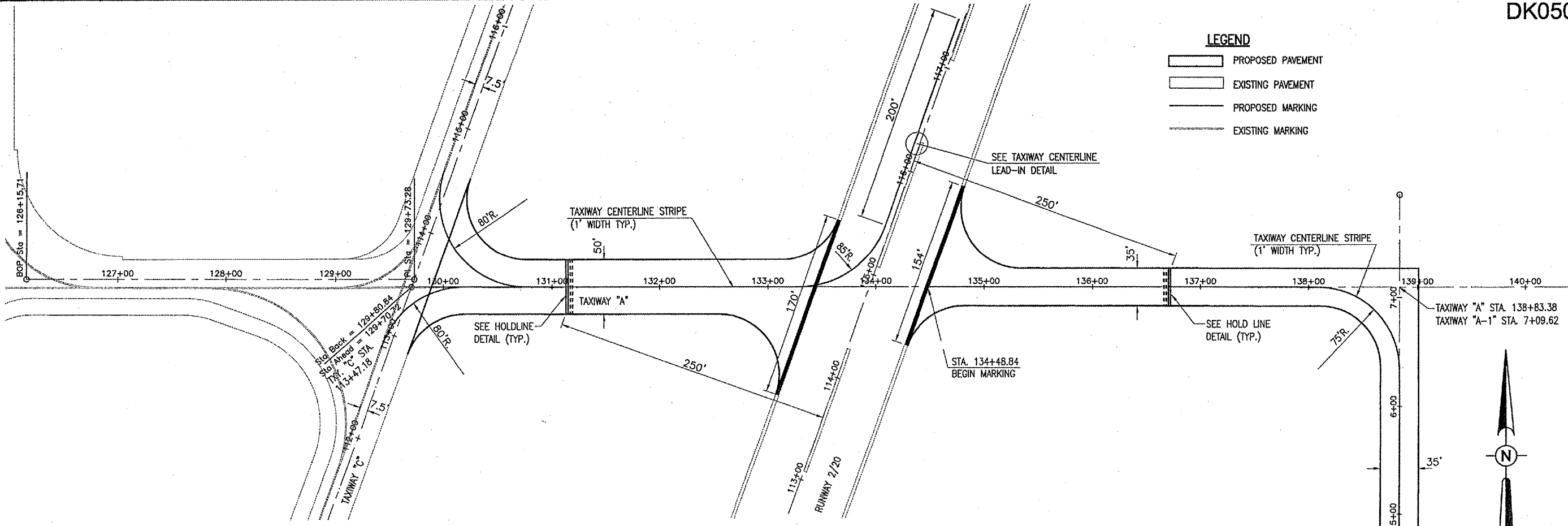

**MARKING QUANTITIES**

DESCRIPTION	UNIT AREA (YELLOW)	UNIT AREA (WHITE)	UNIT AREA (BLACK)
TAXIWAY A CENTERLINE	1,943		
RUNWAY EDGE STRIPES		972	
HOLDLINE (50')	150		250
HOLDLINE (35')	105		175
HOLDLINE REMARK (35')	105		175
<b>TOTAL YELLOW MARKING</b>	<b>2,303</b>		
<b>TOTAL WHITE MARKING</b>		<b>972</b>	
<b>TOTAL BLACK MARKING</b>			<b>600</b>

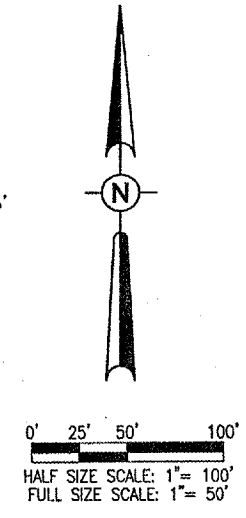

**MARKING NOTES (TAXIWAY A)**

THE TAXIWAY CENTERLINE STRIPES, HOLDING LINES, AND LEAD-INS WILL BE SOLID AND YELLOW IN COLOR.

ALL PROPOSED MARKING WILL BE LOCATED AS SHOWN ON THE PROPOSED MARKING PLAN. ALL PROPOSED MARKING "PAVEMENT MARKING-WATERBORNE" WILL BE APPLIED WITH A REFLECTIVE MEDIA IN ACCORDANCE WITH THE SPECIFICATIONS.

ALL PROPOSED MARKING WILL BE PAID FOR UNDER ITEMS:  
 AR620520 "PAVEMENT MARKING-WATERBORNE" \_\_\_\_\_ PER SQ. FT.  
 AR620525 "PAVEMENT MARKING-BLACK BORDER" \_\_\_\_\_ PER SQ. FT.

THE TAXIWAY HOLD LINES SHALL BE AS SHOWN IN THE DETAIL ON THIS SHEET.

CUT-OFF SHEETS WILL BE REQUIRED TO INSURE STRAIGHT EDGES.

**620900-PAVEMENT MARKING REMOVAL NOTES**

THE EXISTING PAVEMENT MARKING SHALL BE REMOVED IN ACCORDANCE WITH ITEM 620 "PAVEMENT MARKING" AS STATED ON PAGE 77 OF THE SUPPLEMENTAL SPECIFICATIONS AND RECURRING SPECIAL PROVISIONS, ADOPTED JULY 1, 2004.

THE AREAS THAT ARE DESIGNATED FOR REMOVAL ARE SHOWN ON THE CONSTRUCTION PLANS.

ALL AREAS TO BE REMOVED ARE CALCULATED AREAS. ANY ADDITIONAL AREAS, DUE TO OVER SPRAY, SHALL BE CONSIDERED INCIDENTAL TO THE CONTRACT AND NO ADDITIONAL COMPENSATION WILL BE ALLOWED.

THE PROPOSED MARKING REMOVAL WILL BE PAID FOR UNDER ITEM:  
 AR620900 PAVEMENT MARKING REMOVAL \_\_\_\_\_ 46 S.F.

BY	
REVISION	
DATE	

**DIMAX**  
 DEKALB TAYLOR MUNICIPAL AIRPORT  
 ILL. PROJ.: DK050-3448 A.I.P. PROJ.: 3-17-0139-B42

HEB Project No. 803-05TXAD_0800	LAYOUT	J.E.O.	01/18/06
Filename: R-151MRK.DWG	DRAWN	B.A.K.	01/18/06
Scale: 1" = 50'	REVIEWED	C.A.H.	03/16/06
Date: 01/18/06			

**HANSON**  
 Hanson Professional Services Inc.  
 1525 South State Street  
 Springfield, IL 62761-8886  
 Offices Nationwide

EXTEND TAXIWAY "A"  
 PROPOSED MARKING PLAN FOR TAXIWAY "A"

APR 05, 2006 9:40 AM BAK I:\AIRPORTS\DEKALB\803-05TXAD\AIRPORT\SHEETS\TAXIWAY-A-EXT\TAXIWAY-A-EXT-151MRK.DWG - Layout1