

STATE OF ILLINOIS
DEPARTMENT OF TRANSPORTATION

| F.A. RTE. | SECTION | COUNTY | TOTAL SHEETS | SHEET NO. |
|-----------|---------|-----------|--------------------|-----------|
| VAR. | | CHAMPAIGN | 20 | 1 |
| | | ILLINOIS | CONTRACT NO. 46616 | |

M-60-027-23

FOR INDEX OF SHEETS, SEE SHEET NO. 2
FOR SOQ, SEE SHEET NO. 8 - 9

PROPOSED
HIGHWAY PLANS

VARIOUS ROUTES
SECTION D 5 HT PVMNT MRK RPR 23-26
PAVEMENT MARKING
CHAMPAIGN COUNTY

M-60-027-23
VARIOUS LOCATIONS

FOR LOCATION MAPS, SEE SHEETS 3, 4, 5, 6, & 7

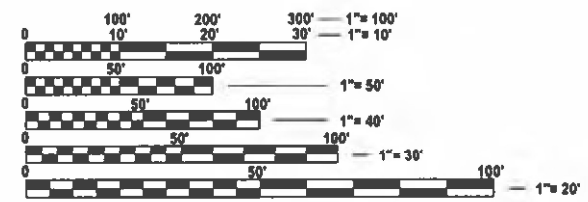
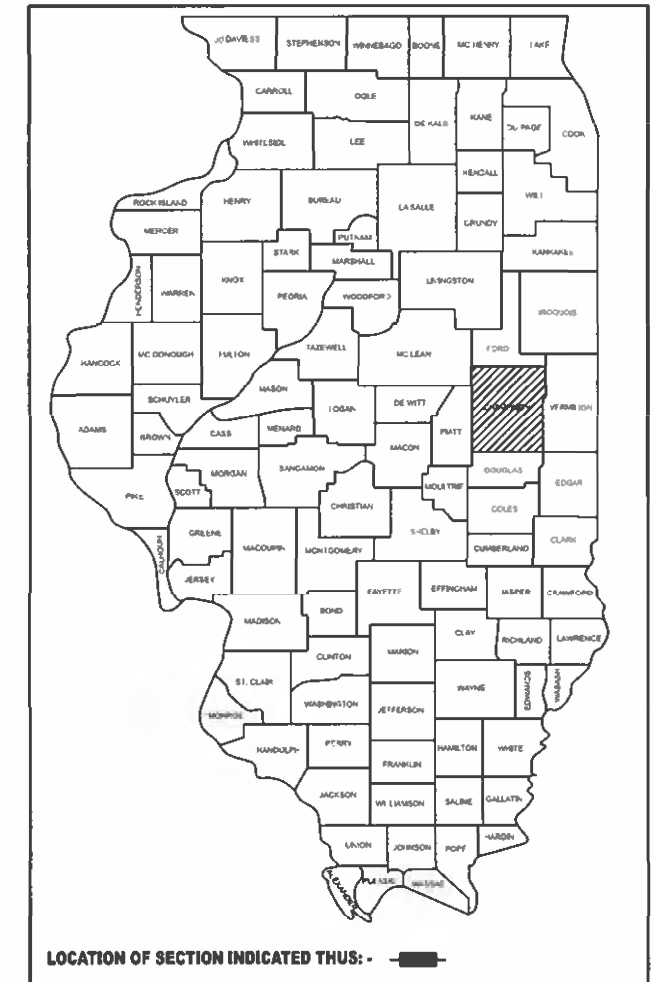

FULL SIZE PLANS HAVE BEEN PREPARED USING STANDARD ENGINEERING SCALES. REDUCED SIZED PLANS WILL NOT CONFORM TO STANDARD SCALES. IN MAKING MEASUREMENTS ON REDUCED PLANS, THE ABOVE SCALES MAY BE USED.

J.U.L.I.E.
JOINT UTILITY LOCATION INFORMATION FOR EXCAVATION
1-800-892-0123
OR 811

PROJECT ENGINEER: RYAN T. CARROLL
SQUAD LEADER: TYLER J. PIERSON

CONTRACT NO. 46619

STATE OF ILLINOIS
DEPARTMENT OF TRANSPORTATION

SUBMITTED 3/22 2023
Kensila Bennett swr
REGIONAL ENGINEER

May 12, 2023 *[Signature]*
ENGINEER OF DESIGN AND ENVIRONMENT

May 12, 2023 *[Signature]*
DIRECTOR OF HIGHWAYS PROJECT IMPLEMENTATION

PRINTED BY THE AUTHORITY
OF THE STATE OF ILLINOIS

INDEX OF SHEETS

| <u>DESCRIPTION</u> | <u>SHEET NO.</u> |
|------------------------------------------------------------------------------------|------------------|
| COVER | 1 |
| INDEX OF SHEETS, LIST OF HIGHWAY STANDARDS, & COMMITMENTS | 2 |
| LOCATION MAPS | 3 to 7 |
| SUMMARY OF QUANTITIES | 8 to 9 |
| SCHEDULE OF QUANTITIES | 10 to 16 |
| D5 DETAIL NO. 7800AAAA - PAVEMENT MARKING AND MARKERS (RURAL & URBAN APPLICATIONS) | 17 to 20 |

LIST OF STANDARDS

| <u>STANDARD NO.</u> | <u>DESCRIPTION</u> |
|---------------------|--------------------------------------------------------------------------------|
| 000001-08 | STANDARD SYMBOLS, ABBREVIATIONS AND PATTERNS |
| 001006 | DECIMAL OF AN INCH AND OF A FOOT |
| 701301-04 | LANE CLOSURE, 2L, 2W, SHORT TIME OPERATIONS |
| 701311-03 | LANE CLOSURE, 2L, 2W, MOVING OPERATIONS - DAY ONLY |
| 701422-10 | LANE CLOSURE, MULTILANE, FOR SPEEDS > 45 MPH TO 55 MPH |
| 701426-09 | LANE CLOSURE, MULTILANE, INTERMITTENT OR MOVING OPERATION, FOR SPEEDS > 45 MPH |
| 701427-05 | LANE CLOSURE, MULTILANE, INTERMITTENT OR MOVING OPERATION, FOR SPEEDS <40 MPH |
| 701501-06 | URBAN LANE CLOSURE, 2L, 2W, UNDIVIDED |
| 701502-09 | URBAN LANE CLOSURE, 2L, 2W, WITH BIDIRECTIONAL LEFT TURN LANE |
| 701601-09 | URBAN LANE CLOSURE, MULTILANE, 1W OR 2W WITH NONTRAVERSABLE MEDIAN |
| 701602-10 | URBAN LANE CLOSURE, MULTILANE, 2W WITH BIDIRECTIONAL LEFT TURN LANE |
| 701701-10 | URBAN LANE CLOSURE, MULTILANE INTERSECTION |
| 701901-08 | TRAFFIC CONTROL DEVICES |
| 780001-05 | TYPICAL PAVEMENT MARKINGS |

GENERAL NOTES

G.N.-100A
ELECTRONIC FILES AND/OR ELECTRONIC SURVEY INFORMATION INCLUDING CADD FILES WILL NOT BE AVAILABLE TO THE CONTRACTOR.

COMMITMENTS

THERE ARE NO COMMITMENTS FOR THIS CONTRACT

MODEL: \\MODEL\MAMES
FILE NAME: \\photospc\c:\na\my.com\PM\DOT\Documents\DOT Office\District 5\ORD Project\054661\CADD\Data\CAD\Sheet\054661\Index\Index, Standards, CN, and Commitments.dgn

| | | |
|--------------------------------|------------|-----------|
| USER NAME = Tyler, Pierson | DESIGNED - | REVISED - |
| | DRAWN - | REVISED - |
| PLOT SCALE = 0.16666667' / in. | CHECKED - | REVISED - |
| PLOT DATE = 3/22/2023 | DATE - | REVISED - |

**STATE OF ILLINOIS
DEPARTMENT OF TRANSPORTATION**

INDEX OF SHEETS, LIST OF STANDARDS,
GENERAL NOTES, AND COMMITMENTS

SCALE: SHEET 1 OF 1 SHEETS STA. ___+___ TO STA. ___+___

| F.A. RTE. | SECTION | COUNTY | TOTAL SHEETS | SHEET NO. |
|-----------|---------|---------------------------|--------------------|-----------|
| | * | CHAMPAIGN | 20 | 2 |
| | | | CONTRACT NO. 46619 | |
| | | ILLINOIS FED. AID PROJECT | | |

* D 5 HT PVMNT MRK RPR 23-26

LOCATION #01 ADT = 4,000
 US 45 PESOTUM FROM STATE POLICE
 HEADQUARTERS TO THE NORTH END
 ON THE ISLAND ON THE NORTH END
 OF TOWN



MODEL: \\MODELS\M1E5
 FILE NAME: \\P:\bids\pvt\1011\1011.dwg

| | | |
|--------------------------------|-----------------|----------------|
| USER NAME = Tyler, Pierson | DESIGNED - ____ | REVISED - ____ |
| | DRAWN - ____ | REVISED - ____ |
| PLOT SCALE = 0.16666633' / in. | CHECKED - ____ | REVISED - ____ |
| PLOT DATE = 3/22/2023 | DATE - ____ | REVISED - ____ |

**STATE OF ILLINOIS
 DEPARTMENT OF TRANSPORTATION**

**LOCATION MAP
 PESOTUM**

SCALE: SHEET 1 OF 5 SHEETS STA. ____+____ TO STA. ____+____

| F.A. RTE. | SECTION | COUNTY | TOTAL SHEETS | SHEET NO. |
|--------------------|---------|-----------|--------------|-----------|
| | * | CHAMPAIGN | 20 | 3 |
| CONTRACT NO. 46619 | | | | |

ILLINOIS FED. AID PROJECT
 * D 5 HT PVMNT MRK RPR 23-26

LOCATION #02 ADT = 4,700
 US 45 INTERSECTION WITH CH 17
 (1051 CR 600N) SOUTH OF TOLONO

LOCATION #03 ADT = 8,450
 US 45 TOLONO CITY LIMITS

LOCATION #04 ADT = 15,400
 US 45 FROM NORTH TOLONO CITY
 LIMIT TO CURTIS RD. IN SAVOY



CONTINUES ON SHEET #

MODEL: \\MODELS\MIES
 FILE NAME: \\P:\Info\pvmnt\mrk\proj\15010\15010.dwg

| | | |
|--------------------------------|------------|-----------|
| USER NAME = Tyler, Pierson | DESIGNED - | REVISED - |
| DRAWN - | REVISED - | |
| PLOT SCALE = 0.16666633' / in. | CHECKED - | REVISED - |
| PLOT DATE = 3/22/2023 | DATE - | REVISED - |

**STATE OF ILLINOIS
 DEPARTMENT OF TRANSPORTATION**

**LOCATION MAP
 TOLONO AND SAVOY**

SCALE: SHEET 2 OF 5 SHEETS STA. ___+___ TO STA. ___+___

| | | | | |
|---------------------------|---------|-----------|--------------|-----------|
| F.A. RTE. | SECTION | COUNTY | TOTAL SHEETS | SHEET NO. |
| VAR. | * | CHAMPAIGN | 20 | 4 |
| CONTRACT NO. 46619 | | | | |
| ILLINOIS FED. AID PROJECT | | | | |

* D 5 HT PVMNT MRK RPR 23-26

LOCATION #04 ADT = 15,400
 US 45 FROM NORTH TOLONO CITY
 LIMIT TO CURTIS RD. IN SAVOY

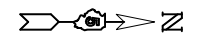

CONTINUES ON SHEET #

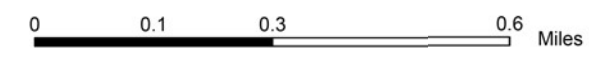
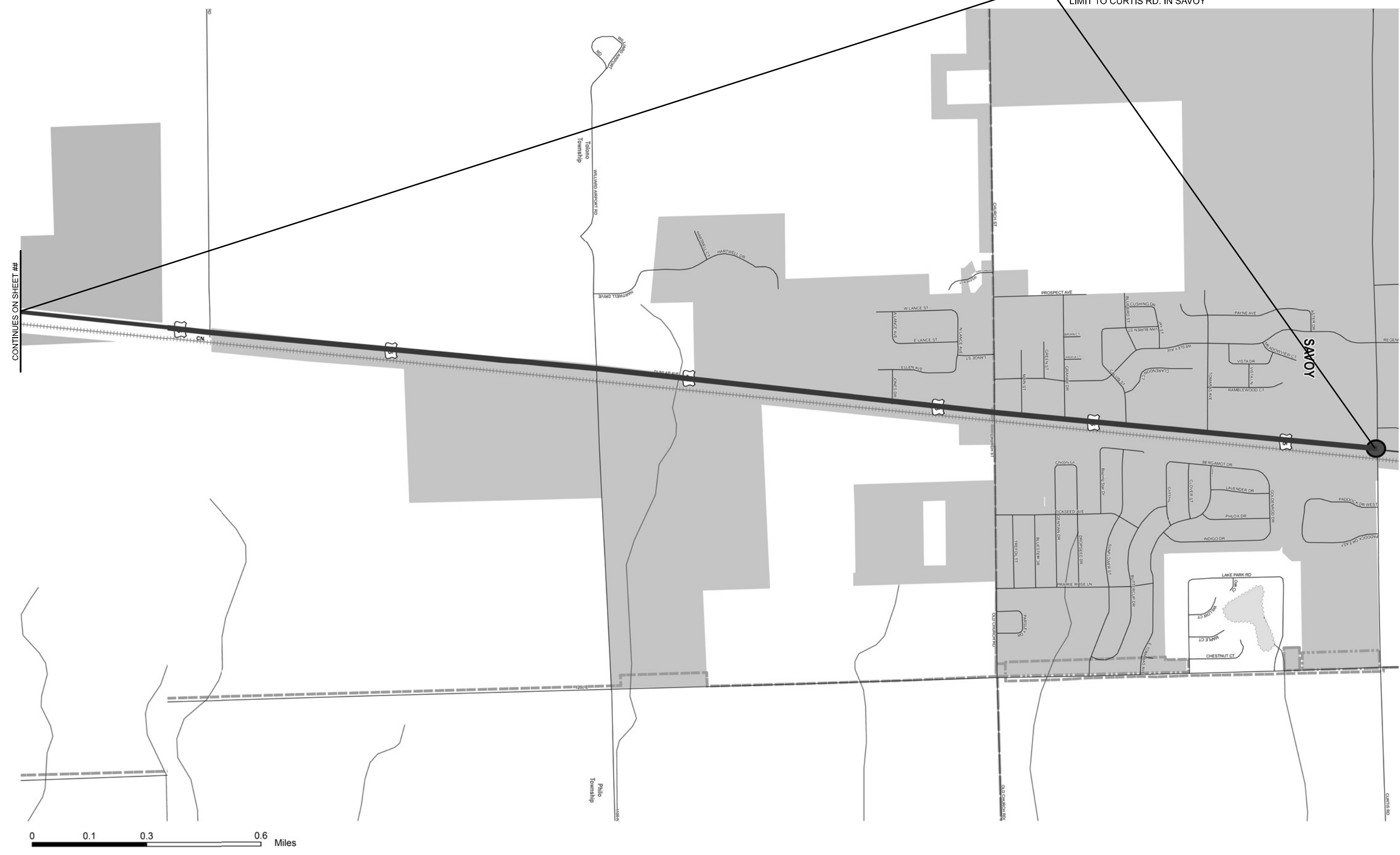

MODEL: \\MODELS\MIES
 FILE NAME: \\P:\DOT\Documents\DOT Office\District 5\ORD Project\045466\CADD\045466\045466.dgn

| | | |
|--------------------------------|------------|----------|
| USER NAME = Tyler, Pierson | DESIGNED - | REVISD - |
| PLOT SCALE = 0.16666833' / in. | DRAWN - | REVISD - |
| PLOT DATE = 3/22/2023 | CHECKED - | REVISD - |
| | DATE - | REVISD - |

**STATE OF ILLINOIS
 DEPARTMENT OF TRANSPORTATION**

**LOCATION MAP
 TOLONO AND SAVOY**

SCALE: SHEET 3 OF 5 SHEETS STA. + + TO STA. + +

| | | | | |
|---------------------------|---------|-----------|--------------|-----------|
| F.A. RTE. | SECTION | COUNTY | TOTAL SHEETS | SHEET NO. |
| VAR. | * | CHAMPAIGN | 20 | 5 |
| CONTRACT NO. 46619 | | | | |
| ILLINOIS FED. AID PROJECT | | | | |

* D 5 HT PVMNT MRK RPR 23-26

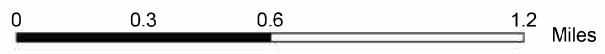
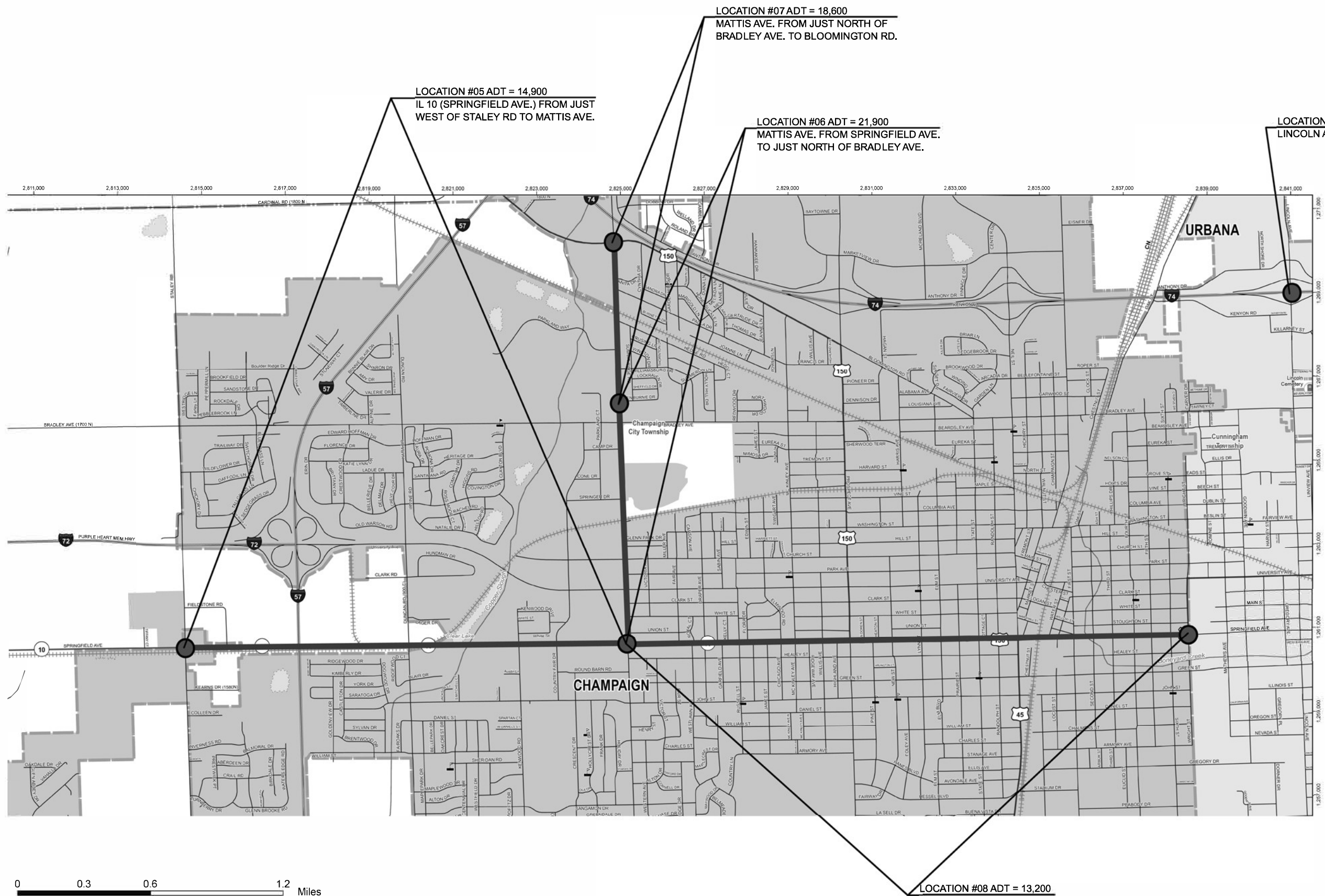

LOCATION #07 ADT = 18,600
MATTIS AVE. FROM JUST NORTH OF
BRADLEY AVE. TO BLOOMINGTON RD.

LOCATION #05 ADT = 14,900
IL 10 (SPRINGFIELD AVE.) FROM JUST
WEST OF STALEY RD TO MATTIS AVE.

LOCATION #06 ADT = 21,900
MATTIS AVE. FROM SPRINGFIELD AVE.
TO JUST NORTH OF BRADLEY AVE.

LOCATION #09 ADT = 10,300
LINCOLN AVE. OVERHEAD AT I-74

LOCATION #08 ADT = 13,200
SPRINGFIELD AVE. FROM
MATTIS AVE. TO WRIGHT ST.

MODEL - MODEL NAMES
FILE NAME - p:\work\pvm\mrk\proj\champaign\DOT\Office\District\BORD\Project\34461\B\CAD\Draws\CA\Draws\1546619_441\Map_City.dgn

| | | |
|-------------------------------|------------|-----------|
| USER NAME = Justin.Cearlock | DESIGNED - | REVISED - |
| PLOT SCALE = 0.16666633 / in. | DRAWN - | REVISED - |
| PLOT DATE = 3/22/2023 | CHECKED - | REVISED - |
| | DATE - | REVISED - |

**STATE OF ILLINOIS
DEPARTMENT OF TRANSPORTATION**

**LOCATION MAP
CHAMPAIGN**

SCALE: SHEET 4 OF 5 SHEETS STA. + TO STA. +

| | | | | |
|--------------------|---------|-----------|--------------|-----------|
| F.A. RTE. | SECTION | COUNTY | TOTAL SHEETS | SHEET NO. |
| VAR. | * | CHAMPAIGN | 20 | 6 |
| CONTRACT NO. 46619 | | | | |

ILLINOIS FED. AID PROJECT

* D 5 HT PVMTR MRK RPR 23-26

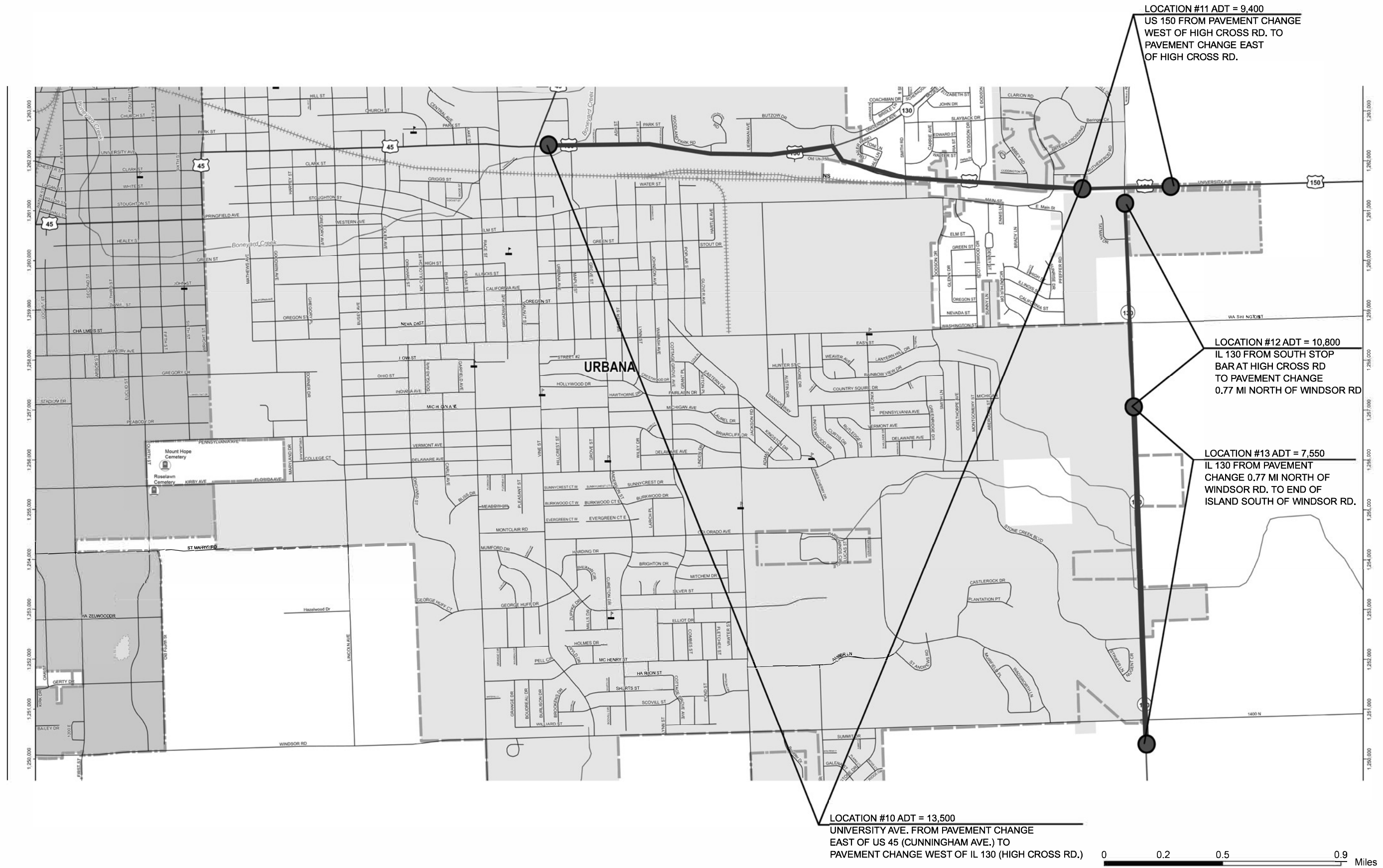

LOCATION #11 ADT = 9,400
US 150 FROM PAVEMENT CHANGE
WEST OF HIGH CROSS RD. TO
PAVEMENT CHANGE EAST
OF HIGH CROSS RD.

LOCATION #12 ADT = 10,800
IL 130 FROM SOUTH STOP
BAR AT HIGH CROSS RD
TO PAVEMENT CHANGE
0.77 MI NORTH OF WINDSOR RD

LOCATION #13 ADT = 7,550
IL 130 FROM PAVEMENT
CHANGE 0.77 MI NORTH OF
WINDSOR RD. TO END OF
ISLAND SOUTH OF WINDSOR RD.

LOCATION #10 ADT = 13,500
UNIVERSITY AVE. FROM PAVEMENT CHANGE
EAST OF US 45 (CUNNINGHAM AVE.) TO
PAVEMENT CHANGE WEST OF IL 130 (HIGH CROSS RD.)

0 0.2 0.5 0.9 Miles

MODEL: \\P:\MODELS\NAMES
FILE NAME: \\P:\MODELS\NAMES\DOT Office\District 5\ORD Project\054461\CA\Draws\CA\Draws\054461\9-411Map_City.dwg

| | | |
|-------------------------------|------------|-----------|
| USER NAME = Justin.Cearlock | DESIGNED - | REVISED - |
| PLOT SCALE = 0.16666633 / in. | DRAWN - | REVISED - |
| PLOT DATE = 3/22/2023 | CHECKED - | REVISED - |
| | DATE - | REVISED - |

**STATE OF ILLINOIS
DEPARTMENT OF TRANSPORTATION**

**LOCATION MAP
URBANA**

SCALE: SHEET 5 OF 5 SHEETS STA. ___+___ TO STA. ___+___

| F.A. RTE. | SECTION | COUNTY | TOTAL SHEETS | SHEET NO. |
|-----------|---------|---------------------------|--------------|-----------|
| VAR. | * | CHAMPAIGN | 20 | 7 |
| | | CONTRACT NO. 46619 | | |
| | | ILLINOIS FED. AID PROJECT | | |

* D 5 HT PVMNT RPR 23-26

SUMMARY OF QUANTITIES

| | | |
|-------------------------|-----------------|-------------------------------------|
| LOCATION OF WORK: | | |
| ROUTE: | FAP 804 (US 45) | VARIOUS |
| COUNTY: | CHAMPAIGN | CHAMPAIGN |
| LOCATION #: | 1 | 3, 4, 5, 6, 7, 8, 9, 10, 11, 12, 13 |
| FUNDING BREAKOUT: | 100% STATE | 100% STATE |
| RURAL / URBAN: | RURAL | URBAN |
| CONSTRUCTION TYPE CODE: | 0021 | 0021 |
| FUNDING BREAKOUT: | | |

| CODE NO. | ITEM | UNIT | TOTAL QUANTITY | ROADWAY QUANTITY | ROADWAY QUANTITY |
|--------------------------|----------------------------------------------------------|-------|----------------|------------------|------------------|
| 78000100 | THERMOPLASTIC PAVEMENT MARKING - LETTERS AND SYMBOLS | SQ FT | 8,293.00 | 1,094.00 | 7,199.00 |
| 78000200 | THERMOPLASTIC PAVEMENT MARKING - LINE 4" | FOOT | 228,905.00 | 36,729.00 | 192,176.00 |
| 78000400 | THERMOPLASTIC PAVEMENT MARKING - LINE 6" | FOOT | 793.00 | 65.00 | 728.00 |
| 78000500 | THERMOPLASTIC PAVEMENT MARKING - LINE 8" | FOOT | 1,000.00 | 900.00 | 100.00 |
| 78000600 | THERMOPLASTIC PAVEMENT MARKING - LINE 12" | FOOT | 4,566.00 | 894.00 | 3,672.00 |
| 78000650 | THERMOPLASTIC PAVEMENT MARKING - LINE 24" | FOOT | 2,069.00 | 170.00 | 1,899.00 |
| 78008300 | POLYUREA PAVEMENT MARKING TYPE II - LETTERS AND SYMBOLS | SQ FT | 112.00 | 15.00 | 97.00 |
| 78008310 | POLYUREA PAVEMENT MARKING TYPE II - LINE 4" | FOOT | 23,288.00 | 1,906.00 | 21,382.00 |
| 78008330 | POLYUREA PAVEMENT MARKING TYPE II - LINE 6" | FOOT | 562.00 | 46.00 | 516.00 |
| 78008350 | POLYUREA PAVEMENT MARKING TYPE II - LINE 12" | FOOT | 2,283.00 | 187.00 | 2,096.00 |
| 78008370 | POLYUREA PAVEMENT MARKING TYPE II - LINE 24" | FOOT | 232.00 | 19.00 | 213.00 |
| 78009000 | MODIFIED URETHANE PAVEMENT MARKING - LETTERS AND SYMBOLS | SQ FT | 4,791.00 | 416.00 | 4,375.00 |
| 78009004 | MODIFIED URETHANE PAVEMENT MARKING - LINE 4" | FOOT | 98,198.00 | 8,035.00 | 90,163.00 |
| 78009006 | MODIFIED URETHANE PAVEMENT MARKING - LINE 6" | FOOT | 1,205.00 | 99.00 | 1,106.00 |
| * DENOTES SPECIALTY ITEM | | | | | |

MODEL: E:\MODEL\NAMES FILE NAME: p:\projects\p\m\DOT Documents\DOT Office\Office\DOT Office\DOT Data\CAD\Drawings\546614-1-15-500.dgn

| | | | |
|--------------------------------|------------|-----------|--|
| USER NAME = Tyler, Pierson | DESIGNED - | REVISED - | |
| | DRAWN - | REVISED - | |
| PLOT SCALE = 0.16666667" / in. | CHECKED - | REVISED - | |
| PLOT DATE = 3/22/2023 | DATE - | REVISED - | |

**STATE OF ILLINOIS
DEPARTMENT OF TRANSPORTATION**

SUMMARY OF QUANTITIES

| | | | | |
|---------------------------|---------|-----------|--------------|-----------|
| F.A. RTE. | SECTION | COUNTY | TOTAL SHEETS | SHEET NO. |
| VAR. | * | CHAMPAIGN | 20 | 8 |
| CONTRACT NO. 46619 | | | | |
| ILLINOIS FED. AID PROJECT | | | | |

SCALE: SHEET 1 OF 2 SHEETS STA. ___+___ TO STA. ___+___

SCHEDULES OF QUANTITIES

| LOCATION #1: US 45 PESOTUM FROM STATE POLICE HEADQUARTERS TO THE NORTH END ON THE ISLAND ON THE NORTH END OF TOWN | | | | | | | | | | |
|-------------------------------------------------------------------------------------------------------------------|-----------------------|-------|-----------|----------|-----------|--------------------------------|--------------------------------|---------------------------------|--------------------------------|-----------------------------------|
| PAY ITEM | DESCRIPTION | UNIT | QUANTITY | WHITE | YELLOW | LT/RT ARROW (15.6 SQ FT) | RAILROAD "R" (3.6 SQ FT) | RAILROAD "X" (54.0 SQ FT) | COMB. ARROW (26.0 SQ FT) | STRAIGHT ARROW (11.5 SQ FT) |
| 78011000 | GRV RCSD PM LTR & SYM | SQ FT | 390.00 | | | 25.00 | 0.00 | 0.00 | 0.00 | 0.00 |
| 78011025 | GRV RCSD PVT MRKG 5 | FOOT | 18,000.00 | 4,900.00 | 13,100.00 | | | | | |
| 78011035 | GRV RCSD PVT MRKG 7 | FOOT | 0.00 | 0.00 | 0.00 | | | | | |
| 78011045 | GRV RCSD PVT MRKG 9 | FOOT | 0.00 | 0.00 | 0.00 | | | | | |
| 78011065 | GRV RCSD PVT MRKG 13 | FOOT | 520.00 | 0.00 | 520.00 | | | | | |
| 78011125 | GRV RCSD PVT MRKG 25 | FOOT | 0.00 | 0.00 | 0.00 | | | | | |
| 78000100 | THPL PVT MK LTR & SYM | SQ FT | 390.00 | | | 25.00 | 0.00 | 0.00 | 0.00 | 0.00 |
| 78000200 | THPL PVT MK LINE 4 | FOOT | 18,000.00 | 4,900.00 | 13,100.00 | | | | | |
| 78000400 | THPL PVT MK LINE 6 | FOOT | 0.00 | 0.00 | 0.00 | | | | | |
| 78000500 | THPL PVT MK LINE 8 | FOOT | 0.00 | 0.00 | 0.00 | | | | | |
| 78000600 | THPL PVT MK LINE 12 | FOOT | 520.00 | 0.00 | 520.00 | | | | | |
| 78000650 | THPL PVT MK LINE 24 | FOOT | 0.00 | 0.00 | 0.00 | | | | | |
| 78008300 | POLYUREA PM T2 LTR-SY | SQ FT | 0.00 | | | 0.00 | 0.00 | 0.00 | 0.00 | 0.00 |
| 78008310 | POLYUREA PM T2 LN 4 | FOOT | 0.00 | 0.00 | 0.00 | | | | | |
| 78008330 | POLYUREA PM T2 LN 6 | FOOT | 0.00 | 0.00 | 0.00 | | | | | |
| 78008350 | POLYUREA PM T2 LN 12 | FOOT | 0.00 | 0.00 | 0.00 | | | | | |
| 78008370 | POLYUREA PM T2 LN 24 | FOOT | 0.00 | 0.00 | 0.00 | | | | | |
| 78009000 | MOD URETH PM LTR-SYM | SQ FT | 0.00 | | | 0.00 | 0.00 | 0.00 | 0.00 | 0.00 |
| 78009004 | MOD URETH PM LINE 4 | FOOT | 0.00 | 0.00 | 0.00 | | | | | |
| 78009006 | MOD URETH PM LINE 6 | FOOT | 0.00 | 0.00 | 0.00 | | | | | |
| 78009012 | MOD URETH PM LINE 12 | FOOT | 0.00 | 0.00 | 0.00 | | | | | |
| 78009024 | MOD URETH PM LINE 24 | FOOT | 0.00 | 0.00 | 0.00 | | | | | |
| 78300201 | PAVMT MRKG REM GRIND | SQ FT | 0.00 | | | | | | | |
| 78300202 | PAVMT MRKG REM WTR BL | SQ FT | 0.00 | | | | | | | |

| LOCATION #2: US 45 INTERSECTION WITH CH 17 (1051 CR 600N) SOUTH OF TOLONO | | | | | | | | | | |
|---------------------------------------------------------------------------|-----------------------|-------|-----------|----------|----------|--------------------------------|--------------------------------|---------------------------------|--------------------------------|-----------------------------------|
| PAY ITEM | DESCRIPTION | UNIT | QUANTITY | WHITE | YELLOW | LT/RT ARROW (15.6 SQ FT) | RAILROAD "R" (3.6 SQ FT) | RAILROAD "X" (54.0 SQ FT) | COMB. ARROW (26.0 SQ FT) | STRAIGHT ARROW (11.5 SQ FT) |
| 78011000 | GRV RCSD PM LTR & SYM | SQ FT | 250.00 | | | 16.00 | 0.00 | 0.00 | 0.00 | 0.00 |
| 78011025 | GRV RCSD PVT MRKG 5 | FOOT | 12,150.00 | 5,300.00 | 6,850.00 | | | | | |
| 78011035 | GRV RCSD PVT MRKG 7 | FOOT | 0.00 | 0.00 | 0.00 | | | | | |
| 78011045 | GRV RCSD PVT MRKG 9 | FOOT | 0.00 | 0.00 | 0.00 | | | | | |
| 78011065 | GRV RCSD PVT MRKG 13 | FOOT | 510.00 | 0.00 | 510.00 | | | | | |
| 78011125 | GRV RCSD PVT MRKG 25 | FOOT | 50.00 | 50.00 | 0.00 | | | | | |
| 78000100 | THPL PVT MK LTR & SYM | SQ FT | 250.00 | | | 16.00 | 0.00 | 0.00 | 0.00 | 0.00 |
| 78000200 | THPL PVT MK LINE 4 | FOOT | 12,150.00 | 5,300.00 | 6,850.00 | | | | | |
| 78000400 | THPL PVT MK LINE 6 | FOOT | 0.00 | 0.00 | 0.00 | | | | | |
| 78000500 | THPL PVT MK LINE 8 | FOOT | 0.00 | 0.00 | 0.00 | | | | | |
| 78000600 | THPL PVT MK LINE 12 | FOOT | 510.00 | 0.00 | 510.00 | | | | | |
| 78000650 | THPL PVT MK LINE 24 | FOOT | 50.00 | 50.00 | 0.00 | | | | | |
| 78008300 | POLYUREA PM T2 LTR-SY | SQ FT | 0.00 | | | 0.00 | 0.00 | 0.00 | 0.00 | 0.00 |
| 78008310 | POLYUREA PM T2 LN 4 | FOOT | 0.00 | 0.00 | 0.00 | | | | | |
| 78008330 | POLYUREA PM T2 LN 6 | FOOT | 0.00 | 0.00 | 0.00 | | | | | |
| 78008350 | POLYUREA PM T2 LN 12 | FOOT | 0.00 | 0.00 | 0.00 | | | | | |
| 78008370 | POLYUREA PM T2 LN 24 | FOOT | 0.00 | 0.00 | 0.00 | | | | | |
| 78009000 | MOD URETH PM LTR-SYM | SQ FT | 0.00 | | | 0.00 | 0.00 | 0.00 | 0.00 | 0.00 |
| 78009004 | MOD URETH PM LINE 4 | FOOT | 0.00 | 0.00 | 0.00 | | | | | |
| 78009006 | MOD URETH PM LINE 6 | FOOT | 0.00 | 0.00 | 0.00 | | | | | |
| 78009012 | MOD URETH PM LINE 12 | FOOT | 0.00 | 0.00 | 0.00 | | | | | |
| 78009024 | MOD URETH PM LINE 24 | FOOT | 0.00 | 0.00 | 0.00 | | | | | |
| 78300201 | PAVMT MRKG REM GRIND | SQ FT | 0.00 | | | | | | | |
| 78300202 | PAVMT MRKG REM WTR BL | SQ FT | 0.00 | | | | | | | |

END OF DOUBLE YELLOW TO END OF DOUBLE YELLOW

MODEL: R:\MODELS\M1E2... FILE NAME: ...

| | | |
|--------------------------------|------------------|-----------------|
| USER NAME = Tyler, Pierson | DESIGNED - _____ | REVISED - _____ |
| | DRAWN - _____ | REVISED - _____ |
| PLOT SCALE = 0.16666633' / in. | CHECKED - _____ | REVISED - _____ |
| PLOT DATE = 3/22/2023 | DATE - _____ | REVISED - _____ |

**STATE OF ILLINOIS
DEPARTMENT OF TRANSPORTATION**

SCHEDULE OF QUANTITIES

SCALE: SHEET 1 OF 7 SHEETS STA. ___+___ TO STA. ___+___

| | | | | |
|---------------------------|---------|-----------|--------------------|-----------|
| F.A. RTE. | SECTION | COUNTY | TOTAL SHEETS | SHEET NO. |
| VAR. | * | CHAMPAIGN | 20 | 10 |
| | | | CONTRACT NO. 46619 | |
| ILLINOIS FED. AID PROJECT | | | | |

* D 5 HT PVMNT MRK RPR 23-26

SCHEDULES OF QUANTITIES

LOCATION #3: US 45 TOLONO CITY LIMITS

| PAY ITEM | DESCRIPTION | UNIT | QUANTITY | WHITE | YELLOW | LT/RT ARROW (15.6 SQ FT) | RAILROAD "R" (3.6 SQ FT) | RAILROAD "X" (54.0 SQ FT) | COMB. ARROW (26.0 SQ FT) | STRAIGHT ARROW (11.5 SQ FT) |
|----------|-----------------------|-------|-----------|----------|-----------|--------------------------------|--------------------------------|---------------------------------|--------------------------------|-----------------------------------|
| 78011000 | GRV RCSD PM LTR & SYM | SQ FT | 734.00 | | | | | | | |
| 78011025 | GRV RCSD PVT MRKG 5 | FOOT | 13,230.00 | 2,010.00 | 11,220.00 | 47.00 | 0.00 | 0.00 | 0.00 | 0.00 |
| 78011035 | GRV RCSD PVT MRKG 7 | FOOT | 0.00 | 0.00 | 0.00 | | | | | |
| 78011045 | GRV RCSD PVT MRKG 9 | FOOT | 0.00 | 0.00 | 0.00 | | | | | |
| 78011065 | GRV RCSD PVT MRKG 13 | FOOT | 400.00 | 0.00 | 400.00 | | | | | |
| 78011125 | GRV RCSD PVT MRKG 25 | FOOT | 159.00 | 159.00 | 0.00 | | | | | |
| 78000100 | THPL PVT MK LTR & SYM | SQ FT | 671.00 | | | 43.00 | 0.00 | 0.00 | 0.00 | 0.00 |
| 78000200 | THPL PVT MK LINE 4 | FOOT | 12,550.00 | 1,850.00 | 10,700.00 | | | | | |
| 78000400 | THPL PVT MK LINE 6 | FOOT | 0.00 | 0.00 | 0.00 | | | | | |
| 78000500 | THPL PVT MK LINE 8 | FOOT | 0.00 | 0.00 | 0.00 | | | | | |
| 78000600 | THPL PVT MK LINE 12 | FOOT | 400.00 | 0.00 | 400.00 | | | | | |
| 78000650 | THPL PVT MK LINE 24 | FOOT | 75.00 | 75.00 | 0.00 | | | | | |
| 78008300 | POLYUREA PM T2 LTR-SY | SQ FT | 63.00 | | | 4.00 | 0.00 | 0.00 | 0.00 | 0.00 |
| 78008310 | POLYUREA PM T2 LN 4 | FOOT | 680.00 | 160.00 | 520.00 | | | | | |
| 78008330 | POLYUREA PM T2 LN 6 | FOOT | 0.00 | 0.00 | 0.00 | | | | | |
| 78008350 | POLYUREA PM T2 LN 12 | FOOT | 0.00 | 0.00 | 0.00 | | | | | |
| 78008370 | POLYUREA PM T2 LN 24 | FOOT | 84.00 | 84.00 | 0.00 | | | | | |
| 78009000 | MOD URETH PM LTR-SYM | SQ FT | 0.00 | | | 0.00 | 0.00 | 0.00 | 0.00 | 0.00 |
| 78009004 | MOD URETH PM LINE 4 | FOOT | 0.00 | 0.00 | 0.00 | | | | | |
| 78009006 | MOD URETH PM LINE 6 | FOOT | 0.00 | 0.00 | 0.00 | | | | | |
| 78009012 | MOD URETH PM LINE 12 | FOOT | 0.00 | 0.00 | 0.00 | | | | | |
| 78009024 | MOD URETH PM LINE 24 | FOOT | 0.00 | 0.00 | 0.00 | | | | | |
| 78300201 | PAVMT MRKG REM GRIND | SQ FT | 0.00 | | | | | | | |
| 78300202 | PAVMT MRKG REM WTR BL | SQ FT | 0.00 | | | | | | | |

HOLDEN STREET: 1. NO CROSSWALKS 2. WEST LEG - STOP BAR, ARROWS, AND LANE LINES ON CONCRETE 3. EAST LEG - STOP BAR, ARROWS, LANE LINES ON CONCRETE - DON'T DO RR SYMBOL OR RR STOP BARS

LOCATION #4: US 45 FROM NORTH TOLONO CITY LIMIT TO CURTIS ROAD IN SAVOY

| PAY ITEM | DESCRIPTION | UNIT | QUANTITY | WHITE | YELLOW | LT/RT ARROW (15.6 SQ FT) | RAILROAD "R" (3.6 SQ FT) | RAILROAD "X" (54.0 SQ FT) | COMB. ARROW (26.0 SQ FT) | STRAIGHT ARROW (11.5 SQ FT) |
|----------|-----------------------|-------|------------|-----------|-----------|--------------------------------|--------------------------------|---------------------------------|--------------------------------|-----------------------------------|
| 78011000 | GRV RCSD PM LTR & SYM | SQ FT | 3,057.00 | | | | | | | |
| 78011025 | GRV RCSD PVT MRKG 5 | FOOT | 124,350.00 | 64,750.00 | 59,600.00 | 190.00 | 0.00 | 0.00 | 0.00 | 8.00 |
| 78011035 | GRV RCSD PVT MRKG 7 | FOOT | 600.00 | 600.00 | 0.00 | | | | | |
| 78011045 | GRV RCSD PVT MRKG 9 | FOOT | 0.00 | 0.00 | 0.00 | | | | | |
| 78011065 | GRV RCSD PVT MRKG 13 | FOOT | 1,925.00 | 325.00 | 1,600.00 | | | | | |
| 78011125 | GRV RCSD PVT MRKG 25 | FOOT | 796.00 | 796.00 | 0.00 | | | | | |
| 78000100 | THPL PVT MK LTR & SYM | SQ FT | 3,025.00 | | | 188.00 | 0.00 | 0.00 | 0.00 | 8.00 |
| 78000200 | THPL PVT MK LINE 4 | FOOT | 124,000.00 | 64,500.00 | 59,500.00 | | | | | |
| 78000400 | THPL PVT MK LINE 6 | FOOT | 450.00 | 450.00 | 0.00 | | | | | |
| 78000500 | THPL PVT MK LINE 8 | FOOT | 0.00 | 0.00 | 0.00 | | | | | |
| 78000600 | THPL PVT MK LINE 12 | FOOT | 1,850.00 | 250.00 | 1,600.00 | | | | | |
| 78000650 | THPL PVT MK LINE 24 | FOOT | 720.00 | 720.00 | 0.00 | | | | | |
| 78008300 | POLYUREA PM T2 LTR-SY | SQ FT | 32.00 | | | 2.00 | 0.00 | 0.00 | 0.00 | 0.00 |
| 78008310 | POLYUREA PM T2 LN 4 | FOOT | 350.00 | 250.00 | 100.00 | | | | | |
| 78008330 | POLYUREA PM T2 LN 6 | FOOT | 150.00 | 150.00 | 0.00 | | | | | |
| 78008350 | POLYUREA PM T2 LN 12 | FOOT | 75.00 | 75.00 | 0.00 | | | | | |
| 78008370 | POLYUREA PM T2 LN 24 | FOOT | 76.00 | 76.00 | 0.00 | | | | | |
| 78009000 | MOD URETH PM LTR-SYM | SQ FT | 0.00 | | | 0.00 | 0.00 | 0.00 | 0.00 | 0.00 |
| 78009004 | MOD URETH PM LINE 4 | FOOT | 0.00 | 0.00 | 0.00 | | | | | |
| 78009006 | MOD URETH PM LINE 6 | FOOT | 0.00 | 0.00 | 0.00 | | | | | |
| 78009012 | MOD URETH PM LINE 12 | FOOT | 0.00 | 0.00 | 0.00 | | | | | |
| 78009024 | MOD URETH PM LINE 24 | FOOT | 0.00 | 0.00 | 0.00 | | | | | |
| 78300201 | PAVMT MRKG REM GRIND | SQ FT | 0.00 | | | | | | | |
| 78300202 | PAVMT MRKG REM WTR BL | SQ FT | 0.00 | | | | | | | |

PHILO ROAD: 1. WEST LEG - ALL MARKINGS TO PAVEMENT CHANGE 2. EAST LEG - ALL MARKINGS ON CONCRETE (NOT CROSS HATCHING) AND ADD A RR STOP BAR FOR EB | MONTICELLO ROAD: 1. WEST LEG - ALL MARKINGS TO PAVEMENT CHANGE
 AIRPORT ROAD: 1. WEST LEG - STOP BAR ONLY 2. EAST LEG - STOP BAR ONLY | CHURCH STREET: 1. WEST LEG - STOP BAR ONLY 2. EAST LEG - NO WORK
 WALMART ENT: 1. WEST LEG - ADD MISSING STOP BAR (ACROSS ALL THREE LANES) BEHIND CROSS WALK
 CURTIS ROAD: 1. WEST LEG - STOP BAR ONLY 2. EAST LEG - NO WORK 3. NORTH LEG - STOP BAR ONLY

MODEL: R:\MODEL\MJEE... FILE NAME: P:\MIDOT\Documents\DOT Office\District 5\ORD Project\05466\05466\05466\05466\Schedule3.dgn

| | | |
|--------------------------------|------------------|-----------------|
| USER NAME = Tyler, Pierson | DESIGNED - _____ | REVISED - _____ |
| | DRAWN - _____ | REVISED - _____ |
| PLOT SCALE = 0.16666633' / in. | CHECKED - _____ | REVISED - _____ |
| PLOT DATE = 3/22/2023 | DATE - _____ | REVISED - _____ |

**STATE OF ILLINOIS
DEPARTMENT OF TRANSPORTATION**

SCHEDULE OF QUANTITIES

SCALE: SHEET 2 OF 7 SHEETS STA. ___+___ TO STA. ___+___

| F.A. RTE. | SECTION | COUNTY | TOTAL SHEETS | SHEET NO. |
|--------------------|---------|-----------|--------------|-----------|
| | * | CHAMPAIGN | 20 | 11 |
| CONTRACT NO. 46619 | | | | |

ILLINOIS FED. AID PROJECT

* D 5 HT PVMNT MRK RPR 23-26

SCHEDULES OF QUANTITIES

| LOCATION #5: IL 10 (SPRINGFIELD AVE) FROM JUST WEST OF STALEY RD TO MATTIS AVE | | | | | | | | | | |
|--------------------------------------------------------------------------------|-----------------------|-------|-----------|-----------|-----------|--------------------------------|--------------------------------|---------------------------------|--------------------------------|-----------------------------------|
| PAY ITEM | DESCRIPTION | UNIT | QUANTITY | WHITE | YELLOW | LT/RT ARROW (15.6 SQ FT) | RAILROAD "R" (3.6 SQ FT) | RAILROAD "X" (54.0 SQ FT) | COMB. ARROW (26.0 SQ FT) | STRAIGHT ARROW (11.5 SQ FT) |
| 78011000 | GRV RCSD PM LTR & SYM | SQ FT | 0.00 | | | 0.00 | 0.00 | 0.00 | 0.00 | 0.00 |
| 78011025 | GRV RCSD PVT MRKG 5 | FOOT | 0.00 | 0.00 | 0.00 | | | | | |
| 78011035 | GRV RCSD PVT MRKG 7 | FOOT | 0.00 | 0.00 | 0.00 | | | | | |
| 78011045 | GRV RCSD PVT MRKG 9 | FOOT | 0.00 | 0.00 | 0.00 | | | | | |
| 78011065 | GRV RCSD PVT MRKG 13 | FOOT | 0.00 | 0.00 | 0.00 | | | | | |
| 78011125 | GRV RCSD PVT MRKG 25 | FOOT | 0.00 | 0.00 | 0.00 | | | | | |
| 78000100 | THPL PVT MK LTR & SYM | SQ FT | 0.00 | | | 0.00 | 0.00 | 0.00 | 0.00 | 0.00 |
| 78000200 | THPL PVT MK LINE 4 | FOOT | 0.00 | 0.00 | 0.00 | | | | | |
| 78000400 | THPL PVT MK LINE 6 | FOOT | 0.00 | 0.00 | 0.00 | | | | | |
| 78000500 | THPL PVT MK LINE 8 | FOOT | 0.00 | 0.00 | 0.00 | | | | | |
| 78000600 | THPL PVT MK LINE 12 | FOOT | 0.00 | 0.00 | 0.00 | | | | | |
| 78000650 | THPL PVT MK LINE 24 | FOOT | 0.00 | 0.00 | 0.00 | | | | | |
| 78008300 | POLYUREA PM T2 LTR-SY | SQ FT | 0.00 | | | 0.00 | 0.00 | 0.00 | 0.00 | 0.00 |
| 78008310 | POLYUREA PM T2 LN 4 | FOOT | 0.00 | 0.00 | 0.00 | | | | | |
| 78008330 | POLYUREA PM T2 LN 6 | FOOT | 0.00 | 0.00 | 0.00 | | | | | |
| 78008350 | POLYUREA PM T2 LN 12 | FOOT | 0.00 | 0.00 | 0.00 | | | | | |
| 78008370 | POLYUREA PM T2 LN 24 | FOOT | 0.00 | 0.00 | 0.00 | | | | | |
| 78009000 | MOD URETH PM LTR-SYM | SQ FT | 1,493.00 | | | 80.00 | 8.00 | 4.00 | 0.00 | 0.00 |
| 78009004 | MOD URETH PM LINE 4 | FOOT | 39,650.00 | 17,800.00 | 21,850.00 | | | | | |
| 78009006 | MOD URETH PM LINE 6 | FOOT | 420.00 | 420.00 | 0.00 | | | | | |
| 78009012 | MOD URETH PM LINE 12 | FOOT | 750.00 | 230.00 | 520.00 | | | | | |
| 78009024 | MOD URETH PM LINE 24 | FOOT | 1,000.00 | 1,000.00 | 0.00 | | | | | |
| 78300201 | PAVMT MRKG REM GRIND | SQ FT | 0.00 | | | | | | | |
| 78300202 | PAVMT MRKG REM WTR BL | SQ FT | 0.00 | | | | | | | |

ENTIRE SECTION: 1. NO GROOVING 2. NO CROSS WALKS | STALEY: 1. NORTH & SOUTH LEGS - STOP BARS AND ISLANDS (6" AND 12")
 DUNCAN: 1. NORTH LEG - STOP BAR 2. SOUTH LEG - NO WORK | KENWOOD ROAD: 1. NORTH LEG & SOUTH LEG - STOP BARS
 PARKING LOT: 1. NORTH LEG & SOUTH LEG - STOP BARS
 MATTIS AVE: 1. WEST LEG - STOP AT STOP BAR 2. SOUTH LEG - STOP BARS 3. EAST LEG - NO WORK 4. NORTH LEG - ON NEXT LOCATION

| LOCATION #6: MATTIS AVE FROM SPRINGFIELD AVE TO JUST NORTH OF BRADLEY AVE | | | | | | | | | | |
|---------------------------------------------------------------------------|-----------------------|-------|-----------|----------|-----------|--------------------------------|--------------------------------|---------------------------------|--------------------------------|-----------------------------------|
| PAY ITEM | DESCRIPTION | UNIT | QUANTITY | WHITE | YELLOW | LT/RT ARROW (15.6 SQ FT) | RAILROAD "R" (3.6 SQ FT) | RAILROAD "X" (54.0 SQ FT) | COMB. ARROW (26.0 SQ FT) | STRAIGHT ARROW (11.5 SQ FT) |
| 78011000 | GRV RCSD PM LTR & SYM | SQ FT | 0.00 | | | 0.00 | 0.00 | 0.00 | 0.00 | 0.00 |
| 78011025 | GRV RCSD PVT MRKG 5 | FOOT | 0.00 | 0.00 | 0.00 | | | | | |
| 78011035 | GRV RCSD PVT MRKG 7 | FOOT | 0.00 | 0.00 | 0.00 | | | | | |
| 78011045 | GRV RCSD PVT MRKG 9 | FOOT | 0.00 | 0.00 | 0.00 | | | | | |
| 78011065 | GRV RCSD PVT MRKG 13 | FOOT | 0.00 | 0.00 | 0.00 | | | | | |
| 78011125 | GRV RCSD PVT MRKG 25 | FOOT | 0.00 | 0.00 | 0.00 | | | | | |
| 78000100 | THPL PVT MK LTR & SYM | SQ FT | 0.00 | | | 0.00 | 0.00 | 0.00 | 0.00 | 0.00 |
| 78000200 | THPL PVT MK LINE 4 | FOOT | 0.00 | 0.00 | 0.00 | | | | | |
| 78000400 | THPL PVT MK LINE 6 | FOOT | 0.00 | 0.00 | 0.00 | | | | | |
| 78000500 | THPL PVT MK LINE 8 | FOOT | 0.00 | 0.00 | 0.00 | | | | | |
| 78000600 | THPL PVT MK LINE 12 | FOOT | 0.00 | 0.00 | 0.00 | | | | | |
| 78000650 | THPL PVT MK LINE 24 | FOOT | 0.00 | 0.00 | 0.00 | | | | | |
| 78008300 | POLYUREA PM T2 LTR-SY | SQ FT | 0.00 | | | 0.00 | 0.00 | 0.00 | 0.00 | 0.00 |
| 78008310 | POLYUREA PM T2 LN 4 | FOOT | 0.00 | 0.00 | 0.00 | | | | | |
| 78008330 | POLYUREA PM T2 LN 6 | FOOT | 0.00 | 0.00 | 0.00 | | | | | |
| 78008350 | POLYUREA PM T2 LN 12 | FOOT | 0.00 | 0.00 | 0.00 | | | | | |
| 78008370 | POLYUREA PM T2 LN 24 | FOOT | 0.00 | 0.00 | 0.00 | | | | | |
| 78009000 | MOD URETH PM LTR-SYM | SQ FT | 1,493.00 | | | 80.00 | 8.00 | 4.00 | 0.00 | 0.00 |
| 78009004 | MOD URETH PM LINE 4 | FOOT | 17,220.00 | 5,760.00 | 11,460.00 | | | | | |
| 78009006 | MOD URETH PM LINE 6 | FOOT | 225.00 | 225.00 | 0.00 | | | | | |
| 78009012 | MOD URETH PM LINE 12 | FOOT | 325.00 | 260.00 | 65.00 | | | | | |
| 78009024 | MOD URETH PM LINE 24 | FOOT | 840.00 | 840.00 | 0.00 | | | | | |
| 78300201 | PAVMT MRKG REM GRIND | SQ FT | 0.00 | | | | | | | |
| 78300202 | PAVMT MRKG REM WTR BL | SQ FT | 0.00 | | | | | | | |

ENTIRE SECTION: 1. NO GROOVING 2. NO CROSS WALKS
 MATTIS AVE: 1. WEST LEG - ON LAST LOCATION 2. SOUTH LEG - ON LAST LOCATION 3. EAST LEG - NO WORK 4. NORTH LEG - START AT STOP BAR
 UNIVERSITY AVE: 1. EAST LEG & WEST LEG - NO WORK | CHURCH ST: 1. EAST LEG & WEST LEG - NO WORK | GLEN PARK DR: 1. EAST LEG & WEST LEG - STOP BARS
 SPRINGER DR: 1. EAST LEG & WEST LEG - STOP BARS | BRADLEY AVE: 1. EAST LEG & WEST LEG - STOP BARS

MODEL: R:\MODEL\NAMES
FILE NAME: P:\Info\pcc\work\mattis\mattis.dwg

| | | |
|--------------------------------|------------------|-----------------|
| USER NAME = Tyler, Pierson | DESIGNED - _____ | REVISED - _____ |
| | DRAWN - _____ | REVISED - _____ |
| PLOT SCALE = 0.16666633' / in. | CHECKED - _____ | REVISED - _____ |
| PLOT DATE = 3/22/2023 | DATE - _____ | REVISED - _____ |

**STATE OF ILLINOIS
DEPARTMENT OF TRANSPORTATION**

SCHEDULE OF QUANTITIES

SCALE: SHEET 3 OF 7 SHEETS STA. ___+___ TO STA. ___+___

| F.A. RTE. | SECTION | COUNTY | TOTAL SHEETS | SHEET NO. |
|---------------------------|---------|-----------|--------------|-----------|
| | * | CHAMPAIGN | 20 | 12 |
| CONTRACT NO. 46619 | | | | |
| ILLINOIS FED. AID PROJECT | | | | |

* D 5 HT PVMNT MRK RPR 23-26

SCHEDULES OF QUANTITIES

| LOCATION #7: MATTIS AVE FROM JUST NORTH OF BRADLEY AVE TO BLOOMINGTON RD | | | | | | | | | | |
|--------------------------------------------------------------------------|-----------------------|-------|-----------|----------|----------|--------------------------------|--------------------------------|---------------------------------|--------------------------------|-----------------------------------|
| PAY ITEM | DESCRIPTION | UNIT | QUANTITY | WHITE | YELLOW | LT/RT ARROW (15.6 SQ FT) | RAILROAD "R" (3.6 SQ FT) | RAILROAD "X" (54.0 SQ FT) | COMB. ARROW (26.0 SQ FT) | STRAIGHT ARROW (11.5 SQ FT) |
| 78011000 | GRV RCSD PM LTR & SYM | SQ FT | 963.00 | | | 46.00 | 8.00 | 4.00 | 0.00 | 0.00 |
| 78011025 | GRV RCSD PVT MRKG 5 | FOOT | 10,300.00 | 2,300.00 | 8,000.00 | | | | | |
| 78011035 | GRV RCSD PVT MRKG 7 | FOOT | 0.00 | 0.00 | 0.00 | | | | | |
| 78011045 | GRV RCSD PVT MRKG 9 | FOOT | 0.00 | 0.00 | 0.00 | | | | | |
| 78011065 | GRV RCSD PVT MRKG 13 | FOOT | 70.00 | 0.00 | 70.00 | | | | | |
| 78011125 | GRV RCSD PVT MRKG 25 | FOOT | 415.00 | 415.00 | 0.00 | | | | | |
| 78000100 | THPL PVT MK LTR & SYM | SQ FT | 963.00 | | | 46.00 | 8.00 | 4.00 | 0.00 | 0.00 |
| 78000200 | THPL PVT MK LINE 4 | FOOT | 10,300.00 | 2,300.00 | 8,000.00 | | | | | |
| 78000400 | THPL PVT MK LINE 6 | FOOT | 0.00 | 0.00 | 0.00 | | | | | |
| 78000500 | THPL PVT MK LINE 8 | FOOT | 0.00 | 0.00 | 0.00 | | | | | |
| 78000600 | THPL PVT MK LINE 12 | FOOT | 70.00 | 0.00 | 70.00 | | | | | |
| 78000650 | THPL PVT MK LINE 24 | FOOT | 395.00 | 395.00 | 0.00 | | | | | |
| 78008300 | POLYUREA PM T2 LTR-SY | SQ FT | 0.00 | | | 0.00 | 0.00 | 0.00 | 0.00 | 0.00 |
| 78008310 | POLYUREA PM T2 LN 4 | FOOT | 0.00 | 0.00 | 0.00 | | | | | |
| 78008330 | POLYUREA PM T2 LN 6 | FOOT | 0.00 | 0.00 | 0.00 | | | | | |
| 78008350 | POLYUREA PM T2 LN 12 | FOOT | 0.00 | 0.00 | 0.00 | | | | | |
| 78008370 | POLYUREA PM T2 LN 24 | FOOT | 20.00 | 20.00 | 0.00 | | | | | |
| 78009000 | MOD URETH PM LTR-SYM | SQ FT | 0.00 | | | 0.00 | 0.00 | 0.00 | 0.00 | 0.00 |
| 78009004 | MOD URETH PM LINE 4 | FOOT | 0.00 | 0.00 | 0.00 | | | | | |
| 78009006 | MOD URETH PM LINE 6 | FOOT | 0.00 | 0.00 | 0.00 | | | | | |
| 78009012 | MOD URETH PM LINE 12 | FOOT | 0.00 | 0.00 | 0.00 | | | | | |
| 78009024 | MOD URETH PM LINE 24 | FOOT | 0.00 | 0.00 | 0.00 | | | | | |
| 78300201 | PAVMT MRKG REM GRIND | SQ FT | 0.00 | | | | | | | |
| 78300202 | PAVMT MRKG REM WTR BL | SQ FT | 0.00 | | | | | | | |

ENTIRE SECTION: 1. NO CROSSWALKS | PARKLAND WAY: 1. WEST LEG - STOP BAR | PAULA DR: 1. WEST LEG & EAST LEG - STOP BARS
BLOOMINGTON RD: 1. STOP AT SOUTH STOP BAR

| LOCATION #8: SPRINGFIELD AVE FROM MATTIS AVE TO WRIGHT STREET | | | | | | | | | | |
|---------------------------------------------------------------|-----------------------|-------|----------|--------|--------|--------------------------------|--------------------------------|---------------------------------|--------------------------------|-----------------------------------|
| PAY ITEM | DESCRIPTION | UNIT | QUANTITY | WHITE | YELLOW | LT/RT ARROW (15.6 SQ FT) | RAILROAD "R" (3.6 SQ FT) | RAILROAD "X" (54.0 SQ FT) | COMB. ARROW (26.0 SQ FT) | STRAIGHT ARROW (11.5 SQ FT) |
| 78011000 | GRV RCSD PM LTR & SYM | SQ FT | 0.00 | | | 0.00 | 0.00 | 0.00 | 0.00 | 0.00 |
| 78011025 | GRV RCSD PVT MRKG 5 | FOOT | 0.00 | 0.00 | 0.00 | | | | | |
| 78011035 | GRV RCSD PVT MRKG 7 | FOOT | 0.00 | 0.00 | 0.00 | | | | | |
| 78011045 | GRV RCSD PVT MRKG 9 | FOOT | 0.00 | 0.00 | 0.00 | | | | | |
| 78011065 | GRV RCSD PVT MRKG 13 | FOOT | 0.00 | 0.00 | 0.00 | | | | | |
| 78011125 | GRV RCSD PVT MRKG 25 | FOOT | 0.00 | 0.00 | 0.00 | | | | | |
| 78000100 | THPL PVT MK LTR & SYM | SQ FT | 0.00 | | | 0.00 | 0.00 | 0.00 | 0.00 | 0.00 |
| 78000200 | THPL PVT MK LINE 4 | FOOT | 0.00 | 0.00 | 0.00 | | | | | |
| 78000400 | THPL PVT MK LINE 6 | FOOT | 0.00 | 0.00 | 0.00 | | | | | |
| 78000500 | THPL PVT MK LINE 8 | FOOT | 0.00 | 0.00 | 0.00 | | | | | |
| 78000600 | THPL PVT MK LINE 12 | FOOT | 0.00 | 0.00 | 0.00 | | | | | |
| 78000650 | THPL PVT MK LINE 24 | FOOT | 0.00 | 0.00 | 0.00 | | | | | |
| 78008300 | POLYUREA PM T2 LTR SY | SQ FT | 0.00 | | | 0.00 | 0.00 | 0.00 | 0.00 | 0.00 |
| 78008310 | POLYUREA PM T2 LN 4 | FOOT | 0.00 | 0.00 | 0.00 | | | | | |
| 78008330 | POLYUREA PM T2 LN 6 | FOOT | 0.00 | 0.00 | 0.00 | | | | | |
| 78008350 | POLYUREA PM T2 LN 12 | FOOT | 0.00 | 0.00 | 0.00 | | | | | |
| 78008370 | POLYUREA PM T2 LN 24 | FOOT | 0.00 | 0.00 | 0.00 | | | | | |
| 78009000 | MOD URETH PM LTR-SYM | SQ FT | 0.00 | | | 0.00 | 0.00 | 0.00 | 0.00 | 0.00 |
| 78009004 | MOD URETH PM LINE 4 | FOOT | 0.00 | 0.00 | 0.00 | | | | | |
| 78009006 | MOD URETH PM LINE 6 | FOOT | 0.00 | 0.00 | 0.00 | | | | | |
| 78009012 | MOD URETH PM LINE 12 | FOOT | 920.00 | 260.00 | 660.00 | | | | | |
| 78009024 | MOD URETH PM LINE 24 | FOOT | 0.00 | 0.00 | 0.00 | | | | | |
| 78300201 | PAVMT MRKG REM GRIND | SQ FT | 0.00 | | | | | | | |
| 78300202 | PAVMT MRKG REM WTR BL | SQ FT | 0.00 | | | | | | | |

ENTIRE SECTION: 1. 12" DIAGONALS ONLY..NO GROOVING (REST OF STRIPING DONE SUMMER OF 2022)

MODEL: R:\MODELS\MEE... FILE NAME: ...

| | | |
|--------------------------------|------------------|-----------------|
| USER NAME = Tyler, Pierson | DESIGNED - _____ | REVISED - _____ |
| | DRAWN - _____ | REVISED - _____ |
| PLOT SCALE = 0.16666633' / in. | CHECKED - _____ | REVISED - _____ |
| PLOT DATE = 3/22/2023 | DATE - _____ | REVISED - _____ |

**STATE OF ILLINOIS
DEPARTMENT OF TRANSPORTATION**

SCHEDULE OF QUANTITIES

SCALE: SHEET 4 OF 7 SHEETS STA. ___+___ TO STA. ___+___

| F.A. RTE. | SECTION | COUNTY | TOTAL SHEETS | SHEET NO. |
|---------------------------|---------|-----------|--------------------|-----------|
| | * | CHAMPAIGN | 20 | 13 |
| | | | CONTRACT NO. 46619 | |
| ILLINOIS FED. AID PROJECT | | | | |

* D 5 HT PVMNT MRK RPR 23-26

SCHEDULES OF QUANTITIES

| LOCATION #9: LINCOLN AVE OVERHEAD @ I-74 | | | | | | | | | | |
|------------------------------------------|-----------------------|-------|----------|--------|--------|--------------------------------|--------------------------------|---------------------------------|--------------------------------|-----------------------------------|
| PAY ITEM | DESCRIPTION | UNIT | QUANTITY | WHITE | YELLOW | LT/RT ARROW (15.6 SQ FT) | RAILROAD "R" (3.6 SQ FT) | RAILROAD "X" (54.0 SQ FT) | COMB. ARROW (26.0 SQ FT) | STRAIGHT ARROW (11.5 SQ FT) |
| 78011000 | GRV RCSD PM LTR & SYM | SQ FT | 0.00 | | | 0.00 | 0.00 | 0.00 | 0.00 | 0.00 |
| 78011025 | GRV RCSD PVT MRKG 5 | FOOT | 640.00 | 180.00 | 460.00 | | | | | |
| 78011035 | GRV RCSD PVT MRKG 7 | FOOT | 0.00 | 0.00 | 0.00 | | | | | |
| 78011045 | GRV RCSD PVT MRKG 9 | FOOT | 0.00 | 0.00 | 0.00 | | | | | |
| 78011065 | GRV RCSD PVT MRKG 13 | FOOT | 0.00 | 0.00 | 0.00 | | | | | |
| 78011125 | GRV RCSD PVT MRKG 25 | FOOT | 0.00 | 0.00 | 0.00 | | | | | |
| 78000100 | THPL PVT MK LTR & SYM | SQ FT | 0.00 | | | 0.00 | 0.00 | 0.00 | 0.00 | 0.00 |
| 78000200 | THPL PVT MK LINE 4 | FOOT | 0.00 | 0.00 | 0.00 | | | | | |
| 78000400 | THPL PVT MK LINE 6 | FOOT | 0.00 | 0.00 | 0.00 | | | | | |
| 78000500 | THPL PVT MK LINE 8 | FOOT | 0.00 | 0.00 | 0.00 | | | | | |
| 78000600 | THPL PVT MK LINE 12 | FOOT | 0.00 | 0.00 | 0.00 | | | | | |
| 78000650 | THPL PVT MK LINE 24 | FOOT | 0.00 | 0.00 | 0.00 | | | | | |
| 78008300 | POLYUREA PM T2 LTR-SY | SQ FT | 0.00 | | | 0.00 | 0.00 | 0.00 | 0.00 | 0.00 |
| 78008310 | POLYUREA PM T2 LN 4 | FOOT | 640.00 | 180.00 | 460.00 | | | | | |
| 78008330 | POLYUREA PM T2 LN 6 | FOOT | 0.00 | 0.00 | 0.00 | | | | | |
| 78008350 | POLYUREA PM T2 LN 12 | FOOT | 0.00 | 0.00 | 0.00 | | | | | |
| 78008370 | POLYUREA PM T2 LN 24 | FOOT | 0.00 | 0.00 | 0.00 | | | | | |
| 78009000 | MOD URETH PM LTR-SYM | SQ FT | 0.00 | | | 0.00 | 0.00 | 0.00 | 0.00 | 0.00 |
| 78009004 | MOD URETH PM LINE 4 | FOOT | 0.00 | 0.00 | 0.00 | | | | | |
| 78009006 | MOD URETH PM LINE 6 | FOOT | 0.00 | 0.00 | 0.00 | | | | | |
| 78009012 | MOD URETH PM LINE 12 | FOOT | 0.00 | 0.00 | 0.00 | | | | | |
| 78009024 | MOD URETH PM LINE 24 | FOOT | 0.00 | 0.00 | 0.00 | | | | | |
| 78300201 | PAVMT MRKG REM GRIND | SQ FT | 0.00 | | | | | | | |
| 78300202 | PAVMT MRKG REM WTR BL | SQ FT | 0.00 | | | | | | | |

BRIDGE DECK AND CONCRETE APPROACH ONLY

| LOCATION #10: US 150 (UNIVERSITY AVE) FROM PAVEMENT CHANGE EAST OF US 45 (CUNNINGHAM AVE) TO PAVEMENT CHANGE WEST OF IL 130 (HIGH CROSS RD) | | | | | | | | | | |
|---------------------------------------------------------------------------------------------------------------------------------------------|-----------------------|-------|-----------|----------|-----------|--------------------------------|--------------------------------|---------------------------------|--------------------------------|-----------------------------------|
| PAY ITEM | DESCRIPTION | UNIT | QUANTITY | WHITE | YELLOW | LT/RT ARROW (15.6 SQ FT) | RAILROAD "R" (3.6 SQ FT) | RAILROAD "X" (54.0 SQ FT) | COMB. ARROW (26.0 SQ FT) | STRAIGHT ARROW (11.5 SQ FT) |
| 78011000 | GRV RCSD PM LTR & SYM | SQ FT | 0.00 | | | 0.00 | 0.00 | 0.00 | 0.00 | 0.00 |
| 78011025 | GRV RCSD PVT MRKG 5 | FOOT | 0.00 | 0.00 | 0.00 | | | | | |
| 78011035 | GRV RCSD PVT MRKG 7 | FOOT | 0.00 | 0.00 | 0.00 | | | | | |
| 78011045 | GRV RCSD PVT MRKG 9 | FOOT | 0.00 | 0.00 | 0.00 | | | | | |
| 78011065 | GRV RCSD PVT MRKG 13 | FOOT | 0.00 | 0.00 | 0.00 | | | | | |
| 78011125 | GRV RCSD PVT MRKG 25 | FOOT | 0.00 | 0.00 | 0.00 | | | | | |
| 78000100 | THPL PVT MK LTR & SYM | SQ FT | 0.00 | | | 0.00 | 0.00 | 0.00 | 0.00 | 0.00 |
| 78000200 | THPL PVT MK LINE 4 | FOOT | 0.00 | 0.00 | 0.00 | | | | | |
| 78000400 | THPL PVT MK LINE 6 | FOOT | 0.00 | 0.00 | 0.00 | | | | | |
| 78000500 | THPL PVT MK LINE 8 | FOOT | 0.00 | 0.00 | 0.00 | | | | | |
| 78000600 | THPL PVT MK LINE 12 | FOOT | 0.00 | 0.00 | 0.00 | | | | | |
| 78000650 | THPL PVT MK LINE 24 | FOOT | 0.00 | 0.00 | 0.00 | | | | | |
| 78008300 | POLYUREA PM T2 LTR-SY | SQ FT | 0.00 | | | 0.00 | 0.00 | 0.00 | 0.00 | 0.00 |
| 78008310 | POLYUREA PM T2 LN 4 | FOOT | 0.00 | 0.00 | 0.00 | | | | | |
| 78008330 | POLYUREA PM T2 LN 6 | FOOT | 0.00 | 0.00 | 0.00 | | | | | |
| 78008350 | POLYUREA PM T2 LN 12 | FOOT | 0.00 | 0.00 | 0.00 | | | | | |
| 78008370 | POLYUREA PM T2 LN 24 | FOOT | 0.00 | 0.00 | 0.00 | | | | | |
| 78009000 | MOD URETH PM LTR-SYM | SQ FT | 1,342.00 | | | 81.00 | 0.00 | 0.00 | 3.00 | 0.00 |
| 78009004 | MOD URETH PM LINE 4 | FOOT | 32,400.00 | 8,000.00 | 24,400.00 | | | | | |
| 78009006 | MOD URETH PM LINE 6 | FOOT | 450.00 | 450.00 | 0.00 | | | | | |
| 78009012 | MOD URETH PM LINE 12 | FOOT | 700.00 | 230.00 | 470.00 | | | | | |
| 78009024 | MOD URETH PM LINE 24 | FOOT | 310.00 | 310.00 | 0.00 | | | | | |
| 78300201 | PAVMT MRKG REM GRIND | SQ FT | 0.00 | | | | | | | |
| 78300202 | PAVMT MRKG REM WTR BL | SQ FT | 0.00 | | | | | | | |

ENTIRE SECTION: 1. NO GROOVING 2. NO CROSS WALKS | GUARDIAN DR: 1. NORTH LEG - STOP BAR & ISLAND ONLY 2. EAST LEG - STOP BAR ONLY
SMITH RD: 1. SOUTH LEG - STOP BAR & ISLAND ONLY 2. NORTH LEG - STOP BAR ONLY

MODEL: \\MODEL\M1E2
FILE NAME: \\P1001\Documents\DOT Office\District 5\ORD Project\05466\CADData\CADSheet\05466-04-Sch-Schedule.dgn

| | | |
|--------------------------------|------------------|-----------------|
| USER NAME = Tyler, Pierson | DESIGNED - _____ | REVISED - _____ |
| | DRAWN - _____ | REVISED - _____ |
| PLOT SCALE = 0.16666633' / in. | CHECKED - _____ | REVISED - _____ |
| PLOT DATE = 3/22/2023 | DATE - _____ | REVISED - _____ |

**STATE OF ILLINOIS
DEPARTMENT OF TRANSPORTATION**

SCHEDULE OF QUANTITIES

SCALE: SHEET 5 OF 7 SHEETS STA. ___+___ TO STA. ___+___

| F.A. RTE. | SECTION | COUNTY | TOTAL SHEETS | SHEET NO. |
|--------------------|---------|-----------|--------------|-----------|
| | * | CHAMPAIGN | 20 | 14 |
| CONTRACT NO. 46619 | | | | |

ILLINOIS FED. AID PROJECT

* D 5 HT PVMNT MRK RPR 23-26

SCHEDULES OF QUANTITIES

| LOCATION #11: US 150 FROM PAVEMENT CHANGE WEST OF HIGH CROSS RD TO PAVEMENT CHANGE EAST OF HIGH CROSS RD | | | | | | | | | | |
|----------------------------------------------------------------------------------------------------------|-----------------------|-------|----------|----------|----------|--------------------------------|--------------------------------|---------------------------------|--------------------------------|-----------------------------------|
| PAY ITEM | DESCRIPTION | UNIT | QUANTITY | WHITE | YELLOW | LT/RT ARROW (15.6 SQ FT) | RAILROAD "R" (3.6 SQ FT) | RAILROAD "X" (54.0 SQ FT) | COMB. ARROW (26.0 SQ FT) | STRAIGHT ARROW (11.5 SQ FT) |
| 78011000 | GRV RCSD PM LTR & SYM | SQ FT | 541.00 | | | 28.00 | 0.00 | 0.00 | 4.00 | 0.00 |
| 78011025 | GRV RCSD PVT MRKG 5 | FOOT | 8,350.00 | 3,350.00 | 5,000.00 | | | | | |
| 78011035 | GRV RCSD PVT MRKG 7 | FOOT | 0.00 | 0.00 | 0.00 | | | | | |
| 78011045 | GRV RCSD PVT MRKG 9 | FOOT | 0.00 | 0.00 | 0.00 | | | | | |
| 78011065 | GRV RCSD PVT MRKG 13 | FOOT | 0.00 | 0.00 | 0.00 | | | | | |
| 78011125 | GRV RCSD PVT MRKG 25 | FOOT | 155.00 | 155.00 | 0.00 | | | | | |
| 78000100 | THPL PVT MK LTR & SYM | SQ FT | 541.00 | | | 28.00 | 0.00 | 0.00 | 4.00 | 0.00 |
| 78000200 | THPL PVT MK LINE 4 | FOOT | 8,350.00 | 3,350.00 | 5,000.00 | | | | | |
| 78000400 | THPL PVT MK LINE 6 | FOOT | 0.00 | 0.00 | 0.00 | | | | | |
| 78000500 | THPL PVT MK LINE 8 | FOOT | 0.00 | 0.00 | 0.00 | | | | | |
| 78000600 | THPL PVT MK LINE 12 | FOOT | 0.00 | 0.00 | 0.00 | | | | | |
| 78000650 | THPL PVT MK LINE 24 | FOOT | 155.00 | 155.00 | 0.00 | | | | | |
| 78008300 | POLYUREA PM T2 LTR-SY | SQ FT | 0.00 | | | 0.00 | 0.00 | 0.00 | 0.00 | 0.00 |
| 78008310 | POLYUREA PM T2 LN 4 | FOOT | 0.00 | 0.00 | 0.00 | | | | | |
| 78008330 | POLYUREA PM T2 LN 6 | FOOT | 0.00 | 0.00 | 0.00 | | | | | |
| 78008350 | POLYUREA PM T2 LN 12 | FOOT | 0.00 | 0.00 | 0.00 | | | | | |
| 78008370 | POLYUREA PM T2 LN 24 | FOOT | 0.00 | 0.00 | 0.00 | | | | | |
| 78009000 | MOD URETH PM LTR-SYM | SQ FT | 0.00 | | | 0.00 | 0.00 | 0.00 | 0.00 | 0.00 |
| 78009004 | MOD URETH PM LINE 4 | FOOT | 0.00 | 0.00 | 0.00 | | | | | |
| 78009006 | MOD URETH PM LINE 6 | FOOT | 0.00 | 0.00 | 0.00 | | | | | |
| 78009012 | MOD URETH PM LINE 12 | FOOT | 0.00 | 0.00 | 0.00 | | | | | |
| 78009024 | MOD URETH PM LINE 24 | FOOT | 0.00 | 0.00 | 0.00 | | | | | |
| 78300201 | PAVMT MRKG REM GRIND | SQ FT | 0.00 | | | | | | | |
| 78300202 | PAVMT MRKG REM WTR BL | SQ FT | 0.00 | | | | | | | |

HIGH CROSS RD: 1. NO CROSS WALKS 2. NORTH LEG - STOP BAR ONLY 3. SOUTH LEG NO WORK (WILL BE DONE WITH THE NEXT LOCATION) 4. DO ALL LANE EXTENSION LINES

| LOCATION #12: IL 130 FROM SOUTH STOP BAR AT HIGH CROSS RD TO PAVEMENT CHANGE 0.77 NORTH OF WINDSOR RD | | | | | | | | | | |
|-------------------------------------------------------------------------------------------------------|-----------------------|-------|-----------|-----------|----------|--------------------------------|--------------------------------|---------------------------------|--------------------------------|-----------------------------------|
| PAY ITEM | DESCRIPTION | UNIT | QUANTITY | WHITE | YELLOW | LT/RT ARROW (15.6 SQ FT) | RAILROAD "R" (3.6 SQ FT) | RAILROAD "X" (54.0 SQ FT) | COMB. ARROW (26.0 SQ FT) | STRAIGHT ARROW (11.5 SQ FT) |
| 78011000 | GRV RCSD PM LTR & SYM | SQ FT | 1,342.00 | | | 86.00 | 0.00 | 0.00 | 0.00 | 0.00 |
| 78011025 | GRV RCSD PVT MRKG 5 | FOOT | 45.00 | 45.00 | 0.00 | | | | | |
| 78011035 | GRV RCSD PVT MRKG 7 | FOOT | 0.00 | 0.00 | 0.00 | | | | | |
| 78011045 | GRV RCSD PVT MRKG 9 | FOOT | 0.00 | 0.00 | 0.00 | | | | | |
| 78011065 | GRV RCSD PVT MRKG 13 | FOOT | 0.00 | 0.00 | 0.00 | | | | | |
| 78011125 | GRV RCSD PVT MRKG 25 | FOOT | 335.00 | 335.00 | 0.00 | | | | | |
| 78000100 | THPL PVT MK LTR & SYM | SQ FT | 1,342.00 | | | 86.00 | 0.00 | 0.00 | 0.00 | 0.00 |
| 78000200 | THPL PVT MK LINE 4 | FOOT | 45.00 | 45.00 | 0.00 | | | | | |
| 78000400 | THPL PVT MK LINE 6 | FOOT | 0.00 | 0.00 | 0.00 | | | | | |
| 78000500 | THPL PVT MK LINE 8 | FOOT | 0.00 | 0.00 | 0.00 | | | | | |
| 78000600 | THPL PVT MK LINE 12 | FOOT | 0.00 | 0.00 | 0.00 | | | | | |
| 78000650 | THPL PVT MK LINE 24 | FOOT | 305.00 | 305.00 | 0.00 | | | | | |
| 78008300 | POLYUREA PM T2 LTR-SY | SQ FT | 0.00 | | | 0.00 | 0.00 | 0.00 | 0.00 | 0.00 |
| 78008310 | POLYUREA PM T2 LN 4 | FOOT | 19,500.00 | 13,900.00 | 5,600.00 | | | | | |
| 78008330 | POLYUREA PM T2 LN 6 | FOOT | 360.00 | 360.00 | 0.00 | | | | | |
| 78008350 | POLYUREA PM T2 LN 12 | FOOT | 2,000.00 | 1,940.00 | 60.00 | | | | | |
| 78008370 | POLYUREA PM T2 LN 24 | FOOT | 30.00 | 30.00 | 0.00 | | | | | |
| 78009000 | MOD URETH PM LTR-SYM | SQ FT | 0.00 | | | 0.00 | 0.00 | 0.00 | 0.00 | 0.00 |
| 78009004 | MOD URETH PM LINE 4 | FOOT | 0.00 | 0.00 | 0.00 | | | | | |
| 78009006 | MOD URETH PM LINE 6 | FOOT | 0.00 | 0.00 | 0.00 | | | | | |
| 78009012 | MOD URETH PM LINE 12 | FOOT | 0.00 | 0.00 | 0.00 | | | | | |
| 78009024 | MOD URETH PM LINE 24 | FOOT | 0.00 | 0.00 | 0.00 | | | | | |
| 78300201 | PAVMT MRKG REM GRIND | SQ FT | 0.00 | | | | | | | |
| 78300202 | PAVMT MRKG REM WTR BL | SQ FT | 0.00 | | | | | | | |

ENTIRE SECTION: 1. NO CROSS WALKS 2. GROOVE IN ARROWS (THERMO), LANE EXTENSION LINES @ TATMAN DR (THERMO), & STOP BARS (THERMO/POLY) 3. RECAP THE REST OF THE JOB WITH POLY (NO GROOVING) DUE TO EXISTING ROUTE AND SEAL
 HIGH CROSS RD: 1. NORTH, WEST, AND EAST LEGS DONE ON LOCATION #11 | WALMART ENTRANCE: 1. STOP BAR, ISLAND, & DIAGONALS
 TATMAN DR: 1. WEST LEG - STOP BAR (POLY) 2. EAST LEG - STOP BAR (THERMO)
 WASHINGTON ST: 1. WEST LEG - STOP BAR 2. EAST LEG - STOP BAR 3. NO BIKE PATH

MODEL: \\MODELS\MEE... FILE NAME: ...

| | | |
|--------------------------------|------------------|-----------------|
| USER NAME = Tyler, Pierson | DESIGNED - _____ | REVISED - _____ |
| | DRAWN - _____ | REVISED - _____ |
| PLOT SCALE = 0.16666633' / in. | CHECKED - _____ | REVISED - _____ |
| PLOT DATE = 3/22/2023 | DATE - _____ | REVISED - _____ |

**STATE OF ILLINOIS
DEPARTMENT OF TRANSPORTATION**

SCHEDULE OF QUANTITIES

SCALE: SHEET 6 OF 7 SHEETS STA. ___+___ TO STA. ___+___

| F.A. RTE. | SECTION | COUNTY | TOTAL SHEETS | SHEET NO. |
|---------------------------|---------|-----------|--------------|-----------|
| | * | CHAMPAIGN | 20 | 15 |
| CONTRACT NO. 46619 | | | | |
| ILLINOIS FED. AID PROJECT | | | | |

* D 5 HT PVMNT MRK RPR 23-26

SCHEDULES OF QUANTITIES

| LOCATION #13: IL 130 FROM PAVEMENT CHANGE 0.77 NORTH OF WINDSOR RD TO END OF ISLAND SOUTH OF WINDSOR RD | | | | | | | | | | |
|---------------------------------------------------------------------------------------------------------|-----------------------|-------|-----------|-----------|-----------|--------------------------------|--------------------------------|---------------------------------|--------------------------------|-----------------------------------|
| PAY ITEM | DESCRIPTION | UNIT | QUANTITY | WHITE | YELLOW | LT/RT ARROW (15.6 SQ FT) | RAILROAD "R" (3.6 SQ FT) | RAILROAD "X" (54.0 SQ FT) | COMB. ARROW (26.0 SQ FT) | STRAIGHT ARROW (11.5 SQ FT) |
| 78011000 | GRV RCSD PM LTR & SYM | SQ FT | 328.00 | | | 21.00 | 0.00 | 0.00 | 0.00 | 0.00 |
| 78011025 | GRV RCSD PVT MRKG 5 | FOOT | 22,700.00 | 11,100.00 | 11,600.00 | | | | | |
| 78011035 | GRV RCSD PVT MRKG 7 | FOOT | 270.00 | 270.00 | 0.00 | | | | | |
| 78011045 | GRV RCSD PVT MRKG 9 | FOOT | 0.00 | 0.00 | 0.00 | | | | | |
| 78011065 | GRV RCSD PVT MRKG 13 | FOOT | 800.00 | 180.00 | 620.00 | | | | | |
| 78011125 | GRV RCSD PVT MRKG 25 | FOOT | 180.00 | 180.00 | 0.00 | | | | | |
| 78000100 | THPL PVT MK LTR & SYM | SQ FT | 328.00 | | | 21.00 | 0.00 | 0.00 | 0.00 | 0.00 |
| 78000200 | THPL PVT MK LINE 4 | FOOT | 22,700.00 | 11,100.00 | 11,600.00 | | | | | |
| 78000400 | THPL PVT MK LINE 6 | FOOT | 270.00 | 270.00 | 0.00 | | | | | |
| 78000500 | THPL PVT MK LINE 8 | FOOT | 0.00 | 0.00 | 0.00 | | | | | |
| 78000600 | THPL PVT MK LINE 12 | FOOT | 800.00 | 180.00 | 620.00 | | | | | |
| 78000650 | THPL PVT MK LINE 24 | FOOT | 180.00 | 180.00 | 0.00 | | | | | |
| 78008300 | POLYUREA PM T2 LTR-SY | SQ FT | 0.00 | | | 0.00 | 0.00 | 0.00 | 0.00 | 0.00 |
| 78008310 | POLYUREA PM T2 LN 4 | FOOT | 0.00 | 0.00 | 0.00 | | | | | |
| 78008330 | POLYUREA PM T2 LN 6 | FOOT | 0.00 | 0.00 | 0.00 | | | | | |
| 78008350 | POLYUREA PM T2 LN 12 | FOOT | 0.00 | 0.00 | 0.00 | | | | | |
| 78008370 | POLYUREA PM T2 LN 24 | FOOT | 0.00 | 0.00 | 0.00 | | | | | |
| 78009000 | MOD URETH PM LTR-SYM | SQ FT | 0.00 | | | 0.00 | 0.00 | 0.00 | 0.00 | 0.00 |
| 78009004 | MOD URETH PM LINE 4 | FOOT | 0.00 | 0.00 | 0.00 | | | | | |
| 78009006 | MOD URETH PM LINE 6 | FOOT | 0.00 | 0.00 | 0.00 | | | | | |
| 78009012 | MOD URETH PM LINE 12 | FOOT | 0.00 | 0.00 | 0.00 | | | | | |
| 78009024 | MOD URETH PM LINE 24 | FOOT | 0.00 | 0.00 | 0.00 | | | | | |
| 78300201 | PAVMT MRKG REM GRIND | SQ FT | 0.00 | | | | | | | |
| 78300202 | PAVMT MRKG REM WTR BL | SQ FT | 0.00 | | | | | | | |

WINDSOR RD: 1. WEST LEG - STOP BARS, ISLAND, AND DIAGONALS 2. EAST LEG - ALL MARKINGS TO PAVEMENT CHANGE

| ON CALL LOCATIONS | | | | | | | | | | | | |
|-------------------|-----------------------|-------|-------------------|-------------------|-------------------|-----------|-----------|--------------------------------|--------------------------------|---------------------------------|--------------------------------|-----------------------------------|
| PAY ITEM | DESCRIPTION | UNIT | TOTAL QUANTITY | RURAL QUANTITY | URBAN QUANTITY | WHITE | YELLOW | LT/RT ARROW (15.6 SQ FT) | RAILROAD "R" (3.6 SQ FT) | RAILROAD "X" (54.0 SQ FT) | COMB. ARROW (26.0 SQ FT) | STRAIGHT ARROW (11.5 SQ FT) |
| 78011000 | GRV RCSD PM LTR & SYM | SQ FT | 1,259.00 | 1,133.00 | 126.00 | | | 69.00 | 3.00 | 2.00 | 2.00 | 1.00 |
| 78011025 | GRV RCSD PVT MRKG 5 | FOOT | 31,855.00 | 28,669.00 | 3,186.00 | 13,939.50 | 17,914.00 | | | | | |
| 78011035 | GRV RCSD PVT MRKG 7 | FOOT | 234.00 | 210.00 | 24.00 | 232.50 | 0.00 | | | | | |
| 78011045 | GRV RCSD PVT MRKG 9 | FOOT | 1,000.00 | 900.00 | 100.00 | 500.00 | 500.00 | | | | | |
| 78011065 | GRV RCSD PVT MRKG 13 | FOOT | 893.00 | 803.00 | 90.00 | 342.50 | 549.50 | | | | | |
| 78011125 | GRV RCSD PVT MRKG 25 | FOOT | 425.00 | 382.00 | 43.00 | 424.00 | 0.00 | | | | | |
| 78000100 | THPL PVT MK LTR & SYM | SQ FT | 783.00 | 704.00 | 79.00 | | | 44.00 | 1.00 | 1.00 | 1.00 | 1.00 |
| 78000200 | THPL PVT MK LINE 4 | FOOT | 20,010.00 | 18,729.00 | 2,081.00 | 9,334.50 | 11,475.00 | | | | | |
| 78000400 | THPL PVT MK LINE 6 | FOOT | 73.00 | 65.00 | 8.00 | 72.00 | 0.00 | | | | | |
| 78000500 | THPL PVT MK LINE 8 | FOOT | 1,000.00 | 900.00 | 100.00 | 500.00 | 500.00 | | | | | |
| 78000600 | THPL PVT MK LINE 12 | FOOT | 416.00 | 374.00 | 42.00 | 43.00 | 372.00 | | | | | |
| 78000650 | THPL PVT MK LINE 24 | FOOT | 189.00 | 170.00 | 19.00 | 188.00 | 0.00 | | | | | |
| 78008300 | POLYUREA PM T2 LTR-SY | SQ FT | 17.00 | 15.00 | 2.00 | | | 1.00 | 0.00 | 0.00 | 0.00 | 0.00 |
| 78008310 | POLYUREA PM T2 LN 4 | FOOT | 2,118.00 | 1,906.00 | 212.00 | 1,449.00 | 668.00 | | | | | |
| 78008330 | POLYUREA PM T2 LN 6 | FOOT | 52.00 | 46.00 | 6.00 | 51.00 | 0.00 | | | | | |
| 78008350 | POLYUREA PM T2 LN 12 | FOOT | 208.00 | 187.00 | 21.00 | 201.50 | 6.00 | | | | | |
| 78008370 | POLYUREA PM T2 LN 24 | FOOT | 22.00 | 19.00 | 3.00 | 21.00 | 0.00 | | | | | |
| 78009000 | MOD URETH PM LTR-SYM | SQ FT | 463.00 | 416.00 | 47.00 | | | 24.00 | 2.00 | 1.00 | 1.00 | 0.00 |
| 78009004 | MOD URETH PM LINE 4 | FOOT | 8,928.00 | 8,035.00 | 893.00 | 3,156.00 | 5,771.00 | | | | | |
| 78009006 | MOD URETH PM LINE 6 | FOOT | 110.00 | 99.00 | 11.00 | 109.50 | 0.00 | | | | | |
| 78009012 | MOD URETH PM LINE 12 | FOOT | 270.00 | 243.00 | 27.00 | 98.00 | 171.50 | | | | | |
| 78009024 | MOD URETH PM LINE 24 | FOOT | 216.00 | 194.00 | 22.00 | 215.00 | 0.00 | | | | | |
| 78300201 | PAVMT MRKG REM GRIND | SQ FT | 1,000.00 | 900.00 | 100.00 | 500.00 | 500.00 | | | | | |
| 78300202 | PAVMT MRKG REM WTR BL | SQ FT | 1,000.00 | 900.00 | 100.00 | 500.00 | 500.00 | | | | | |

MODEL: R:\MODEL\M1E2... FILE NAME: ...

| | | |
|--------------------------------|------------------|-----------------|
| USER NAME = Tyler, Pierson | DESIGNED - _____ | REVISED - _____ |
| DRAWN - _____ | REVISION - _____ | |
| PLOT SCALE = 0.16666633' / in. | CHECKED - _____ | REVISED - _____ |
| PLOT DATE = 3/22/2023 | DATE - _____ | REVISED - _____ |

**STATE OF ILLINOIS
DEPARTMENT OF TRANSPORTATION**

SCHEDULE OF QUANTITIES

SCALE: SHEET 7 OF 7 SHEETS STA. ___+___ TO STA. ___+___

| | | | | |
|---------------------------|---------|-----------|--------------------|-----------|
| F.A. RTE. | SECTION | COUNTY | TOTAL SHEETS | SHEET NO. |
| VAR. | * | CHAMPAIGN | 20 | 16 |
| | | | CONTRACT NO. 46619 | |
| ILLINOIS FED. AID PROJECT | | | | |

* D 5 HT PVMNT MRK RPR 23-26

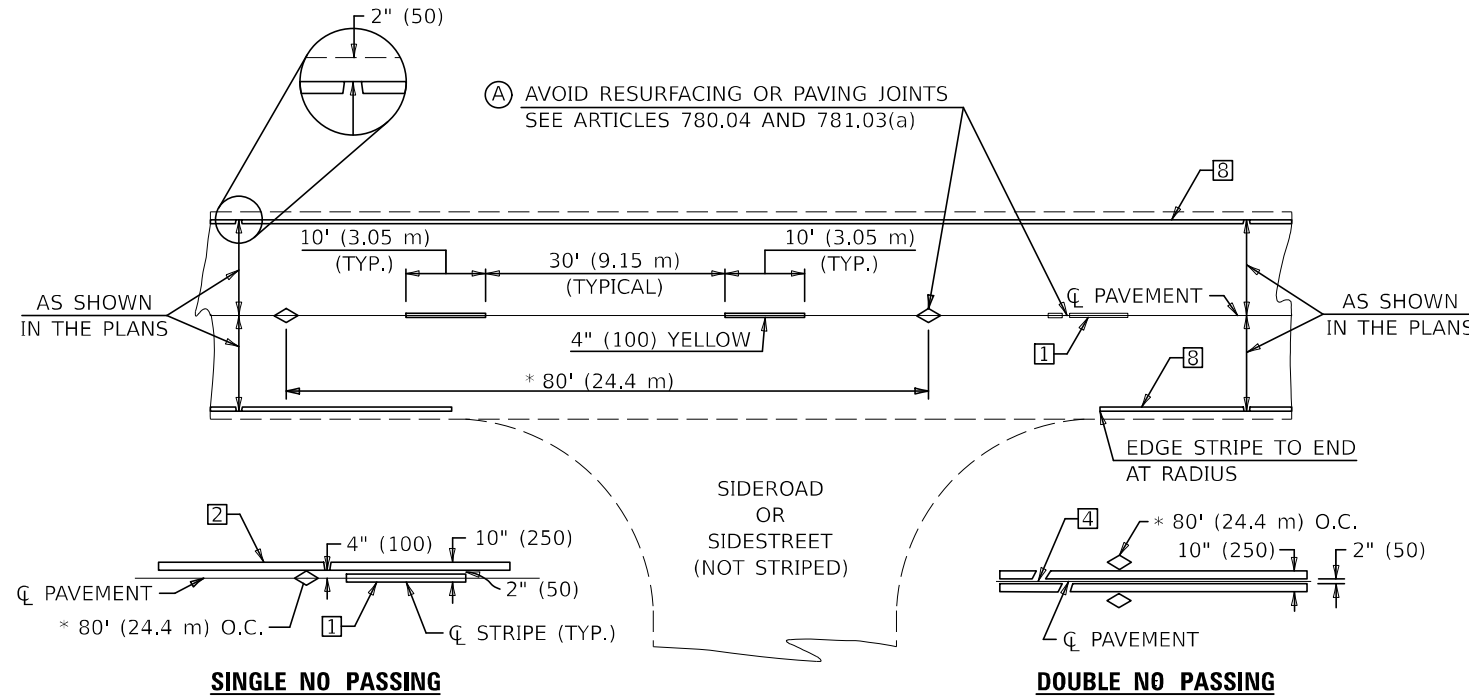

* REDUCE TO 40' (12.2 m) O.C. ON CURVES WITH POSTED OR ADVISORY SPEEDS OF 45 mph (70 km/h) OR LESS.

TWO LANE/TWO WAY

TYPICAL PAVEMENT MARKING LEGEND

- 1 4" (100) SKIP-DASH (YELLOW)
- 2 4" (100) SOLID (YELLOW)
- 3 12" (300) DIAGONAL (YELLOW)
- 4 4" (100) DOUBLE YELLOW (NARROW)
- 5 RESERVED
- 6 RESERVED
- 7 4" (100) SKIP-DASH (WHITE)
- 8 4" (100) SOLID (WHITE)
- 9 12" (300) DIAGONAL (WHITE)
- 10 6" (150) SOLID (WHITE)
- 11 24" (600) STOP BAR (WHITE)
- 12 8" (200) SOLID (WHITE)
- 13 4" (100) LANE LINE EXTENSIONS (WHITE)
- 14 4" (100) PARKING WHITE

TYPICAL PAVEMENT MARKERS LEGEND

- ◇ TWO-WAY AMBER MARKER
- ▷ ONE-WAY AMBER MARKER
- ▷ ONE-WAY CRYSTAL MARKER

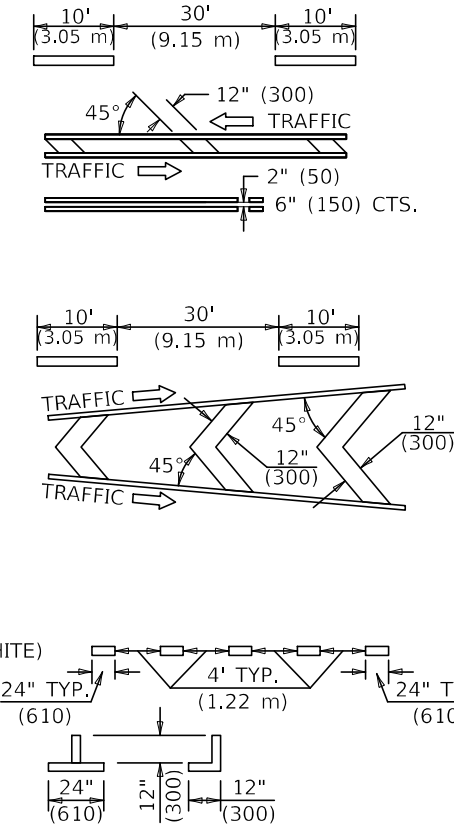

RURAL LEFT TURN

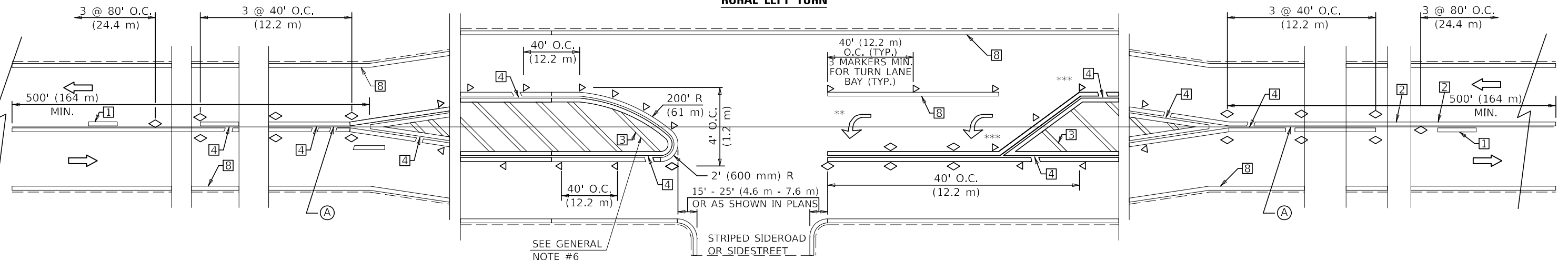

*** REDUCE SPACING IF NECESSARY TO ASSURE MARKERS AT CORNER POINTS.
 ** TURN ARROWS SHALL BE PLACED AS SHOWN ON SHEET #2.

Note: All dimensions are in INCHES (millimeters) unless otherwise shown.

DISTRICT 5 DETAIL NO. 7800AAAA

| | | |
|--------------------------------|------------|----------|
| USER NAME = Tyler, Pierson | DESIGNED - | REVISD - |
| PLOT SCALE = 0.16666833" / in. | DRAWN - | REVISD - |
| PLOT DATE = 3/22/2023 | CHECKED - | REVISD - |
| | DATE - | REVISD - |

**STATE OF ILLINOIS
DEPARTMENT OF TRANSPORTATION**

**PAVEMENT MARKING AND MARKERS
(RURAL & URBAN APPLICATIONS)**

SCALE: N.T.S. SHEET 1 OF 4 SHEETS STA. ____+__ TO STA. ____+__

| F.A. RTE. | SECTION | COUNTY | TOTAL SHEETS | SHEET NO. |
|--------------------|---------|-----------|--------------|-----------|
| | * | CHAMPAIGN | 20 | 17 |
| CONTRACT NO. 46619 | | | | |

ILLINOIS FED. AID PROJECT
 * D 5 HT PVMNT MRK RPR 23-26

MODEL: R:\MODELS\MRES...
 FILE NAME: P:\PMDOT\Documents\DOT Office\District 5\ORD Project\05466\CADD\05466\05466-04-H-02-Detail-5-Detail.dgn

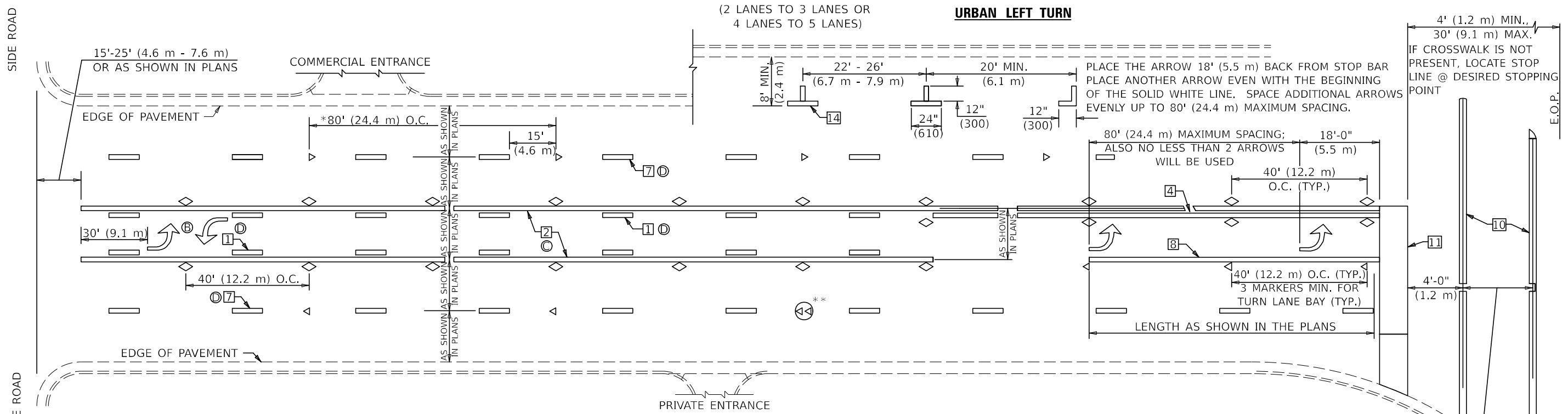

* REDUCE TO 40 FEET (12.2 METERS) ON CENTER ON CURVES WHERE ADVISORY SPEEDS ARE 10 MPH (15 km/h) LOWER THAN POSTED SPEEDS.

** DOUBLE LANE LINE MARKERS SHALL BE SPECIFIED AND SPACED AS SHOWN IN HIGHWAY STANDARD 781001 FOR MULTI-LANE DIVIDED AND UNDIVIDED HIGHWAYS.

GENERAL NOTES:

- ⓑ TURN ARROW PAIRS SHALL BE PLACED AT 250' (75 m) INTERVALS AND SHALL BE EVENLY SPACED BETWEEN BOTH ENDS OF THE BIDIRECTIONAL LEFT TURN LANE.
- ⓒ THE SOLID YELLOW PAVEMENT MARKINGS ② SHOULD GENERALLY START OR END NEAR THE RADIUS POINT OF EACH STREET RETURN EXCEPT WHERE ONE OR BOTH ENDS WOULD INCLUDE STOP BARS.
- ⓓ THE SKIP-DASH PAVEMENT MARKINGS ① OR ⑦ SHOULD BE CENTERED BETWEEN BOTH ENDS OF EACH CITY BLOCK AND SHALL BE PLACED SO THEY LINE UP ACROSS FROM EACH OTHER. SEE EXAMPLE ON SHEET 2 OF 3.
- ⓔ USE LARGE ARROW SIZE FOR BOTH RURAL AND URBAN LOCATIONS. (SEE LAST PAGE OF SECTION 780x FOR SYMBOLS TABLE)

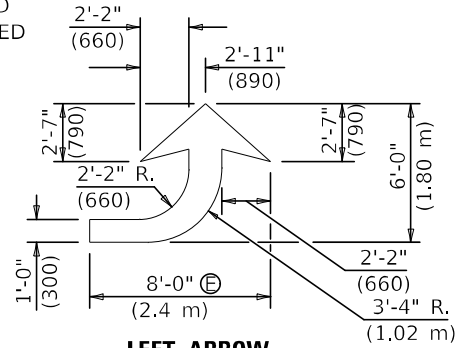

LEFT ARROW
REVERSE FOR RIGHT ARROW
AREA = 15.6 SQ. FT. (1.47 m²)
(WHITE)

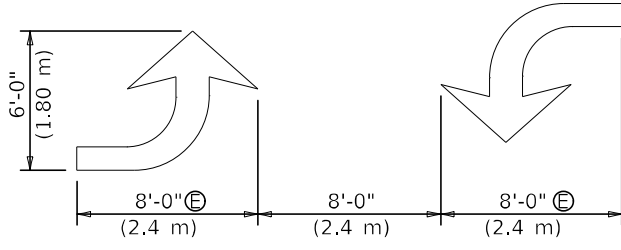

TYPICAL DOUBLE TURN ARROWS (WHITE)

BLOOMINGTON-NORMAL CITY LIMITS ONLY

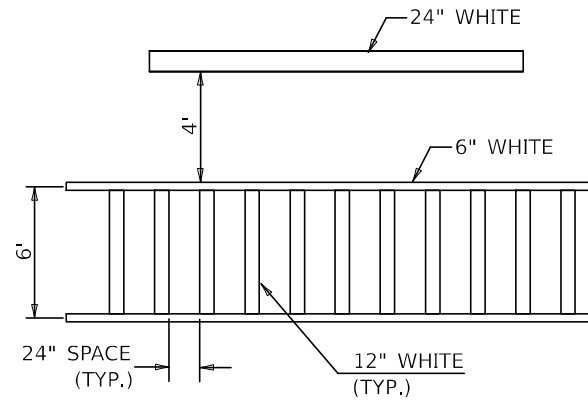

TYPICAL SPACING FOR CROSSWALKS & STOP BARS

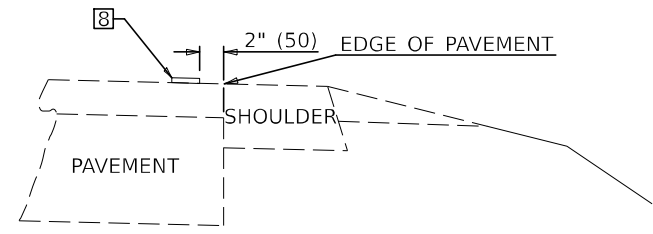

RELATIONSHIP OF EDGE LINE TO EDGE OF PAVEMENT
(SAFETY SHOULDER OR PAVED SURFACE)
SEE ARTICLE 780.04

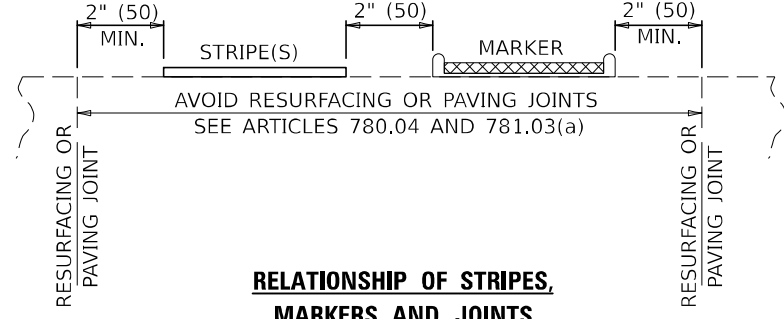

RELATIONSHIP OF STRIPES, MARKERS AND JOINTS

Note: All dimensions are in INCHES (millimeters) unless otherwise shown.

MODEL: \\MODELS\MJES... FILE NAME: ...

| | | |
|-------------------------------|------------|-----------|
| USER NAME = Tyler, Pierson | DESIGNED - | REVISED - |
| DRAWN - | REVISED - | |
| PLOT SCALE = 0.16666633 / in. | CHECKED - | REVISED - |
| PLOT DATE = 3/22/2023 | DATE - | REVISED - |

**STATE OF ILLINOIS
DEPARTMENT OF TRANSPORTATION**

**PAVEMENT MARKING AND MARKERS
(RURAL & URBAN APPLICATIONS)**

SCALE: N.T.S. SHEET 2 OF 4 SHEETS STA. ___+___ TO STA. ___+___

| | | | | |
|--------------------------------------|---------|-----------|--------------|-----------|
| DISTRICT 5 DETAIL NO. 7800AAA | | | | |
| F.A. RTE. | SECTION | COUNTY | TOTAL SHEETS | SHEET NO. |
| VAR. | * | CHAMPAIGN | 20 | 18 |
| CONTRACT NO. 46619 | | | | |
| ILLINOIS FED. AID PROJECT | | | | |

* D 5 HT PVMNT MRK RPR 23-26

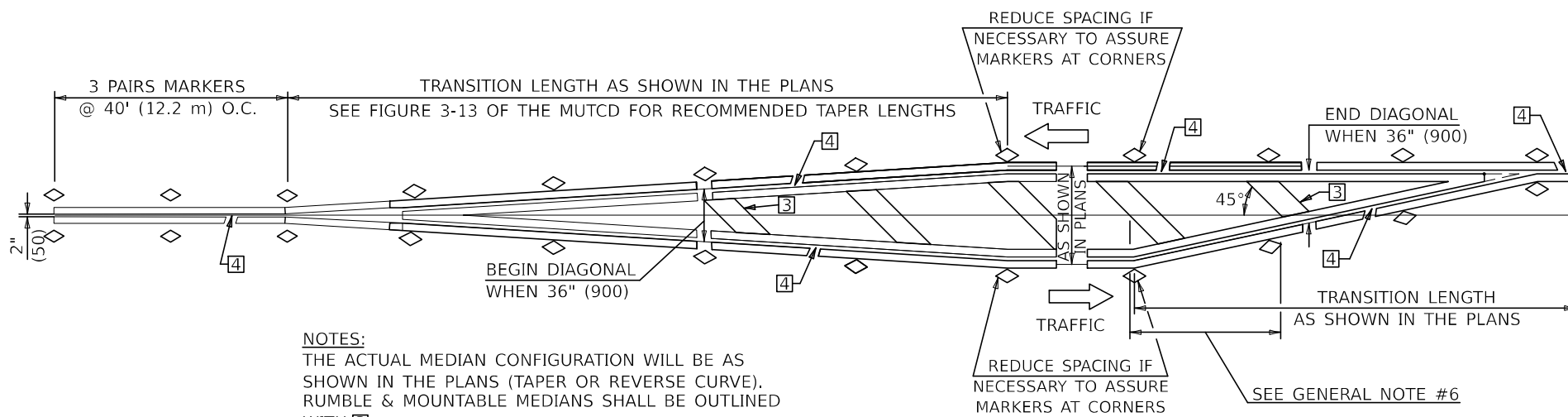

NOTES:
 THE ACTUAL MEDIAN CONFIGURATION WILL BE AS SHOWN IN THE PLANS (TAPER OR REVERSE CURVE). RUMBLE & MOUNTABLE MEDIANS SHALL BE OUTLINED WITH [2].

TYPICAL MEDIAN TRANSITIONS

GENERAL NOTES

1. WHEN MEDIANS ARE PRESENT, PAVEMENT MARKINGS ARE TO BE PLACED ADJACENT TO MEDIANS.
2. SOME OF THE INFORMATION INCLUDED WITH THIS DETAIL MAY NOT BE APPLICABLE TO THIS IMPROVEMENT.
3. PAVEMENT MARKINGS ARE TO BE EXTENDED THROUGH OMISSIONS WHEN APPLICABLE.
4. A STRIPING KEY IS AVAILABLE ELSEWHERE AND SHALL BE SHOWN WHERE THE QUANTITIES ARE LISTED.
5. FINAL PAVEMENT MARKINGS SHALL BE IN PLACE PRIOR TO PLACING ANY RAISED REFLECTIVE PAVEMENT MARKERS.
6. THE FOLLOWING CRITERIA SHALL BE USED FOR SELECTING THE DIAGONAL PAVEMENT MARKING SPACING,
 <30 MPH USE 15' (<50 km/h USE 4.5 m)
 30-45 MPH USE 20' (50-75 km/h USE 6.0 m)
 >45 MPH USE 30' (>75 km/h USE 9.0 m)

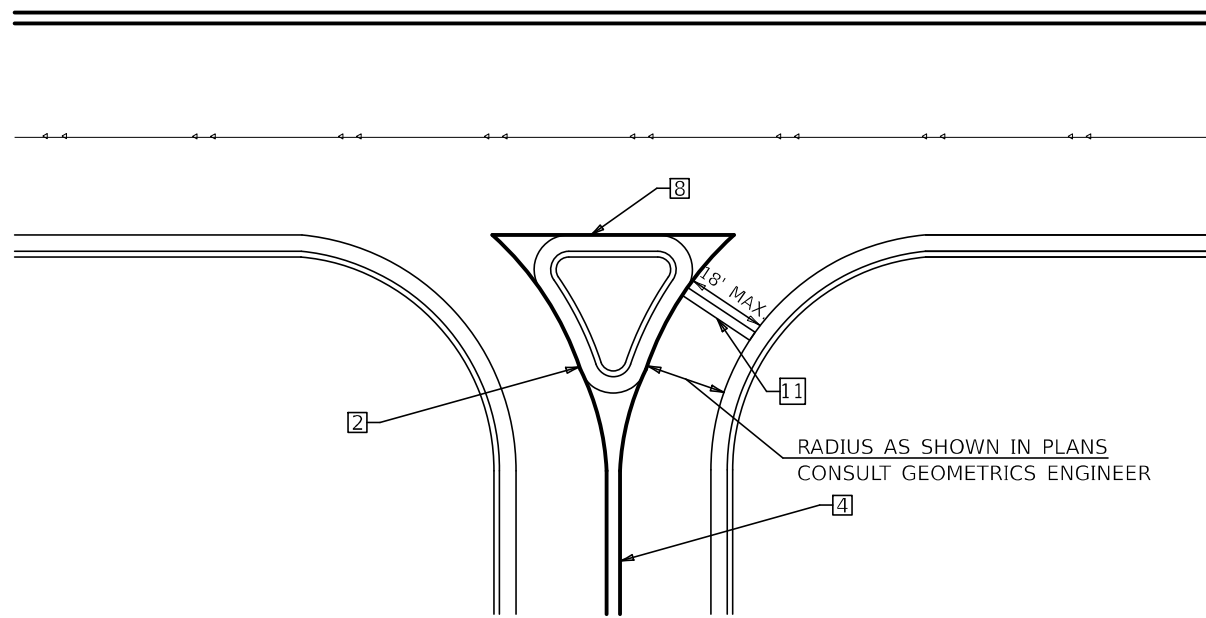

RIGHT IN - RIGHT OUT ACCESS

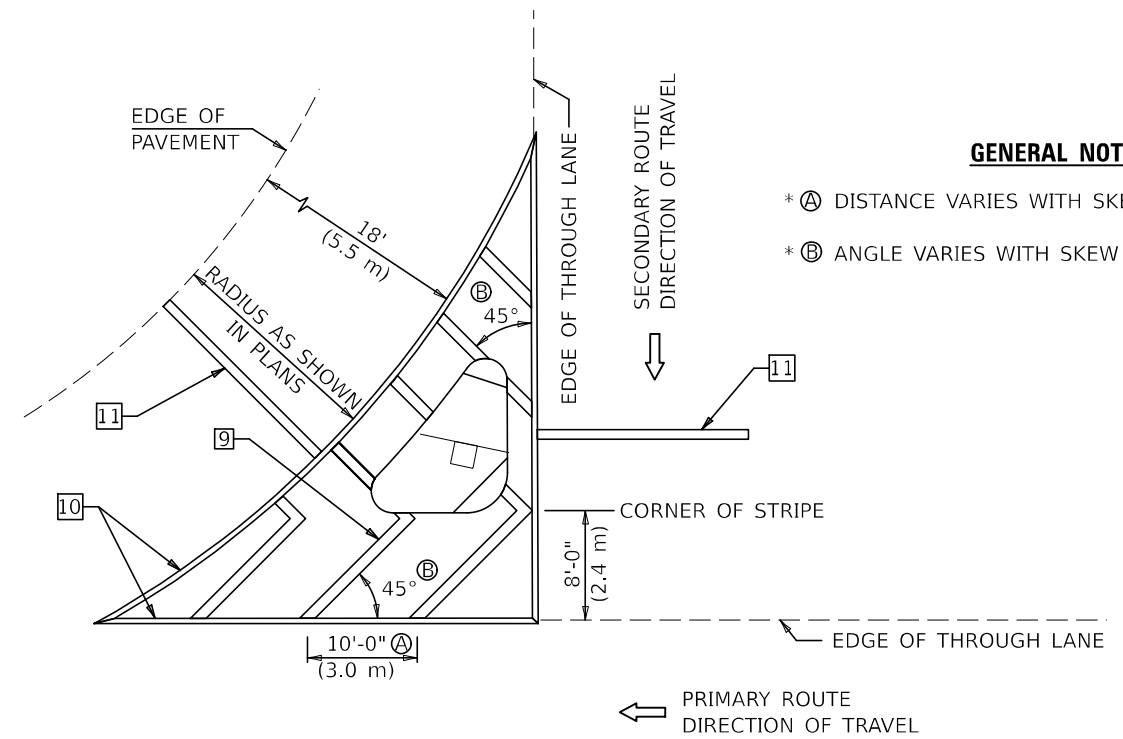

ISLAND

GENERAL NOTES

- * A DISTANCE VARIES WITH SKEW OF INTERSECTION.
- * B ANGLE VARIES WITH SKEW OF INTERSECTION.

* FOR RIGHT TURN LANE AND ISLAND STRIPING CONSULT GEOMETRICS ENGINEER.

Note: All dimensions are in INCHES (millimeters) unless otherwise shown.

MODEL: \\MODELS\MJES
 FILE NAME: \\p100\pc\work\proj\DOT\Office\District 5\ORD\Projects\05466\CAD\Drawings\05466\05466-Detail-5-Detail.dgn

| | | |
|--------------------------------|------------------|-----------------|
| USER NAME = Tyler, Pierson | DESIGNED - _____ | REVISED - _____ |
| PLOT SCALE = 0.16666633' / in. | DRAWN - _____ | REVISED - _____ |
| PLOT DATE = 3/22/2023 | CHECKED - _____ | REVISED - _____ |
| | DATE - _____ | REVISED - _____ |

**STATE OF ILLINOIS
 DEPARTMENT OF TRANSPORTATION**

| | | | |
|--------------------------------------------------------------|---------|-------------|------------------------------|
| PAVEMENT MARKING AND MARKERS (RURAL & URBAN APPLICATIONS) | | | |
| SCALE: N.T.S. | SHEET 3 | OF 4 SHEETS | STA. ___+___ TO STA. ___+___ |

| DISTRICT 5 DETAIL NO. 7800AAAA | | | | |
|--------------------------------|---------|-----------|--------------------|-----------|
| F.A. RTE. | SECTION | COUNTY | TOTAL SHEETS | SHEET NO. |
| VAR. | * | CHAMPAIGN | 20 | 19 |
| | | | CONTRACT NO. 46619 | |
| ILLINOIS FED. AID PROJECT | | | | |

* D 5 HT PVMNT MRK RPR 23-26

MODEL: RMODEL\M1E2
FILE NAME: P:\MIDOT\Documents\DOT Office\District 5\ORD Project\05466\CADD\Drawings\CD\Sheet\05466-04-Highway-District 5 Detail.dgn

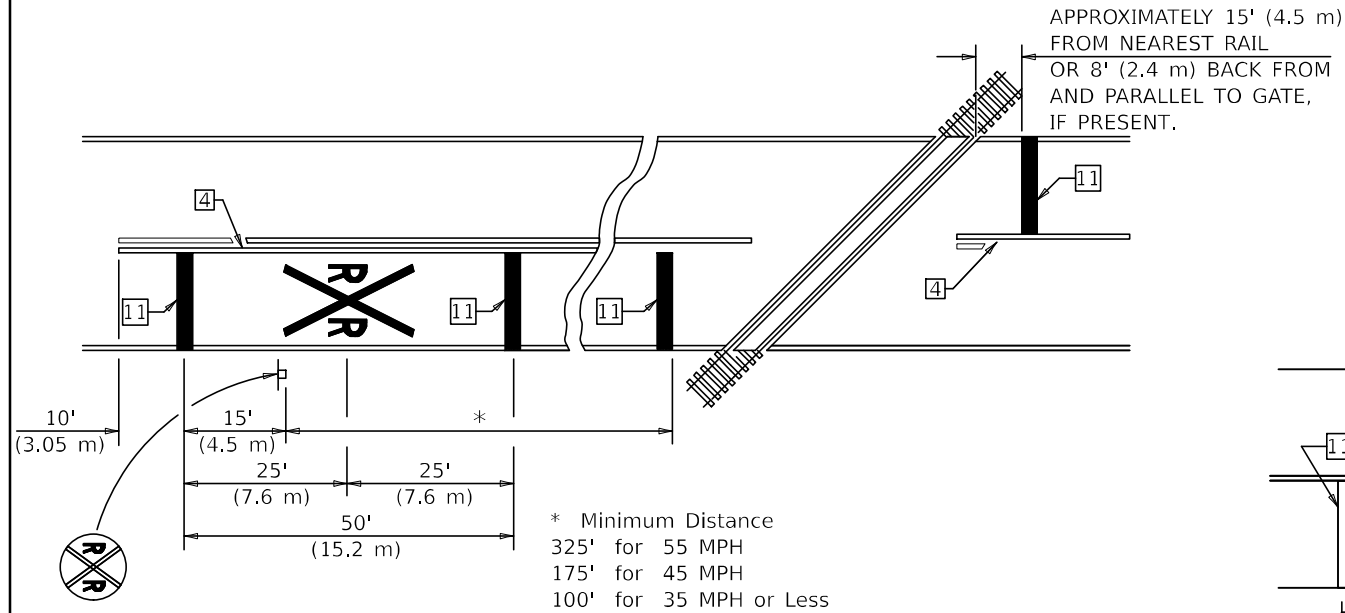

PAVEMENT MARKINGS AT RAILROAD-HIGHWAY GRADE CROSSING

RAILROAD CROSSING WITH INTERCONNECT ONLY

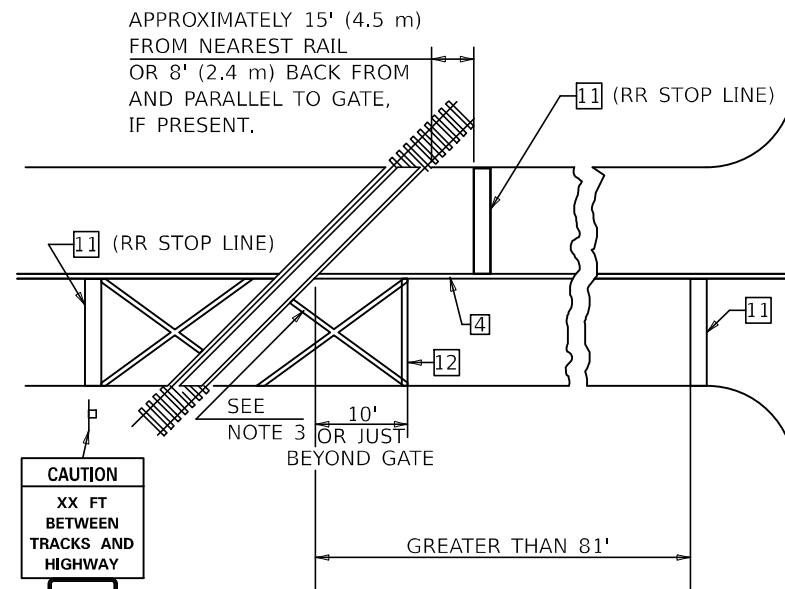

R8-8
24" X 30"

R8-8
24" X 30"

RAILROAD CROSSING WITH INTERCONNECT AND PRE-SIGNALS

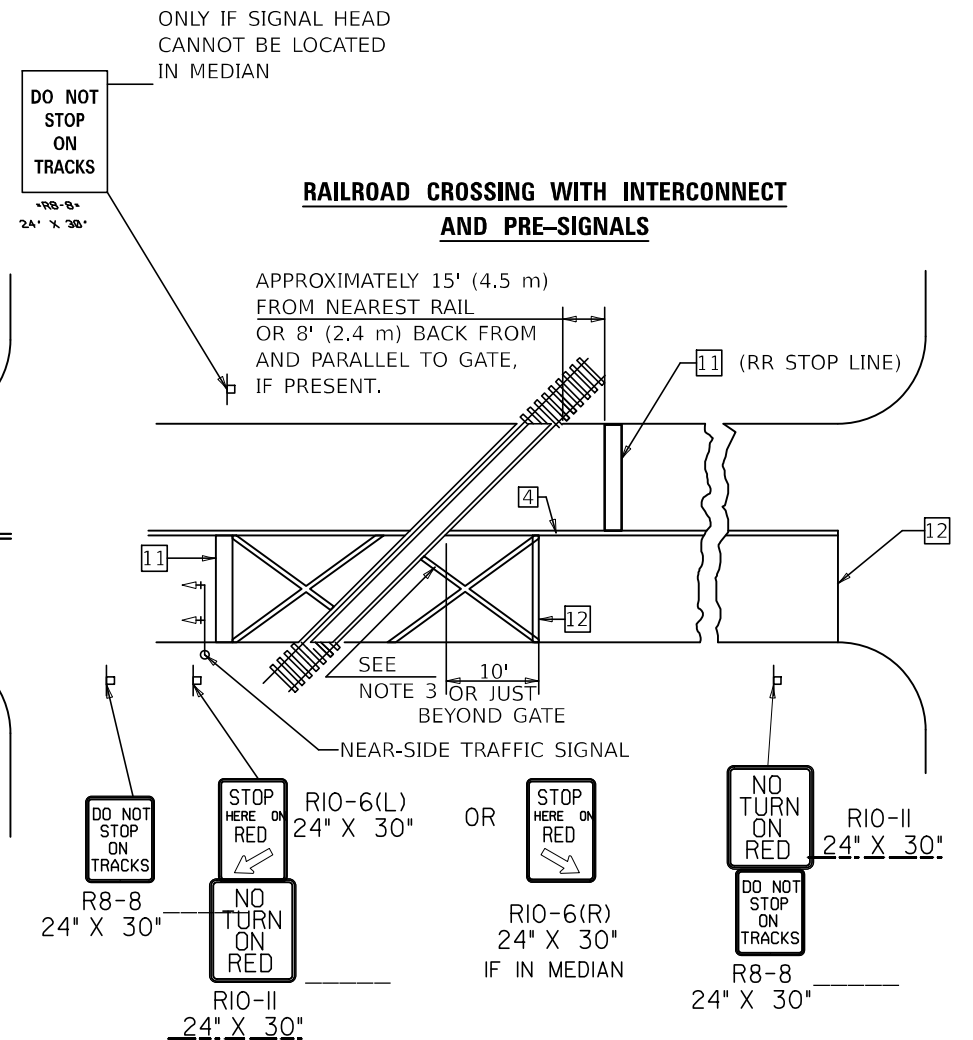

R8-8
24" X 30"

RIO-6(L)
24" X 30"

RIO-6(R)
24" X 30"

RIO-6(R)
24" X 30"

RIO-II
24" X 30"

R8-8
24" X 30"

GENERAL NOTES

- SUPPLEMENTAL PAVEMENT MARKINGS TO BE INSTALLED ONLY ON APPROACHES TO INTERSECTIONS CONTROLLED BY TRAFFIC SIGNALS WHICH ARE INTERCONNECTED WITH THE RAILROAD WARNING SIGNALS.
- EXTEND PAVEMENT MARKINGS TO THE INTERSECTION ONLY WHERE NEAR-SIDE TRAFFIC SIGNALS ARE USED.
- 6" WHITE PAVEMENT MARKINGS AT 45° TO PAVEMENT, 8" CENTER TO CENTER.
- XX DISTANCE TO BE SHOWN ON SIGN MEASURED FROM A POINT 6 FEET FROM THE RAIL CLOSEST TO THE INTERSECTION OR FROM THE CLOSEST POINT ALONG THE EXIT GATE IF PRESENT OVER THE ROADWAY WHEN IN THE LOWERED POSITION TO THE STOP BAR OR CROSSWALK, WHICH EVER IS CLOSEST, ROUNDED DOWN TO NEAREST 5 FEET. WHERE THERE IS NO STOP LINE, MEASURE TO POINT WHERE DRIVER HAS A VIEW OF APPROACHING TRAFFIC.
- THE CLEARANCE SIGN IS ALSO TO BE USED AS AN INTERIM MEASURE AT LOCATIONS WITH INTERCONNECTED INTERSECTION TRAFFIC SIGNALS WHERE IT IS PLANNED TO CHANGE THEM TO NEAR-SIDE SIGNALS AT A FUTURE TIME. IN THIS CASE, THE DISTANCE TO BE SHOWN ON THE SIGN IS MEASURED FROM THE EDGE OF THE STRIPED-OUT AREA INSTEAD OF 6 FEET FROM THE RAIL. THE SIGN IS TO BE REMOVED WHEN THE NEAR-SIDE SIGNALS ARE INSTALLED AND THE PAVEMENT MARKINGS EXTENDED TO THE INTERSECTION.

SUPPLEMENTAL PAVEMENT MARKING TREATMENT FOR RAILROAD-HIGHWAY GRADE CROSSING

ALTERNATE SIGNS

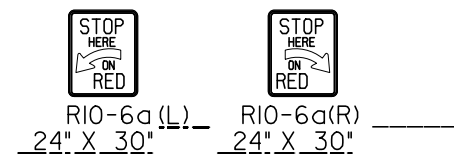

NOTES

- THE TRAVERSE SPREAD OF THE "X" MAY VARY ACCORDING TO LANE WIDTH.
- ON MULTI-LANE ROADS, THE STOP LINES SHALL EXTEND ACROSS ALL APPROACH LANES AND SEPARATE RXR SYMBOLS SHALL BE PLACED ADJACENT TO EACH OTHER IN EACH LANE.
- WHEN THE PAVEMENT MARKING SYMBOL IS USED, A PORTION OF THE SYMBOL SHOULD BE LOCATED DIRECTLY ADJACENT TO THE ADVANCE WARNING SIGN (W10-1) AS PLACED BY TABLE II-1, CONDITION B OF THE MUTCD.

Note: All dimensions are in INCHES (millimeters) unless otherwise shown.

DISTRICT 5 DETAIL NO. 7800AAAA

| | | |
|-------------------------------|------------|-----------|
| USER NAME = Tyler, Pierson | DESIGNED - | REVISED - |
| DRAWN - | CHECKED - | REVISED - |
| PLOT SCALE = 0.16666833 / in. | DATE - | REVISED - |
| PLOT DATE = 3/22/2023 | | |

STATE OF ILLINOIS DEPARTMENT OF TRANSPORTATION

PAVEMENT MARKING AND MARKERS (RURAL & URBAN APPLICATIONS)

SCALE: N.T.S. SHEET 4 OF 4 SHEETS STA. ___+___ TO STA. ___+___

| F.A. RTE. | SECTION | COUNTY | TOTAL SHEETS | SHEET NO. |
|--------------------|---------|-----------|--------------|-----------|
| VAR. | * | CHAMPAIGN | 20 | 20 |
| CONTRACT NO. 46619 | | | | |

ILLINOIS FED. AID PROJECT
* D 5 HT PVMNT MRK RPR 23-26