

STATE OF ILLINOIS
DEPARTMENT OF TRANSPORTATION
DIVISION OF HIGHWAYS

**PROPOSED
HIGHWAY PLANS**

FAI 74 (I-74) & FAS 1380 (IL RTE 91)
SECTION 72[4B,30;(3C)BR]SCR
SCOUR REPAIRS
PEORIA COUNTY
C-94-018-23

F.A.I. RTE.	SECTION	COUNTY	TOTAL SHEETS	SHEET NO.
74	72[4B,30;(3C)BR]SCR	PEORIA	9	1
		ILLINOIS	CONTRACT NO. 68H36	

D-94-013-23

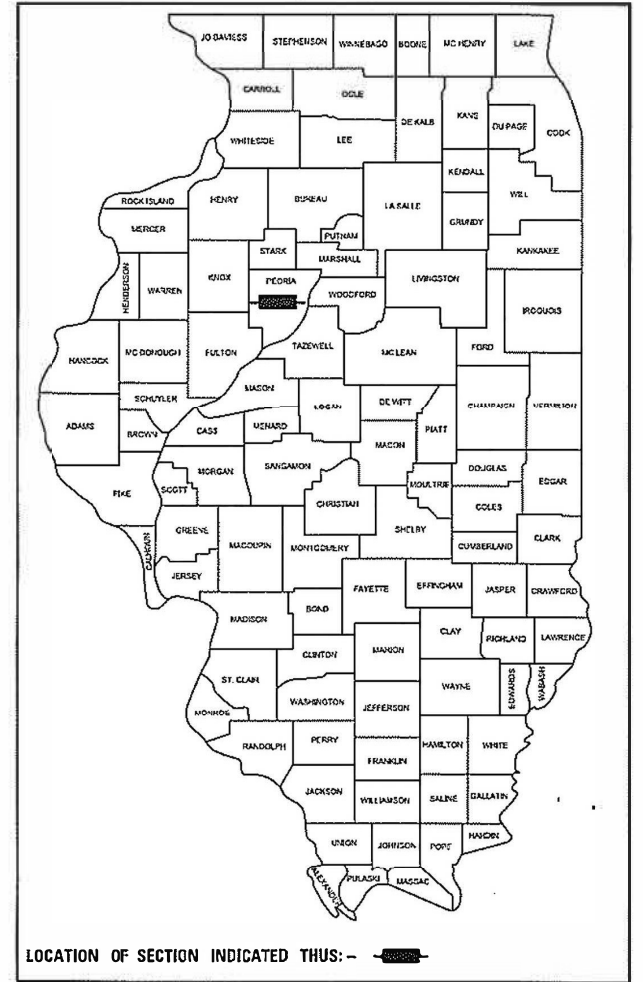

DESCRIPTION:
SCOUR REPAIRS OF SN 072-2009 ON I-74 OVER SWAB RUN, SN 072-0079 & 072-0080 ON I-74 OVER KICKAPOO CREEK, AND SN 072-0155, IL 91 OVER KICKAPOO CREEK IN PEORIA COUNTY.

STATE OF ILLINOIS
DEPARTMENT OF TRANSPORTATION

SUBMITTED March 23, 2023
Kensil A. Dorsett, Inc. REGIONAL ENGINEER
May 12, 2023 [Signature]
ENGINEER OF DESIGN AND ENVIRONMENT
May 12, 2023 [Signature]
DIRECTOR OF HIGHWAYS PROJECT IMPLEMENTATION

INDEX OF SHEETS

- 1 COVER SHEET
- 2 GENERAL NOTES
- 3 SUMMARY OF QUANTITIES
- 4 SN 072-2009 GENERAL PLAN & ELEVATION
- 5 SN 072-2009 SCOUR REPAIR DETAILS
- 6 SN 072-0079 & SN 072-0080 GENERAL PLAN & ELEVATION
- 7 SN 072-0079 & SN 072-0080 SCOUR REPAIR DETAILS
- 8 SN 072-0155 GENERAL PLAN & ELEVATION
- 9 SN 072-0155 SCOUR REPAIR DETAILS

ILLINOIS HIGHWAY STANDARDS

- 000001-08 701201-05
- 701001-02 701400-11
- 701006-05 701406-13
- 701101-05 701901-08
- 701106-02

ROADWAY CLASSIFICATION:

- SN 072-2009: I-74 - INTERSTATE; ADT (2021) 15,100; SU(775); MU(4,150)
- SN 072-0079 & 072-0080: I-74 - INTERSTATE; ADT (2021) 18,700; SU(675); MU(3,800)
- SN 072-0155: IL ROUTE 91 - MINOR ARTERIAL; ADT (2021) 6,100; SU=110; MU=100

LOCATION
SN 072-2009

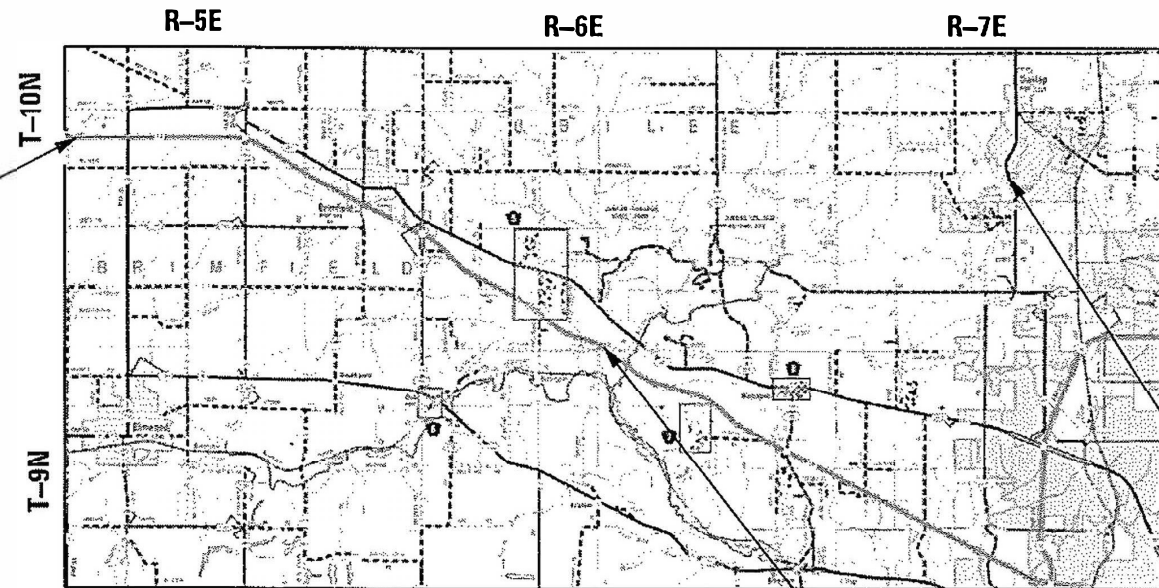

LOCATION MAP

LOCATION
SN 072-0155

LOCATION
SN 072-0079 &
SN 072-0080

J.U.L.I.E.
JOINT UTILITY LOCATION INFORMATION FOR EXCAVATION
1-800-892-0123
OR 811

PROJECT ENGINEER: MARK ECKHOFF (309)671-4463
PROJECT MANAGER: BEN TELLEFSON (309)671-3333

CONTRACT NO. 68H36
CATALOG NO. 03862-00D

**KLINGNER
& ASSOCIATES, P.C.**

Engineers • Architects • Surveyors
www.klingner.com

Galesburg, Illinois Quincy, IL Hannibal, MO
49 North Prairie Street Burlington, IA Peoria, IA Columbia, MO
308.342.4042 Davenport, IA Carbondale, IL

DESIGN FIRM NO. 184-2738

PRINTED BY THE AUTHORITY
OF THE STATE OF ILLINOIS

FILE NAME = 0:\21\1\213081\001 - DIST 4 - PTB 201-933\Work Order 89 - FY 2023 Structures\Transportation\Combined Scour Repair Plans (072-0149 0079 0080 0155)\BRIDGE.DM_Scour Repairs_2023_Plans.dgn

GENERAL NOTES

Plan dimensions and details relative to existing plans are subject to nominal construction variations. The Contractor shall field verify existing dimensions and details affecting new construction and make necessary approved adjustments prior to construction or ordering of materials. Such variations shall not be cause for additional compensation for a change in scope of the work, however, the Contractor will be paid for the quantity actually furnished at the unit price bid for the work.

Layout of the slope protection system may be varied to suit ground conditions in the field as directed by the Engineer.

The Contractor shall remove and dispose of any debris located within or adjacent to the structures. This work shall not be paid for seperately, but shall be considered incidental in cost to the assocaited pay items.

ENVIRONMENTAL REVIEW

PRIOR TO THE USE OF ANY PROPOSED BORROW AREAS, USE AREAS (TEMPORARY ACCESS ROADS, DETOURS, RUN-AROUNDS, ETC.) AND/OR WASTE AREAS, THE CONTRACTOR SHALL FILE THE REQUIRED ENVIRONMENTAL RESOURCE REQUEST SURVEYS ACCORDING TO SECTION 107.22 OF THE STANDARD SPECIFICATIONS. THESE SURVEYS ARE REQUIRED IN ORDER FOR THE DEPARTMENT TO CONDUCT CULTURAL AND BIOLOGICAL RESOURCE SURVEYS FOR THE PROPOSED SITE.

THE REQUIRED ENVIRONMENTAL RESOURCE DOCUMENTATION SHALL INCLUDE THE FOLLOWING:

- BDE FORM 2289 (BORROW SITE REVIEW)
- BDE FORM 2290 (WASTE/USE AREA REVIEW)
- A LOCATION MAP SHOWING THE SIZE LIMITS AND LOCATION OF THE USE AREA
- COLOR PHOTOGRAPHS DEPICTING THE USE AREA
- BORROW AREA ENTRY AGREEMENT FORM D4 PI0101

PRIOR TO ANY WASTE MATERIALS BEING REMOVED FROM THE CONSTRUCTION SITE THE REQUIRED ENVIRONMENTAL RESOURCE SURVEYS SHALL BE OBTAINED AND FILED BY THE CONTRACTOR. EXCESS WASTE PRODUCTS REMOVED FROM THE CONSTRUCTION SITE SHALL BE DISPOSED OF AS REQUIRED IN SECTION 202.03 OF THE STANDARD SPECIFICATIONS.

ANY PROTRUDING METAL BARS SHALL BE REMOVED PRIOR TO THE DISPOSAL OF BROKEN CONCRETE AT APPROVED DISPOSAL SITES.

PLEASE NOTE THAT A MINIMUM OF FOUR WEEKS SHALL BE ALLOWED FOR THE DISTRICT TO OBTAIN THE REQUIRED WASTE SITE ENVIRONMENTAL CLEARANCES AND SIX WEEKS FOR THE REQUIRED BORROW SITE ENVIRONMENTAL CLEARANCES.

COMMITMENTS

STRUCTURE 072-2009

The Contractor shall notify the adjacent property owner prior to and completion of the work. The Contractor shall remove and re-install the existing wire fence and posts that interfere with the planned work. The Contractor shall take all necessary to precautions to protect the nearby livestock during the working operations. Removal and reinstallation of the existing fence shall be paid for at the unit price per foot of FENCE REMOVAL AND REINSTALLATION.

The owners name and address are as follows:

South side: GND Farms, LLC
 Gregory L Harmon
 566 Santa Fe Trail
 Metamora IL, 61548
 (309) 635-7504

North side: Roger L. Recker
 (309) 339-7681

SITE ACCESS

THE CONTRACTOR SHALL PROVIDE THE ENGINEER WITH AN ACCESS AND RESTORATION PLAN FOR EACH LOCATION. ALL WORK AND MATERIALS REQUIRED TO GAIN ACCESS AND RESTORE THE ACCESS PATH WILL NOT BE PAID FOR SEPARATELY BUT SHALL BE INCLUDED IN THE COST OF THE ASSOCIATED PAY ITEMS.

REMOVAL OF SAPLINGS AND TREES (3) INCHES OR GREATER IN DIAMETER AT CHEST HEIGHT SHALL NOT BE PERMITTED FROM APRIL 1ST THROUGH SEPTEMBER 30TH.

MODEL: Default FILE NAME: O:\21files\213081 IDCT -DIST 4 --PTB 201-033\Work Order 09 - FY 2023 Structures\Transportation\Combined Scour Repair Plans (072-0149 (079 0080 0155)\88H36_D4_SCOUF REPAIRS_2023_Plans.dgn



USER NAME =	DESIGNED - CMV	REVISED -
	CHECKED - RJP	REVISED -
PLOT SCALE =	DRAWN - CMV	REVISED -
PLOT DATE =	CHECKED - RJP	REVISED -

**STATE OF ILLINOIS
 DEPARTMENT OF TRANSPORTATION**

GENERAL NOTES

SHEET 1 OF 1 SHEETS

F.A.I. RTE.	SECTION	COUNTY	TOTAL SHEETS	SHEET NO.
74	72(4B,30,(3C)BRJSCR	PEORIA	9	2
CONTRACT NO. 68H36				

ILLINOIS | FED. AID PROJECT

Benchmark: N/A

Existing S.N. 072-2009: The existing structure was originally built in 1968 as F.A.I. 74 (I-74), Section 72-30, as a cast in place reinforced concrete double 10'x9' box culvert.

The existing structure shall have Class A-5 riprap with filter fabric and bedding stone installed at the upstream and downstream ends. Traffic shall be maintained using IDOT Highway Standard 701401 during construction.

No Salvage.

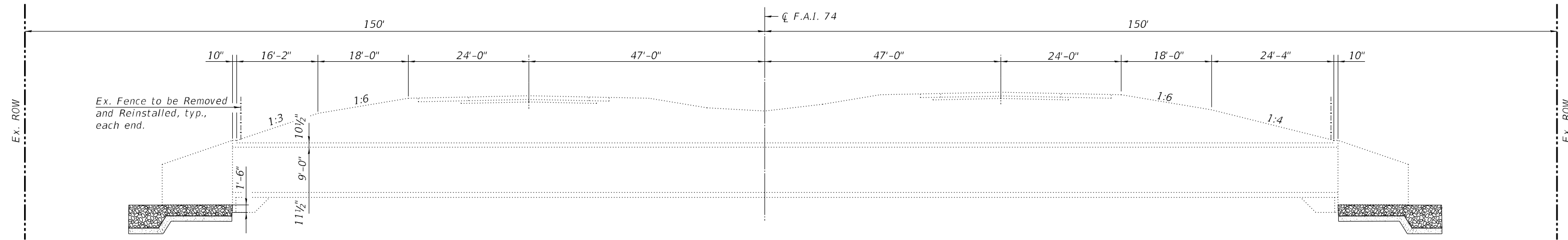

LONGITUDINAL SECTION
(Looking East)

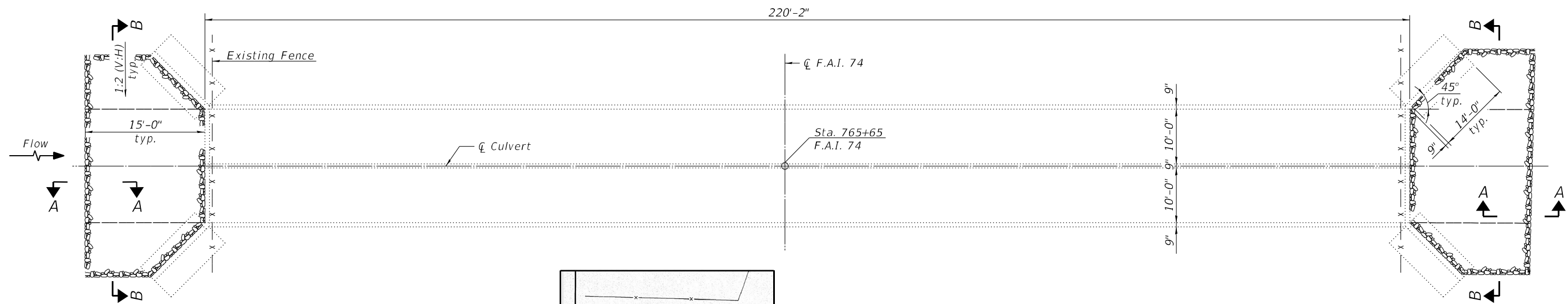

The Contractor shall notify the adjacent property owner prior to and completion of the work. The Contractor shall remove and re-install the existing wire fence and posts that interfere with the planned work. The Contractor shall take all necessary precautions to protect the nearby livestock during the working operations. Removal and reinstallation of the existing fence shall be paid for at the unit price per foot of FENCE REMOVAL AND REINSTALLATION.

The owners name and address are as follows:

South side: GND Farms, LLC
Gregory L Harmon
566 Santa Fe Trail
Metamora IL, 61548
(309) 635-7504

North side: Roger L. Recker
(309) 339-7681

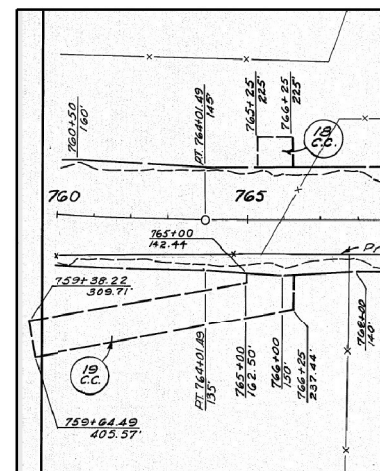

R.O.W. LAYOUT

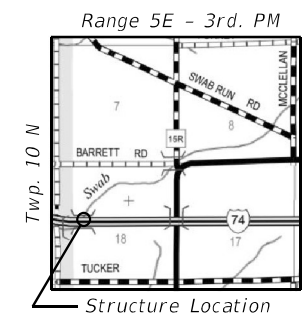

LOCATION SKETCH

See Sheet 3 of 3 for Section A-A and Section B-B.

GENERAL PLAN & ELEVATION
F.A.I. 74 (I-74)
OVER SWAB RUN
SECTION
PEORIA COUNTY
STATION 765+65
STRUCTURE NO. 072-2009

MODEL: Default
FILE NAME: C:\21files\213081 IDOT - DIST 4 - PTB 201-033\Work Order 09 - FY 2023 Structures\Transportation\Combined Scour Repair Plans (072-0149 0079 0080 0155)68H36_D4_SCOUR REPAIRS_2023_Plans.dgn
12/1/2022 3:09:40 PM

KLINGNER & ASSOCIATES, P.C.
Engineers • Architects • Surveyors
816 N. 24TH ST. QUINCY, ILLINOIS 62301 217.223-2670
STATE OF ILLINOIS DESIGN FIRM NO. 184-2738

USER NAME =	DESIGNED - CMV	REVISED -
PLOT SCALE =	CHECKED - RJP	REVISED -
PLOT DATE =	DRAWN - CMV	REVISED -
	CHECKED - RJP	REVISED -

STATE OF ILLINOIS
DEPARTMENT OF TRANSPORTATION

GENERAL PLAN AND ELEVATION
STRUCTURE NO. 072-2009

SHEET 1 OF 2 SHEETS

F.A.I. RTE.	SECTION	COUNTY	TOTAL SHEETS	SHEET NO.
74	72(4B,30)(3C)BRJSCR	PEORIA	9	4
CONTRACT NO. 68H36				

ILLINOIS FED. AID PROJECT

TOTAL BILL OF MATERIAL

ITEM	UNIT	TOTAL
Stone Riprap, Class A5	Sq. Yd.	140
Filter Fabric	Sq. Yd.	140
Fence Removal And Reinstallation	Foot	126

GENERAL NOTES

Plan dimensions and details relative to existing plans are subject to nominal construction variations. The Contractor shall field verify existing dimensions and details affecting new construction and make necessary approved adjustments prior to construction or ordering of materials. Such variations shall not be cause for additional compensation for a change in scope of the work, however, the Contractor will be paid for the quantity actually furnished at the unit price bid for the work.

Layout of the slope protection system may be varied to suit ground conditions in the field as directed by the Engineer.

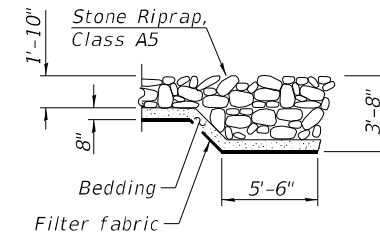

SECTION A-A

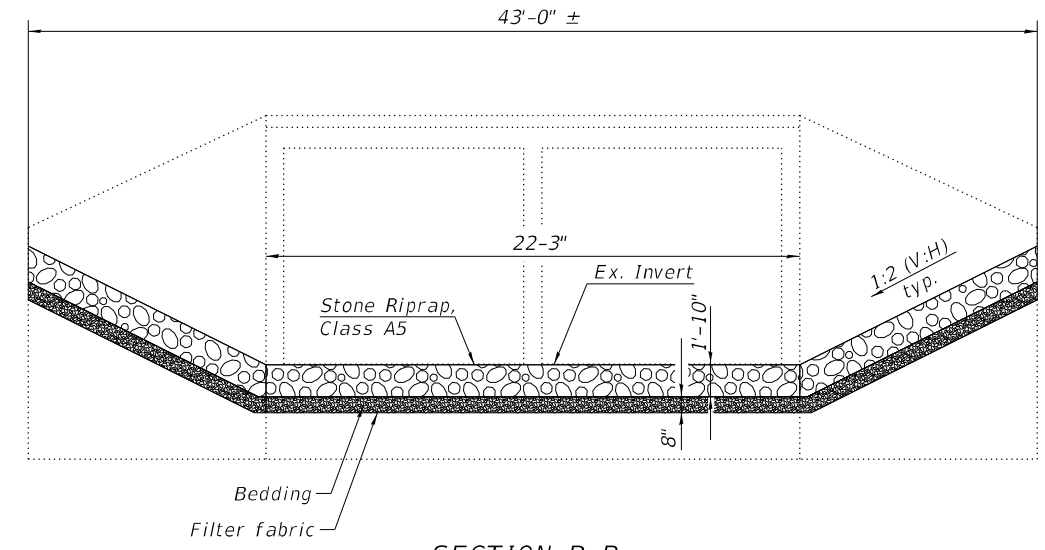

SECTION B-B
(typ. each end)

Note: Pay Limits of Fence Removal and Replacement shall be 10' max. beyond edge of windwalls.

MODEL: Default
FILE NAME: C:\21files\213081 IDOT - DIST - 4 - PTB 201-033\Work Order 09 - FY 2023 Structures\Transportation\Combined Scour Repair Plans (072-0149 0079 0080 0155)68H36_D4_SCOUR REPAIRS_2023_Plans.dgn

KLINGNER & ASSOCIATES, P.C.
Engineers • Architects • Surveyors
816 N. 24TH ST. QUINCY, ILLINOIS 62301 217.223-3670
STATE OF ILLINOIS DESIGN FIRM NO. 184-2738

USER NAME =	DESIGNED - CMV	REVISED -
PLOT SCALE =	CHECKED - RJP	REVISED -
PLOT DATE =	DRAWN - CMV	REVISED -
	CHECKED - RJP	REVISED -

**STATE OF ILLINOIS
DEPARTMENT OF TRANSPORTATION**

**SCOUR REPAIR DETAILS
STRUCTURE NO. 072-2009**

SHEET 2 OF 2 SHEETS

F.A.I. RTE.	SECTION	COUNTY	TOTAL SHEETS	SHEET NO.
74	72[4B,30;(3C)BR]SCR	PEORIA	9	5
CONTRACT NO. 68H36				
ILLINOIS		FED. AID PROJECT		

Benchmark: N/A

Existing S.N. 072-0079 & 072-0080: The existing structures were originally built in 1968 as F.A.I.-Route 74 (I-74). Each bridge is a five-span continuous steel structure with solid wall piers and open stub abutments.

The existing structure shall have Class A-5 riprap with filter fabric and bedding stone placed at each of the piers.

No Salvage.

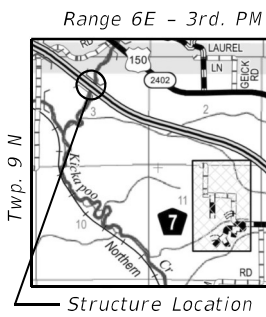
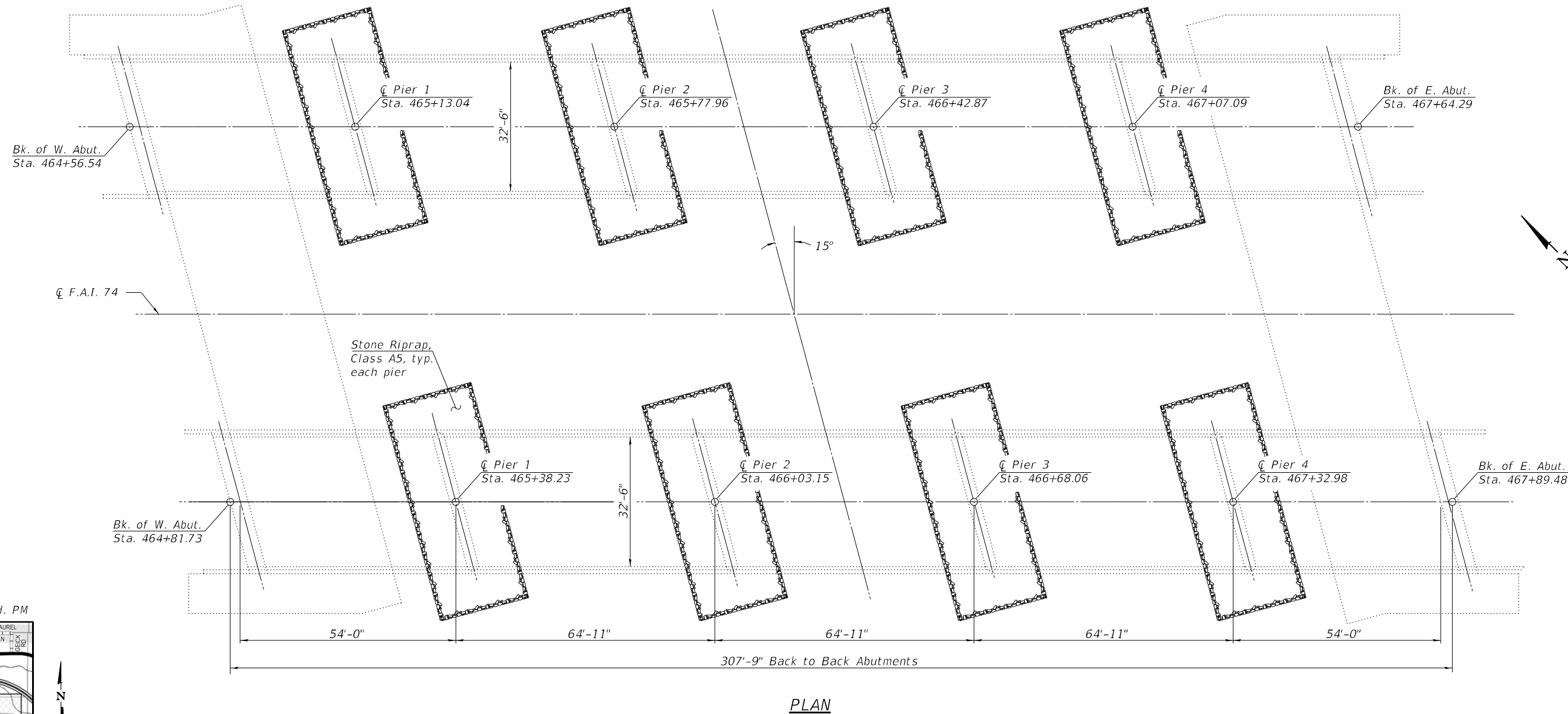
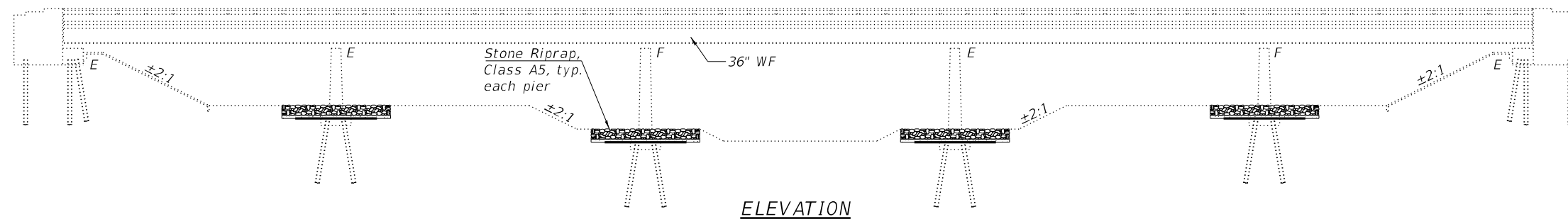

LOCATION SKETCH

GENERAL PLAN & ELEVATION
F.A.I. 74 (I-74)
OVER KICKAPOO CREEK
PEORIA COUNTY
STATION 466+20

STRUCTURE NO. 072-0079 (EB) & 072-0080 (WB)

MODEL: Default
 FILE NAME: C:\21files\213081 IDOT - DIST 4 - PTB 201-033\Work Order 09 - FY 2023 Structures\Transportation\Combined Scour Repair Plans (072-0149 0079 0080 0155)68H36_D4_SCOUR REPAIRS_2023_Plans.dgn
 12/1/2022 3:09:59 PM

KLINGNER & ASSOCIATES, P.C.
 Engineers • Architects • Surveyors
 816 N. 24TH ST. QUINCY, ILLINOIS 62301 217.223-3670
 STATE OF ILLINOIS DESIGN FIRM NO. 184-2738

USER NAME =	DESIGNED - CMV	REVISED -
PLOT SCALE =	CHECKED - RJP	REVISED -
PLOT DATE =	DRAWN - CMV	REVISED -
	CHECKED - RJP	REVISED -

STATE OF ILLINOIS
DEPARTMENT OF TRANSPORTATION

GENERAL PLAN AND ELEVATION
STRUCTURE NO. 072-0079 (EB) & 072-0080 (WB)

SHEET 1 OF 2 SHEETS

F.A.I. RTE.	SECTION	COUNTY	TOTAL SHEETS	SHEET NO.
74	72[4B,30;(3C)BR]SCR	PEORIA	9	6
CONTRACT NO. 68H36				
ILLINOIS FED. AID PROJECT				

TOTAL BILL OF MATERIAL

ITEM	UNIT	TOTAL
Stone Riprap, Class A5	Sq. Yd.	1,055
Filter Fabric	Sq. Yd.	635

GENERAL NOTES

Plan dimensions and details relative to existing plans are subject to nominal construction variations. The Contractor shall field verify existing dimensions and details affecting new construction and make necessary approved adjustments prior to construction or ordering of materials. Such variations shall not be cause for additional compensation for a change in scope of the work, however, the Contractor will be paid for the quantity actually furnished at the unit price bid for the work.

Layout of the slope protection system may be varied to suit ground conditions in the field as directed by the Engineer.

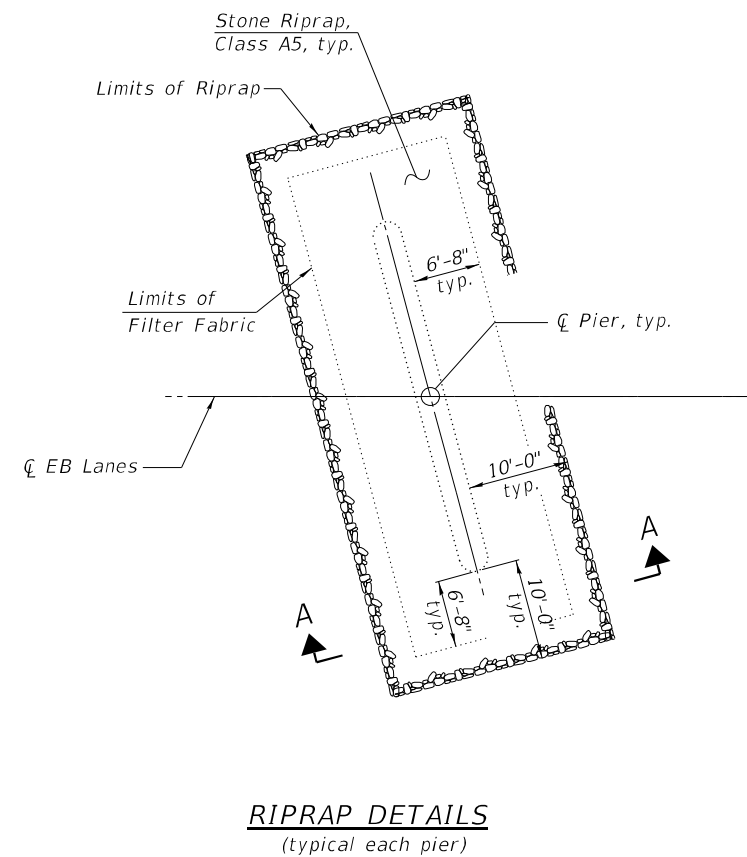
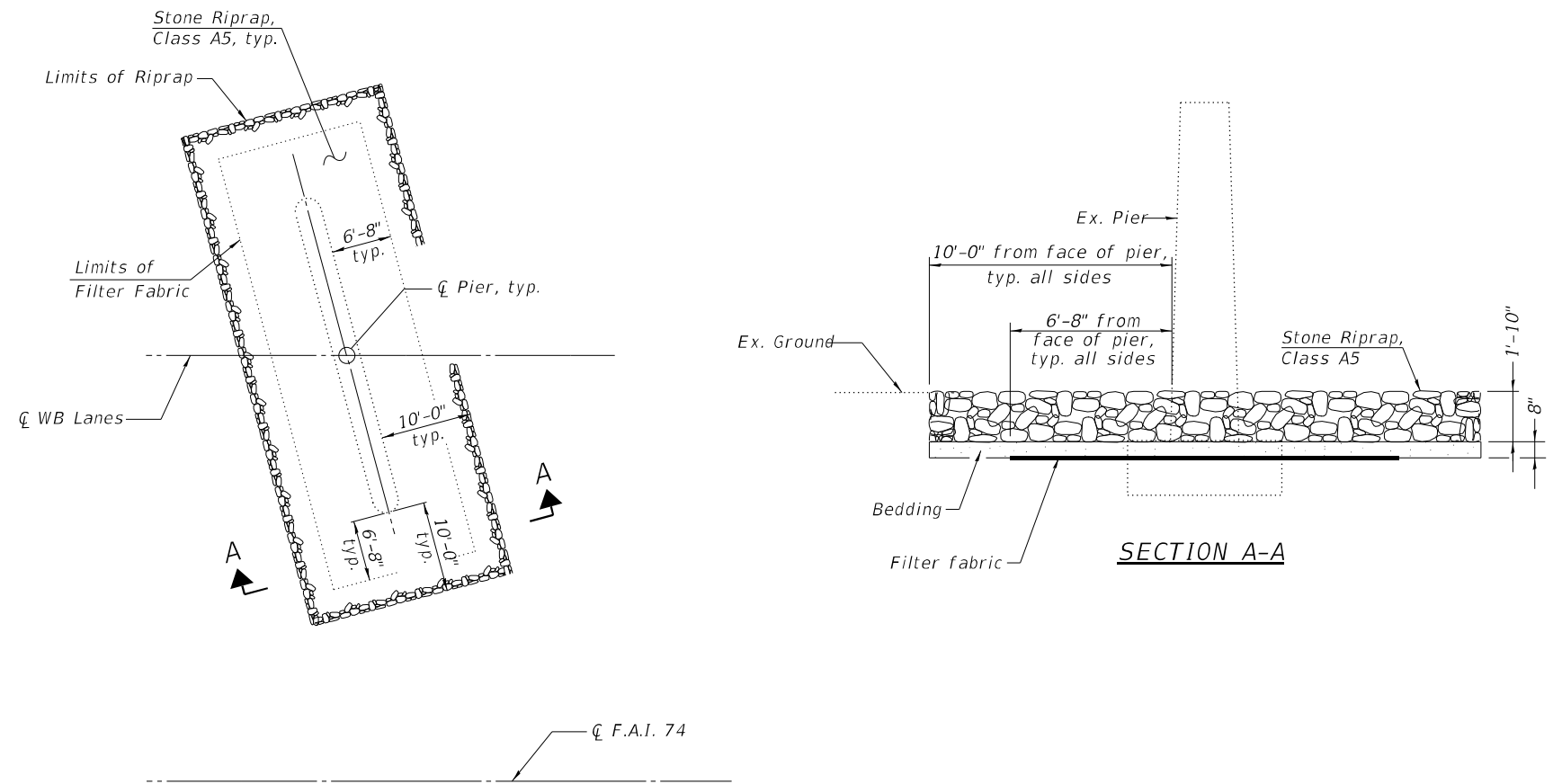

MODEL: Default
 FILE NAME: C:\21files\213081 IDOT - DIST - 4 - PTB 201-033\Work Order 09 - FY 2023 Structures\Transportation\Combined Scour Repair Plans (072-0149 0079 0080 0155)68H36_D4_SCOUR REPAIRS_2023_Plans.dgn
 12/1/2022 3:10:12 PM

KLINGNER & ASSOCIATES, P.C.
 Engineers • Architects • Surveyors
 816 N. 24TH ST. QUINCY, ILLINOIS 62301 217.223-3670
 STATE OF ILLINOIS DESIGN FIRM NO. 184-2738

USER NAME =	DESIGNED - CMV	REVISED -
PLOT SCALE =	CHECKED - RJP	REVISED -
PLOT DATE =	DRAWN - CMV	REVISED -
	CHECKED - RJP	REVISED -

**STATE OF ILLINOIS
 DEPARTMENT OF TRANSPORTATION**

**SCOUR REPAIR DETAILS
 STRUCTURE NO. 072-0079 (EB) & 072-0080 (WB)**

SHEET 2 OF 2 SHEETS







F.A.I. RTE.	SECTION	COUNTY	TOTAL SHEETS	SHEET NO.
74	72(4B,30)(3C)BR SCR	PEORIA	9	7
CONTRACT NO. 68H36				
ILLINOIS		FED. AID PROJECT		

Benchmark: N/A

Existing S.N. 072-0155: The existing structure was originally built in 1987 as S.B.I. Rte. 30, Section (3C)BR, is a three-span Precast Prestressed Concrete I-beam structure with solid wall piers and open stub abutments.

The existing structure shall have Class A5 dumped riprap placed and channel excavation at the north pier.
Traffic shall be maintained using IDOT Highway Standard 701201 during construction.

No Salvage.

-  Creek Edge
-  Existing Revetment Mat
-  Existing Riprap
-  Existing Gabions
-  Pr. Riprap
-  Channel Ex.

See Sheet 5 of 5 for Sec. A-A and Sec. B-B

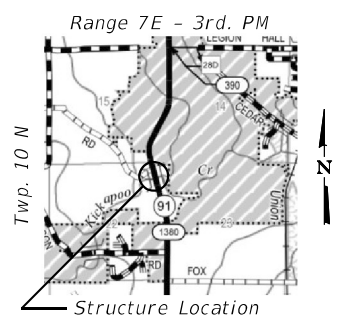
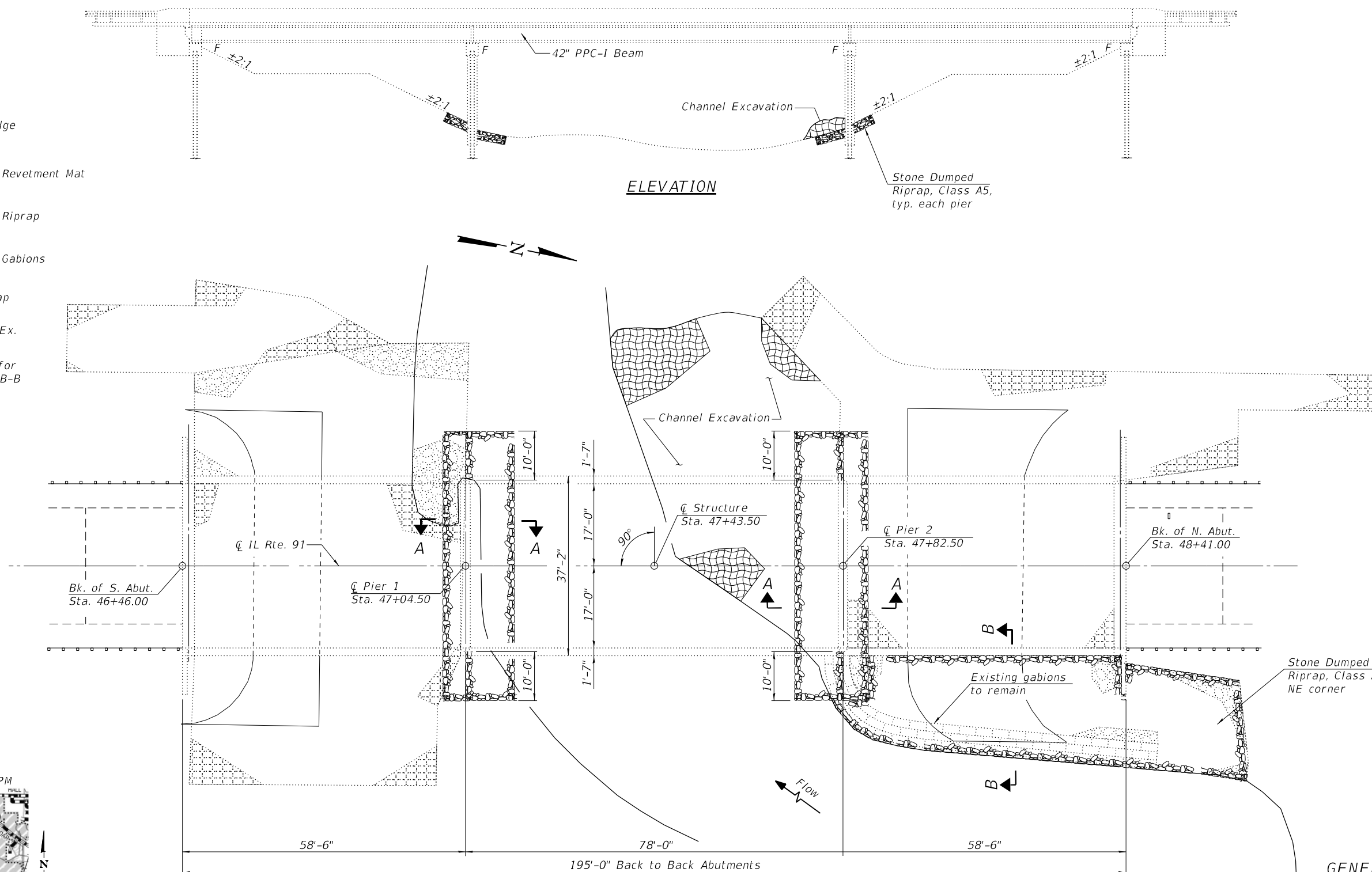

LOCATION SKETCH

GENERAL PLAN & ELEVATION
F.A.S. 1380 (IL RTE 91)
OVER KICKAPOO CREEK
PEORIA COUNTY
STATION 47+43.50
STRUCTURE NO. 072-0155

MODEL: Default
 FILE NAME: C:\21files\213081 IDOT - DIST 4 - PTB 201-033\Work Order 09 - FY 2023 Structures\Transportation\Combined Scour Repair Plans (072-0149 0079 0080 0155)\68H36_D4_SCOUR REPAIRS_2023_Plans.dgn
 12/1/2022 3:10:25 PM

KLINGNER & ASSOCIATES, P.C.
 Engineers - Architects - Surveyors
 816 N. 24TH ST. QUINCY, ILLINOIS 62301 217.223-2670
 STATE OF ILLINOIS DESIGN FIRM NO. 184-2738

USER NAME =	DESIGNED - CMV	REVISED -
CHECKED - RJP	CHECKED - RJP	REVISED -
PLOT SCALE =	DRAWN - CMV	REVISED -
PLOT DATE =	CHECKED - RJP	REVISED -

STATE OF ILLINOIS
DEPARTMENT OF TRANSPORTATION

GENERAL PLAN AND ELEVATION
STRUCTURE NO. 072-0155

SHEET 1 OF 2 SHEETS

F.A.S. RTE.	SECTION	COUNTY	TOTAL SHEETS	SHEET NO.
1380	72(4B,30)(3C)BR SCR	PEORIA	9	8
CONTRACT NO. 68H36				
ILLINOIS FED. AID PROJECT				

TOTAL BILL OF MATERIAL

ITEM	UNIT	TOTAL
Stone Dumped Riprap, Class A5	Ton	411
Channel Excavation	Cu. Yd.	30

GENERAL NOTES

Plan dimensions and details relative to existing plans are subject to nominal construction variations. The Contractor shall field verify existing dimensions and details affecting new construction and make necessary approved adjustments prior to construction or ordering of materials. Such variations shall not be cause for additional compensation for a change in scope of the work, however, the Contractor will be paid for the quantity actually furnished at the unit price bid for the work.

Layout of the slope protection system may be varied to suit ground conditions in the field as directed by the Engineer.

The Contractor shall leave the existing gabions intact.

The final location of the area of Channel Excavation shall be determined in the field by the Engineer. Approximate depth is 5'

The Contractor shall remove vegetation over the existing gabion baskets before placing riprap. Cost included with Stone Dumped Riprap, Class A5.

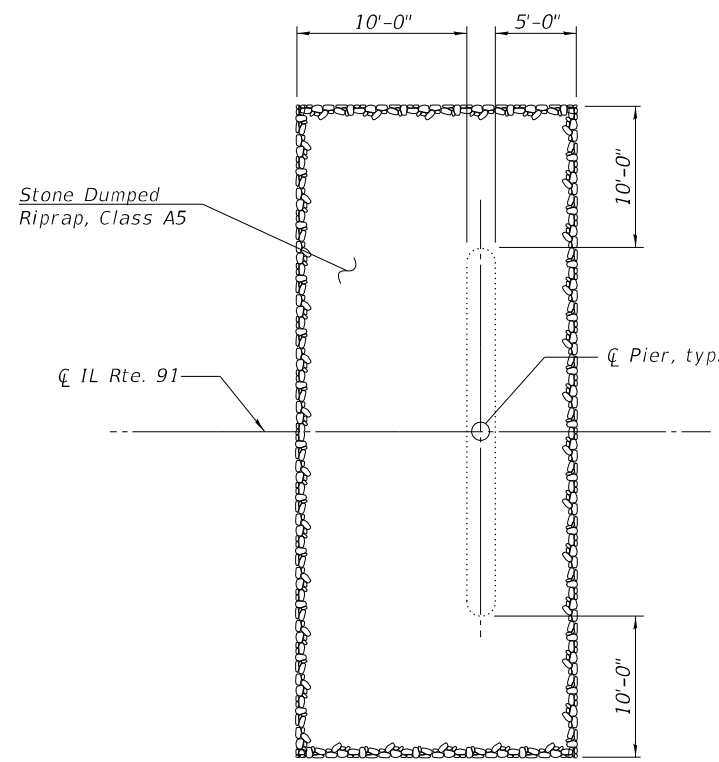

PLAN VIEW
(Pier 2 shown, Pier 1 similar by rotating 180°)

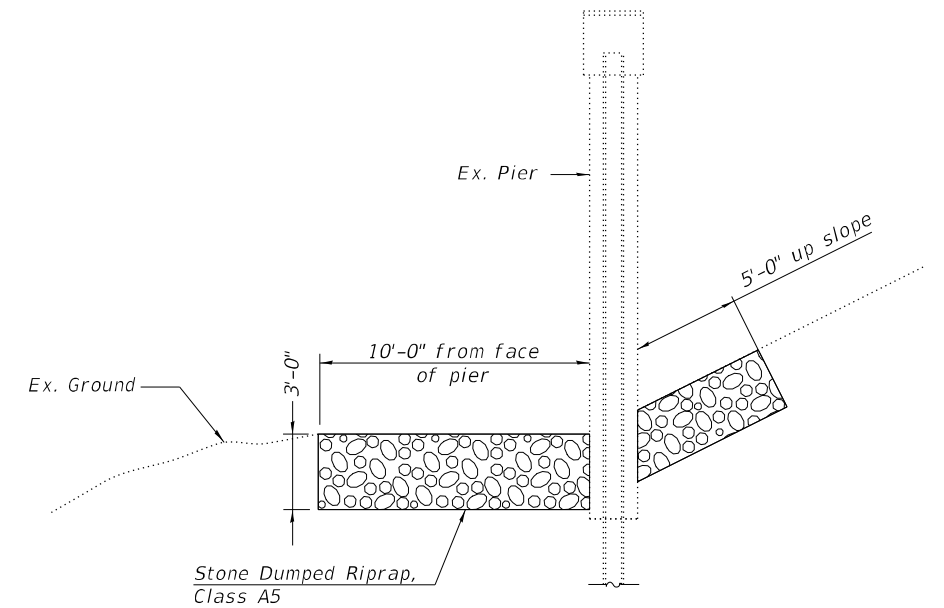

SECTION A-A

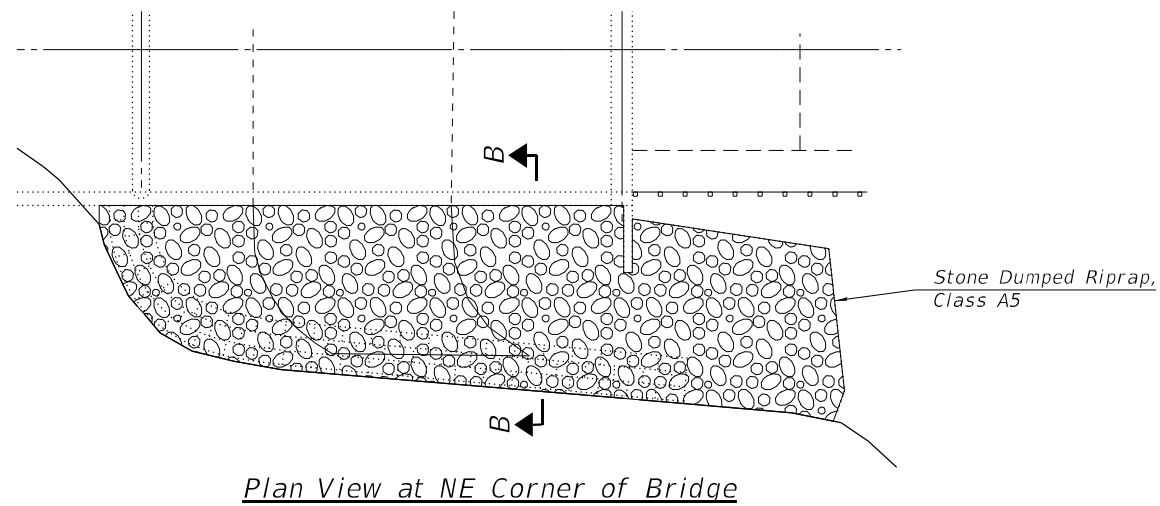

Plan View at NE Corner of Bridge

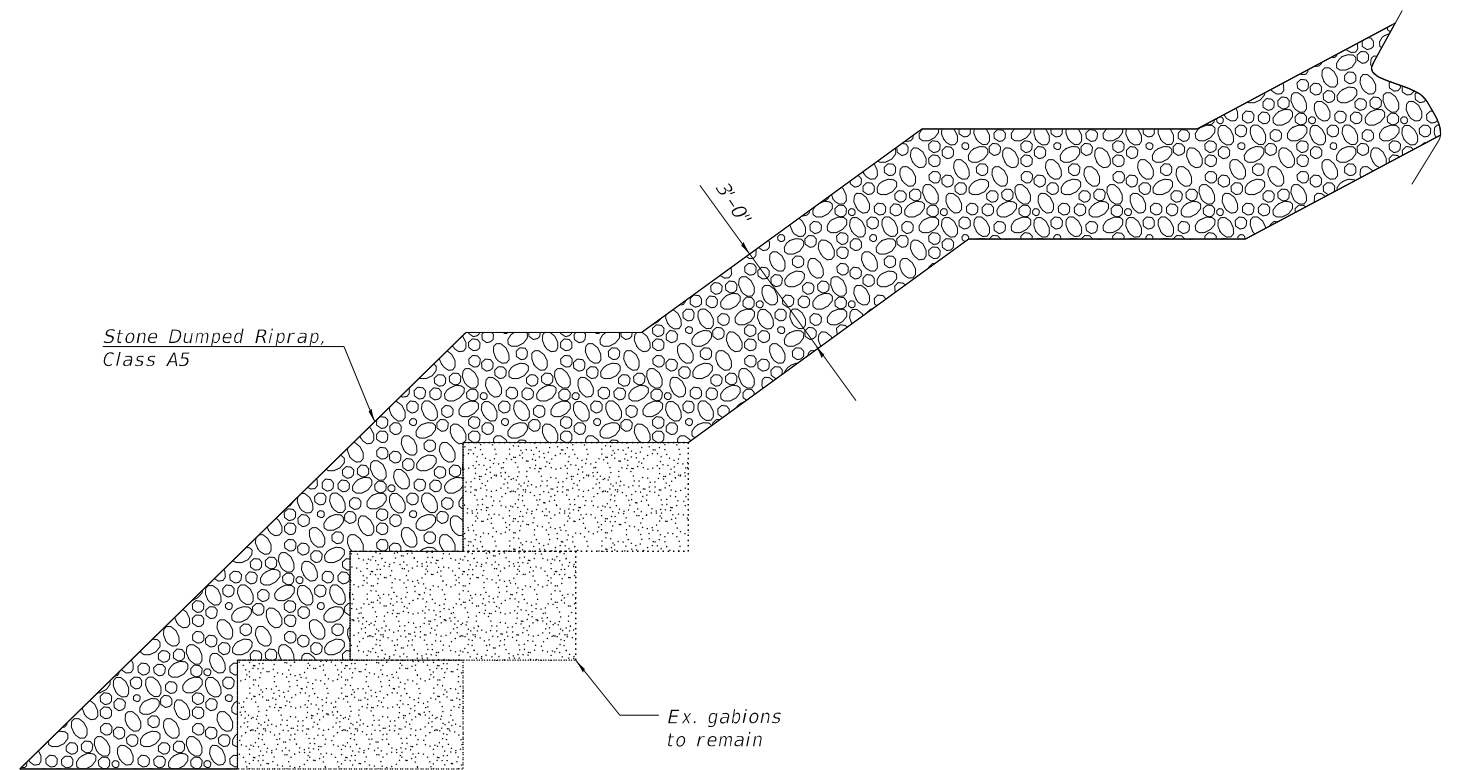

SECTION B-B

NE RIPRAP DETAILS

MODEL: Default
 FILE NAME: C:\21files\213081 IDOT - DIST 4 - PTB 201-033\Work Order 09 - FY 2023 Structures\Transportation\Combined Scour Repair Plans (072-0149 0079 0080 0155)68H36_D4_SCOUR REPAIRS_2023_Plans.dgn
 12/1/2022 3:10:36 PM

KLINGNER & ASSOCIATES, P.C.
 Engineers • Architects • Surveyors
 816 N. 24TH ST. QUINCY, ILLINOIS 62301 217.223-3670
 STATE OF ILLINOIS DESIGN FIRM NO. 184-2738

USER NAME =	DESIGNED - CMV	REVISED -
PLOT SCALE =	CHECKED - RJP	REVISED -
PLOT DATE =	DRAWN - CMV	REVISED -
	CHECKED - RJP	REVISED -

**STATE OF ILLINOIS
DEPARTMENT OF TRANSPORTATION**

**SCOUR REPAIR DETAILS
STRUCTURE NO. 072-0155**

SHEET 2 OF 2 SHEETS

F.A.S. RTE.	SECTION	COUNTY	TOTAL SHEETS	SHEET NO.
1380	72[4B,30;(3C)]BRJSCR	PEORIA	9	9
CONTRACT NO. 68H36				
		ILLINOIS	FED. AID PROJECT	