

STATE OF ILLINOIS
DEPARTMENT OF TRANSPORTATION

ROUTE NO.	SECTION	COUNTY	TOTAL SHEETS	SHEET NO.	SHEET NO. 10 SHEETS 25
FAI. 74	(10-6) RS-1	CHAMPAIGN	144	100	
FED. ROAD DIST. NO. 1	ILLINOIS	FED. AID PROJECT			

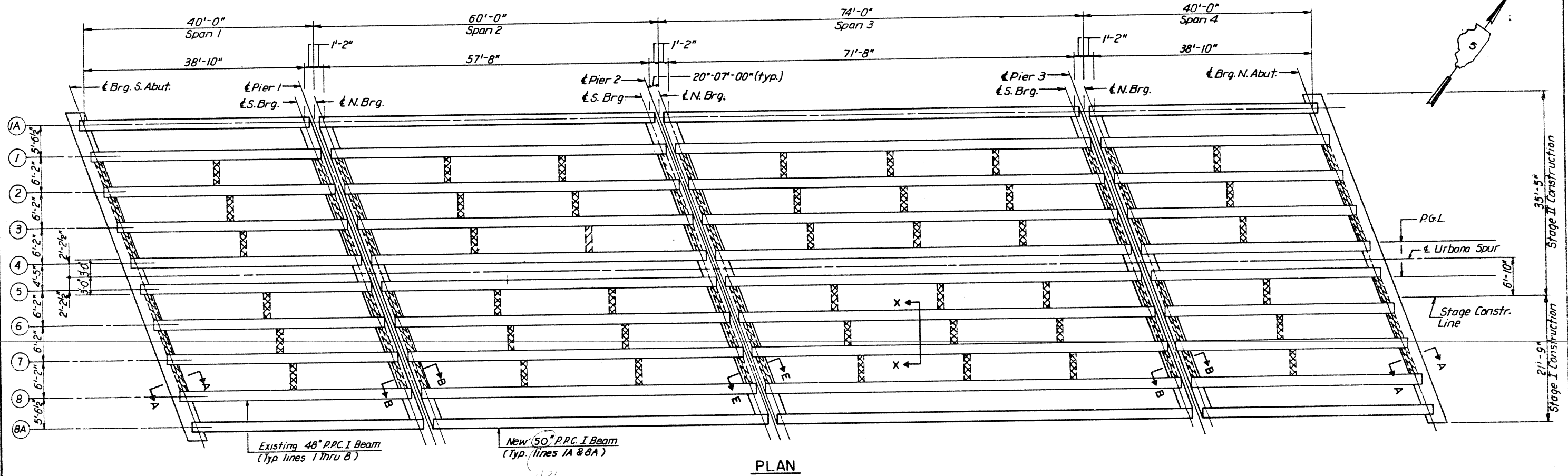

PLAN

LEGEND

- Indicates diaphragm removal. Reinforcement extending into removed area shall be cleaned and incorporated into the New Construction.
- Indicates diaphragm and reinforcement removal. Existing beams shall be patched as required with epoxy mortar.

NOTE:
See sheet no. 8 for Section A-A and B-B
See sheet no. 9 for Section E-E

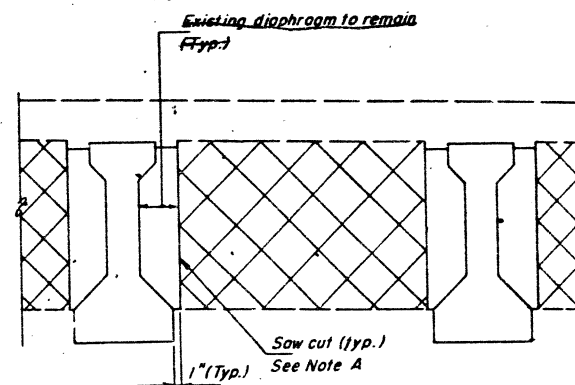

Note A
Patch ~~and~~ **beam** diaphragm as required with epoxy mortar.

SECTION X-X

(Typical intermediate diaphragm removal)

NOTE: Diaphragms fell off of beams.
only bond was @ bottom flange.

DESIGNED	R.V.P.
CHECKED	J.M.P.
DRAWN	K.A.C./V.B.P.
CHECKED	R.V.P.

REVISIONS	
NAME	DATE

P.G. ENGINEERING ASSOCIATES, INC.
800 WEST JACKSON BLVD.
CHICAGO ILLINOIS 60606

FRAMING PLAN
URBANA SPUR OVER F.A.I. RT. 74
SECTION (10-6) RS-1
CHAMPAIGN COUNTY
STA. 49+99.40
S.N.OIO-0033

SCALE: VERT.
HORIZ.
DATE