

FOR INDEX OF SHEETS, SEE SHEET NO. 2
 FOR SUMMARY OF QUANTITIES, SEE SHEET NO. 3 - 4

STATE OF ILLINOIS
 DEPARTMENT OF TRANSPORTATION

**PROPOSED
 HIGHWAY PLANS**

**FAS ROUTE 488 / (CH 53)
 SECTION (57-17)RS
 PROJECT STP-NLGC(869)
 STANDARD OVERLAY
 MCLEAN COUNTY**

C-95-058-22

**NB RAMP TO SB RAMP OF I-74 AT
 CARLOCK INTERCHANGE**

F.A.S. RTE.	SECTION	COUNTY	TOTAL SHEETS	SHEET NO.
488	(57-17)RS	MCLEAN	21	1
		ILLINOIS	CONTRACT NO. 70G15	

P-95-017-22

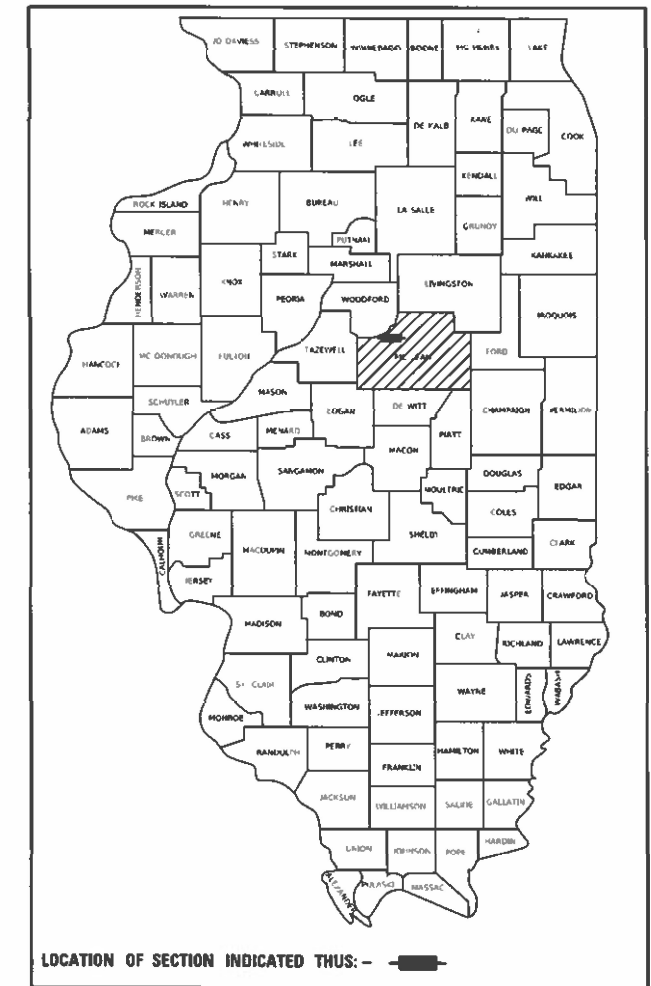

CURRENT TRAFFIC DATA

FAS 488 / (CH 53)

	ADT (2022)	PV %	SU %	MU %
LEG "A" =	450	73.3	8.9	17.8
LEG "B" =	450	71.1	11.1	17.8
LEG "C" =	450	88.8	6.7	4.5
LEG "D" =	350	82.8	8.6	8.6
LEG "E" =	1,750	79.8	9.1	11.1
LEG "F" =	1,200	86.7	5.8	7.5
LEG "G" =	950	90.5	4.2	5.3

TRAFFIC DATA LOCATIONS

- LEG "A" = I-74 EB OFF-RAMP
- LEG "B" = I-74 WB ON-RAMP
- LEG "C" = I-74 EB ON-RAMP
- LEG "D" = I-74 WB OFF-RAMP
- LEG "E" = FAS 488 EAST OF I-74 WB RAMPS
- LEG "F" = FAS 488 OVER I-74
- LEG "G" = FAS 488 WEST OF I-74 EB RAMPS

FUNCTIONAL CLASSIFICATION

MAJOR COLLECTOR

DESIGN DESIGNATION

NA

TOWNSHIP: WHITE OAK

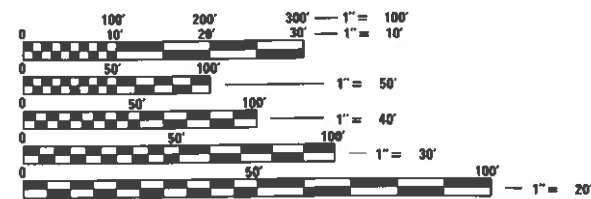

FULL SIZE PLANS HAVE BEEN PREPARED USING STANDARD ENGINEERING SCALES. REDUCED SIZED PLANS WILL NOT CONFORM TO STANDARD SCALES. IN MAKING MEASUREMENTS ON REDUCED PLANS, THE ABOVE SCALES MAY BE USED.

J.U.L.I.E.
 JOINT UTILITY LOCATION INFORMATION FOR EXCAVATORS
 1-800-892-0123
 OR 811

PROJECT ENGINEER: JASON STULTS
SQUAD LEADER: GREG EAGLIN
PHONE: (217)465-4181
CONTRACT NO. 70G15

PROJECT BEGINS:
 STA. 33+14.50

PROJECT ENDS:
 STA. 48+55.00

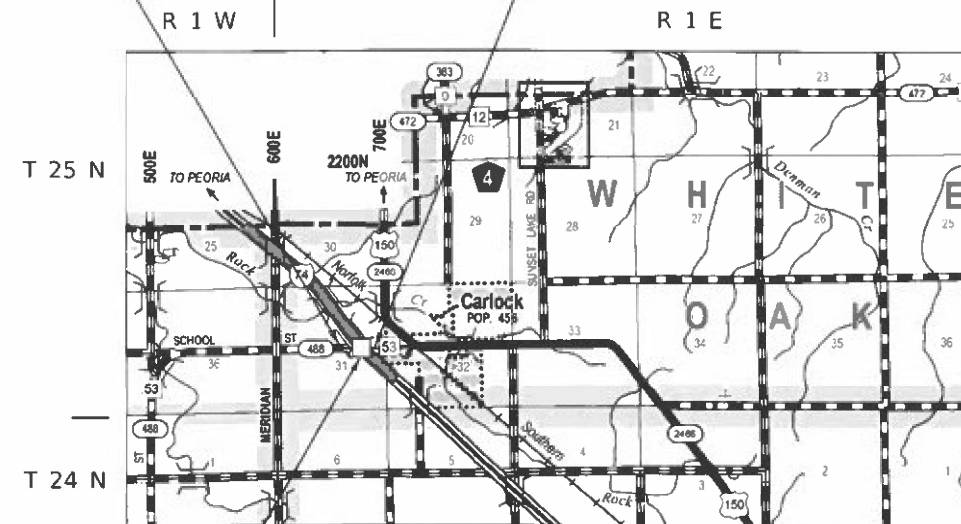

STRUCTURE OMISSION:
 S.N. 057-0102
 STA. 39+32.74 TO
 STA. 42+28.17

SCALE FOR MAIN MAP

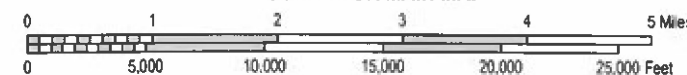

GROSS LENGTH = 1540.50 FT. = 0.292 MILE
 NET LENGTH = 1245.07 FT. = 0.236 MILE



STATE OF ILLINOIS
 DEPARTMENT OF TRANSPORTATION

SUBMITTED 2/22 2023
Kensilla Barnett swm
 REGIONAL ENGINEER

May 12, 2023 [Signature]
 ENGINEER OF DESIGN AND ENVIRONMENT

May 12, 2023 [Signature]
 DIRECTOR OF HIGHWAYS PROJECT IMPLEMENTATION

**PRINTED BY THE AUTHORITY
 OF THE STATE OF ILLINOIS**

INDEX OF SHEETS

SHEET NO.	DESCRIPTION
1	COVER SHEET
2	INDEX OF SHEETS
2	LIST OF HIGHWAY STANDARDS
2	GENERAL NOTES
3 - 4	SUMMARY OF QUANTITIES
5 - 7	EXISTING AND PROPOSED TYPICAL CROSS SECTIONS
8 - 10	SCHEDULE OF QUANTITIES
11 - 13	PLAN SHEETS
14 - 16	PAVEMENT MARKING & GUARDRAIL PLAN SHEETS
17 - 20	DETAIL FOR PAVEMENT MARKING AND MARKINGS (RURAL & URBAN TYPICAL APPLICATIONS)
21	DETAIL FOR PAVEMENT MARKING (INTERSTATE & MULTI-LANE APPLICATIONS)

LIST OF HIGHWAY STANDARDS

STANDARD NO.	NAME OF STANDARD
000001-08	STANDARD SYMBOLS, ABBREVIATIONS AND PATTERNS
001006	DECIMAL OF AN INCH AND OF A FOOT
442201-03	CLASS C AND D PATCHES
482011-03	HMA SHLD. STRIPS/SHLDS. WITH RESURFACING OR WIDENING AND RESURFACING PROJECTS
630001-12	STEEL PLATE BEAM GUARDRAIL
630301-09	SHOULDER WIDENING FOR TYPE 1 (SPECIAL) GUARDRAIL TERMINALS
701006-05	OFF-RD OPERATIONS, 2L, 2W, 15' TO 24" FROM PAVEMENT EDGE
701301-04	LANE CLOSURE, 2L, 2W, SHORT TIME OPERATIONS
701311-03	LANE CLOSURE 2L, 2W MOVING OPERATIONS-DAY ONLY
701456-05	PARTIAL EXIT RAMP CLOSURE FREEWAY / EXPRESSWAY
701501-06	URBAN LANE CLOSURE, 2L, 2W, UNDIVIDED
701901-08	TRAFFIC CONTROL DEVICES
725001-01	OBJECT AND TERMINAL MARKERS
780001-05	TYPICAL PAVEMENT MARKINGS
781001-04	TYPICAL APPLICATIONS RAISED REFLECTIVE PAVEMENT MARKERS
782006-01	GUARDRAIL AND BARRIER WALL REFLECTOR MOUNTING DETAILS

GENERAL NOTES

G.N. - 100A
ELECTRONIC FILES AND/OR ELECTRONIC SURVEY INFORMATION INCLUDING CADD FILES WILL NOT BE AVAILABLE TO THE CONTRACTOR.

G.N. - 406H
THE FOLLOWING MIXTURE REQUIREMENTS ARE APPLICABLE FOR THIS PROJECT:

LOCATION	FAS 488 / (CH 53)	FAS 488 / (CH 53)	FAS 488 / (CH 53)
MIXTURE USE	SURFACE MAINLINE, RAMPS & TOP 1 1/2" OF SHOULDERS	BINDER FG MAINLINE, RAMPS & BOTTOM 1 1/4" OF SHOULDERS	CLASS D PATCHES
AC/PG	SBS PG 70-22	SBS PG 70-22	PG 64-22
DESIGN AIR VOIDS	4.0% @ Ndes=50	4.0% @ Ndes=50	4.0% @ Ndes=50
MIX COMP(GRADATION)	IL 9.5	IL 9.5 FG	IL 19.0
FRICITION AGGREGATE	MIX "C"	N.A.	N.A.
MIXTURE WEIGHT	112	112	112
QUALITY MANAGEMENT PROGRAM	QC/QA	QC/QA	QC/QA
SUBLOT SIZE	3000	3000	3000
MATERIAL TRANSFER DEVICE (REQUIRED) ?	NO	NO	NO

G.N. 406S
PROJECT POSTED SPEED LIMITS

THE FOLLOWING TABLE IS A LISTING OF POSTED SPEED LIMITS WITHIN THE PROJECT LIMITS. THE ENGINEER SHALL FIELD VERIFY THESE LIMITS:

LOCATION	STATION	TO	STATION	POSTED SPEED LIMIT (MPH)
FAS 488 / (CH 53)	33+14.50		48+55.00	30

G.N.-703A
SHORT TERM PAVEMENT MARKING SHALL BE APPLIED TO THE PAVEMENT AFTER ANY OF THE FOLLOWING: PAVEMENT MARKING REMOVAL, COLD MILLING AND/OR PLACING BITUMINOUS MATERIALS (TACK COAT), AND BINDER & SURFACE COURSES. SHORT TERM PAVEMENT MARKING PLACED ON THE SURFACE, SHALL COINCIDE WITH THE FINAL PAVEMENT STRIPING. SHORT TERM PAVEMENT MARKING PLACED PRIOR TO THE SURFACE SHALL COINCIDE WITH THE EXISTING PAVEMENT MARKINGS. USE 4 FEET PER 40 FEET (OR 10% PER STATION).

G.N.-781
THE FINAL PAVEMENT MARKINGS SHALL BE IN PLACE PRIOR TO PLACING THE RAISED REFLECTIVE PAVEMENT MARKERS.

COMMITMENTS

THERE ARE NO COMMITMENTS FOR THIS CONTRACT.

STRUCTURE INFORMATION:

IF THE CONTRACTOR ELECTS TO USE A MATERIAL TRANSFER DEVICE (MTD), THEN THE FOLLOWING REQUIREMENTS WILL APPLY.

BASED ON STRUCTURAL ANALYSIS, THE FOLLOWING SHOULD BE NOTED WITH REGARDS TO MATERIAL TRANSFER DEVICES (MTD) TRAVELING OVER EXISTING STRUCTURES:

ONLY AN EMPTY MATERIAL TRANSFER DEVICE WITH A MAXIMUM GROSS WEIGHT OF 40 TONS MAY CROSS OVER THE FOLLOWING STRUCTURES:

S.N. 057-0102

**STATE OF ILLINOIS
DEPARTMENT OF TRANSPORTATION**

**INDEX OF SHEETS, LIST OF HIGHWAY STANDARDS,
GENERAL NOTES**

SCALE: SHEET 1 OF 1 SHEETS STA. TO STA.

F.A.S. RTE.	SECTION	COUNTY	TOTAL SHEETS	SHEET NO.
488	(57-17)RS	MCLEAN	21	2
			CONTRACT NO. 70G15	
ILLINOIS FED. AID PROJECT				

SUMMARY OF QUANTITIES

LOCATION OF WORK : FAS 488
 (CH 53)
 RURAL 2 LANE
 COUNTY : MCLEAN
 STA. 33+14.50
 TO
 STA. 48+55.00
 FUNDING BREAKOUT : 80% FED
 20% STATE
 CONSTRUCTION CODE : 0005

LOCATION OF WORK : FAS 488
 (CH 53)
 RURAL 2 LANE
 COUNTY : MCLEAN
 STA. 33+14.50
 TO
 STA. 48+55.00
 FUNDING BREAKOUT : 80% FED
 20% STATE
 CONSTRUCTION CODE : 0005

CODE NO	ITEM	UNIT	TOTAL QUANTITY
40600290	BITUMINOUS MATERIALS (TACK COAT)	POUND	4,694.0
40600370	LONGITUDINAL JOINT SEALANT	FOOT	3,736.0
40600990	TEMPORARY RAMP	SQ YD	262.0
40603215	POLYMERIZED HOT-MIX ASPHALT BINDER COURSE, 1L-9.5FG, N50	TON	337.0
40604150	POLYMERIZED HOT-MIX ASPHALT SURFACE COURSE, 1L-9.5, MIX "C", N50	TON	405.0
44000160	HOT-MIX ASPHALT SURFACE REMOVAL, 2 3/4"	SQ YD	6,954.0
44201789	CLASS D PATCHES, TYPE II, 12 INCH	SQ YD	80.0
44201794	CLASS D PATCHES, TYPE III, 12 INCH	SQ YD	93.0
48102100	AGGREGATE WEDGE SHOULDER, TYPE B	TON	70.0
48203008	HOT-MIX ASPHALT SHOULDERS, 2 3/4"	SQ YD	2,140.0
* 63000003	STEEL PLATE BEAM GUARDRAIL, TYPE A, 9 FOOT POSTS	FOOT	137.5
* 63100167	TRAFFIC BARRIER TERMINAL, TYPE 1 (SPECIAL) TANGENT	EACH	5.0

* SPECIALTY ITEM

CODE NO	ITEM	UNIT	TOTAL QUANTITY
63200310	GUARDRAIL REMOVAL	FOOT	390.0
67100100	MOEILIZATION	L SUM	1.0
70100825	TRAFFIC CONTROL AND PROTECTION, STANDARD 701456	L SUM	1.0
70102620	TRAFFIC CONTROL AND PROTECTION, STANDARD 701501	L SUM	1.0
70300100	SHORT TERM PAVEMENT MARKING	FOOT	408.0
70300150	SHORT TERM PAVEMENT MARKING REMOVAL	SQ FT	46.0
70300211	TEMPORARY PAVEMENT MARKING LETTERS AND SYMBOLS - PAINT	SQ FT	63.0
70300231	TEMPORARY PAVEMENT MARKING - LINE 5" - PAINT	FOOT	2,864.0
70300241	TEMPORARY PAVEMENT MARKING - LINE 6" - PAINT	FOOT	1,421.0
70300261	TEMPORARY PAVEMENT MARKING - LINE 12" - PAINT	FOOT	287.0
70300281	TEMPORARY PAVEMENT MARKING - LINE 24" - PAINT	FOOT	72.0
* 72501000	TERMINAL MARKER - DIRECT APPLIED	EACH	5.0

* SPECIALTY ITEM

MODEL: I:\MODEL\MHFE FILE: MHFE_Plan\Subcontract\benefy.com\PIV\DOT\Documents\DOT Office\Dir\Dir: S:\Project\70G15\CAD\Drawings\CAD\Sheet\70G15-PL-500.dwg

USER NAME = Greg.Eaglin	DESIGNED -	REVISED -
PLOT SCALE = 40,0000 */ in.	DRAWN -	REVISED -
PLOT DATE = 2/22/2023	CHECKED -	REVISED -
	DATE -	REVISED -

**STATE OF ILLINOIS
DEPARTMENT OF TRANSPORTATION**

SUMMARY OF QUANTITIES	
SCALE:	SHEET 1 OF 2 SHEETS STA. TO STA.

F.A.S. RTE.	SECTION	COUNTY	TOTAL SHEETS	SHEET NO.
488	(57-17)RS	MCLEAN	21	3
			CONTRACT NO. 70G15	
		ILLINOIS	FED. AID PROJECT	

SUMMARY OF QUANTITIES

LOCATION OF WORK : FAS 488
 (CH 53)
 RURAL 2 LANE
 COUNTY : MCLEAN
 STA. 33+14.50
 TO
 STA. 48+55.00
 FUNDING BREAKOUT : 80% FED
 20% STATE
 CONSTRUCTION CODE : 0005

CODE NO	ITEM	UNIT	TOTAL QUANTITY
*	78000100 THERMOPLASTIC PAVEMENT MARKING - LETTERS AND SYMBOLS	SQ FT	63.0
*	78000400 THERMOPLASTIC PAVEMENT MARKING - LINE 6'	FOOT	1,421.0
*	78000600 THERMOPLASTIC PAVEMENT MARKING - LINE 12"	FOOT	287.0
*	78000650 THERMOPLASTIC PAVEMENT MARKING - LINE 24"	FOOT	72.0
*	78001120 PAINT PAVEMENT MARKING - LINE 5"	FOOT	2,864.0
*	78011000 GROOVING FOR RECESSED PAVEMENT MARKING, LETTERS AND SYMBOLS	SQ FT	63.0
*	78011035 GROOVING FOR RECESSED PAVEMENT MARKING 7"	FOOT	1,421.0
*	78011065 GROOVING FOR RECESSED PAVEMENT MARKING 13"	FOOT	287.0
*	78011125 GROOVING FOR RECESSED PAVEMENT MARKING 25"	FOOT	72.0
*	78100100 RAISED REFLECTIVE PAVEMENT MARKER	EACH	18.0
*	78200005 GUARDRAIL REFLECTORS, TYPE A	EACH	8.0
	Z0013798 CONSTRUCTION LAYOUT	L SUM	1.0

* SPECIALTY ITEM

MODEL: \\MODEL\MAME
 FILE: \\MAIL: public\paw_bentley.com\PIV\DOT\Documents\DOT Office\Dir\dir: S:\Project\70G15\CAD\DATA\CAD\Sheet\70G15-PL-500.dgn

USER NAME = Greg.Eaglin	DESIGNED -	REVISED -
	DRAWN -	REVISED -
PLOT SCALE = 40,0000 */ in.	CHECKED -	REVISED -
PLOT DATE = 2/22/2023	DATE -	REVISED -

**STATE OF ILLINOIS
DEPARTMENT OF TRANSPORTATION**

SUMMARY OF QUANTITIES

SCALE: SHEET 2 OF 2 SHEETS STA. TO STA.

F.A.S. RTE.	SECTION	COUNTY	TOTAL SHEETS	SHEET NO.
488	(57-17)RS	MCLEAN	21	4
CONTRACT NO. 70G15				
ILLINOIS FED. AID PROJECT				

A EXISTING TYPICAL CROSS SECTION

STATION	TO	STATION
33+14.50		39+32.74
B 42+28.17		B 48+55.00

STRUCTURE OMISSION:
 S.N. 057-0102
 STA. 39+32.74 TO
 STA. 42+28.17

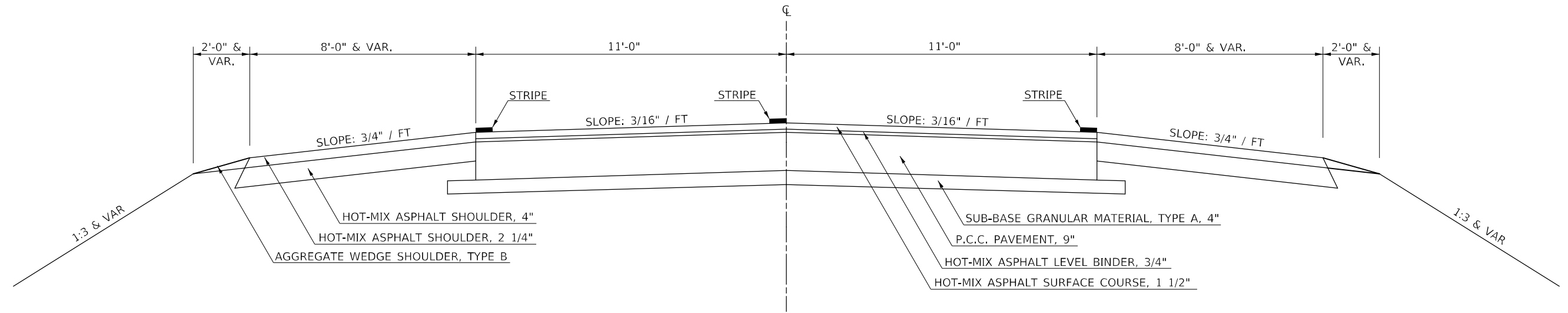

1 PROPOSED TYPICAL CROSS SECTION

STATION	TO	STATION
33+14.50		39+32.74
2 42+28.17		2 48+55.00

STRUCTURE OMISSION:
 S.N. 057-0102
 STA. 39+32.74 TO
 STA. 42+28.17

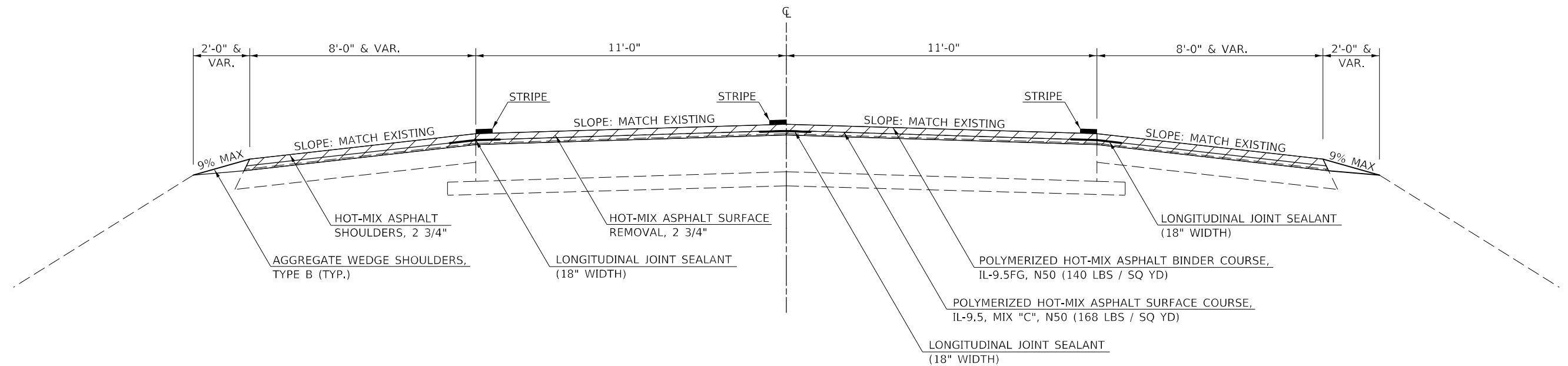

HOT-MIX ASPHALT SURFACE REMOVAL, 2 3/4"

MODEL: \\MODEL\NAME
 FILE: \\NAME\PROJECT\DRAWING\COM\PROJECT\DOCUMENTS\DOT\OFFICE\DIR\DR: S:\PROJECT\057015\CADD\DATA\CAD\PROJECTS\057015\PLN-TYPICAL.dgn

USER NAME = Greg.Eaglin	DESIGNED -	REVISED -
	DRAWN -	REVISED -
PLOT SCALE = 40,0000 * / in.	CHECKED -	REVISED -
PLOT DATE = 2/22/2023	DATE -	REVISED -

**STATE OF ILLINOIS
 DEPARTMENT OF TRANSPORTATION**

TYPICAL CROSS SECTION FAS 488 (CH 53)			
SCALE:	SHEET 1	OF 3 SHEETS	STA. TO STA.

F.A.S. RTE.	SECTION	COUNTY	TOTAL SHEETS	SHEET NO.
488	(57-17)RS	MCLEAN	21	5
CONTRACT NO. 70G15			ILLINOIS FED. AID PROJECT	

B EXISTING TYPICAL CROSS SECTION

STATION TO STATION
 A 39+32.74 TO 42+28.17 A

STRUCTURE OMISSION:
 S.N. 057-0102
 STA. 39+32.74 TO
 STA. 42+28.17

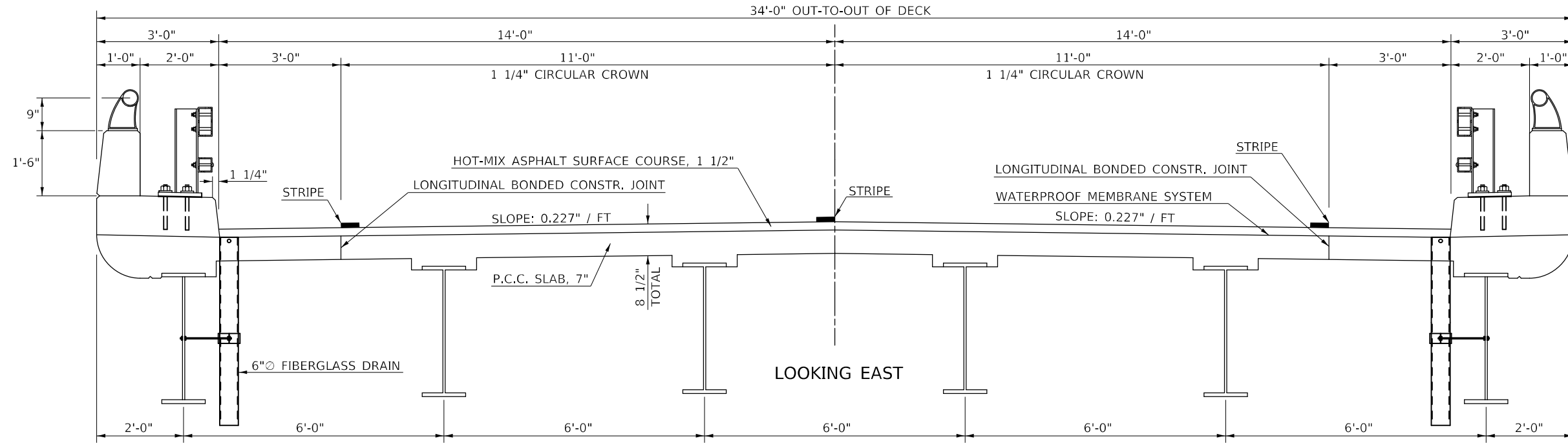

2 PROPOSED TYPICAL CROSS SECTION

STATION TO STATION
 1 39+32.74 TO 42+28.17 1

STRUCTURE OMISSION:
 S.N. 057-0102
 STA. 39+32.74 TO
 STA. 42+28.17

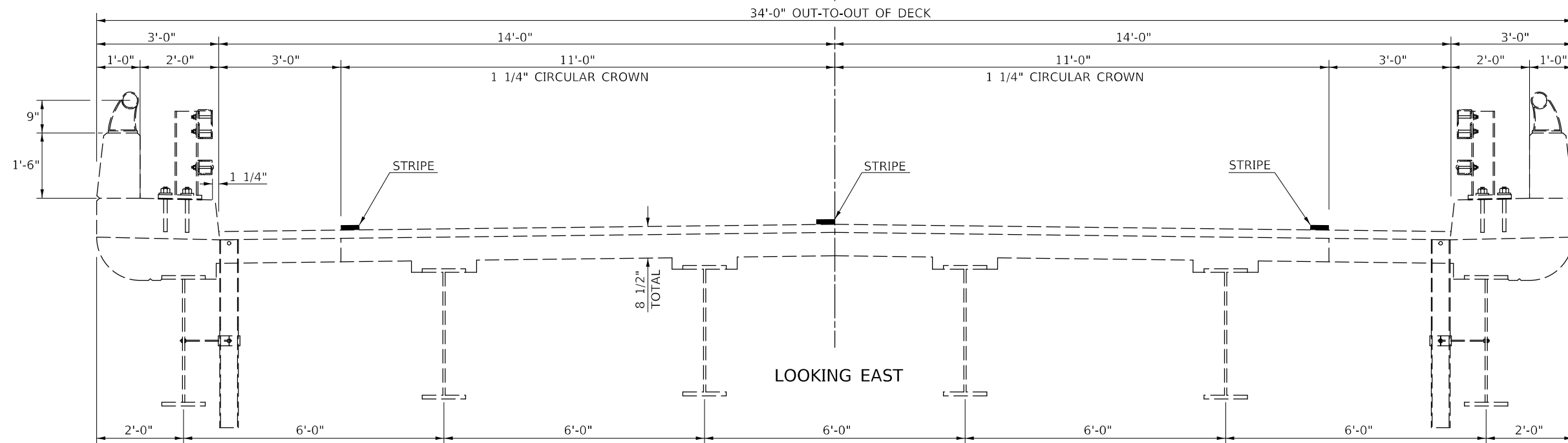

MODEL: I:\MODEL\NAME: FILE: NAME: PROJECT: I:\PROJECT\570615\CADD\DATA\CAD\PROJECTS\570615\15-TYPICAL.dgn

USER NAME = Greg.Eaglin	DESIGNED -	REVISED -
	DRAWN -	REVISED -
PLOT SCALE = 40,0000 * / in.	CHECKED -	REVISED -
PLOT DATE = 2/22/2023	DATE -	REVISED -

**STATE OF ILLINOIS
 DEPARTMENT OF TRANSPORTATION**

**TYPICAL CROSS SECTION
 S.N. 057-0102**

SCALE: SHEET 2 OF 3 SHEETS STA. TO STA.

F.A.S. RTE.	SECTION	COUNTY	TOTAL SHEETS	SHEET NO.
488	(57-17)RS	MCLEAN	21	6
CONTRACT NO. 70G15			ILLINOIS FED. AID PROJECT	

③ EXISTING TYPICAL CROSS SECTION

STATION	TO	STATION
RAMP A		RAMP A
RAMP B		RAMP B
RAMP C		RAMP C
RAMP D		RAMP D

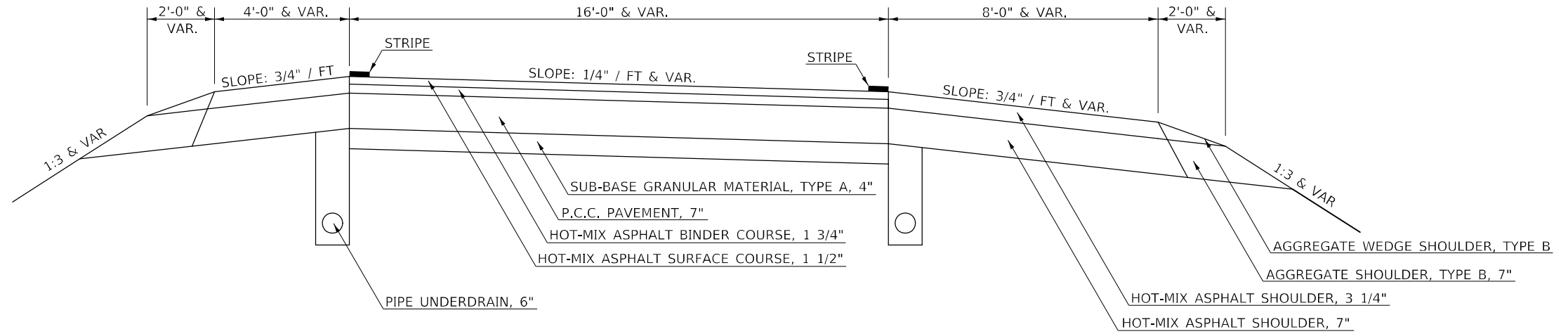

③ PROPOSED TYPICAL CROSS SECTION

STATION	TO	STATION
RAMP A		RAMP A
RAMP B		RAMP B
RAMP C		RAMP C
RAMP D		RAMP D

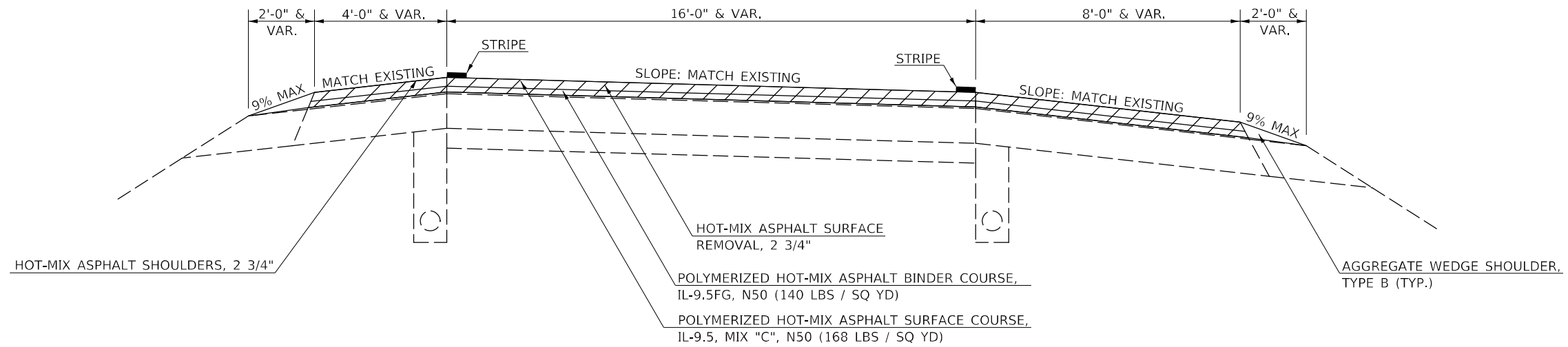

HOT-MIX ASPHALT SURFACE REMOVAL, 2 3/4"

MODEL: \\MODEL\MAME FILE: \\MAILS_P\pub\cpx\bea\paw.com\PIV\DOT\Documents\DOT\Office\Dir\dr. S\Project\0570G15\CAD\DATA\CAD\Sheet\0570G15-ht-Typical.dgn

USER NAME = Greg.Eaglin	DESIGNED -	REVISED -
	DRAWN -	REVISED -
PLOT SCALE = 40,0000 * / in.	CHECKED -	REVISED -
PLOT DATE = 2/22/2023	DATE -	REVISED -

**STATE OF ILLINOIS
DEPARTMENT OF TRANSPORTATION**

**TYPICAL CROSS SECTION
FAI-74 / (I-74) INTERCHANGE RAMP**

SCALE: SHEET 3 OF 3 SHEETS STA. TO STA.

F.A.S. RTE.	SECTION	COUNTY	TOTAL SHEETS	SHEET NO.
488	(57-17)RS	MCLEAN	21	7
ILLINOIS FED. AID PROJECT			CONTRACT NO. 70G15	

SCHEDULE OF QUANTITIES

HOT-MIX ASPHALT SCHEDULE

LOCATION		STATION	TO	STATION	LENGTH (FT)	AVERAGE WIDTH (FT)	AREA (SQ YD)	HMA BINDER THICKNESS (INCHES)	HMA SURFACE THICKNESS (INCHES)	HMA SHOULDER THICKNESS (INCHES)	44000160 HMA SURFACE REMOVAL, 2-3/4" (SQ YD)	40600290 BITUMINOUS MATERIAL TACK COAT (POUND)	40600370 LONGITUDINAL JOINT SEALANT **(SEE NOTE) (FOOT)	40603215 POLYMERIZED HOT-MIX ASPHALT BINDER COURSE IL-9.5FG, N50 (TON)	40604150 POLYMERIZED HOT-MIX ASPHALT SURFACE COURSE IL-9.5, MIX"C", N50 (TON)	48203008 HOT-MIX ASPHALT SHOULDERS, 2 3/4" (SQ YD)		
RT.	CH 53	MAINLINE		33+14.50		39+32.74	618.24	11.30	776.23	1.25	1.5		776.23	523.96	1854.72	54.34	65.20	91.57
RT.	CH 53	SHOULDER		33+14.50		34+15.00	100.50	8.20	91.57		2.75		91.57	61.81				91.57
RT.	CH 53	SHOULDER		35+15.00		37+39.00	224.00	9.00	224.00		2.75		224.00	151.20				224.00
RT.	CH 53	SHOULDER		37+39.00		39+41.95	202.95	5.60	126.28		2.75		126.28	85.24				126.28
RT.	CH 53	MAINLINE		42+28.17		48+55.00	626.83	11.00	766.13	1.25	1.5		766.13	517.13	1880.49	53.63	64.35	98.49
RT.	CH 53	SHOULDER		42+37.54		44+08.00	170.46	5.20	98.49		2.75		98.49	66.48				98.49
RT.	CH 53	SHOULDER		44+08.00		46+22.00	214.00	8.50	202.11		2.75		202.11	136.43				202.11
RT.	CH 53	SHOULDER		47+93.00		48+55.00	62.00	7.20	49.60		2.75		49.60	33.48				49.60
RT.	RAMP B	MAINLINE					388.00		388.00	1.25	1.5		388.00	261.90		27.16	32.59	109.00
RT.	RAMP B	S.W. SHOULDER					109.00		109.00		2.75		109.00	73.58				109.00
RT.	RAMP B	S.F. SHOULDER					56.00		56.00		2.75		56.00	37.80				56.00
RT.	RAMP D	MAINLINE					495.00		495.00	1.25	1.5		495.00	334.13		34.65	41.58	43.00
RT.	RAMP D	S.W. SHOULDER					43.00		43.00		2.75		43.00	29.03				43.00
RT.	RAMP D	S.E. SHOULDER					64.00		64.00		2.75		64.00	43.20				64.00
LT.	CH 53	MAINLINE		33+14.50		39+32.74	618.24	11.00	755.63	1.25	1.5		755.63	510.05		52.89	63.47	43.99
LT.	CH 53	SHOULDER		33+14.50		33+68.00	53.50	7.40	43.99		2.75		43.99	29.69				43.99
LT.	CH 53	SHOULDER		35+34.50		37+28.00	193.50	8.10	174.15		2.75		174.15	117.55				174.15
LT.	CH 53	SHOULDER		37+28.00		39+23.50	195.50	5.50	119.47		2.75		119.47	80.64				119.47
LT.	CH 53	MAINLINE		42+28.17		48+55.00	626.83	11.30	787.02	1.25	1.5		787.02	531.24		55.09	66.11	110.83
LT.	CH 53	SHOULDER		42+18.65		44+00.00	181.35	5.50	110.83		2.75		110.83	74.81				110.83
LT.	CH 53	SHOULDER		44+00.00		46+22.00	222.00	7.70	189.93		2.75		189.93	128.21				189.93
LT.	CH 53	SHOULDER		47+40.00		48+55.00	115.00	8.00	102.22		2.75		102.22	69.00				102.22
LT.	RAMP A	MAINLINE					522.00		522.00	1.25	1.5		522.00	352.35		36.54	43.85	98.00
LT.	RAMP A	N.W. SHOULDER					98.00		98.00		2.75		98.00	66.15				98.00
LT.	RAMP A	N.E. SHOULDER					64.00		64.00		2.75		64.00	43.20				64.00
LT.	RAMP C	MAINLINE					324.00		324.00	1.25	1.5		324.00	218.70		22.68	27.22	62.00
LT.	RAMP C	N.W. SHOULDER					62.00		62.00		2.75		62.00	41.85				62.00
LT.	RAMP C	N.E. SHOULDER					111.00		111.00		2.75		111.00	74.93				111.00

TOTAL =	6953.64	4693.71	3735.21	336.98	404.38	2139.64
USE =	6954.00	4694.00	3736.00	337.00	405.00	2140.00
	SQ YD	POUND	FOOT	TON	TON	SQ YD

****NOTE:**
LONGITUDINAL JOINT SEALANT SHALL BE PLACED ALONG THE CENTERLINE JOINT AND ALONG THE EDGE OF PAVEMENT JOINT ON BOTH SIDES OF THE PAVEMENT AS SHOWN IN THE TYPICAL CROSS SECTIONS.

CLASS D PATCHING SCHEDULE

LOCATION	NUMBER OF PATCHES (QTY)	LENGTH (FT)	AVERAGE WIDTH (FT)	QUANTITY PER PATCH SIZE (SQ YD)	44201789	44201794
					TYPE II, 12" (SQ YD)	TYPE III, 12" (SQ YD)
CH 53	10.0	4.0	11.25	5.00	50.00	
CH 53	4.0	6.0	11.25	7.50	30.00	
CH 53	3.0	14.0	11.25	17.50		52.50
CH 53	2.0	16.0	11.25	20.00		40.00
TOTAL =					80.00	92.50
USE =					80.00	93.00
					SQ YD	SQ YD

NOTE:
FIELD INSPECTION HAS DETERMINED THAT THE QUANTITY OF PATCHES SHOWN IN THE SCHEDULE MAY BE NEEDED FOR THIS CONTRACT. THE ROADWAY STATIONS ARE NOT SHOWN, BUT WILL BE DETERMINED IN THE FIELD BY THE ENGINEER.

70300100 SHORT TERM PAVEMENT MARKING

70300150 SHORT TERM PAVEMENT MARKING REMOVAL

LOCATION	STATION	TO	STATION	70300100	APPLY AFTER	COLOR	70300150
				QUANTITY (FT)			QUANTITY (SQ FT)
C.L. SKIP-DASH	33+14.50		39+32.74	204.00	MILLING, BINDER, & SURFACE	YELLOW	22.67
C.L. SKIP-DASH	42+28.17		48+55.00	204.00	MILLING, BINDER, & SURFACE	YELLOW	22.67
TOTAL =				408.00			45.33
USE =				408.00			46.00
				FT			SQ FT

NOTES:
SHORT TERM PAVEMENT MARKINGS WILL NOT BE REQUIRED ON THE SHOULDERS.
SHORT TERM PAVEMENT MARKINGS WILL BE REMOVED FROM THE FINAL SURFACE ONLY.

MODEL: \\MODEL\MRFS
FILE: \\MAILS_PUB\pub\scsh\beadefy.com\FW\DOT\Documents\DOT_Offices\Dir\dir_5\Project\0570G15\CAD\DATA\CAD\Revised\0570G15-H-SP-Schedule.dgn

USER NAME = Greg.Eaglin	DESIGNED -	REVISED -
	DRAWN -	REVISED -
PLOT SCALE = 40,0000 * / in.	CHECKED -	REVISED -
PLOT DATE = 2/22/2023	DATE -	REVISED -

**STATE OF ILLINOIS
DEPARTMENT OF TRANSPORTATION**

SCHEDULE OF QUANTITIES

SCALE: SHEET 1 OF 3 SHEETS STA. TO STA.

F.A.S. RTE.	SECTION	COUNTY	TOTAL SHEETS	SHEET NO.
488	(57-17)RS	MCLEAN	21	8
CONTRACT NO. 70G15				
ILLINOIS FED. AID PROJECT				

SEC. 31, T.25N., R.1E., 3RD P.M.

SEC. 31, T.25N., R.1E., 3RD P.M.

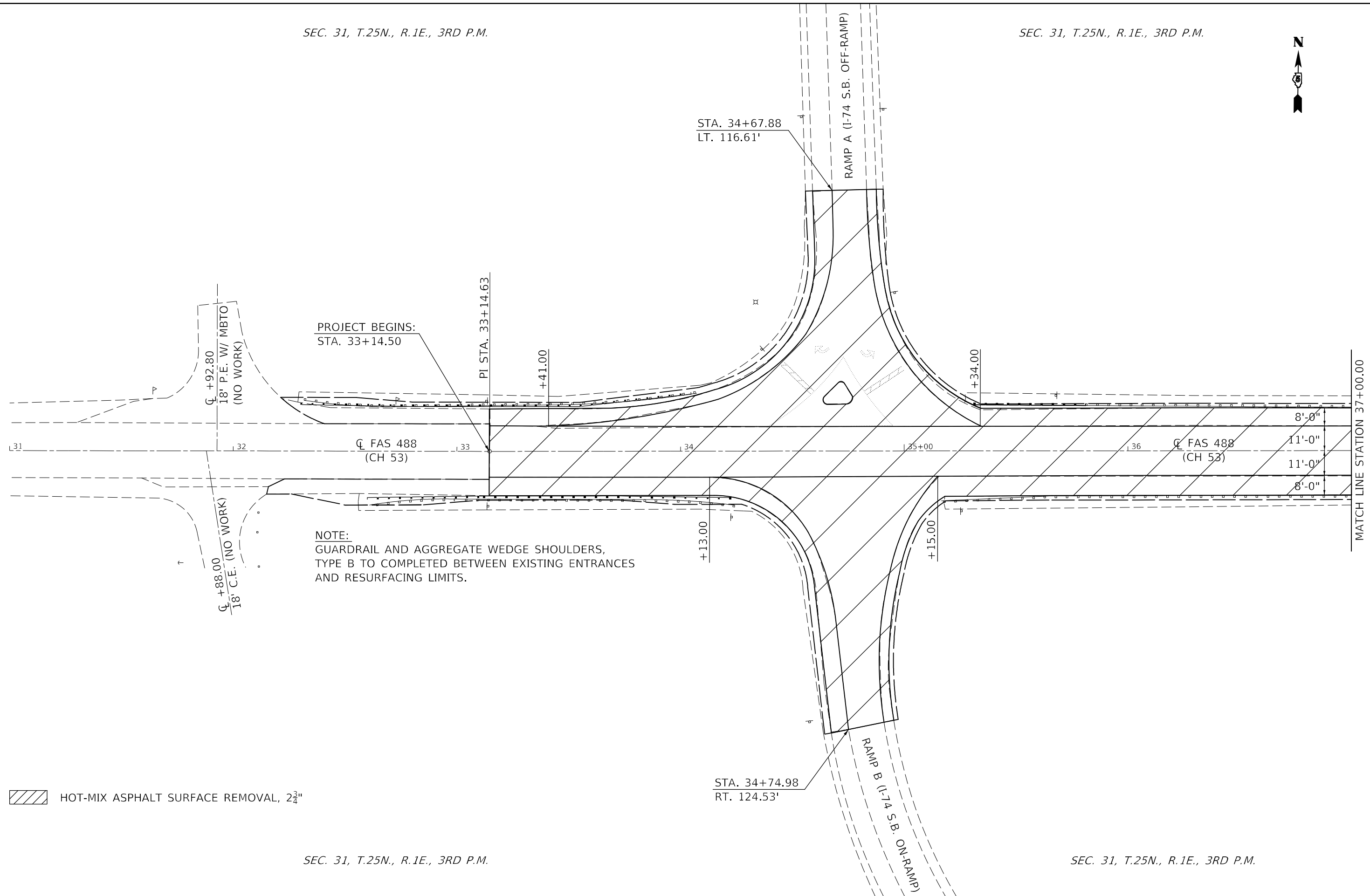

PROJECT BEGINS:
STA. 33+14.50

NOTE:
GUARDRAIL AND AGGREGATE WEDGE SHOULDERS,
TYPE B TO COMPLETED BETWEEN EXISTING ENTRANCES
AND RESURFACING LIMITS.

HOT-MIX ASPHALT SURFACE REMOVAL, 2 3/4"

SEC. 31, T.25N., R.1E., 3RD P.M.

SEC. 31, T.25N., R.1E., 3RD P.M.

MODEL: \\MODEL\MAME
FILE: \\MAILS_P\public\paw_bendley.com\PI\DOT\Documents\DOT_Offices\Dir\dr_5\Project\70G15\CADD\DATA\CAD\Sheet\70G15-PLN-20.dgn

USER NAME = Greg.Eaglin	DESIGNED -	REVISED -
	DRAWN -	REVISED -
PLOT SCALE = 40,0000 * / in.	CHECKED -	REVISED -
PLOT DATE = 2/22/2023	DATE -	REVISED -

**STATE OF ILLINOIS
DEPARTMENT OF TRANSPORTATION**

PLAN SHEET (CH 53)

SCALE: SHEET 1 OF 3 SHEETS STA. 31+00.00 TO STA. 37+00.00

F.A.S. RTE.	SECTION	COUNTY	TOTAL SHEETS	SHEET NO.
488	(57-17)RS	MCLEAN	21	11
CONTRACT NO. 70G15				
ILLINOIS FED. AID PROJECT				

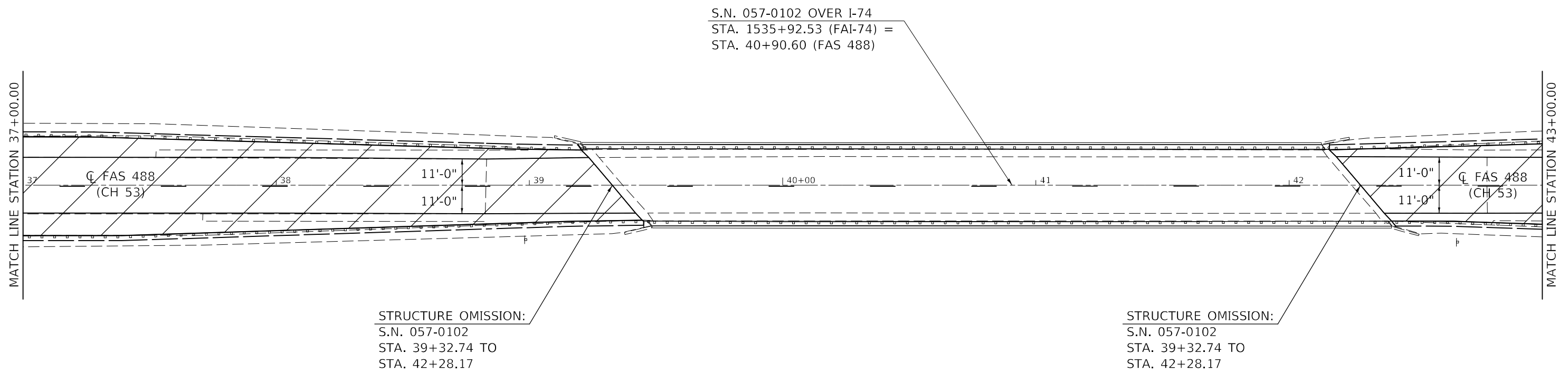

STRUCTURE OMISSION:
S.N. 057-0102
STA. 39+32.74 TO
STA. 42+28.17

STRUCTURE OMISSION:
S.N. 057-0102
STA. 39+32.74 TO
STA. 42+28.17

HOT-MIX ASPHALT SURFACE REMOVAL, 2 3/4"

MODEL: I:\MODELS\MHFE...
FILE: MHFE...
PROJECT: I:\PROJECTS\70G15\CADD\CADD\CAD\Drawings\70G15-PLN-20.dwg

USER NAME = Greg.Eaglin	DESIGNED -	REVISED -
	DRAWN -	REVISED -
PLOT SCALE = 40,0000 * / in.	CHECKED -	REVISED -
PLOT DATE = 2/22/2023	DATE -	REVISED -

**STATE OF ILLINOIS
DEPARTMENT OF TRANSPORTATION**

PLAN SHEET (CH 53)

SCALE: SHEET 2 OF 3 SHEETS STA. 37+00.00 TO STA. 43+00.00

F.A.S. RTE.	SECTION	COUNTY	TOTAL SHEETS	SHEET NO.
488	(57-17)RS	MCLEAN	21	12
CONTRACT NO. 70G15				
ILLINOIS FED. AID PROJECT				

SEC. 31, T.25N., R.1E., 3RD P.M.

SEC. 31, T.25N., R.1E., 3RD P.M.

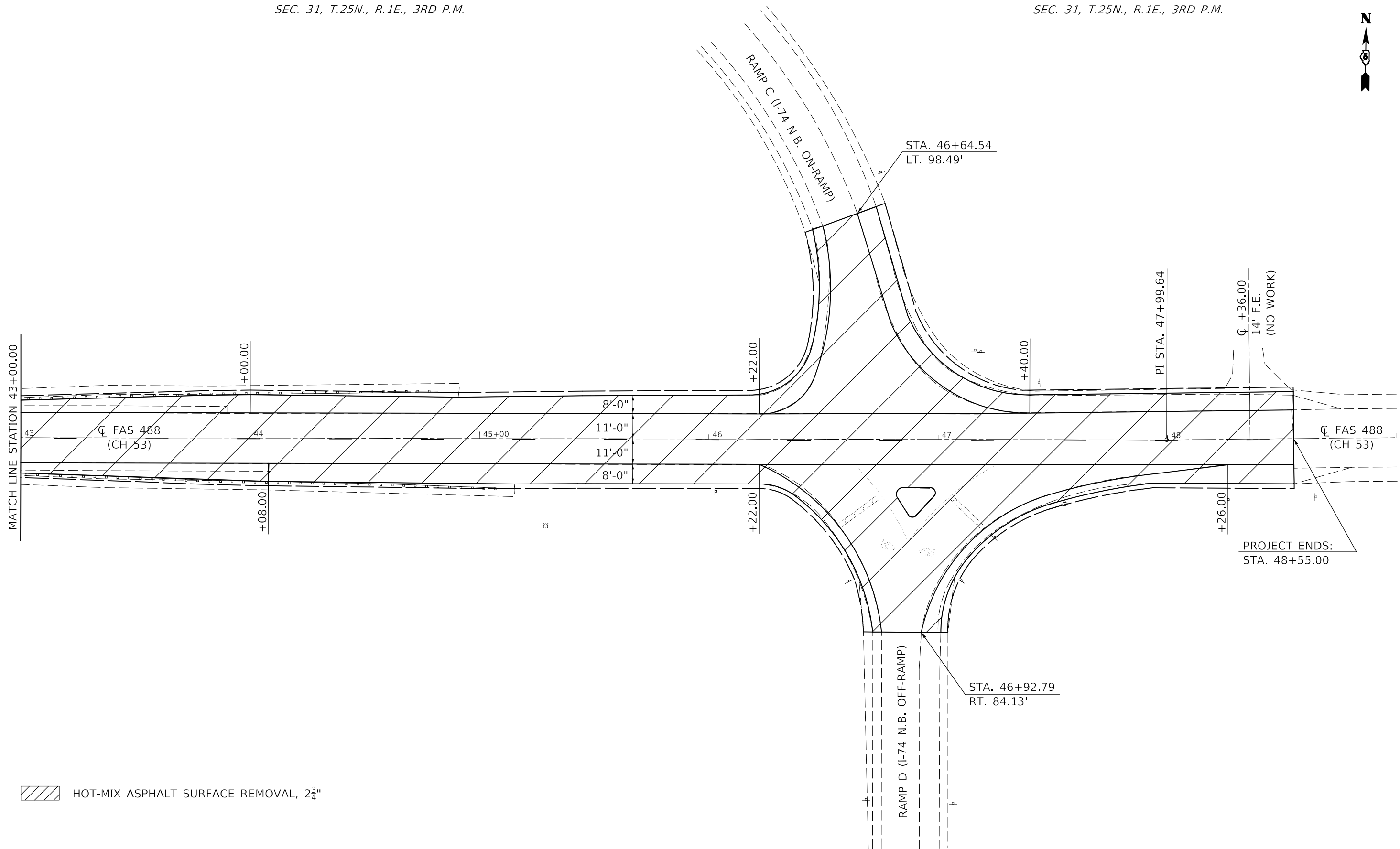

HOT-MIX ASPHALT SURFACE REMOVAL, 2 3/4"

SEC. 31, T.25N., R.1E., 3RD P.M.

SEC. 31, T.25N., R.1E., 3RD P.M.

MODEL: \\MODEL\MAME
FILE: \\MAILS_PUB\Public\paw_beaufay.com\PIV\DOT\Documents\DOT_Offices\Dir\dr: S:\Project\0570G15\CAD\DATA\CAD\Sheet\0570G15-PIV-Plan_20.dgn

USER NAME = Greg.Eaglin	DESIGNED -	REVISED -
	DRAWN -	REVISED -
PLOT SCALE = 40,0000 * / in.	CHECKED -	REVISED -
PLOT DATE = 2/22/2023	DATE -	REVISED -

**STATE OF ILLINOIS
DEPARTMENT OF TRANSPORTATION**

PLAN SHEET (CH 53)

SCALE: SHEET 3 OF 3 SHEETS STA. 43+00.00 TO STA. 49+00.00

F.A.S. RTE.	SECTION	COUNTY	TOTAL SHEETS	SHEET NO.
488	(57-17)RS	MCLEAN	21	13
CONTRACT NO. 70G15			ILLINOIS FED. AID PROJECT	

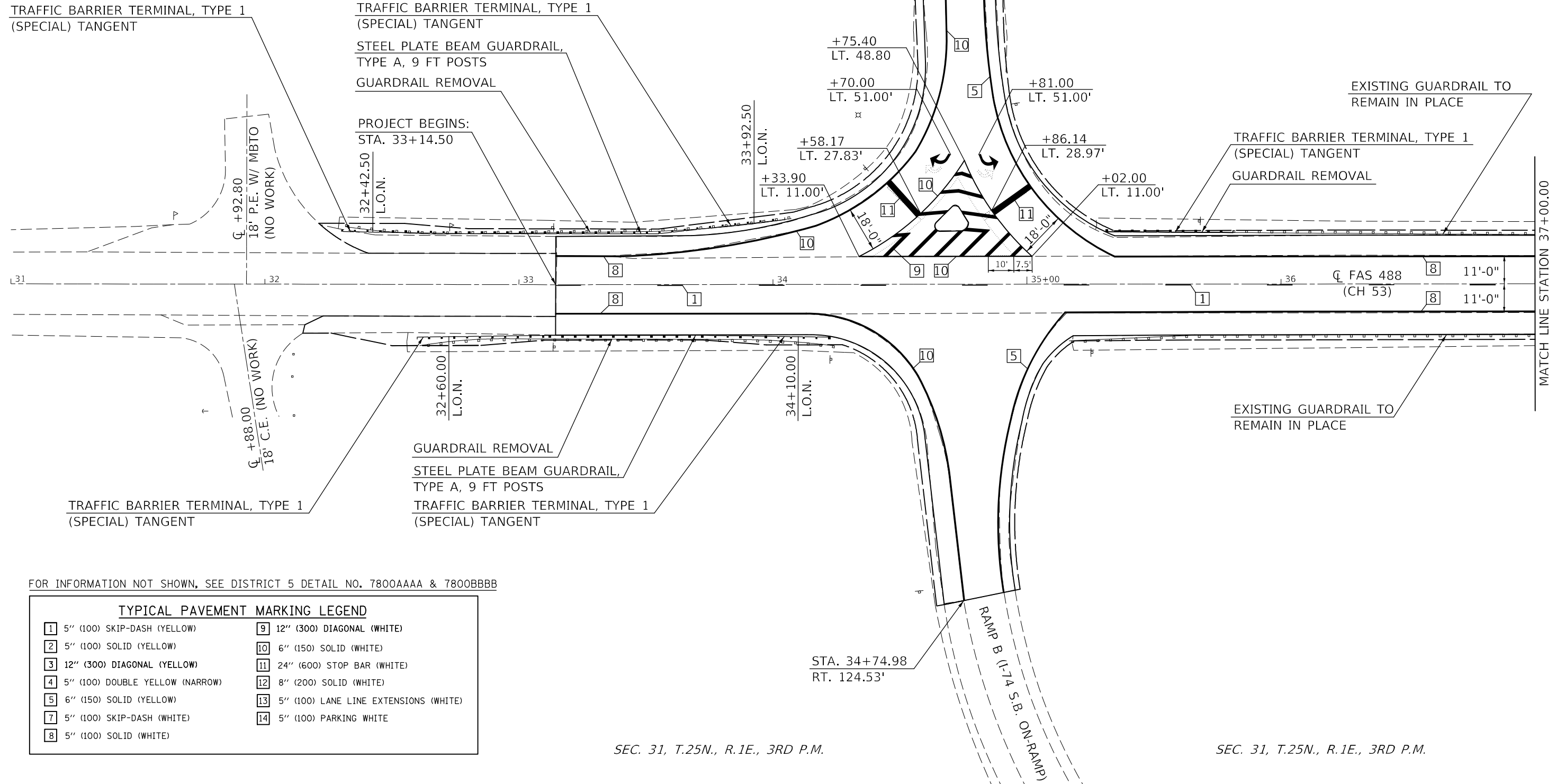
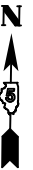

MATCH LINE STATION 37+00.00

FOR INFORMATION NOT SHOWN, SEE DISTRICT 5 DETAIL NO. 7800AAAA & 7800BBBB

TYPICAL PAVEMENT MARKING LEGEND	
1 5" (100) SKIP-DASH (YELLOW)	9 12" (300) DIAGONAL (WHITE)
2 5" (100) SOLID (YELLOW)	10 6" (150) SOLID (WHITE)
3 12" (300) DIAGONAL (YELLOW)	11 24" (600) STOP BAR (WHITE)
4 5" (100) DOUBLE YELLOW (NARROW)	12 8" (200) SOLID (WHITE)
5 6" (150) SOLID (YELLOW)	13 5" (100) LANE LINE EXTENSIONS (WHITE)
6 5" (100) SKIP-DASH (WHITE)	14 5" (100) PARKING WHITE
7 5" (100) SOLID (WHITE)	
8 5" (100) SOLID (WHITE)	

MODEL: I:\MODEL\MMF5
FILE: MMF5_Plan\I-74 S.B. Off-Ramp\DOT Office\Drawings\Project\70G15\CADD\Drawings\Sheet\70G15-PL-PMK.dgn

USER NAME = Greg.Eaglin	DESIGNED -	REVISED -
PLOT SCALE = 40,0000 * / in.	DRAWN -	REVISED -
PLOT DATE = 2/22/2023	CHECKED -	REVISED -
	DATE -	REVISED -

**STATE OF ILLINOIS
DEPARTMENT OF TRANSPORTATION**

**PAVEMENT MARKING & GUARDRAIL
PLAN SHEET**

SCALE: SHEET 1 OF 3 SHEETS STA. 31+00.00 TO STA. 37+00.00

F.A.S. RTE.	SECTION	COUNTY	TOTAL SHEETS	SHEET NO.
488	(57-17)RS	MCLEAN	21	14
CONTRACT NO. 70G15			ILLINOIS FED. AID PROJECT	

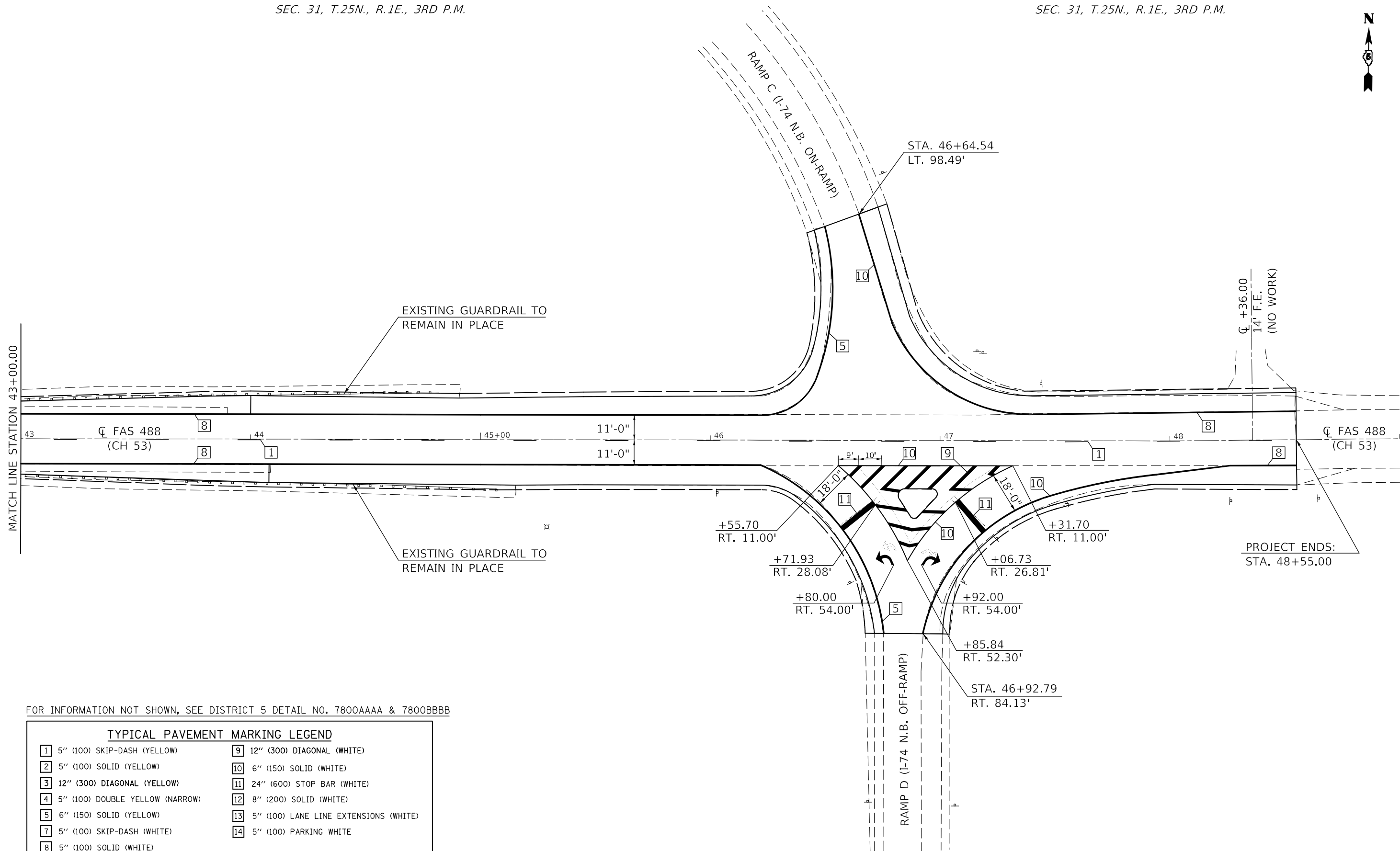

FOR INFORMATION NOT SHOWN, SEE DISTRICT 5 DETAIL NO. 7800AAAA & 7800BBBB

TYPICAL PAVEMENT MARKING LEGEND	
1 5" (100) SKIP-DASH (YELLOW)	9 12" (300) DIAGONAL (WHITE)
2 5" (100) SOLID (YELLOW)	10 6" (150) SOLID (WHITE)
3 12" (300) DIAGONAL (YELLOW)	11 24" (600) STOP BAR (WHITE)
4 5" (100) DOUBLE YELLOW (NARROW)	12 8" (200) SOLID (WHITE)
5 6" (150) SOLID (YELLOW)	13 5" (100) LANE LINE EXTENSIONS (WHITE)
7 5" (100) SKIP-DASH (WHITE)	14 5" (100) PARKING WHITE
8 5" (100) SOLID (WHITE)	

MODEL: I:\MODEL\MARF...
 FILE: MARF...
 PROJECT: I:\PROJECT\70G15\CADD\DATA\CAD\PROJECTS\70G15-PL-PMK.dgn

USER NAME = Greg.Eaglin	DESIGNED -	REVISED -
PLOT SCALE = 40,0000 */ in.	DRAWN -	REVISED -
PLOT DATE = 2/22/2023	CHECKED -	REVISED -
	DATE -	REVISED -

**STATE OF ILLINOIS
DEPARTMENT OF TRANSPORTATION**

**PAVEMENT MARKING & GUARDRAIL
PLAN SHEET**

SCALE: SHEET 3 OF 3 SHEETS STA. 43+00.00 TO STA. 49+00.00

F.A.S. RTE.	SECTION	COUNTY	TOTAL SHEETS	SHEET NO.
488	(57-17)RS	MCLEAN	21	16
CONTRACT NO. 70G15			ILLINOIS FED. AID PROJECT	

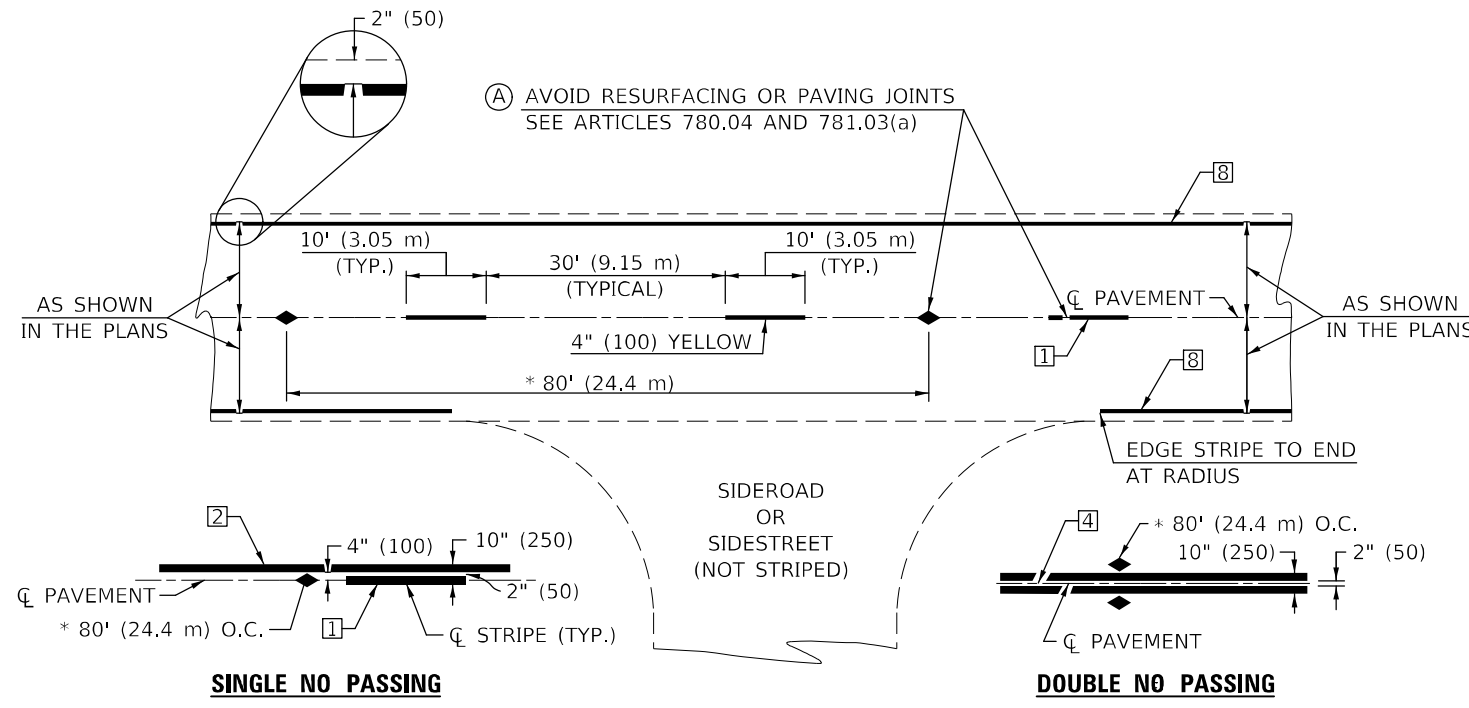

(A) AVOID RESURFACING OR PAVING JOINTS
SEE ARTICLES 780.04 AND 781.03(a)

SINGLE NO PASSING

DOUBLE NO PASSING

* REDUCE TO 40' (12.2 m) O.C. ON
CURVES WITH POSTED OR ADVISORY
SPEEDS OF 45 mph (70 km/h) OR LESS.

TWO LANE/TWO WAY

TYPICAL PAVEMENT MARKING LEGEND

- 1 5" (100) SKIP-DASH (YELLOW)
- 2 5" (100) SOLID (YELLOW)
- 3 12" (300) DIAGONAL (YELLOW)
- 4 5" (100) DOUBLE YELLOW (NARROW)
- 5 RESERVED
- 6 RESERVED
- 7 5" (100) SKIP-DASH (WHITE)
- 8 5" (100) SOLID (WHITE)
- 9 12" (300) DIAGONAL (WHITE)
- 10 6" (150) SOLID (WHITE)
- 11 24" (600) STOP BAR (WHITE)
- 12 8" (200) SOLID (WHITE)
- 13 5" (100) LANE LINE EXTENSIONS (WHITE)
- 14 5" (100) PARKING WHITE

TYPICAL PAVEMENT MARKERS LEGEND

- ◆ TWO-WAY AMBER MARKER
- ▶ ONE-WAY AMBER MARKER
- ▷ ONE-WAY CRYSTAL MARKER

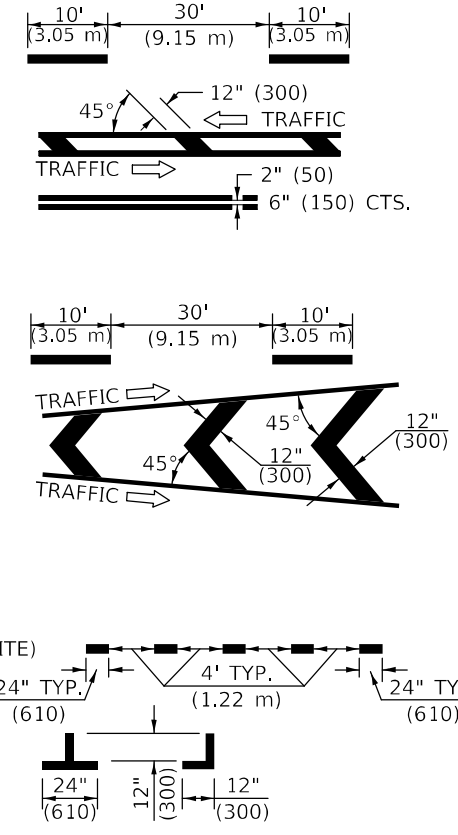

RURAL LEFT TURN

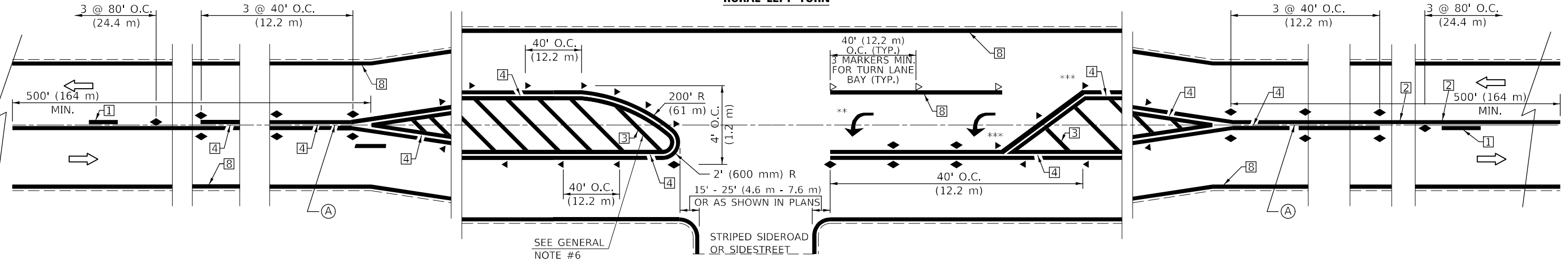

*** REDUCE SPACING IF NECESSARY TO ASSURE
MARKERS AT CORNER POINTS.
** TURN ARROWS SHALL BE PLACED
AS SHOWN ON SHEET #2.

Note: All dimensions are in INCHES
(millimeters) unless otherwise shown.

MODEL: I:\MODEL MARKS
FILE: MARKS_PAVEMENT.PLT
PROJECT: I:\PROJECTS\70G15\CADD\DATA\Documents\DOT\Office\Drawings\Project\70G15-PAVEMENT.PLT

USER NAME = Greg.Eaglin	DESIGNED -	REVISED - 4/2014 JLA
	DRAWN -	REVISED - 3/2019 SWN
PLOT SCALE = 40,0000 * / in.	CHECKED -	REVISED - 8/2022 JLA
PLOT DATE = 2/22/2023	DATE -	REVISED - 9/2022 JWS

**STATE OF ILLINOIS
DEPARTMENT OF TRANSPORTATION**

**PAVEMENT MARKING AND MARKERS
(RURAL & URBAN APPLICATIONS)**

SCALE: SHEET 1 OF 4 SHEETS STA. TO STA.

DISTRICT 5 DETAIL NO. 7800AAAA				
F.A.S. RTE.	SECTION	COUNTY	TOTAL SHEETS	SHEET NO.
488	(57-17)RS	MCLEAN	21	17
			CONTRACT NO. 70G15	
ILLINOIS FED. AID PROJECT				

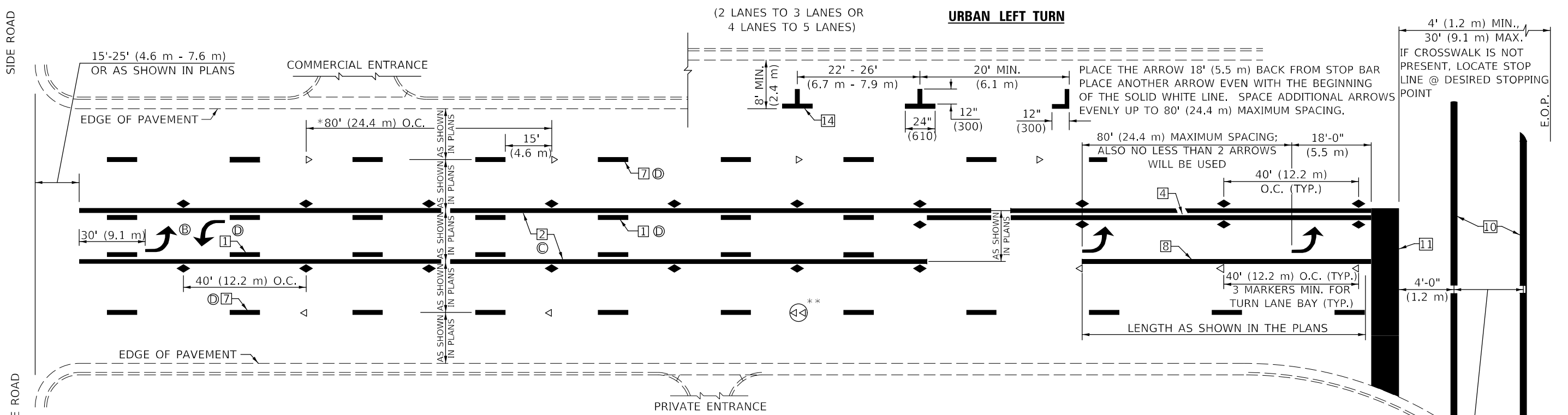

* REDUCE TO 40 FEET (12.2 METERS) ON CENTER ON CURVES WHERE ADVISORY SPEEDS ARE 10 MPH (15 km/h) LOWER THAN POSTED SPEEDS.

** DOUBLE LANE LINE MARKERS SHALL BE SPECIFIED AND SPACED AS SHOWN IN HIGHWAY STANDARD 781001 FOR MULTI-LANE DIVIDED AND UNDIVIDED HIGHWAYS.

GENERAL NOTES:

- Ⓑ TURN ARROW PAIRS SHALL BE PLACED AT 250' (75 m) INTERVALS AND SHALL BE EVENLY SPACED BETWEEN BOTH ENDS OF THE BIDIRECTIONAL LEFT TURN LANE.
- Ⓒ THE SOLID YELLOW PAVEMENT MARKINGS [2] SHOULD GENERALLY START OR END NEAR THE RADIUS POINT OF EACH STREET RETURN EXCEPT WHERE ONE OR BOTH ENDS WOULD INCLUDE STOP BARS.
- Ⓓ THE SKIP-DASH PAVEMENT MARKINGS [1] OR [7] SHOULD BE CENTERED BETWEEN BOTH ENDS OF EACH CITY BLOCK AND SHALL BE PLACED SO THEY LINE UP ACROSS FROM EACH OTHER. SEE EXAMPLE ON SHEET 2 OF 3.
- Ⓔ USE LARGE ARROW SIZE FOR BOTH RURAL AND URBAN LOCATIONS. (SEE LAST PAGE OF SECTION 780x FOR SYMBOLS TABLE)

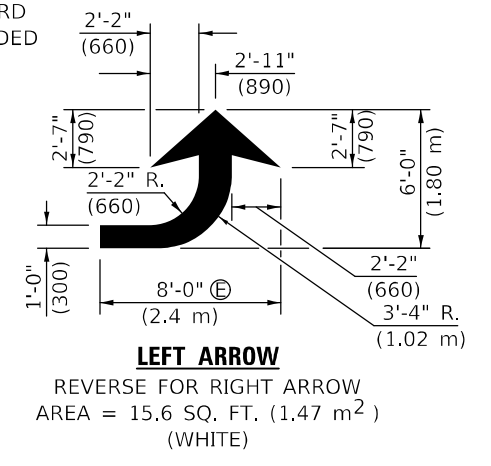

LEFT ARROW

REVERSE FOR RIGHT ARROW
AREA = 15.6 SQ. FT. (1.47 m²)
(WHITE)

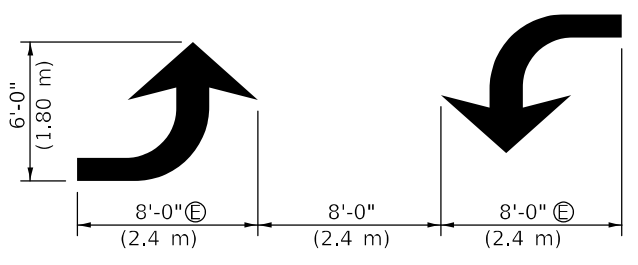

TYPICAL DOUBLE TURN ARROWS (WHITE)

BLOOMINGTON-NORMAL CITY LIMITS ONLY

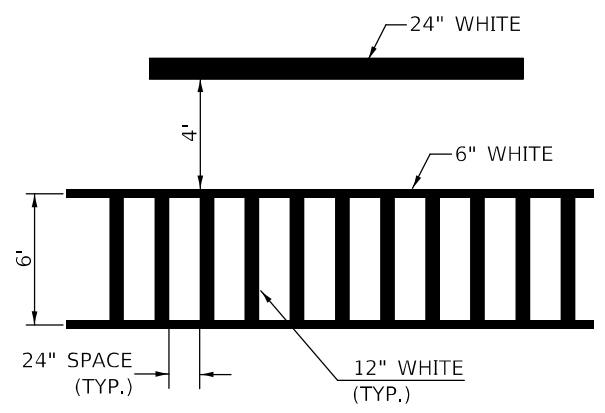

TYPICAL SPACING FOR CROSSWALKS & STOP BARS

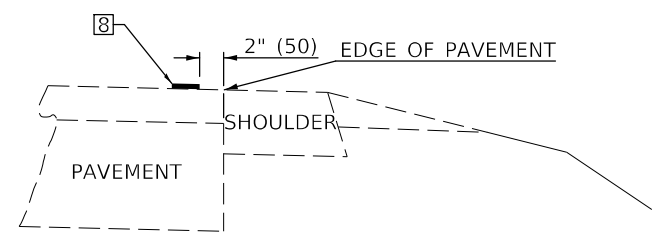

RELATIONSHIP OF EDGE LINE TO EDGE OF PAVEMENT

(SAFETY SHOULDER OR PAVED SURFACE)
SEE ARTICLE 780.04

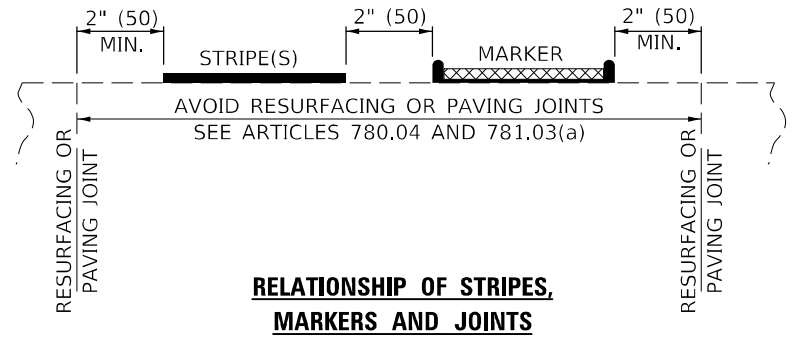

RELATIONSHIP OF STRIPES, MARKERS AND JOINTS

Note: All dimensions are in INCHES (millimeters) unless otherwise shown.

MODEL: I:\MODELS\MAR15... FILE NAME: P:\Public\paw_bendley.com\PIV\DOT\Documents\DOT_Offices\Dir\dr... S:\Project\0570G15\CADD\DATA\CAD\References\70G15-PIV-Detail.kgm

USER NAME = Greg.Eaglin	DESIGNED -	REVISED - 4/2014 JLA
	DRAWN -	REVISED - 3/2019 SWN
PLOT SCALE = 40,0000 * / in.	CHECKED -	REVISED - 8/2022 JLA
PLOT DATE = 2/22/2023	DATE -	REVISED - 9/2022 JWS

**STATE OF ILLINOIS
DEPARTMENT OF TRANSPORTATION**

**PAVEMENT MARKING AND MARKERS
(RURAL & URBAN APPLICATIONS)**

SCALE: SHEET 2 OF 4 SHEETS STA. TO STA.

DISTRICT 5 DETAIL NO. 7800AAAA				
F.A.S. RTE.	SECTION	COUNTY	TOTAL SHEETS	SHEET NO.
488	(57-17)RS	MCLEAN	21	18
			CONTRACT NO. 70G15	
ILLINOIS FED. AID PROJECT				

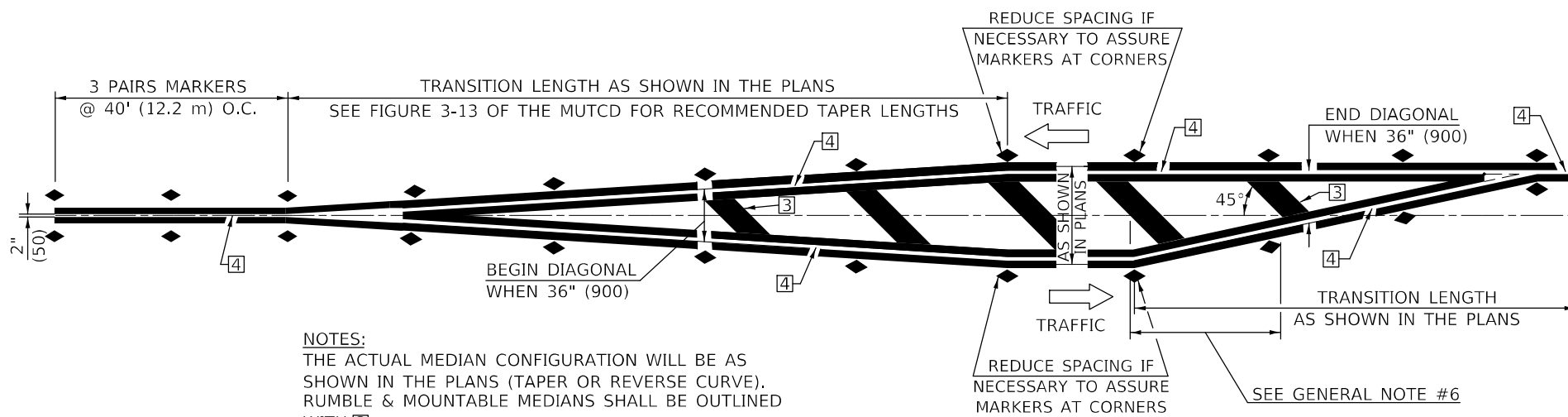

NOTES:
THE ACTUAL MEDIAN CONFIGURATION WILL BE AS SHOWN IN THE PLANS (TAPER OR REVERSE CURVE). RUMBLE & MOUNTABLE MEDIANS SHALL BE OUTLINED WITH [2].

TYPICAL MEDIAN TRANSITIONS

GENERAL NOTES

1. WHEN MEDIANS ARE PRESENT, PAVEMENT MARKINGS ARE TO BE PLACED ADJACENT TO MEDIANS.
2. SOME OF THE INFORMATION INCLUDED WITH THIS DETAIL MAY NOT BE APPLICABLE TO THIS IMPROVEMENT.
3. PAVEMENT MARKINGS ARE TO BE EXTENDED THROUGH OMISSIONS WHEN APPLICABLE.
4. A STRIPING KEY IS AVAILABLE ELSEWHERE AND SHALL BE SHOWN WHERE THE QUANTITIES ARE LISTED.
5. FINAL PAVEMENT MARKINGS SHALL BE IN PLACE PRIOR TO PLACING ANY RAISED REFLECTIVE PAVEMENT MARKERS.
6. THE FOLLOWING CRITERIA SHALL BE USED FOR SELECTING THE DIAGONAL PAVEMENT MARKING SPACING,
 <30 MPH USE 15' (<50 km/h USE 4.5 m)
 30-45 MPH USE 20' (50-75 km/h USE 6.0 m)
 >45 MPH USE 30' (>75 km/h USE 9.0 m)

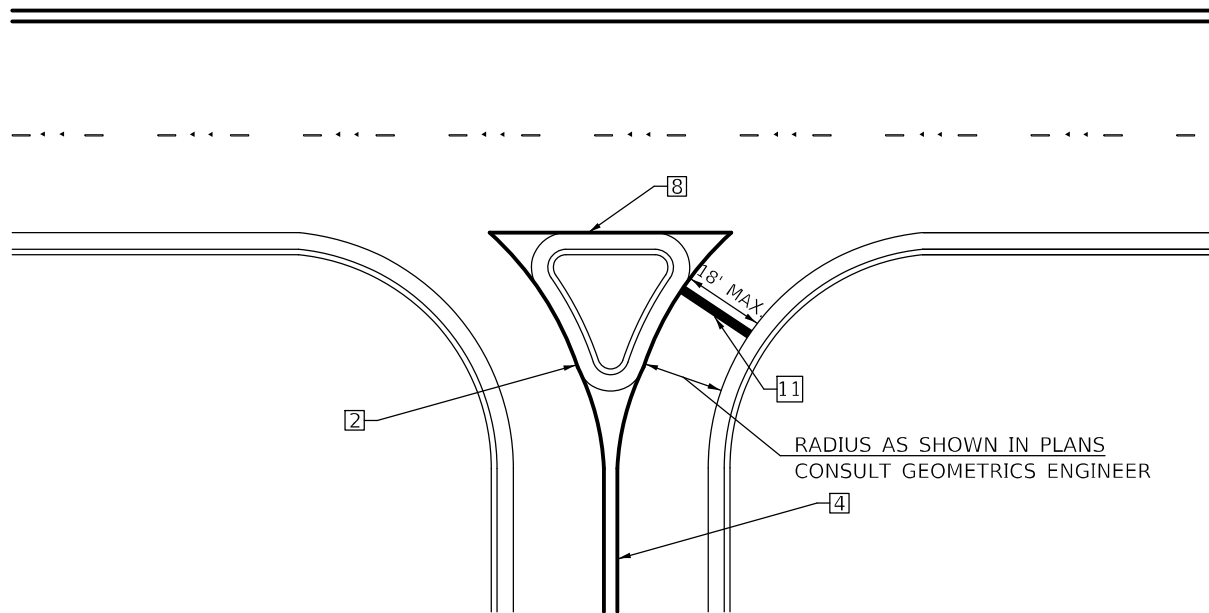

RIGHT IN - RIGHT OUT ACCESS

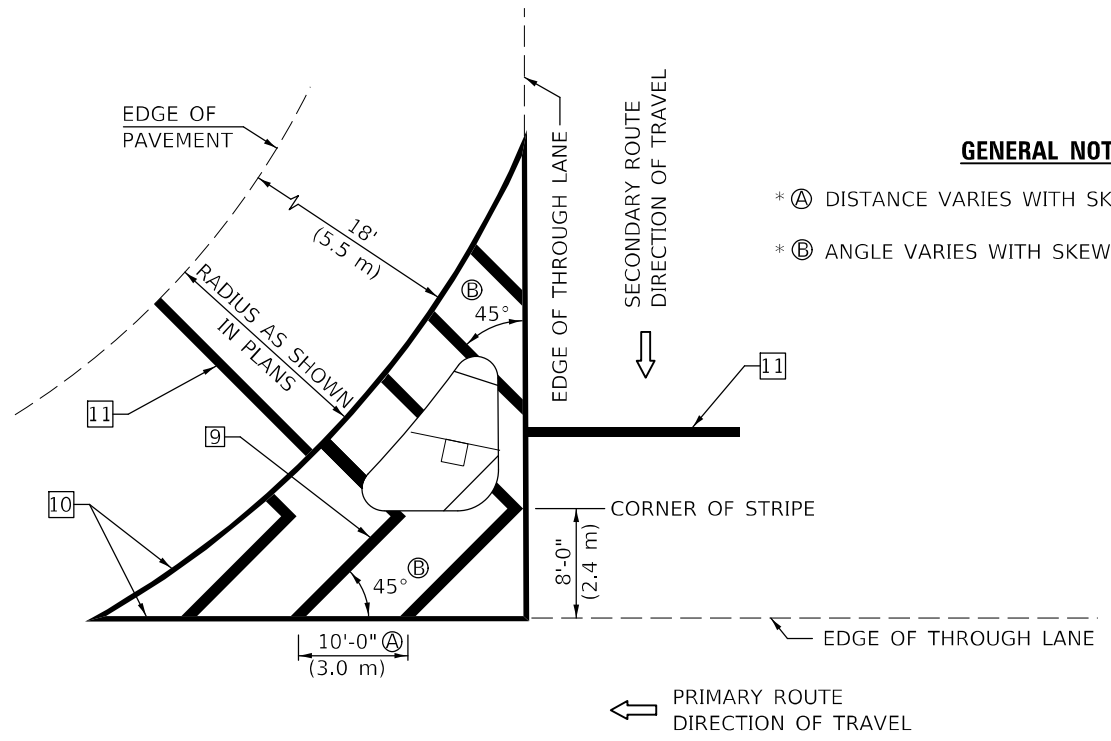

ISLAND

GENERAL NOTES

- * A DISTANCE VARIES WITH SKEW OF INTERSECTION.
- * B ANGLE VARIES WITH SKEW OF INTERSECTION.

* FOR RIGHT TURN LANE AND ISLAND STRIPING CONSULT GEOMETRICS ENGINEER.

Note: All dimensions are in INCHES (millimeters) unless otherwise shown.

MODEL: I:\MODEL MARKS FILE: MARKS_PAVEMENT.dwg, DATE: 2/22/2023, PROJECT: I:\PROJECTS\70G15\CADD\DATA\CAD\PROJECTS\70G15-PAVEMENT.dwg

USER NAME = Greg.Eaglin	DESIGNED -	REVISED - 4/2014 JLA
	DRAWN -	REVISED - 3/2019 SWN
PLOT SCALE = 40,0000 * / in.	CHECKED -	REVISED - 8/2022 JLA
PLOT DATE = 2/22/2023	DATE -	REVISED - 9/2022 JWS

**STATE OF ILLINOIS
DEPARTMENT OF TRANSPORTATION**

**PAVEMENT MARKING AND MARKERS
(RURAL & URBAN APPLICATIONS)**

SCALE: SHEET 3 OF 4 SHEETS STA. TO STA.

DISTRICT 5 DETAIL NO. 7800AAAA				
F.A.S. RTE.	SECTION	COUNTY	TOTAL SHEETS	SHEET NO.
488	(57-17)RS	MCLEAN	21	19
			CONTRACT NO. 70G15	
ILLINOIS FED. AID PROJECT				

DESIGNER NOTE: SEE TABLE 2C-4 OF THE MUTCD FOR ADDITIONAL INFORMATION

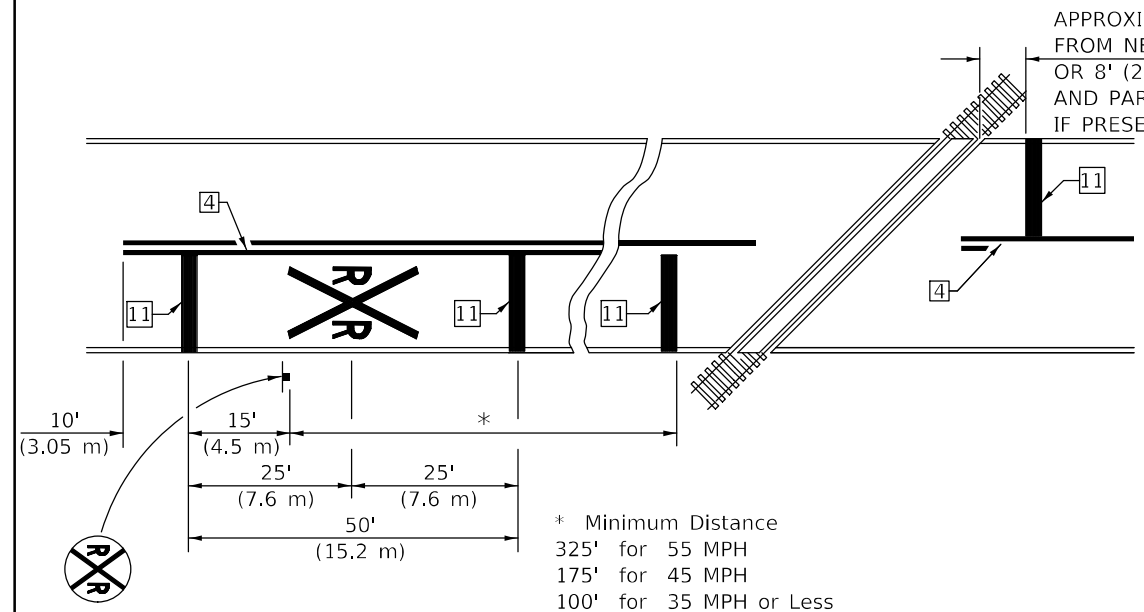

PAVEMENT MARKINGS AT RAILROAD-HIGHWAY GRADE CROSSING

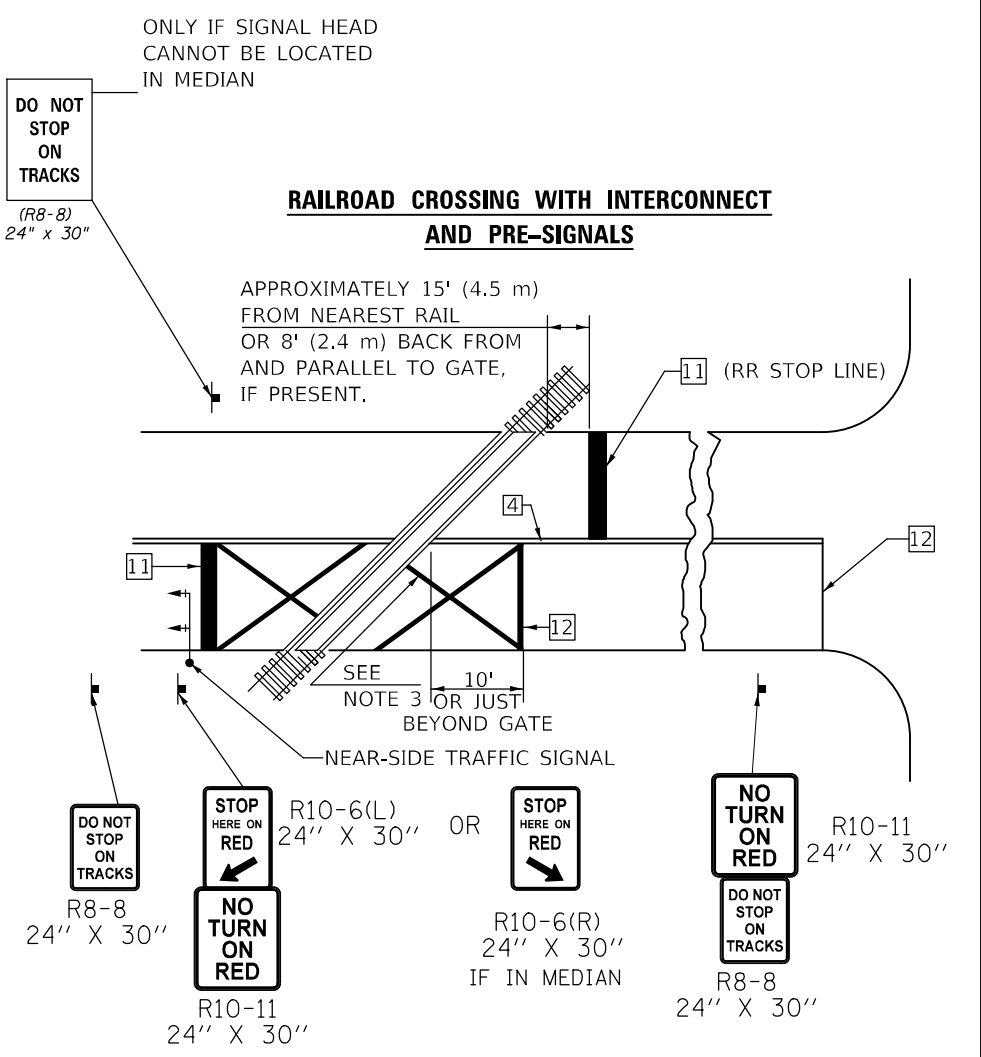
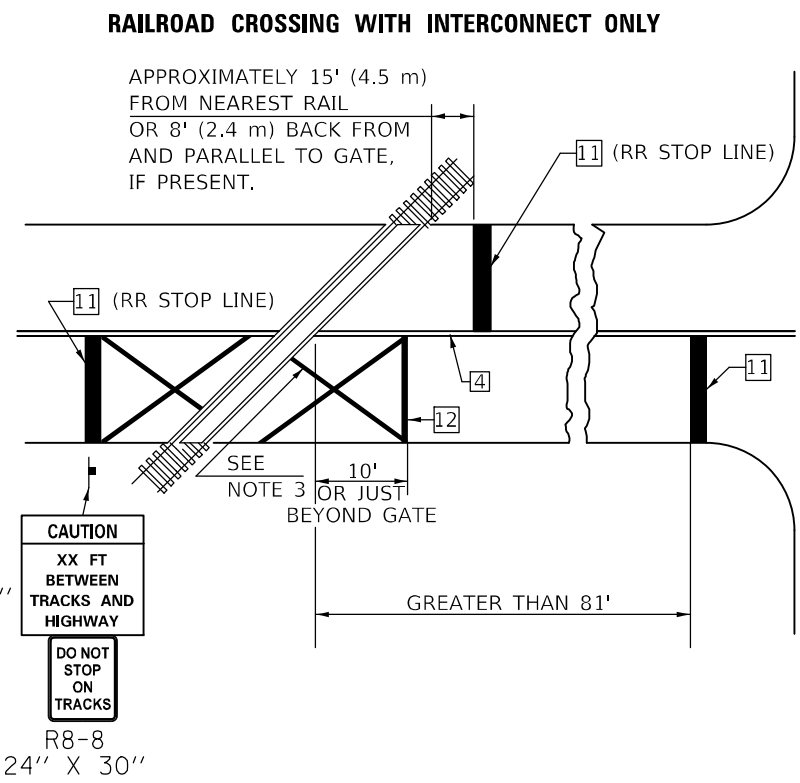

SUPPLEMENTAL PAVEMENT MARKING TREATMENT FOR RAILROAD-HIGHWAY GRADE CROSSING

ALTERNATE SIGNS

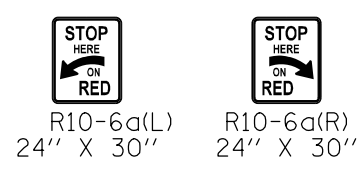

NOTES

THE TRAVERSE SPREAD OF THE "X" MAY VARY ACCORDING TO LANE WIDTH.

ON MULTI-LANE ROADS, THE STOP LINES SHALL EXTEND ACROSS ALL APPROACH LANES AND SEPARATE RXR SYMBOLS SHALL BE PLACED ADJACENT TO EACH OTHER IN EACH LANE.

WHEN THE PAVEMENT MARKING SYMBOL IS USED, A PORTION OF THE SYMBOL SHOULD BE LOCATED DIRECTLY ADJACENT TO THE ADVANCE WARNING SIGN (W10-1) AS PLACED BY TABLE II-1, CONDITION B OF THE MUTCD.

GENERAL NOTES

1. SUPPLEMENTAL PAVEMENT MARKINGS TO BE INSTALLED ONLY ON APPROACHES TO INTERSECTIONS CONTROLLED BY TRAFFIC SIGNALS WHICH ARE INTERCONNECTED WITH THE RAILROAD WARNING SIGNALS.
2. EXTEND PAVEMENT MARKINGS TO THE INTERSECTION ONLY WHERE NEAR-SIDE TRAFFIC SIGNALS ARE USED.
3. 6" WHITE PAVEMENT MARKINGS AT 45° TO PAVEMENT, 8' CENTER TO CENTER.
4. XX DISTANCE TO BE SHOWN ON SIGN MEASURED FROM A POINT 6 FEET FROM THE RAIL CLOSEST TO THE INTERSECTION OR FROM THE CLOSEST POINT ALONG THE EXIT GATE IF PRESENT OVER THE ROADWAY WHEN IN THE LOWERED POSITION TO THE STOP BAR OR CROSSWALK, WHICH EVER IS CLOSEST, ROUNDED DOWN TO NEAREST 5 FEET. WHERE THERE IS NO STOP LINE, MEASURE TO POINT WHERE DRIVER HAS A VIEW OF APPROACHING TRAFFIC.
5. THE CLEARANCE SIGN IS ALSO TO BE USED AS AN INTERIM MEASURE AT LOCATIONS WITH INTERCONNECTED INTERSECTION TRAFFIC SIGNALS WHERE IT IS PLANNED TO CHANGE THEM TO NEAR-SIDE SIGNALS AT A FUTURE TIME. IN THIS CASE, THE DISTANCE TO BE SHOWN ON THE SIGN IS MEASURED FROM THE EDGE OF THE STRIPED-OUT AREA INSTEAD OF 6 FEET FROM THE RAIL. THE SIGN IS TO BE REMOVED WHEN THE NEAR-SIDE SIGNALS ARE INSTALLED AND THE PAVEMENT MARKINGS EXTENDED TO THE INTERSECTION.

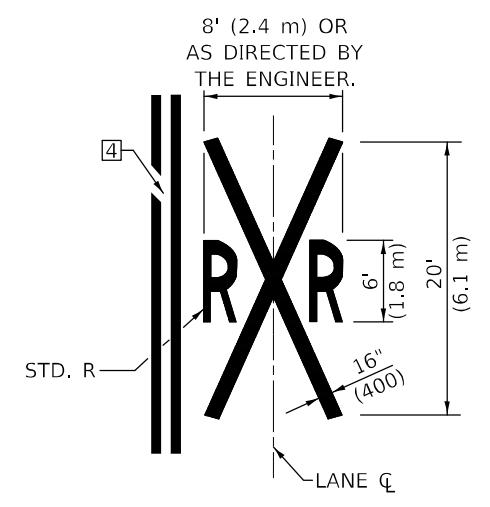

Note: All dimensions are in INCHES (millimeters) unless otherwise shown.

DISTRICT 5 DETAIL NO. 7800AAAA

USER NAME = Greg.Eaglin	DESIGNED -	REVISED - 4/2014 JLA
	DRAWN -	REVISED - 3/2019 SWN
PLOT SCALE = 40,0000 * / in.	CHECKED -	REVISED - 8/2022 JLA
PLOT DATE = 2/22/2023	DATE -	REVISED - 9/2022 JWS

STATE OF ILLINOIS DEPARTMENT OF TRANSPORTATION

PAVEMENT MARKING AND MARKERS (RURAL & URBAN APPLICATIONS)

SCALE: SHEET 4 OF 4 SHEETS STA. TO STA.

F.A.S. RTE.	SECTION	COUNTY	TOTAL SHEETS	SHEET NO.
488	(57-17)RS	MCLEAN	21	20
CONTRACT NO. 70G15				
ILLINOIS FED. AID PROJECT				

CENTERLINE INTERSTATE OR MULTI-LANE TWO WAY DIVIDED HIGHWAY

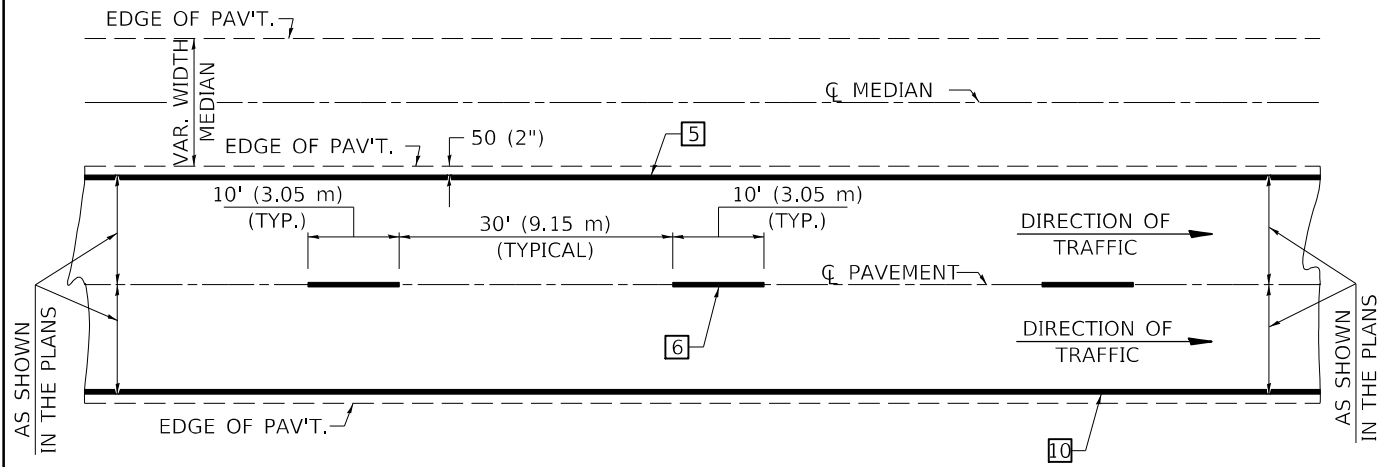

NOTE: PAVEMENT MARKINGS ARE TO BE EXTENDED THROUGH OMISSIONS WHEN APPLICABLE.

NOTE: SEE ARTICLES 780.04 & 781.03 FOR LOCATION OF STRIPES AND MARKERS RELATIVE TO EDGES OR JOINTS.

FOR RAISED REFLECTIVE PAVEMENT MARKERS, REFER TO STANDARD 781001.

TYPICAL PAVEMENT MARKING LEGEND

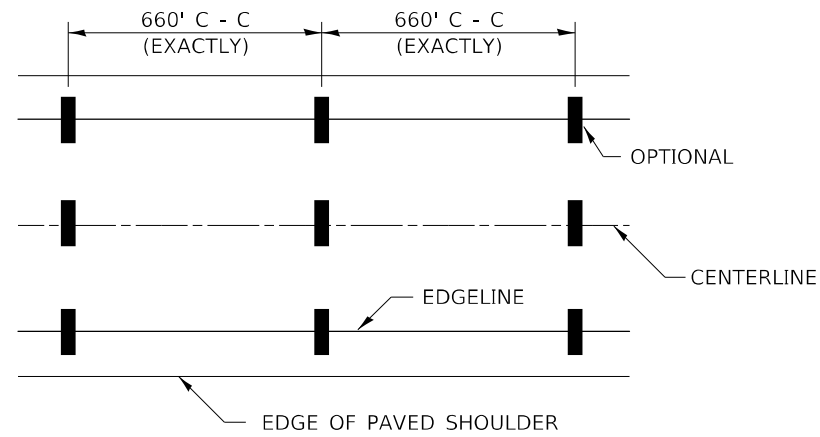

IT WILL BE NECESSARY TO HAVE A REPRESENTATIVE OF THE STATE POLICE PRESENT SO THAT THE ACCURACY OF MEASUREMENT CAN BE ATTESTED TO IN COURT.

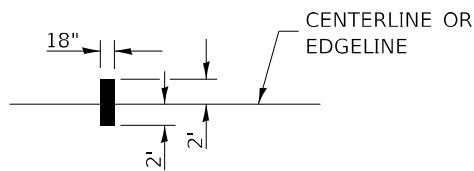

AERIAL SPEED CHECK ZONES

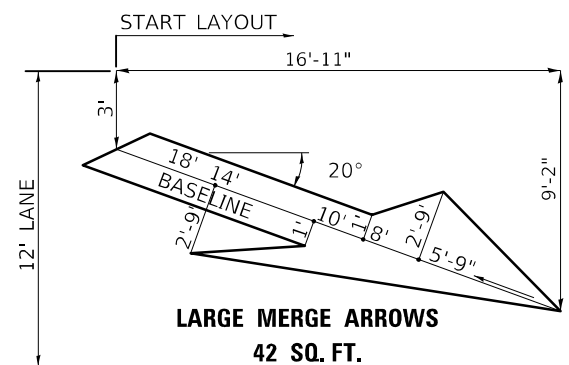

- 1 5" (100) SKIP-DASH (YELLOW)
- 2 5" (100) SOLID (YELLOW)
- 3 12" (300) DIAGONAL (YELLOW)
- 4 5" (100) DOUBLE YELLOW (NARROW)
- 5 6" (150) SOLID (YELLOW)
- 6 6" (150) SKIP-DASH (WHITE)
- 7 5" (100) SKIP-DASH (WHITE)
- 8 5" (100) SOLID (WHITE)
- 9 12" (300) DIAGONAL (WHITE)
- 10 6" (150) SOLID (WHITE)
- 11 24" (600) STOP BAR (WHITE)
- 12 8" (200) SOLID (WHITE)
- 13 6" (150) LANE LINE EXTENSIONS (WHITE)

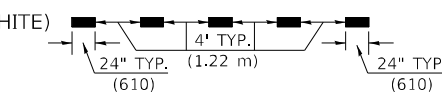
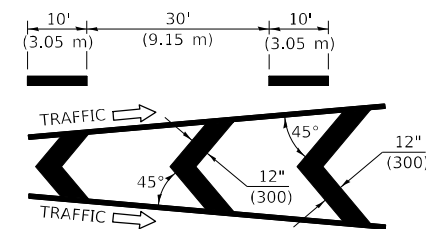
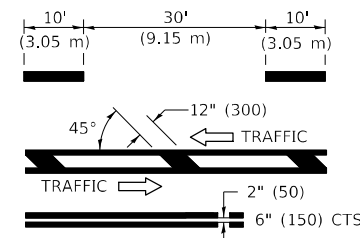

TYPICAL EXIT RAMP TERMINAL

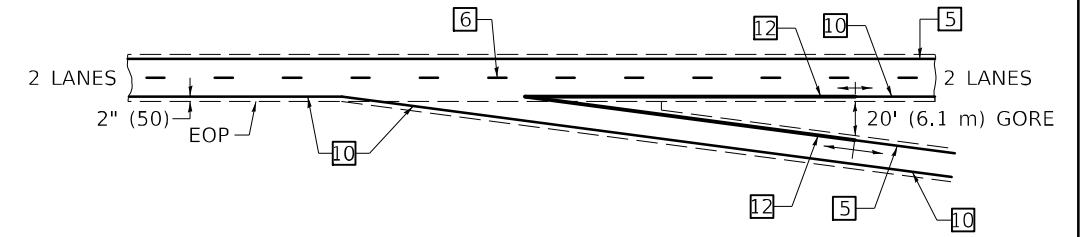

EXIT RAMP TERMINAL with EXCLUSIVE (auxiliary) LANE

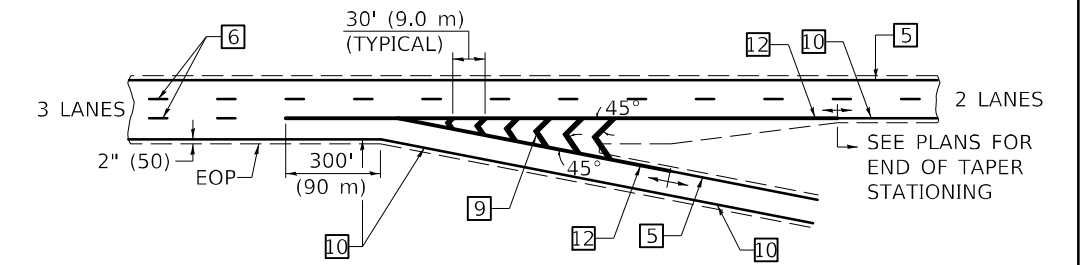

TYPICAL ENTRANCE RAMP TERMINAL

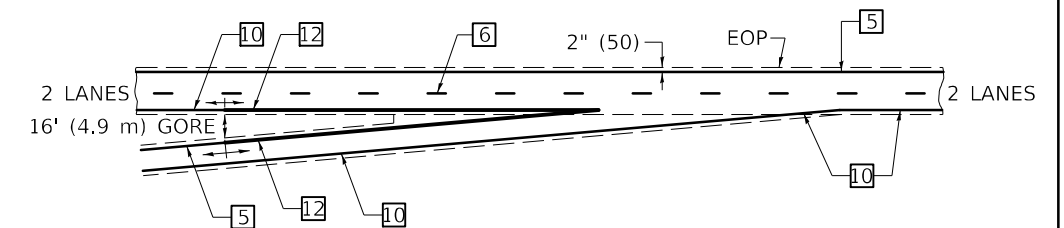

ENTRANCE RAMP TERMINAL with EXCLUSIVE LANE

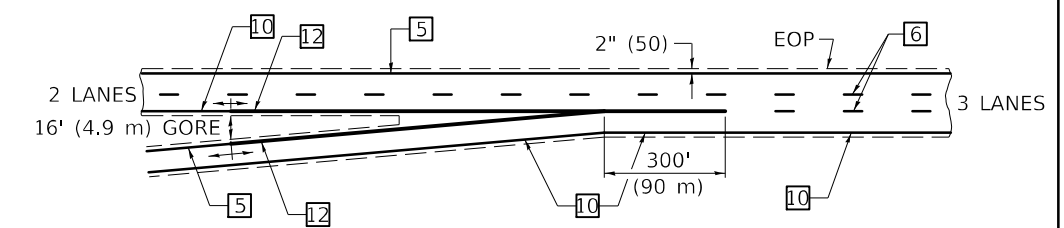

Note: All dimensions are in INCHES (millimeters) unless otherwise shown.

DISTRICT 5 DETAIL NO. 7800BBBB

USER NAME = Greg.Eaglin	DESIGNED -	REVISED -
PLOT SCALE = 40,0000 * / in.	DRAWN -	REVISED -
PLOT DATE = 2/22/2023	CHECKED -	REVISED -
	DATE -	REVISED -

**STATE OF ILLINOIS
DEPARTMENT OF TRANSPORTATION**

**PAVEMENT MARKING
(INTERSTATE & MULTI-LANE APPLICATIONS)**

SCALE: SHEET 1 OF 1 SHEETS STA. TO STA.

F.A.S. RTE.	SECTION	COUNTY	TOTAL SHEETS	SHEET NO.
488	(57-17)RS	MCLEAN	21	21
CONTRACT NO. 70G15				
ILLINOIS FED. AID PROJECT				

MODEL: I:\MODEL\NAME: FILE: NAME: PROJECT: D:\PROJECTS\70G15\CADD\DATA\CAD\PROJECTS\70G15\PL-DISTRIK.COM