

06-16-2023 LETTING ITEM 054

STATE OF ILLINOIS
DEPARTMENT OF TRANSPORTATION

F.A.P. RTE.	SECTION	COUNTY	TOTAL SHEETS	SHEET NO.
662	V(BR) BDR	MACOUPIN	7	1
		ILLINOIS	CONTRACT NO. 72056	

FOR INDEX OF SHEETS, SEE SHEET NO. 2

PROPOSED CONTRACT MAINTENANCE

FAP ROUTE 662 (IL 4)
SECTION V(BR) BDR
PROJECT (STATE ONLY)
BRIDGE DECK REPAIRS
MACOUPIN COUNTY

C-96-084-22



PROJECT LOCATION
SN 059-0007
IL 4 OVER MACOUPIN CR.
1.7 MI S IL 108

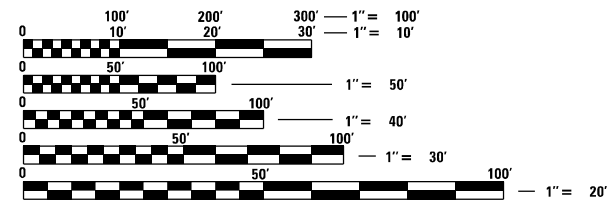
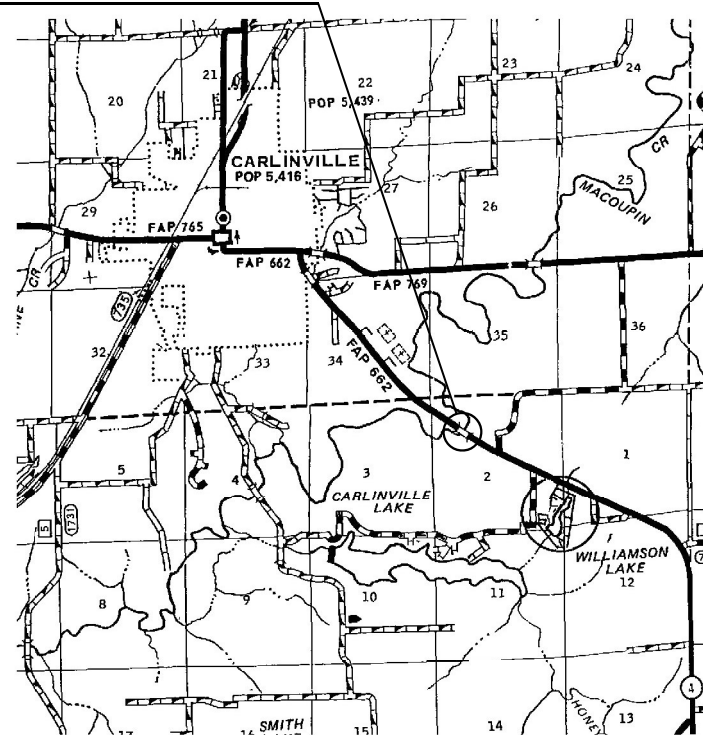

FULL SIZE PLANS HAVE BEEN PREPARED USING STANDARD ENGINEERING SCALES, REDUCED SIZED PLANS WILL NOT CONFORM TO STANDARD SCALES. IN MAKING MEASUREMENTS ON REDUCED PLANS, THE ABOVE SCALES MAY BE USED.

J.U.L.I.E.
JOINT UTILITY LOCATION INFORMATION FOR EXCAVATION
1-800-892-0123
OR 811

BRIDGE MAINTENANCE ENGINEER: BRANDON DUDLEY - (217) 785-9290

GROSS LENGTH = 410 FT. = 0.08 MILE
NET LENGTH = 410 FT. = 0.08 MILE

CONTRACT NO. 72056

D-96-066-22

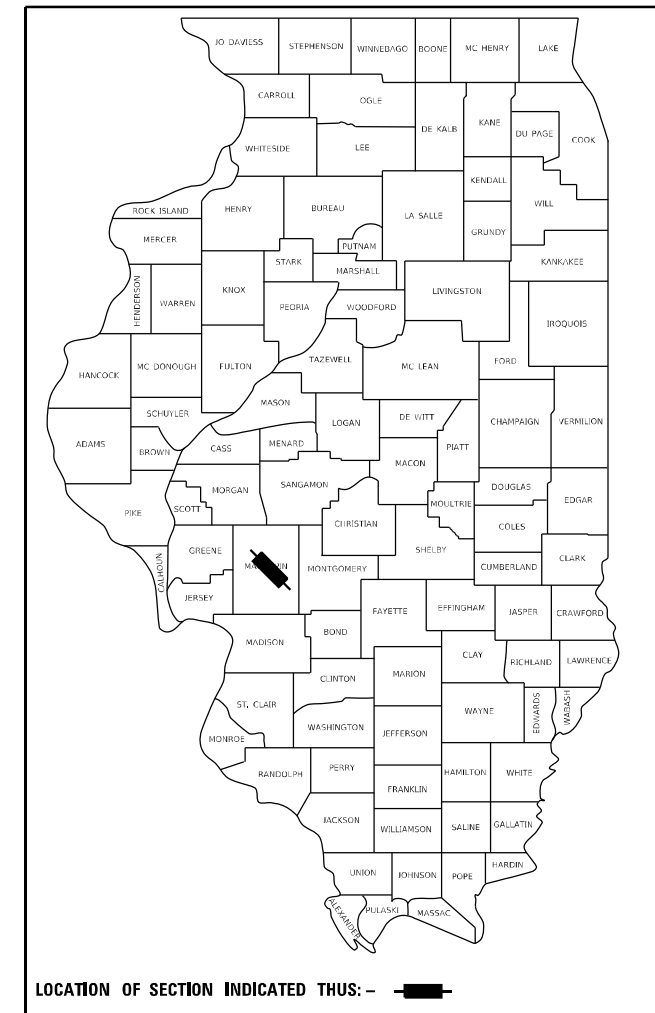

LOCATION OF SECTION INDICATED THIS: - [thick black bar] -

STATE OF ILLINOIS
DEPARTMENT OF TRANSPORTATION

SUBMITTED March 22, 2023
Greg P. Meyer
REGIONAL ENGINEER
May 12, 2023
Scott A. Etk
ENGINEER OF DESIGN AND ENVIRONMENT
May 12, 2023
Stephen M. Smith
DIRECTOR OF HIGHWAYS PROJECT IMPLEMENTATION

PRINTED BY THE AUTHORITY
OF THE STATE OF ILLINOIS

INDEX OF SHEETS

- 1 COVER SHEET
- 2 INDEX, STANDARDS, SIGNATURES, & GENERAL NOTES
- 3 SUMMARY OF QUANTITIES
- 4 STAGING PLAN
- 5-7 SN 059-0007 BRIDGE PLANS



STANDARDS

- 000001-08
- 001001-02
- 001006
- 701001-02
- 701006-05
- 701201-05
- 701301-04
- 701316-13
- 701901-08

GENERAL NOTES:

AREAS OF DECK REPAIRS SHOWN ARE ESTIMATED. THE ENGINEER SHALL SHOW ACTUAL LOCATIONS ON AS-BUILT PLANS.

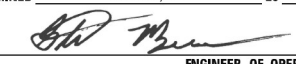
FULL DEPTH PATCHES SHALL BE COVERED WITH STEEL PLATES WHEN WORKERS ARE NOT PRESENT.

STATE OF ILLINOIS DEPARTMENT OF TRANSPORTATION DIVISION OF HIGHWAYS DISTRICT 6	
EXAMINED	March, 17 20 23
 ENGINEER OF OPERATIONS	
EXAMINED	March, 21 20 23
 ENGINEER OF PROJECT IMPLEMENTATION	
EXAMINED	March, 21 20 23
 ENGINEER OF PROGRAM DEVELOPMENT	

MODEL: Default
FILE NAME: S:\Addresses\Bridges\059\0007\Batching\0590007.dgn

USER NAME = Brandon.Dudley	DESIGNED -	REVISED -
	DRAWN -	REVISED -
PLOT SCALE = 100,0000 ' / in.	CHECKED -	REVISED -
PLOT DATE = 3/22/2023	DATE -	REVISED -

**STATE OF ILLINOIS
DEPARTMENT OF TRANSPORTATION**

**INDEX OF SHEETS, STANDARDS,
GENERAL NOTES, & SIGNATURES**

SCALE: SHEET OF SHEETS STA. TO STA.

F.A.P. RTE.	SECTION	COUNTY	TOTAL SHEETS	SHEET NO.
662	V(BR) BDR	MACOUPIN	7	2
			CONTRACT NO. 72056	
		ILLINOIS	FED. AID PROJECT	

0-02178-6005
SN 059-0007

100% STATE

BRIDGE/RURAL
0047
MACOUPIN

CODE NO.	ITEM	UNIT	TOTAL QUANTITY	
28100205	STONE RIPRAP, CLASS A3	TON	20	20
50300300	PROTECTIVE COAT	SQ YD	170	170
67100100	MOBILIZATION	L SUM	1	1
70100100	TRAFFIC CONTROL AND PROTECTION, STANDARD 701316	EACH	1	1
70100450	TRAFFIC CONTROL AND PROTECTION, STANDARD 701201	L SUM	1	1
70106500	TEMPORARY BRIDGE TRAFFIC SIGNALS	EACH	1	1
70106700	TEMPORARY RUMBLE STRIPS	EACH	6	6
70107025	CHANGEABLE MESSAGE SIGNS	CAL DAY	100	100
X7200201	WIDTH RESTRICTION SIGNING	L SUM	1	1
Z0001800	APPROACH SLAB REPAIR (PARTIAL DEPTH)	SQ YD	4	4
Z0012754	STRUCTURAL REPAIR OF CONCRETE (DEPTH EQUAL TO OR LESS THAN 5 INCHES)	SQ FT	55	55
Z0016002	DECK SLAB REPAIR (FULL DEPTH, TYPE II)	SQ YD	14	14
Z0016200	DECK SLAB REPAIR (PARTIAL)	SQ YD	146	146
Z0032500	JOINT SEALING (PATCHES)	FOOT	1500	1500

MODEL: Default
FILE NAME: S:\Addresses\Bridges\Bridges\CAD\72056 - 0590007\batching\batchsheet.dgn

USER NAME = Brandon.Dudley	DESIGNED -	REVISED -
	DRAWN -	REVISED -
PLOT SCALE = 100,0000 ' / in.	CHECKED -	REVISED -
PLOT DATE = 3/22/2023	DATE -	REVISED -

**STATE OF ILLINOIS
DEPARTMENT OF TRANSPORTATION**

SUMMARY OF QUANTITIES

SCALE: SHEET OF SHEETS STA. TO STA.

F.A.P. RTE.	SECTION	COUNTY	TOTAL SHEETS	SHEET NO.
662	V(BR) BDR	MACOUPIN	7	3
			CONTRACT NO. 72056	
		ILLINOIS	FED. AID PROJECT	

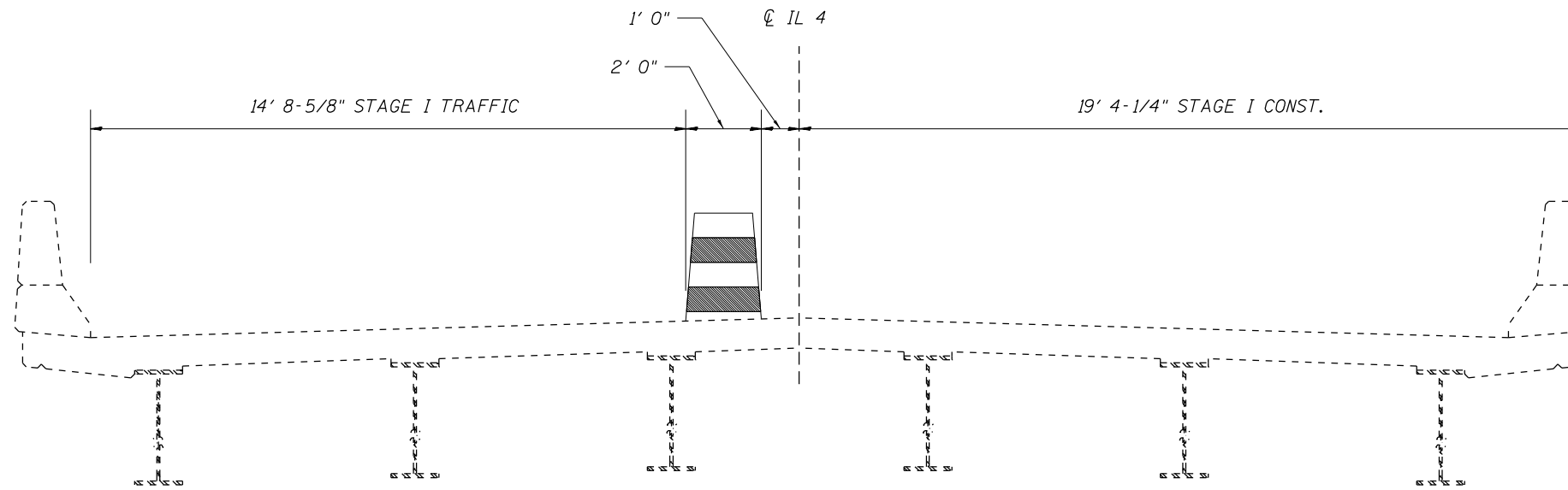

STAGE I CROSS SECTION
(Looking East)

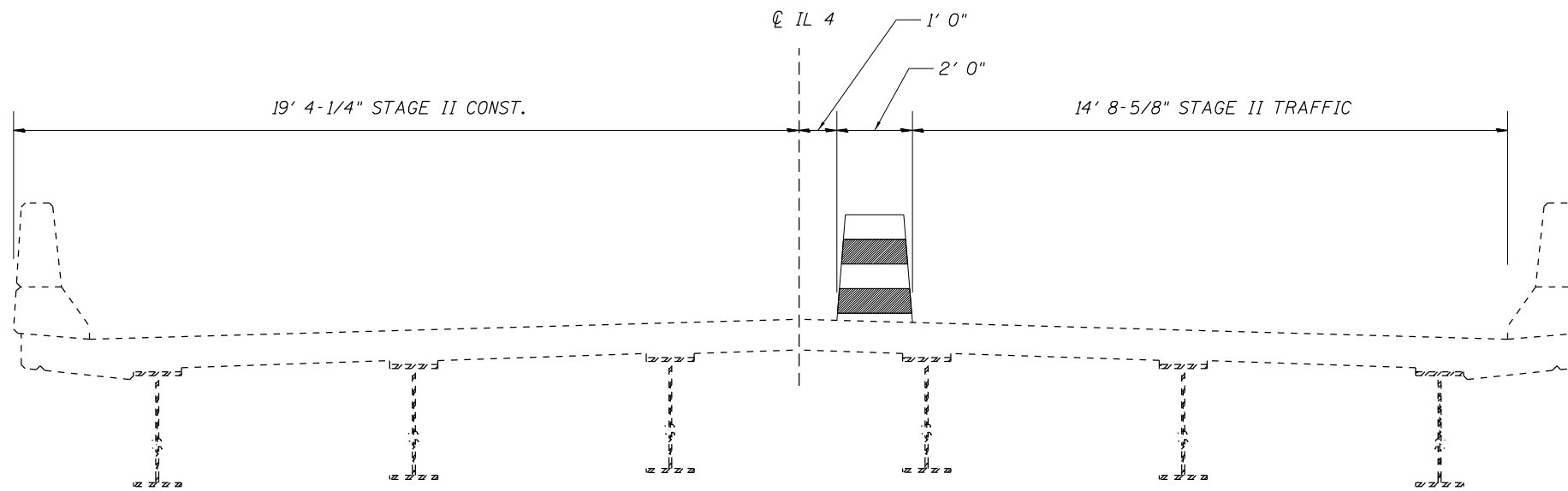

STAGE II CROSS SECTION
(Looking East)

NOTE: ALL TRAFFIC CONTROL SHALL CONFORM TO STANDARD 701316

MODEL: Default
 FILE NAME: S:\Addresses\Bridges\bars_CAD\72056 - 0590007_batching\bar-sheet.dgn

USER NAME = Brandon.Dudley	DESIGNED -	REVISED -
	DRAWN -	REVISED -
PLOT SCALE = 100,0000 ' / in.	CHECKED -	REVISED -
PLOT DATE = 3/22/2023	DATE -	REVISED -

**STATE OF ILLINOIS
DEPARTMENT OF TRANSPORTATION**

TRAFFIC STAGING PLAN				
SCALE:	SHEET	OF	SHEETS	STA. TO STA.

F.A.P. RTE.	SECTION	COUNTY	TOTAL SHEETS	SHEET NO.
662	V(BR) BDR	MACOUPIN	7	4
CONTRACT NO. 72056				
ILLINOIS FED. AID PROJECT				

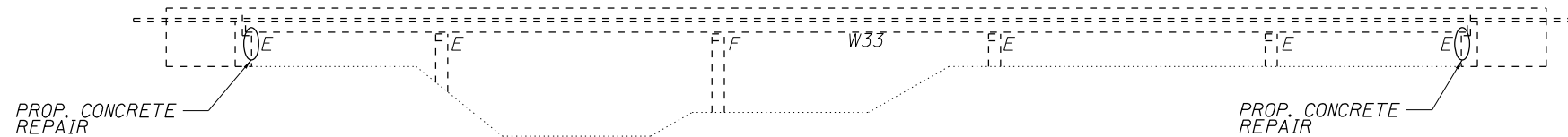

ELEVATION

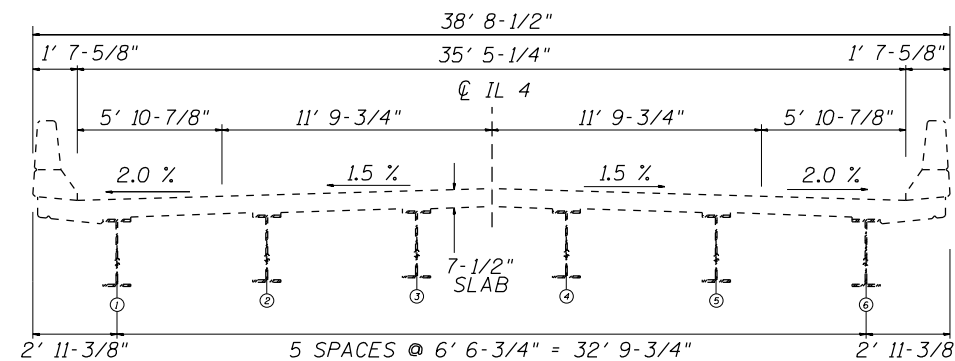

CROSS SECTION
Looking North

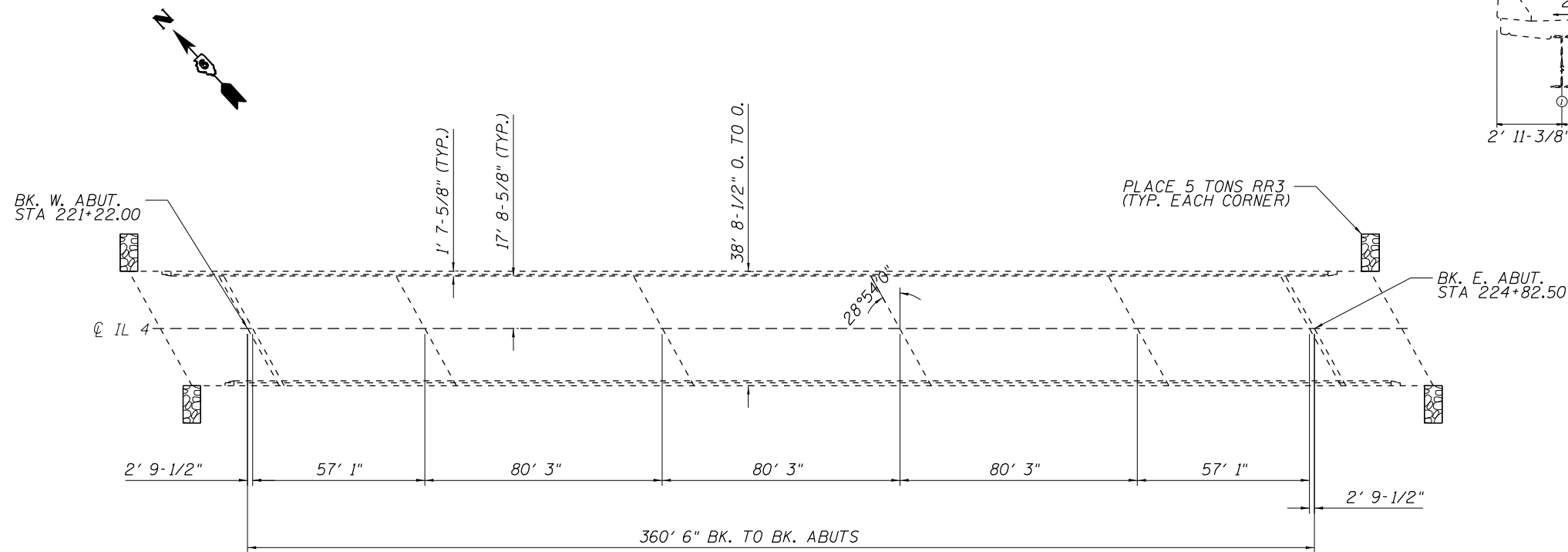

PLAN

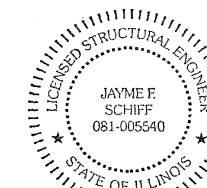

EXPIRES 11-30-2024

Jayme F. Schiff

TOTAL BILL OF MATERIAL (SN 059-0007)

ITEM	UNIT	QUANTITY
Deck Slab Repair (Partial)	Sq. Yd.	146
Approach Slab Repair (Partial Depth)	Sq. Yd.	4
Deck Slab Repair (Full Depth, Type II)	Sq. Yd.	14
Joint Sealing (Patches)	Foot	1500
Structural Repair of Concrete (Depth Equal to or Less Than 5")	Sq. Ft.	55
Stone Riprap, Class A3	Ton	20
Protective Coat	Sq. Yd.	170

STRUCTURE GENERAL NOTES:

PRIOR TO POURING THE NEW CONCRETE PATCHES, ALL HEAVY OR LOOSE MILL SCALE AND OTHER LOOSE OR POTENTIALLY DETRIMENTAL FOREIGN MATERIAL SHALL BE REMOVED FROM THE SURFACES IN CONTACT WITH CONCRETE. TIGHTLY ADHERED PAINT MAY REMAIN UNLESS OTHERWISE NOTED. REMOVAL SHALL BE ACCOMPLISHED BY METHODS THAT WILL NOT DAMAGE THE STEEL AND THE COST WILL BE INCLUDED IN CONCRETE REMOVAL.

PLAN DIMENSIONS AND DETAILS RELATIVE TO EXISTING PLANS ARE SUBJECT TO NOMINAL CONSTRUCTION VARIATIONS. THE CONTRACTOR SHALL FIELD VERIFY EXISTING DIMENSIONS AND DETAILS AFFECTING NEW CONSTRUCTION AND MAKE NECESSARY APPROVED ADJUSTMENTS PRIOR TO CONSTRUCTION OR ORDERING OF MATERIALS. SUCH VARIATIONS SHALL NOT BE CAUSE FOR ADDITIONAL COMPENSATION FOR A CHANGE IN THE SCOPE OF WORK, HOWEVER, THE CONTRACTOR WILL BE PAID FOR THE QUANTITY ACTUALLY FURNISHED AT THE UNIT PRICE BID FOR THE WORK.

EXISTING REINFORCEMENT BARS EXTENDING INTO THE REMOVAL AREA SHALL BE CLEANED, STRAIGHTENED, AND INCORPORATED INTO THE NEW CONSTRUCTION. ANY REINFORCEMENT BARS THAT ARE DAMAGED DURING CONCRETE REMOVAL SHALL BE REPLACED WITH AN APPROVED BAR SPLICER OR ANCHORAGE SYSTEM. COST INCLUDED WITH CONCRETE REMOVAL.

PROTECTIVE COAT SHALL BE APPLIED TO NEW CONCRETE ONLY.

MODEL: Default
FILE NAME: S:\Addresses\Bridges\bars_CAD\72056 - 0590007_patch\plan\brnchecet.dgn

USER NAME = Brandon.Dudley	DESIGNED - BRANDON DUDLEY	REVISED -
PLOT SCALE = 100,0000' / in.	CHECKED - BRANDON DUDLEY	REVISED -
PLOT DATE = 3/22/2023	DATE - 2/8/2023	REVISED -

**STATE OF ILLINOIS
DEPARTMENT OF TRANSPORTATION**

**BRIDGE PLAN & ELEVATION
SN 059-0007**

SCALE: SHEET 1 OF 3 SHEETS STA. TO STA.

F.A.P. RTE. 662	SECTION V(BR) BDR	COUNTY MACOUPIN	TOTAL SHEETS 7	SHEET NO. 5
ILLINOIS FED. AID PROJECT			CONTRACT NO. 72056	

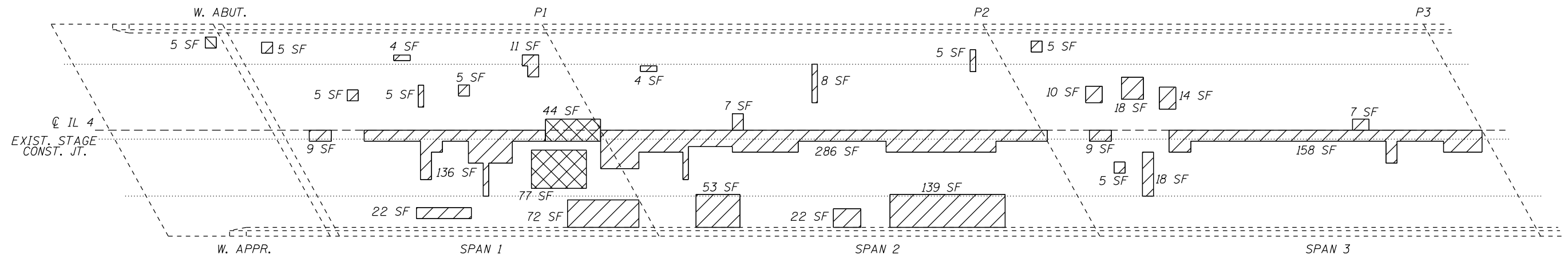

PARTIAL DECK PLAN

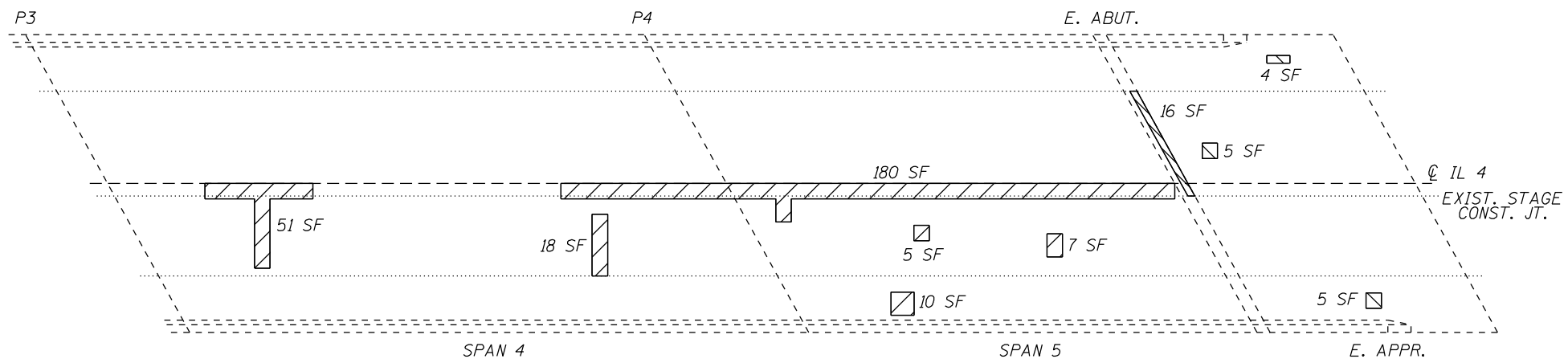
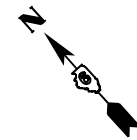

PARTIAL DECK PLAN

PATCHING BILL OF MATERIAL

ITEM	UNIT	QUANTITY
Deck Slab Repair (Partial)	Sq. Yd.	146
Approach Slab Repair (Partial Depth)	Sq. Yd.	4
Deck Slab Repair (Full Depth, Type II)	Sq. Yd.	14
Joint Sealing (Patches)	Foot	1500



DECK SLAB REPAIR (FULL DEPTH)



APPROACH SLAB REPAIR (PARTIAL DEPTH)

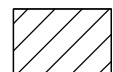

DECK SLAB REPAIR (PARTIAL)

NOTES:

IDENTIFIED PATCHING LOCATIONS ARE ESTIMATED FROM A DECK SURVEY PERFORMED ON 1/18/2022. THE PATCHING SURVEY IS INCLUDED FOR INFORMATION ONLY. THE ENGINEER SHALL LAY OUT ACTUAL PATCH LOCATIONS IN THE FIELD.

THE ENGINEER SHALL SHOW ACTUAL LOCATIONS OF DECK REPAIRS ON AS-BUILT PLANS.

FULL DEPTH PATCHING LOCATIONS MAY BE OMITTED IF SOUND CONCRETE IS ENCOUNTERED.

JOINT SEALING (PATCHES) SHALL BE APPLIED IN LOCATIONS AS DIRECTED IN THE SPECIAL PROVISIONS, ALONG THE ENTIRE LENGTH OF THE EXISTING STAGE CONSTRUCTION LINE, AND ALONG THE CONSTRUCTION JOINTS BETWEEN THE ABUTMENT AND APPROACHES.

MODEL: Default
 FILE NAME: S:\Addresses\Bridges\059-0007 Patching\plan\sheet.dgn

USER NAME = Brandon.Dudley	DESIGNED -	REVISED -
	DRAWN -	REVISED -
PLOT SCALE = 100,0000' / in.	CHECKED -	REVISED -
PLOT DATE = 3/22/2023	DATE -	REVISED -

**STATE OF ILLINOIS
 DEPARTMENT OF TRANSPORTATION**

**SLAB REPAIR PLAN
 SN 059-0007**

SCALE: SHEET 2 OF 3 SHEETS STA. TO STA.

F.A.P. RTE.	SECTION	COUNTY	TOTAL SHEETS	SHEET NO.
662	V(BR) BDR	MACOUPIN	7	6
CONTRACT NO. 72056			ILLINOIS FED. AID PROJECT	

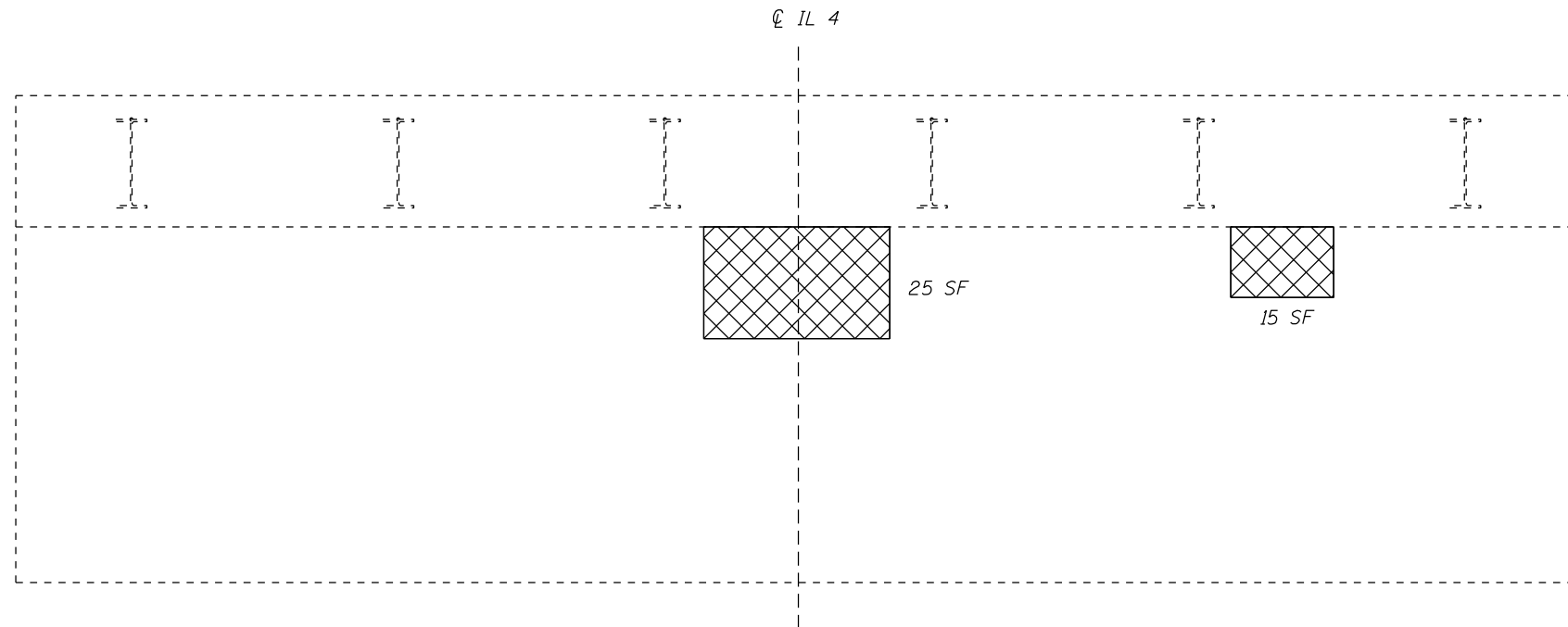

SOUTH ABUT. ELEVATION (LOOKING SOUTH)

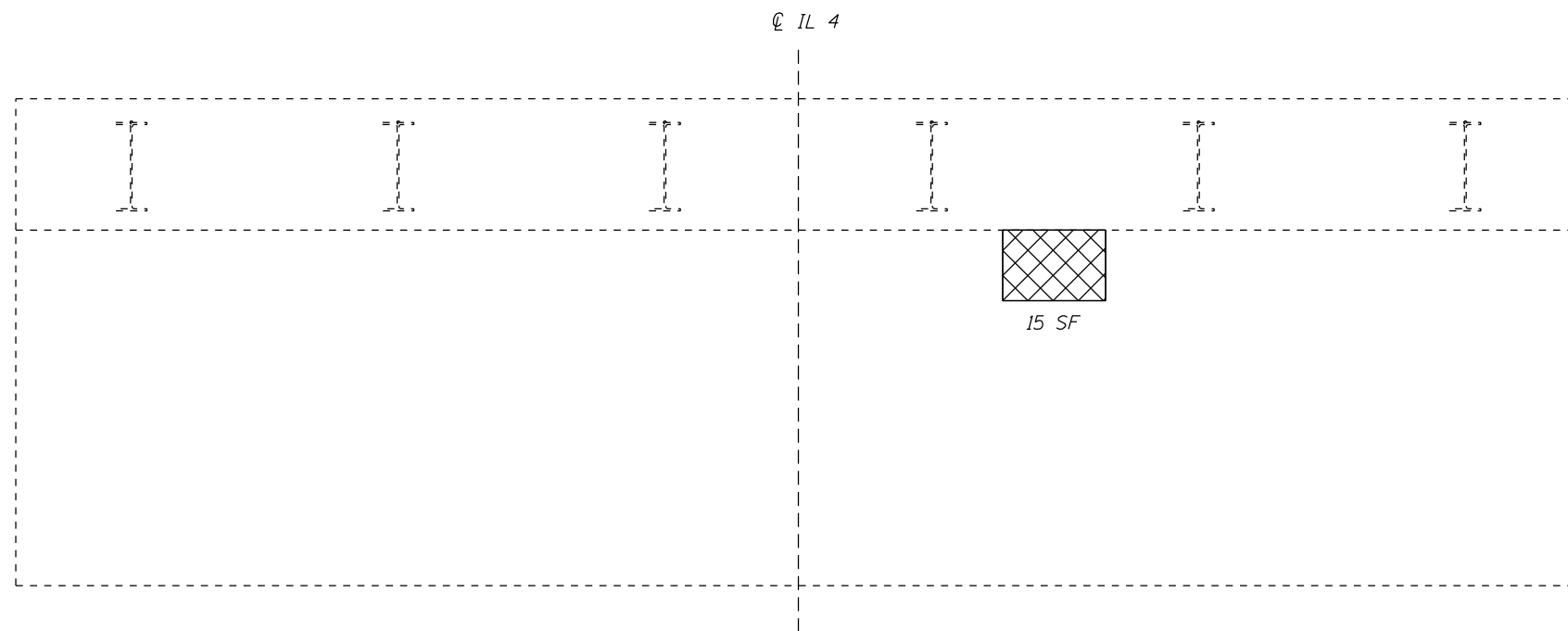

NORTH ABUT. ELEVATION (LOOKING NORTH)

CONCRETE REPAIR BILL OF MATERIAL

ITEM	UNIT	QUANTITY
Structural Repair of Concrete (Depth Equal to or Less Than 5")	Sq. Ft.	55



STRUCTURAL REPAIR OF CONCRETE (<5")

MODEL: Default
FILE NAME: S:\Roads\Bridges\bars_CAD\72056 - 0590007_patch\brnchecet.dgn

USER NAME = Brandon.Dudley	DESIGNED -	REVISED -
PLOT SCALE = 100,0000 ' / in.	DRAWN -	REVISED -
PLOT DATE = 3/22/2023	CHECKED -	REVISED -
	DATE -	REVISED -

**STATE OF ILLINOIS
DEPARTMENT OF TRANSPORTATION**

**SUBSTRUCTURE REPAIR PLAN
SN 059-0007**

SCALE: SHEET 3 OF 3 SHEETS STA. TO STA.

F.A.P. RTE.	SECTION	COUNTY	TOTAL SHEETS	SHEET NO.
662	V(BR) BDR	MACOUPIN	7	7
CONTRACT NO. 72056			ILLINOIS FED. AID PROJECT	