

STATE OF ILLINOIS
 DEPARTMENT OF TRANSPORTATION
 DIVISION OF HIGHWAYS
**PROPOSED
 HIGHWAY PLANS**

FOR INDEX OF SHEETS SEE SHEET 2

ADT = 3200
 FUNCTIONAL CLASSIFICATION = OTHER PRINCIPAL ARTERIAL

FAP ROUTE 332 (IL 1)
 SECTION (21XNRH, 21NRH 22, 23)RS-3
 PROJECT COVD-NHPP-G87U(987)
 DESIGNED OVERLAY
 CLARK & CRAWFORD COUNTY

F.A.P. RTE	SECTION	COUNTY	TOTAL SHEETS	SHEET NO
332	21XNRH, 21NRH 22, 23)RS-3	CLARK & CRAWFORD, ILLINOIS	33	1
CONTRACT NO 74A06				

D-97-088-20



LOCATION OF SECTION INDICATED THIS: - [Symbol] -

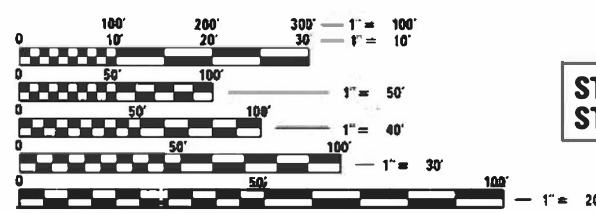
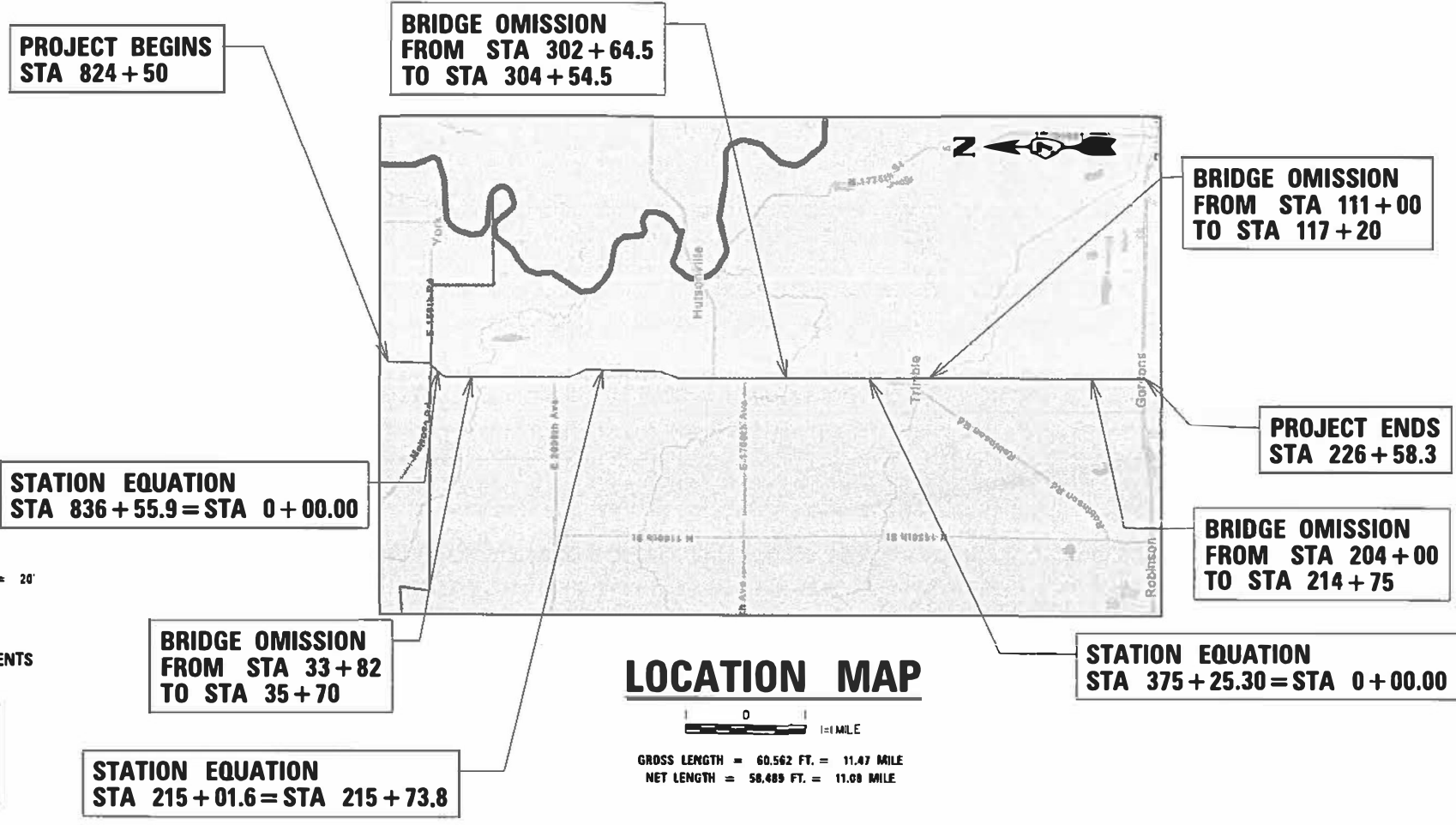

FULL SIZE PLANS HAVE BEEN PREPARED USING STANDARD ENGINEERING SCALES. REDUCED SIZED PLANS WILL NOT CONFORM TO STANDARD SCALES. IN MAKING MEASUREMENTS ON REDUCED PLANS, THE ABOVE SCALES MAY BE USED.

J.U.L.I.E.
 JOINT UTILITY LOCATION INFORMATION FOR EXCAVATION
 1-800-892-0123
 OR 811

IDOT PROJECT ENGINEER: MATT BOWER
 CONSULTANT PROJECT MANAGER: MARK REZNICEK
 PHONE NUMBER: (217)-342-8359
 CONTRACT NO. 74A06

LOCATION MAP

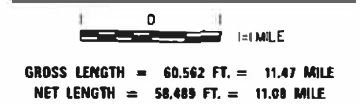

THIS DOCUMENT IS THE PROPERTY OF ESI CONSULTANTS, LTD. AND NO PART HEREIN SHALL BE USED EXCEPT FOR THIS SPECIFIC PROJECT WITHOUT THE WRITTEN CONSENT OF ESI CONSULTANTS, LTD.

STATE OF ILLINOIS
 DEPARTMENT OF TRANSPORTATION
 DIVISION OF HIGHWAYS

SUBMITTED April 6, 2023
Jeffrey P. Myners
 DEPUTY DIRECTOR OF HIGHWAYS, REGION ENGINEER
 May 12, 2023

Scott A. Etk
 ENGINEER OF DESIGN AND ENVIRONMENT
 May 12, 2023

Stephen M. Janda
 DIRECTOR OF HIGHWAYS PROJECT IMPLEMENTATION



Mark Reznicek
 MARK A. REZNICEK, P.E.
 EXP: 11/30/2023
 SHEETS 1-33

PRINTED BY THE AUTHORITY
 OF THE STATE OF ILLINOIS

INDEX OF SHEETS

SHEET NO.	ITEM
1	COVER SHEET
2	INDEX OF SHEETS & GENERAL NOTES
3-5	SUMMARY OF QUANTITIES
6-7	TYPICAL SECTIONS
8-12	SCHEDULE OF QUANTITIES
13-24	PLAN SHEETS
25	PAVEMENT MARKING DETAILS - HUTSONVILLE
26-27	ENTRANCE DETAILS
28-29	MISC. DETAIL
30-33	PAVEMENT MARKING D7 STANDARD DETAILS

THE FOLLOWING STANDARDS ARE A PART OF THESE PLANS AND ARE INCLUDED AFTER SHEET NO. 33:

STD. NO.	DESCRIPTION
000001-08	STANDARD SYMBOLS, ABBREVIATIONS AND PATTERNS
001006	DECIMAL OF AN INCH AND OF A FOOT
406201-01	MAILBOX TURNOUT
442201-03	CLASS C AND D PATCHES
667101-02	PERMANENT SURVEY MARKERS
701001-02	OFF-RD OPERATIONS, 2L, 2W, MORE THAN 15' FROM PAVEMENT EDGE
701006-05	OFF-RD OPERATIONS, 2L, 2W, 15' TO 24' FROM PAVEMENT EDGE
701011-04	OFF-RD MOVING OPERATIONS, 2L, 2W, DAY ONLY
701201-05	LANE CLOSURE 2L, 2W, DAY ONLY
701301-04	LANE CLOSURE 2L, 2W - SHORT TIME OPERATION
701306-04	LANE CLOSURE 2L, 2W, SLOW MOVING OPERATIONS DAY ONLY, FOR SPEEDS ≥ 45 MPH
701311-03	LANE CLOSURE 2L, 2S, MOVING OPERATIONS - DAY ONLY
701901-08	TRAFFIC CONTROL DEVICES
780001-05	TYPICAL PAVEMENT MARKINGS
781001-04	TYPICAL APPLICATIONS RAISED REFLECTIVE PAVEMENT MARKERS

GENERAL NOTES

THE MATERIAL USED FOR AGGREGATE SURFACE COURSE, TYPE B SHALL BE CRUSHED STONE OR CRUSHED CONCRETE.

THE FOLLOWING RATES OF APPLICATION HAVE BEEN USED IN CALCULATING PLAN QUANTITIES:

HOT MIX ASPHALT	112 LBS/SQ YD/IN
GRANULAR MATERIAL	2.05 TONS/CU YD

THE WORK INCLUDED IN SECTION (21XNRH, 21NRH 22, 23) RS-3 CONSISTS OF PAVEMENT PATCHING, RESURFACING WITH HMA, AGGREGATE SHOULDERS, PAVEMENT MARKINGS, AND OTHER WORK NECESSARY TO COMPLETE THE SECTION.

THE PROPOSED PROJECT BEGINS 0.3 MILES NORTH OF THE CLARK COUNTY LINE TO IL 33.

THE MATERIAL USED FOR AGGREGATE WEDGE SHOULDERS, TYPE B SHALL BE CRUSHED STONE OR CRUSHED CONCRETE.

THE FOLLOWING MIXTURE REQUIREMENTS ARE APPLICABLE TO THIS PROJECT:

LOCATION(S)	MIXTURE USE(S)	PG	DESIGN AIR VOIDS	MIXTURE COMPOSITION	FRICTION AGGREGATE	MIXTURE WEIGHT	QUALITY MANAGEMENT PROGRAM	SUBLOT SIZE	MATERIAL TRANSFER DEVICE (REQUIRED?)
MAINLINE	HMA SURFACE COURSE, IL-9.5, MIX "C", N70 (2")	PG 64-22	4.0% @ N=70	IL - 9.5	MIXTURE C	N70	PFP	1000	N/A
MAINLINE	HMA BINDER COURSE, IL-9.5FG, N70 (1 3/4")	PG 64-22	4.0% @ N=70	IL - 9.5FG	N/A	N70	PFP	1000	N/A
PATCHING	HMA BINDER COURSE, IL-19.0, N70	PG 64-22	4.0% @ N=70	IL - 19.0	N/A	N70	QC/QA	3000	N/A
INCIDENTAL	HMA SURFACE COURSE, IL-9.5, MIX "C", N70	PG 64-22	4.0% @ N=70	IL - 9.5	MIXTURE C	N70	QC/QA	3000	N/A

REV. - MS



USER NAME = *USER*	DESIGNED -	REVISED -
	DRAWN -	REVISED -
PLOT SCALE = *SCALE*	CHECKED -	REVISED -
PLOT DATE = *DATE*	DATE -	REVISED -

STATE OF ILLINOIS
DEPARTMENT OF TRANSPORTATION

GENERAL NOTES

SCALE: N/A SHEET NO 1 OF 1 SHEETS

F.A.P. RTE	SECTION	COUNTY	TOTAL SHEETS	SHEET NO
332	(21XNRH, 21NRH 22, 23)RS-3	CLARK & CRAWFORD	33	2
CONTRACT NO 74A06			ILLINOIS FEDERAL AID PROJECT	

SUMMARY OF QUANTITIES			TOTAL QUANTITY	CONSTRUCTION TYPE CODE			
				Clark 80% Fed / 20% State ROADWAY 0005 RURAL	Clark 100% Covid ROADWAY 0005 RURAL	Crawford 80% Fed / 20% State ROADWAY 0005 RURAL	Crawford 100% Covid ROADWAY 0005 RURAL
CODE NO.	ITEM	UNIT					
40200800	AGGREGATE SURFACE COURSE, TYPE B	TON	648	5	8	262	373
40600290	BITUMINOUS MATERIALS (TACK COAT)	POUND	117765	752	1070	47884	68059
40600370	LONGITUDINAL JOINT SEALANT	FOOT	61698	381	542	25100	35675
40600982	HOT-MIX ASPHALT SURFACE REMOVAL - BUTT JOINT	SQ YD	1535	52	73	582	828
40600990	TEMPORARY RAMP	SQ YD	170	6	8	64	92
40602970	HOT-MIX ASPHALT BINDER COURSE, IL-9.5FG, N70	TON	17098	109	156	6952	9881
40604052	HOT-MIX ASPHALT SURFACE COURSE, IL-9.5, MIX "C", N70	TON	19540	125	177	7945	11293
40800050	INCIDENTAL HOT-MIX ASPHALT SURFACING	TON	371	11	16	142	202
44000155	HOT-MIX ASPHALT SURFACE REMOVAL, 1 1/2"	SQ YD	173057	1063	1511	70409	100074
44201847	CLASS D PATCHES, TYPE I, 17 INCH	SQ YD	27			11	16
44201851	CLASS D PATCHES, TYPE II, 17 INCH	SQ YD	1162	9	13	471	669
44201855	CLASS D PATCHES, TYPE III, 17 INCH	SQ YD	259			107	152
44201857	CLASS D PATCHES, TYPE IV, 17 INCH	SQ YD	665			275	390
48102100	AGGREGATE WEDGE SHOULDER, TYPE B	TON	3879	25	36	1577	2241
66700205	PERMANENT SURVEY MARKERS, TYPE I	EACH	4			2	2

PRINTED DATE: \$DATE\$
FILE NAME: \$FILE\$



USER NAME = \$USER\$	DESIGNED -	REVISED -
	DRAWN -	REVISED -
PLOT SCALE = \$SCALE\$	CHECKED -	REVISED -
PLOT DATE = \$DATE\$	DATE -	REVISED -

STATE OF ILLINOIS
DEPARTMENT OF TRANSPORTATION

SUMMARY OF QUANTITIES

SCALE: N/A SHEET NO 1 OF 3 SHEETS

F.A.P. RTE	SECTION	COUNTY	TOTAL SHEETS	SHEET NO
332	(21XNRH, 21NRH 22, 23)RS-3	CLARK & CRAWFORD	33	3
			CONTRACT NO 74A06	
ILLINOIS FEDERAL AID PROJECT				

SUMMARY OF QUANTITIES				CONSTRUCTION TYPE CODE			
				Clark 80% Fed / 20% State ROADWAY 0005 RURAL	Clark 100% Covid ROADWAY 0005 RURAL	Crawford 80% Fed / 20% State ROADWAY 0005 RURAL	Crawford 100% Covid ROADWAY 0005 RURAL
CODE NO.	ITEM	UNIT	TOTAL QUANTITY				
67000500	ENGINEER'S FIELD OFFICE, TYPE B	CAL MO	6			2	4
67000600	ENGINEER'S FIELD LABORATORY	CAL MO	6			1	1
67100100	MOBILIZATION	L SUM	1			0.4	0.6
70100450	TRAFFIC CONTROL AND PROTECTION, STANDARD 701201	L SUM	1			0.4	0.6
70100460	TRAFFIC CONTROL AND PROTECTION, STANDARD 701306	L SUM	1			0.4	0.6
70107025	CHANGEABLE MESSAGE SIGN	CAL DA	28			12	16
70300100	SHORT TERM PAVEMENT MARKING	FOOT	12264	76	109	4989	7090
70300150	SHORT TERM PAVEMENT MARKING REMOVAL	SQ FT	1533	10	13	624	886
* 78000100	THERMOPLASTIC PAVEMENT MARKING - LETTERS AND SYMBOLS	SQ FT	255			105	150
* 78000200	THERMOPLASTIC PAVEMENT MARKING - LINE 4"	FOOT	6946			2869	4077
* 78000400	THERMOPLASTIC PAVEMENT MARKING - LINE 6"	FOOT	200			83	117
* 78000500	THERMOPLASTIC PAVEMENT MARKING - LINE 8"	FOOT	2319			958	1361
* 78000600	THERMOPLASTIC PAVEMENT MARKING - LINE 12"	FOOT	140			58	82
* 78000650	THERMOPLASTIC PAVEMENT MARKING - LINE 24"	FOOT	76			31	45
* 78001110	PAINT PAVEMENT MARKING - LINE 4"	FOOT	150513	1158	1646	61004	86705

PRINTED DATE: \$DATE\$
FILE NAME: \$FILE\$

*** SPECIALTY ITEM**



ES I
Excellent Service. Integrity
www.esi.com

USER NAME = \$USER\$	DESIGNED -	REVISED -
	DRAWN -	REVISED -
PLOT SCALE = \$SCALE\$	CHECKED -	REVISED -
PLOT DATE = \$DATE\$	DATE -	REVISED -

**STATE OF ILLINOIS
DEPARTMENT OF TRANSPORTATION**

SUMMARY OF QUANTITIES

SCALE: N/A SHEET NO 2 OF 3 SHEETS

F.A.P. RTE	SECTION	COUNTY	TOTAL SHEETS	SHEET NO
332	(21XNRH, 21NRH 22, 23)RS-3	CLARK & CRAWFORD	33	4
CONTRACT NO 74A06			ILLINOIS FEDERAL AID PROJECT	

SUMMARY OF QUANTITIES				CONSTRUCTION TYPE CODE			
				Clark 80% Fed / 20% State ROADWAY 0005 RURAL	Clark 100% Covid ROADWAY 0005 RURAL	Crawford 80% Fed / 20% State ROADWAY 0005 RURAL	Crawford 100% Covid ROADWAY 0005 RURAL
CODE NO.	ITEM	UNIT	TOTAL QUANTITY				
* 78011000	GROOVING FOR RECESSED PAVEMENT MARKING, LETTERS AND SYMBOLS	SQ FT	255			105	150
* 78011025	GROOVING FOR RECESSED PAVEMENT MARKING 5"	FOOT	6946			2869	4077
* 78011035	GROOVING FOR RECESSED PAVEMENT MARKING 7"	FOOT	200			83	117
* 78011045	GROOVING FOR RECESSED PAVEMENT MARKING 9"	FOOT	2319			958	1361
* 78011065	GROOVING FOR RECESSED PAVEMENT MARKING 13"	FOOT	140			58	82
* 78011125	GROOVING FOR RECESSED PAVEMENT MARKING 25"	FOOT	76			31	45
* 78100100	RAISED REFLECTIVE PAVEMENT MARKER	EACH	856	5	7	349	495
78300200	RAISED REFLECTIVE PAVEMENT MARKER REMOVAL	EACH	856	5	7	349	495
X0326440	SURFACE REMOVAL, VARIABLE DEPTH (SPECIAL)	SQ YD	2989	88	126	1146	1629
X4060995	TEMPORARY RAMP (SPECIAL)	SQ YD	1307	21	29	519	738
X4406680	PARTIAL DEPTH REMOVAL, TYPE IV, 8"	SQ YD	278			115	163
X4421000	PARTIAL DEPTH PATCHING	TON	124			51	73
Z0049799	PROTECTING OR RESETTING SURVEY MARKERS	EACH	24		1	9	14

* SPECIALTY ITEM

PRINTED DATE: \$DATE\$
FILE NAME: \$FILEL\$



USER NAME = \$USER\$	DESIGNED -	REVISED -
	DRAWN -	REVISED -
PLOT SCALE = \$SCALE\$	CHECKED -	REVISED -
PLOT DATE = \$DATE\$	DATE -	REVISED -

STATE OF ILLINOIS
DEPARTMENT OF TRANSPORTATION

SUMMARY OF QUANTITIES

SCALE: N/A SHEET NO 3 OF 3 SHEETS

F.A.P. RTE	SECTION	COUNTY	TOTAL SHEETS	SHEET NO
332	(21XNRH, 21NRH 22, 23IRS-3	CLARK & CRAWFORD	33	5
			CONTRACT NO 74A06	
ILLINOIS FEDERAL AID PROJECT				

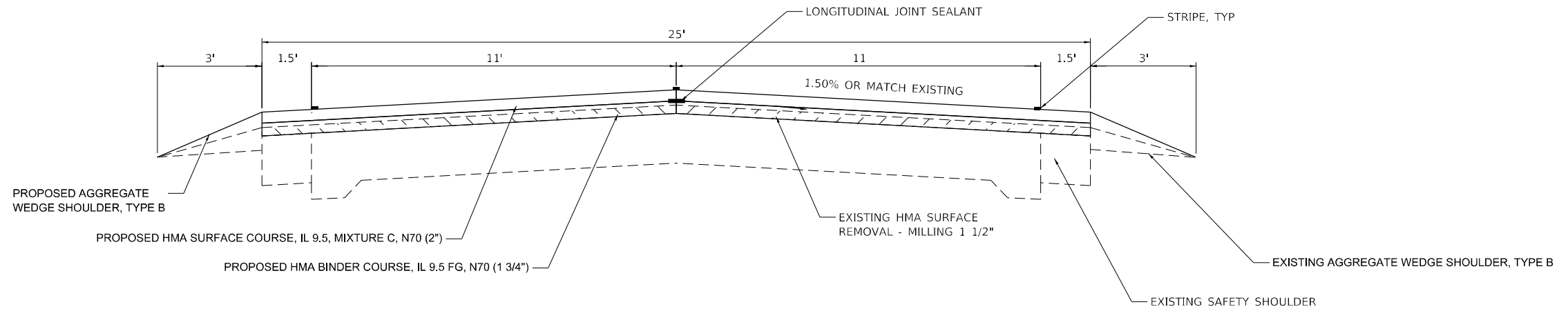

EXISTING AND PROPOSED TYPICAL SECTION OF IL 1

STA. 824+50 - 836+65.3 SECTIONS (22)
 *STA. 0+00 - 375+25.3 (23)

OMISSION 33+82 - 35+70 (RACoon CREEK) SN017-0023
 OMISSION 302+64.5 - 304+54.5 (HUTSON CREEK) SN017-0025

NOTE:
 PAVEMENT WIDTH TRANSITION
 START AT STATION 375+88.1 FROM 2 LANE AT 11' EACH LANE
 VARI TO STATION 38+76 AT 2 LANE AT 12' EACH LANE

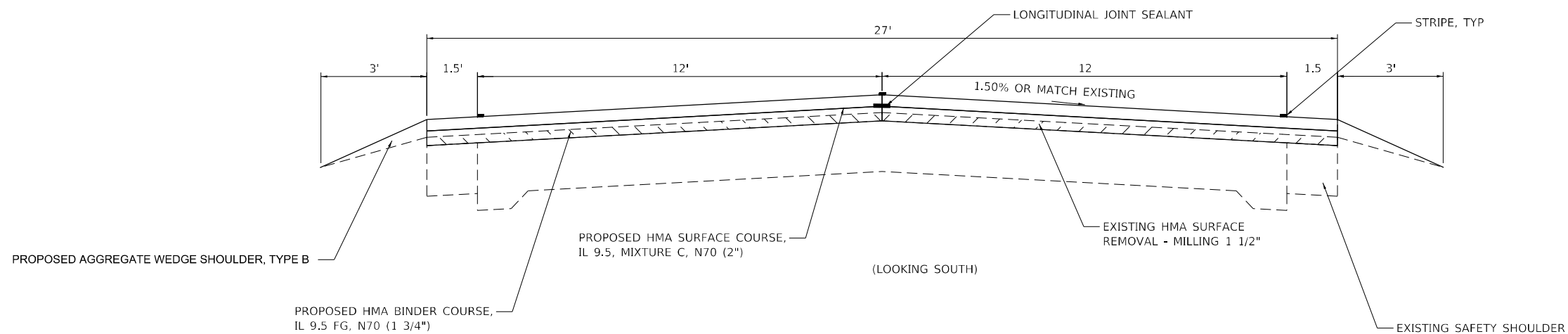

EXISTING AND PROPOSED TYPICAL SECTION OF IL 1

**STA. 0+00 - 226+58.3 SECTIONS (21-NRH)
 (21XNRH)

OMISSION 111+00 60 117+20 (SUGAR CREEK) SN017-0033
 OMISSION 204+00 TO 214+75 (SUGAR CREEK) SN017-0032

**STA 46+00-48+82 LT & RT
 HMA SHLD WIDTH VARIES
 (1.5' TO 4.5') MATCH EXIST SHOULDER

PRINTED DATE: \$DATE\$
 FILE NAME: \$FILE\$



USER NAME = \$USER\$	DESIGNED -	REVISED -
	DRAWN -	REVISED -
PLOT SCALE = \$SCALE\$	CHECKED -	REVISED -
PLOT DATE = \$DATE\$	DATE -	REVISED -

**STATE OF ILLINOIS
 DEPARTMENT OF TRANSPORTATION**

TYPICAL SECTIONS

SCALE: N/A SHEET NO 1 OF 2 SHEETS

F.A.P. RTE	SECTION	COUNTY	TOTAL SHEETS	SHEET NO
332	(21XNRH, 21NRH 22, 23)RS-3	CLARK & CRAWFORD	33	6
CONTRACT NO 74A06				
ILLINOIS FEDERAL AID PROJECT				

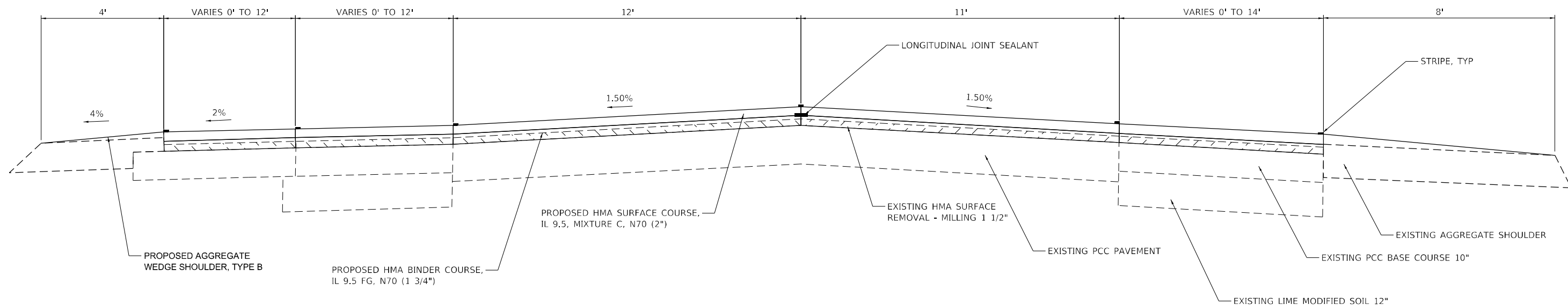

EXISTING AND PROPOSED TYPICAL SECTION OF IL 1
 STA 242+35.00 TO 249+10.00
 AT HUTSONVILLE ROAD

PRINTED DATE: \$DATE\$
 FILE NAME: \$FILEL\$



USER NAME = \$USER\$	DESIGNED -	REVISED -
	DRAWN -	REVISED -
PLOT SCALE = \$SCALE\$	CHECKED -	REVISED -
PLOT DATE = \$DATE\$	DATE -	REVISED -

**STATE OF ILLINOIS
 DEPARTMENT OF TRANSPORTATION**

TYPICAL SECTIONS

SCALE: N/A SHEET NO 2 OF 2 SHEETS

F.A.P. RTE	SECTION	COUNTY	TOTAL SHEETS	SHEET NO
332	(21XNRH, 21NRH 22, 23IRS-3)	CLARK & CRAWFORD	33	7
CONTRACT NO 74A06				
ILLINOIS FEDERAL AID PROJECT				

MAINLINE RESURFACING SCHEDULE

STATION	TO	STATION	LENGTH	AVERAGE PAVEMENT WIDTH	HMA SURFACE REMOVAL - BUTT JOINT 40600982	HOT-MIX ASPHALT SURFACE REMOVAL, 1 1/2" 44000155	BITUMINOUS MATERIALS (TACK COAT) 40600290	HOT-MIX ASPHALT SURFACE COURSE, IL-9.5 MIX "C", N70 40604052	HOT-MIX ASPHALT BINDER COURSE, IL-9.5FG, N70 40602970	LONGITUDINAL JOINT SEALANT 40600370	AGGREGATE WEDGE SHOULDERS, TYPE B 48102100	TEMPORARY RAMP 40600990
			FOOT	FOOT	SQ YD	SQ YD	POUND	TON	TON	FOOT	TON	SQ YD
824+50	TO	824+95	45.0	25.0	125.0		84.4	14.0	12.3	45.0	3.0	13.9
824+95	TO	825+54	58.6	25.0		162.8	109.9	18.2	16.0	58.6	3.9	
825+54	TO	833+73	819.0	26.5		2411.4	1627.7	270.1	236.3	819.0	54.4	
Clark Co. / Crawford Co. Split												
833+73	TO	836+56	283.3	26.5		834.2	563.1	93.4	81.7	282.9	18.8	
STA. 836+55.9 BK = STA. 0+00.00 AH												
0+00	TO	6+91	691.4	25.0		1920.6	1296.4	215.1	188.2	691.4	45.9	
6+91	TO	16+31	939.5	25.0		2609.7	1761.6	292.3	255.8	939.5	62.4	
16+31	TO	33+37	1706.1	25.0		4739.2	3198.9	530.8	464.4	1706.1	113.3	
33+37	TO	33+82	45.0	25.0	125.0		84.4	14.0	12.3	45.0	3.0	13.9
Raccoon Creek Bridge Omission												
35+70	TO	36+15	45.0	25.0	125.0		84.4	14.0	12.3	45.0	3.0	13.9
36+15	TO	115+39	7924.0	25.0		22011.1	14857.5	2465.2	2157.1	7924.0	526.4	
115+39	TO	123+14	775.0	25.0		2152.8	1453.1	241.1	211.0	775.0	51.5	
123+14	TO	128+06	492.0	25.0		1366.7	922.5	153.1	133.9	492.0	32.7	
128+06	TO	135+81	775.0	28.0		2411.1	1627.5	270.0	236.3	775.0	51.5	
135+81	TO	189+40	5359.0	25.0		14886.1	10048.1	1667.2	1458.8	5359.0	356.0	
189+40	TO	200+47	1107.0	25.0		3075.0	2075.6	344.4	301.4	1107.0	73.6	
200+47	TO	203+82	335.0	25.0		930.6	628.1	104.2	91.2	335.0	22.3	
203+82	TO	215+02	1119.6	25.0		3110.0	2099.3	348.3	304.8	1119.6	74.4	
STA. 215+01.6 BK = 215+73.8 AH												
215+74	TO	233+00	1726.2	25.0		4795.0	3236.6	537.0	469.9	1726.2	114.7	
233+00	TO	249+10	1610.0	VAR		8623.8	5821.1	965.9	845.1	3722.0	47.0	
249+10	TO	260+00	1090.0	25.0		3027.8	2043.8	339.1	296.7	1090.0	72.4	
260+00	TO	302+20	4219.5	25.0		11720.8	7911.6	1312.7	1148.6	4220.0	280.3	
302+20	TO	302+65	45.0	25.0	125.0		84.4	14.0	12.3	45.0	3.0	13.9
Hutson Creek Bridge Omission												
304+55	TO	305+00	45.0	25.0	125.0		84.4	14.0	12.3	45.0	3.0	13.9
305+00	TO	375+25	7025.3	25.0		19514.7	13172.4	2185.6	1912.4	7025.3	466.7	
STA. 375+25.30 BK = STA. 0+00.00 AH												
0+00	TO	46+15	4615.0	27.0		13845.0	9345.4	1550.6	1356.8	4615.0	306.6	
46+15	TO	46+75	60.0	30.5		203.3	137.3	22.8	19.9	60.0	4.0	
46+75	TO	47+95	120.0	34.0		453.3	306.0	50.8	44.4	120.0	8.0	
47+95	TO	48+55	60.0	30.5		203.3	137.3	22.8	19.9	60.0	4.0	
48+55	TO	110+55	6200.0	27.0		18600.0	12555.0	2083.2	1822.8	6200.0	411.9	
110+55	TO	111+00	45.0	27.0	135.0		91.1	15.1	13.2	45.0	3.0	15.0
Bridge Omission												
117+20	TO	117+65	45.0	27.0	135.0		91.1	15.1	13.2	45.0	3.0	15.0
117+65	TO	203+55	8590.0	27.0		25770.0	17394.8	2886.2	2525.5	8590.0	570.7	
203+55	TO	204+00	45.0	27.0	135.0		91.1	15.1	13.2	45.0	3.0	15.0
Bridge Omission												
214+75	TO	215+20	45.0	27.0	135.0		91.1	15.1	13.2	45.0	3.0	15.0
215+20	TO	226+13	1093.0	27.0		3279.0	2213.3	367.2	321.3	1093.0	72.6	
226+13	TO	226+58	45.0	27.0	135.0		91.1	15.1	13.2	45.0	3.0	15.0
Hutson Rd												
0+00	TO	1+55	155.0	25.0								
1+55	TO	2+00	45.0	25.0	125.0							13.9
Trimble Rd Spur												
375+88	TO	379+30	342.0	Var		400	270	45	39	342		
379+30	TO	379+75	255.0	Var	110.0		74	12	11		3	12
TOTAL (Clark Co)					125	2574	1822	302	265	923	61	14
TOTAL (Crawford Co)					1,410	170483	115943	19238	16833	60775	3818	156
TOTAL					1,535	173,057	117,765	19,540	17,098	61,698	3,879	170

PRINTED DATE: \$DATE\$
FILE NAME: \$FILEL\$



USER NAME = \$USER\$	DESIGNED -	REVISED -
	DRAWN -	REVISED -
PLOT SCALE = \$SCALE\$	CHECKED -	REVISED -
PLOT DATE = \$DATE\$	DATE -	REVISED -

STATE OF ILLINOIS
DEPARTMENT OF TRANSPORTATION

SCHEDULES
SCALE: N/A SHEET NO 1 OF 5 SHEETS

F.A.P. RTE	SECTION	COUNTY	TOTAL SHEETS	SHEET NO
332	(21XNRH, 21NRH 22, 23IRS-3	CLARK & CRAWFORD	33	8
CONTRACT NO 74A06				
ILLINOIS FEDERAL AID PROJECT				

ENTRANCE SCHEDULE

DESCRIPTION	STATION	L/R	RAMP (Y/N)	MATERIAL	LENGTH "L"	WIDTH @ EOP	WIDTH @ "L"	AREA	INCIDENTAL HOT-MIX ASPHALT SURFACING 40800050	SURFACE REMOVAL, VARIABLE DEPTH (SPECIAL) X0326440	AGGREGATE SURFACE COURSE, TYPE B 40200800	TEMPORARY RAMP, SPECIAL X4060995
					FEET	FEET	FEET					
FE	824+95	RT	N	AGG	10	35	25	300.0			4.3	
FE	831+75	LT	N	AGG	10	72	45	585.0			8.3	
PRA - 150N	833+72.5	LT	Y	HMA	10	107	78	925.0	13.0	102.8		23.8
PRA - 150N	833+78	RT	Y	HMA	10	120	81	1005.0	14.1	111.7		26.7
Clark Co. / Crawford Co. Split												
FE	+60.0	RT	N	AGG	10	31	14	225.0			3.2	
FE	13+46.0	RT	N	AGG	10	25	16	205.0			2.9	
PE	17+50.0	RT	Y	AGG	10	39	15	270.0			3.8	8.7
PE	20+06.0	RT	Y	AGG	10	33	16	245.0			3.5	7.3
PE	26+36.0	RT	Y	HMA	10	67	19	430.0	6.0	47.8		14.9
PE	26+42.0	LT	Y	AGG	10	32	17	245.0			3.5	7.1
FE	30+85.0	RT	N	AGG	10	32	28	300.0			4.3	
PE	37+91.0	LT	Y	HMA	7	27	13	140.0	2.0	15.6		6.0
PE	42+04.0	RT	Y	AGG	10	30	13	215.0			3.1	6.7
FE	46+30.0	LT	N	AGG	10	35	15	250.0			3.6	
FE	47+45.0	RT	N	AGG	10	35	15	250.0			3.6	
PE	52+80.0	LT	Y	AGG	10	45	25	350.0			5.0	10.0
MBT	54+30.0	LT	N	AGG	10	30	11	205.0			2.9	
PE	54+30.0	LT	Y	HMA	10	45	25	350.0	4.9	38.9		10.0
FE	56+51.0	RT	N	AGG	10	35	20	275.0			3.9	
FE	65+60.0	RT	N	AGG	18	36	18	486.0			6.9	
PRA - E 2075th Ave	68+75.0	LT	Y	HMA	10	100	56	780.0	10.9	86.7		22.2
MBT	69+30.0	LT	N	AGG	9	75	1	342.0			4.9	
PE	69+30.0	RT	Y	AGG	10	42	30	360.0			5.1	9.3
PE	71+96.0	RT	Y	AGG	10	41	18	295.0			4.2	9.1
PE	79+15.0	RT	Y	AGG	10	55	31	430.0		22.2	6.1	12.2
FE	84+40.0	LT	N	AGG	10	35	22	285.0			4.1	
FE	86+82.0	RT	N	AGG	10	27	15	210.0			3.0	
MBT	87+51.0	LT	N	AGG	5	20	12	80.0			1.1	
PE	87+51.0	LT	Y	AGG	10	41	20	305.0		25.6	4.3	9.1
FE	94+83.0	RT	N	AGG	10	44	23	335.0			4.8	
FE	94+83.0	LT	N	AGG	10	44	23	335.0			4.8	
PE	97+78.0	RT	Y	AGG	10	40	21	305.0			4.3	8.9
PRA - 2000th Ave	105+61.5	RT	Y	HMA	10	126	87	1065.0	14.9	118.3		28.0
PRA - 2000th Ave	106+17.0	LT	Y	HMA	10	103	70	865.0	12.1	96.1		22.9
FE	114+40.0	RT	N	AGG	10	60	42	510.0			7.3	
FE	118+58.0	LT	N	AGG	10	37	18	275.0			3.9	
MBT	118+94.0	RT	N	AGG	10	33	21	270.0			3.8	
FE	118+94.0	RT	N	AGG	10	37	16	265.0			3.8	
PE	119+30.0	LT	Y	AGG	10	67	33	500.0			7.1	14.9
PE	131+67.0	LT	Y	AGG	10	58	32	450.0			6.4	12.9
PE	132+82.0	LT	Y	HMA	15	41	19	450.0	6.3	50.0		9.1
FE	133+95.0	RT	N	AGG	10	30	24	270.0			3.8	
PE	139+55.0	RT	Y	AGG	10	37	20	285.0			4.1	8.2
PE	140+40.0	RT	Y	AGG	10	25	20	225.0			3.2	5.6
FE	144+46.0	LT	N	AGG	10	41	25	330.0			4.7	
PE	147+78.0	RT	Y	AGG	10	48	16	320.0			4.6	10.7
PE	148+70.0	LT	Y	AGG	10	27	16	215.0			3.1	6.0
MBT	149+26.0	RT	N	AGG	8	40	10	200.0			2.8	
PE	149+26.0	RT	Y	AGG	10	37	15	260.0			3.7	8.2
PE	153+49.0	LT	Y	AGG	10	50	25	375.0			5.3	11.1
MBT	153+56.0	RT	N	AGG	4	28	12	80.0			1.1	
PRA - 1900th Ave	161+00.0	LT	Y	HMA	10	90	44	670.0	9.4	74.4		20.0
PRA - 1900th Ave	161+00.0	RT	Y	HMA	10	84	47	655.0	9.2	72.8		18.7
FE	167+53.0	RT	N	AGG	10	50	33	415.0			5.9	
FE	174+16.0	RT	N	AGG	10	30	20	250.0			3.6	
FE	177+87.0	LT	N	AGG	10	37	23	300.0			4.3	
FE	189+41.0	RT	N	AGG	10	31	18	245.0			3.5	
FE	190+00.0	LT	N	AGG	10	31	21	260.0			3.7	
PE	192+30.0	RT	Y	AGG	10	33	17	250.0			3.6	7.3
MBT	192+30.2	LT	N	AGG	4	44	23	134.0			1.9	
MBT	193+35.2	LT	N	AGG	4	43	23	132.0			1.9	
PE	193+38.4	RT	Y	AGG	10	28	15	215.0			3.1	6.2
MBT	196+40.0	LT	N	AGG	5	41	32	182.5			2.6	
PE	196+40.0	LT	Y	AGG	10	54	27	405.0			5.8	12.0
PE	196+50.0	RT	Y	AGG	10	28	11	195.0			2.8	6.2
FE	197+39.0	RT	N	HMA	10	56	22	390.0	5.5	43.3		
FE	209+13.0	RT	N	HMA	10	50	33	415.0	5.8	46.1		
PRA - 1800th Ave	215+01.6	RT	Y	HMA	10	62	38	500.0	7.0	55.6		13.8
PRA - 1800th Ave	215+01.6	LT	Y	HMA	10	62	41	515.0	7.2	57.2		13.8
MBT	223+17.0	RT	N	AGG	4	40	15	110.0			1.6	
PE	223+17.0	LT	Y	AGG	10	37	17	270.0			3.8	8.2
FE	227+14.0	LT	N	AGG	10	35	12	235.0			3.3	
FE	229+14.0	RT	N	AGG	10	27	12	195.0			2.8	

PRINTED DATE: \$DATE\$
FILE NAME: \$FILE\$



USER NAME = \$USER\$	DESIGNED -	REVISED -
	DRAWN -	REVISED -
PLOT SCALE = \$SCALE\$	CHECKED -	REVISED -
PLOT DATE = \$DATE\$	DATE -	REVISED -

STATE OF ILLINOIS
DEPARTMENT OF TRANSPORTATION

SCALE: N/A SHEET NO 2 OF 5 SHEETS

SCHEDULES

F.A.P. RTE	SECTION	COUNTY	TOTAL SHEETS	SHEET NO
332	(21XNRH, 21NRH 22, 23)RS-3	CLARK & CRAWFORD	33	9
			CONTRACT NO 74A06	
ILLINOIS FEDERAL AID PROJECT				

ENTRANCE SCHEDULE

DESCRIPTION	STATION	L/R	RAMP (Y/N)	MATERIAL	LENGTH "L" FEET	WIDTH @ EOP FEET	WIDTH @ "L" FEET	AREA SQ FT	INCIDENTAL HOT-MIX ASPHALT SURFACING 40800050 TON	SURFACE REMOVAL, VARIABLE DEPTH (SPECIAL) X0326440 SQ YD	AGGREGATE SURFACE COURSE, TYPE B 40200800 TON	TEMPORARY RAMP, SPECIAL X4060995 SQ YD
CE	242+35.0	RT	Y	CONC.	10	107	55	810.0				23.8
FE	255+53.0	LT	N	AGG	10	30	18	240.0			3.4	
FE	255+53.0	RT	N	AGG	10	28	18	230.0			3.3	
MBT	258+70.0	RT	N	AGG	5	18	25	107.5			1.5	
PE	258+70.0	RT	Y	AGG	10	44	27	355.0			5.1	9.8
MBT	262+25.0	RT	N	AGG	5	15	14	72.5			1.0	
PE	262+25.0	RT	Y	AGG	10	37	17	270.0			3.8	8.2
PRA - 1700th Ave	268+94.0	RT	Y	HMA	10	122	73	975.0	13.7	108.3		27.1
MBT	270+00.0	LT	N	AGG	7	42	26	238.0			3.4	
PE	270+25.0	LT	Y	AGG	10	52	37	445.0			6.3	11.6
PE	273+86.0	RT	Y	AGG	10	59	31	450.0			6.4	13.1
PE	275+75.0	RT	Y	AGG	10	34	14	240.0			3.4	7.6
PE	276+54.0	RT	Y	HMA	10	47	24	355.0	5.0	39.4		10.4
MBT	276+64.0	RT	N	AGG	7	30	1	108.5			1.5	
MBT	277+12.0	LT	N	AGG	7	21	19	140.0			2.0	
PE	277+30.0	LT	Y	HMA	10	36	16	260.0	3.6	28.9		8.0
FE	282+20.0	LT	N	AGG	10	25	14	195.0			2.8	
PE	282+20.0	RT	Y	AGG	10	45	30	375.0			5.3	10.0
MBT	282+39.0	RT	N	AGG	7	50	1	178.5			2.5	
FE	283+05.0	RT	N	AGG	10	35	23	290.0			4.1	
PE	291+80.0	RT	Y	AGG	10	44	23	335.0			4.8	9.8
MBT	294+34.0	LT	N	AGG	5	17	16	82.5			1.2	
PE	294+34.0	LT	Y	AGG	10	44	20	320.0			4.6	9.8
MBT	294+90.0	RT	N	AGG	7	40	1	143.5			2.0	
PRA - 1650th Ave	295+39.0	RT	Y	HMA	10	48	29	385.0	5.4	42.8		10.7
PE	306+25.0	LT	Y	AGG	6	56	27	249.0			3.5	12.4
MBT	306+30.0	LT	N	AGG	5	30	1	77.5			1.1	
FE	319+35.0	LT	N	AGG	10	20	12	160.0			2.3	
MBT	321+00.0	LT	N	AGG	7	40	1	143.5			2.0	
PE	321+20.0	LT	Y	HMA	10	31	18	245.0	3.4	27.2		6.9
FE	321+45.0	RT	N	AGG	10	45	34	395.0			5.6	
PE	324+65.0	LT	Y	AGG	10	30	15	225.0			3.2	6.7
PE	329+00.0	LT	Y	HMA	10	35	19	270.0	3.8	30.0		7.8
FE	330+00.0	LT	N	AGG	10	33	16	245.0			3.5	
FE	330+18.0	RT	N	AGG	10	34	20	270.0			3.8	
PRA - 1550th Ave	338+52.5	RT	Y	HMA	10	101	62	815.0	11.4	90.6		22.4
FE	339+00.0	RT	N	AGG	10	37	18	275.0			3.9	
PE	340+40.0	LT	Y	AGG	10	113	75	940.0			13.4	25.1
FE	348+35.0	LT	N	AGG	10	31	19	250.0			3.6	
PE	350+35.0	LT	Y	AGG	10	54	23	385.0			5.5	12.0
FE	352+40.0	RT	N	AGG	10	81	52	665.0			9.5	
PRA - 1500th Ave	362+64.5	LT	Y	HMA	10	93	55	740.0	10.4	82.2		20.7
FE	365+00.0	RT	N	AGG	10	50	30	400.0			5.7	
FE	369+00.0	LT	N	AGG	10	50	30	400.0			5.7	
FE	369+00.0	RT	N	AGG	10	50	30	400.0			5.7	
PE	372+55.0	LT	Y	AGG	10	50	31	405.0			5.8	11.1
FE	0+75.0	RT	N	AGG	10	43	41	420.0			6.0	
PRA - Trimble S Spur	7+00.0	RT	Y	HMA	10	93	77	850.0	11.9	94.4		20.7
PE	8+77.0	RT	Y	AGG	10	26	12	190.0			2.7	5.8
PE	9+56.0	RT	Y	AGG	10	26	12	190.0			2.7	5.8
MBT	10+00.0	RT	N	AGG	10	15	25	200.0			2.8	
CE	10+56.0	RT	Y	AGG	10	36	24	300.0			4.3	8.0
PE	14+48.0	LT	Y	AGG	10	35	20	275.0			3.9	7.8
MBT	15+05.0	RT	N	AGG	9	110	1	499.5			7.1	
PE	15+05.0	LT	Y	AGG	10	35	13	240.0			3.4	7.8
PE	15+60.0	LT	Y	AGG	10	42	19	305.0			4.3	9.3
PE	17+48.0	LT	Y	AGG	10	30	16	230.0			3.3	6.7
MBT	17+65.0	RT	N	AGG	10	17	10	135.0			1.9	
PRA	18+12.0	RT	Y	HMA	10	40	20	300.0	4.2	33.3		8.9
MBT	19+60.0	RT	N	HMA	5	30	13	107.5	1.5	11.9		
PE	19+90.0	LT	Y	AGG	10	24	14	190.0			2.7	5.3
PE	20+25.0	LT	Y	AGG	10	24	14	190.0			2.7	5.3
MBT	21+23.0	RT	N	HMA	8	21	41	248.0	3.5	27.6		
PE	21+30.0	LT	Y	HMA	10	32	16	240.0	3.4	26.7		7.1
PRA	22+83.0	RT	Y	HMA	10	38	18	280.0	3.9	31.1		8.4
MBT	23+20.0	RT	N	HMA	7	30	12	147.0	2.1	16.3		
PE	23+53.0	RT	Y	HMA	10	58	16	370.0	5.2	41.1		12.9
PE	23+68.0	LT	Y	HMA	10	31	13	220.0	3.1	24.4		6.9
PE	23+88.0	LT	Y	HMA	10	52	15	335.0	4.7	37.2		11.6
PRA	26+00.0	RT	Y	HMA	10	32	14	230.0	3.2	25.6		7.1
MBT	26+00.0	RT	N	HMA	8	21	28	196.0	2.7	21.8		
PE	26+80.0	LT	Y	AGG	10	70	33	515.0			7.3	15.6
PRA - 1425th Ave	28+09.5	LT	Y	HMA	10	67	39	530.0	7.4	58.9		14.9
PRA - 1425th Ave	29+48.5	RT	Y	HMA	10	66	38	520.0	7.3	57.8		14.7

PRINTED DATE: \$DATE\$
FILE NAME: \$FILE\$



USER NAME = \$USER\$	DESIGNED -	REVISED -
	DRAWN -	REVISED -
PLOT SCALE = \$SCALE\$	CHECKED -	REVISED -
PLOT DATE = \$DATE\$	DATE -	REVISED -

STATE OF ILLINOIS
DEPARTMENT OF TRANSPORTATION

SCHEDULES	
SCALE: N/A	SHEET NO 3 OF 5 SHEETS

F.A.P. RTE	SECTION	COUNTY	TOTAL SHEETS	SHEET NO
332	(21XNRH, 21NRH 22, 23)RS-3	CLARK & CRAWFORD	33	10
CONTRACT NO 74A06				
ILLINOIS FEDERAL AID PROJECT				

ENTRANCE SCHEDULE

DESCRIPTION	STATION	L/R	RAMP (Y/N)	MATERIAL	LENGTH "L"	WIDTH @ EOP	WIDTH @ "L"	AREA	INCIDENTAL HOT-MIX ASPHALT SURFACING 40800050 TON	SURFACE REMOVAL, VARIABLE DEPTH (SPECIAL) X0326440 SQ YD	AGGREGATE SURFACE COURSE, TYPE B 40200800 TON	TEMPORARY RAMP, SPECIAL X4060995 SQ YD
					FEET	FEET	FEET	SQ FT				
32+00	30+00.0	LT	N	AGG	10	40	23	315.0			4.5	
PE	32+28.0	LT	Y	AGG	10	25	15	200.0			2.8	5.6
MBT	33+01.0	RT	N	AGG	7	15	20	122.5			1.7	
PE	33+01.0	RT	Y	AGG	10	25	15	200.0			2.8	5.6
PE	33+01.0	LT	Y	AGG	10	25	15	200.0			2.8	5.6
MBT	33+60.0	RT	N	AGG	7	15	20	122.5			1.7	
PE	33+60.0	RT	Y	AGG	10	25	15	200.0			2.8	5.6
PE	34+32.0	LT	Y	AGG	10	96	63	795.0			11.3	21.3
PRA	34+61.0	RT	Y	HMA	12	40	23	378.0	5.3	42.0		8.9
PE	35+00.0	RT	Y	AGG	10	40	33	365.0			5.2	8.9
MBT	35+50.0	RT	N	AGG	7	34	28	217.0			3.1	
PE	36+05.0	LT	Y	AGG	10	35	15	250.0			3.6	7.8
MBT	36+62.0	RT	N	AGG	10	30	20	250.0			3.6	
PRA	37+13.0	RT	Y	AGG	10	36	24	300.0			4.3	8.0
FE	37+60.0	LT	N	AGG	10	48	38	430.0			6.1	
MBT	39+80.0	RT	N	AGG	7	45	1	161.0			2.3	
FE	39+80.0	RT	N	AGG	10	24	13	185.0			2.6	
FE	40+96.0	RT	N	AGG	10	20	36	280.0			4.0	
FE	49+00.0	LT	N	AGG	10	39	33	360.0			5.1	
FE	49+00.0	RT	N	AGG	10	31	15	230.0			3.3	
PE	53+83.0	LT	Y	AGG	10	35	17	260.0			3.7	7.8
FE	59+43.7	RT	N	AGG	10	20	15	175.0			2.5	
FE	67+25.0	LT	N	AGG	10	40	18	290.0			4.1	
FE	78+55.0	LT	N	AGG	10	26	17	215.0			3.1	
CE	79+40.0	RT	Y	AGG	10	52	24	380.0			5.4	11.6
MBT	80+30.0	RT	N	AGG	7	36	21	199.5			2.8	
CE	80+30.0	RT	Y	AGG	10	47	19	330.0			4.7	10.4
CE	82+55.0	RT	Y	AGG	10	63	32	475.0			6.8	14.0
FE	88+00.0	LT	N	AGG	10	30	35	325.0			4.6	
FE	92+00.0	LT	N	AGG	10	60	35	475.0			6.8	
PRA - 1300th Ave	94+35.0	LT	Y	HMA	10	59	38	485.0	6.8	53.9		13.1
PE	95+06.0	LT	Y	AGG	10	31	13	220.0			3.1	6.9
PRA - 1300th Ave	95+62.5	RT	Y	HMA	10	63	35	490.0	6.9	54.4		14.0
FE	103+50.0	RT	N	AGG	10	32	17	245.0			3.5	
FE	103+50.0	LT	N	AGG	10	32	25	285.0			4.1	
FE	111+20.0	LT	N	AGG	10	30	13	215.0			3.1	
FE	113+55.0	RT	N	AGG	10	30	13	215.0			3.1	
MBT	117+00.0	RT	N	AGG	7	43	23	231.0			3.3	
PE	117+00.0	LT	Y	AGG	10	35	15	250.0			3.6	7.8
FE	119+88.0	RT	N	AGG	10	24	17	205.0			2.9	
FE	119+98.0	LT	N	AGG	10	44	30	370.0			5.3	
FE	120+57.0	RT	N	AGG	10	31	23	270.0			3.8	
PRA - 1250th Ave	122+30.0	RT	Y	HMA	10	51	32	415.0	5.8	46.1		11.3
PRA - 1235th Ave	127+04.0	LT	Y	HMA	10	53	39	460.0	6.4	51.1		11.8
FE	129+90.0	LT	N	AGG	10	19	10	145.0			2.1	
FE	146+15.0	LT	N	AGG	10	29	15	220.0			3.1	
FE	148+40.0	RT	N	AGG	10	43	26	345.0			4.9	
MBT	149+75.0	RT	N	AGG	7	24	40	224.0			3.2	
PE	149+75.0	RT	Y	AGG	10	44	24	340.0			4.8	9.8
PRA - E Willis DR	151+35.0	RT	Y	HMA	10	55	38	465.0	6.5	51.7		12.2
FE	159+75.0	LT	N	AGG	10	23	15	190.0			2.7	
FE	159+75.0	RT	N	AGG	10	35	20	275.0			3.9	
PRA - 1150th Ave	173+40.0	LT	Y	HMA	10	58	37	475.0	6.7	52.8		12.9
PRA - 1150th Ave	175+30.0	RT	Y	HMA	10	94	61	775.0	10.9	86.1		20.9
FE	175+30.0	LT	N	AGG	10	33	22	275.0			3.9	
FE	179+85.0	LT	N	AGG	10	35	18	265.0			3.8	
MBT + FE	188+70.0	RT	N	AGG	10	75	30	525.0			7.5	
CE	189+75.0	LT	Y	AGG	10	28	10	190.0			2.7	6.2
CE	190+00.0	RT	Y	HMA	10	113	84	985.0	13.8	109.4		25.1
PE	190+05.0	LT	Y	AGG	10	28	10	190.0			2.7	6.2
MBT	191+31.0	RT	N	AGG	7	77	12	311.5			4.4	
PE	191+31.0	LT	Y	AGG	10	28	10	190.0			2.7	6.2
CE	199+26.0	LT	Y	HMA	10	61	32	465.0	6.5	51.7		13.6
FE		RT	N	AGG	10	15	7	110.0			1.6	
CE	213+60.0	LT	Y	HMA	10	64	25	445.0	6.2	49.4		14.2
CE	216+25.0	LT	Y	HMA	10	54	25	395.0	5.5	43.9		12.0
CE	221+02.0	LT	Y	HMA	10	153	89	1210.0	16.9	134.4		34.0
CE	222+15.0	LT	Y	HMA	10	82	37	595.0	8.3	66.1		18.2
CE	225+36.0	LT	Y	HMA	10.0	87.0	46.0	665.0	9.3	73.9		19.3
TOTAL (Clark Co.)									27	214	13	50
TOTAL (Crawford Co.)									344	2775	635	1257
JOB TOTAL									371	2989	648	1307

PRINTED DATE: \$DATE\$
FILE NAME: \$FILE\$



USER NAME = \$USER\$	DESIGNED -	REVISED -
	DRAWN -	REVISED -
PLOT SCALE = \$SCALE\$	CHECKED -	REVISED -
PLOT DATE = \$DATE\$	DATE -	REVISED -

STATE OF ILLINOIS
DEPARTMENT OF TRANSPORTATION

SCHEDULES

SCALE: N/A SHEET NO 4 OF 5 SHEETS

F.A.P. RTE	SECTION	COUNTY	TOTAL SHEETS	SHEET NO
332	(21XNRH, 21NRH 22, 23)RS-3	CLARK & CRAWFORD	33	11
ILLINOIS FEDERAL AID PROJECT			CONTRACT NO 74A06	

PAVEMENT MARKING SCHEDULE																
STATION	TO	STATION	LENGTH	PAINT PAVEMENT MARKING - LINE 4" (WHITE) 78001110	PAINT PAVEMENT MARKING - LINE 4" (YELLOW) 78001110	THERMOPLASTIC PAVEMENT MARKING - LETTERS AND SYMBOLS 78000100	THERMOPLASTIC PAVEMENT MARKING - LINE 4" 78000200		THERMOPLASTIC PAVEMENT MARKING - LINE 6" 78000400	THERMOPLASTIC PAVEMENT MARKING - LINE 8" 78000500	THERMOPLASTIC PAVEMENT MARKING - LINE 12" 78000600	THERMOPLASTIC PAVEMENT MARKING - 24" 78000650	GROOVING FOR RECESSED PAVEMENT MARKING - LETTERS AND SYMBOLS 78011000	GROOVING FOR RECESSED PAVEMENT MARKING 5" 78011025	GROOVING FOR RECESSED PAVEMENT MARKING - 7" 78011035	GROOVING FOR RECESSED PAVEMENT MARKING - 9" 78011045
			FOOT	FOOT	FOOT	SQ FT	(WHITE) - FOOT	(YELLOW) - FOOT	FOOT	FOOT	FOOT	(White) FOOT	SQ FT	FOOT	FOOT	FOOT
824+50.00	TO	833+72.55	922.6	1,845	1,153											
833+72.60	TO	835+55.90	283.3	567	442											
Sta. 836+55.9 BK = Sta. 0+00.00 AH																
0+00.00	TO	215+01.60	21501.6	43,003	13,142											
Sta. 215+01.6 BK = 215+73.8 AH																
215+74.00	TO	233+00.00	1726.0	3,452	1,114											
233+00.00	TO	249+10.00	1610.0			255	3,442	3,504	200	2,319	140	45	255	6946	200	2319
249+10.00	TO	375+25.00	12615.0	25,230	8,027											
Sta. 375+25.30 BK = Sta. 0+00.00 AH																
0+00.00	TO	225+58.00	22658	45,316	8,513							31				
Trimble RD Spur																
375+88.00	TO	379+75.00	387.00	387	86											
EDGELINE DEDUCTIONS				1,764												
TOTAL (Clark Co.)				1,651	1,153											
TOTAL (Crawford Co.)				116,385	31,324	255	3,442	3,504	200	2,319	140	76	255	6946	200	2319
TOTAL				150,513	42,477	255	6,946	7,008	200	2,319	140	76	255	6946	200	2319

STATION	TO	STATION	RAISED REFLECTIVE PAVEMENT MARKER REMOVAL 78300200	
			Clark Co	Crawford Co
824+50.00	TO	833+72.55	12	
833+72.55	TO	836+55.90		4
Sta. 836+55.9 BK = Sta. 0+00.00 AH				
0+00	TO	215+02.00		269
Sta. 215+01.6 BK = Sta. 215+73.8 AH				
215+74.00	TO	375+25.30		287
Sta. 375+25.3 BK = Sta. 0+00.00 AH				
0+00	TO	226+58.00		284
Total			12	844
TOTAL			12	856

STATION	TO	STATION	RAISED REFLECTIVE PAVEMENT MARKER 78100100		Clark Co Total	Crawford Co Total
			CRYSTAL	AMBER		
824+50.00	TO	833+72.55		12.0	12	
833+72.55	TO	836+55.90		4.0		4
Sta. 836+55.9 BK = Sta. 0+00.00 AH						
0+00	TO	215+02.00	27.0	269.0		296
Sta. 215+01.6 BK = Sta. 215+73.8 AH						
215+74.00	TO	375+25.30		260.0		260
Sta. 375+25.30 BK = Sta. 0+00.00 AH						
0+00	TO	226+58.00		284.0		284
TOTAL			27.0	515.0	12	584

SURVEY MARKER SCHEDULE								
POINT	NORTHING	EASTING	STATION	OFFSET	DESCRIPTION	PROPOSED PROTECT OR RESET DEVICE	PROTECTING OR RESETTING SURVEY MARKERS Z0049799	PERMANENT SURVEY MARKERS, TYPE I 66700205
							EACH	EACH
102	913672.68	1169525.04	827+03.59	0	ALUM DISK - PC	TYPE I - ALUM. IDOT DISK	1	
100	912837.16	1169154.45	836+45.92	0	ALUM DISK - PT	TYPE I - ALUM. IDOT DISK	1	
133	902573.61	1168321.21	105+62	8.5' LT	MAG NAIL - SE COR. SEC 12, T8N, R12W	MAG NAIL	1	
104	891974.82	1168362.52	215+74	4.2' RT	MAG NAIL W/WASHER - NW COR. SEC 30	TYPE I - ALUM. IDOT DISK	1	1
105	889311.96	1168380.07	242+36	0	MAG NAIL W/WASHER - W 1/4 SEC 30	TYPE I - ALUM. IDOT DISK	1	1
106	886658.95	1168396.49	268+90	0	MAG NAIL - SW COR. SEC 30	TYPE I - ALUM. IDOT DISK	1	1
107	881346.60	1168434.72	321+95	0	MAG NAIL - NE COR. SEC 1	MAG NAIL	1	
108	879686.42	1168441.01	338+45	0	MAGNAIL SEC. COR. E 1/4 SEC 1	MAG NAIL	1	
110	876005.55	1168462.73	375+25.30 Bk = 0+00 Ah	1.4' LT	SAB #981 MAG NAIL	TYPE I - ALUM. IDOT DISK	1	1
111	871937.07	1168483.23	40+69	0.7' RT	MAG NAIL POSSIBLE NW SEC 18	MAG NAIL	1	
112	871936.67	1168483.90	40+69	0	MAG NAIL POSSIBLE NW SEC 18	MAG NAIL	1	
113	871739.04	1168483.95	42+67	1.4' RT	MAG NAIL NE SEC 13	MAG NAIL	1	
114	869093.80	1168496.26	69+12	3.0' RT	MAG NAIL E 1/4 SEC 13	MAG NAIL	1	
115	866634.15	1168507.57	93+71	4.8' RT	IDOT ALUM DISK. NW COR SEC 19	TYPE I - ALUM. IDOT DISK	1	
116	866634.17	1168512.39	93+71	0	MAG NAIL (TIE FOR #114 OR POSSIBLE CL POT)	MAG NAIL	1	
117	866439.99	1168508.42	95+66	5.2' RT	MAGNAIL. SE COR SEC 13	MAG NAIL	1	
123	863978.84	1168519.72	120+26.95	6.7' RT	IDOT ALUM DISK. W 1/4 SEC 19	TYPE I - ALUM. IDOT DISK	1	
124	863779.36	1168520.63	122+26.44	6.8' RT	MAG NAIL SEC COR E 1/4 24	MAG NAIL	1	
126	861343.21	1168528.37	146+63	8.2' RT	IDOT ALUM DISK. SW COR SEC 19	TYPE I - ALUM. IDOT DISK	1	
127	861144.59	1168529.10	148+62	7.5' RT	MAG NAIL SE COR SEC 24	MAG NAIL	1	
128	858479.66	1168540.06	175+27	4' RT	MAG NAIL E 1/4 SEC 25	MAG NAIL	1	
130	856056.38	1168550.06	199+50	0.7' RT	IDOT ALUM DISK	TYPE I - ALUM. IDOT DISK	1	
131	855830.46	1168550.95	201+76	0	MAG NAIL. SE COR SEC 25	MAG NAIL	1	
132	853292.64	1168558.70	227+13	0.8' LT	IDOT ALUM DISK. W 1/4 SEC 31	TYPE I - ALUM. IDOT DISK	1	
(CLARK CO.) TOTAL							1	
(CRAWFORD CO.) TOTAL							23	4
JOB TOTAL							24	4

PRINTED DATE: \$DATE\$
FILE NAME: \$FILE\$



USER NAME = \$USER\$	DESIGNED -	REVISED -
PLOT SCALE = \$SCALE\$	DRAWN -	REVISED -
PLOT DATE = \$DATE\$	CHECKED -	REVISED -
	DATE -	REVISED -

STATE OF ILLINOIS
DEPARTMENT OF TRANSPORTATION

SCHEDULES
SCALE: N/A SHEET NO 5 OF 5 SHEETS

F.A.P. RTE	SECTION	COUNTY	TOTAL SHEETS	SHEET NO
332	(21XNRH, 21NRH 22, 23JRS-3	CLARK & CRAWFORD	33	12
CONTRACT NO 74A06			ILLINOIS FEDERAL AID PROJECT	

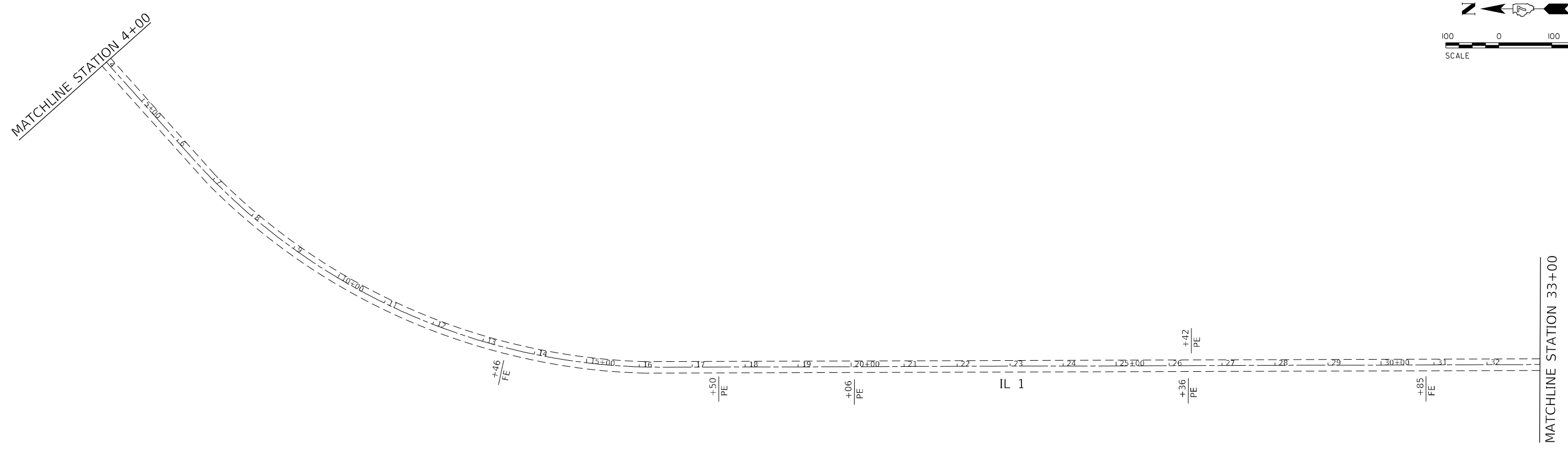
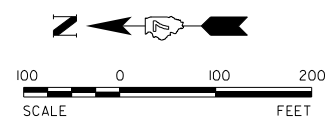
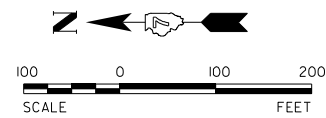

PRINTED DATE: \$DATE\$
FILE NAME: \$FILEL\$



USER NAME = \$USER\$	DESIGNED -	REVISED -
	DRAWN -	REVISED -
PLOT SCALE = \$SCALE\$	CHECKED -	REVISED -
PLOT DATE = \$DATE\$	DATE -	REVISED -

**STATE OF ILLINOIS
DEPARTMENT OF TRANSPORTATION**

IL ROUTE 1		
SCALE: 1"=100'	SHEET NO 1 OF 12 SHEETS	STA 824+50 TO STA 33+00

F.A.P. RTE	SECTION	COUNTY	TOTAL SHEETS	SHEET NO
332	(21XNRH, 21NRH 22, 23IRS-3	CLARK & CRAWFORD	33	13
CONTRACT NO 74A06			ILLINOIS FEDERAL AID PROJECT	

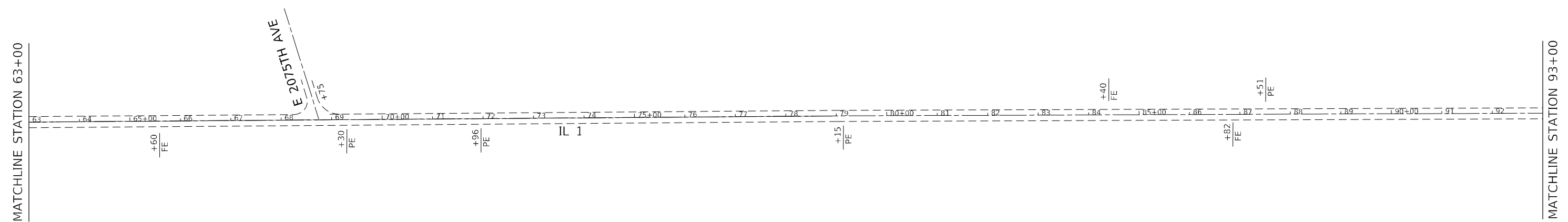
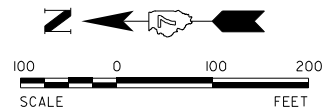
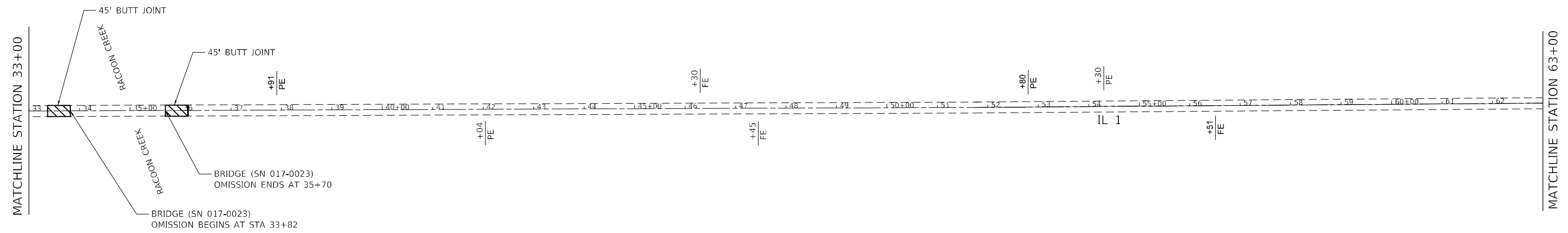
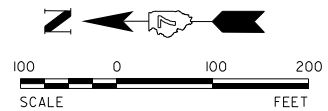

PRINTED DATE: 10/20/10
 FILE NAME: 071110.DWG



USER NAME = #USER#	DESIGNED -	REVISED -
IL ROUTE 1	DRAWN -	REVISED -
PLOT SCALE = #SCALE#	CHECKED -	REVISED -
DATE = 10/20/10	DATE = 10/20/10	REVISED -

**STATE OF ILLINOIS
 DEPARTMENT OF TRANSPORTATION**

IL ROUTE 1

SCALE: 1"=100' SHEET NO 2 OF 12 SHEETS STA 33+00 TO STA 93+00

F.A.P. RTE	SECTION	COUNTY	TOTAL SHEETS	SHEET NO
332	(21XNRH, 21NRH 22, 23)RS-3	CLARK & CRAWFORD	33	14
			CONTRACT NO 74A06	
ILLINOIS FEDERAL AID PROJECT				

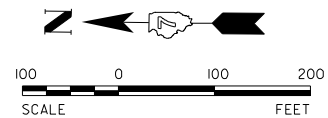

MATCHLINE STATION 93+00

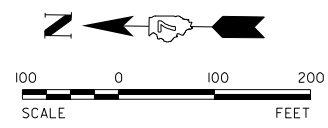
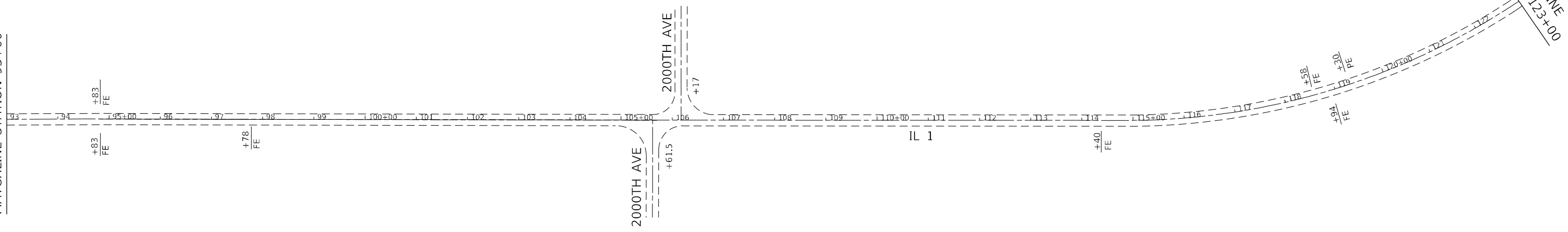

MATCHLINE STATION 123+00



MATCHLINE STATION 153+00

PRINTED DATE: \$DATE\$
FILE NAME: \$FILEL\$



USER NAME = \$USER\$	DESIGNED -	REVISED -
	DRAWN -	REVISED -
PLOT SCALE = \$SCALE\$	CHECKED -	REVISED -
PLOT DATE = \$DATE\$	DATE -	REVISED -

**STATE OF ILLINOIS
DEPARTMENT OF TRANSPORTATION**

IL ROUTE 1

SCALE: 1"=100' SHEET NO 3 OF 12 SHEETS STA 93+00 TO STA 153+00

F.A.P. RTE	SECTION	COUNTY	TOTAL SHEETS	SHEET NO
332	(21XNRH, 21NRH 22, 23IRS-3	CLARK & CRAWFORD	33	15
			CONTRACT NO 74A06	
ILLINOIS FEDERAL AID PROJECT				

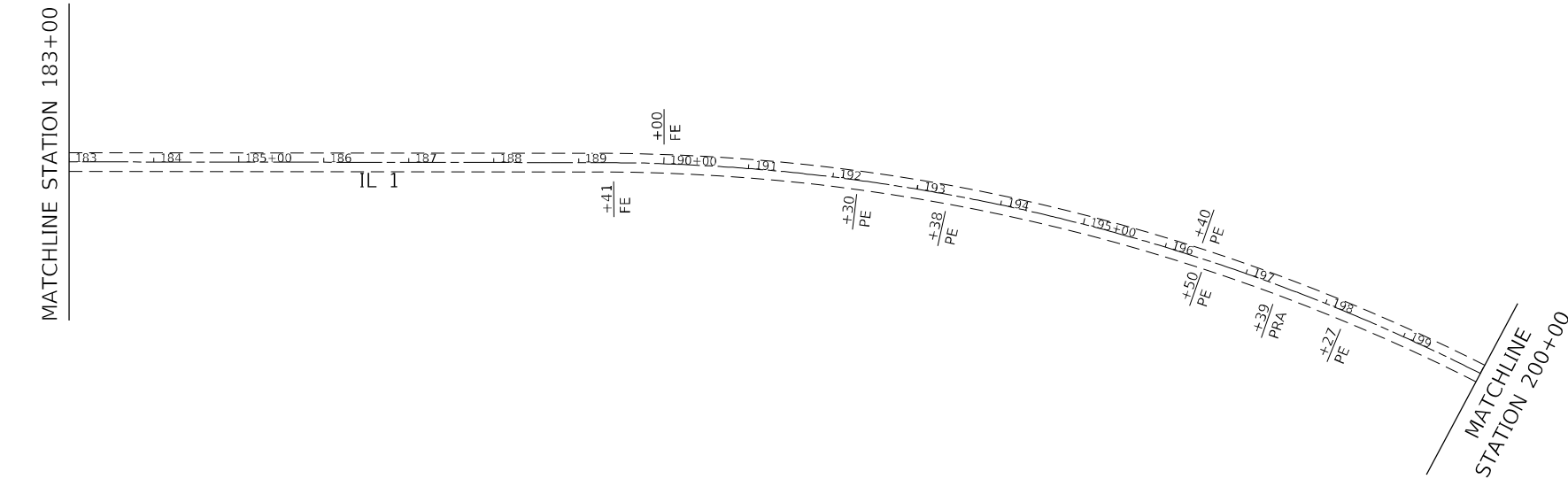
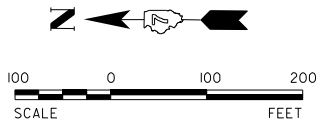
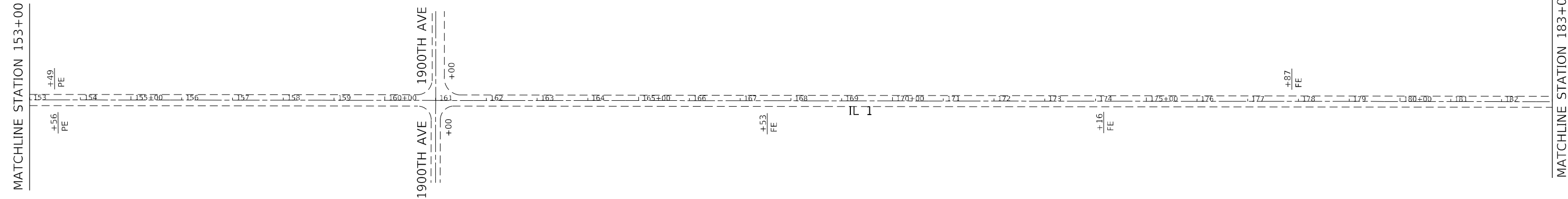
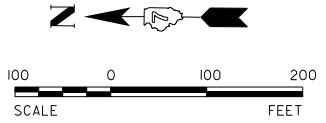

PRINTED DATE: \$DATE\$
FILE NAME: \$FILEL\$



USER NAME = \$USER\$	DESIGNED -	REVISED -
	DRAWN -	REVISED -
PLOT SCALE = \$SCALE\$	CHECKED -	REVISED -
PLOT DATE = \$DATE\$	DATE -	REVISED -

**STATE OF ILLINOIS
DEPARTMENT OF TRANSPORTATION**

IL ROUTE 1

SCALE: 1"=100' SHEET NO 4 OF 12 SHEETS STA 153+00 TO STA 200+00

F.A.P. RTE	SECTION	COUNTY	TOTAL SHEETS	SHEET NO
332	(21XNRH, 21NRH 22, 23)RS-3	CLARK & CRAWFORD	33	16
			CONTRACT NO 74A06	
ILLINOIS FEDERAL AID PROJECT				

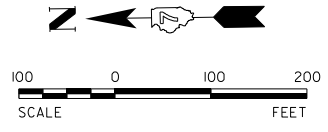

MATCHLINE
STATION 200+00

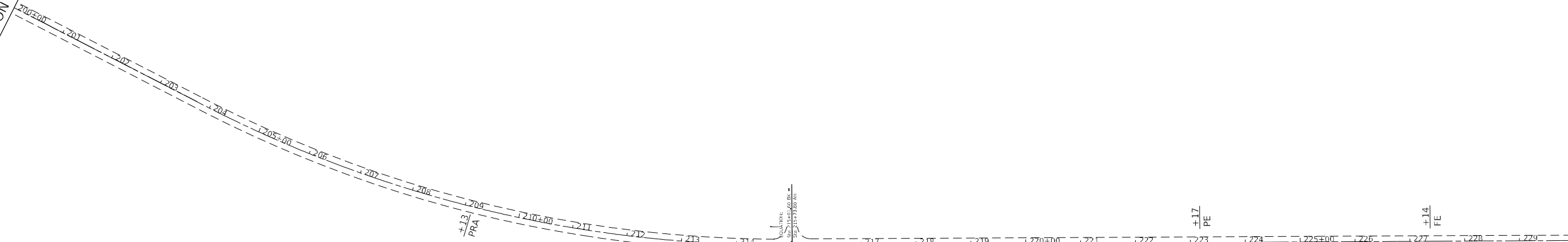

E 1800TH AVE
ADJUSTED
 2015+00.00
 215+00.00
 225+00.00

MATCHLINE STATION 230+00

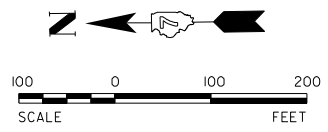

MATCHLINE STATION 230+00

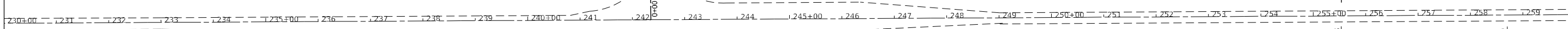

E 1750TH AVE
ADJUSTED
 235+00.00
 242+00.00
 249+00.00

HUTSONVILLE ROAD

MATCHLINE STATION 260+00

PRINTED DATE: \$DATE\$
 FILE NAME: \$FILEL\$



USER NAME = \$USER\$	DESIGNED -	REVISED -
	DRAWN -	REVISED -
PLOT SCALE = \$SCALE\$	CHECKED -	REVISED -
PLOT DATE = \$DATE\$	DATE -	REVISED -

**STATE OF ILLINOIS
 DEPARTMENT OF TRANSPORTATION**

IL ROUTE 1		
SCALE: 1"=100'	SHEET NO 5 OF 12 SHEETS	STA 200+00 TO STA 260+00

F.A.P. RTE	SECTION	COUNTY	TOTAL SHEETS	SHEET NO
332	(21XNRH, 21NRH 22, 23JRS-3	CLARK & CRAWFORD	33	17
CONTRACT NO 74A06			ILLINOIS FEDERAL AID PROJECT	

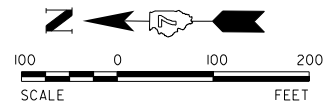

MATCHLINE STATION 260+00

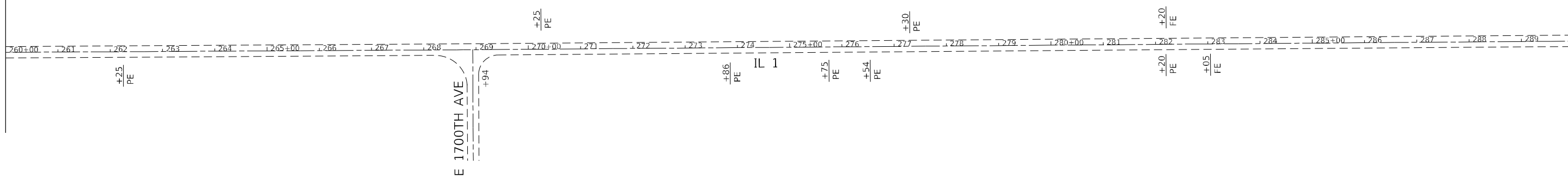

MATCHLINE STATION 290+00

PRINTED DATE: \$DATE\$
FILE NAME: \$FILEL\$



USER NAME = \$USER\$	DESIGNED -	REVISED -
	DRAWN -	REVISED -
PLOT SCALE = \$SCALE\$	CHECKED -	REVISED -
PLOT DATE = \$DATE\$	DATE -	REVISED -

**STATE OF ILLINOIS
DEPARTMENT OF TRANSPORTATION**

IL ROUTE 1

SCALE: 1"=100' SHEET NO 6 OF 12 SHEETS STA 260+00 TO STA 290+00

F.A.P. RTE	SECTION	COUNTY	TOTAL SHEETS	SHEET NO
332	(21XNRH, 21NRH 22, 23)RS-3	CLARK & CRAWFORD	33	18
CONTRACT NO 74A06				
ILLINOIS FEDERAL AID PROJECT				

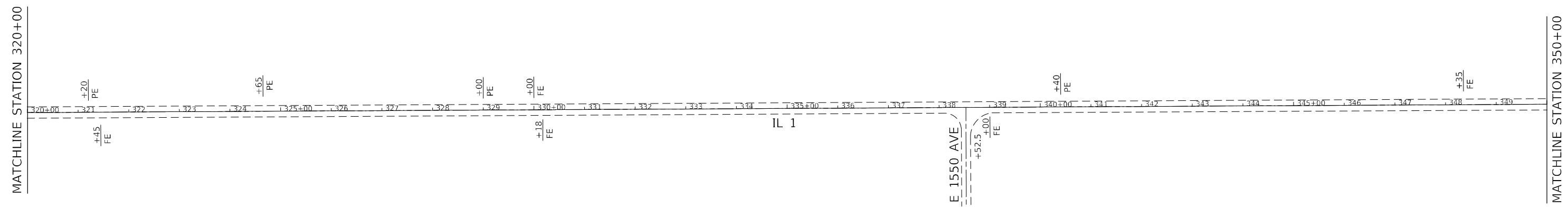
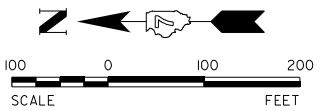
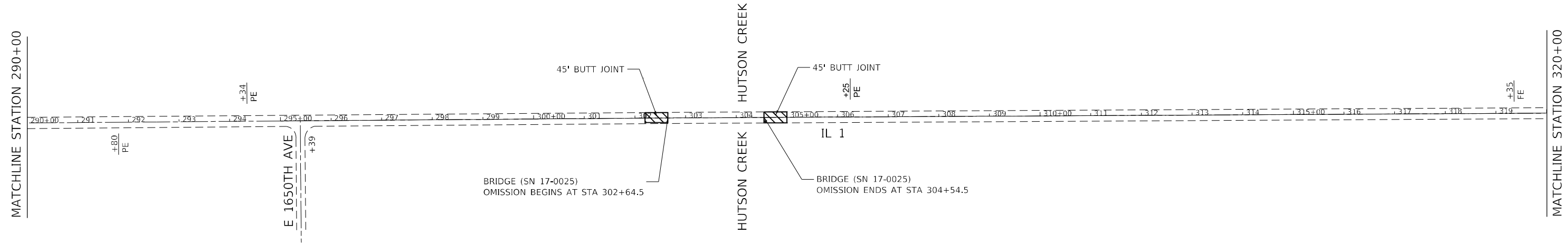
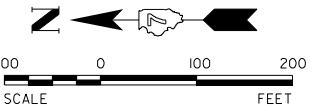

PRINTED DATE: \$DATE\$
FILE NAME: \$FILEL\$



USER NAME = \$USER\$	DESIGNED -	REVISED -
	DRAWN -	REVISED -
PLOT SCALE = \$SCALE\$	CHECKED -	REVISED -
PLOT DATE = \$DATE\$	DATE -	REVISED -

**STATE OF ILLINOIS
DEPARTMENT OF TRANSPORTATION**

IL ROUTE 1

SCALE: 1"=100' SHEET NO 7 OF 12 SHEETS STA 290+00 TO STA 350+00

F.A.P. RTE	SECTION	COUNTY	TOTAL SHEETS	SHEET NO
332	(21XNRH, 21NRH 22, 23IRS-3	CLARK & CRAWFORD	33	19
CONTRACT NO 74A06			ILLINOIS FEDERAL AID PROJECT	

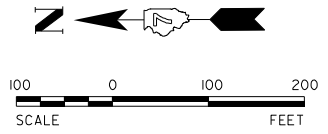

MATCHLINE STATION 350+00

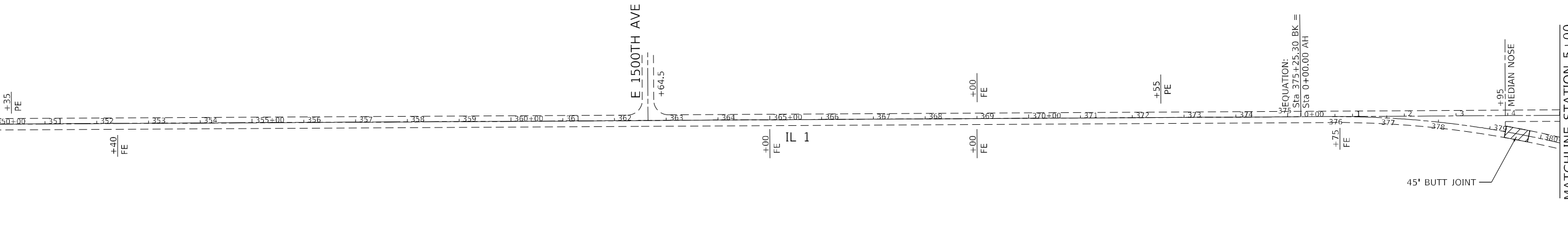

MATCHLINE STATION 5+00

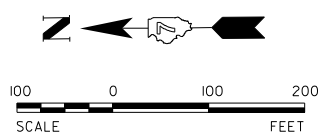

MATCHLINE STATION 5+00

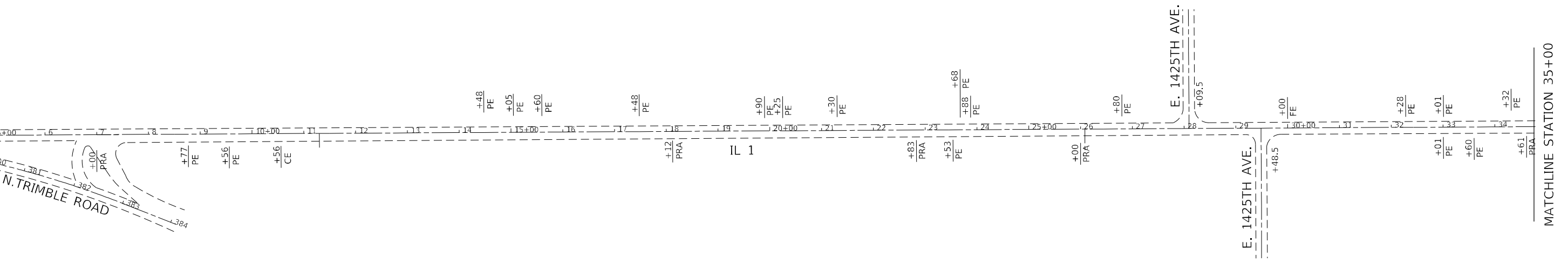

MATCHLINE STATION 35+00

PRINTED DATE: \$DATE\$
FILE NAME: \$FILEL\$



USER NAME = \$USER\$	DESIGNED -	REVISED -
PLOT SCALE = \$SCALE\$	DRAWN -	REVISED -
PLOT DATE = \$DATE\$	CHECKED -	REVISED -
	DATE -	REVISED -

**STATE OF ILLINOIS
DEPARTMENT OF TRANSPORTATION**

IL ROUTE 1
SCALE: 1"=100' SHEET NO 8 OF 12 SHEETS STA 350+00 TO STA 35+00

F.A.P. RTE	SECTION	COUNTY	TOTAL SHEETS	SHEET NO
332	(21XNRH, 21NRH 22, 23JRS-3	CLARK & CRAWFORD	33	20
CONTRACT NO 74A06				
ILLINOIS FEDERAL AID PROJECT				

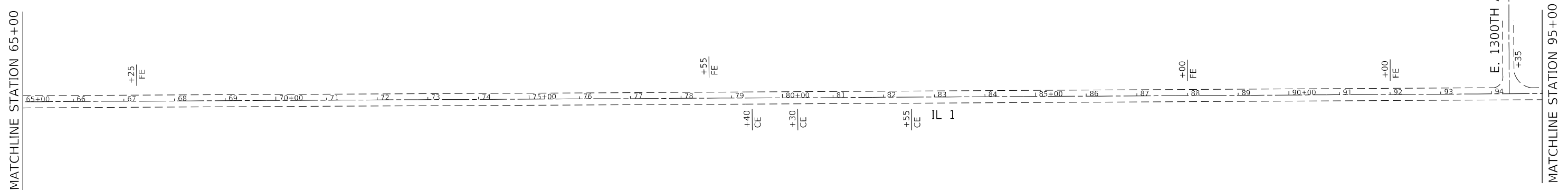
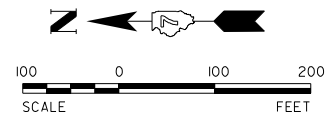
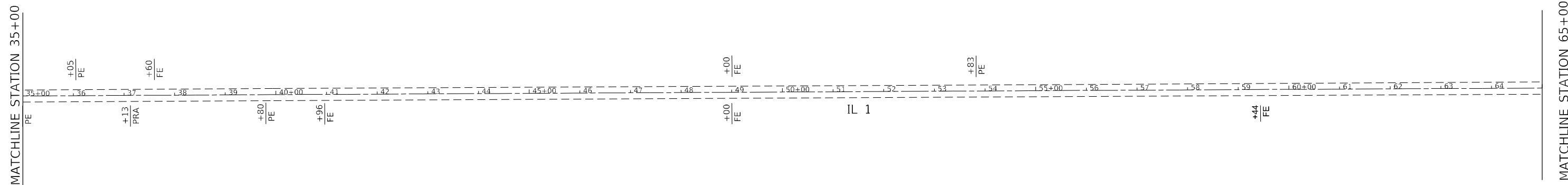
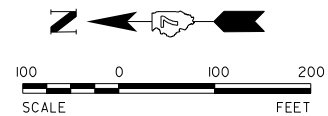

PRINTED DATE: \$DATE\$
FILE NAME: \$FILEL\$



USER NAME = \$USER\$	DESIGNED -	REVISED -
	DRAWN -	REVISED -
PLOT SCALE = \$SCALE\$	CHECKED -	REVISED -
PLOT DATE = \$DATE\$	DATE -	REVISED -

**STATE OF ILLINOIS
DEPARTMENT OF TRANSPORTATION**

IL ROUTE 1

SCALE: 1"=100' SHEET NO 9 OF 12 SHEETS STA 35+00 TO STA 95+00

F.A.P. RTE	SECTION	COUNTY	TOTAL SHEETS	SHEET NO
332	(21XNRH, 21NRH 22, 23IRS-3	CLARK & CRAWFORD	33	21
CONTRACT NO 74A06				
ILLINOIS FEDERAL AID PROJECT				

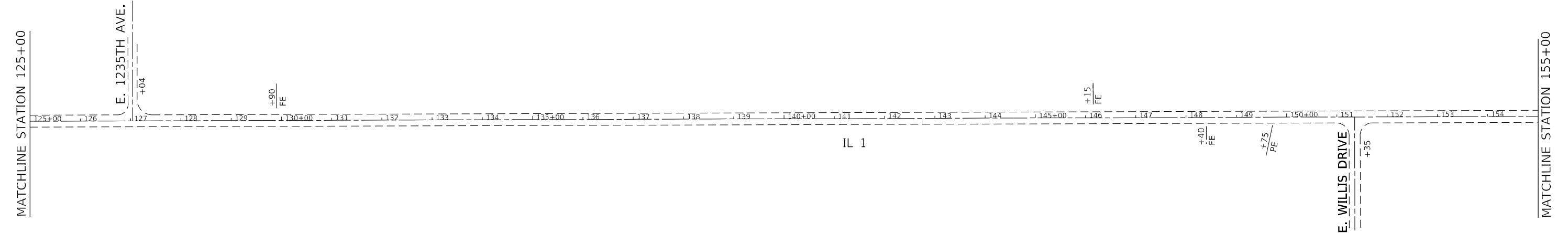
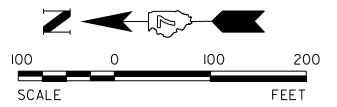
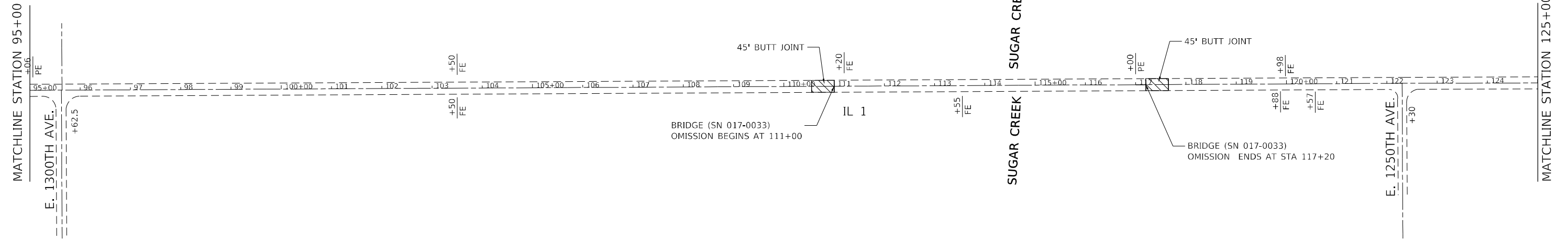
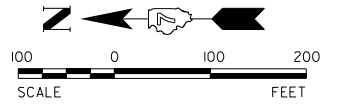

PRINTED DATE: \$DATE\$
FILE NAME: \$FILEL\$



USER NAME = \$USER\$	DESIGNED -	REVISED -
PLOT SCALE = \$SCALE\$	DRAWN -	REVISED -
PLOT DATE = \$DATE\$	CHECKED -	REVISED -
	DATE -	REVISED -

**STATE OF ILLINOIS
DEPARTMENT OF TRANSPORTATION**

IL ROUTE 1

SCALE: 1"=100' SHEET NO 10 OF 12 SHEETS STA 95+00 TO STA 155+00

F.A.P. RTE	SECTION	COUNTY	TOTAL SHEETS	SHEET NO
332	(21XNRH, 21NRH 22, 23JRS-3	CLARK & CRAWFORD	33	22
CONTRACT NO 74A06			ILLINOIS FEDERAL AID PROJECT	

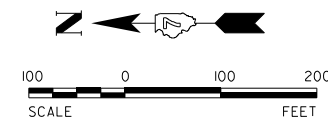

MATCHLINE STATION 155+00

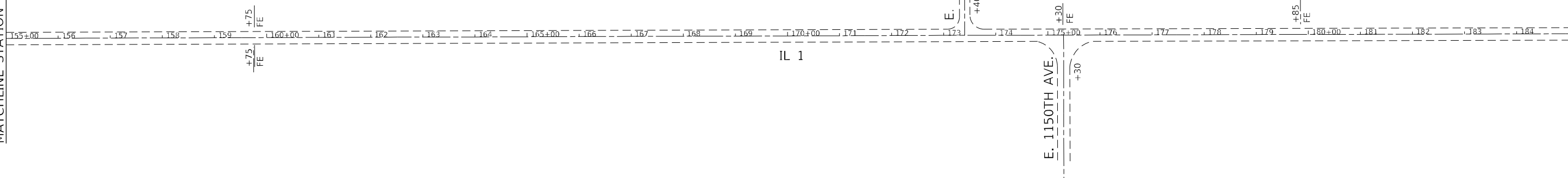

MATCHLINE STATION 185+00

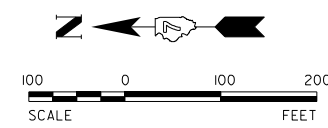

MATCHLINE STATION 185+00

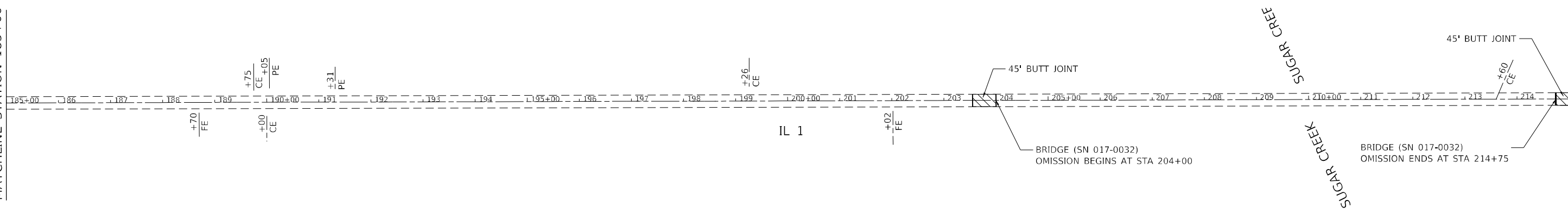

MATCHLINE STATION 215+00

PRINTED DATE: \$DATE\$
FILE NAME: \$FILEL\$



USER NAME = \$USER\$	DESIGNED -	REVISED -
	DRAWN -	REVISED -
PLOT SCALE = \$SCALE\$	CHECKED -	REVISED -
PLOT DATE = \$DATE\$	DATE -	REVISED -

**STATE OF ILLINOIS
DEPARTMENT OF TRANSPORTATION**

IL ROUTE 1
SCALE: 1"=100' SHEET NO 11 OF 12 SHEETS STA 155+00 TO STA 215+00

F.A.P. RTE	SECTION	COUNTY	TOTAL SHEETS	SHEET NO
332	(21XNRH, 21NRH 22, 23)RS-3	CLARK & CRAWFORD	33	23
			CONTRACT NO 74A06	
ILLINOIS FEDERAL AID PROJECT				

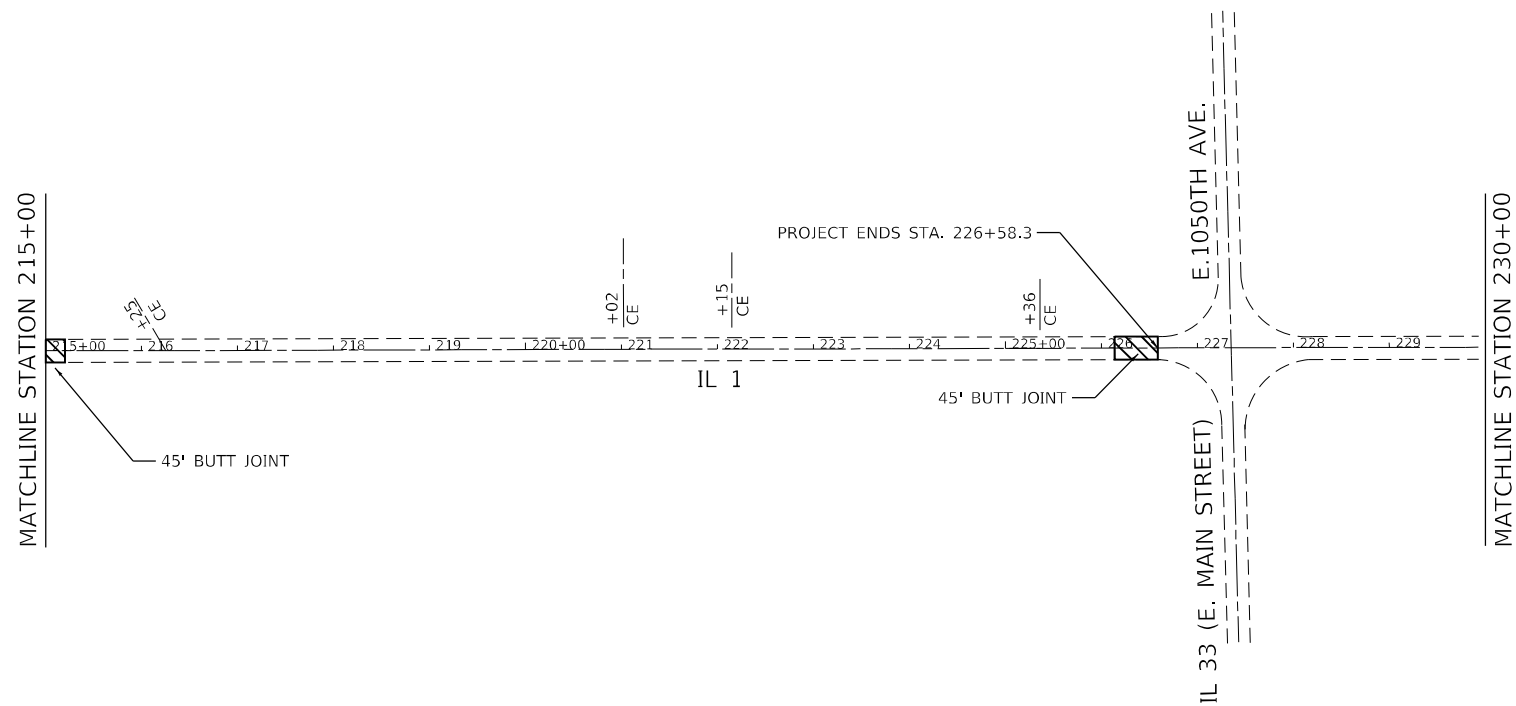
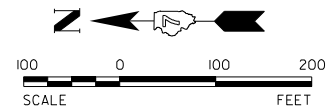

PRINTED DATE: \$DATE\$
FILE NAME: \$FILEL\$



USER NAME = \$USER\$	DESIGNED -	REVISED -
	DRAWN -	REVISED -
PLOT SCALE = \$SCALE\$	CHECKED -	REVISED -
PLOT DATE = \$DATE\$	DATE -	REVISED -

**STATE OF ILLINOIS
DEPARTMENT OF TRANSPORTATION**

IL ROUTE 1

SCALE: 1"=100' SHEET NO 12 OF 12 SHEETS STA 215+00 TO STA 230+00

F.A.P. RTE	SECTION	COUNTY	TOTAL SHEETS	SHEET NO
332	(21XNRH, 21NRH 22, 23)RS-3	CLARK & CRAWFORD	33	24
CONTRACT NO 74A06				
ILLINOIS FEDERAL AID PROJECT				

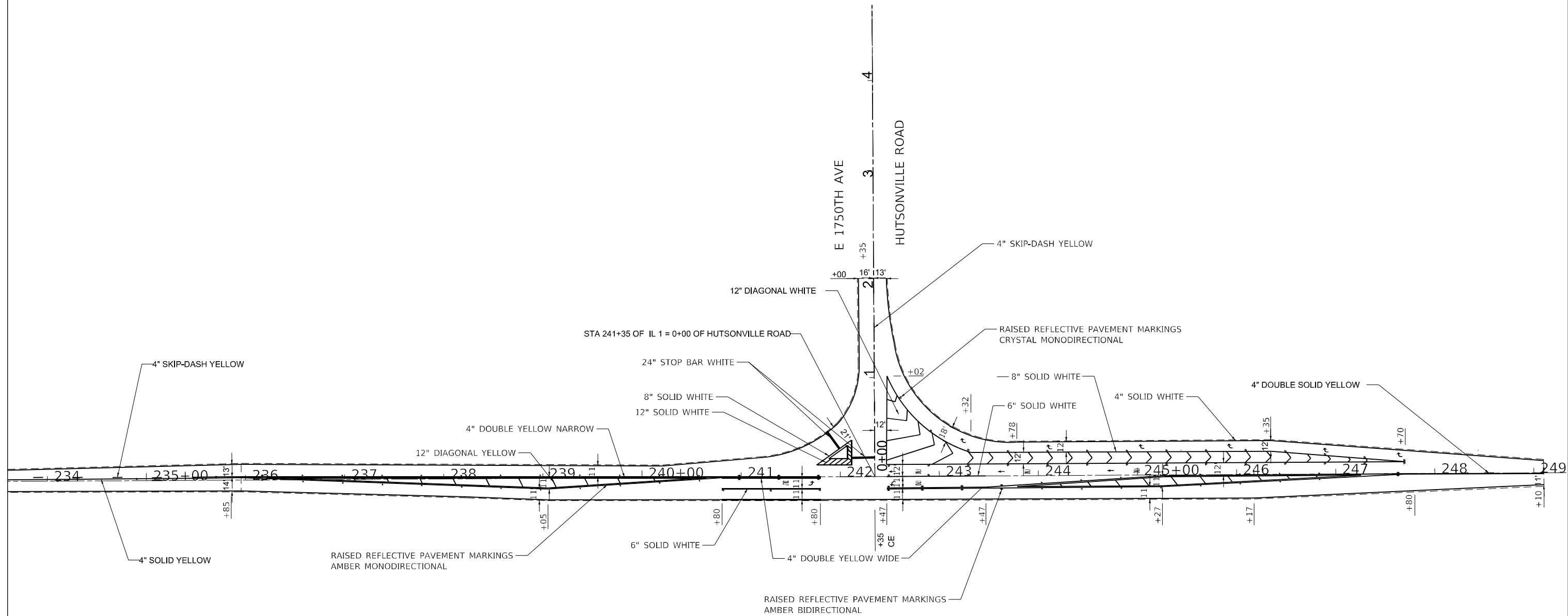
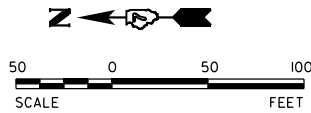

NOTE:
500' OF NO PASS ZONE ON NORTH AND SOUTH ENDS OF HUTSONVILLE INTERSECTION

PRINTED DATE: \$DATE\$
FILE NAME: \$FILE\$



USER NAME = \$USER\$	DESIGNED -	REVISED -
PLOT SCALE = \$SCALE\$	DRAWN -	REVISED -
PLOT DATE = \$DATE\$	CHECKED -	REVISED -
	DATE -	REVISED -

**STATE OF ILLINOIS
DEPARTMENT OF TRANSPORTATION**

**PAVEMENT MARKING DETAIL
HUTSONVILLE ROAD**

SCALE: 1"=50' SHEET NO 1 OF 1 SHEETS STA 233+00 TO STA 249+10

F.A.P. RTE	SECTION	COUNTY	TOTAL SHEETS	SHEET NO
332	(21XNRH, 21NRH 22, 23RS-3	CLARK & CRAWFORD	33	25
CONTRACT NO 74A06			ILLINOIS FEDERAL AID PROJECT	

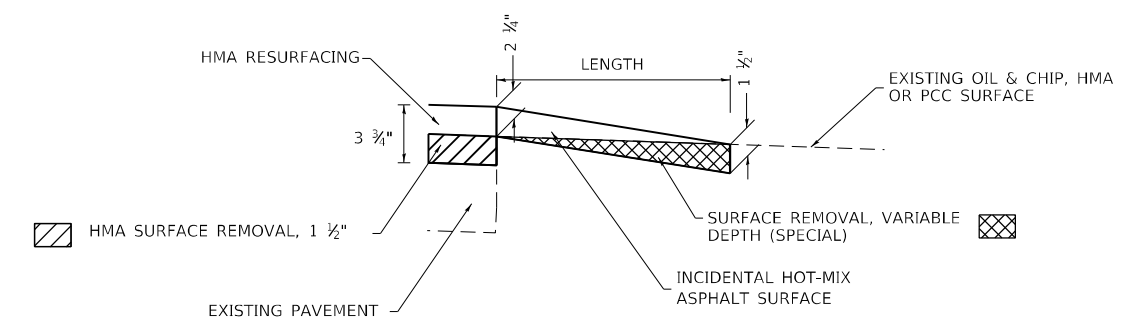
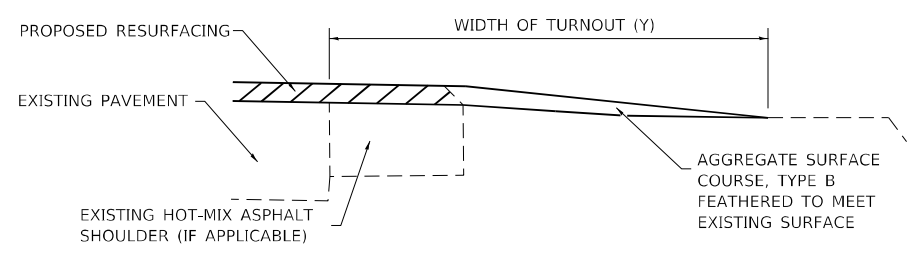
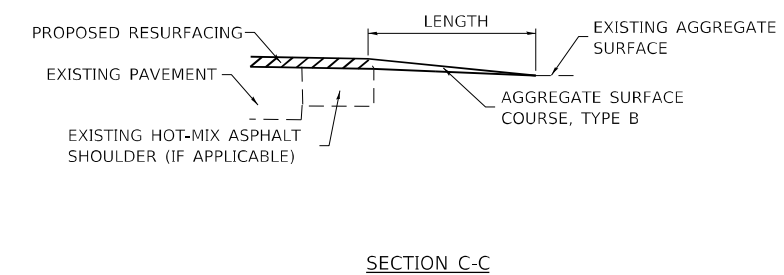
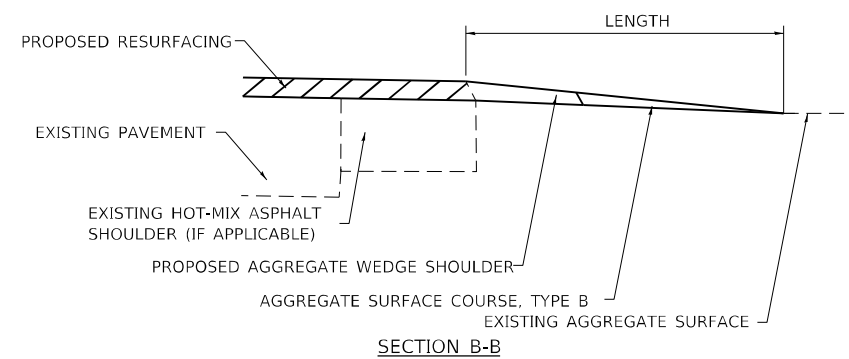
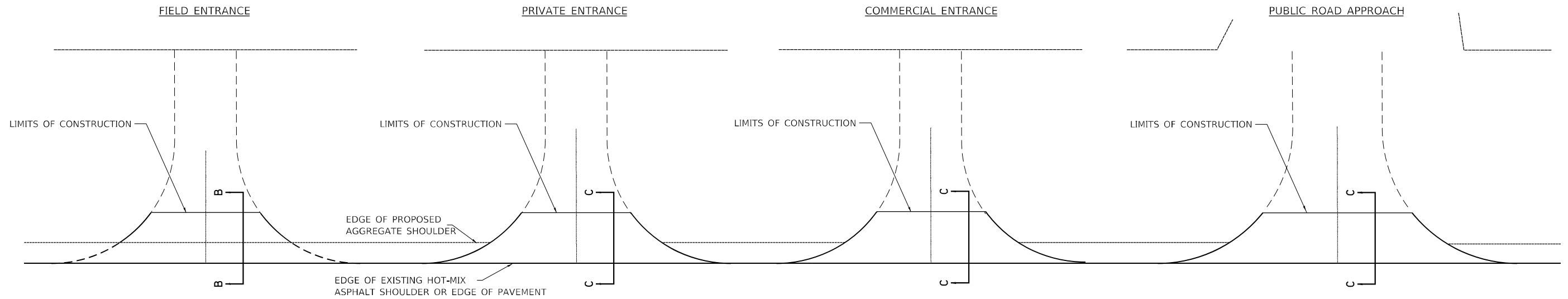

TYPICAL SECTION AT MAILBOX TURNOUT
NOTE: SEE STANDARD 406201 FOR MAILBOX TURNOUT DETAILS

NOTES

LENGTH = 10' UNLESS OTHERWISE NOTED ON PLANS
IF THERE IS NOT EXISTING HOT-MIX ASPHALT SHOULDER THEN THE ENTRANCE TAPER STARTS AT THE EDGE OF EXISTING PAVEMENT.

PRINTED DATE: \$DATE\$
FILE NAME: \$FILE\$



USER NAME = \$USER\$	DESIGNED -	REVISED -
	DRAWN -	REVISED -
PLOT SCALE = \$SCALE\$	CHECKED -	REVISED -
PLOT DATE = \$DATE\$	DATE -	REVISED -

**STATE OF ILLINOIS
DEPARTMENT OF TRANSPORTATION**

RURAL ENTRANCE AND MAILBOX TURNOUT DETAIL

SCALE: N/A SHEET NO 1 OF 8 SHEETS

F.A.P. RTE	SECTION	COUNTY	TOTAL SHEETS	SHEET NO
332	(21XNRH, 21NRH 22, 23JRS-3	CLARK & CRAWFORD	33	26
			CONTRACT NO 74A06	
ILLINOIS FEDERAL AID PROJECT				

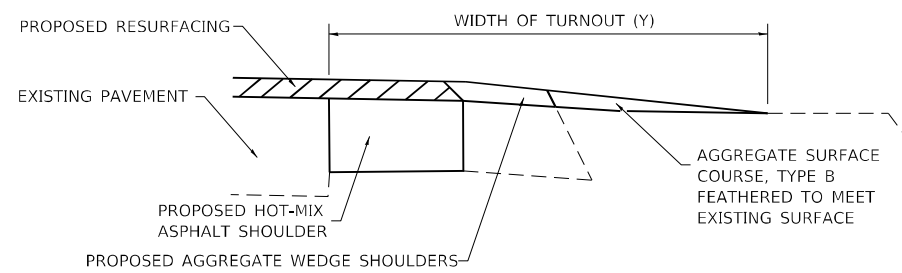
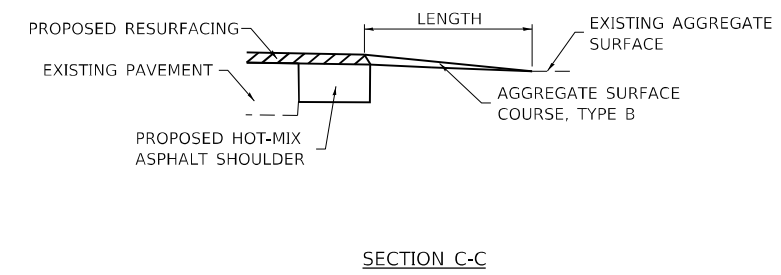
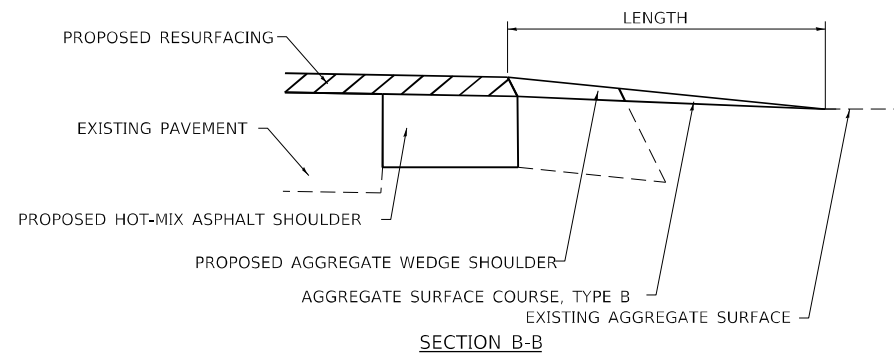
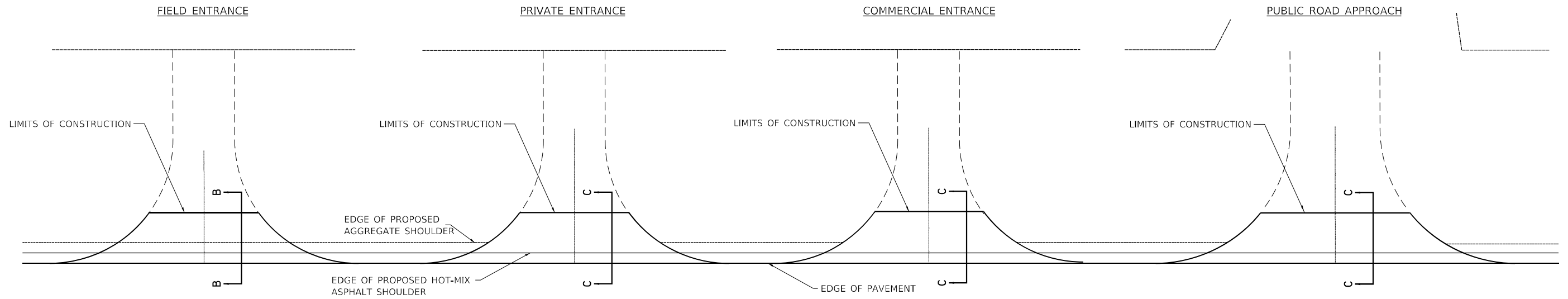

TYPICAL SECTION AT MAILBOX TURNOUT
NOTE: SEE STANDARD 406201 FOR MAILBOX TURNOUT DETAILS

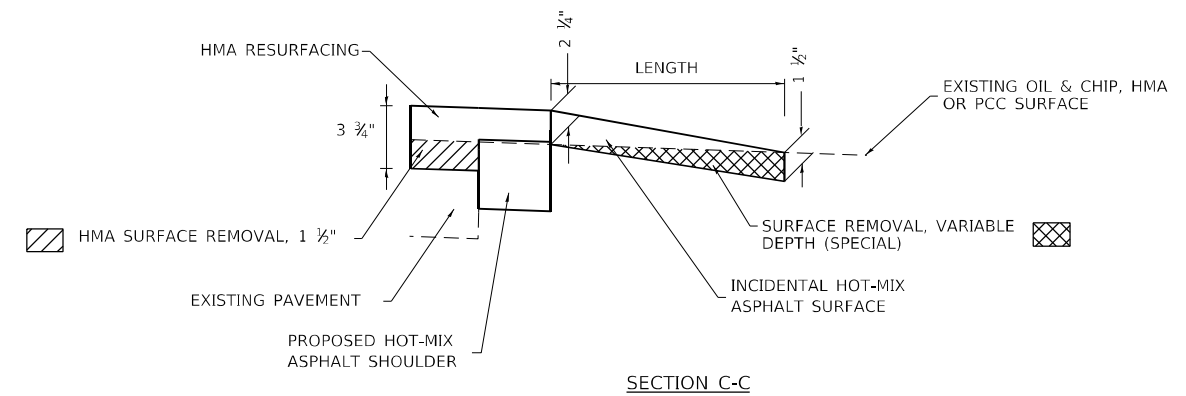

NOTES

LENGTH = 10' UNLESS OTHERWISE NOTED ON PLANS

THE THICKNESS OF THE HOT-MIX ASPHALT SHOULDERS THROUGH AGGREGATE COMMERCIAL ENTRANCES AND PUBLIC ROADS SHALL BE 10". THE COST OF THE EXTRA THICKNESS SHALL BE INCLUDED WITH THE HOT-MIX ASPHALT SHOULDERS PAY ITEM.

PRINTED DATE: \$DATE\$
FILE NAME: \$FILEL\$



USER NAME = \$USER\$	DESIGNED -	REVISED -
	DRAWN -	REVISED -
PLOT SCALE = \$SCALE\$	CHECKED -	REVISED -
PLOT DATE = \$DATE\$	DATE -	REVISED -

STATE OF ILLINOIS
DEPARTMENT OF TRANSPORTATION

RURAL ENTRANCE AND MAILBOX TURNOUT DETAIL
(PROPOSED)

SCALE: N/A SHEET NO 2 OF 8 SHEETS

F.A.P. RTE	SECTION	COUNTY	TOTAL SHEETS	SHEET NO
332	(21XNRH, 21NRH 22, 23IRS-3	CLARK & CRAWFORD	33	27
CONTRACT NO 74A06				
ILLINOIS FEDERAL AID PROJECT				

BUTT JOINT DETAIL

STATION	TO	STATION
824+50		824+95
33+37		33+82
35+70		36+15
302+21.5		302+64.5
304+54.5		304+99.5
110+55		111+00
117+20		117+65
203+55		204+00
214+75		215+20
226+13.3		226+58.3

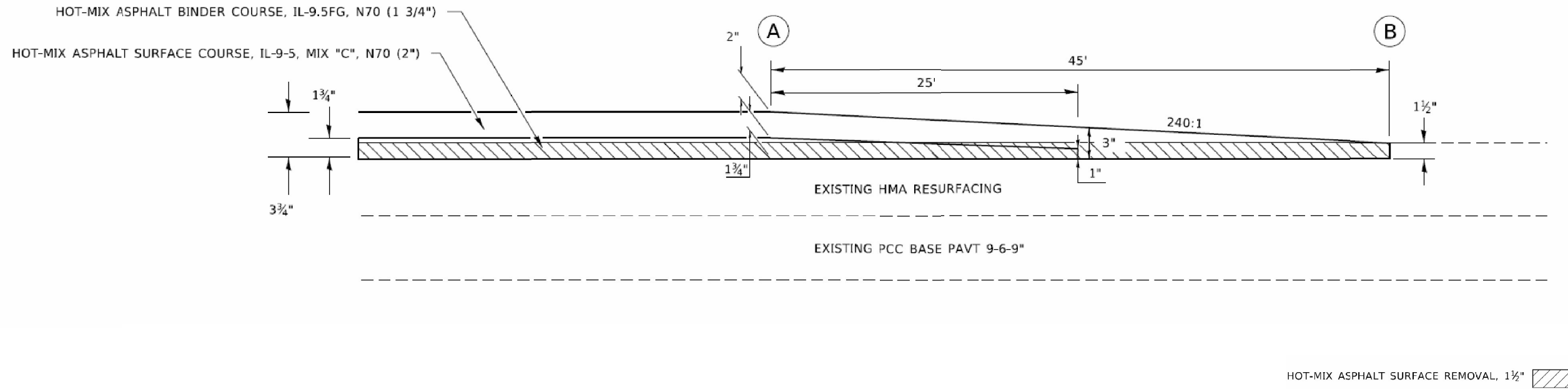

PRINTED DATE: \$DATE\$
FILE NAME: \$FILEL\$



USER NAME = \$USER\$	DESIGNED -	REVISED -
	DRAWN -	REVISED -
PLOT SCALE = \$SCALE\$	CHECKED -	REVISED -
PLOT DATE = \$DATE\$	DATE -	REVISED -

STATE OF ILLINOIS
DEPARTMENT OF TRANSPORTATION

BUTT JOINT DETAIL

SCALE: N/A SHEET NO 3 OF 8 SHEETS

F.A.P. RTE	SECTION	COUNTY	TOTAL SHEETS	SHEET NO
332	(21XNRH, 21NRH 22, 23)RS-3	CLARK & CRAWFORD	33	28
CONTRACT NO 74A06			ILLINOIS FEDERAL AID PROJECT	

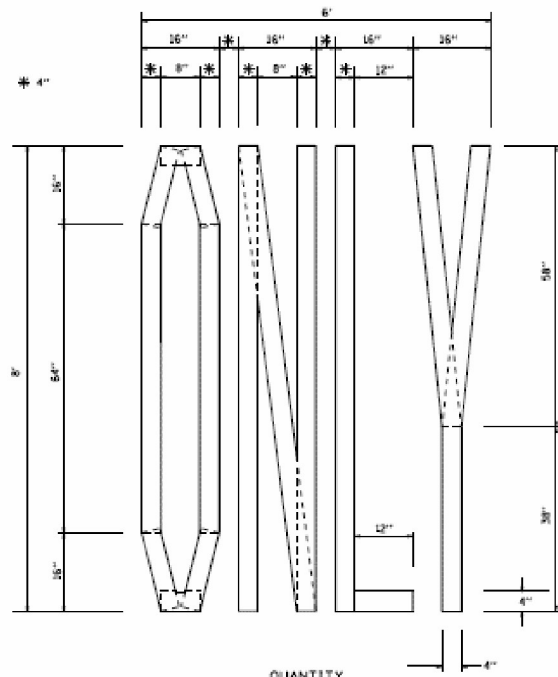

QUANTITY
4" LINE = 63.2 ft.
21.0 sq. ft.

SHORT TERM STOP BAR

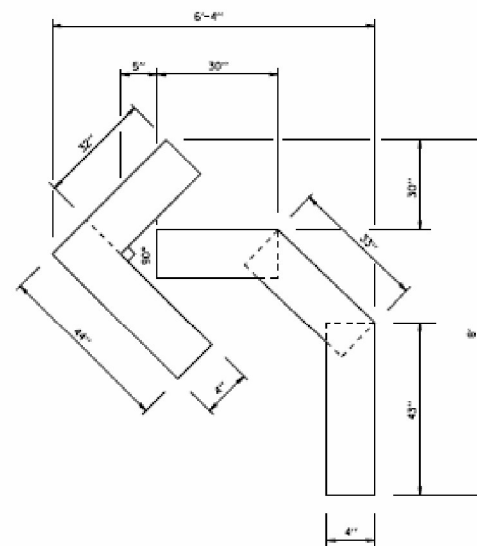

QUANTITY
4" LINE = 15.2 ft.
5.0 sq. ft.

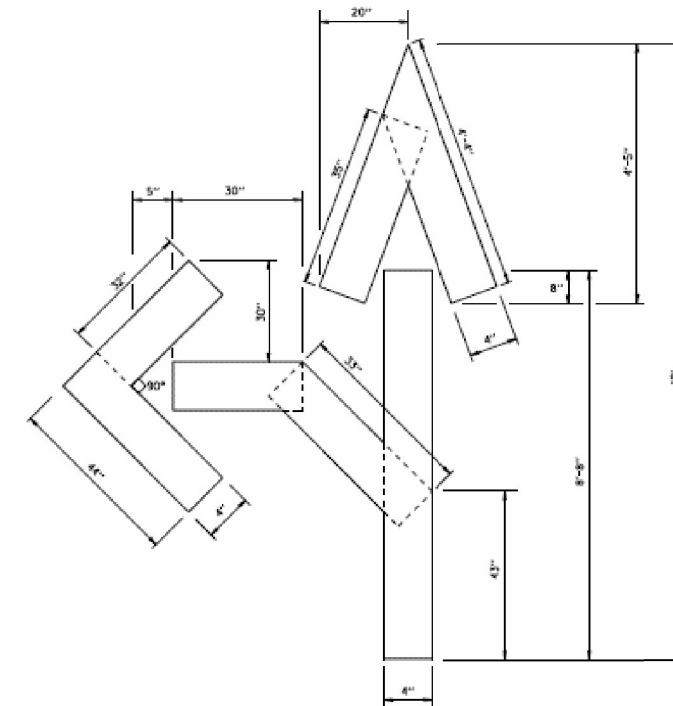

QUANTITY
4" LINE = 27.5 ft.
9.2 sq. ft.

USER NAME = \$USER\$	DESIGNED -	REVISED -
	DRAWN -	REVISED -
PLOT SCALE = \$SCALE\$	CHECKED -	REVISED -
PLOT DATE = \$DATE\$	DATE -	REVISED -

F.A.P. RTE	SECTION	COUNTY	TOTAL SHEETS	SHEET NO
332	(21XNRH, 21NRH 22, 23)RS-3	CLARK & CRAWFORD	33	29
CONTRACT NO 74A06				
ILLINOIS FEDERAL AID PROJECT				

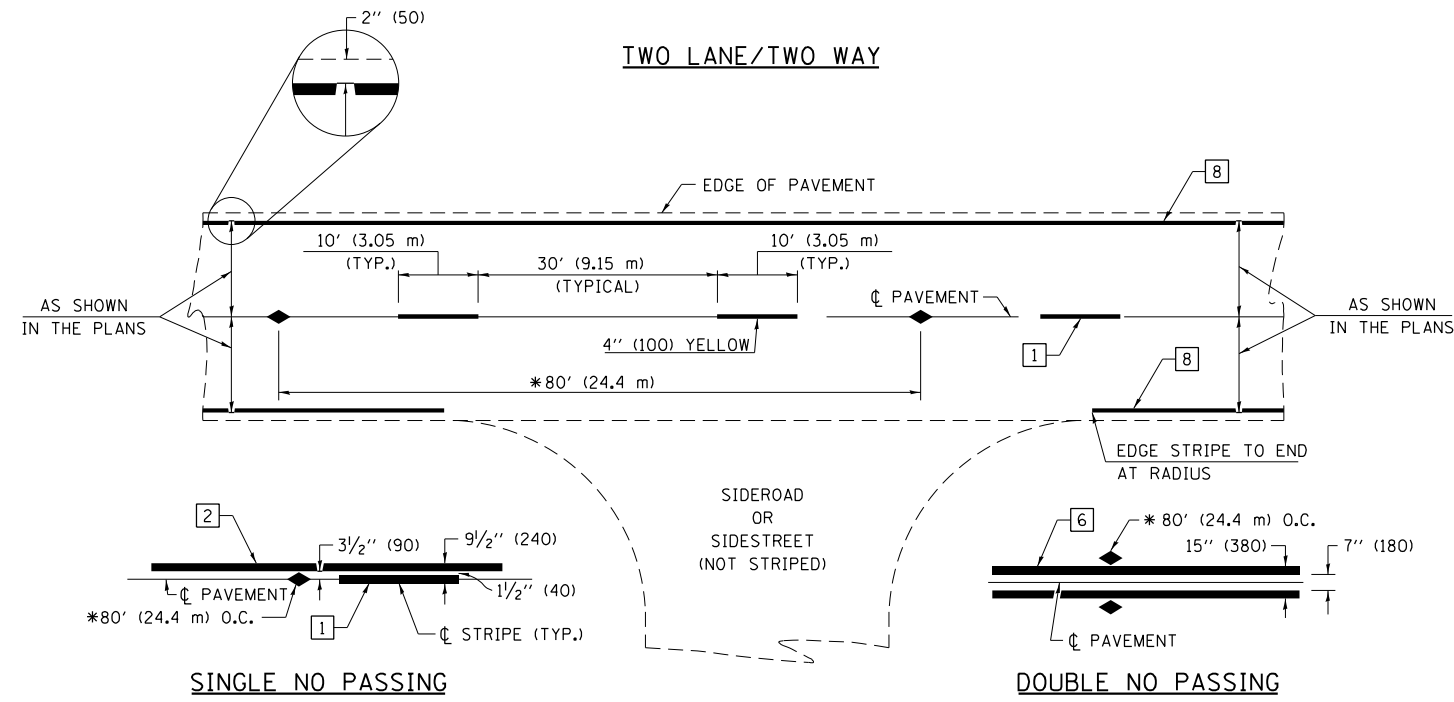

PAVEMENT MARKING LEGEND

- 1 4" (100) SKIP-DASH (YELLOW)
- 2 4" (100) SOLID (YELLOW)
- 3 12" (300) DIAGONAL (YELLOW)
- 4 4" (100) DOUBLE YELLOW (NARROW)
- 5 12" (300) SOLID WHITE
- 6 4" (100) DOUBLE YELLOW (WIDE)
- 7 6" (150) SKIP-DASH (WHITE)
- 8 4" (100) SOLID (WHITE)
- 9 12" (300) DIAGONAL (WHITE)
- 10 6" (150) SOLID (WHITE)
- 11 24" (600) STOP BAR (WHITE)
- 12 8" (200) SOLID (WHITE)
- 13 4" (100) PARKING WHITE

* REDUCE TO 40' (12.2 m) O.C. ON CURVES WITH POSTED OR ADVISORY SPEEDS OF 45 mph (70 km/h) OR LESS.

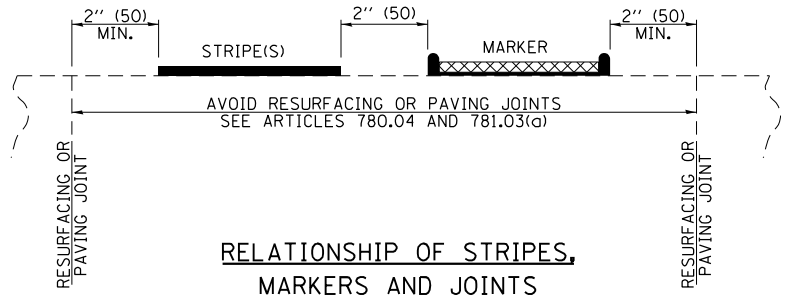

TYPICAL PAVEMENT MARKERS LEGEND

- ◆ TWO-WAY AMBER MARKER
- ▶ ONE-WAY AMBER MARKER
- ▷ ONE-WAY CRYSTAL MARKER

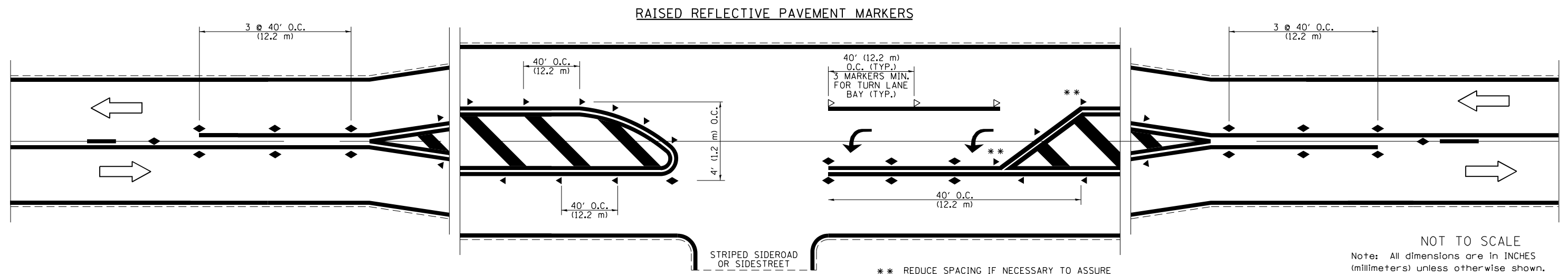

NOT TO SCALE
Note: All dimensions are in INCHES (millimeters) unless otherwise shown.

DISTRICT 7 DETAIL NO. 78000001

PRINTED DATE: \$DATE\$
FILE NAME: \$FILEL\$



USER NAME = \$USER\$	DESIGNED -	REVISED -
PLOT SCALE = \$SCALE\$	DRAWN -	REVISED -
PLOT DATE = \$DATE\$	CHECKED -	REVISED -
	DATE -	REVISED -

**STATE OF ILLINOIS
DEPARTMENT OF TRANSPORTATION**

**PAVEMENT MARKING AND RAISED PAVEMENT MARKERS
(RURAL AND URBAN APPLICATIONS)**

SCALE: N/A SHEET NO 5 OF 8 SHEETS

F.A.P. RTE.	SECTION	COUNTY	TOTAL SHEETS	SHEET NO.
332	(21XNRH, 21NRH 22, 23JRS-3	CLARK & CRAWFORD	33	30
CONTRACT NO 74A06				
ILLINOIS FEDERAL AID PROJECT				

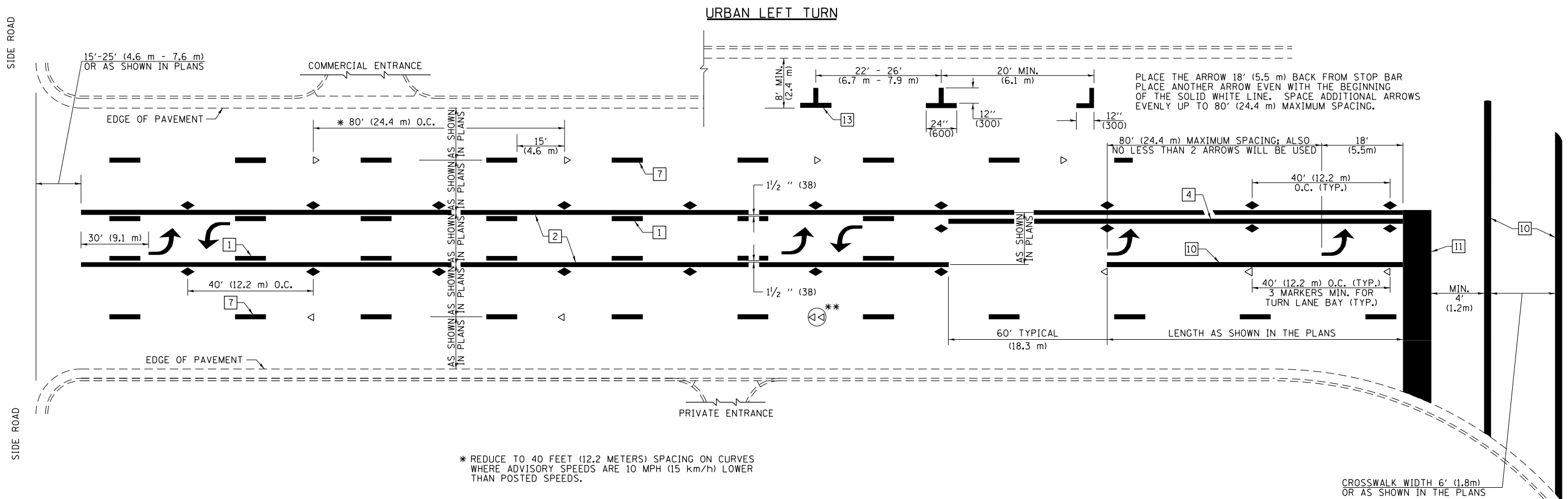

PLACE THE ARROW 18' (5.5 m) BACK FROM STOP BAR
 PLACE ANOTHER ARROW EVEN WITH THE BEGINNING
 OF THE SOLID WHITE LINE. SPACE ADDITIONAL ARROWS
 EVENLY UP TO 80' (24.4 m) MAXIMUM SPACING.

* REDUCE TO 40 FEET (12.2 METERS) SPACING ON CURVES
 WHERE ADVISORY SPEEDS ARE 10 MPH (15 km/h) LOWER
 THAN POSTED SPEEDS.

** DOUBLE LANE LINE MARKERS SHALL BE SPECIFIED
 AND SPACED AS SHOWN IN HIGHWAY STANDARD
 781001 FOR MULTI-LANE DIVIDED AND UNDIVIDED
 HIGHWAYS.

PAVEMENT MARKING LEGEND

- 1 4" (100) SKIP-DASH (YELLOW)
- 2 4" (100) SOLID (YELLOW)
- 3 12" (300) DIAGONAL (YELLOW)
- 4 4" (100) DOUBLE YELLOW (NARROW)
- 5 12" (300) SOLID WHITE
- 6 4" (100) DOUBLE YELLOW (WIDE)
- 7 6" (150) SKIP-DASH (WHITE)
- 8 4" (100) SOLID (WHITE)
- 9 12" (300) DIAGONAL (WHITE)
- 10 6" (150) SOLID (WHITE)
- 11 24" (600) STOP BAR (WHITE)
- 12 8" (200) SOLID (WHITE)
- 13 4" (100) PARKING WHITE

GENERAL NOTES

1. TURN ARROW PAIRS SHALL BE PLACED AT 250' (75 m) INTERVALS AND SHALL BE EVENLY SPACED BETWEEN BOTH ENDS OF THE BIDIRECTIONAL LEFT TURN LANE. USE A MINIMUM OF TWO PAIRS PER BLOCK.
2. THE SOLID YELLOW PAVEMENT MARKINGS [2] SHOULD GENERALLY START OR END NEAR THE RADIUS POINT OF EACH STREET RETURN EXCEPT WHERE ONE OR BOTH ENDS WOULD INCLUDE STOP BARS.
3. THE SKIP-DASH PAVEMENT MARKINGS [1] OR [7] SHOULD BE CENTERED BETWEEN BOTH ENDS OF EACH CITY BLOCK AND SHALL BE PLACED SO THEY LINE UP ACROSS FROM EACH OTHER.
4. USE LARGE ARROW SIZE FOR BOTH RURAL AND URBAN LOCATIONS. (SEE SECTION 780 FOR SYMBOLS TABLE)
5. LANE LINE EXTENSIONS SHALL BE THE SAME COLOR AND WIDTH AS THE LANE LINE BEING EXTENDED.
6. ALL WHITE SKIP-DASH LINES SHALL BE 6" IN WIDTH.

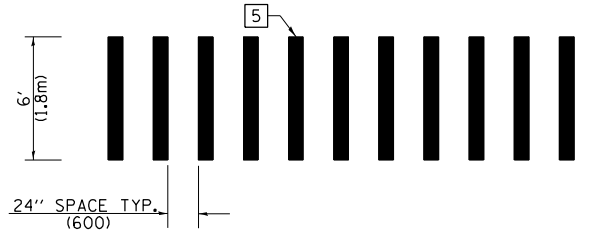

**CROSSWALK DETAIL
 (DECATUR CITY LIMITS ONLY)**

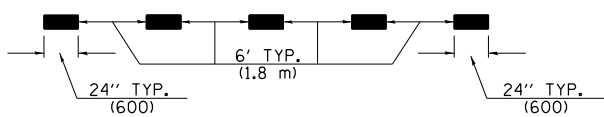

LANE LINE EXTENSIONS

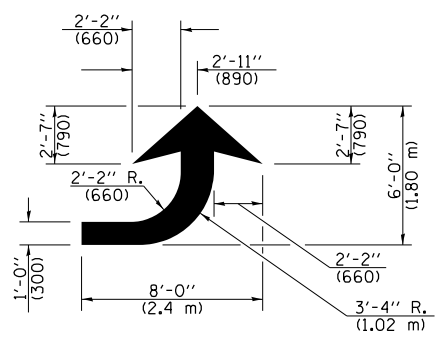

LEFT ARROW

REVERSE FOR RIGHT ARROW
 AREA = 15.6 SQ. FT. (1.47 m²)
 (WHITE)

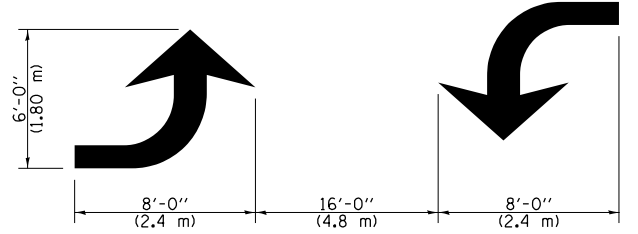

**TYPICAL DOUBLE
 TURN ARROWS (WHITE)**

NOT TO SCALE

Note: All dimensions are in INCHES
 (millimeters) unless otherwise shown.

DISTRICT 7 DETAIL NO. 7800001

F.A.P. RTE	SECTION	COUNTY	TOTAL SHEETS	SHEET NO.
332	(21XNRH, 21NRH 22, 23IRS-3)	CLARK & CRAWFORD	33	31
CONTRACT NO 74A06			ILLINOIS FEDERAL AID PROJECT	

PRINTED DATE: \$DATE\$
 FILE NAME: \$FILEL\$



USER NAME = \$USER\$	DESIGNED -	REVISED -
PLOT SCALE = \$SCALE\$	DRAWN -	REVISED -
PLOT DATE = \$DATE\$	CHECKED -	REVISED -
	DATE -	REVISED -

**STATE OF ILLINOIS
 DEPARTMENT OF TRANSPORTATION**

**PAVEMENT MARKING AND RAISED PAVEMENT MARKERS
 (RURAL AND URBAN APPLICATIONS)**

SCALE: N/A SHEET NO 6 OF 8 SHEETS

ISLANDS

OPTION 1

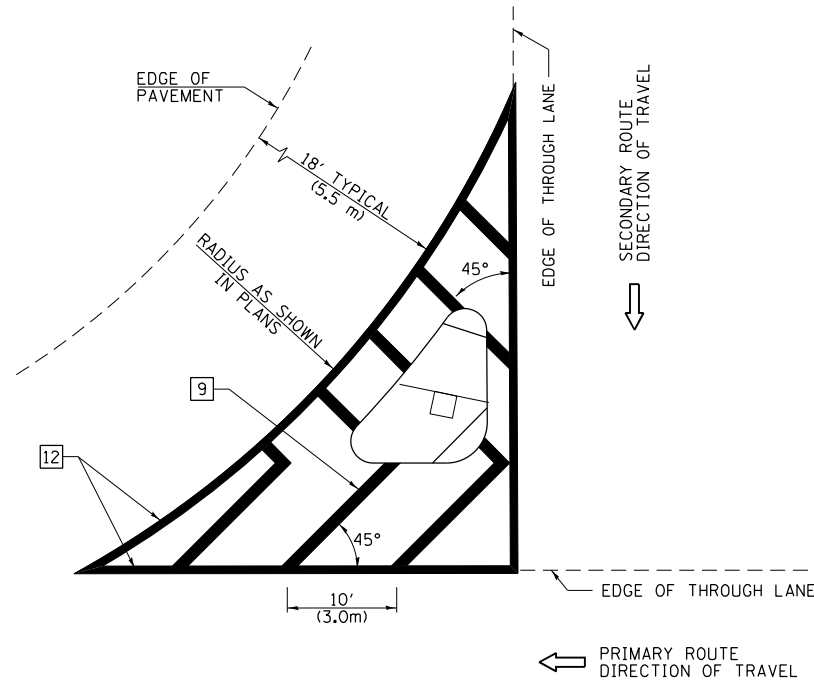

GENERAL NOTES

1. RAISED AND CORRUGATED MEDIANS SHALL BE OUTLINED WITH [2].
2. SOME OF THE INFORMATION INCLUDED WITH THIS DETAIL MAY NOT BE APPLICABLE TO THIS IMPROVEMENT.
3. PAVEMENT MARKINGS ARE TO BE EXTENDED THROUGH OMISSIONS WHEN APPLICABLE.
4. FINAL PAVEMENT MARKINGS SHALL BE IN PLACE PRIOR TO PLACING ANY RAISED REFLECTIVE PAVEMENT MARKERS.
5. THE FOLLOWING CRITERIA SHALL BE USED FOR SELECTING THE DIAGONAL PAVEMENT MARKING SPACING:

< 30 MPH (< 50 km/h)	15' (4.5 m)
30-45 MPH (50-75 km/h)	20' (6.0 m)
> 45 MPH (> 75 km/h)	30' (9.0 m)
6. THE USE OF ISLAND STRIPING OPTION 1 OR OPTION 2 SHALL BE AS SHOWN ON THE PLANS.

OPTION 2

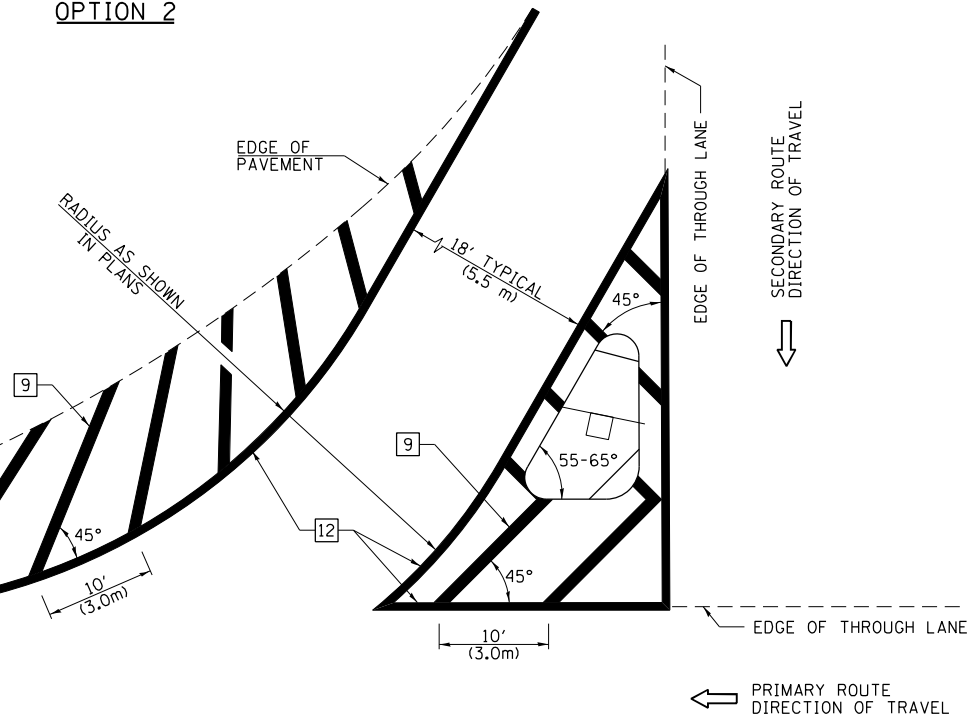

PAVEMENT MARKING LEGEND

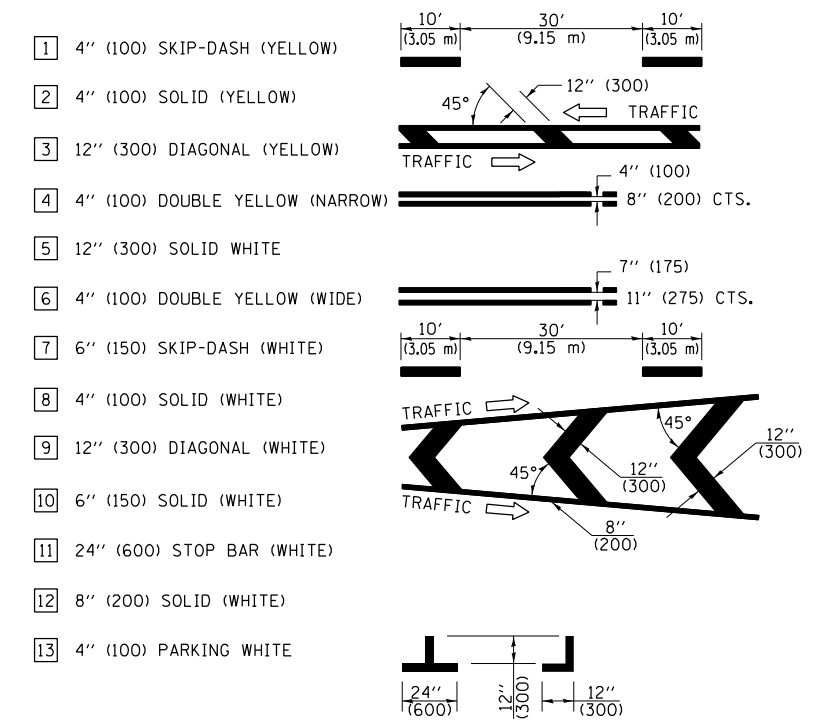

RURAL LEFT TURN STRIPING

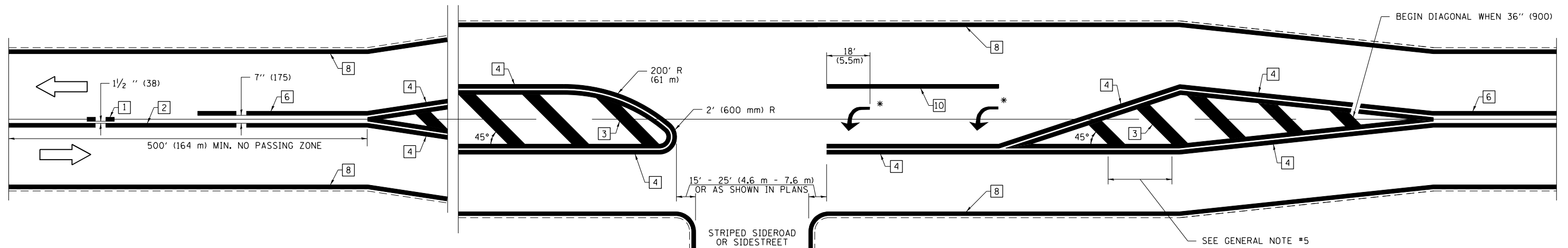

* PLACE AN ARROW 18' (5.5 m) BACK FROM END OF THE SOLID WHITE LINE. PLACE ANOTHER ARROW EVEN WITH THE BEGINNING OF THE SOLID WHITE LINE. SPACE ADDITIONAL ARROWS EVENLY UP TO 80' (24.4 m) MAXIMUM SPACING. USE MINIMUM OF 2 ARROWS.

NOT TO SCALE

Note: All dimensions are in INCHES (millimeters) unless otherwise shown.

DISTRICT 7 DETAIL NO. 7800001



USER NAME = #USER#	DESIGNED -	REVISED -
PLOT SCALE = #SCALE#	DRAWN -	REVISED -
PLOT DATE = #DATE#	CHECKED -	REVISED -
	DATE -	REVISED -

**STATE OF ILLINOIS
DEPARTMENT OF TRANSPORTATION**

**PAVEMENT MARKING AND RAISED PAVEMENT MARKERS
(RURAL AND URBAN APPLICATIONS)**

SCALE: N/A SHEET NO 7 OF 8 SHEETS

F.A.P. RTE	SECTION	COUNTY	TOTAL SHEETS	SHEET NO
332	(21XNRH, 21NRH 22, 23IRS-3	CLARK & CRAWFORD	33	32
CONTRACT NO 74A06				
ILLINOIS FEDERAL AID PROJECT				

PRINTED DATE: #DATE#
FILE NAME: #FILE#

SUPPLEMENTAL PAVEMENT MARKING TREATMENT FOR RAILROAD-HIGHWAY GRADE CROSSING

PAVEMENT MARKING LEGEND

- 1 4" (100) SKIP-DASH (YELLOW)
 - 2 4" (100) SOLID (YELLOW)
 - 3 12" (300) DIAGONAL (YELLOW)
 - 4 4" (100) DOUBLE YELLOW (NARROW)
 - 5 12" (300) SOLID WHITE
 - 6 4" (100) DOUBLE YELLOW (WIDE)
 - 7 6" (150) SKIP-DASH (WHITE)
 - 8 4" (100) SOLID (WHITE)
 - 9 12" (300) DIAGONAL (WHITE)
 - 10 6" (150) SOLID (WHITE)
 - 11 24" (600) STOP BAR (WHITE)
 - 12 8" (200) SOLID (WHITE)
 - 13 4" (100) PARKING WHITE
-

PAVEMENT MARKINGS AT RAILROAD-HIGHWAY GRADE CROSSING

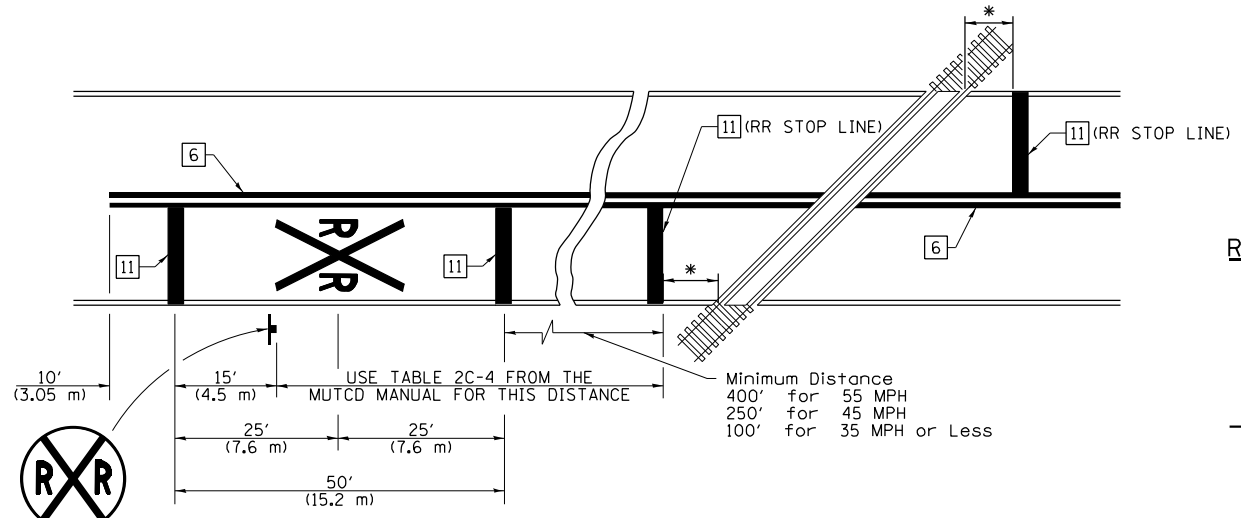

RAILROAD CROSSING WITH NON-SIGNALIZED INTERSECTION

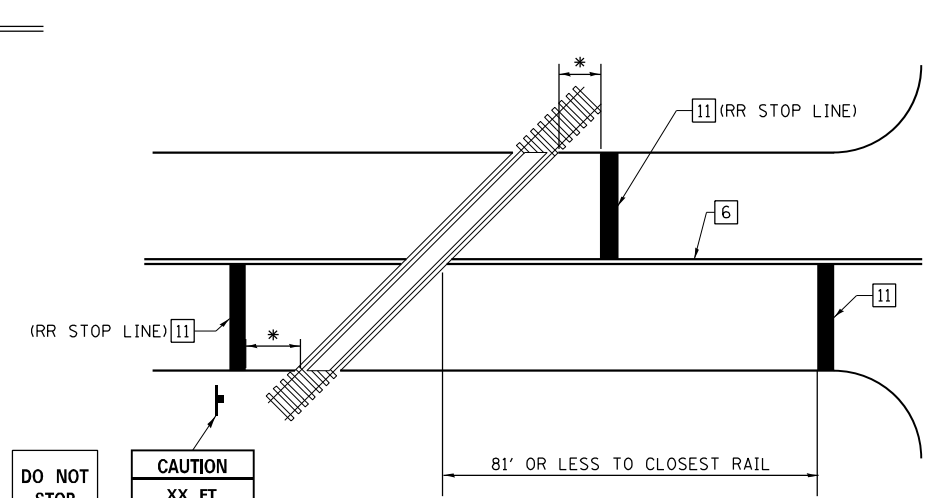

NOTES

THE TRAVERSE SPREAD OF THE "X" MAY VARY ACCORDING TO LANE WIDTH.

ON MULTI-LANE ROADS, THE STOP LINES SHALL EXTEND ACROSS ALL APPROACH LANES AND SEPARATE RRR SYMBOLS SHALL BE PLACED ADJACENT TO EACH OTHER IN EACH LANE.

WHEN THE PAVEMENT MARKING SYMBOL IS USED, A PORTION OF THE SYMBOL SHOULD BE LOCATED DIRECTLY ADJACENT TO THE ADVANCE WARNING SIGN (W10-1) AS PLACED BY TABLE II-1, CONDITION B OF THE MUTCD.

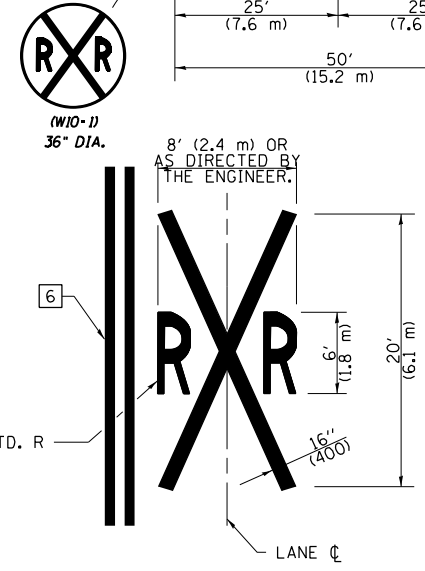

RAILROAD CROSSING WITH INTERCONNECT ONLY

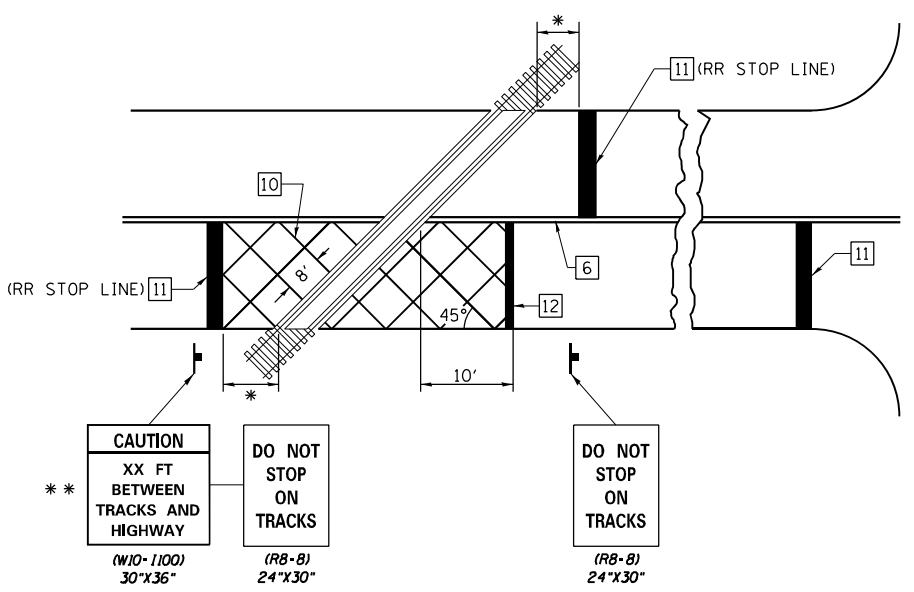

RAILROAD CROSSING WITH INTERCONNECT AND PRE-SIGNALS

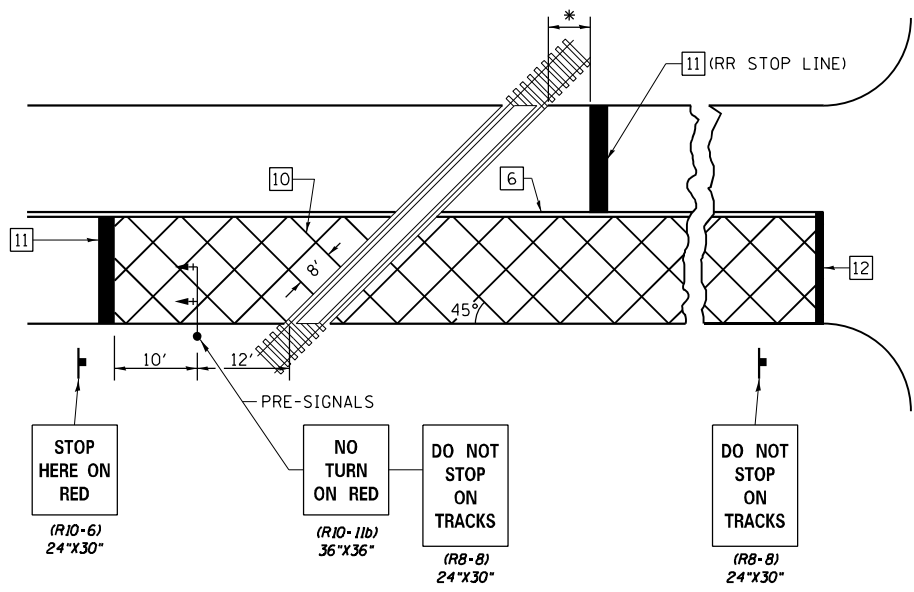

- ### GENERAL NOTES
- SUPPLEMENTAL PAVEMENT MARKINGS TO BE INSTALLED ONLY ON APPROACHES TO INTERSECTIONS CONTROLLED BY TRAFFIC SIGNALS WHICH ARE INTERCONNECTED WITH THE RAILROAD WARNING SIGNALS.
 - EXTEND PAVEMENT MARKINGS TO THE INTERSECTION ONLY WHERE PRE-SIGNALS ARE USED.
 - WHEN PEDESTRIAN SIGNALS ARE PRESENT WITH INTERCONNECTED SIGNALS, WARNING SIGN W10-1101 (18"X24") SHALL BE PLACED NEAR EACH PEDESTRIAN SIGNAL HEAD. COUNTDOWN PEDESTRIAN SIGNAL HEADS SHALL NOT BE UTILIZED ALONG WITH INTERCONNECTED SIGNALS.
 - PLEASE REFER TO THE IDOT BUREAU OF OPERATION MEMO OPS T-06 DATED DECEMBER 1, 2020 FOR ADDITIONAL INFORMATION.

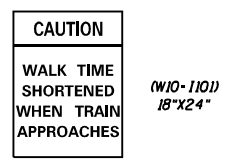

- * 15' FROM NEAR RAIL OR 8' FROM AND PARALLEL TO GATE IF PRESENT
- ** WARNING SIGN W10-1100 SHALL BE USED AS AN INTERIM MEASURE AT INTERCONNECTED SIGNAL LOCATIONS WHERE PRE-SIGNALS ARE TO BE INSTALLED IN THE FUTURE. THIS SIGN SHALL BE REMOVED WHEN THE PRE-SIGNALS ARE INSTALLED AND THE PAVEMENT MARKINGS ARE EXTENDED TO THE INTERSECTION.

NOT TO SCALE
Note: All dimensions are in INCHES (millimeters) unless otherwise shown.

DISTRICT 7 DETAIL NO. 78000001

F.A.P. RTE.	SECTION	COUNTY	TOTAL SHEETS	SHEET NO.
332	(21XNRH, 21NRH 22, 23JRS-3	CLARK & CRAWFORD	33	33
CONTRACT NO 74A06				

PRINTED DATE: \$DATE\$
FILE NAME: \$FILEL\$



USER NAME = \$USER\$	DESIGNED -	REVISED -
PLOT SCALE = \$SCALE\$	DRAWN -	REVISED -
PLOT DATE = \$DATE\$	CHECKED -	REVISED -
	DATE -	REVISED -

STATE OF ILLINOIS
DEPARTMENT OF TRANSPORTATION

PAVEMENT MARKING AND RAISED PAVEMENT MARKERS
(RURAL AND URBAN APPLICATIONS)
SCALE: N/A SHEET NO 8 OF 8 SHEETS

ILLINOIS FEDERAL AID PROJECT