

06-16-2023 LETTING ITEM 176

STATE OF ILLINOIS  
DEPARTMENT OF TRANSPORTATION

PROPOSED  
HIGHWAY PLANS

ROUTE FAP 669 (IL 8 /IL 116)  
D4 MAST ARM REPLACEMENT 2023-1  
PEORIA COUNTY  
PROJECT NO. NHPP-6Z7E(825)  
C-94-039-23

F.A.P. RTE.	SECTION	COUNTY	TOTAL SHEETS	SHEET NO.
669	D4 MAST ARM REPLACEMENT 2023-1	PEORIA	17*	1
		ILLINOIS	CONTRACT NO. 68H56	

\* 17 + 3 = 20 TOTAL SHEETS

D-94-033-23

INDEX OF SHEETS:  
SEE SHEET 2 FOR INDEX OF SHEETS

HIGHWAY STANDARDS:  
SEE SHEET 2 FOR A LIST OF  
APPLICABLE HIGHWAY STANDARDS

PROJECT DESCRIPTION:  
TRAFFIC SIGNAL MAST ARM  
REPLACEMENT AT IL 8/IL 116  
(MACARTHUR HWY.) &  
WASHINGTON ST. IN PEORIA

J.U.L.I.E.  
JOINT UTILITY LOCATION INFORMATION FOR EXCAVATORS  
1-800-892-0123  
OR 811

PROJECT ENGINEER : TREVOR HANSON (309) 671-4474  
PROJECT MANAGER : ERIC HOWALD (309) 671-4481  
CATALOG NO. 036382-00D  
CONTRACT NO. 68H56



IL 8/ IL 116 (MACARTHUR HWY.)  
& SW WASHINGTON ST.



STATE OF ILLINOIS  
DEPARTMENT OF TRANSPORTATION

SUBMITTED December 15 20 22  
Trevor Hanson  
REGIONAL ENGINEER

February 3, 2023  
Eric Howald  
ENGINEER OF DESIGN AND ENVIRONMENT

February 3, 2023  
Stephen McQuinn  
DIRECTOR OF HIGHWAYS PROJECT IMPLEMENTATION

PRINTED BY THE AUTHORITY  
OF THE STATE OF ILLINOIS

NO COMMITMENTS HAVE BEEN MADE IN CONJUNCTION WITH THIS PROJECT.

INDEX OF SHEETS	
SHEET	DESCRIPTION
1	COVER SHEET
2	COMMITMENTS, INDEX OF SHEETS, HIGHWAY STANDARDS, & TRAFFIC SIGNAL CONSTRUCTION STAGING NOTES
3	STATUS OF UTILITIES
4	CONSTRUCTION NOTES
5 - 6	SUMMARY OF QUANTITIES
7	EXISTING TRAFFIC SIGNAL PLANS & REMOVAL ITEMS - IL 8/ IL 116 (MACARTHUR HWY.) & SW WASHINGTON ST. - PEORIA
8	EXISTING CABLE & PHASE DIAGRAMS - IL 8/ IL 116 (MACARTHUR HWY.) & SW WASHINGTON ST. - PEORIA
9	PROPOSED TRAFFIC SIGNAL SCHEDULES - IL 8/ IL 116 (MACARTHUR HWY.) & SW WASHINGTON ST. - PEORIA
10	PROPOSED TRAFFIC SIGNAL IMPROVEMENTS NW QUADRANT IL 8/ IL 116 (MACARTHUR HWY.) & SW WASHINGTON ST. - PEORIA
11	PROPOSED TRAFFIC SIGNAL IMPROVEMENTS NE QUADRANT IL 8/ IL 116 (MACARTHUR HWY.) & SW WASHINGTON ST. - PEORIA
12A	PROPOSED TRAFFIC SIGNAL IMPROVEMENTS SE QUADRANT IL 8/ IL 116 (MACARTHUR HWY.) & SW WASHINGTON ST. - PEORIA
12B	PROPOSED TRAFFIC SIGNAL IMPROVEMENTS SW QUADRANT IL 8/ IL 116 (MACARTHUR HWY.) & SW WASHINGTON ST. - PEORIA
13	PROPOSED CABLE & PHASE DIAGRAMS - IL 8/ IL 116 (MACARTHUR HWY.) & SW WASHINGTON ST. - PEORIA
14	PROPOSED MAST ARM AND TRAFFIC SIGNAL POST DETAILS - IL 8/ IL 116 (MACARTHUR HWY.) & SW WASHINGTON ST. - PEORIA
15	PROPOSED SIGN PANEL TYPE II DETAIL
16	PEDESTRIAN PUSHBUTTON POST DETAIL
17	ELECTRIC SERVICE INSTALLATION, SPECIAL DETAIL
18	SOIL BORING LOGS
19	SOIL BORING LOG LOCATIONS

HIGHWAY STANDARDS	
000001-08	STANDARD SYMBOLS, ABBREVIATIONS AND PATTERNS
001006	DECIMAL OF AN INCH & FOOT
701701-10	URBAN LANE CLOSURE, MULTILANE INTERSECTION
701801-06	SIDEWALK, CORNER OR CROSSWALK CLOSURE
701901-08	TRAFFIC CONTROL DEVICES
720001-01	SIGN PANEL MOUNTING DETAILS
720016-04	MAST ARM MOUNTED STREET NAME SIGNS
814001-03	HANDHOLES
814006-03	DOUBLE HANDHOLES
821101-02	LUMINARE WIRING IN POLE
857001-01	STANDARD PHASE DESIGNATION DIAGRAMS AND PHASE SEQUENCES
873001-02	TRAFFIC SIGNAL GROUNDING & BONDING
877001-08	STEEL MAST ARM ASSEMBLY AND POLE 16' THROUGH 55'
877011-10	STEEL COMB. MAST ARM ASSEMBLY AND POLE 16' THROUGH 55'
878001-11	CONCRETE FOUNDATION DETAILS
880006-01	TRAFFIC SIGNAL MOUNTING DETAILS

TRAFFIC SIGNAL CONSTRUCTION STAGING NOTES	
1.	THE CONTRACTOR WILL BE ALLOWED TO PLACE THE INTERSECTION INTO ALL-RED FLASH MODE TO FACILITATE THE INSTALLATION OF THE PROPOSED TRAFFIC SIGNAL MAST ARMS, POSTS, SIGNAL HEADS, ELECTRICAL CABLE AND OTHER COMPONENTS.
2.	THE CONTRACTOR SHALL FURNISH AND INSTALL A MINIMUM OF TWO STOP SIGNS PER APPROACH WHEN THE INTERSECTION IS OPERATING IN ALL-RED FLASH MODE. THE TRAFFIC SIGNALS MAY BE PLACED INTO ALL-RED FLASH MODE BETWEEN THE HOURS OF 8:30AM AND 3:00PM ONLY.
3.	THE CONTRACTOR SHALL RESTORE THE TRAFFIC SIGNALS TO NORMAL OPERATION AT ALL OTHER TIMES, UNLESS SPECIFICALLY DIRECTED OTHERWISE BY THE ENGINEER.
4.	THE CONTRACTOR WILL BE ALLOWED TO PLACE THE INTERSECTION INTO FLASH FOR A MAXIMUM OF FIVE DAYS PER EACH LOCATION.
5.	THE CONTRACTOR WILL BE ALLOWED TO MAKE TEMPORARY SPLICES AS NEEDED TO FACILITATE THE INSTALLATION OF THE PROPOSED TRAFFIC SIGNAL EQUIPMENT.
6.	ALL COSTS (LABOR, MATERIALS, AND EQUIPMENT) ASSOCIATED WITH THESE REQUIREMENTS SHALL BE INCLUDED IN THE CONTRACT BID PRICE. THERE WILL BE NO ADDITIONAL COMPENSATION FOR ITEMS REQUIRED TO IMPLEMENT STAGING, INCLUDING, BUT NOT LIMITED TO, TEMPORARY CABLE SPLICES, TEMPORARY TRAFFIC POSTS, AND PREMIUM TIME HOURS.

MODEL: Default  
FILE NAME: S:\CEN\WORK\DESIGN\A11\hanson\#\_Completed\_Contract\123-03\_Letting\_68H56\_Mast\_Arm\_MacArthurFiles\68H56\_Revision: (04-11-23).dgn

USER NAME = trevor.hanson	DESIGNED -	REVISED - TJH 04-11-23
	DRAWN -	REVISED -
PLOT SCALE = 23.8272' / in.	CHECKED -	REVISED -
PLOT DATE = 4/11/2023	DATE -	REVISED -

**STATE OF ILLINOIS  
DEPARTMENT OF TRANSPORTATION**

**COMMITMENTS, INDEX OF SHEETS, HIGHWAY STANDARDS, &  
TRAFFIC SIGNAL CONSTRUCTION STAGING NOTES**

SCALE: SHEET OF SHEETS STA. TO STA.

F.A.P. RTE.	SECTION	COUNTY	TOTAL SHEETS	SHEET NO.
669	D4 MAST ARM REPLACEMENT 2023-1	PEORIA	19	2
			CONTRACT NO. 68H56	
ILLINOIS FED. AID PROJECT				

STATUS OF UTILITIES					
COMPANY	CONTACT	TYPE OF UTILITY	TYPE OF CONFLICT	LOCATION	DISPOSITION
AT&T	WILLIAM CONOVER 8515 N INDUSTRIAL RD. PEORIA, IL 61615	COMMUNICATIONS (AERIAL)	MAST ARM	PROPOSED MA-2, MA-4	CAUTION
AMEREN	ELIZABETH COOKE 7064 W ROUTE 150 EDWARDS, IL 61528	GAS	UNDERGROUND CONDUIT, MAST ARM	PROPOSED MA-2	CAUTION
GREATER PEORIA SANITARY DISTRICT	JOHN BOYLE 2322 S DARST ST. PEORIA, IL 61607	STORM SEWER & SANITARY SEWER	UNDERGROUND CONDUIT	ALL QUADRANTS	CAUTION
ILLINOIS AMERICAN WATER	CHARLES BARTON 7500 N. HARKER DR. PEORIA, IL 61615	WATER LINE/ FIRE HYDRANT	UNDERGROUND CONDUIT, PEDESTRIAN PUSHBUTTON POST	ALL QUADRANTS	CAUTION
UTILITY DEPTHS TO BE DETERMINED THROUGH UTILITY LOCATES AND POT HOLING					

MODEL: D:\dwg\...  
 FILE NAME: ...  
 USER: ...  
 DATE: ...

USER NAME = trevor.hanson	DESIGNED -	REVISED - Tjh 04-11-23
	DRAWN -	REVISED -
PLOT SCALE = 23.8272' / in.	CHECKED -	REVISED -
PLOT DATE = 4/11/2023	DATE -	REVISED -

**STATE OF ILLINOIS**  
**DEPARTMENT OF TRANSPORTATION**

**STATUS OF UTILITIES**

SCALE:      SHEET    OF    SHEETS    STA.                    TO STA.

F.A.P. RTE.	SECTION	COUNTY	TOTAL SHEETS	SHEET NO.
669	D4 MAST ARM REPLACEMENT 2023-1	PEORIA	19	3
			CONTRACT NO. 68H56	
ILLINOIS   FED. AID PROJECT				

**CONSTRUCTION NOTES**

1.	THE LOCATION OF ALL UTILITIES AND PRIVATELY OWNED FACILITIES SHALL BE FIELD VERIFIED BY THE CONTRACTOR PRIOR TO THE INSTALLATION OF ANY COMPONENTS.
2.	THE CONTRACTOR SHALL BE RESPONSIBLE FOR LOCATING EXISTING IDOT ELECTRICAL FACILITIES AT HIS/HER OWN EXPENSE IF REQUIRED. THE CONTRACTOR SHALL ALSO BE LIABLE FOR ANY DAMAGE TO IDOT FACILITIES RESULTING FROM INACCURATE LOCATING.
3.	ELECTRICAL WORK SHALL CONFORM WITH NATIONAL, STATE, AND LOCAL CODES.
4.	THE LOCATIONS FOR HANDHOLES AND CONCRETE FOUNDATIONS ARE PROVIDED FOR REFERENCE ONLY. THE ENGINEER OF TRAFFIC SHALL BE NOTIFIED FOR LOCATION VERIFICATION BEFORE INSTALLATION.
5.	ALL TRAFFIC SIGNAL SECTIONS SHALL HAVE 12" SINGLE LED LENSES.
6.	THE RED SECTIONS OF THE SIGNAL HEADS SHARING THE SAME MAST ARM SHALL BE LEVEL WITH ONE ANOTHER AND MAINTAIN A 16 FT. MINIMUM CLEARANCE FROM THE HIGHEST POINT OF THE ROADWAY TO BOTTOM OF THE SIGNAL BACKPLATE.
7.	ALL TRAFFIC SIGNAL HEAD BRACKETS ARE TO BE GALVANIZED STEEL WITH A NATURAL FINISH.
8.	ALL TRAFFIC SIGNAL STRUCTURES SHALL BE BONDED IN ACCORDANCE WITH NEC REQUIREMENTS. THIS WORK SHALL BE PAID FOR AT THE CONTRACT UNIT PRICE FOR "ELECTRIC CABLE IN CONDUIT, EQUIPMENT GROUNDING CONDUCTOR, NO. 6 1C" AND SHALL INCLUDE ALL LABOR, EQUIPMENT, AND MATERIALS (INCLUDING CLAMPS, HARDWARE, ELECTRICAL CABLE, AND ALL OTHER ITEMS REQUIRED TO BOND THE STRUCTURES).
9.	SDR 13.5 HDPE COILABLE DUCT MAY BE USED IN PLACE OF SCHEDULE 40 PVC CONDUIT.
10.	THE CONTRACTOR SHALL PROVIDE ELECTRICAL CABLE SLACK IN ACCORDANCE WITH ARTICLE 873.03.
11.	ELECTRICAL CABLE WILL BE MEASURED FOR PAYMENT IN ACCORDANCE WITH ARTICLE 873.04.
12.	THE CONTRACTOR SHALL VERIFY FIELD CONDITIONS PRIOR TO BIDDING. THERE WILL BE NO ADDITIONAL COMPENSATION PAID FOR CLAIMS THAT ARISE FROM A FAILURE TO FULLY INVESTIGATE EXISTING FIELD CONDITIONS.
13.	THE EXISTING TRAFFIC SIGNALS SHALL REMAIN IN OPERATION DURING THE CONSTRUCTION OF THE PROPOSED TRAFFIC SIGNALS.
14.	ANY MAINTENANCE OF EXISTING TRAFFIC SIGNALS WILL BE CONSIDERED EXTRA WORK IN ACCORDANCE WITH ARTICLE 109.04 OF THE STANDARD SPECIFICATIONS.
15.	THE HANDHOLES SHALL BE CONSTRUCTED SO THAT THE TOP OF THE FRAME WILL BE FLUSH WITH THE SURFACE OF THE SHOULDER OR GROUND LINE.
16.	ALL SURPLUS MATERIALS SHALL BE DISPOSED OF IN ACCORDANCE WITH ARTICLE 202.03 OF THE STANDARD SPECIFICATIONS.
17.	COILABLE POLYETHYLENE DUCT MAY BE SUBSTITUTED FOR PVC PUSHED OR TRENCHED.
18.	NO ADDITIONAL COMPENSATION WILL BE ALLOWED FOR PLACING CONDUIT AT GREATER THAN 2 FT. MINIMUM DEPTH TO AVOID OBSTACLES SUCH AS UNDERGROUND UTILITIES.
19.	THE CONTRACTOR IS RESPONSIBLE FOR THE COST OF UNCOVERING OR HAND DIGGING AROUND UTILITIES AS NECESSARY. THIS COST OF THIS WORK SHALL BE INCLUDED IN THE UNIT PRICES FOR THE CONDUITS.
20.	THE CONTRACTOR SHALL RELOCATE SIGNS FROM THE EXISTING MAST ARMS AND TRAFFIC SIGNAL POSTS TO THE PROPOSED MAST ARMS AND TRAFFIC SIGNAL POSTS. THIS WORK WILL NOT BE PAID FOR SEPARATELY, BUT SHALL BE INCLUDED IN THE BID PRICE OF THE PROPOSED MAST ARMS AND TRAFFIC SIGNAL POSTS.
21.	ALL PROPOSED STREET SIGNS SHALL INCLUDE THE BLOCK NUMBERING AT THE BOTTOM OF THE SIGN.
22.	THE CONTRACTOR SHALL FURNISH AND INSTALL GROUT AROUND ALL DRILLED CONDUITS LOCATED INSIDE OF HANDHOLES TO PREVENT WATER AND DIRT INTRUSION INTO THE HANDHOLE. THE COST OF THIS WORK SHALL BE INCLUDED IN THE COST OF "DRILL EXISTING HANDHOLE."
23.	WITHIN THIRTY CALENDAR DAYS AFTER CONTRACT EXECUTION, THE CONTRACTOR SHALL SUBMIT J.U.L.I.E. TICKETS TO HAVE THE UNDERGROUND UTILITIES MARKED AT THE INTERSECTION AND THEN SCHEDULE AN ON-SITE MEETING WITH THE RESIDENT ENGINEER AND IDOT D4 TRAFFIC OPERATIONS TO DETERMINE AND MARK THE EXACT PLACEMENT OF THE PROPOSED TRAFFIC SIGNAL COMPONENTS.
24.	THE CONTRACTOR SHALL FIELD VERIFY THE EXISTING ANCHOR BOLT PATTERN FOR THE EXISTING MA-4 PRIOR TO ORDERING MATERIAL FOR THE PROPOSED MA-4. THE CONTRACTOR SHALL VERIFY THAT THE PROPOSED MA-4 IS COMPATIBLE WITH THE EXISTING ANCHOR BOLT PATTERN.
26.	THE CONTRACTOR SHALL FURNISH AND INSTALL ONE 20A 1-POLE CIRCUIT BREAKER, BUTTON PHOTOCELL, TERMINAL BLOCK WIRING, AND ALL OTHER ITEMS REQUIRED TO PROVIDE POWER TO THE PROPOSED AND RELOCATED LUMINAIRES. THESE ITEMS SHALL BE INSTALLED IN THE PROPOSED TRAFFIC SIGNAL CABINET. THE COST OF THIS WORK SHALL BE INCLUDED IN THE COST OF RELOCATING THE EXISTING TRAFFIC SIGNAL CABINET. ALL LUMINAIRES SHALL BE WIRED TO 120V.
27.	THE CONTRACTOR SHALL FURNISH AND INSTALL PEDESTRIAN PUSHBUTTON EXTENSIONS AS NEEDED TO ALLOW THE FACE OF THE PUSHBUTTON TO BE LOCATED A MAXIMUM OF 10 INCHES FROM THE EDGE OF THE CLEAR SPACE, AS SHOWN IN THE PEDESTRIAN PUSHBUTTON PLAN DETAIL. THE COST OF THIS WORK SHALL BE INCLUDED IN THE COST OF THE "ACCESSIBLE PEDESTRIAN SIGNALS."
28.	THE CONTRACTOR SHALL RELOCATE THE EXISTING CCTV CAMERA, HARDWARE, ETC. FROM THE EXISTING MAST ARM (MA-4) TO THE PROPOSED MAST ARM (MA-4.) THIS WORK SHALL BE INCLUDED IN THE BID PRICE OF THE PAY ITEM "RELOCATE EXISTING PTZ CAMERA."
29.	THE CONTRACTOR SHALL PICK UP FOUR ROADWAY LUMINAIRES FROM THE CITY OF PEORIA PUBLIC WORKS DEPARTMENT AT 3505 N. DRIES LN. PEORIA, IL 61604 AND INSTALL TWO ON MA-2 AND TWO ON MA-4 AS SHOWN IN THE PLANS. THE LUMINAIRES SHALL BE INSTALLED 90 DEGREES APART. THE CONTRACTOR SHALL FURNISH AND INSTALL NEW POLE WIRING, SURGE ARRESTORS, FUSE HOLDERS, AND FUSES. THIS WORK WILL NOT BE PAID FOR SEPARATELY, BUT SHALL BE INCLUDED IN THE BID PRICE FOR THE ROADWAY LUMINAIRES, SPECIAL (INSTALL ONLY.)
30.	PEDESTRIAN PUSHBUTTONS SHALL BE LOCATED IN ACCORDANCE WITH THE 2009 MUTCD. FOR ALL INSTALLATIONS, THE REACH RANGE (DISTANCE BETWEEN THE FACE OF PEDESTRIAN PUSHBUTTON AND THE CLEAR SPACE) SHALL NOT EXCEED 10 INCHES. THE COST TO MODIFY OR RELOCATE ANY PUSHBUTTONS THAT WERE NOT INSTALLED ACCORDING TO MUTCD REQUIREMENTS AND CONTRACT SPECIFICATIONS WILL BE THE RESPONSIBILITY OF THE CONTRACTOR.
31.	PEDESTRIAN PUSHBUTTON SIGNS (R10-3E) SHALL BE CONSTRUCTED USING DIAMOND GRADE (TYPE XI) REFLECTIVE SHEETING.
32.	FOR LOCATIONS WITH TWO PEDESTRIAN PUSHBUTTONS ON A SINGLE TRAFFIC SIGNAL POST OR PEDESTRIAN PUSHBUTTON POST, THE CONTRACTOR SHALL FURNISH AND INSTALL A SINGLE MOUNTING BRACKET THAT HOUSES BOTH PEDESTRIAN PUSHBUTTON FRAMES, WITH INTEGRATED CUPS, AT A 90 DEGREE ANGLE FROM EACH OTHER. THE COST OF THIS WORK WILL NOT BE PAID FOR SEPARATELY, BUT SHALL BE INCLUDED IN THE BID PRICE FOR THE "ACCESSIBLE PEDESTRIAN SIGNALS."
35.	THE CONTRACTOR SHALL CLEAR AND REMOVE ANY BRUSH OR LANDSCAPING TO ACCOMODATE THE INSTALLATION OF THE PROPOSED CONCRETE FOUNDATIONS. THIS WORK WILL NOT BE PAID FOR SEPARATELY, BUT SHALL BE INCLUDED IN THE COST OF THE CONCRETE FOUNDATIONS.

MODEL: Default  
FILE NAME: S:\CEN\WORK\DESIGN\Abrahamson\# Completed Contract\123-03 Letting\_68H56 Mast Arm MacArthurFiles\68H56 Revision: (04-11-23).dgn

USER NAME = trevor.hanson	DESIGNED -	REVISED - TJH 04-11-23
PLOT SCALE = 23.8272' / in.	DRAWN -	REVISED -
PLOT DATE = 4/11/2023	CHECKED -	REVISED -
	DATE -	REVISED -

**STATE OF ILLINOIS  
DEPARTMENT OF TRANSPORTATION**

**CONSTRUCTION NOTES**

SCALE: SHEET OF SHEETS STA. TO STA.

F.A.P. RTE.	SECTION	COUNTY	TOTAL SHEETS	SHEET NO.
669	D4 MAST ARM REPLACEMENT 2023-1	PEORIA	19	4
			CONTRACT NO. 68H56	
ILLINOIS   FED. AID PROJECT				

SUMMARY OF QUANTITIES

CONST. CODE
0021
80% FEDERAL
20% STATE
0% CITY
URBAN
PEORIA

ITEM NUMBER	ITEM DESCRIPTION	UNIT	TOTAL QTY.	CONST. CODE
42400100	PORTLAND CEMENT CONCRETE SIDEWALK 4 INCH	SQ FT	142.5	142.5
44000600	SIDEWALK REMOVAL	SQ FT	186.5	186.5
67100100	MOBILIZATION	L SUM	1.0	1.0
* 72000100	SIGN PANEL - TYPE 1	SQ FT	10.0	10.0
* 72000200	SIGN PANEL - TYPE 2	SQ FT	76.4	76.4
81028320	UNDERGROUND CONDUIT, PVC, 1" DIA.	FOOT	52.0	52.0
81028350	UNDERGROUND CONDUIT, PVC, 2" DIA.	FOOT	382.0	382.0
81028370	UNDERGROUND CONDUIT, PVC, 3" DIA.	FOOT	55.0	55.0
81400700	HANDHOLE, PORTLAND CEMENT CONCRETE	EACH	4.0	4.0
81400720	DOUBLE HANDHOLE, PORTLAND CEMENT CONCRETE	EACH	1.0	1.0
81702110	ELECTRIC CABLE IN CONDUIT, 600V (XLP-TYPE USE) 1/C NO. 10	FOOT	503.0	503.0
81702130	ELECTRIC CABLE IN CONDUIT, 600V (XLP-TYPE USE) 1/C NO. 6	FOOT	212.0	212.0
87301225	ELECTIC CABLE IN CONDUIT, SIGNAL NO. 14 3C	FOOT	209.0	209.0
87301245	ELECTRIC CABLE IN CONDUIT, SIGNAL NO. 14 5C	FOOT	1573.5	1573.5
87301255	ELECTRIC CABLE IN CONDUIT, SIGNAL NO. 14 7C	FOOT	1192.0	1192.0
87301900	ELECTRIC CABLE IN CONDUIT, EQUIPMENT GROUNDING CONDUCTOR, NO. 6 1C	FOOT	549.5	549.5
87502500	TRAFFIC SIGNAL POST, GALVANIZED STEEL 16 FT.	EACH	1.0	1.0
87700160	STEEL MAST ARM ASSEMBLY AND POLE, 24 FT.	EACH	1.0	1.0
87702890	STEEL COMBINATION MAST ARM ASSEMBLY AND POLE 32 FT.	EACH	1.0	1.0
87702910	STEEL COMBINATION MAST ARM ASSEMBLY AND POLE 36 FT.	EACH	1.0	1.0
87800100	CONCRETE FOUNDATION, TYPE A	FOOT	3.0	3.0
87800200	CONCRETE FOUNDATION, TYPE D	FOOT	3.5	3.5

\* = SPECIALTY ITEM

MODEL: Default  
FILE NAME: S:\CEN\WORK\DESIGN\Ahhanson\# Completed Contract\123-03 Letting\_68H56 Mast Arm MacArthurFiles\68H56 Revision: (04-11-23).dgn

USER NAME = trevor.hanson	DESIGNED -	REVISED - TJH 04-11-23
	DRAWN -	REVISED -
PLOT SCALE = 23.8272' / in.	CHECKED -	REVISED -
PLOT DATE = 4/11/2023	DATE -	REVISED -

STATE OF ILLINOIS  
DEPARTMENT OF TRANSPORTATION

SUMMARY OF QUANTITIES	
SCALE:	SHEET OF SHEETS STA. TO STA.

F.A.P. RTE.	SECTION	COUNTY	TOTAL SHEETS	SHEET NO.
669	D4 MAST ARM REPLACEMENT 2023-1	PEORIA	19	5
ILLINOIS FED. AID PROJECT			CONTRACT NO. 68H56	

SUMMARY OF QUANTITIES - CONTINUED

CONST. CODE  
0021  
80% FEDERAL  
20% STATE  
0% CITY  
URBAN  
PEORIA

ITEM NUMBER	ITEM DESCRIPTION	UNIT	TOTAL QTY.	
87800400	CONCRETE FOUNDATION, TYPE E 30-INCH DIAMETER	FOOT	23.5	23.5
<b>87900100</b>	<b>DRILL EXISTING FOUNDATION</b>	<b>EACH</b>	<b>1.0</b>	<b>1.0</b>
87900200	DRILL EXISTING HANDHOLE	EACH	1.0	1.0
88040070	SIGNAL HEAD, POLYCARBONATE, LED, 1-FACE, 3-SECTION, BRACKET MOUNTED	EACH	1.0	1.0
88040090	SIGNAL HEAD, POLYCARBONATE, LED, 1-FACE, 3-SECTION, MAST ARM MOUNTED	EACH	6.0	6.0
88040110	SIGNAL HEAD, POLYCARBONATE, LED, 1-FACE, 4-SECTION, BRACKET MOUNTED	EACH	4.0	4.0
88040120	SIGNAL HEAD, POLYCARBONATE, LED, 1-FACE, 4-SECTION, MAST ARM MOUNTED	EACH	4.0	4.0
88102845	PEDESTRIAN SIGNAL HEAD, POLYCARBONATE, LED, 2-FACE, BRACKET MOUNTED WITH COUNT DOWN TIMER	EACH	4.0	4.0
88200510	TRAFFIC SIGNAL BACKPLATE, RETROREFLECTIVE	EACH	15.0	15.0
89502375	REMOVE EXISTING TRAFFIC SIGNAL EQUIPMENT	EACH	1.0	1.0
89502385	REMOVE EXISTING CONCRETE FOUNDATION	EACH	4.0	4.0
X0322281	WIDE AREA VIDEO DETECTION SYSTEM COMPLETE	EACH	1.0	1.0
X8710304	FIBER OPTIC CABLE SPLICE - LATERAL	EACH	1.0	1.0
X0326812	CAT 5 ETHERNET CABLE	FOOT	111.5	111.5
X1400227	ROADWAY LUMINAIRE, SPECIAL (INSTALL ONLY)	EACH	4.0	4.0
X1400368	RELOCATE EXISTING PTZ CAMERA	EACH	1.0	1.0
X7010216	TRAFFIC CONTROL AND PROTECTION, (SPECIAL)	L SUM	1.0	1.0
X8040102	ELECTRIC SERVICE INSTALLATION, SPECIAL	EACH	1.0	1.0
X8760200	ACCESSIBLE PEDESTRIAN SIGNALS	EACH	8.0	8.0
X8760201	PEDESTRIAN PUSH-BUTTON POST	EACH	4.0	4.0
X8950224	RELOCATE CONTROLLER CABINET	EACH	1.0	1.0

MODEL: Default  
FILE NAME: S:\CEN\WORK\DESIGN\Ahhanson\# Completed Contract\123-03 Letting\_68H56 Mast Arm MacArthurFiles\68H56 Revision: (04-11-23).dgn

USER NAME = trevor.hanson	DESIGNED -	REVISED - TJH 04-11-23
	DRAWN -	REVISED -
PLOT SCALE = 23.8272' / in.	CHECKED -	REVISED -
PLOT DATE = 4/11/2023	DATE -	REVISED -

STATE OF ILLINOIS  
DEPARTMENT OF TRANSPORTATION

SUMMARY OF QUANTITIES - CONTINUED

SCALE: SHEET OF SHEETS STA. TO STA.

F.A.P. RTE.	SECTION	COUNTY	TOTAL SHEETS	SHEET NO.
669	D4 MAST ARM REPLACEMENT 2023-1	PEORIA	19	6
ILLINOIS FED. AID PROJECT			CONTRACT NO. 68H56	



BILL OF MATERIALS		
MACARTHUR & WASHINGTON (REMOVAL)		
ITEM DESCRIPTION	UNIT	QTY.
REMOVE EXISTING TRAFFIC SIGNAL EQUIPMENT	EACH	1.0
REMOVE EXISTING CONCRETE FOUNDATION	EACH	4.0

REMOVE EXISTING TRAFFIC SIGNAL EQUIPMENT - QTY. 1.0 EACH (INCLUDES ALL ITEMS LISTED BELOW)	
THE FOLLOWING ITEMS SHALL BE REMOVED AND DISPOSED OF BY THE CONTRACTOR OFF OF THE RIGHT-OF-WAY:	
QTY.	ITEM DESCRIPTION
3.0	SIGNAL HEAD, BRACKET MOUNTED (SIGNAL HEADS 3,8,12)
9.0	SIGNAL HEAD, MAST ARM MOUNTED (SIGNAL HEADS 1,2,4,5,6,7,9,10,11)
2.0	STEEL COMBINATION MAST ARM ASSEMBLY AND POLE (MA-2, MA-4)
1.0	STEEL MAST ARM ASSEMBLY AND POLE (MA-3)
1.0	TRAFFIC SIGNAL POST (TS-1)
4.0	VIDEO VEHICLE DETECTION CAMERA
ALL	ELECTRICAL CABLE NOT USED IN PROPOSED PLANS

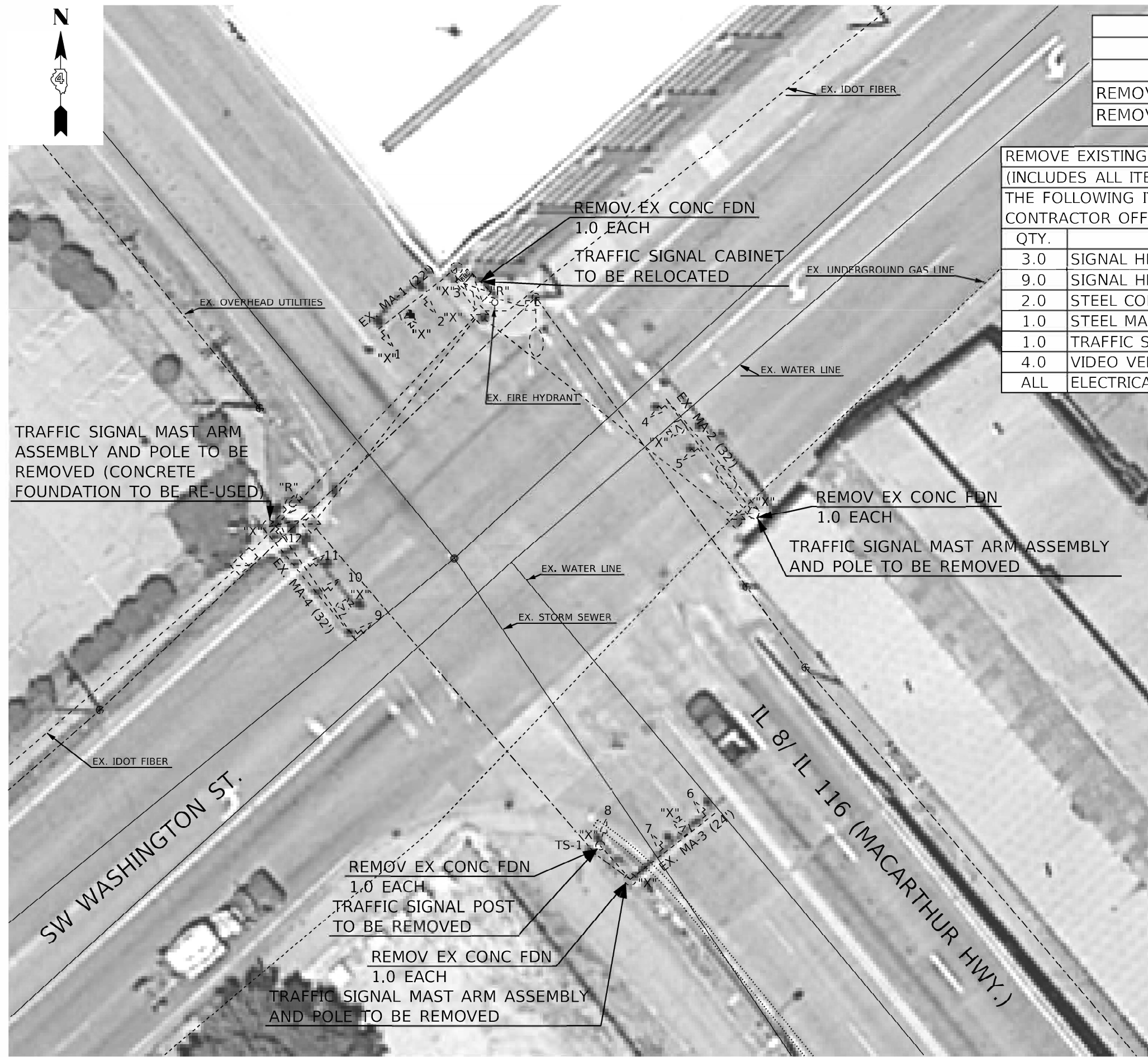

- NOTES:
1. REMOVAL ITEMS LABELED "X"
  2. RELOCATED ITEMS LABELED "R"
  3. THE CONCRETE FOUNDATION FOR EXISTING MAST ARM (MA-4) SHALL REMAIN AND BE RE-USED FOR THE PROPOSED MAST ARM (MA-4.)

"X" INDICATES REMOVAL ITEM  
"R" INDICATES RELOCATE ITEM

LEGEND	
	EX. TS CONTROLLER CABINET
	EX. DOUBLE HANDHOLE
	EX. HANDHOLE
	EX. SIGNAL HEAD (WITH BACKPLATE)
	EX. SIGNAL HEAD (WITHOUT BACKPLATE)
	EX. MAST ARM ASSEMBLY AND POLE
	EX. COMBINATION MAST ARM ASSEMBLY AND POLE
	EX. TRAFFIC SIGNAL POST
	EX. LUMINAIRE
	EX. CONDUIT
	EX. CCTV CAMERA
	EX. VEHICLE VIDEO DETECTION CAMERA

NOT TO SCALE

MODEL: Default  
FILE NAME: S:\CEN\HWY04\DESIGN\Akhanson\# Completed Contract\123-03 Letting\_68H56 Mast Arm\_MacArthur\Files\68H56\_Revisions\_04-11-23.dgn

USER NAME = trevor.hanson	DESIGNED -	REVISED - TJH 04-11-23
PLOT SCALE = 23.8272' / in.	DRAWN -	REVISED -
PLOT DATE = 4/11/2023	CHECKED -	REVISED -
	DATE -	REVISED -

STATE OF ILLINOIS  
DEPARTMENT OF TRANSPORTATION

EXISTING TRAFFIC SIGNAL PLANS & REMOVAL ITEMS	
IL 8/IL 116 (MACARTHUR HWY.) & SW WASHINGTON ST. - PEORIA	
SCALE:	SHEET OF SHEETS STA. TO STA.

F.A.P. RTE.	SECTION	COUNTY	TOTAL SHEETS	SHEET NO.
669	D4 MAST ARM REPLACEMENT 2023-1	PEORIA	19	7
			CONTRACT NO. 68H56	
ILLINOIS FED. AID PROJECT				

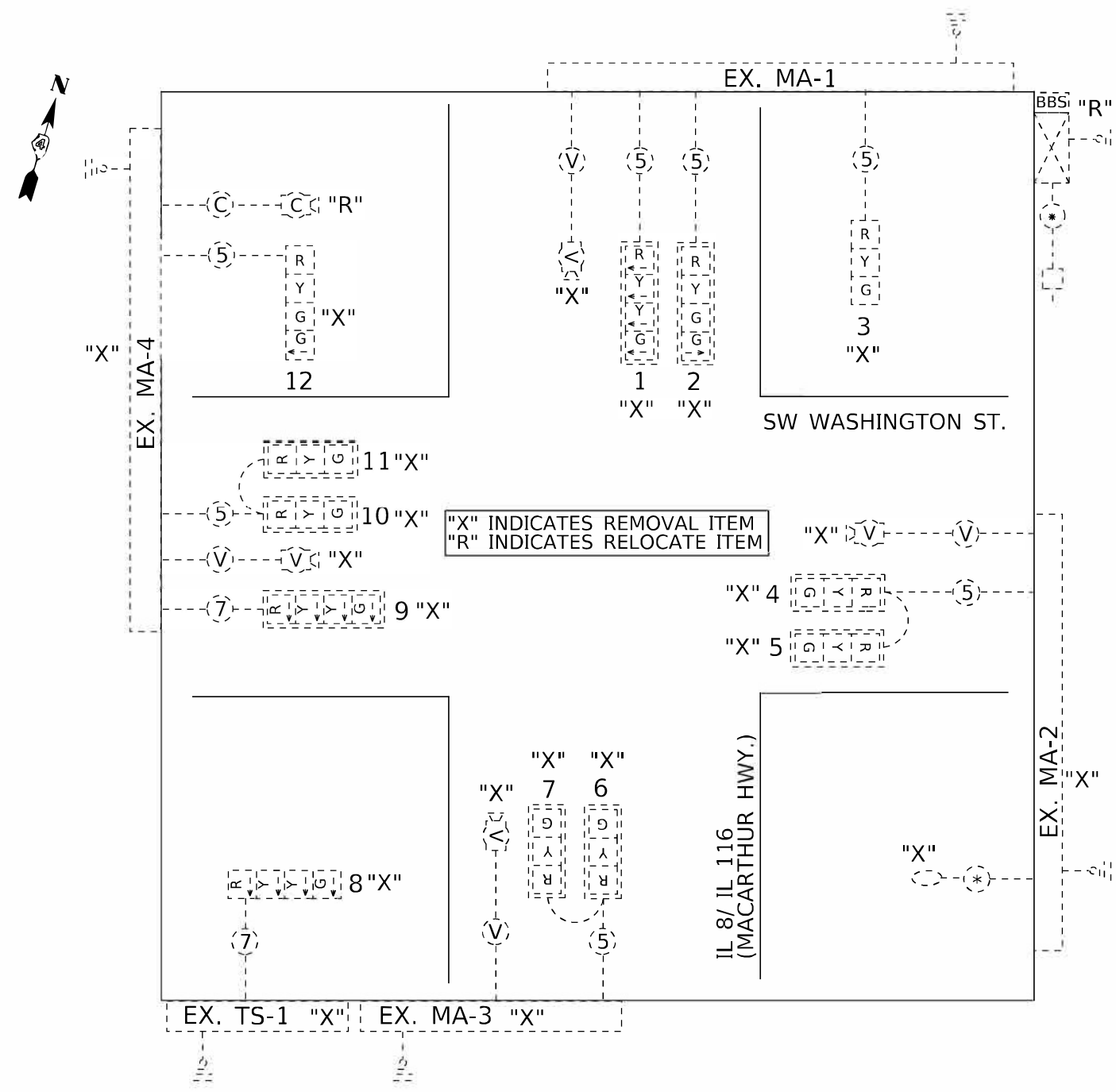

"X" INDICATES REMOVAL ITEM  
 "R" INDICATES RELOCATE ITEM

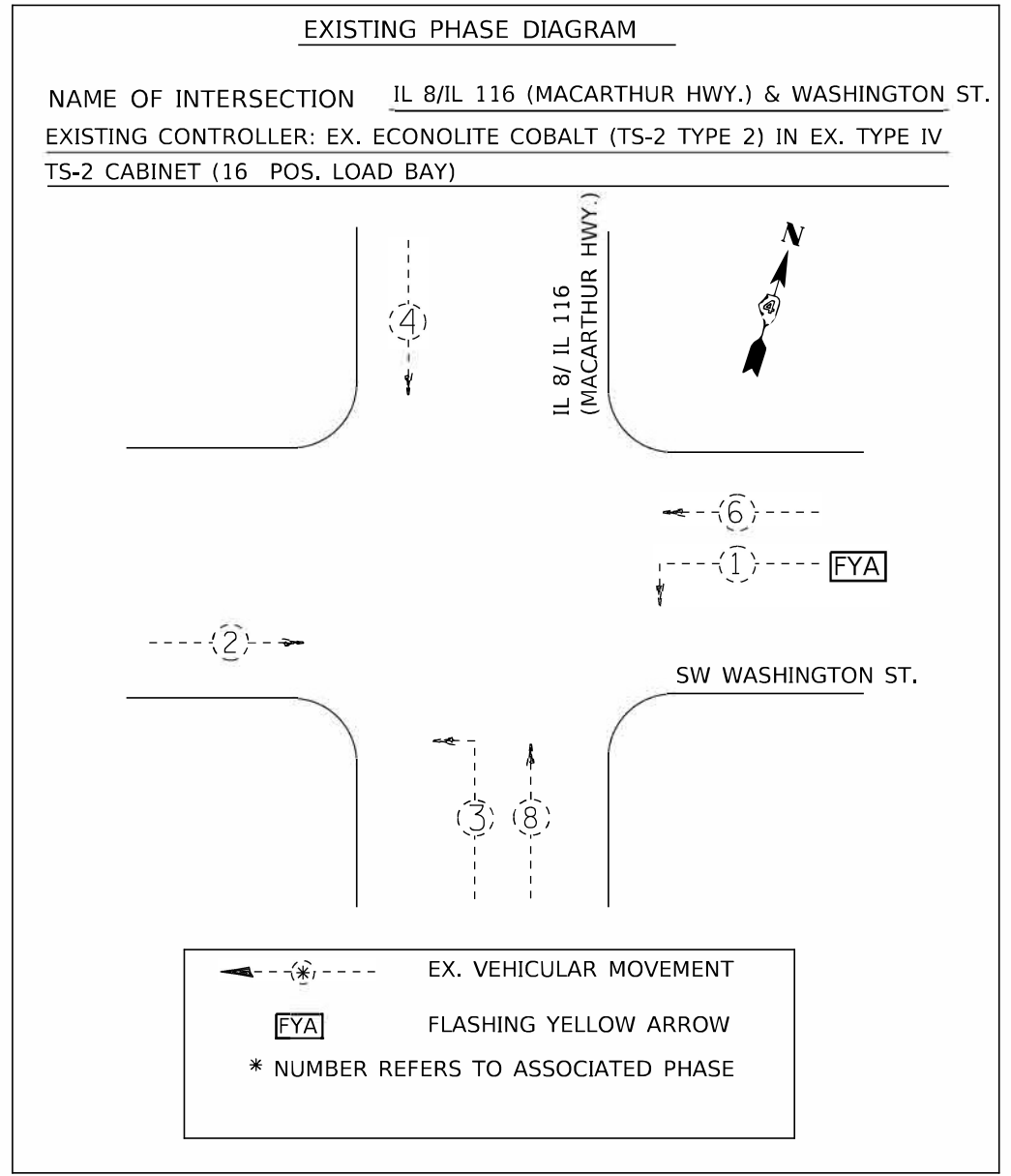

TRAFFIC SIGNALS LEGEND

	EX. TRAFFIC SIGNAL CONTROLLER CABINET (TO BE RELOCATED)		EX. 3 SEC. SIGNAL HEAD WITH BACKPLATE		EX. 5/C NO. 14 SIGNAL CABLE
	EX. ELECTRIC SERVICE		EX. 3 SEC. SIGNAL HEAD WITHOUT BACKPLATE		EX. 7/C NO. 14 SIGNAL CABLE
	EX. GROUND/SAFETY BOND		EX. ROADWAY LUMINAIRE		EX. 1/C NO. 6 CABLE
	EX. CCTV CAMERA		EX. VIDEO VEHICLE DETECTOR		EX. VIDEO DETECTION CABLE
			EX. CAT 5 ETHERNET CABLE		

MODEL: D:\p1\116\116.dwg  
 FILE NAME: S:\CEN\HW\08\DESP\AN\hanson\# Completed Contracts\12\03 Letting\_68H56 Mast Arm\_MacArthurFiles\68H56 Revisions (04-11-23).dgn

NOT TO SCALE

USER / NAME = tressor.hanson	DESIGNED -	REVISED - TJH 04-11-23
	DRAWN -	REVISED -
PLOT SCALE = 23.8272' / in.	CHECKED -	REVISED -
PLOT DATE = 4/11/2023	DATE -	REVISED -

STATE OF ILLINOIS  
 DEPARTMENT OF TRANSPORTATION

EXISTING CIRCUIT AND PHASE DIAGRAMS	
IL 8/IL 116 (MACARTHUR HWY.) & WASHINGTON ST. - PEORIA	
SCALE:	SHEET OF SHEETS STA. TO STA.

F.A.P. RTE. 669	SECTION D4 MAST ARM REPLACEMENT 2023-1	COUNTY PEORIA	TOTAL SHEETS 19	SHEET NO. 8
ILLINOIS FED. AID PROJECT			CONTRACT NO. 68H56	



TRAFFIC SIGNAL HEAD SCHEDULE			
IL 8/IL 116 (MACARTHUR) & WASHINGTON			
PROP. QTY.	UNIT	ITEM	LOCATION
1.0	EACH	SH P LED 1F 3S BM	3
6.0	EACH	SH P LED 1F 3S MAM	2,4,5,7,10,11
4.0	EACH	SH P LED 1F 4S BM	8,12,13,15
4.0	EACH	SH P LED 1F 4S MAM	1,6,9,14
4.0	EACH	PED SH P LED 2F BM CT	A/B, C/D, E/F, G/H
15.0	EACH	TS BACKPLATE RET-REFL	1,2,3,4,5,6,7,8,9,10,11,12,13,14,15

HANDHOLE SCHEDULE			
IL 8/IL 116 (MACARTHUR) & WASHINGTON			
NAME	TYPE	LOCATION	DESCRIPTION
HH-1	DOUBLE	NW QUAD	PROPOSED PCC HANDHOLE
HH-2	SINGLE	NW QUAD	PROPOSED PCC HANDHOLE
HH-3	SINGLE	NW QUAD	ABANDON IN PLACE
HH-4	SINGLE	NE QUAD	PROPOSED PCC HANDHOLE
HH-5	SINGLE	NE QUAD	DRILL EX. HANDHOLE
HH-6	SINGLE	SE QUAD	PROPOSED PCC HANDHOLE
HH-7	SINGLE	SE QUAD	ABANDON IN PLACE
HH-6	SINGLE	SW QUAD	PROPOSED PCC HANDHOLE

MAST ARM AND TRAFFIC SIGNAL POST SCHEDULE						
IL 8/IL 116 (MACARTHUR) & WASHINGTON						
NAME	DESCRIPTION	LENGTH	PROPOSED FOUNDATION			LOCATION
			DIAMETER	TYPE	DEPTH	
MA-1	EX. S MAA&P	22 FT.	N/A			NE QUAD
MA-2	PROP. STL COMB MAA&P INSTALLED ON PROP. CONCRETE FOUNDATION	36 FT.	30 INCH	TYPE E	13.5 FT.	SE QUAD
MA-3	PROP. S MAA&P INSTALLED ON PROP. CONCRETE FOUNDATION	24 FT.	30 INCH	TYPE E	10.0 FT.	SW QUAD (MINIMUM 2 FT. BEHIND EX. PARAPET WALL)
MA-4	PROP. STL COMB MAA&P INSTALLED ON EX. CONCRETE FOUNDATION*	32 FT.	N/A			NW QUAD
TS-1	PROP. TS POST GALVS	16 FT.	24 INCH	TYPE A	3.0 FT.	SW QUAD

\* THE CONTRACTOR SHALL INSPECT THE EXISTING ANCHOR BOLT PATTERN FOR MA-4 PRIOR TO ORDERING MATERIALS. THE CONTRACTOR SHALL VERIFY THAT THE PROPOSED MA-4 IS COMPATIBLE WITH THE EXISTING ANCHOR BOLT PATTERN.

ACCESSIBLE PEDESTRIAN SIGNAL (APS) SCHEDULE		
IL 8/IL 116 (MACARTHUR) & WASHINGTON		
NAME	PROP. ACCESSIBLE PEDESTRIAN SIGNAL QTY.	LOCATION
P1	1.0	NE QUAD (PED-1)
P2	1.0	NE QUAD (PED-2)
P3	1.0	SE QUAD (PED-3)
P4	1.0	SE QUAD (PED-3)
P5	1.0	SW QUAD (TS-1)
P6	1.0	SW QUAD (TS-1)
P7	1.0	NW QUAD (PED-4)
P8	1.0	NW QUAD (PED-4)

SIGN SCHEDULE				
IL 8/IL 116 (MACARTHUR) & WASHINGTON				
DESCRIPTION	SIGN TYPE	SIGN SIZE (SQ FT.)	QTY.	LOCATION
PROP. MACARTHUR HWY*	II	19.8	2.0	EX. MA-1, PROP. MA-3
PROP. WASHINGTON ST*	II	18.4	2.0	PROP. MA-2, PROP. MA-4
PROP. FLASHING YELLOW ARROW	I	5.0	2.0	PROP. MA-2, PROP. MA-4

ALL OTHER EX. SIGNS TO BE RELOCATED TO PROP. MAST ARMS  
\* SEE PLAN SHEET 14 FOR BLOCK LETTERING DETAILS

LEGEND	
	EX. TS CONTROLLER CABINET (RELOCATED)
	EX. DOUBLE HANDHOLE
	EX. HANDHOLE
	EX. COMMUNICATIONS VAULT
	EX. BATTERY BACKUP SYSTEM (RELOCATED)
	EX. MAST ARM ASSEMBLY AND POLE
	EX. COMBINATION MAST ARM ASSEMBLY AND POLE
	EX. TRAFFIC SIGNAL POST
	EX. LUMINAIRE
	EX. CONDUIT
	EX. CCTV CAMERA (RELOCATED)
	EX. FIRE HYDRANT
	PROP. VEHICLE VIDEO DETECTION CAMERA
	PROP. ELECTRIC SERVICE
	PROP. TS CONTROLLER CABINET
	PROP. HANDHOLE
	PROP. SIGNAL HEAD (WITH BACKPLATE)
	PROP. MAST ARM ASSEMBLY AND POLE
	PROP. COMBINATION MAST ARM ASSEMBLY AND POLE
	PROP. TRAFFIC SIGNAL POST
	PROP. PEDESTRIAN SIGNAL HEAD
	PROP. PEDESTRIAN PUSHBUTTON (APS)
	PROP. LED LUMINAIRE

MODEL: D:\dwg\116\116.dwg  
FILE NAME: S:\CEN\116\116.dwg  
PROJECT: 68H56 MAST ARM, MACARTHUR HWY & WASHINGTON ST. PEORIA  
CONTRACT: 68H56 MAST ARM, MACARTHUR HWY & WASHINGTON ST. PEORIA  
DATE: 04-11-23

USER NAME = trevor.hanson	DESIGNED -	REVISED - TJH 04-11-23
	DRAWN -	REVISED -
PLOT SCALE = 23.8272' / in.	CHECKED -	REVISED -
PLOT DATE = 4/11/2023	DATE -	REVISED -

**STATE OF ILLINOIS  
DEPARTMENT OF TRANSPORTATION**

<b>PROPOSED TRAFFIC SIGNAL SCHEDULES</b>			
<b>IL 8/IL 116 (MACARTHUR HWY.) &amp; SW WASHINGTON ST. - PEORIA</b>			
SCALE:	SHEET	OF	SHEETS
		STA.	TO STA.

F.A.P. RTE.	SECTION	COUNTY	TOTAL SHEETS	SHEET NO.
669	D4 MAST ARM REPLACEMENT 2023-1	PEORIA	19	9
ILLINOIS			FED. AID PROJECT	

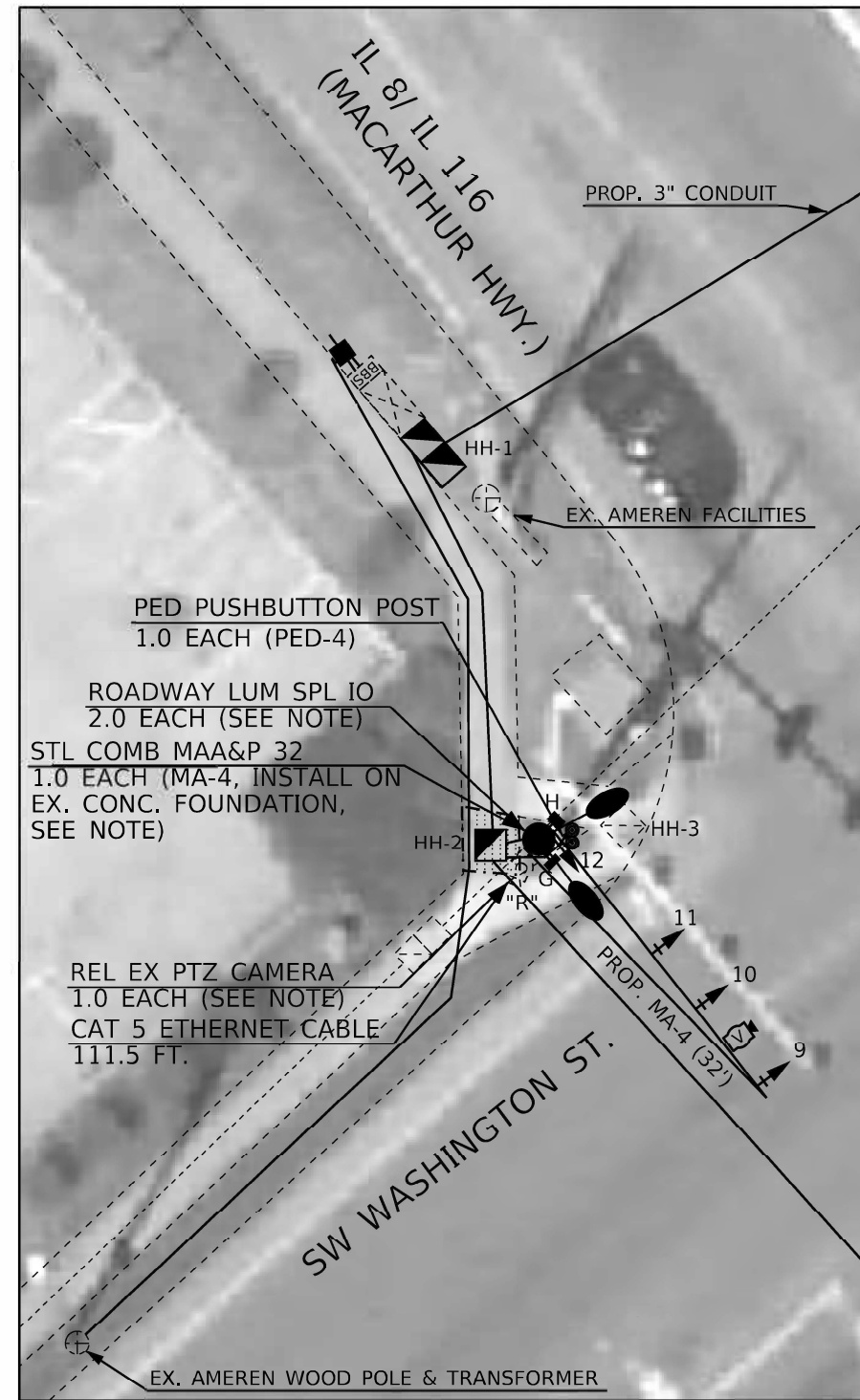
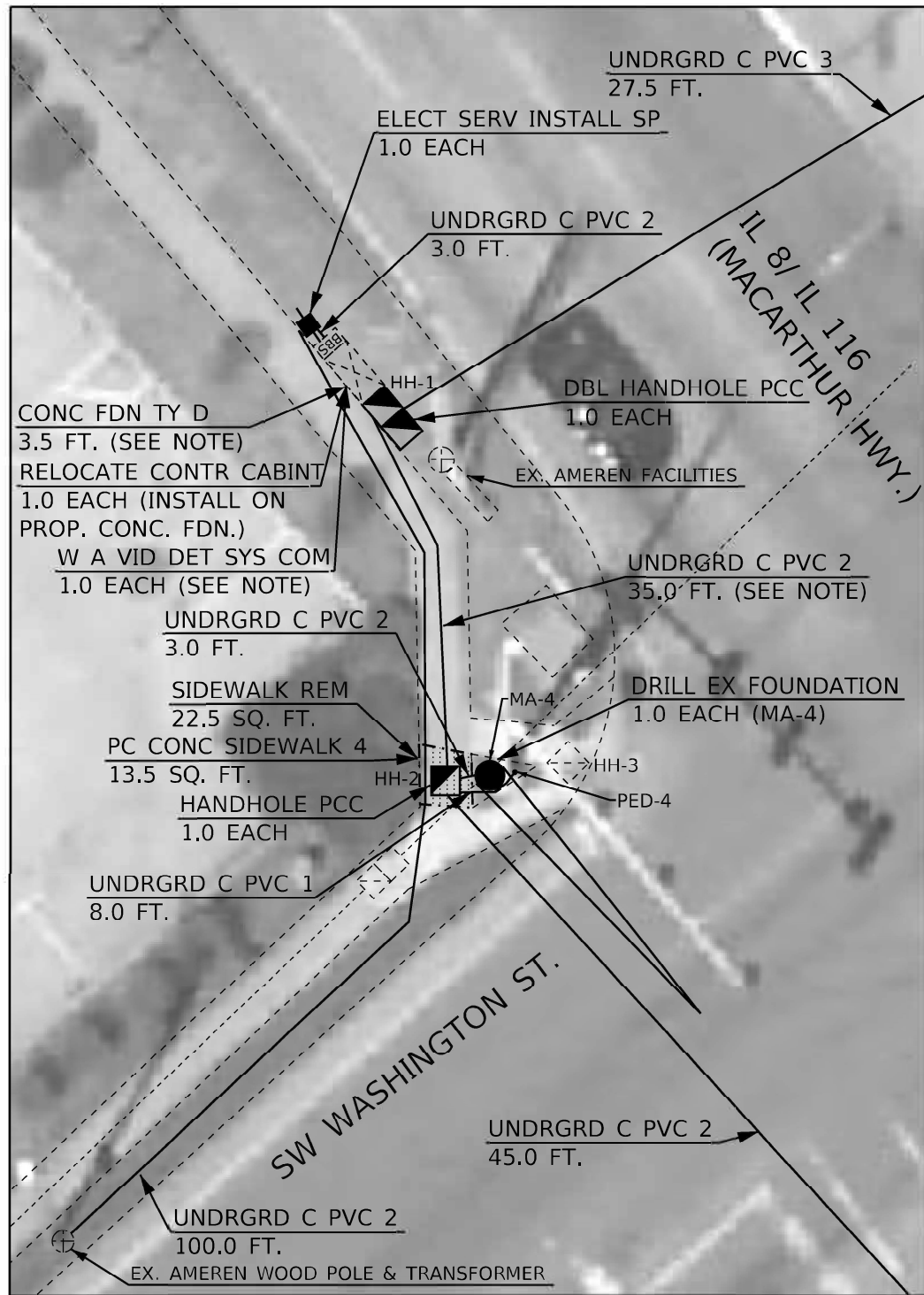

"R" INDICATES RELOCATED ITEM

BILL OF MATERIALS		
IL 8/IL 116 (MACARTHUR) & WASHINGTON NW QUADRANT		
ITEM DESCRIPTION	UNIT	QTY.
PORTLAND CEMENT CONCRETE SIDEWALK 4 INCH	SQ FT	13.5
SIDEWALK REMOVAL	SQ FT	22.5
SIGN PANEL - TYPE 1	SQ FT	5.0
SIGN PANEL - TYPE 2	SQ FT	19.8
UNDERGROUND CONDUIT, PVC, 1" DIA.	FOOT	8.0
UNDERGROUND CONDUIT, PVC, 2" DIA.	FOOT	186.0
UNDERGROUND CONDUIT, PVC, 3" DIA.	FOOT	27.5
HANDHOLE, PORTLAND CEMENT CONCRETE	EACH	1.0
DOUBLE HANDHOLE, PORTLAND CEMENT CONCRETE	EACH	1.0
ELECTRIC CABLE IN CONDUIT, 600V (XLP-TYPE USE) 1/C NO. 10	FOOT	133.0
ELECTRIC CABLE IN CONDUIT, 600V (XLP-TYPE USE) 1/C NO. 6	FOOT	212.0
ELECTRIC CABLE IN CONDUIT, SIGNAL NO. 14 5C	FOOT	265.5
ELECTRIC CABLE IN CONDUIT, SIGNAL NO. 14 7C	FOOT	191.0
ELECTRIC CABLE IN CONDUIT, EQUIPMENT GROUNDING CONDUCTOR, NO. 6 1C	FOOT	258.5
STEEL COMBINATION MAST ARM ASSEMBLY AND POLE 32 FT.	EACH	1.0
CONCRETE FOUNDATION, TYPE D	FOOT	3.5
DRILL EXISTING FOUNDATION	EACH	1.0
SIGNAL HEAD, POLYCARBONATE, LED, 1-FACE, 3-SECTION, MAST ARM MOUNTED	EACH	2.0
SIGNAL HEAD, POLYCARBONATE, LED, 1-FACE, 4-SECTION, BRACKET MOUNTED	EACH	1.0
SIGNAL HEAD, POLYCARBONATE, LED, 1-FACE, 4-SECTION, MAST ARM MOUNTED	EACH	1.0
PEDESTRIAN SIGNAL HEAD, POLYCARBONATE, LED, 2-FACE, BRACKET MOUNTED	EACH	1.0
TRAFFIC SIGNAL BACKPLATE, RETROREFLECTIVE	EACH	4.0
WIDE AREA VIDEO DETECTION SYSTEM COMPLETE	EACH	1.0
CAT 5 ETHERNET CABLE	FOOT	111.5
ROADWAY LUMINAIRE, SPECIAL (INSTALL ONLY)	EACH	2.0
RELOCATE EXISTING PTZ CAMERA	EACH	1.0
ACCESSIBLE PEDESTRIAN SIGNALS	EACH	2.0
PEDESTRIAN PUSH-BUTTON POST	EACH	1.0
ELECTRIC SERVICE INSTALLATION, SPECIAL	EACH	1.0
RELOCATE CONTROLLER CABINET	EACH	1.0

NOTES:

1. THE CONTROLLER CABINET SHALL BE RELOCATED ALONG THE EXISTING SIDEWALK, WITH THE DOOR FACING THE SIDEWALK. THIS PLACEMENT WILL NOT REQUIRE THE CONTRACTOR TO INSTALL A STAND PAD.
2. THE CONTRACTOR MAY SUBSTITUTE THE 2" CONDUIT BETWEEN THE DOUBLE HANDHOLE (HH-1) AND THE HANDHOLE (HH-2) WITH TWO 1.5" CONDUITS, IF DESIRED, AT NO ADDITIONAL COST TO THE DEPARTMENT.
3. THE CONTRACTOR SHALL REMOVE THE EXISTING CCTV CAMERA, HARDWARE, ETC. FROM THE EXISTING MAST ARM (MA-4) AND REINSTALL IT ON THE PROPOSED MAST ARM (MA-4). THIS WORK SHALL BE INCLUDED IN THE BID PRICE OF THE PAY ITEM "RELOCATE EXISTING PTZ CAMERA."
4. THE CONTRACTOR SHALL PICK UP FOUR ROADWAY LUMINAIRES FROM THE CITY OF PEORIA PUBLIC WORKS DEPARTMENT AT 3505 N. DRIES LN, PEORIA, IL 61604 AND INSTALL TWO ON MA-4 AS SHOWN IN THE PLANS. THE LUMINAIRES SHALL BE INSTALLED 90 DEGREES APART. THE CONTRACTOR SHALL FURNISH AND INSTALL NEW POLE WIRING, SURGE ARRESTORS, FUSE HOLDERS, AND FUSES. THIS WORK SHALL BE INCLUDED IN THE BID PRICE FOR THE ROADWAY LUMINAIRES, SPECIAL (INSTALL ONLY.)
5. THE CONTRACTOR SHALL FURNISH AND INSTALL EITHER A FOUR CAMERA OR ONE CAMERA VIDEO DETECTION SYSTEM PER THE PROJECT SPECIAL PROVISION, "WIDE AREA VIDEO DETECTION SYSTEM COMPLETE."
6. FOR A FOUR CAMERA VIDEO DETECTION SYSTEM, THE PROPOSED VIDEO DETECTION CAMERAS ARE TO BE INSTALLED ON THE MAST ARMS AS SHOWN IN THE PLANS ON 5 FT. BRACKETS, CENTERED OVER THE APPROACH. THIS WORK WILL BE INCLUDED IN THE COST OF THE PAY ITEM "WIDE AREA VIDEO DETECTION SYSTEM COMPLETE."
7. FOR A ONE CAMERA VIDEO DETECTION SYSTEM, THE PROPOSED VIDEO DETECTION CAMERA IS TO BE INSTALLED ON THE MA-4 STRAIN POLE. THIS WORK WILL BE INCLUDED IN THE COST OF THE PAY ITEM "WIDE AREA VIDEO DETECTION SYSTEM COMPLETE."
8. THE PROPOSED MAST ARM MA-4 SHALL BE INSTALLED ON THE EXISTING CONCRETE FOUNDATION. THE CONTRACTOR SHALL VERIFY THE CONDITION OF THE FOUNDATION AND THE ANCHOR BOLT SIZE, PATTERN, AND CONDITION PRIOR TO ORDERING THE PROPOSED MA-4. THE CONTRACTOR SHALL VERIFY THAT THE PROPOSED MA-4 IS COMPATIBLE WITH THE EXISTING ANCHOR BOLT PATTERN.

NOT TO SCALE

MODEL: Default  
FILE NAME: S:\CEN\HW\04\03\03\Completed\Contract123-03\Letting\_68H56\Map\_Arm\_MacArthurFiles\68H56\_Revisions\_04-11-23.dgn

USER NAME = trevor.hanson	DESIGNED -	REVISED - TJH 04-11-23
	DRAWN -	REVISED -
PLOT SCALE = 23.8272' / in.	CHECKED -	REVISED -
PLOT DATE = 4/11/2023	DATE -	REVISED -

STATE OF ILLINOIS  
DEPARTMENT OF TRANSPORTATION

PROPOSED TRAFFIC SIGNAL IMPROVEMENTS NW QUADRANT  
IL 8/IL 116 (MACARTHUR HWY.) & SW WASHINGTON ST. - PEORIA

SCALE: SHEET OF SHEETS STA. TO STA.

F.A.P. RTE.	SECTION	COUNTY	TOTAL SHEETS	SHEET NO.
669	D4 MAST ARM REPLACEMENT 2023-1	PEORIA	19	10
ILLINOIS FED. AID PROJECT			CONTRACT NO. 68H56	

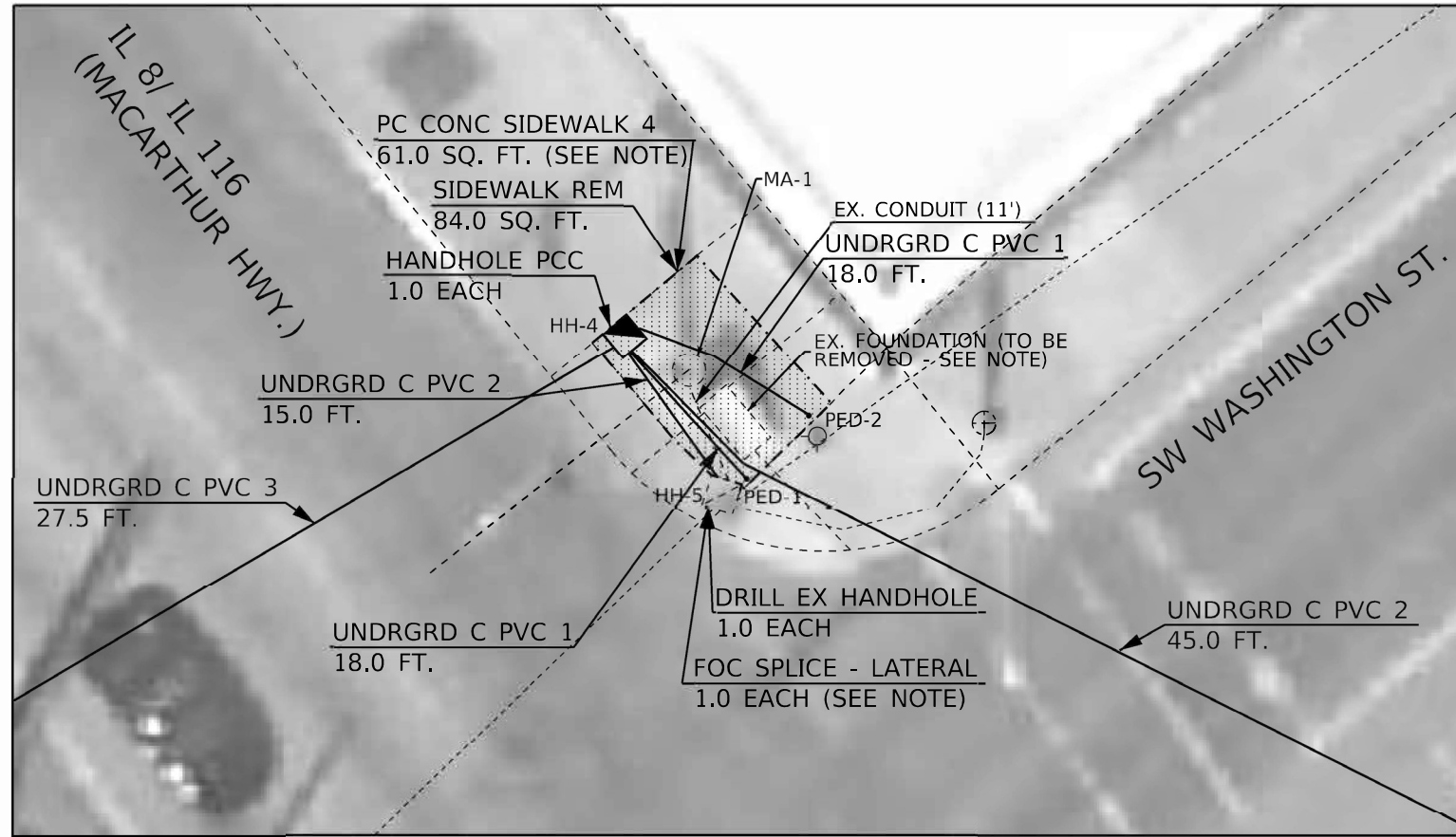

BILL OF MATERIALS		
IL 8/IL 116 (MACARTHUR) & WASHINGTON NE QUADRANT		
ITEM DESCRIPTION	UNIT	QTY.
PORTLAND CEMENT CONCRETE SIDEWALK 4 INCH	SQ FT	61.0
SIDEWALK REMOVAL	SQ FT	84.0
SIGN PANEL - TYPE 2	SQ FT	18.4
UNDERGROUND CONDUIT, PVC, 1" DIA.	FOOT	36.0
UNDERGROUND CONDUIT, PVC, 2" DIA.	FOOT	60.0
UNDERGROUND CONDUIT, PVC, 3" DIA.	FOOT	27.5
HANDHOLE, PORTLAND CEMENT CONCRETE	EACH	1.0
ELECTRIC CABLE IN CONDUIT, SIGNAL NO. 14 3C	FOOT	209.0
ELECTRIC CABLE IN CONDUIT, SIGNAL NO. 14 5C	FOOT	255.0
ELECTRIC CABLE IN CONDUIT, SIGNAL NO. 14 7C	FOOT	215.0
ELECTRIC CABLE IN CONDUIT, EQUIPMENT GROUNDING CONDUCTOR, NO. 6 1C	FOOT	113.5
DRILL EXISTING HANDHOLE	EACH	1.0
SIGNAL HEAD, POLYCARBONATE, LED, 1-FACE, 3-SECTION, BRACKET MOUNTED	EACH	1.0
SIGNAL HEAD, POLYCARBONATE, LED, 1-FACE, 3-SECTION, MAST ARM MOUNTED	EACH	1.0
SIGNAL HEAD, POLYCARBONATE, LED, 1-FACE, 4-SECTION, BRACKET MOUNTED	EACH	1.0
SIGNAL HEAD, POLYCARBONATE, LED, 1-FACE, 4-SECTION, MAST ARM MOUNTED	EACH	1.0
PEDESTRIAN SIGNAL HEAD, POLYCARBONATE, LED, 2-FACE, BRACKET MOUNTED	EACH	1.0
TRAFFIC SIGNAL BACKPLATE, RETROREFLECTIVE	EACH	4.0
FIBER OPTIC CABLE SPLICE - LATERAL	EACH	1.0
ACCESSIBLE PEDESTRIAN SIGNALS	EACH	2.0
PEDESTRIAN PUSH-BUTTON POST	EACH	2.0

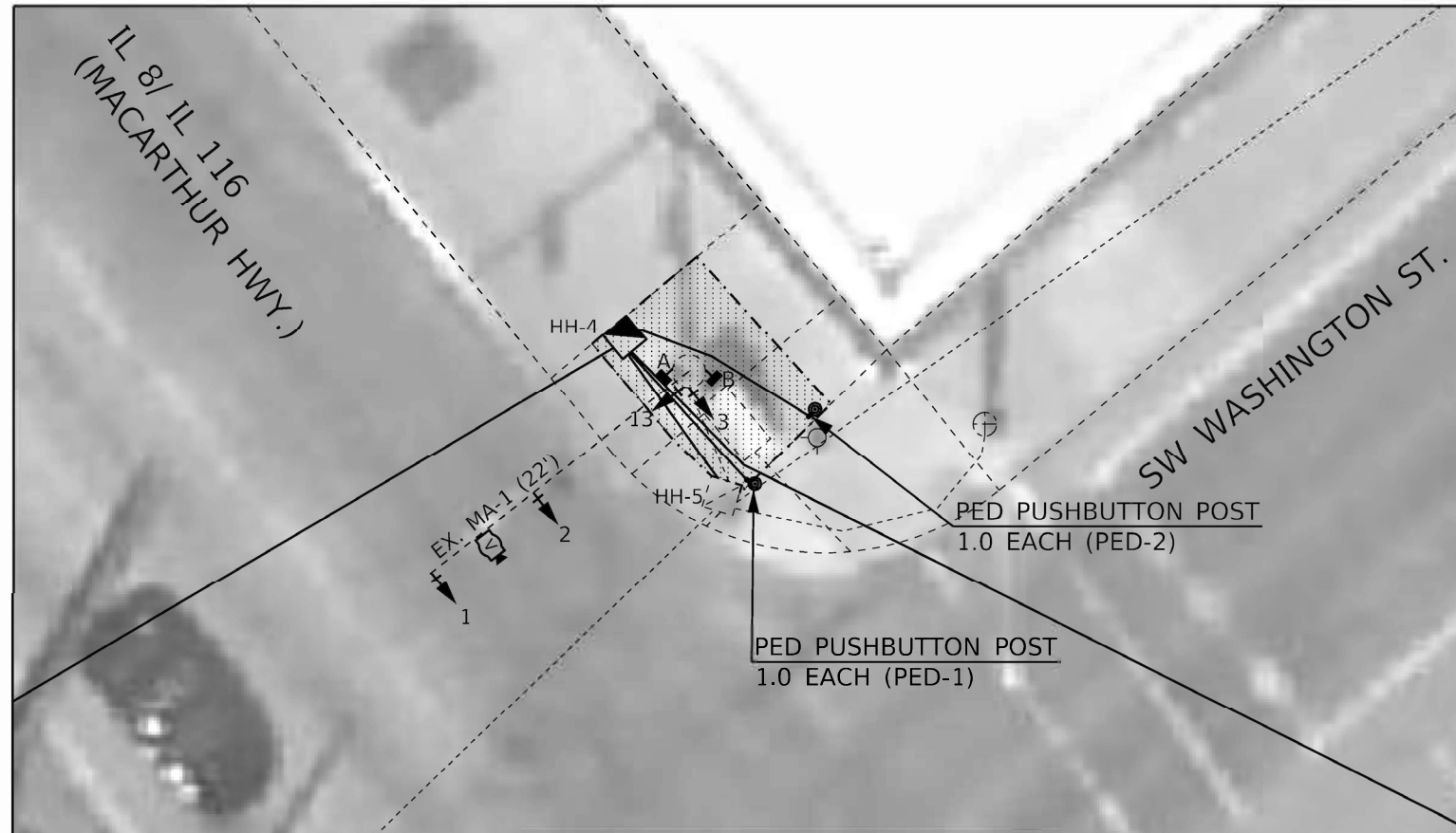

NOTES:

1. THE CONTRACTOR SHALL INSTALL THE PROPOSED SIDEWALK AROUND THE BASE OF MA-1 TO MATCH THE EXISTING SIDEWALK INSTALLATION. THIS WORK SHALL BE INCLUDED IN THE BID PRICE FOR THE "PORTLAND CEMENT CONCRETE SIDEWALK 4 INCH."
2. THE CONTRACTOR SHALL REMOVE THE EXISTING TRAFFIC SIGNAL CONTROLLER FOUNDATION TO MATCH THE GRADE OF THE PROPOSED SIDEWALK. THE CONTRACTOR SHALL FILL ALL EXISTING CONDUIT ENTRY POINTS WITH EPOXY. THIS WORK WILL NOT BE PAID FOR SEPARATELY, BUT SHALL BE INCLUDED IN THE BID PRICE OF THE "REMOVE EXISTING CONCRETE FOUNDATION."
3. THE CONTRACTOR SHALL FURNISH AND INSTALL FIBER OPTIC CABLE WITH A MINIMUM OF 12 SINGLE MODE FIBERS FROM THE RELOCATED TRAFFIC SIGNAL CABINET TO PROP. HANDHOLE (HH-5.) THE CONTRACTOR SHALL FURNISH AND INSTALL THE SPLICE ENCLOSURE AND ALL OTHER ITEMS REQUIRED TO SPLICE THE PROPOSED AND EXISTING FIBERS IN THE HANDHOLE. THIS WORK WILL NOT BE PAID FOR SEPARATELY, BUT SHALL BE INCLUDED IN THE BID PRICE FOR THE "FIBER OPTIC CABLE SPLICE - LATERAL."
4. FIBER OPTIC CABLE FOR LATERAL SPLICING SHALL INCLUDE A MINIMUM OF 12 SINGLE MODE AND 12 MULTIMODE FIBERS. THE CONTRACTOR MAY FURNISH FIBER WITH GREATER STRAND COUNTS AT NO ADDITIONAL COST TO THE DEPARTMENT.

NOT TO SCALE

MODEL: Default  
FILE NAME: S:\CEN\HWY\03\DESIGN\Akhanson\# Completed Contract\123-03 Letting\_68H56 Mast Arm\_MacArthurFiles\68H56\_Revision: (04-11-23).dgn

USER NAME = trevor.hanson	DESIGNED -	REVISED - TJH 04-11-23
	DRAWN -	REVISED -
PLOT SCALE = 23.8272' / in.	CHECKED -	REVISED -
PLOT DATE = 4/11/2023	DATE -	REVISED -

STATE OF ILLINOIS  
DEPARTMENT OF TRANSPORTATION

PROPOSED TRAFFIC SIGNAL IMPROVEMENTS NE QUADRANT  
IL 8/IL 116 (MACARTHUR HWY.) & SW WASHINGTON ST. - PEORIA

SCALE: SHEET OF SHEETS STA. TO STA.

F.A.P. RTE.	SECTION	COUNTY	TOTAL SHEETS	SHEET NO.
669	D4 MAST ARM REPLACEMENT 2023-1	PEORIA	19	11
ILLINOIS FED. AID PROJECT			CONTRACT NO. 68H56	

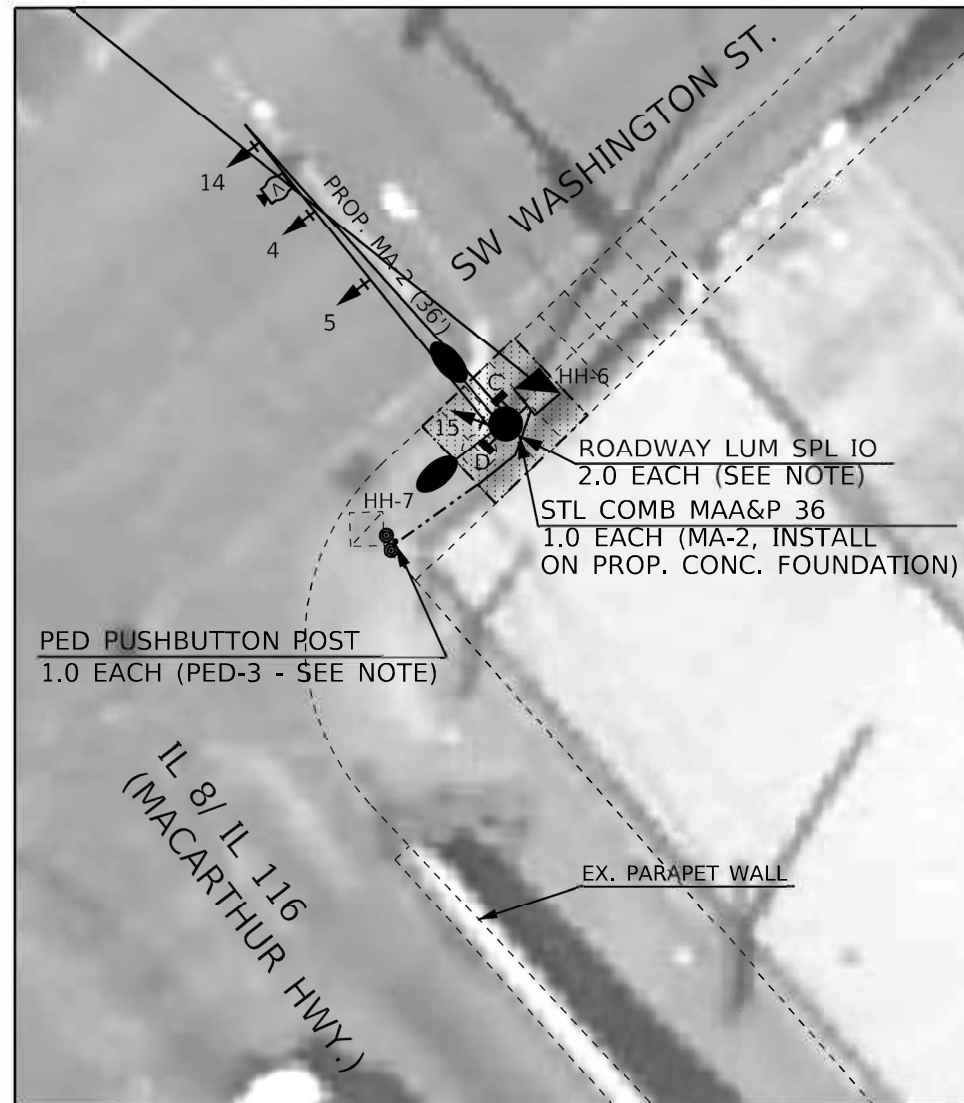
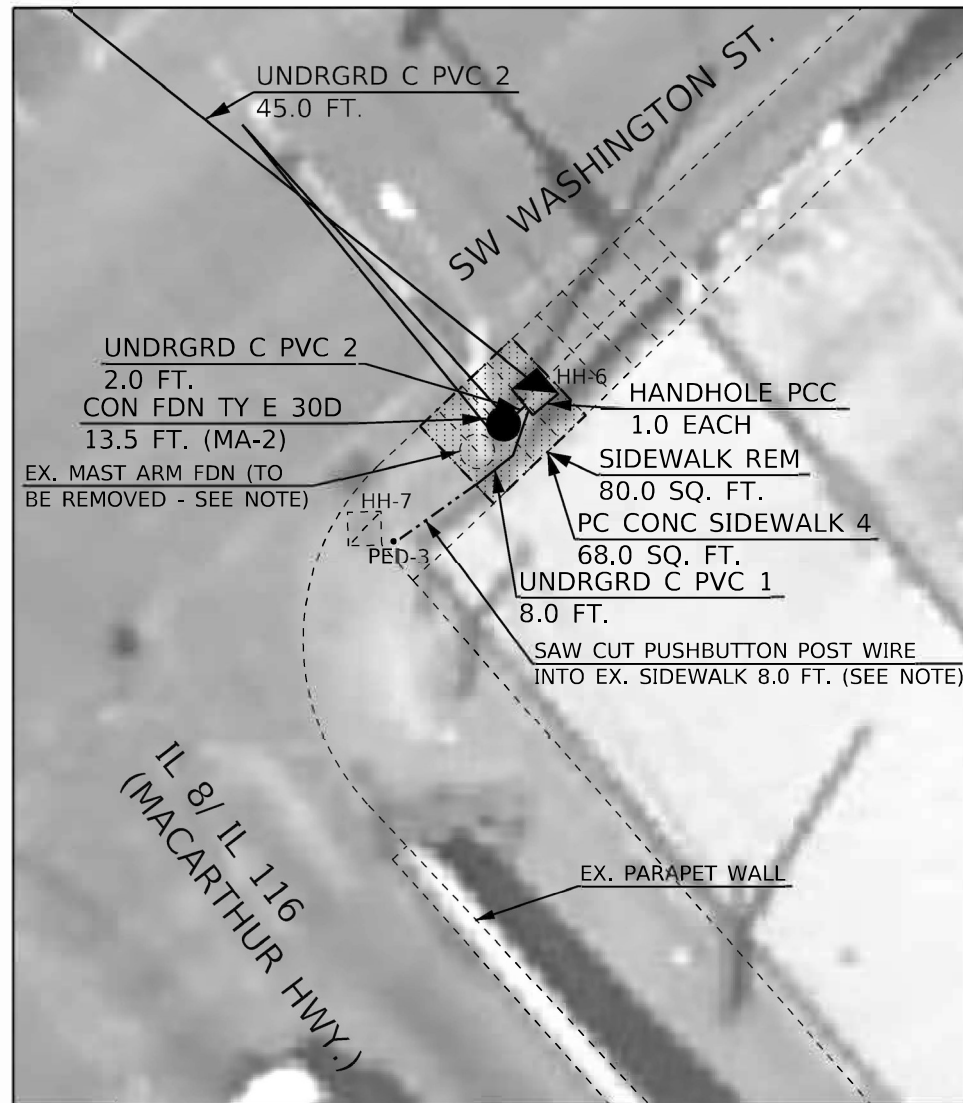

BILL OF MATERIALS		
IL 8/IL 116 (MACARTHUR) & WASHINGTON SE QUADRANT		
ITEM DESCRIPTION	UNIT	QTY.
PORTLAND CEMENT CONCRETE SIDEWALK 4 INCH	SQ FT	68.0
SIDEWALK REMOVAL	SQ FT	80.0
SIGN PANEL - TYPE 1	SQ FT	5.0
SIGN PANEL - TYPE 2	SQ FT	19.8
UNDERGROUND CONDUIT, PVC, 1" DIA.	FOOT	8.0
UNDERGROUND CONDUIT, PVC, 2" DIA.	FOOT	47.0
HANDHOLE, PORTLAND CEMENT CONCRETE	EACH	1.0
ELECTRIC CABLE IN CONDUIT, 600V (XLP-TYPE USE) 1/C NO. 10	FOOT	370.0
ELECTRIC CABLE IN CONDUIT, SIGNAL NO. 14 5C	FOOT	631.0
ELECTRIC CABLE IN CONDUIT, SIGNAL NO. 14 7C	FOOT	432.0
ELECTRIC CABLE IN CONDUIT, EQUIPMENT GROUNDING CONDUCTOR, NO. 6 1C	FOOT	63.0
STEEL COMBINATION MAST ARM ASSEMBLY AND POLE 36 FT.	EACH	1.0
CONCRETE FOUNDATION, TYPE E 30-INCH DIAMETER	FOOT	13.5
SIGNAL HEAD, POLYCARBONATE, LED, 1-FACE, 3-SECTION, MAST ARM MOUNTED	EACH	2.0
SIGNAL HEAD, POLYCARBONATE, LED, 1-FACE, 4-SECTION, BRACKET MOUNTED	EACH	1.0
SIGNAL HEAD, POLYCARBONATE, LED, 1-FACE, 4-SECTION, MAST ARM MOUNTED	EACH	1.0
PEDESTRIAN SIGNAL HEAD, POLYCARBONATE, LED, 2-FACE, BRACKET MOUNTED	EACH	1.0
TRAFFIC SIGNAL BACKPLATE, RETROREFLECTIVE	EACH	4.0
ROADWAY LUMINAIRE, SPECIAL (INSTALL ONLY)	EACH	2.0
ACCESSIBLE PEDESTRIAN SIGNALS	EACH	2.0
PEDESTRIAN PUSH-BUTTON POST	EACH	1.0

**NOTES:**

1. THE CONTRACTOR SHALL INSTALL PROPOSED 1" PVC CONDUIT BETWEEN HH-6 AND THE EDGE OF THE PROPOSED SIDEWALK.
2. THE PUSHBUTTON POST WIRES SHALL BE SAW CUT INTO THE EXISTING SIDEWALK AND TO PED-4. THE CONTRACTOR SHALL SEAL THE SAW CUT CHANNEL AND THE ENTRANCE TO THE 1" CONDUIT WITH EPOXY. THIS WORK WILL NOT BE PAID FOR SEPARATELY, BUT SHALL BE INCLUDED IN THE BID PRICE OF THE 5/C SIGNAL CABLE.
3. THE CONTRACTOR SHALL REMOVE THE EXISTING MA-2 FOUNDATION TO MATCH THE GRADE OF THE PROPOSED SIDEWALK. THE CONTRACTOR SHALL FILL ALL EXISTING CONDUIT ENTRY POINTS WITH EPOXY. THIS WORK WILL NOT BE PAID FOR SEPARATELY, BUT SHALL BE INCLUDED IN THE BID PRICE OF THE "REMOVE EXISTING CONCRETE FOUNDATION."
4. THE CONTRACTOR SHALL INSTALL THE PROPOSED PEDESTRIAN PUSHBUTTON POST (PED-3) BY DRILLING AND INSTALLING ANCHOR BOLTS WITH EPOXY INTO THE EXISTING SIDEWALK. THIS WORK SHALL BE INCLUDED IN THE BID PRICE OF THE PEDESTRIAN PUSHBUTTON POST.
5. THE CONTRACTOR SHALL PICK UP FOUR ROADWAY LUMINAIRES FROM THE CITY OF PEORIA PUBLIC WORKS DEPARTMENT AT 3505 N. DRIES LN. PEORIA, IL 61604 AND INSTALL TWO ON MA-2 AS SHOWN IN THE PLANS. THE LUMINAIRES SHALL BE INSTALLED 90 DEGREES APART. THE CONTRACTOR SHALL FURNISH AND INSTALL NEW POLE WIRING, SURGE ARRESTORS, FUSE HOLDERS, AND FUSES. THIS WORK SHALL BE INCLUDED IN THE BID PRICE FOR THE ROADWAY LUMINAIRES, SPECIAL (INSTALL ONLY.)
6. THE CONTRACTOR MAY FURNISH SMALLER DIAMETER CONDUIT FOR PED-4 TO FACILITATE INSTALLATION BY SAWCUTTING THE CONDUIT AND WIRE INTO THE SIDEWALK.

NOT TO SCALE

MODEL: Default  
FILE NAME: S:\CEN\WV\03\DESIGN\Ahhanson\#\_Completed\_Contract\123-03\_Letting\_68H56\_Mast\_Arm\_MacArthurFiles\68H56\_Revision\04-11-23.dgn

USER NAME = trevor.hanson	DESIGNED -	REVISED - TJH 04-11-23
	DRAWN -	REVISED -
PLOT SCALE = 23.8272' / in.	CHECKED -	REVISED -
PLOT DATE = 4/11/2023	DATE -	REVISED -

**STATE OF ILLINOIS  
DEPARTMENT OF TRANSPORTATION**

**PROPOSED TRAFFIC SIGNAL IMPROVEMENTS SE QUADRANT  
IL 8/IL 116 (MACARTHUR HWY.) & SW WASHINGTON ST. - PEORIA**

SCALE: SHEET OF SHEETS STA. TO STA.

F.A.P. RTE.	SECTION	COUNTY	TOTAL SHEETS	SHEET NO.
669	D4 MAST ARM REPLACEMENT 2023-1	PEORIA	19	12A
			CONTRACT NO. 68H56	
ILLINOIS FED. AID PROJECT				

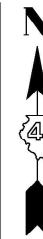
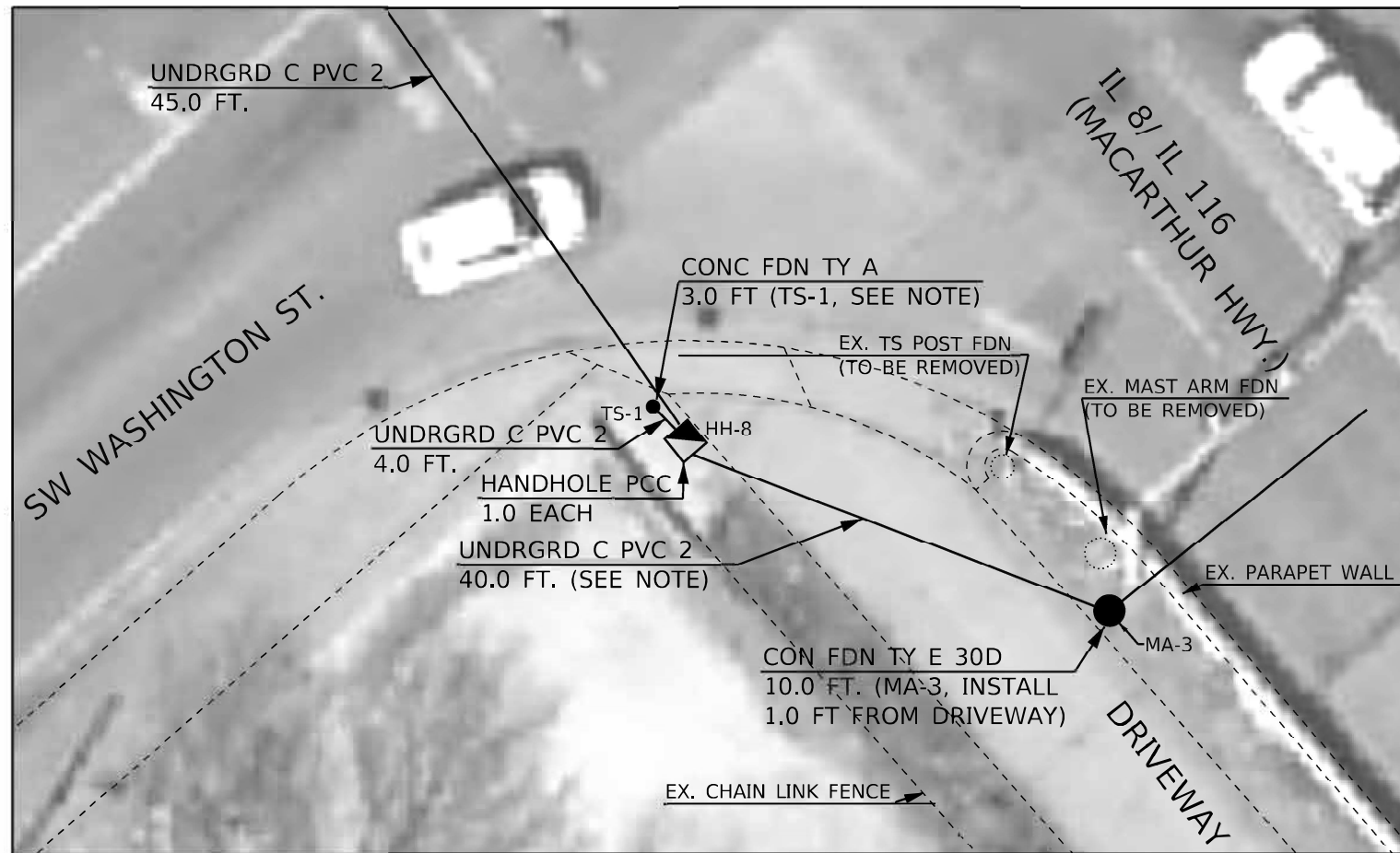

BILL OF MATERIALS		
IL 8/IL 116 (MACARTHUR) & WASHINGTON SW QUADRANT		
ITEM DESCRIPTION	UNIT	QTY.
SIGN PANEL - TYPE 2	SQ FT	18.4
UNDERGROUND CONDUIT, PVC, 2" DIA.	FOOT	89.0
HANDHOLE, PORTLAND CEMENT CONCRETE	EACH	1.0
ELECTRIC CABLE IN CONDUIT, SIGNAL NO. 14 5C	FOOT	422.0
ELECTRIC CABLE IN CONDUIT, SIGNAL NO. 14 7C	FOOT	354.0
ELECTRIC CABLE IN CONDUIT, EQUIPMENT GROUNDING CONDUCTOR, NO. 6 1C	FOOT	114.5
TRAFFIC SIGNAL POST, GALVANIZED STEEL 16 FT.	EACH	1.0
STEEL MAST ARM ASSEMBLY AND POLE, 24 FT.	EACH	1.0
CONCRETE FOUNDATION, TYPE A	FOOT	3.0
CONCRETE FOUNDATION, TYPE E 30-INCH DIAMETER	FOOT	10.0

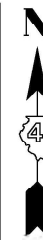
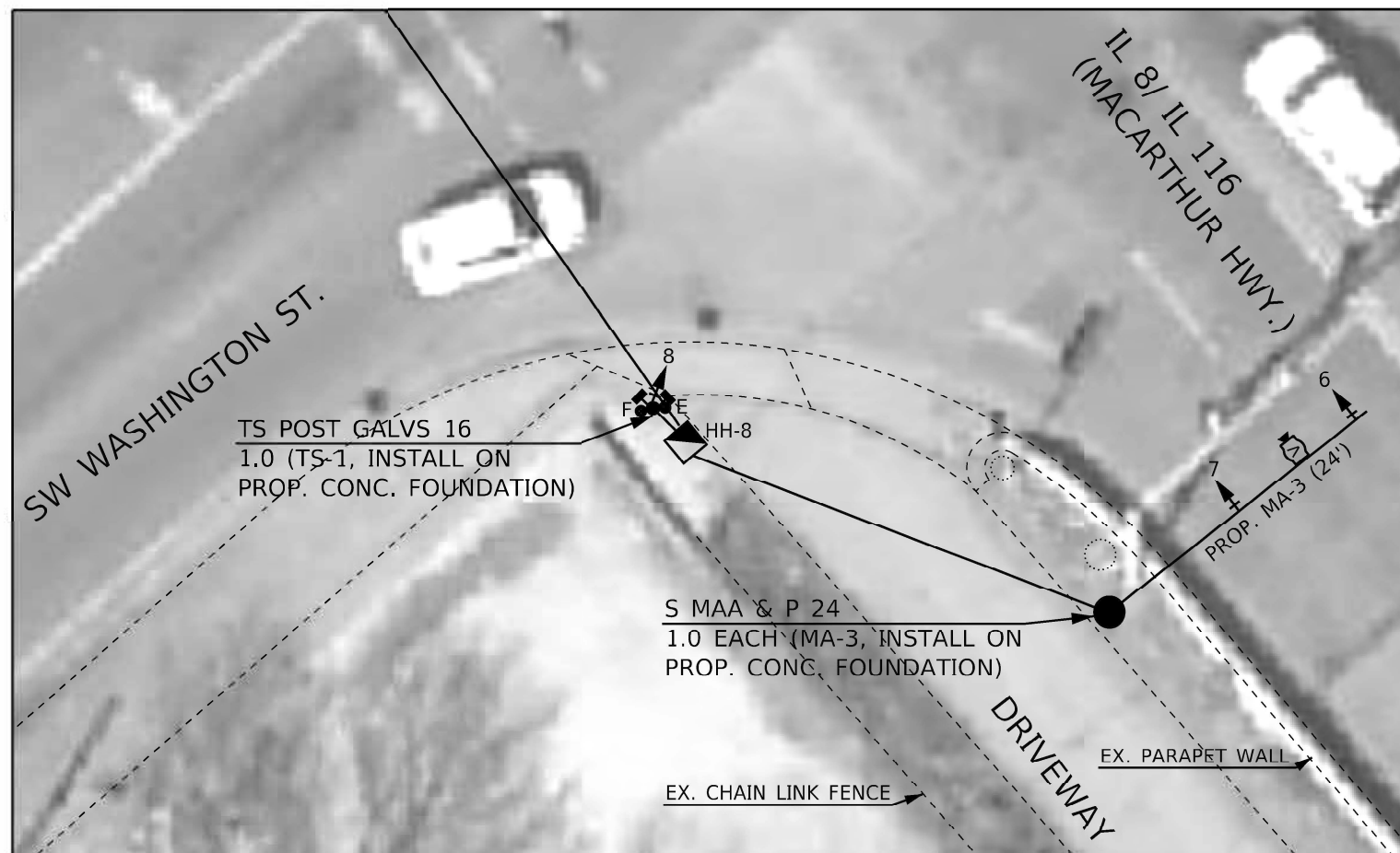

NOTES:

- FOR THE PROPOSED 2" PVC CONDUIT BETWEEN HH-8 AND MA-3, THE CONTRACTOR CAN EITHER DIRECTIONALLY BORE UNDER THE DRIVEWAY OR SAW CUT THE DRIVEWAY PAVEMENT AND COVER THE CONDUIT WITH EPOXY. THIS WORK WILL NOT BE PAID FOR SEPARATELY, BUT SHALL BE INCLUDED IN THE BID PRICE OF THE 2" PVC CONDUIT.
- THE PROPOSED CONCRETE FOUNDATION FOR TS-1 SHALL BE LOCATED IN THE GRASS AREA BETWEEN THE ROW LINE AND THE EXISTING ALLEY. THE CONTRACTOR SHALL CLEAR AND REMOVE ANY BRUSH OR LANDSCAPING TO ACCOMMODATE THE INSTALLATION. THIS WORK WILL NOT BE PAID FOR SEPARATELY, BUT SHALL BE INCLUDED IN THE COST OF THE CONCRETE FOUNDATION.

NOT TO SCALE

MODEL: Default  
FILE NAME: S:\CEN\HWY\03\DESIGN\A\Hanson\#\_Completed\_Contract\123-03\_Let\119\_68H56\_Mast\_Arm\_MacArthurFiles\68H56\_Revisions\_04-11-23.dgn

USER NAME = trevor.hanson	DESIGNED -	REVISED - TJH 04-11-23
PLOT SCALE = 23.8272' / in.	DRAWN -	REVISED -
PLOT DATE = 4/11/2023	CHECKED -	REVISED -
	DATE -	REVISED -

STATE OF ILLINOIS  
DEPARTMENT OF TRANSPORTATION

PROPOSED TRAFFIC SIGNAL IMPROVEMENTS SW QUADRANT  
IL 8/IL 116 (MACARTHUR HWY.) & SW WASHINGTON ST. - PEORIA

SCALE: SHEET OF SHEETS STA. TO STA.

F.A.P. RTE.	SECTION	COUNTY	TOTAL SHEETS	SHEET NO.
669	D4 MAST ARM REPLACEMENT 2023-1	PEORIA	19	12B
			CONTRACT NO. 68H56	
ILLINOIS FED. AID PROJECT				

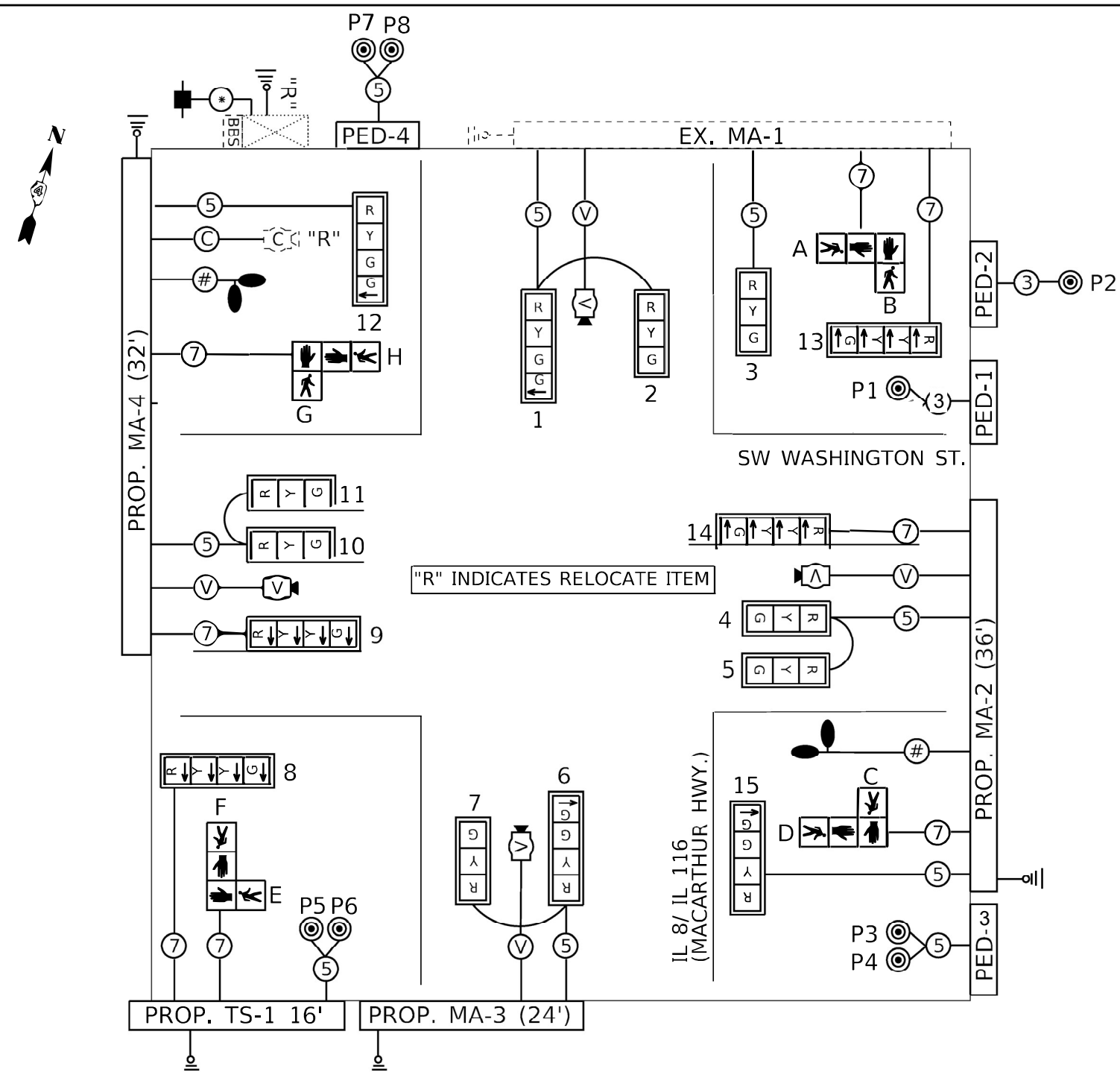

TRAFFIC SIGNALS LEGEND

- |  |   |  |   |  |                               |
|--|---|--|---|--|-------------------------------|
|  | EX. TRAFFIC SIGNAL CONTROLLER CABINET (TO BE RELOCATED) |  | EX. 3 SEC. SIGNAL HEAD WITH BACKPLATE                   |  | PROP. 5/C NO. 14 SIGNAL CABLE |
|  | PROP. ELECTRIC SERVICE INSTALLATION, SPECIAL            |  | EX. 3 SEC. SIGNAL HEAD WITHOUT BACKPLATE                |  | PROP. 7/C NO. 14 SIGNAL CABLE |
|  | EX. GROUND/SAFETY BOND                                  |  | PROP. 3 SEC. SIGNAL HEAD WITH RETROREFLECTIVE BACKPLATE |  | PROP. 1/C NO. 6 CABLE X 2     |
|  | PROP. GROUND/SAFETY BOND                                |  | PROP. PEDESTRIAN SIGNAL HEAD                            |  | PROP. CAT 5 ETHERNET CABLE    |
|  | EX. ROADWAY LUMINAIRE                                   |  | PROP. PEDESTRIAN PUSHBUTTON (APS)                       |  | PROP. VIDEO DETECTION CABLE   |
|  | EX. CCTV CAMERA   |  |   |  |                               |
|  | PROP. VIDEO VEHICLE DETECTOR                            |  |   |  |                               |

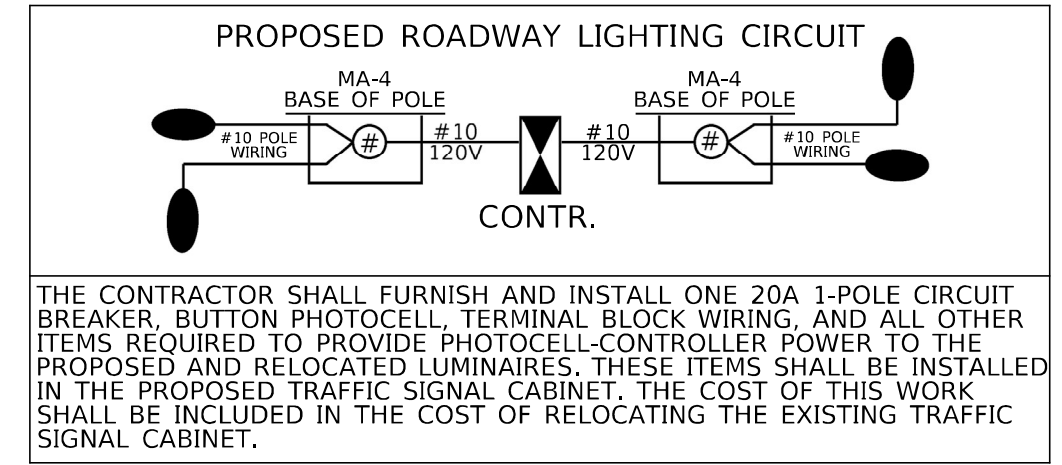
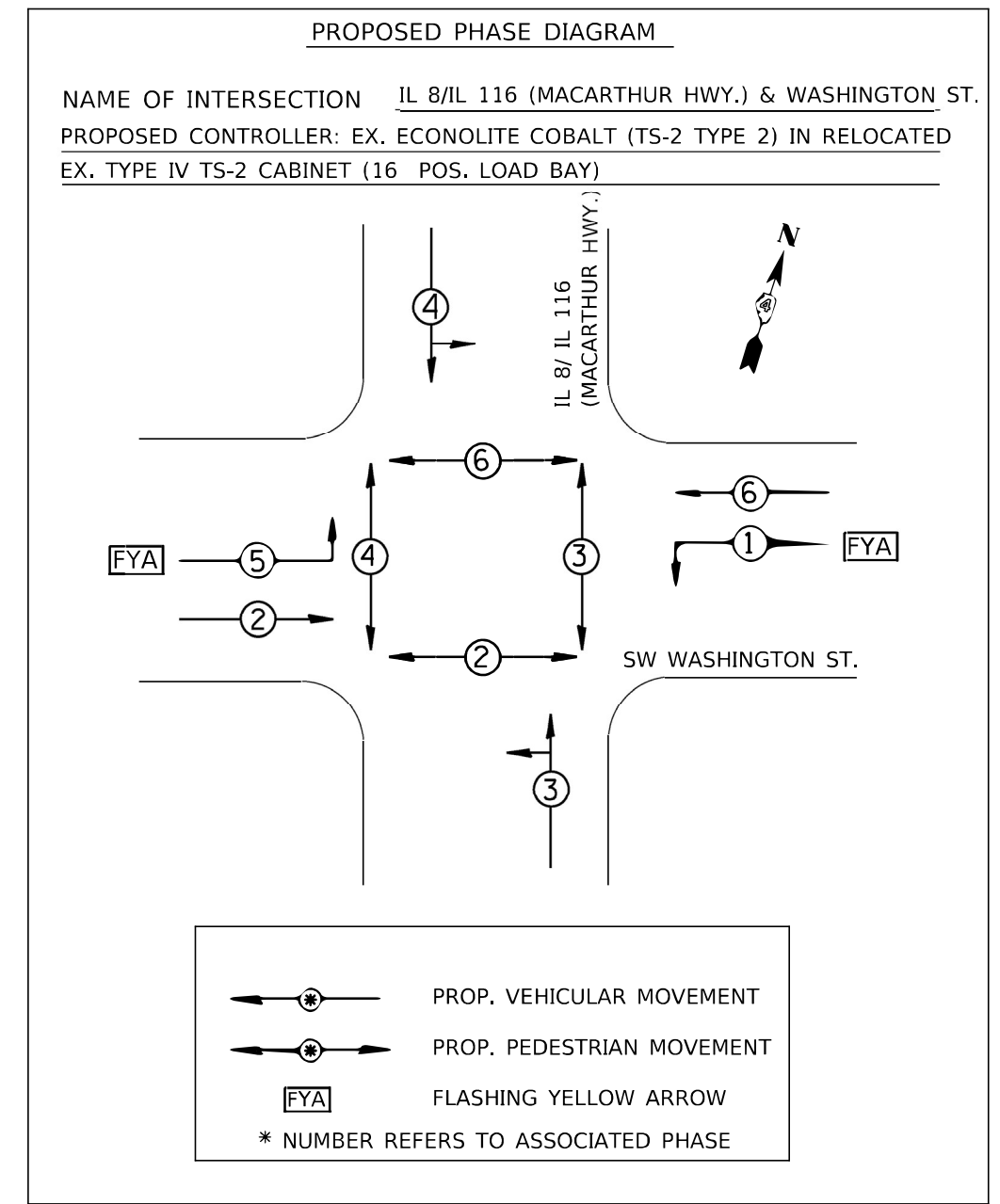

THE CONTRACTOR SHALL FURNISH AND INSTALL ONE 20A 1-POLE CIRCUIT BREAKER, BUTTON PHOTOCCELL, TERMINAL BLOCK WIRING, AND ALL OTHER ITEMS REQUIRED TO PROVIDE PHOTOCCELL-CONTROLLER POWER TO THE PROPOSED AND RELOCATED LUMINAIRES. THESE ITEMS SHALL BE INSTALLED IN THE PROPOSED TRAFFIC SIGNAL CABINET. THE COST OF THIS WORK SHALL BE INCLUDED IN THE COST OF RELOCATING THE EXISTING TRAFFIC SIGNAL CABINET.

NOT TO SCALE

MODEL: Default  
FILE NAME: S:\GEN\W\W08D\ESP\AN\hanson\# Completed Contract\12-203 Letting\_68H56 Main Arm\_MacArthurFiles\68H56 Revisions\_04-11-23.dgn

USER NAME = trevor.hanson	DESIGNED -	REVISED - TJH 04-11-23
PLOT SCALE = 23.8272" / in.	DRAWN -	REVISED -
PLOT DATE = 4/11/2023	CHECKED -	REVISED -
	DATE -	REVISED -

STATE OF ILLINOIS  
DEPARTMENT OF TRANSPORTATION

PROPOSED CIRCUIT AND PHASE DIAGRAMS  
IL 8/IL 116 (MACARTHUR HWY.) & SW WASHINGTON ST. - PEORIA

F.A.P. RTE. 669	SECTION D4 MAST ARM REPLACEMENT 2023-1	COUNTY PEORIA	TOTAL SHEETS 19	SHEET NO. 13
SCALE: SHEET OF SHEETS STA. TO STA.			CONTRACT NO. 68H56	
ILLINOIS FED. AID PROJECT				

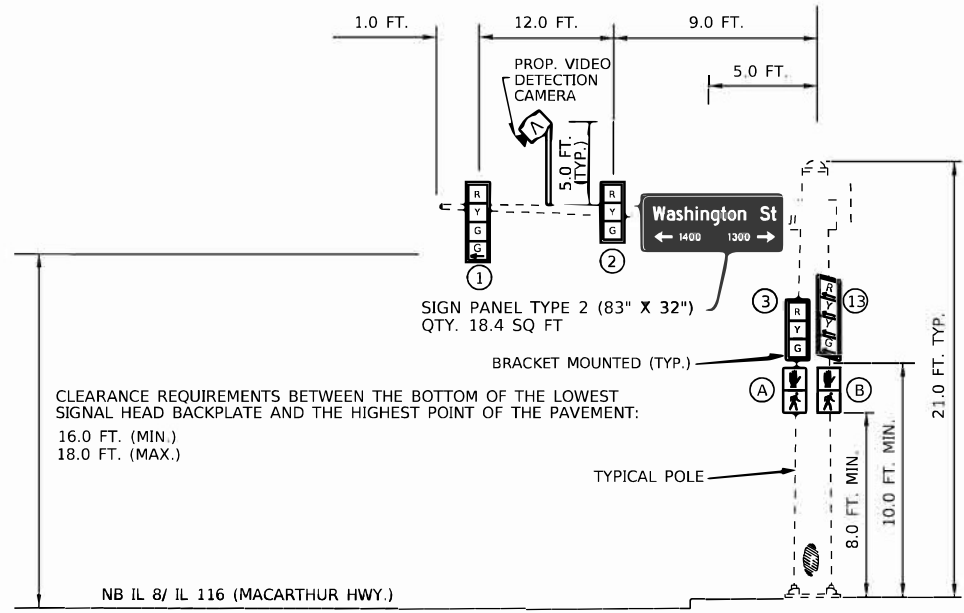

NORTHBOUND TRAFFIC SIGNAL  
NORTHEAST QUADRANT  
EX. MA-1 (22')

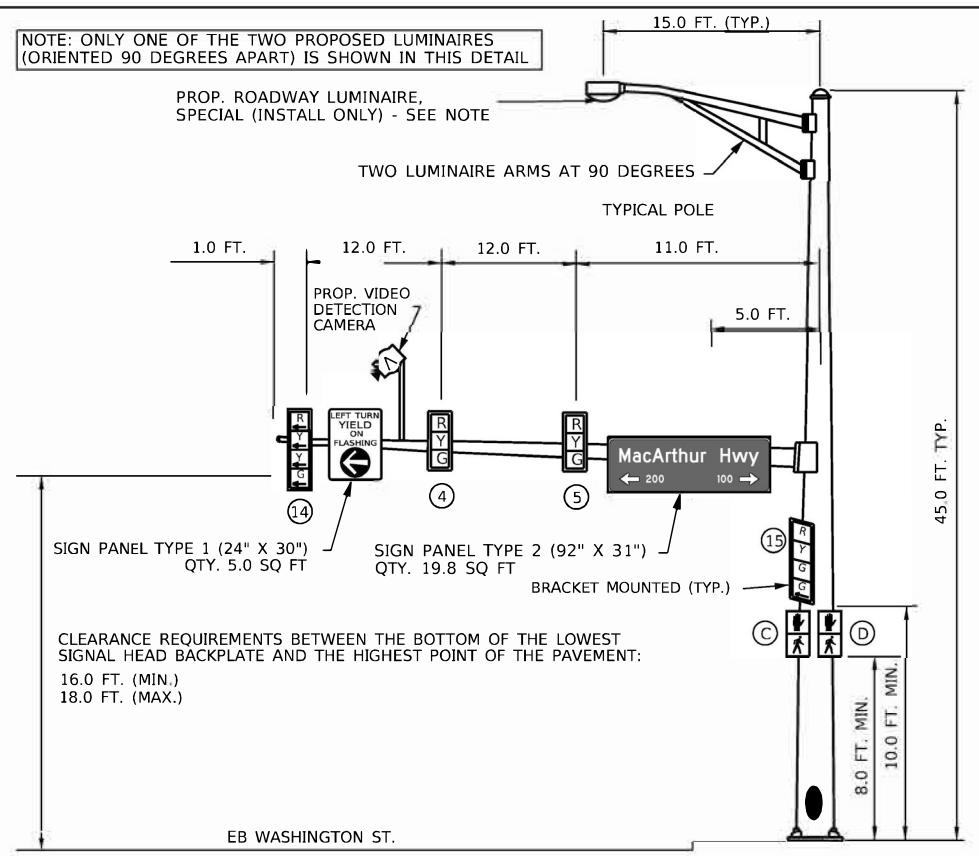

EASTBOUND TRAFFIC SIGNAL  
SOUTHEAST QUADRANT  
PROP. MA-2 (36')

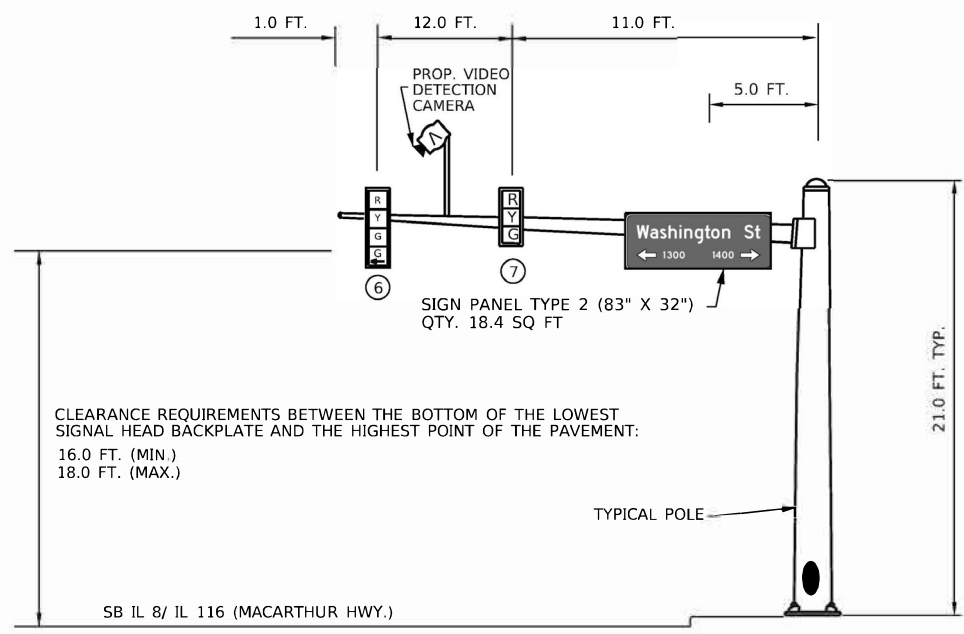

SOUTHBOUND TRAFFIC SIGNAL  
SOUTHWEST QUADRANT  
PROP. MA-3 (24')

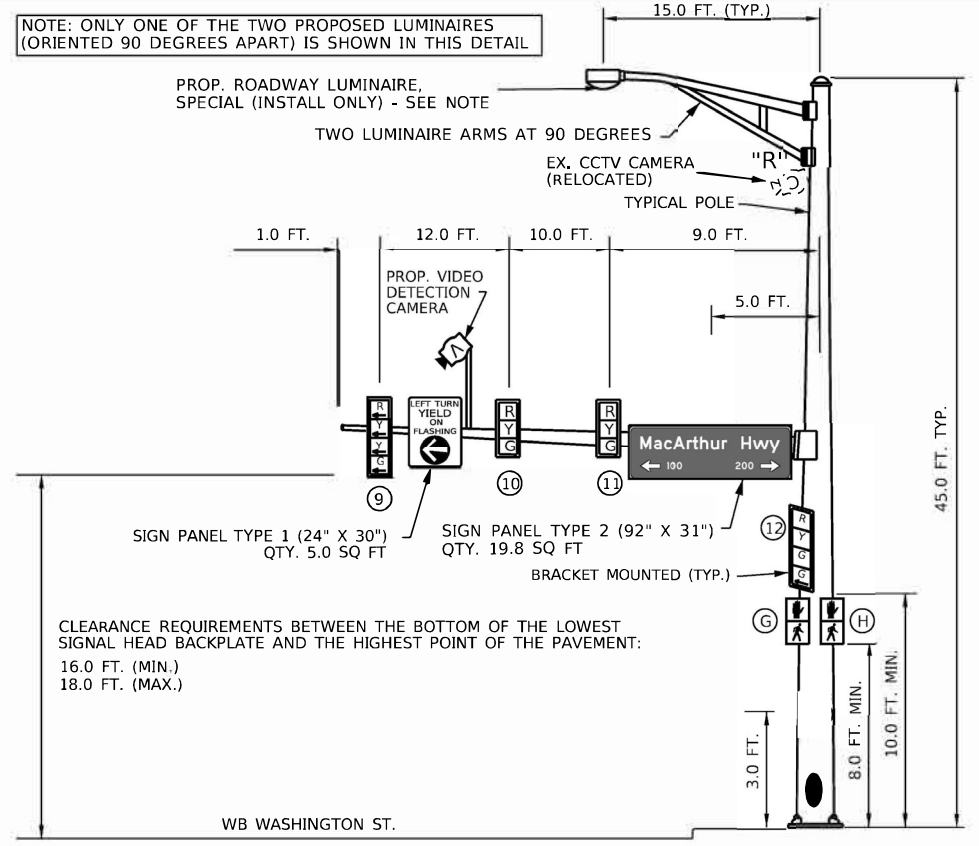

EASTBOUND TRAFFIC SIGNAL  
SOUTHEAST QUADRANT  
PROP. MA-4 (32')  
(INSTALLED ON EX. FOUNDATION)  
SEE NOTE

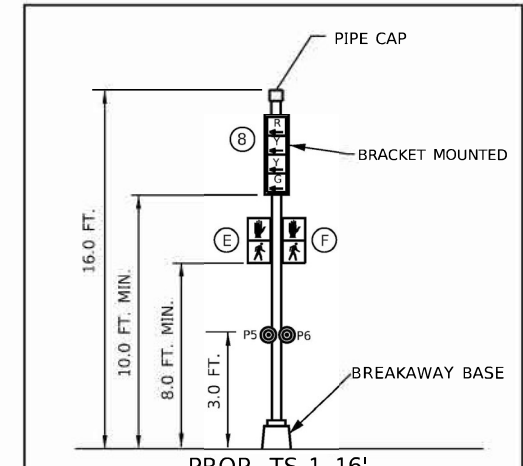

PROP. TS-1 16'  
WESTBOUND TRAFFIC SIGNAL  
SOUTHWEST QUADRANT

"R" INDICATES RELOCATE ITEM

- NOTES:
1. THE CONTRACTOR SHALL RELOCATE ALL OTHER EXISTING SIGNS FROM THE REMOVED MAST ARMS AND TRAFFIC SIGNAL POSTS TO THE PROPOSED MAST ARMS AND TRAFFIC SIGNAL POSTS. THIS WORK WILL NOT BE PAID FOR SEPARATELY BUT SHALL BE INCLUDED IN THE COST OF THE PROPOSED MAST ARMS AND TRAFFIC SIGNAL POSTS.
  2. THE CONTRACTOR SHALL INSPECT THE EXISTING ANCHOR BOLT PATTERN FOR MA-4 PRIOR TO ORDERING MATERIAL. THE CONTRACTOR SHALL VERIFY THAT THE PROPOSED MA-4 IS COMPATIBLE WITH THE EXISTING ANCHOR BOLT PATTERN.
  3. THE CONTRACTOR SHALL PICK UP FOUR ROADWAY LUMINAIRES FROM THE CITY OF PEORIA PUBLIC WORKS DEPARTMENT AT 3505 N. DRIES LN. PEORIA, IL 61604 AND INSTALL TWO ON MA-2 AND TWO ON MA-4 AS SHOWN IN THE PLANS.
  4. COMBINATION MAST ARMS SHALL BE EQUIPPED WITH DUAL 15 FT. LUMINAIRE ARMS. THE COST OF THIS WORK SHALL BE INCLUDED IN THE COST OF THE COMBINATION MAST ARMS.

NOTE: ONLY ONE OF THE TWO PROPOSED LUMINAIRES (ORIENTED 90 DEGREES APART) IS SHOWN IN THIS DETAIL

NOTE: ONLY ONE OF THE TWO PROPOSED LUMINAIRES (ORIENTED 90 DEGREES APART) IS SHOWN IN THIS DETAIL

STATE OF ILLINOIS  
DEPARTMENT OF TRANSPORTATION

PROPOSED MAST ARM AND TRAFFIC SIGNAL POST DETAILS  
IL 8/IL 116 (MACARTHUR HWY.) & SW WASHINGTON ST. - PEORIA

F.A.P. RTE.	SECTION	COUNTY	TOTAL SHEETS	SHEET NO.
669	D4 MAST ARM REPLACEMENT 2023-1	PEORIA	19	14
CONTRACT NO. 68H56				
ILLINOIS FED. AID PROJECT				

NOT TO SCALE

MODEL: Default  
FILE NAME: S:\CEN\WORK\DESIGN\Akhanson\# Completed\Contract\123-03 Letting\_68H56 Mast Arm\_MacArthurFiles\68H56\_Revision: (04-11-23).dgn

USER NAME = trevor.hanson	DESIGNED -	REVISED - TJH 04-11-23
PLOT SCALE = 23.8272' / in.	DRAWN -	REVISED -
PLOT DATE = 4/11/2023	CHECKED -	REVISED -
	DATE -	REVISED -

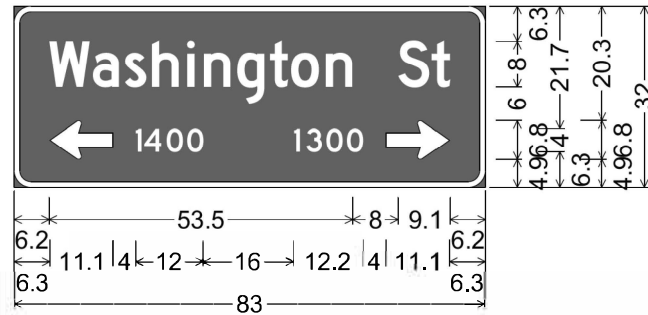

3.0" Radius, 1.0" Border, White on Green;  
 "Washington", D 2K; "St", D 2K;  
 Standard Arrow Custom 11.1" X 6.8" 180°;  
 "1400", D 2K; "1300", D 2K;  
 Standard Arrow Custom 11.1" X 6.8" 0°;  
 Table of distances between letter and object lefts

6.2	W	7.7	a	5.6	4.8	6.3	2.9	5.9	5.7	3.7	6.2	n
			S	12.7	t	5.9	3.2	6.2				
6.3	←	15.1	1	1.6	4	3.9	3.6	0	0			
			1	18.9	2.2	3.5	3.6	0	0	→	11.1	6.3

INSTALL ON EX. MA-1

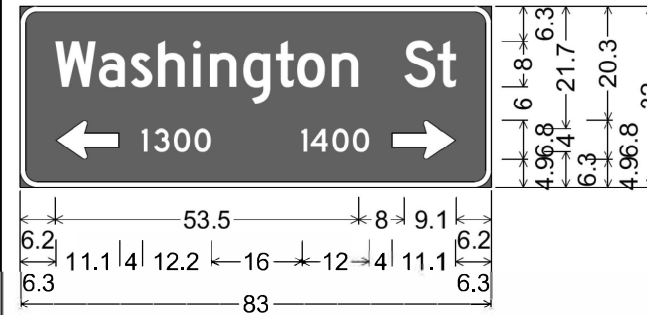

3.0" Radius, 1.0" Border, White on Green;  
 "Washington", D 2K; "St", D 2K;  
 Standard Arrow Custom 11.1" X 6.8" 180°;  
 "1300", D 2K; "1400", D 2K;  
 Standard Arrow Custom 11.1" X 6.8" 0°;  
 Table of distances between letter and object lefts

6.2	W	7.7	a	5.6	4.8	6.3	2.9	5.9	5.7	3.7	6.2	n
			S	12.7	t	5.9	3.2	6.2				
6.3	←	15.1	1	1.6	3	3.6	3.6	0	0			
			1	18.8	1.6	3.9	3.6	0	0	→	11.1	6.3

INSTALL ON PROP. MA-3

FLASHING YELLOW ARROW SIGN

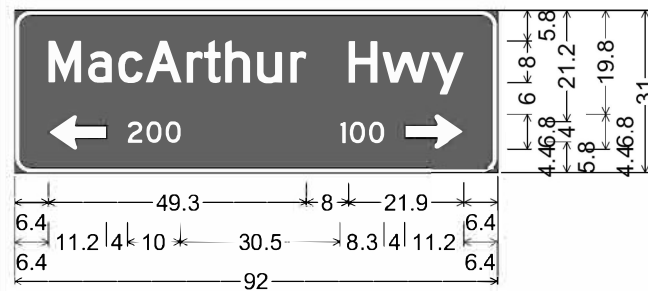
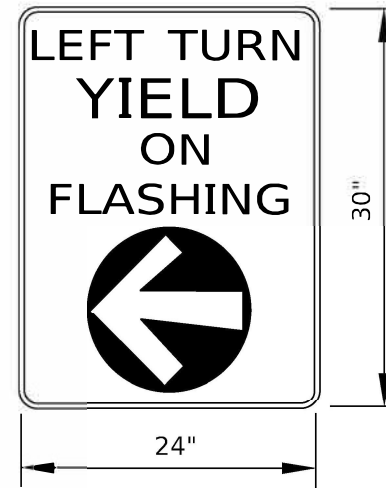

3.0" Radius, 1.0" Border, White on Green;  
 "MacArthur", D 2K; "Hwy", D 2K;  
 Standard Arrow Custom 11.1" X 6.8" 180°;  
 "200", D 2K; "100", D 2K;  
 Standard Arrow Custom 11.1" X 6.8" 0°;  
 Table of distances between letter and object lefts

6.4	M	7.6	a	5.8	5.2	7.8	3.3	4.1	6.1	6.3	r	
			H	11.1	w	6.5	9.4	6.0	6.4			
6.4	←	15.2	2	3.5	0	3.6	33.4	1.9	3.6	0	0	→
			0	15.2	3.5	3.6	33.4	1.9	3.6	6.8	11.2	6.4

INSTALL ON PROP. MA-2

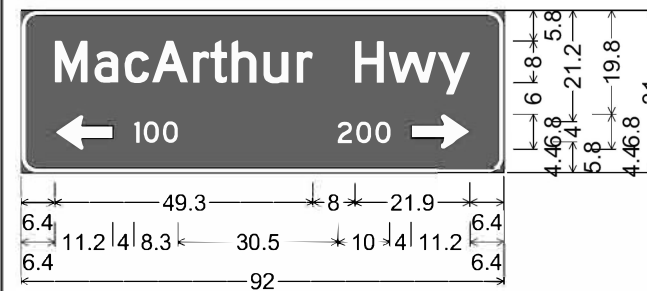

3.0" Radius, 1.0" Border, White on Green;  
 "MacArthur", D 2K; "Hwy", D 2K;  
 Standard Arrow Custom 11.1" X 6.8" 180°;  
 "100", D 2K; "200", D 2K;  
 Standard Arrow Custom 11.1" X 6.8" 0°;  
 Table of distances between letter and object lefts

6.4	M	7.6	a	5.8	5.2	7.8	3.3	4.1	6.1	6.3	r	
			H	11.1	w	6.5	9.4	6.0	6.4			
6.4	←	15.2	1	1.9	0	3.6	33.3	3.6	3.6	0	0	→
			0	15.2	1.9	3.6	33.3	3.6	3.6	6.8	11.2	6.4

INSTALL ON PROP. MA-4

MODEL: Default  
 FILE NAME: S:\GEN\HWY\04\25\Akhanson\#\_Completed\_Contract123-03\_Letting\_68H56\_Mast\_Arm\_MacArthurFiles\68H56\_Revisions\_04-11-23.dgn

USER NAME = trevor.hanson	DESIGNED -	REVISED - TJH 04-11-23
PLOT SCALE = 23.8272' / in.	DRAWN -	REVISED -
PLOT DATE = 4/11/2023	CHECKED -	REVISED -
	DATE -	REVISED -

STATE OF ILLINOIS  
 DEPARTMENT OF TRANSPORTATION

PROPOSED SIGN PANEL TYPE II DETAIL

SCALE: SHEET OF SHEETS STA. TO STA.

F.A.P. RTE.	SECTION	COUNTY	TOTAL SHEETS	SHEET NO.
669	D4 MAST ARM REPLACEMENT 2023-1	PEORIA	19	15
ILLINOIS FED. AID PROJECT			CONTRACT NO. 68H56	

NOT TO SCALE



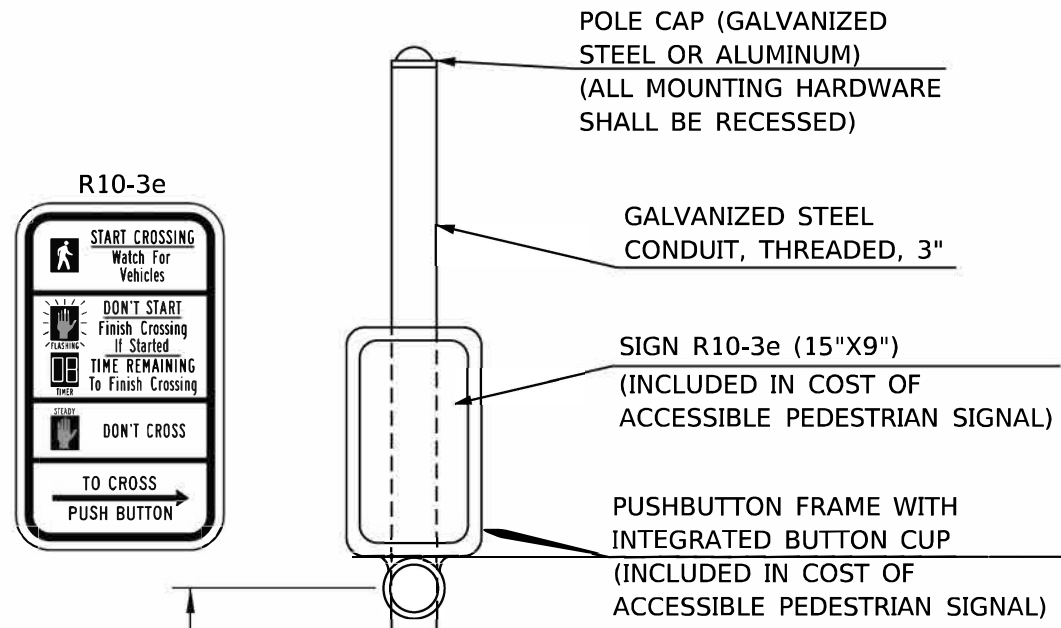

POLE CAP (GALVANIZED STEEL OR ALUMINUM) (ALL MOUNTING HARDWARE SHALL BE RECESSED)

GALVANIZED STEEL CONDUIT, THREADED, 3"

SIGN R10-3e (15"X9") (INCLUDED IN COST OF ACCESSIBLE PEDESTRIAN SIGNAL)

PUSHBUTTON FRAME WITH INTEGRATED BUTTON CUP (INCLUDED IN COST OF ACCESSIBLE PEDESTRIAN SIGNAL)

- NOTES:
1. PEDESTRIAN PUSHBUTTONS SHALL BE LOCATED IN ACCORDANCE WITH THE 2009 MUTCD. THE COST TO MODIFY OR RELOCATE ANY PUSHBUTTONS THAT WERE NOT INSTALLED ACCORDING TO MUTCD REQUIREMENTS AND CONTRACT SPECIFICATIONS WILL BE THE RESPONSIBILITY OF THE CONTRACTOR. FOR ALL INSTALLATIONS, THE REACH RANGE (DISTANCE BETWEEN THE FACE OF PEDESTRIAN PUSHBUTTON AND THE CLEAR SPACE) SHALL NOT EXCEED 10 INCHES.
  2. PEDESTRIAN PUSHBUTTON SIGN (R10-3E) SHALL BE CONSTRUCTED USING DIAMOND GRADE (TYPE XI) REFLECTIVE SHEETING.
  3. THE PEDESTRIAN PUSHBUTTON POSTS DETAILED ON THIS SHEET SHALL BE PAID FOR AS "PEDESTRIAN PUSH-BUTTON POST."
  4. FOR LOCATIONS WITH TWO PEDESTRIAN PUSHBUTTONS ON A SINGLE TRAFFIC SIGNAL POST OR PEDESTRIAN PUSHBUTTON POST, THE CONTRACTOR SHALL FURNISH AND INSTALL A SINGLE MOUNTING BRACKET THAT HOUSES BOTH PEDESTRIAN PUSHBUTTON FRAMES, WITH INTEGRATED CUPS, AT A 90 DEGREE ANGLE FROM EACH OTHER. THE COST OF THIS WORK WILL NOT BE PAID FOR SEPARATELY, BUT SHALL BE INCLUDED IN THE BID PRICE FOR THE PAY ITEM ACCESSIBLE PEDESTRIAN SIGNALS.

THESE REQUIREMENTS APPLY TO ALL PEDESTRIAN PUSHBUTTON INSTALLATIONS, INCLUDING PEDESTRIAN PUSHBUTTON POSTS, TRAFFIC SIGNAL POSTS, AND MAST ARM STRAIN POLE INSTALLATIONS.

THREADED PIPE FLANGE, 7.5" DIA. GALVANIZED STEEL (CLASS 150)

LEVELING NUT, GALVANIZED STEEL X 4 - TO ALLOW WATER EGRESS (MAX. 1/4" GAP BETWEEN FLANGE AND CONCRETE FOUNDATION)

5/8"X12" GALVANIZED STEEL ANCHOR BOLT X 4 (6" BOLT CIRCLE)

CONCRETE FOUNDATION, 12" DIA. X 30"

42" MAX.  
30" MIN.

TOP OF CURB/  
SIDEWALK/  
GRADE

PEDESTRIAN PUSHBUTTON POST

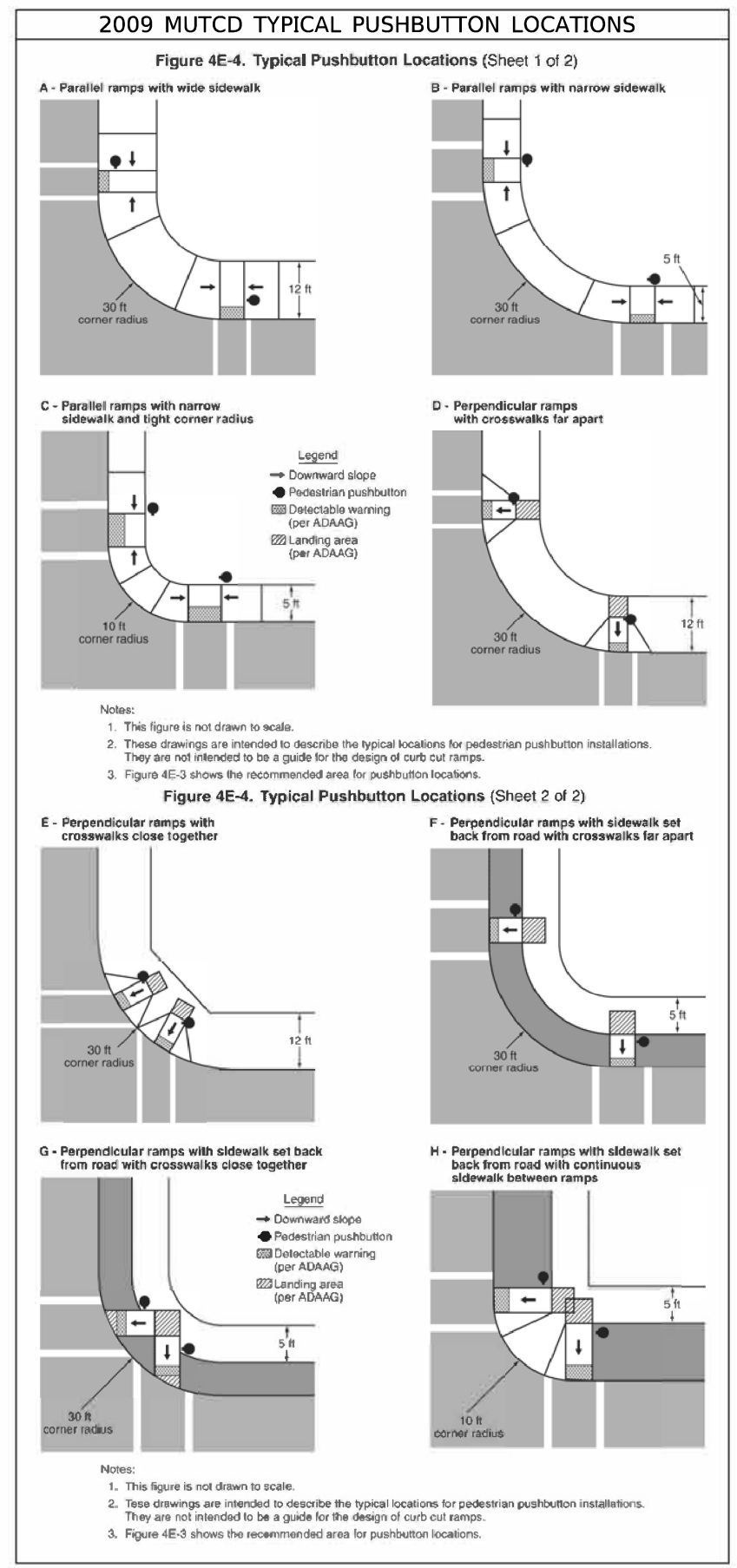

2009 MUTCD TYPICAL PUSHBUTTON LOCATIONS

Figure 4E-4. Typical Pushbutton Locations (Sheet 1 of 2)

- Notes:
1. This figure is not drawn to scale.
  2. These drawings are intended to describe the typical locations for pedestrian pushbutton installations. They are not intended to be a guide for the design of curb cut ramps.
  3. Figure 4E-3 shows the recommended area for pushbutton locations.

Figure 4E-4. Typical Pushbutton Locations (Sheet 2 of 2)

- Notes:
1. This figure is not drawn to scale.
  2. These drawings are intended to describe the typical locations for pedestrian pushbutton installations. They are not intended to be a guide for the design of curb cut ramps.
  3. Figure 4E-3 shows the recommended area for pushbutton locations.

NOT TO SCALE

MODEL: Default  
FILE NAME: S:\CEN\W\W02\DES\A\A\hanson\#\_Completed\_Contract123-03\_Letling\_68H56\_Mast\_Arm\_MacArthurFiles\68H56\_Revisions\_(04-11-23).dgn

USER NAME = trevor.hanson	DESIGNED -	REVISED - TJH 04-11-23
	DRAWN -	REVISED -
PLOT SCALE = 23.8272' / in.	CHECKED -	REVISED -
PLOT DATE = 4/11/2023	DATE -	REVISED -

STATE OF ILLINOIS  
DEPARTMENT OF TRANSPORTATION

PEDESTRIAN PUSHBUTTON POST DETAIL  
SCALE: SHEET OF SHEETS STA. TO STA.

F.A.P. RTE.	SECTION	COUNTY	TOTAL SHEETS	SHEET NO.
669	D4 MAST ARM REPLACEMENT 2023-1	PEORIA	19	16
ILLINOIS FED. AID PROJECT			CONTRACT NO. 68H56	

## ELECTRIC SERVICE INSTALLATION

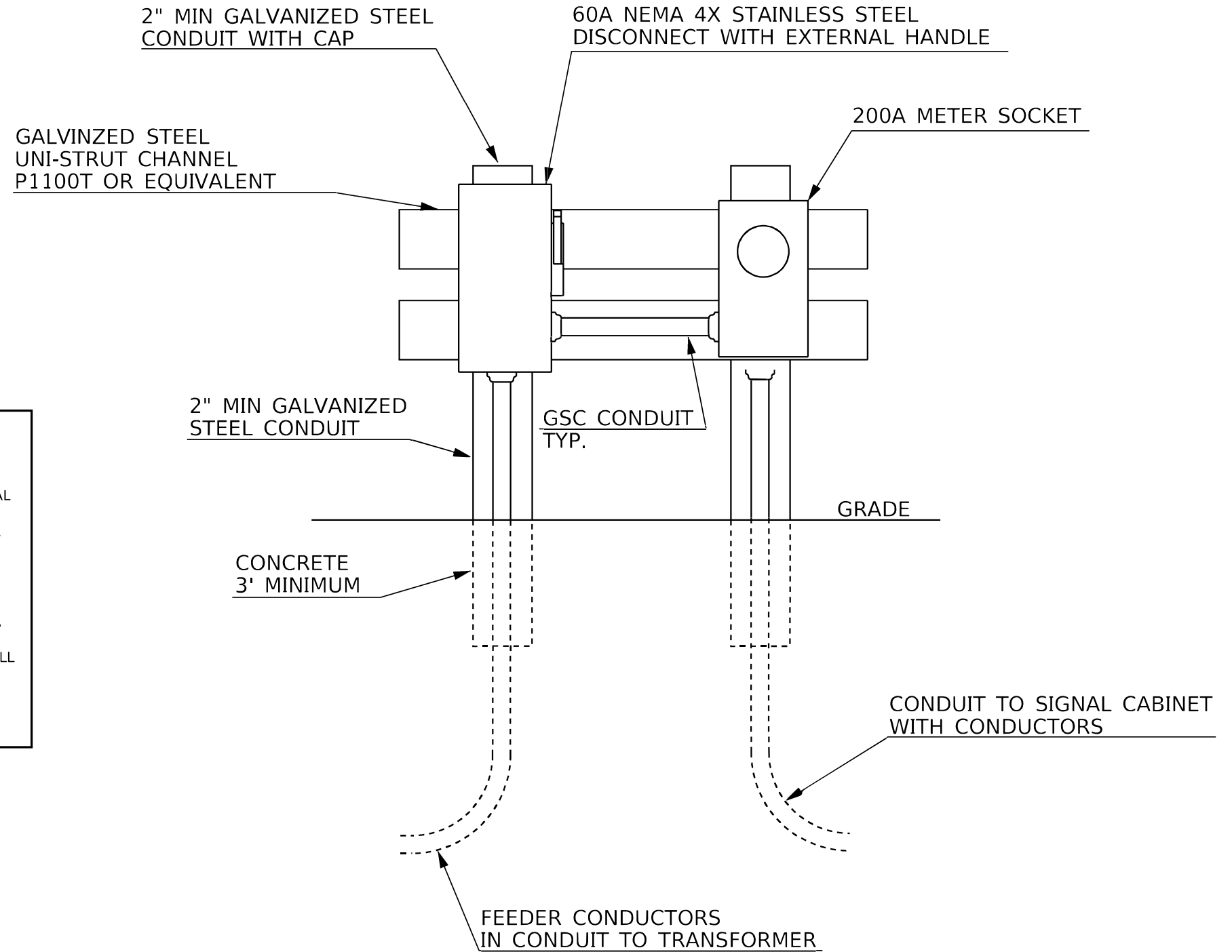

**NOTES:**

1. THE COST OF THE UNDERGROUND SERVICE CABLE/ CONDUIT FROM THE AMEREN TRANSFORMER TO THE PROPOSED ELECTRICAL SERVICE AND SERVICE CABLE/ CONDUIT FROM THE ELECTRICAL SERVICE TO THE SIGNAL CONTROLLER SHALL BE INCLUDED IN THE COST OF THE PROPOSED ELECTRICAL SERVICE INSTALLATION, SPECIAL.
2. THE CONTRACTOR SHALL VERIFY UTILITY COMPANY SERVICE INSTALLATION REQUIREMENTS, THERE WILL BE NO ADDITIONAL COMPENSATION TO ACCOMMODATE ADDITIONAL REQUIREMENTS NOT SHOWN IN THE PLANS.
3. THE PROPOSED ELECTRICAL SERVICE INSTALLATION SHALL BE LOCATED WITHIN 5 FT. OF THE PROPOSED TRAFFIC SIGNAL CONTROLLER CABINET AND SHALL BE CONSTRUCTED IN ACCORDANCE WITH UTILITY COMPANY REQUIREMENTS.

NOT TO SCALE

MODEL: Default; FILE NAME: S:\GEN\WV\W08\DESIGN\AN\Hanson\# Completed Contract\12-203 Letting\_68H56 Mast Arm\_MacArthurFiles\68H56 Revisions\_ (04-11-23).dgn

USER NAME = trevor.hanson	DESIGNED -	REVISED - TJH 04-11-23
	DRAWN -	REVISED -
PLOT SCALE = 23.8272' / in.	CHECKED -	REVISED -
PLOT DATE = 4/11/2023	DATE -	REVISED -

**STATE OF ILLINOIS  
DEPARTMENT OF TRANSPORTATION**

**ELECTRIC SERVICE INSTALLATION, SPECIAL DETAIL**

SCALE:      SHEET      OF      SHEETS      STA.      TO      STA.

F.A.P. RTE.	SECTION	COUNTY	TOTAL SHEETS	SHEET NO.
669	D4 MAST ARM REPLACEMENT 2023-1	PEORIA	19	17
CONTRACT NO. 68H56				
ILLINOIS   FED. AID PROJECT				



# SOIL BORING LOG

Date 4/5/22

ROUTE Various DESCRIPTION Special Investigation Boring for Traffic Signal Mast Arm LOGGED BYPP (RUBINO)

SECTION Various LOCATION MacArthur Hwy & SW Washington St., Peoria, SEC. 16, TWP. 8 N, RNG. 8 E, 4<sup>th</sup>  
Latitude 40.6809, Longitude -89.6040

COUNTY Peoria & Tazewell DRILLING METHOD Hollow Stem Auger HAMMER TYPE Automatic

STRUCT. NO.	D	B	U	M	Surface Water Elev.	D	B	U	M
Station	E	L	C	O	ft	E	L	C	O
	P	O	S	I	ft	P	O	S	I
	T	W	Qu	T		H	S	Qu	T
BORING NO.	H	S			Groundwater Elev.:	(ft)	(/6")	(tsf)	(%)
Station					First Encounter				
Offset					Upon Completion				
Ground Surface Elev.	ft	(ft)	(/6")	(tsf)	After Hrs.	ft	(ft)	(/6")	(tsf)
					End of Boring				
ASPHALT (approximate thickness of 2")	-0.17								
	-1.00								
CONCRETE (approximate thickness of 10")		4		10					
		1							
FILL: CLAY, trace sand and gravel, with silt, brown and gray	-3.00	2							
SAND to SANDY LOAM, trace gravel, brown to dark brown, loose to medium dense, moist to very moist		5		9					
		7							
	-5	10				-25			
		3							
		4		15					
		4							
		2		7					
		2							
	-10	2				-30			
SAND and GRAVEL, brown to tan, medium dense, moist	-10.50			6					
		9							
		9		6					
		10							
		6		5					
		5							
	-15	7				-35			
		3		3					
		9							
		11							
		5		4					
		7							
		9							
	-20.00	20				-40			

The Unconfined Compressive Strength (UCS) Failure Mode is indicated by (B-Bulge, S-Shear, P-Penetrometer)  
The SPT (N value) is the sum of the last two blow values in each sampling zone (AASHTO T206)

BBS, form 137 (Rev. 8-99)



# SOIL BORING LOG

Date 4/5/22

ROUTE Various DESCRIPTION Special Investigation Boring for Traffic Signal Mast Arm LOGGED BYPP (RUBINO)

SECTION Various LOCATION MacArthur Hwy & SW Washington St., Peoria, SEC. 17, TWP. 8 N, RNG. 8 E, 4<sup>th</sup>  
Latitude 40.6806, Longitude -89.6042

COUNTY Peoria & Tazewell DRILLING METHOD Hollow Stem Auger HAMMER TYPE Automatic

STRUCT. NO.	D	B	U	M	Surface Water Elev.	D	B	U	M
Station	E	L	C	O	ft	E	L	C	O
	P	O	S	I	ft	P	O	S	I
	T	W	Qu	T		H	S	Qu	T
BORING NO.	H	S			Groundwater Elev.:	(ft)	(/6")	(tsf)	(%)
Station					First Encounter				
Offset					Upon Completion				
Ground Surface Elev.	ft	(ft)	(/6")	(tsf)	After Hrs.	ft	(ft)	(/6")	(tsf)
					End of Boring				
FILL: CLAY, with gravel and brick pieces, brown	-1.00								
		2							
FILL: CLAY LOAM, trace gravel and brick pieces, dark brown, moist to wet		4		11					
		8							
		4							
		3		20					
	-5	5				-25			
		7							
		5		14					
		7							
FILL: SANDY LOAM, trace gravel, brown and dark brown, loose, moist to wet	-8.00								
		5							
		4		7					
		3							
	-10	3				-30			
		3							
		3		22					
		5							
SANDY LOAM, with gravel, brown, medium dense, moist	-13.00								
		7		9					
		8							
		9				-35			
		6							
		6		4					
		7							
		5							
		6		4					
		6							
	-20.00	20				-40			

The Unconfined Compressive Strength (UCS) Failure Mode is indicated by (B-Bulge, S-Shear, P-Penetrometer)  
The SPT (N value) is the sum of the last two blow values in each sampling zone (AASHTO T206)

BBS, form 137 (Rev. 8-99)

MODEL: Default  
FILE NAME: S:\CEN\HW\03\DESIGN\A\A\hanson\#\_Completed\_Contract173-03\_Letting\_68H56\_Mast\_Arm\_MacArthurFiles\68H56\_Revisions\_04-11-23.dgn

USER NAME = trevor.hanson	DESIGNED -	REVISED - TJH 04-11-23
	DRAWN -	REVISED -
PLOT SCALE = 23.8272' / in.	CHECKED -	REVISED -
PLOT DATE = 4/11/2023	DATE -	REVISED -

**STATE OF ILLINOIS  
DEPARTMENT OF TRANSPORTATION**

**SOIL BORING LOGS**

SCALE: SHEET OF SHEETS STA. TO STA.

F.A.P. RTE.	SECTION	COUNTY	TOTAL SHEETS	SHEET NO.
669	D4 MAST ARM REPLACEMENT 2023-1	PEORIA	19	18
CONTRACT NO. 68H56			ILLINOIS FED. AID PROJECT	



Google Earth  
Image Landsat / Copernicus

100 ft

MODEL: Default  
FILE: M:\GIS\_3\CEN\WV\03\DESP\AN\hanson\# Completed Contract\123-03 Letting\_68H56 Mast Arm MacArthur\Files\68H56 Revisions (04-11-23).dgn

USER NAME = trevor.hanson	DESIGNED -	REVISED - TJH 04-11-23
	DRAWN -	REVISED -
PLOT SCALE = 23.8272' / in.	CHECKED -	REVISED -
PLOT DATE = 4/11/2023	DATE -	REVISED -

**STATE OF ILLINOIS  
DEPARTMENT OF TRANSPORTATION**

**SOIL BORING LOG LOCATIONS**

SCALE: SHEET OF SHEETS STA. TO STA.

F.A.P. RTE.	SECTION	COUNTY	TOTAL SHEETS	SHEET NO.
669	D4 MAST ARM REPLACEMENT 2023-1	PEORIA	19	19
ILLINOIS FED. AID PROJ CT			CONTRACT NO. 68H56	