

LEGEND

SECTION CORNER (Symbol: 9 10 16 15)

QUARTER SECTION CORNER (Symbol: 16 15)

SECTION LINE

QUARTER SECTION LINE

QUARTER, QUARTER SECTION LINE

PLATTED LOT LINE

PROPERTY (DEED) LINE

APL APPARENT PROPERTY LINE

CENTERLINE

EXISTING RIGHT OF WAY LINE

PROPOSED RIGHT OF WAY LINE

PROPOSED EASEMENT

MEASURED DIMENSION

COMPUTED DIMENSION

RECORD DATA

ENGLISH EQUIVALENT

EXISTING BUILDING

PK NAIL SET

REPLACED AFTER CONSTRUCTION

IRON PIPE OR ROD FOUND

CUT CROSS FOUND OR SET

THESE STAKES REFERENCE FOUND OR SET MONUMENTATION. SET 5/8 INCH IRON ROD FLUSH WITH GROUND TO THE FOUND IRON STAKE. IDENTIFIED BY COLORED PLASTIC CAP BEARING SURVEYORS REGISTRATION NUMBER.

BT1 THESE STAKES, IN CULTIVATED AREAS, REFERENCE FOUND OR SET MONUMENTATION. BURIED 5/8 INCH IRON ROD 20 INCHES BELOW GROUND TO THE FOUND IRON STAKE. IDENTIFIED BY COLORED PLASTIC CAP BEARING SURVEYORS REGISTRATION NUMBER.

BT2

BT3

STAKING OF PROPOSED RIGHT OF WAY. SET DIVISION OF HIGHWAYS SURVEY MARKER TO MONUMENT THE POSITION SHOWN. IDENTIFIED BY INSCRIPTION DATA AND SURVEYORS REGISTRATION NUMBER.

STAKING OR PROPOSED RIGHT OF WAY IN CULTIVATED AREAS. BURIED 5/8 INCH METAL ROD 20 INCHES BELOW GROUND TO MARK FUTURE SURVEY MARKER POSITION. IDENTIFIED BY COLOR PLASTIC CAP BEARING SURVEYORS REGISTRATION NUMBER.

PERMANENT SURVEY MARKER, 1D O T STD. 2135 (TO BE SET BY OTHERS)

RIGHT OF WAY STAKING PROPOSED TO BE SET.

LIGHT STANDARD

SCALE ENGLISH - 1" = 40'

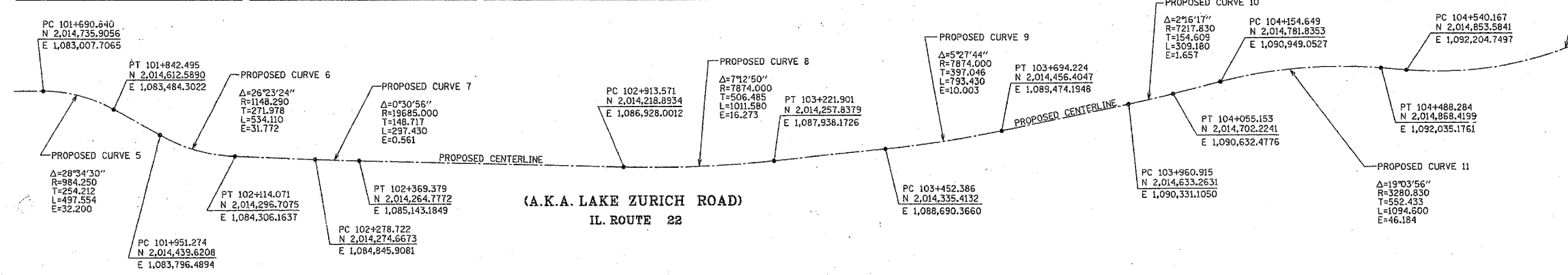

STATE OF ILLINOIS)
COUNTY OF COOK)

WE, SPACECO, INC., AN ILLINOIS PROFESSIONAL DESIGN FIRM, NUMBER 184-001157, DO HEREBY DECLARE THAT WE HAVE SURVEYED THE PLAT OF HIGHWAYS SHOWN HEREON BETWEEN SECTIONS 17 AND 20, TOWNSHIP 43 N, RANGE 11 EAST OF THE THIRD PRINCIPAL MERIDIAN, LAKE COUNTY; THAT THE SURVEY IS TRUE AND COMPLETE AS SHOWN TO THE BEST OF OUR KNOWLEDGE AND BELIEF; THAT THE PLAT CORRECTLY REPRESENTS SAID SURVEY; THAT ALL MONUMENTS FOUND AND ESTABLISHED ARE OF PERMANENT QUALITY AND OCCUPY THE POSITIONS SHOWN THEREON AND THAT THE MONUMENTS ARE SUFFICIENT TO ENABLE THE SURVEY TO BE RETRACED. MADE FOR THE DEPARTMENT OF TRANSPORTATION, STATE OF ILLINOIS.

DATED AT ROSEMONT, ILLINOIS THIS 22ND DAY OF August, A.D., 2002.

C. Brian Lounsbury
C. BRIAN LOUNSBURY I.P.L.S. No. 033-2841
LICENSE EXPIRES: 11-30-2002
(VALID ONLY IF EMBOSSED SEAL AFFIXED)

SPACECO, INC.
9575 W. HIGGINS • SUITE 700 • ROSEMONT, IL 60018 (708) 696-4060 FAX (708) 696-4065

PLAT OF HIGHWAYS
STATE OF ILLINOIS
DEPARTMENT OF TRANSPORTATION
FAP 337 (IL RTE 22)
LAKE ZURICH ROAD

SECTION 18.3 TO US45/IL21 LAKE COUNTY
PROJECT FAP 337 (IL RTE 22) JOB NO. R-91-005-01
STATION 10+500 TO STATION 10+613.491
SCALE: 1"=40' SHEET 8 OF 8

BUREAU OF LAND ACQUISITION
201 WEST CENTER COURT
SCHAMBURG, ILLINOIS 60196