

F.A.P. RTE.	SECTION	COUNTY	TOTAL SHEETS	SHEET NO.
337	20 WRS-6	LAKE	318	37
STA. 11+000		TO STA. 11+700		
FED. ROAD DIST. NO.	ILLINOIS	FED. AID PROJECT		
CONTRACT NO. 62030				

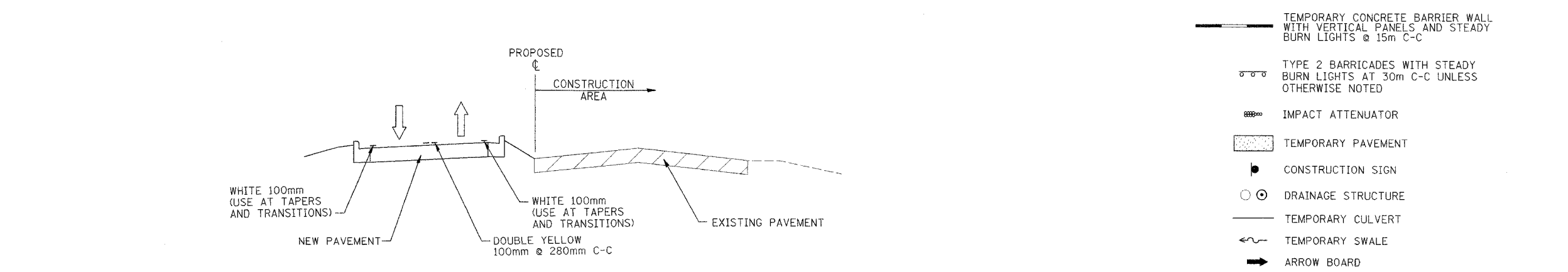
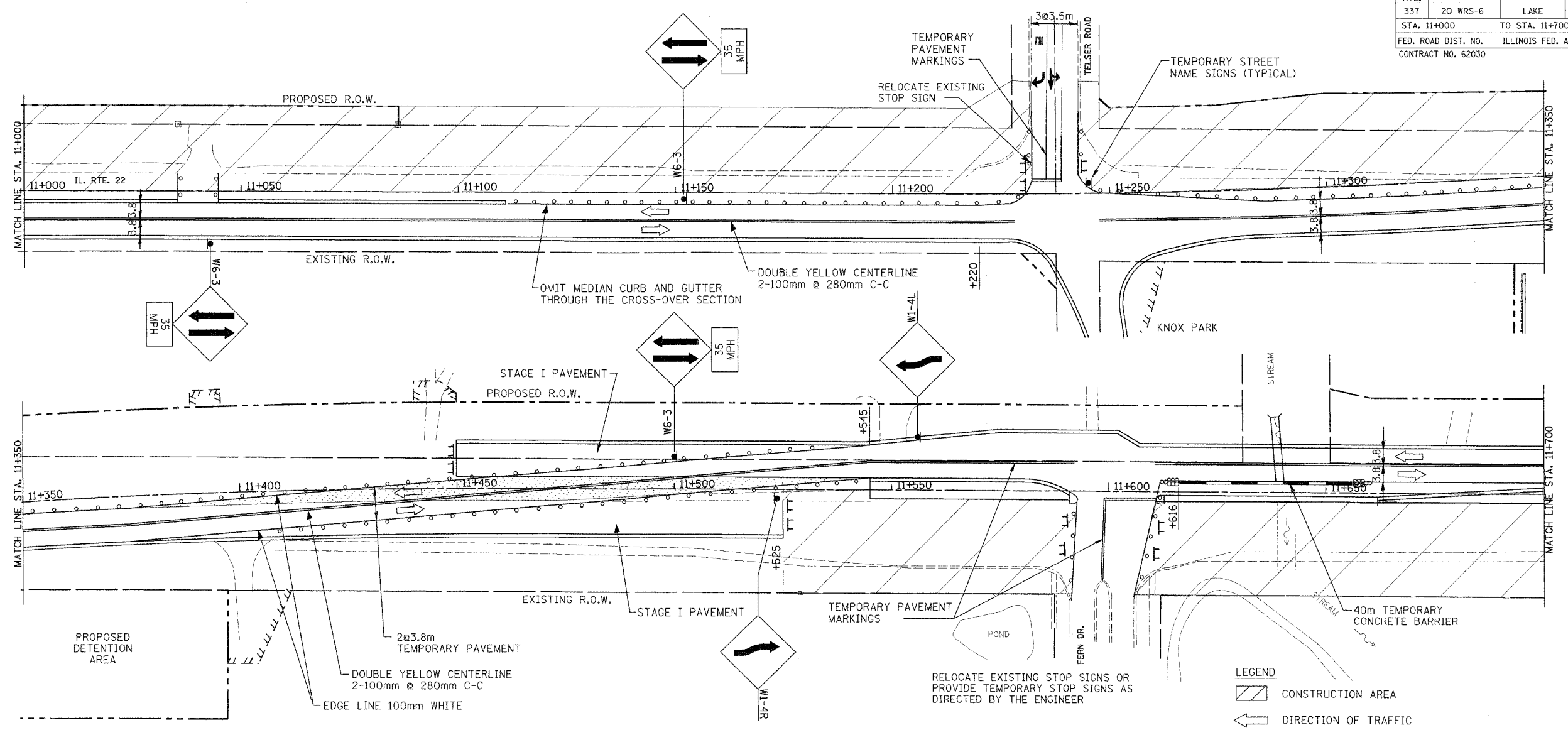

- LEGEND**
- CONSTRUCTION AREA
  - DIRECTION OF TRAFFIC
  - TEMPORARY CONCRETE BARRIER WALL WITH VERTICAL PANELS AND STEADY BURN LIGHTS @ 15m C-C
  - TYPE 2 BARRICADES WITH STEADY BURN LIGHTS AT 30m C-C UNLESS OTHERWISE NOTED
  - IMPACT ATTENUATOR
  - TEMPORARY PAVEMENT
  - CONSTRUCTION SIGN
  - DRAINAGE STRUCTURE
  - TEMPORARY CULVERT
  - TEMPORARY SWALE
  - ARROW BOARD

TEMPORARY MARKINGS SHALL BE TYPE III TAPE ON NEW PAVEMENT

IL 22 STAGE II  
STA. 11+450 TO STA. 12+875

REVISIONS	
NAME	DATE

ILLINOIS DEPARTMENT OF TRANSPORTATION  
ILLINOIS ROUTE 22  
MAINTENANCE OF TRAFFIC  
STAGE II  
STA. 11+000 TO STA. 11+700

SCALE IN METERS  
HORIZ. 1:5000

DATE: 03/11/05

DRAWN BY: SMP  
CHECKED BY: SJG