

|                     |          |                           |              |           |
|---------------------|----------|---------------------------|--------------|-----------|
| F.A.P. RTE.         | SECTION  | COUNTY                    | TOTAL SHEETS | SHEET NO. |
| 337                 | 20 WRS-6 | LAKE                      | 318          | 48        |
| STA. 1+100          |          | TO STA. 1+450             |              |           |
| FED. ROAD DIST. NO. |          | ILLINOIS FED. AID PROJECT |              |           |
| CONTRACT NO. 62030  |          |                           |              |           |

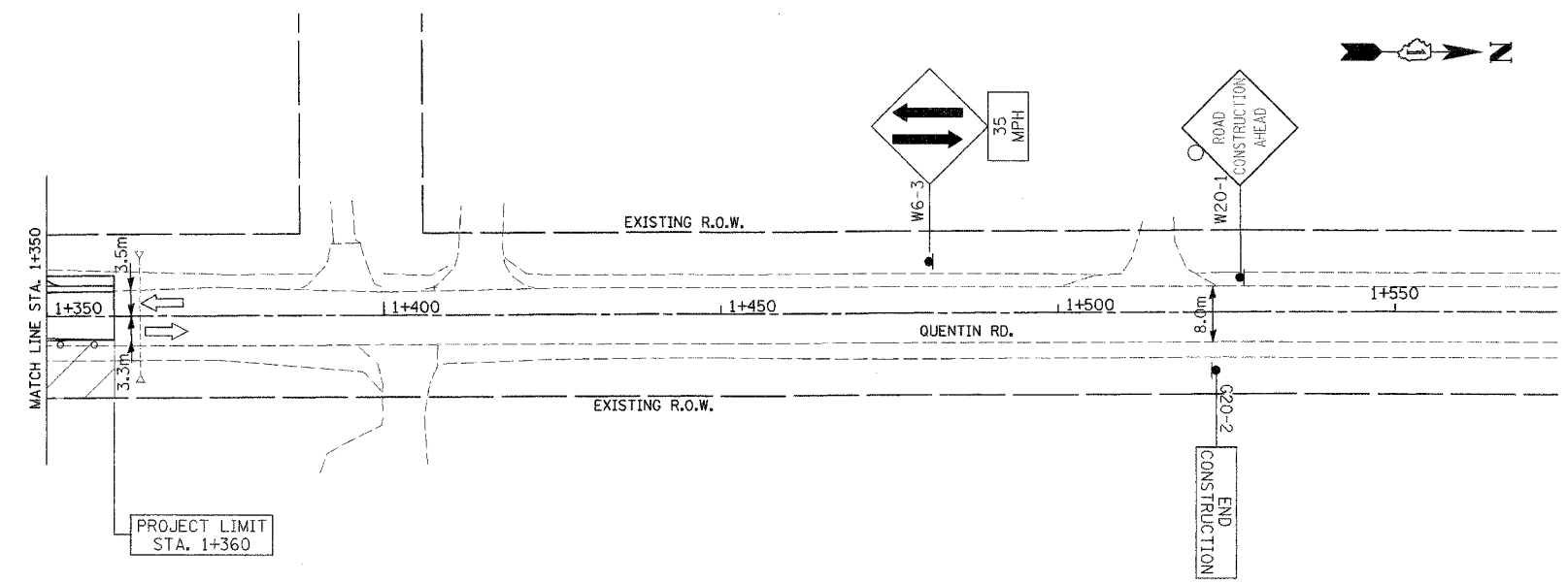
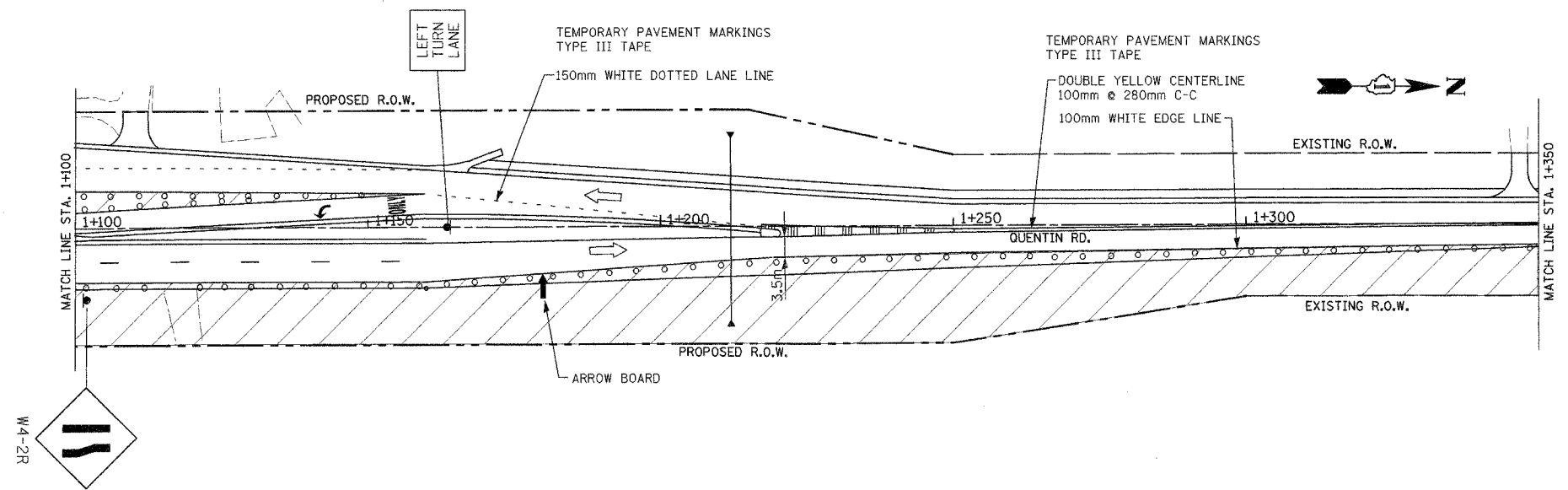

- LEGEND**
- CONSTRUCTION AREA
  - DIRECTION OF TRAFFIC
  - TEMPORARY CONCRETE BARRIER WALL WITH VERTICAL PANELS AND STEADY BURN LIGHTS @ 15m C-C
  - TYPE 2 BARRICADES WITH STEADY BURN LIGHTS AT 30m C-C UNLESS OTHERWISE NOTED
  - IMPACT ATTENUATOR
  - TEMPORARY PAVEMENT
  - CONSTRUCTION SIGN
  - DRAINAGE STRUCTURE
  - TEMPORARY CULVERT
  - TEMPORARY SWALE
  - ARROW BOARD

| REVISIONS |      |
|-----------|------|
| NAME      | DATE |
|           |      |
|           |      |
|           |      |
|           |      |
|           |      |
|           |      |
|           |      |
|           |      |
|           |      |
|           |      |

ILLINOIS DEPARTMENT OF TRANSPORTATION  
 ILLINOIS ROUTE 22  
 MAINTENANCE OF TRAFFIC  
 STAGE III  
 STA. 1+100 TO STA. 1+550

SCALE IN METERS  
 HORIZ. (1:500) DRAWN BY: SMP  
 DATE: 03/11/05 CHECKED BY: SJG