

F.A.P. RTE.	SECTION	COUNTY	TOTAL SHEETS	SHEET NO.
337	20 WRS-6	LAKE	318	74
STA. 0+900		TO STA. 1+200		
FED. ROAD DIST. NO.		ILLINOIS FED. AID PROJECT		
CONTRACT NO. 62030		WETLAND #2D		

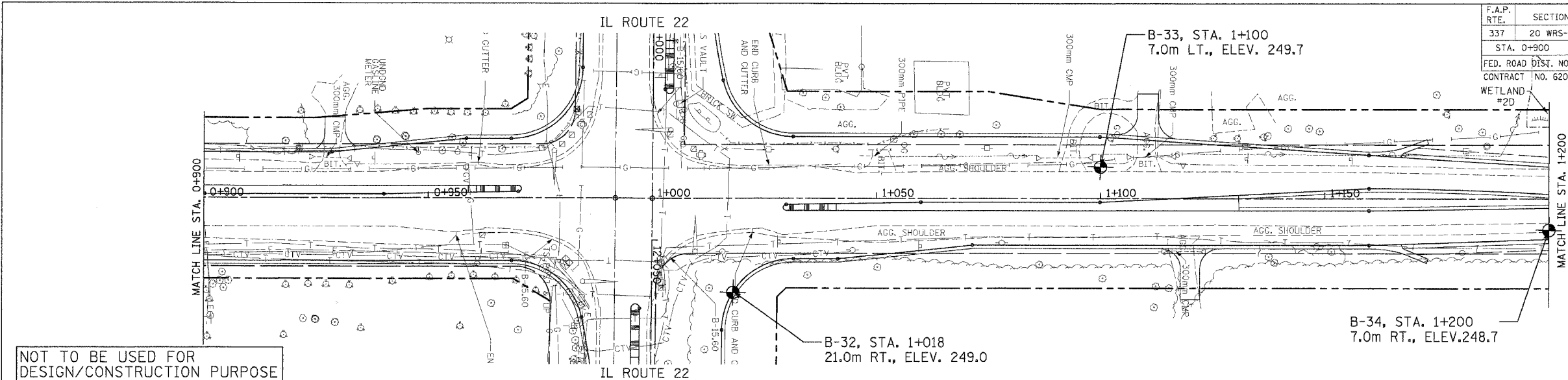

NOT TO BE USED FOR DESIGN/CONSTRUCTION PURPOSE

SCALE:
HORIZ. 1:500
VERT. 1:50

FINAL SURVEY	BY	DATE
SURVEYED		
PLOTTED		
NOTE BOOK TEMPLATE		
AREAS CHECKED		
NO.		

ORIGINAL SURVEY	BY	DATE
SURVEYED		
PLOTTED		
NOTE BOOK TEMPLATE		
AREAS CHECKED		
NO.		

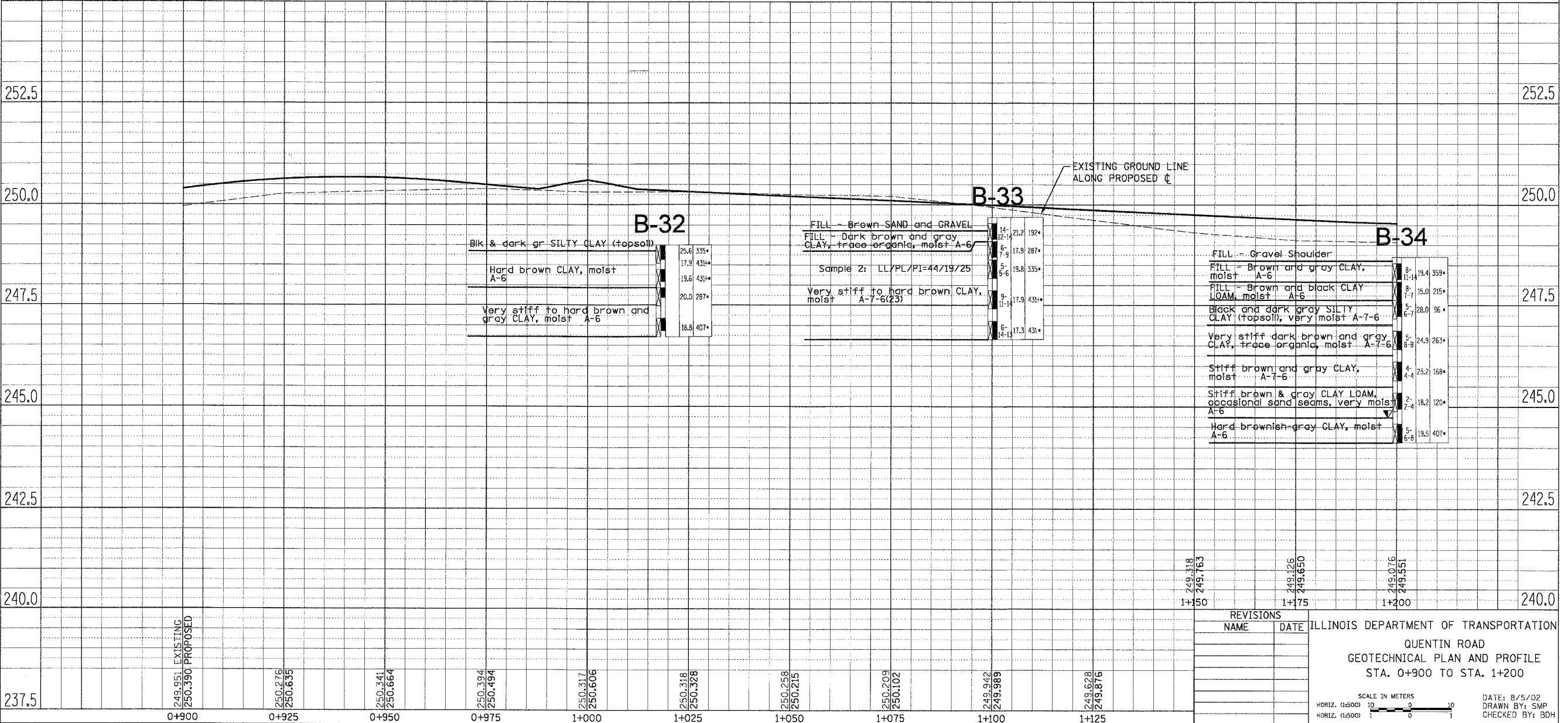

249.318	1+150
249.763	
249.126	1+175
249.650	
249.076	1+200
249.551	

REVISIONS	NAME	DATE

ILLINOIS DEPARTMENT OF TRANSPORTATION
 QUENTIN ROAD
 GEOTECHNICAL PLAN AND PROFILE
 STA. 0+900 TO STA. 1+200

SCALE IN METERS
 HORIZ. (1:500) 0 10
 HORIZ. (1:500) 1 0 1

DATE: 8/5/02
 DRAWN BY: SMP
 CHECKED BY: BDH