

CONTRACT NO. 62030

F.A.P. RTE.	SECTION	COUNTY	TOTAL SHEETS	SHEET NO.
337	20 WRS-6	LAKE	318	102
STA. 11+100		TO STA. 11+450		
FED. ROAD DIST. NO.		ILLINOIS FED. AID PROJECT		

LEGEND

ADJ	STRUCTURE TO BE ADJUSTED
F	STRUCTURE TO BE FILLED
R	STRUCTURE TO BE REMOVED
REC	STRUCTURE TO BE RECONSTRUCTED
—	PIPE ABANDONMENT (OR REMOVAL WHERE REQ'D)

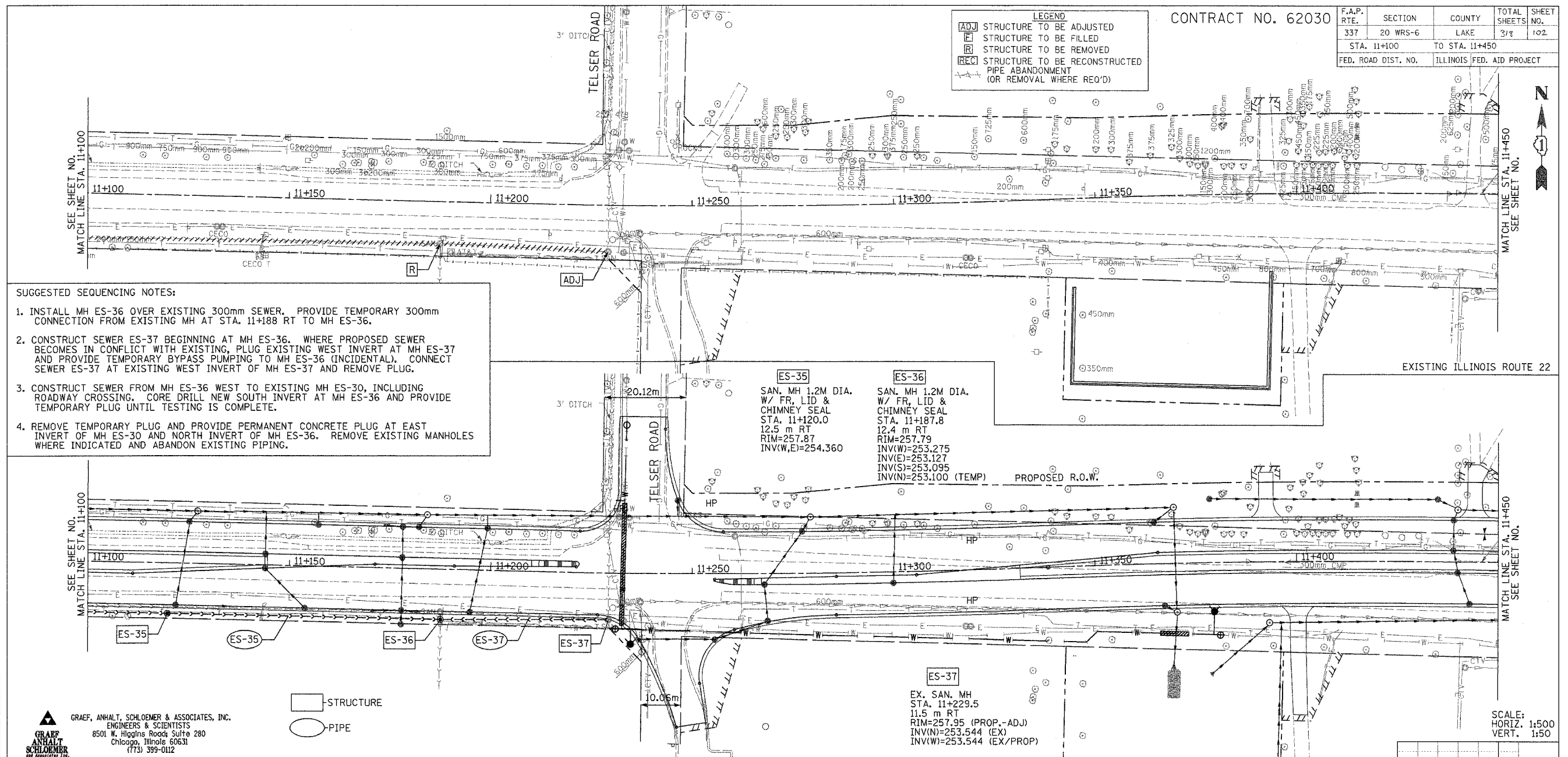

- SUGGESTED SEQUENCING NOTES:**
1. INSTALL MH ES-36 OVER EXISTING 300mm SEWER. PROVIDE TEMPORARY 300mm CONNECTION FROM EXISTING MH AT STA. 11+188 RT TO MH ES-36.
 2. CONSTRUCT SEWER ES-37 BEGINNING AT MH ES-36. WHERE PROPOSED SEWER BECOMES IN CONFLICT WITH EXISTING, PLUG EXISTING WEST INVERT AT MH ES-37 AND PROVIDE TEMPORARY BYPASS PUMPING TO MH ES-36 (INCIDENTAL). CONNECT SEWER ES-37 AT EXISTING WEST INVERT OF MH ES-37 AND REMOVE PLUG.
 3. CONSTRUCT SEWER FROM MH ES-36 WEST TO EXISTING MH ES-30, INCLUDING ROADWAY CROSSING. CORE DRILL NEW SOUTH INVERT AT MH ES-36 AND PROVIDE TEMPORARY PLUG UNTIL TESTING IS COMPLETE.
 4. REMOVE TEMPORARY PLUG AND PROVIDE PERMANENT CONCRETE PLUG AT EAST INVERT OF MH ES-30 AND NORTH INVERT OF MH ES-36. REMOVE EXISTING MANHOLES WHERE INDICATED AND ABANDON EXISTING PIPING.

BY	DATE

FINAL SURVEY PLOTTED
NOTE BOOK TEMPLATE AREAS CHECKED

BY	DATE

ORIGINAL SURVEY PLOTTED
NOTE BOOK TEMPLATE AREAS CHECKED

GRAEF, ANHALT, SCHLOEMER & ASSOCIATES, INC.
ENGINEERS & SCIENTISTS
8501 W. Higgins Road, Suite 280
Chicago, Illinois 60631
(773) 399-0112

□ STRUCTURE
○ PIPE

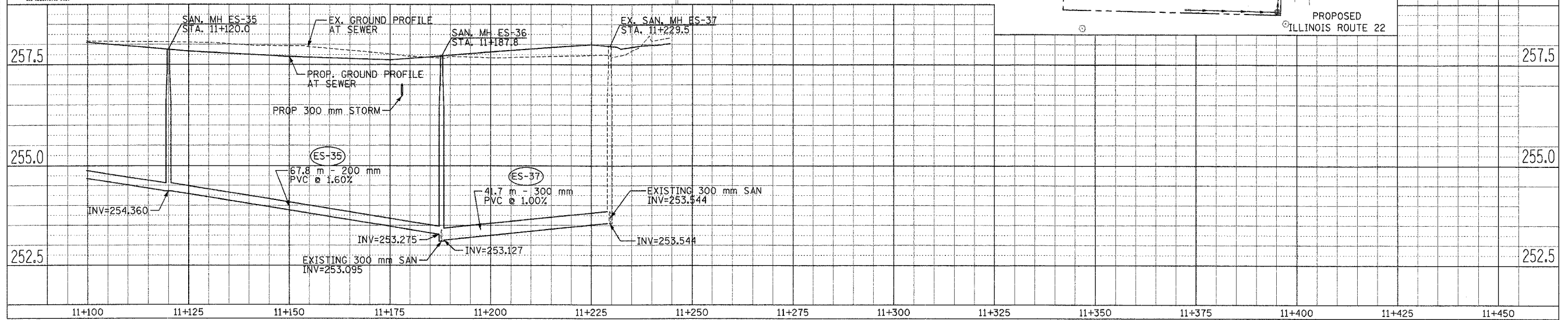

SANITARY SEWER RELOCATION IL. RTE. 22 STA. 11+100 TO STA. 11+450

FILE: H:\Jobs\2003\20034005\CAD\1001_Tran\sdn\1001\sspp4-SAN.dgn
DATE: 06-16-05 09:58