

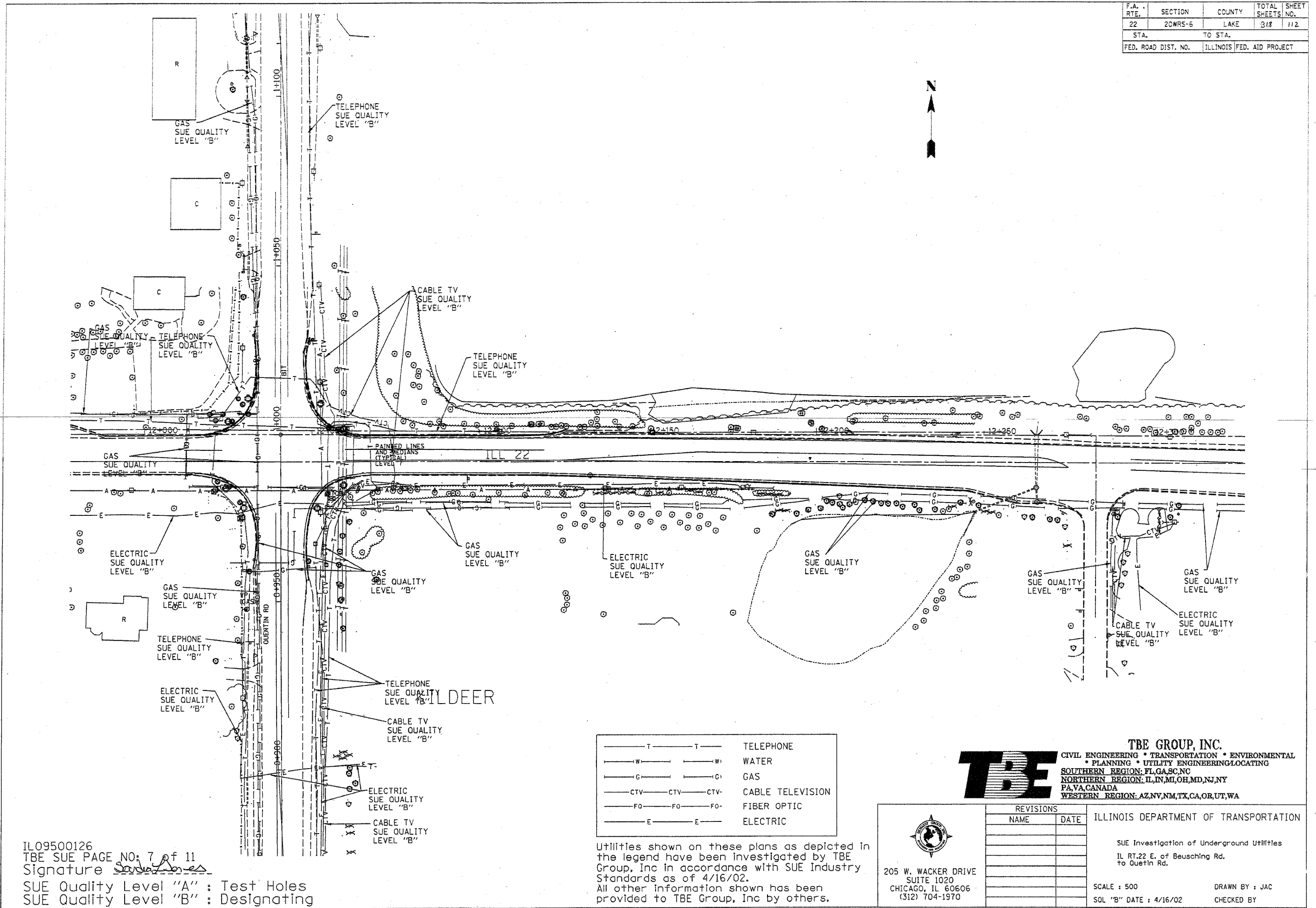

| | | | | |
|---------------------|---------------------------|--------|--------------|-----------|
| F.A. RTE. | SECTION | COUNTY | TOTAL SHEETS | SHEET NO. |
| 22 | 20WRS-6 | LAKE | 318 | 112 |
| STA. | TO STA. | | | |
| FED. ROAD DIST. NO. | ILLINOIS FED. AID PROJECT | | | |



ILO9500126
 TBE SUE PAGE NO: 7 of 11
 Signature *Sandra Ames*
 SUE Quality Level "A" : Test Holes
 SUE Quality Level "B" : Designating

| | |
|---------------------|------------------|
| — T — T — | TELEPHONE |
| — W — W — | WATER |
| — G — G — | GAS |
| — CTV — CTV — CTV — | CABLE TELEVISION |
| — FO — FO — FO — | FIBER OPTIC |
| — E — E — | ELECTRIC |

Utilities shown on these plans as depicted in the legend have been investigated by TBE Group, Inc in accordance with SUE Industry Standards as of 4/16/02.
 All other information shown has been provided to TBE Group, Inc by others.

 205 W. WACKER DRIVE
 SUITE 1020
 CHICAGO, IL 60606
 (312) 704-1970

TBE **TBE GROUP, INC.**
 CIVIL ENGINEERING * TRANSPORTATION * ENVIRONMENTAL
 * PLANNING * UTILITY ENGINEERING/LOCATING
 SOUTHERN REGION: FL, GA, SC, NC
 NORTHERN REGION: IL, IN, MI, OH, MD, NJ, NY
 PA, VA, CANADA
 WESTERN REGION: AZ, NV, NM, TX, CA, OR, UT, WA

| REVISIONS | |
|-----------|------|
| NAME | DATE |
| | |
| | |
| | |
| | |
| | |
| | |
| | |
| | |
| | |
| | |

ILLINOIS DEPARTMENT OF TRANSPORTATION
 SUE Investigation of Underground Utilities
 IL RT.22 E. of Beusching Rd.
 to Quetin Rd.
 SCALE : 500
 SOL "B" DATE : 4/16/02
 DRAWN BY : JAC
 CHECKED BY :