

F.A.P. RTE.	SECTION	COUNTY	TOTAL SHEETS	SHEET NO.
337	20 WRS-6	LAKE	318	180
STA.	TO STA.			
FED. ROAD DIST. NO.		ILLINOIS	FED. AID PROJECT:	
CONTRACT NO. 62030				

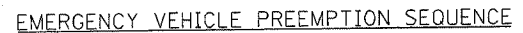

PROPOSED EMERGENCY VEHICLE PREEMPTORS		
EMERGENCY VEHICLE PREEMPTOR	3	4
MOVEMENT	→	←

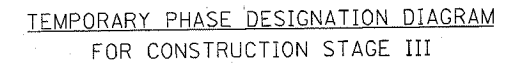
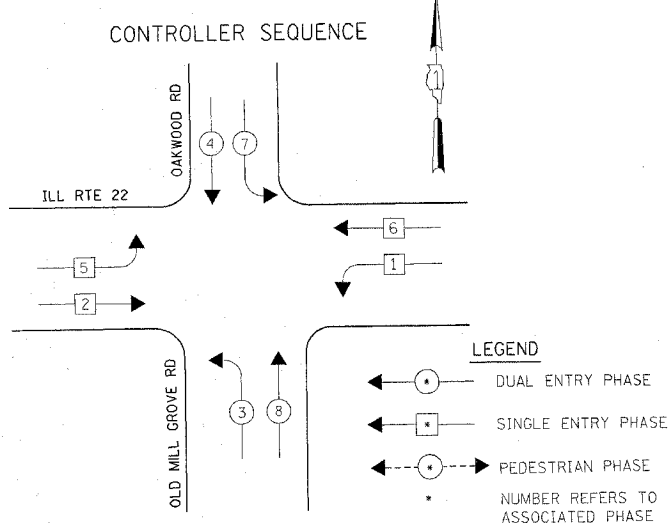
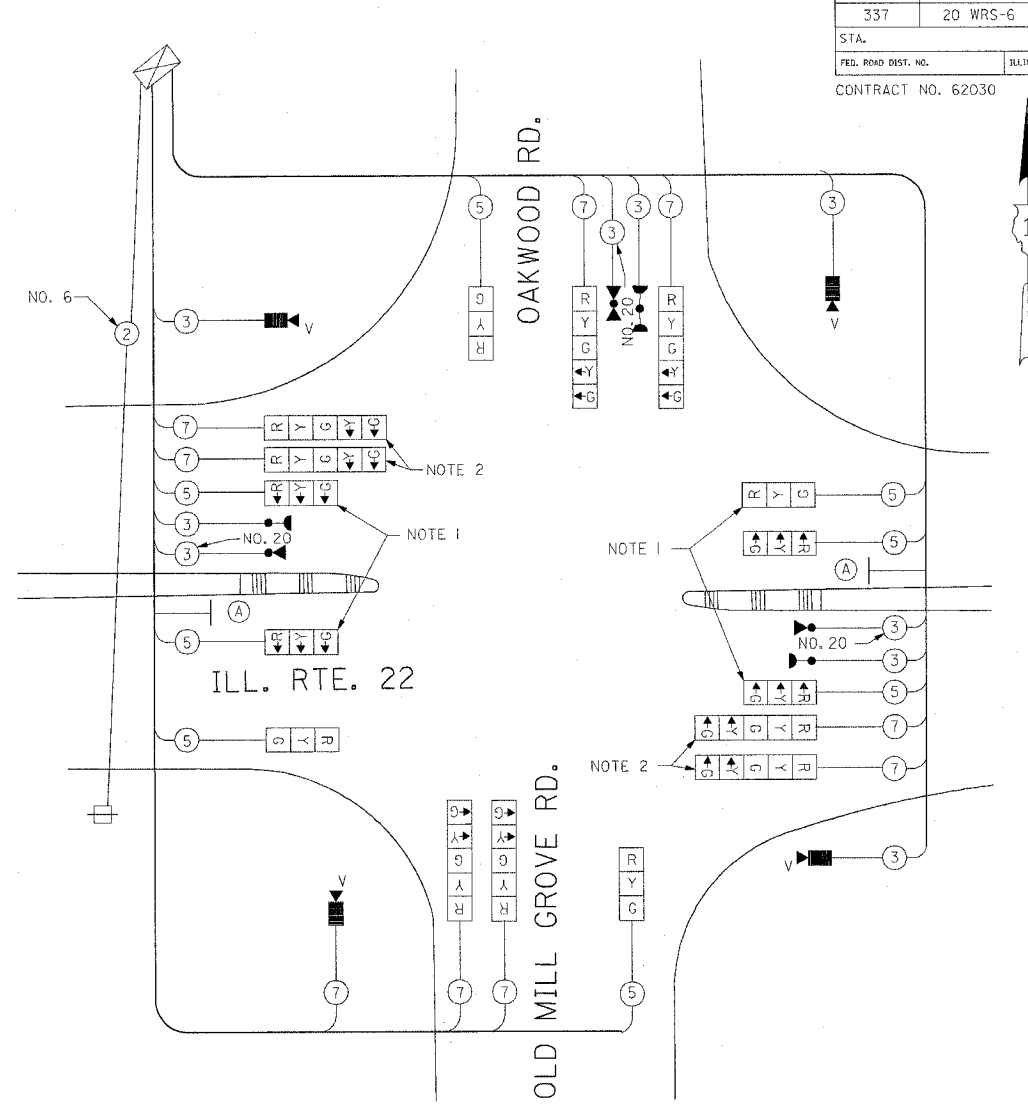
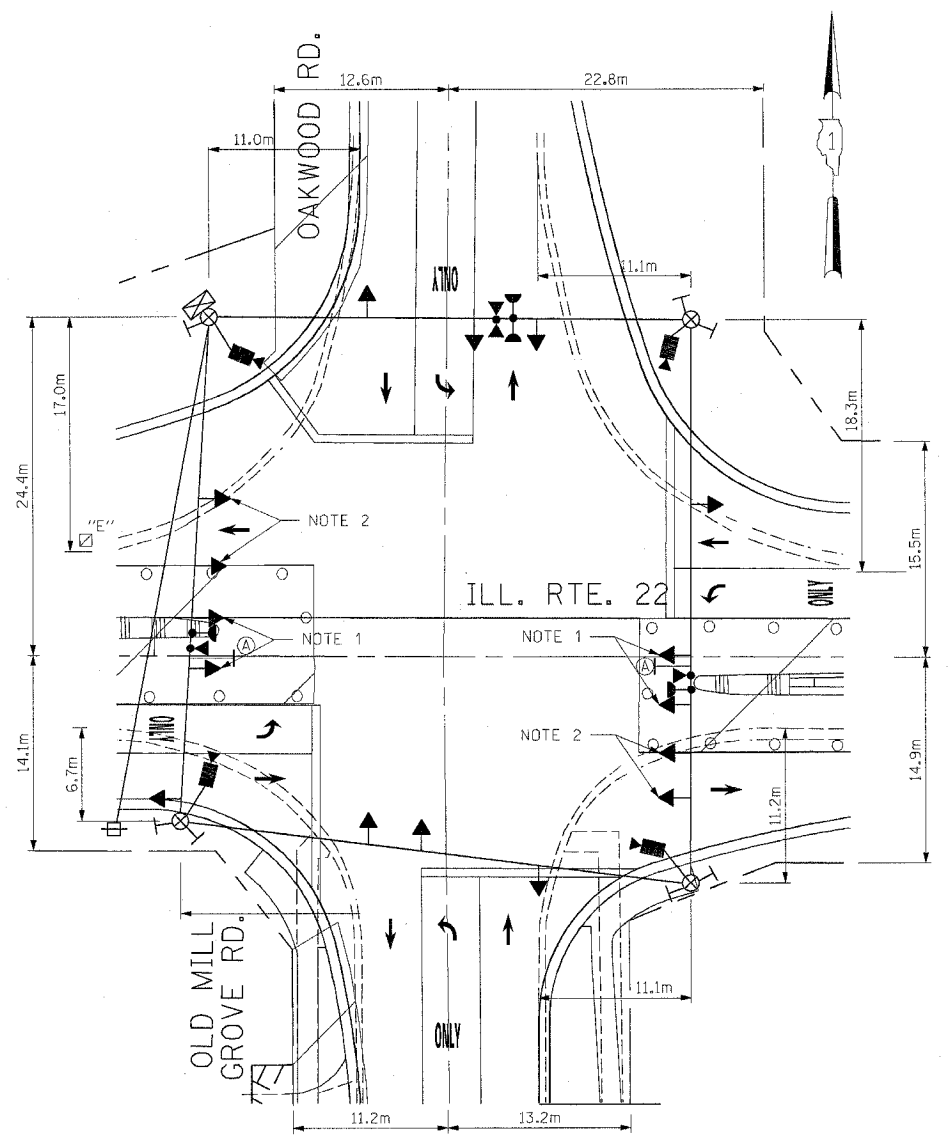

NOTE 1: THE PROPOSED PROTECTED LEFT TURN SIGNAL HEADS ARE NOT TO BE INSTALLED AT THE TIME THE TEMPORARY SIGNAL IS CONSTRUCTED. THESE SIGNAL HEADS ARE TO BE INSTALLED ONE WEEK PRIOR TO THE OPENING OF THE CONSTRUCTION STAGE III LANE CONFIGURATION. THE HEADS ARE TO BE BAGGED UNTIL THEY ARE PLACED IN OPERATION. WITH APPROVAL FROM THE ENGINEER THE CONTRACTOR MAY, HOWEVER, INSTALL AND BAG THESE SIGNAL HEADS AT THE TIME THE TEMPORARY TRAFFIC SIGNAL INSTALLATION IS CONSTRUCTED.

NOTE 2: THE GREEN AND YELLOW LEFT TURN ARROW INDICATIONS ARE TO BE BAGGED AND DISCONNECTED PRIOR TO THE CONNECTION AND UNBAGGING OF THE PROTECTED LEFT TURN SIGNAL INDICATIONS FOR ILLINOIS ROUTE 22.

EXISTING EQUIPMENT TO BE REMOVED LEGEND

- ◀ EXISTING SIGNAL TO BE REMOVED
- "E" EXISTING SERVICE INSTALLATION TO BE REMOVED
- EXISTING SIGNAL POST AND FOUNDATION TO BE REMOVED
- ⊙ EXISTING MAST ARM POLE AND FOUNDATION TO BE REMOVED
- ⊠ "E" EXISTING CONTROLLER AND FOUNDATION TO BE REMOVED
- ⊠ "E" EXISTING HANDHOLE TO BE REMOVED
- ⊠ "E" EXISTING DOUBLE HANDHOLE TO BE REMOVED
- PEDESTRIAN SIGNAL TO BE REMOVED
- ⊙ EXISTING PEDESTRIAN PUSH-BUTTON TO BE REMOVED
- ⊙ EMERGENCY VEHICLE LIGHT DETECTOR TO BE REMOVED
- ⊙ CONFIRMATION BEACON TO BE REMOVED
- ⊠ "E" EXISTING HEAVY DUTY HANDHOLE TO BE REMOVED
- EXISTING STEEL MAST ARM POLE AND FOUNDATION TO BE REMOVED

TEMPORARY TRAFFIC SIGNAL LEGEND

- ◀ TEMPORARY TRAFFIC SIGNAL HEAD SPAN WIRE MOUNTED ORIGINAL LOCATION
- ◀ TEMPORARY TRAFFIC SIGNAL HEAD SPAN WIRE MOUNTED SECONDARY LOCATION
- ⊙ TEMPORARY WOOD POLE (CLASS 5 OR BETTER) 45 FOOT (13.7m) MINIMUM
- ⊠ TEMPORARY CONTROLLER CABINET
- ⊠ TEMPORARY SERVICE INSTALLATION
- ⊠ TEMPORARY PEDESTRIAN SIGNAL HEAD, BRACKET MOUNTED
- ⊙ VIDEO CAMERA ASSEMBLY
- ⊙ PEDESTRIAN PUSHBUTTON DETECTOR
- ⊙ EMERGENCY VEHICLE LIGHT DETECTOR
- ⊙ CONFIRMATION BEACON
- VEHICLE DETECTOR, INDUCTION LOOP
- CT COMMON TRENCH
- UD UNIT DUCT
- G.S. CONDUIT IN GROUND
- HANDHOLE
- HEAVY DUTY HANDHOLE

TEMPORARY CABLE DIAGRAM LEGEND

- ⊠ TEMPORARY TRAFFIC SIGNAL SECTION OR PEDESTRIAN SIGNAL SECTION 12" (300mm)
- ⊠ TEMPORARY CONTROLLER CABINET
- ⊠ TEMPORARY SERVICE INSTALLATION
- ⑤ INDICATES NUMBER OF CONDUCTORS IN CABLE. ALL CONDUCTORS TO BE NUMBER 14 AWG WIRE UNLESS OTHERWISE NOTED.
- ⊙ EMERGENCY VEHICLE LIGHT DETECTOR
- ⊙ CONFIRMATION BEACON
- ⊙ VEHICLE DETECTOR, INDUCTION LOOP
- ⊙ PEDESTRIAN PUSHBUTTON DETECTOR
- ⊙ 12" (300mm) PEDESTRIAN SIGNAL SECTION
- ⊙ VIDEO CAMERA ASSEMBLY



CONSTRUCTION NOTE

1. THE EXISTING LIGHT DETECTOR (MODEL: 521) ON TRAFFIC SIGNAL MAST ARM IN THE N-W CORNER OF THE INTERSECTION SHALL BE RELOCATED TO THE PROPOSED TRAFFIC SIGNAL INSTALLATION.

I.D.O.T. TRAFFIC SIGNAL INSTALLATION ELECTRICAL SERVICE REQUIREMENTS					TOTAL WATTAGE
TYPE	NO LAMPS	WATTAGE	%OPERATION		
		INCAND.	LED		
SIGNAL (RED)	16	135	17	0.50	1080.00
(YELLOW)	16	135	25	0.25	540.00
ARROW (GREEN)	16	135	15	0.25	540.00
ARROW	8	135	12	1.00	108.00
PED. SIGNAL		90	25	1.00	
CONTROLLER	1	100	100	1.00	100.00
ILLUM. SIGN				0.05	
FLASHER				0.50	
ENERGY COSTS TO:				TOTAL =	2368.00

ILLINOIS DEPARTMENT OF TRANSPORTATION
201 WEST CENTER COURT
SCHAUMBURG, ILLINOIS 60196-1096

ENERGY SUPPLY CONTACT: JOAN COOK
PHONE: (847) 816-5461
COMPANY: LIBERTYVILLE OFFICE

REVISIONS	
NAME	DATE

ILLINOIS DEPARTMENT OF TRANSPORTATION

TEMPORARY TRAFFIC SIGNAL INSTALLATION FOR CONSTRUCTION STAGE III
ILLINOIS ROUTE 22
AT OAKWOOD ROAD-OLD MILL GROVE ROAD

SCALE: AS NOTED
DATE: MARCH 11, 2005

DRAWN BY: EAO
DESIGNED BY: BC/PKG
CHECKED BY: PKG/RMM