

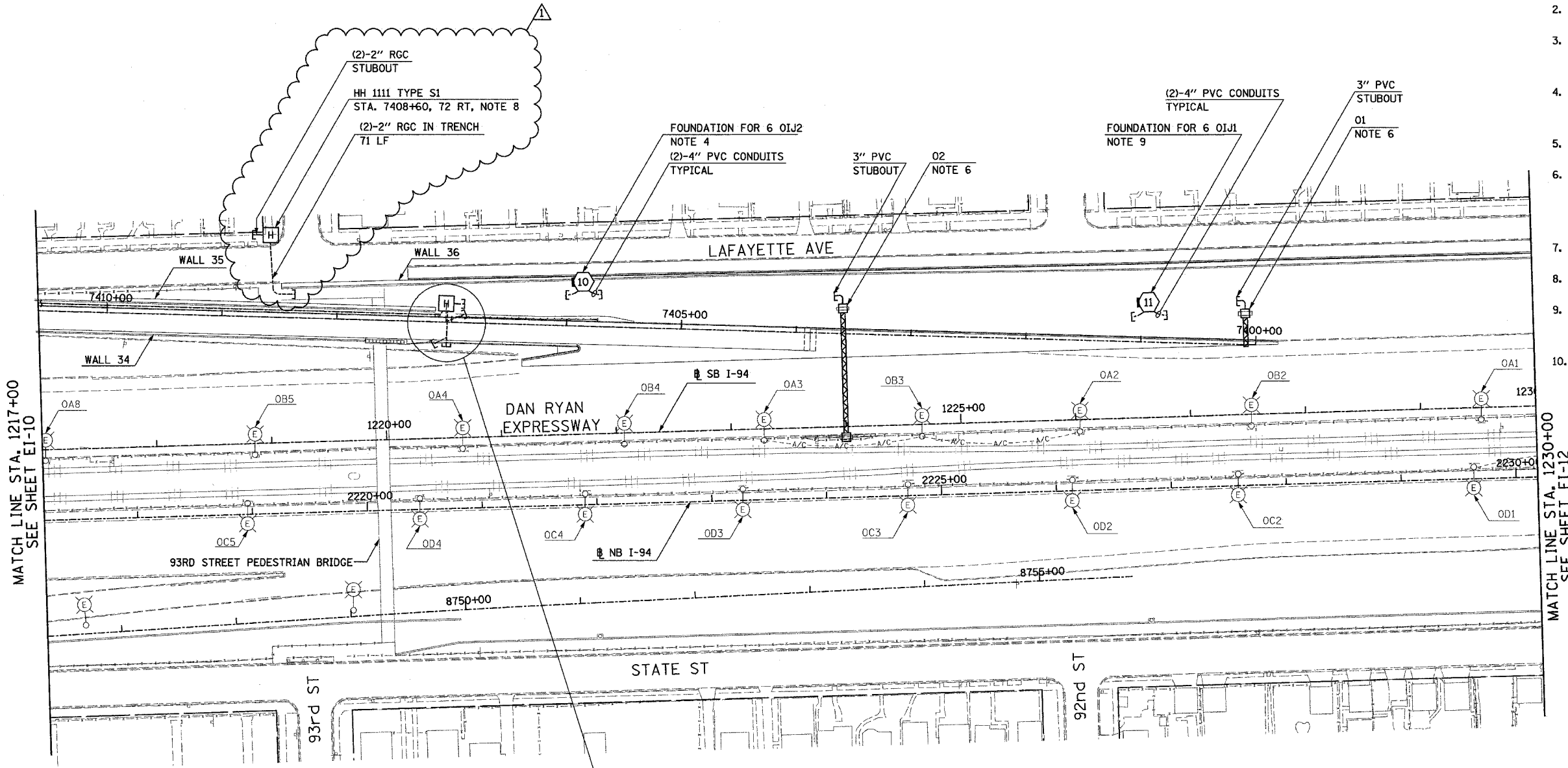

- NOTES:**
- SEE DRAWINGS EI-100 AND EI-101 FOR ELECTRICAL SYMBOLS AND ABBREVIATIONS.
 - COORDINATE ALL WORK WITH IDOT CONTRACTS 62583 AND 62694.
 - UNLESS NOTED OTHERWISE, ALL ITEMS AND WORK SHOWN IN HEAVY LINE WEIGHT ON THIS DRAWING ARE PROPOSED NEW ITEMS AND WORK.
 - REFER TO STRUCTURAL DRAWINGS AND EI-104 FOR CONDUIT INSTALLATION DETAILS FOR LIGHT TOWER FOUNDATION MOUNTED ON WALL.
 - REFER TO SHEET EI-107 FOR COMMUNICATIONS VAULT CI DETAILS.
 - SIGN STRUCTURE SHALL BE PROVIDED UNDER THIS CONTRACT. SIGN LUMINAIRES, DISCONNECT SWITCH, WIRING AND CONNECTIONS SHALL BE PROVIDED BY OTHERS UNDER CONTRACT 62583. SIGN O1 SHALL BE LIT BEFORE RAMP AT 95th STREET IS OPEN.
 - REFER TO SHEETS EI-102 AND ME-04 FOR DUCTBANK INSTALLATION DETAILS.
 - REFER TO SHEETS EI-103, EI-106 AND EI-110 FOR HANDHOLE DETAILS.
 - REFER TO BE-501 FOR GROUND MOUNTED TOWER FOUNDATION DETAILS. LIGHTING TOWER AND LUMINAIRES SHALL BE PROVIDED UNDER CONTRACT 62583.
 - SIGN STRUCTURE SHALL BE PROVIDED UNDER THIS CONTRACT. SIGN LUMINAIRES, DISCONNECT SWITCH, WIRING AND CONNECTIONS SHALL BE PROVIDED BY OTHERS UNDER CONTRACT 62583. SIGN O2 SHALL BE LIT BEFORE EXISTING SIGN O2 IS DISCONNECTED



MATCH LINE STA. 1217+00
SEE SHEET EI-10

MATCH LINE STA. 1230+00
SEE SHEET EI-12

HH 1101, TYPE C1
STA. 7407+05, 16 RT, NOTE 5
(2)-3" RGC STUBOUT

2" CNC IN TRENCH
(6)-4" CNC AND (2)-3" CNC
CONCRETE ENCASED, REINFORCED,
(4-4" CNC ITS, 2-4" CNC LTG.), 31 LF, NOTE 7

(4)-4" CNC CONCRETE ENCASED
REINFORCED, 17 LF, NOTE 7

(4)-4" CNC CONCRETE ENCASED, REINFORCED,
(2-4" CNC ITS, 2-4" CNC LTG.), 17 LF, NOTE 7

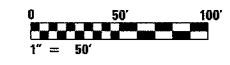

17B/EI-11

REVISIONS	
NAME	DATE
REVISD	5/06/05
ADDENDUM 1	05/27/05

ILLINOIS DEPARTMENT OF TRANSPORTATION
F.A.I. 94 (DAN RYAN EXPRESSWAY)

ELECTRICAL INFRASTRUCTURE PLANS
PROPOSED IMPROVEMENTS

SCALE: 1"=50' DRAWN BY: VG
DATE: MARCH 25, 2005 CHECKED BY: TM

SINGH
300 W. ADAMS ST.
CHICAGO, IL 60606
SINGH & ASSOCIATES, INC. TEL: (312) 629-0240
CONSULTING ENGINEERS FAX: (312) 629-8449

5/25/2005 11:23:04 AM