

F.A.I. RTE.	SECTION	COUNTY	TOTAL SHEETS	SHEET NO.
94		COOK	907	62
STA. 1200+00.00 TO STA. 1365+00				
FED. ROAD DIST. NO.		ILLINOIS	FED. AID PROJECT	
(1516.1, 1717 & 1818) R-9		62695		

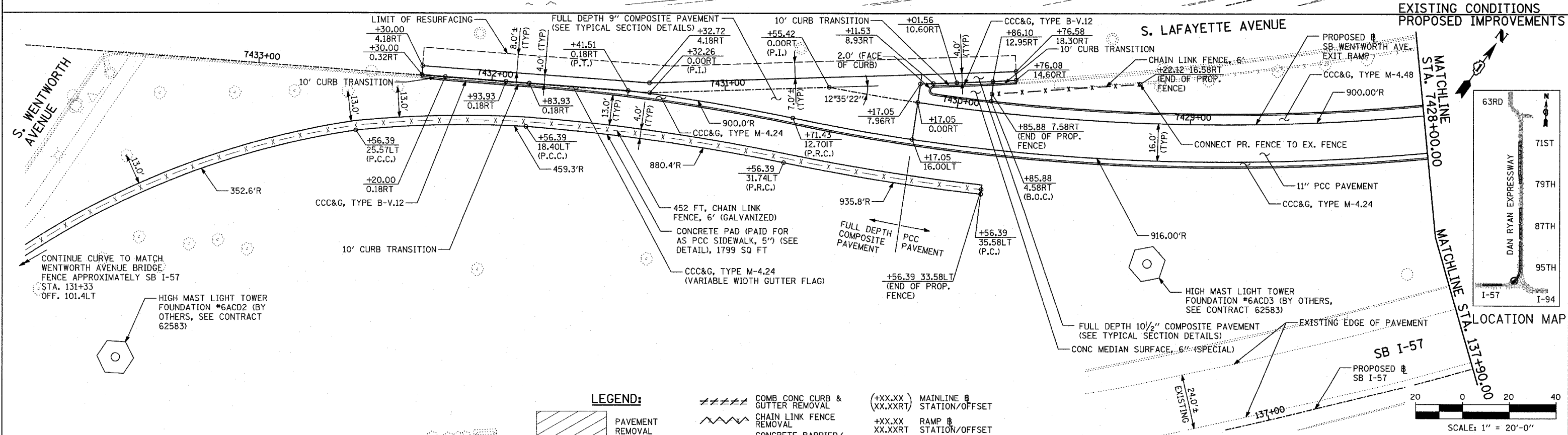
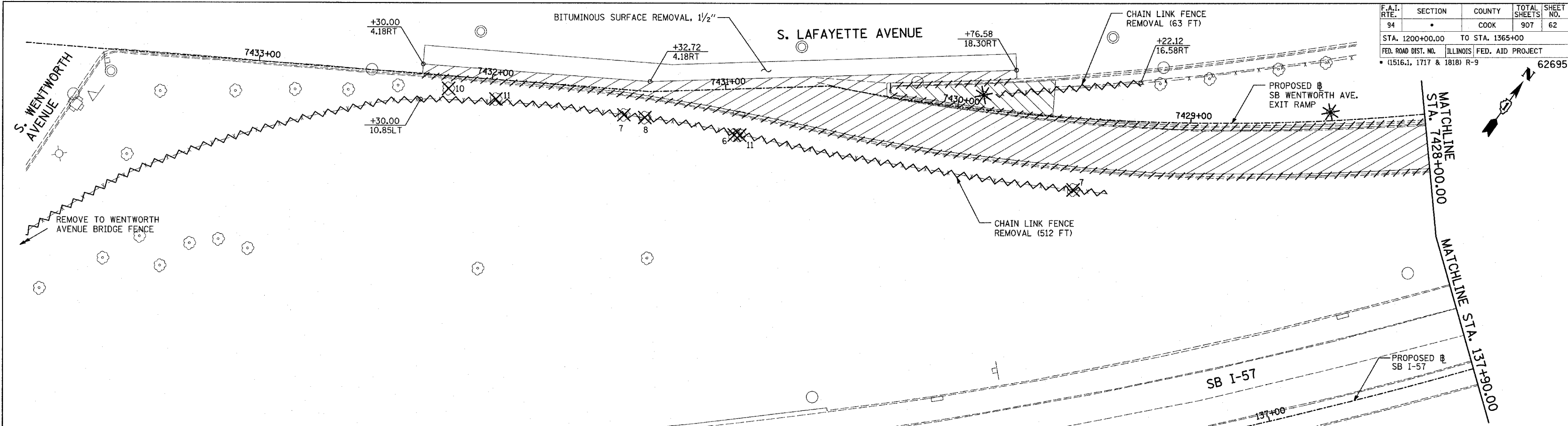

TYLIN INTERNATIONAL

LEGEND:

	PAVEMENT REMOVAL		CHAIN LINK FENCE REMOVAL		TREE REMOVAL (UNITS) (NO UNIT SHOWN = <6)
	PAVED SHOULDER REMOVAL		CONCRETE BARRIER/GUARDRAIL REMOVAL		SOIL BORING LOCATIONS
	PAVEMENT/SHOULDER REMOVAL, SPECIAL		LIGHT POLE FOUNDATION REMOVAL (SEE EXISTING ELECTRICAL PLANS)		

NOTES:

- ALL STATION/OFFSET/RADIUS CALLOUTS MEASURED TO EDGE OF PAVEMENT UNLESS OTHERWISE NOTED.
- EXACT LOCATIONS OF EXISTING PIERS/ABUTMENTS TO BE FIELD VERIFIED

REVISIONS	
NAME	DATE

ILLINOIS DEPARTMENT OF TRANSPORTATION
F.A.I. 94 (DAN RYAN EXPRESSWAY)
EXISTING AND PROPOSED PLAN
SB WENTWORTH AVENUE EXIT RAMP
RAMP STA. 7428+00.00 TO STA. 7432+30.00

SCALE: 1"=20'
DATE: MARCH 25, 2005

DRAWN BY: MPG
CHECKED BY: CL

