

F.A.I. RTE.	SECTION	COUNTY	TOTAL SHEETS	SHEET NO.
94	*	COOK	907	64
STA. 1200+00.00 TO STA. 1365+00				
FED. ROAD DIST. NO.	ILLINOIS	FED. AID PROJECT		
* (1516.1, 1717 & 1818) R-9		62695		

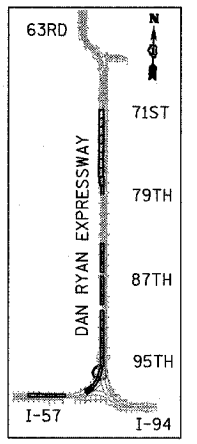

LOCATION MAP

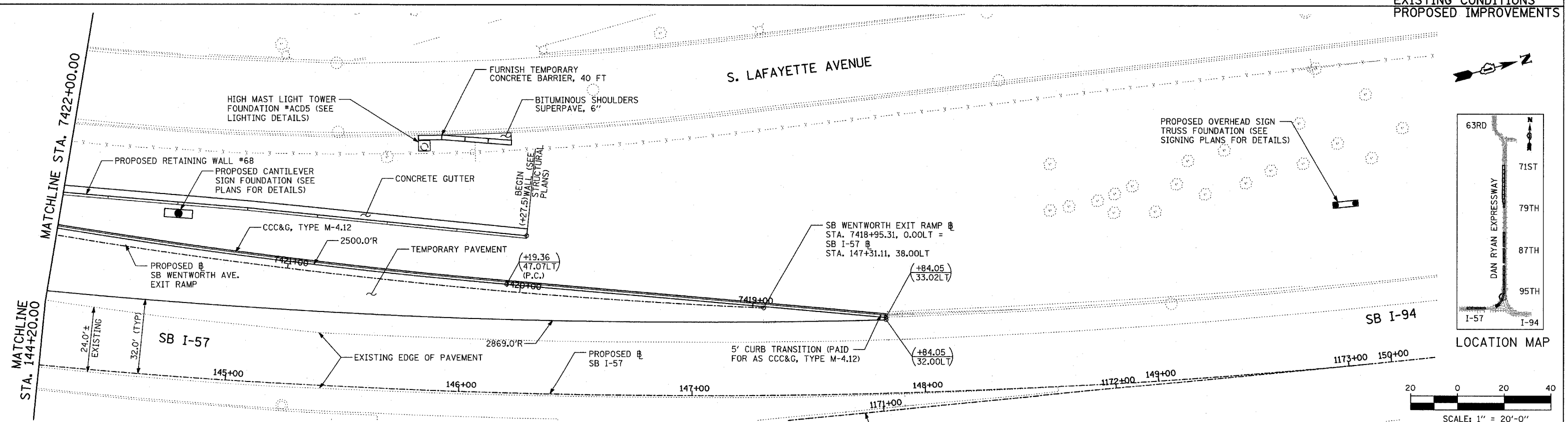
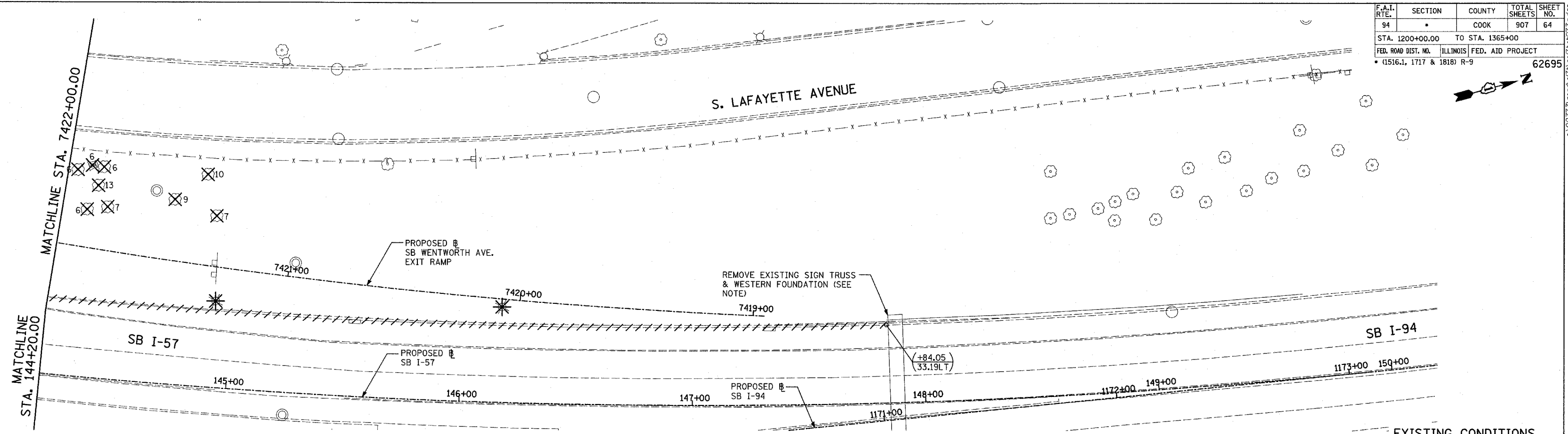
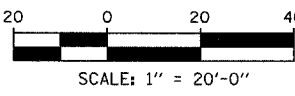

LEGEND:

	PAVEMENT REMOVAL		COMB CONC CURB & GUTTER REMOVAL		MAINLINE # STATION/OFFSET
	PAVED SHOULDER REMOVAL		CHAIN LINK FENCE REMOVAL		RAMP # STATION/OFFSET
	PAVEMENT/SHOULDER REMOVAL, SPECIAL		CONCRETE BARRIER/GUARDRAIL REMOVAL		SOIL BORING LOCATIONS
			TREE REMOVAL (UNITS) (NO UNIT SHOWN = <6)		LIGHT POLE FOUNDATION REMOVAL (SEE EXISTING ELECTRICAL PLANS)

NOTES:

- ALL STATION/OFFSET/RADIUS CALLOUTS MEASURED TO EDGE OF PAVEMENT UNLESS OTHERWISE NOTED.
- EXACT LOCATIONS OF EXISTING PIERS/ABUTMENTS TO BE FIELD VERIFIED
- CONCRETE SIGN FOUNDATIONS SHALL BE REMOVED A MINIMUM OF 1 FOOT BELOW THE ELEVATION OF THE PROPOSED PAVEMENT SUBGRADE

REVISIONS	
NAME	DATE

ILLINOIS DEPARTMENT OF TRANSPORTATION
 F.A.I. 94 (DAN RYAN EXPRESSWAY)
EXISTING AND PROPOSED PLAN
 SB WENTWORTH AVENUE EXIT RAMP
 SB I-57 STA. 147+84.05 TO
 RAMP STA. 7422+00.00

SCALE: 1"=20'
 DATE: MARCH 25, 2005
 DRAWN BY: MPG
 CHECKED BY: CL

TYLIN INTERNATIONAL

03/30/2005 11:54:0 AM