

F.A.I. RTE.	SECTION	COUNTY	TOTAL SHEETS	SHEET NO.
94	*	COOK	905	157
STA. 1200+00.00		TO STA. 1365+00		
FED. ROAD DIST. NO.	ILLINOIS	FED. AID PROJECT		
* (1516.1, 1717 & 1818) R-9		62695		

MATCHLINE SB I-94 STA. 1358+00.00 (PREV. SHEET)

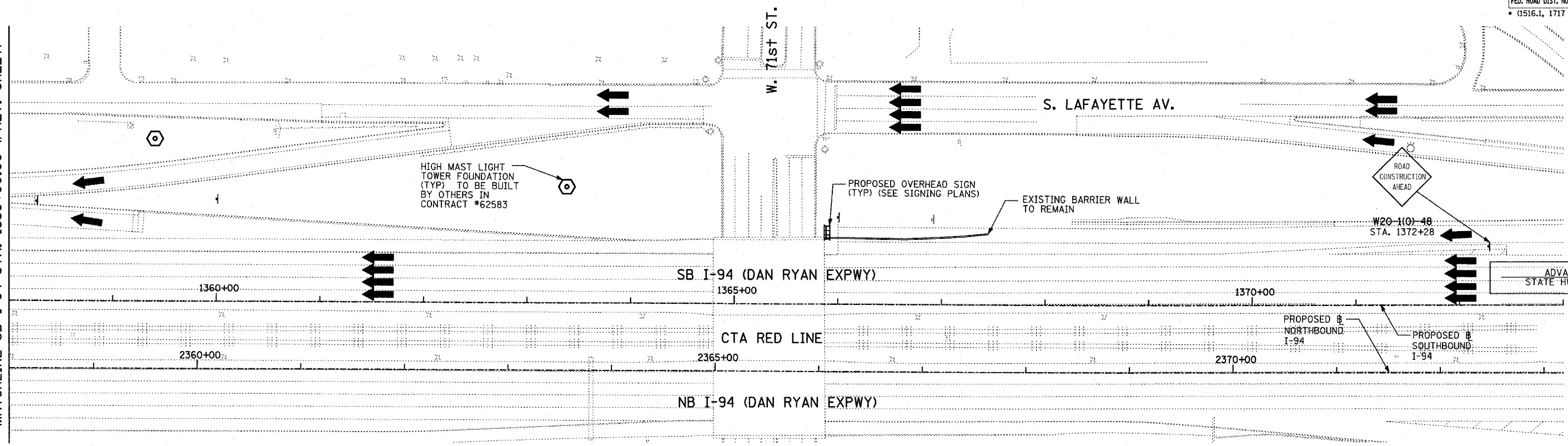

ADVANCE SIGNING PER STATE HWY STANDARD 701400

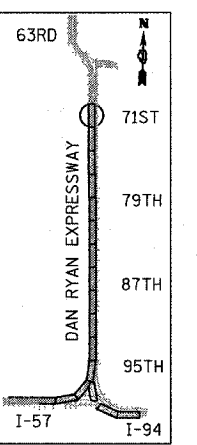

LOCATION MAP

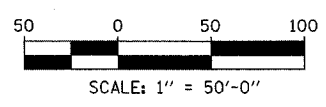

- LEGEND:**
- TEMPORARY CONCRETE BARRIER
 - TRAFFIC LANE
 - WORK ZONE
 - BARRICADE, TYPE III
 - DRUM WITH MONO-DIRECTIONAL STEADY BURNING LIGHT
 - ARROW BOARD

REVISIONS	
NAME	DATE

ILLINOIS DEPARTMENT OF TRANSPORTATION
F.A.I. 94 (DAN RYAN EXPRESSWAY)
MAINTENANCE OF TRAFFIC PLAN
 SB I-94 - STAGE 2
 SB I-94 STA. 1358+00 TO 1373+00
 SHEET 9 OF 9

SCALE: 1"=50'-0"
 DATE: MARCH 25, 2005

DRAWN BY: JPA, RTM
 CHECKED BY: MAG, JPM

TYLIN INTERNATIONAL

03/29/2005 02:35:07 PM