

NOT ALL
 PLOTTED
 NOTE BOOK
 GRADES CHECKED
 STRUCTURE
 STATUS CHKG
 NO.

F.A.I. RTE.	SECTION	COUNTY	TOTAL SHEETS	SHEET NO.
90/94	*	COOK	907	827
STA. 1200+00.00 TO STA. 1365+00		ILLINOIS FED. AID PROJECT		
FED. ROAD DIST. NO. (1516.12717 & 1818) R-9		62695		

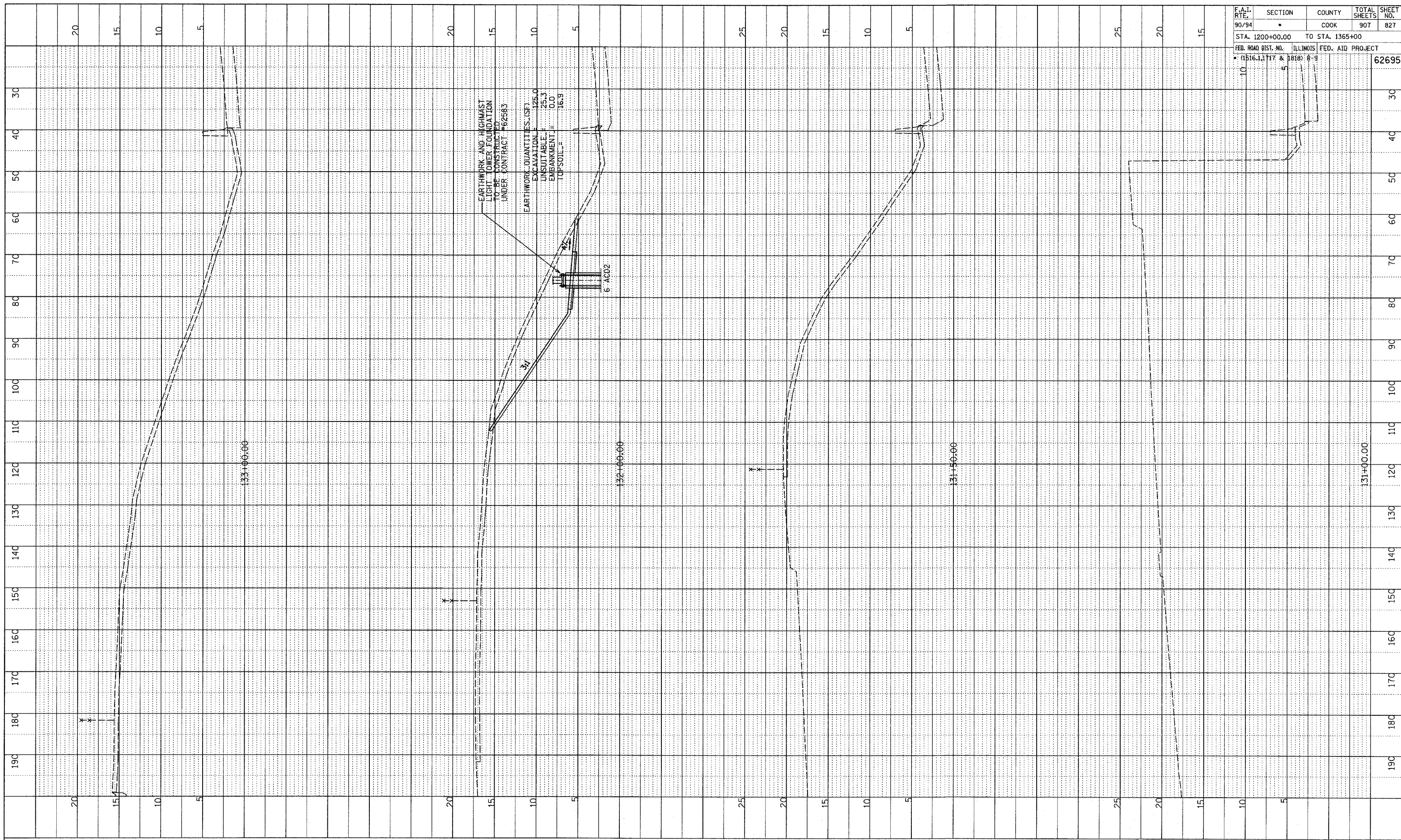

TYLIN INTERNATIONAL

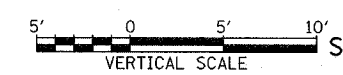
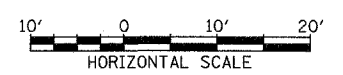

SB WENTWORTH AVENUE EXIT RAMP
STA. 131+00 TO STA. 133+00